

LEGEND

- 8 Granodiorite
- 7 Kspar-Qtz porphyry
- 6 (Quartz) Monzonite porphyry
- 5 Felsite
- 4 Pink feldspar porphyry
- 3 Monzodiorite
- 2 Microdiorite - probably related to 1
- 1 Nicola andesite
- inner limit of chlorite
- inner limit of pervasive epidote
- outline of 17% sulfides
- /// area of 17% total sulfides

From A.R. 6292
M. Wolfhard, 1977
Quitana Minerals Corp.

Geology

LUCKY CLAIMS
1:5000

NTS 92H/9W

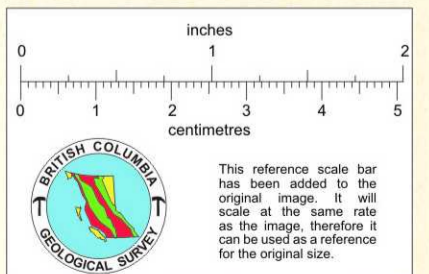

Note: it's difficult to tell which way area, sulfides increase on the orig. map but this is what I gather from the map & text

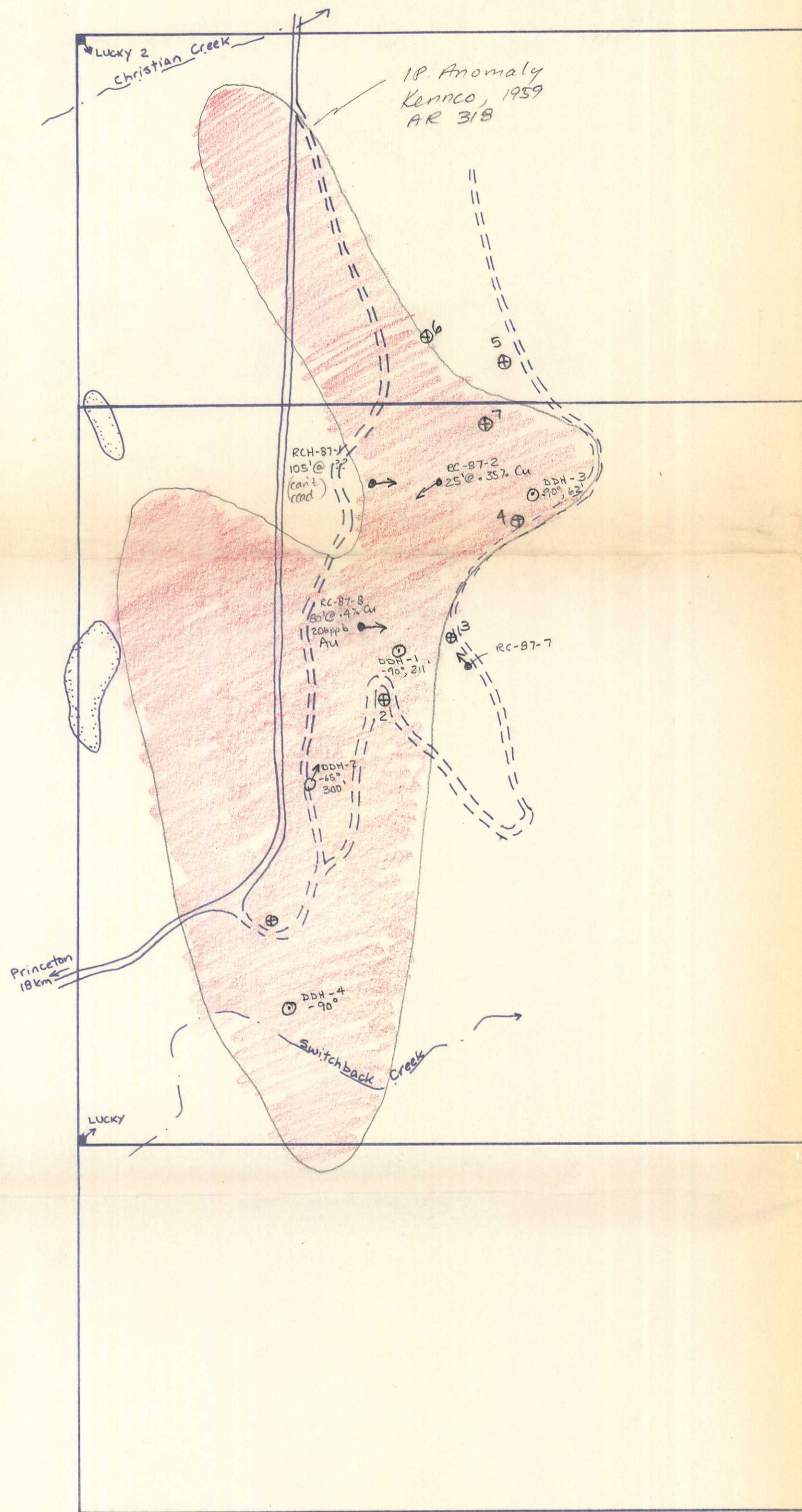

- ⊕ Reverse circ holes by Superior Oil, 1979
- Reverse circ holes referenced on Peto's submission map. Prob by Midgold & not filed for assessment
- ⊙ Diamond drill holes by Keneco, 1959. Loc's in A.R. 318 but no results.

Drilling and I.P. Survey

LUCKY CLAIMS
1:5000

NTS 92H/9W

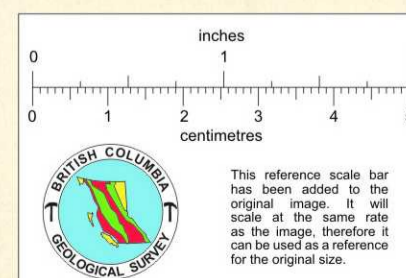

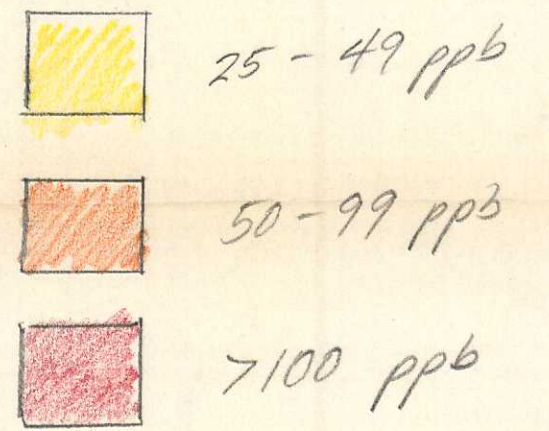
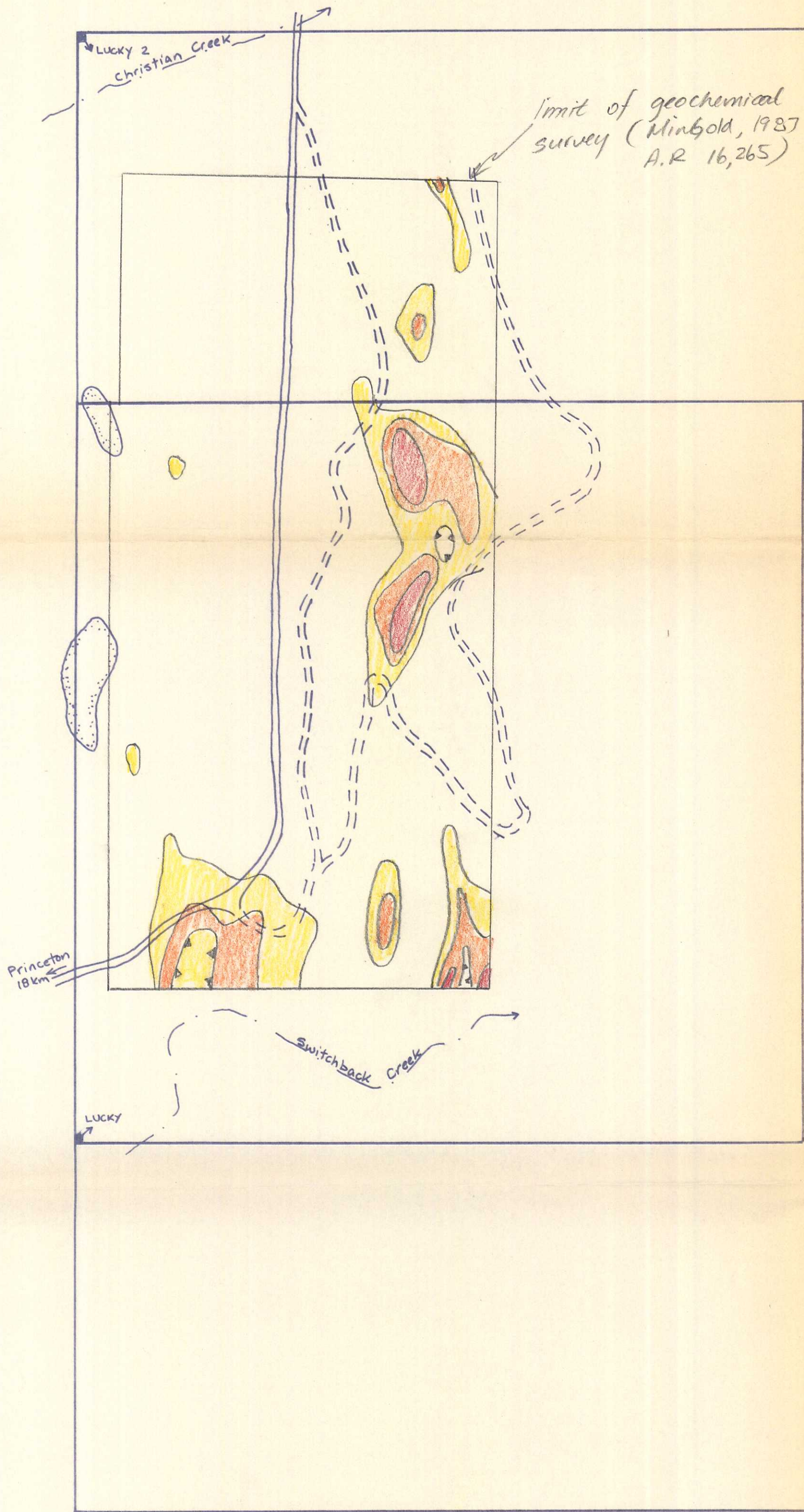

Gold Geochemistry.

LUCKY CLAIMS
1:5000

NTS 92H/9W

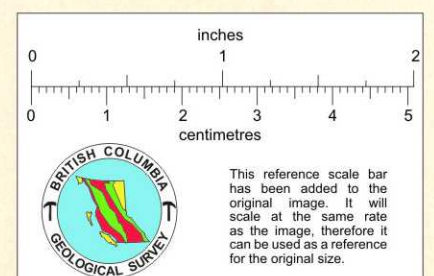

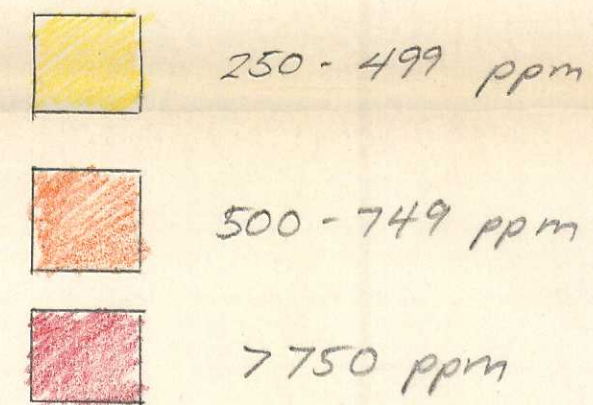
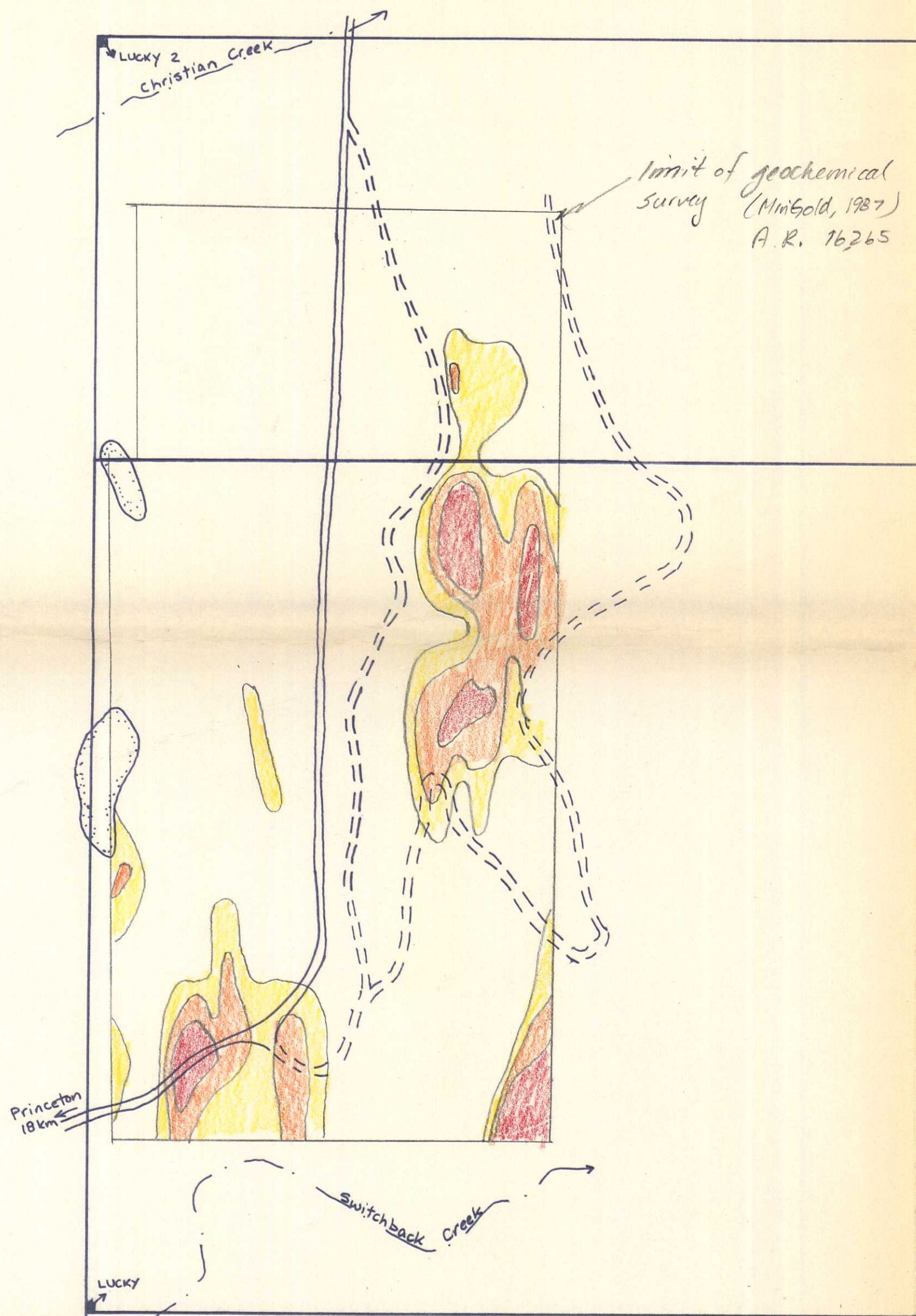

Copper Geochemistry

LUCKY CLAIMS
1:5000

NTS 92H/9W

