

PIONEER CLAIMS

GEOLOGY AND ROCK GEOCHEMISTRY

*MDJ*  
June 6/77

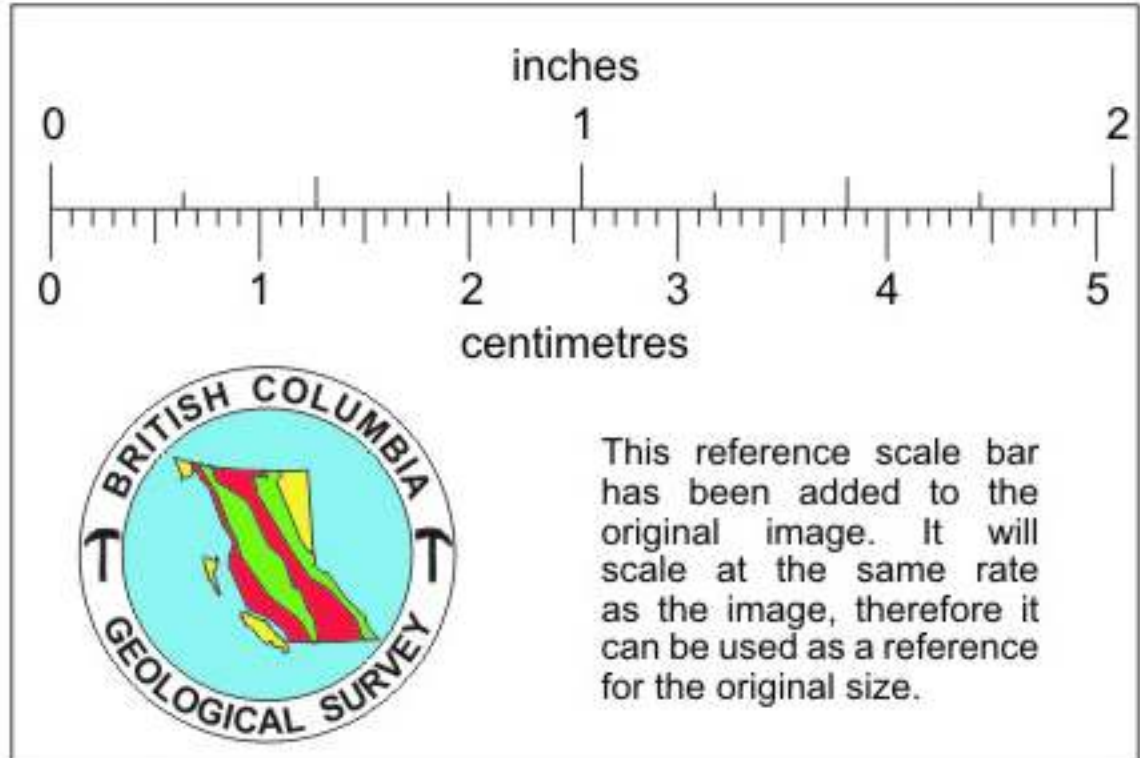

SCALE 1:500

Prepared by: M R W	Date: May 1977	NTS MAP AREA: 92 M 9/W	DRAWING No.
Drawn by: Altur	Revised:		

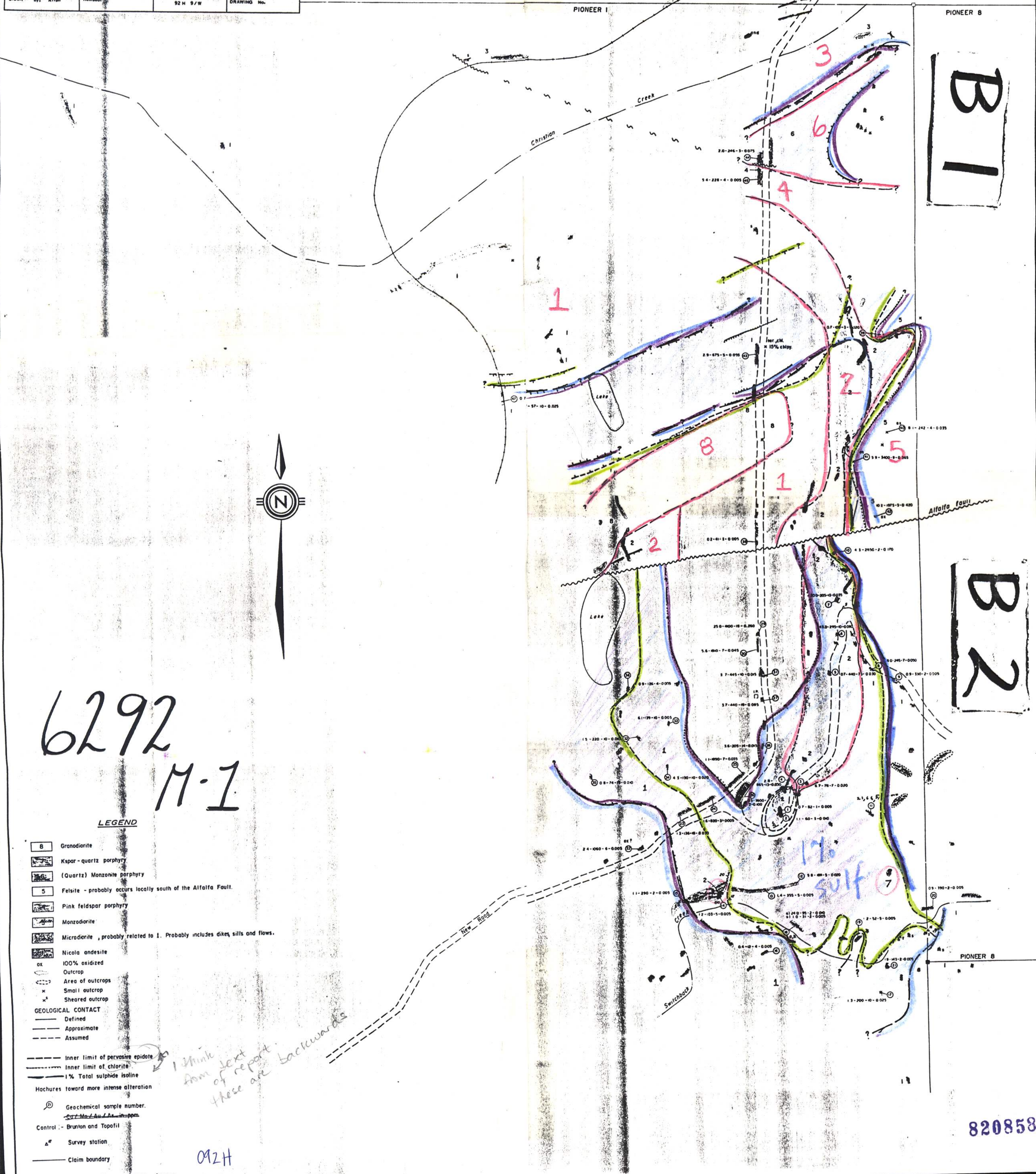

LEGEND

- 8 Granodiorite
- Kspar-quartz porphyry
- (Quartz) Monzonite porphyry
- 5 Felsite - probably occurs locally south of the Alfalfa Fault.
- Pink feldspar porphyry
- Monzodiorite
- Microdiorite, probably related to 1. Probably includes dikes, sills and flows.
- Nicola andesite
- 100% oxidized
- Outcrop
- Area of outcrops
- Small outcrop
- Sheared outcrop
- GEOLOGICAL CONTACT
  - Defined
  - Approximate
  - Assumed
- Inner limit of pervasive epidote
- Inner limit of chlorite
- 1% Total sulphide isoline
- Hachures toward more intense alteration
- Geochemical sample number.
  - Mo ppm - Cu ppm - As ppm - Au ppm
- Control - Brunton and Topofil
- Survey station
- Claim boundary

*I think some text of report these are backwards*

092H