

# KERR ADDISON MINES LIMITED

(FOR INTER-OFFICE USE ONLY)

File

820787

To File From A.D. Clendenan  
Subject Standard Creek Property 92J -10E Date May 15, 1985

Robert Pincombe is a Director of Trans Atlantic Resources which holds the Standard Gold Property, due to be released in a week or so. Is Kerr interested in 70' of .12 of Au in adit in McGillvary Pass south of Normines Cadwallader property, Bridge River Area, on Cadwallader fault for 5 to 6 miles. Report by Don Allan in '84.

Yes.

Robert Pincombe (RN Property) brought the data to Kerr.

May 18, 1985

Reviewed by Jo Anne Nelson.

"Not very interesting" "In a more environmentally sensitive area than reference in report indicates". Jo Anne has copies of some of the maps and may look at the area if they are close by this summer.

Reviewed by A.D. Clendenan

The reported 70' of .12 Au is in the Standard Adit and the adit is caved. There is a surface IP resistivity high that could correspond to the quartz stringers with minor pyrite in a talcose vein zone that was reported by Clouthier (BCDM Ann.Rpt. 19132, 1933) to carry the .12 oz/T Au.

The soil geochem (see fig. 8) has anomalous As, Zn but only spotty Au.

There are better targets available. I have contacted Robert Pincombe and said we will decline at this time, however if Jo Anne is in the area she will look at the ground.

A. D. Clendenan  
May 31, 1985

Ref. See.

Statement of Material Facts

Trans Atlantic Resources Dated April 15, 1985.

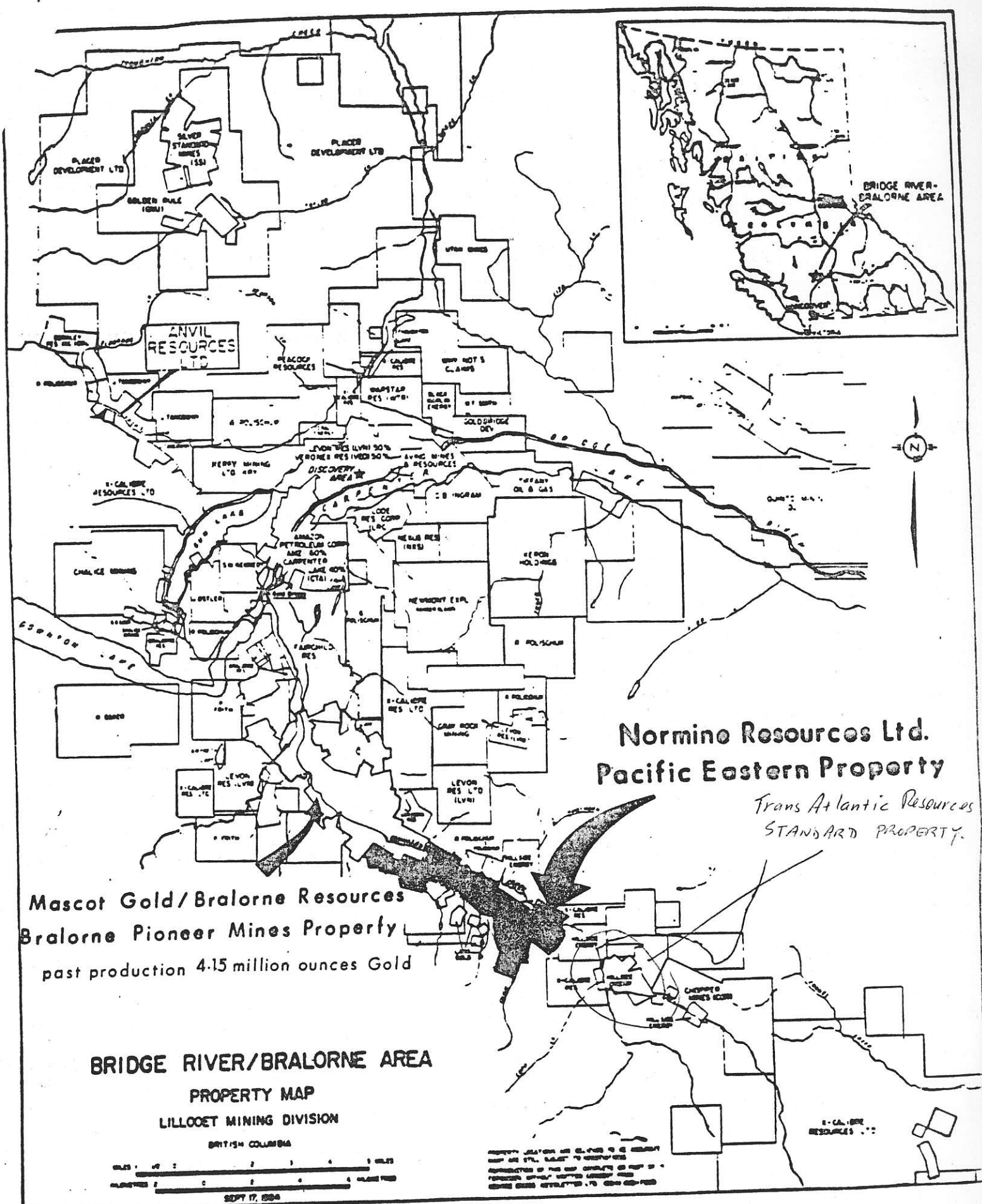

**Normine Resources Ltd.  
Pacific Eastern Property**

*Trans Atlantic Resources  
STANDARD PROPERTY.*

**Mascot Gold/Bralorne Resources  
Bralorne Pioneer Mines Property**  
past production 4.15 million ounces Gold

**BRIDGE RIVER/BRALORNE AREA  
PROPERTY MAP  
LILLOOET MINING DIVISION**

BRITISH COLUMBIA

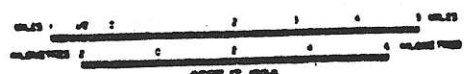

SEPT 17, 1964

PROPERTY LINES ARE SUBJECT TO REVISION  
AND ARE NOT SUBJECT TO RESERVATION  
APPROPRIATION OF THIS MAP CONSTITUTES NO PART OF A  
PROPERTY OFFICIAL SURVEY DOCUMENT AND  
SHOULD BE REFERRED TO FOR DETAILS

TRANS ATLANTIC RESOURCES

added May 85

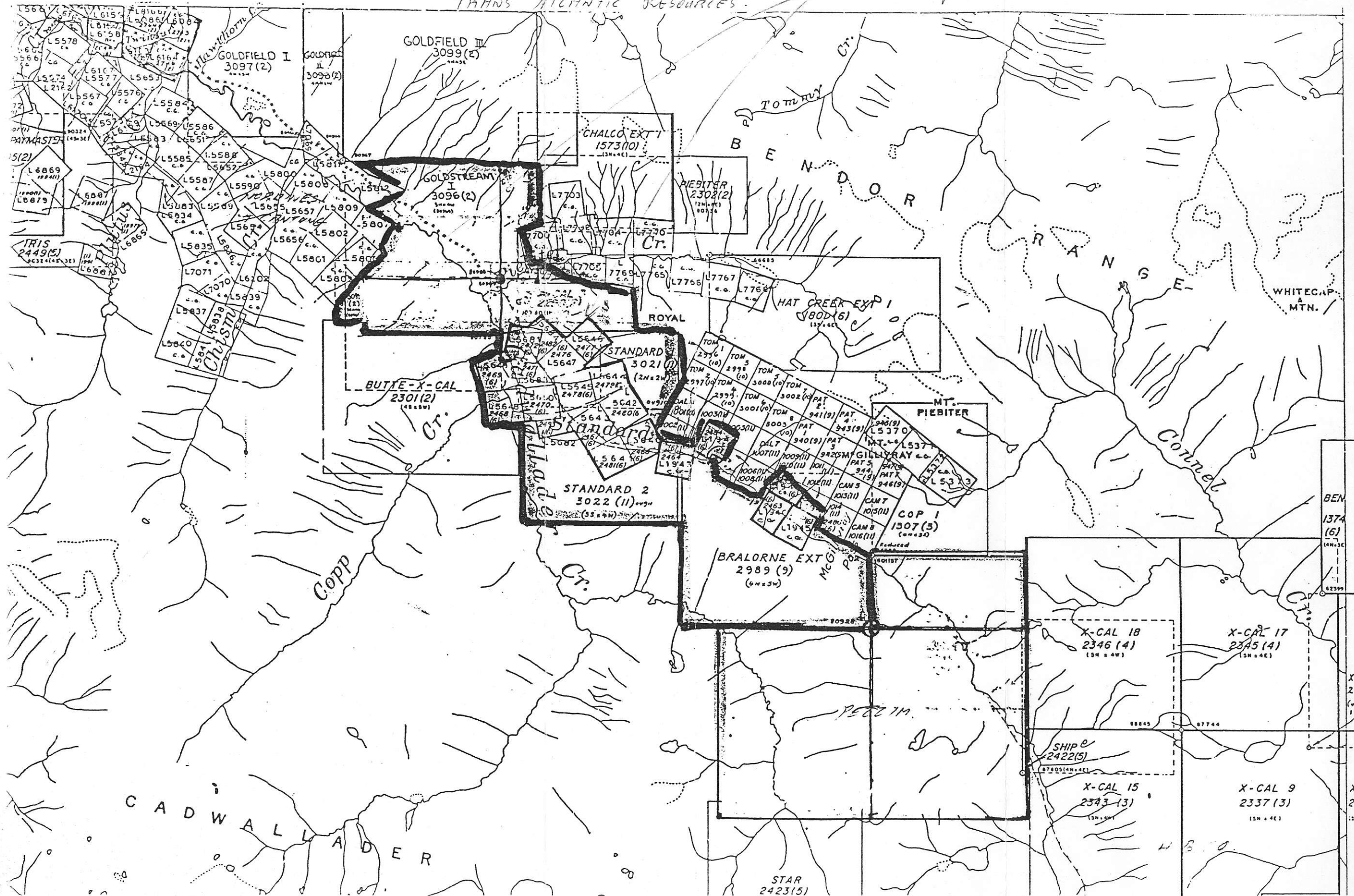

Claim Position as of May 16, 1985

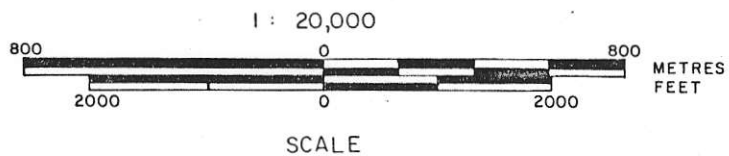
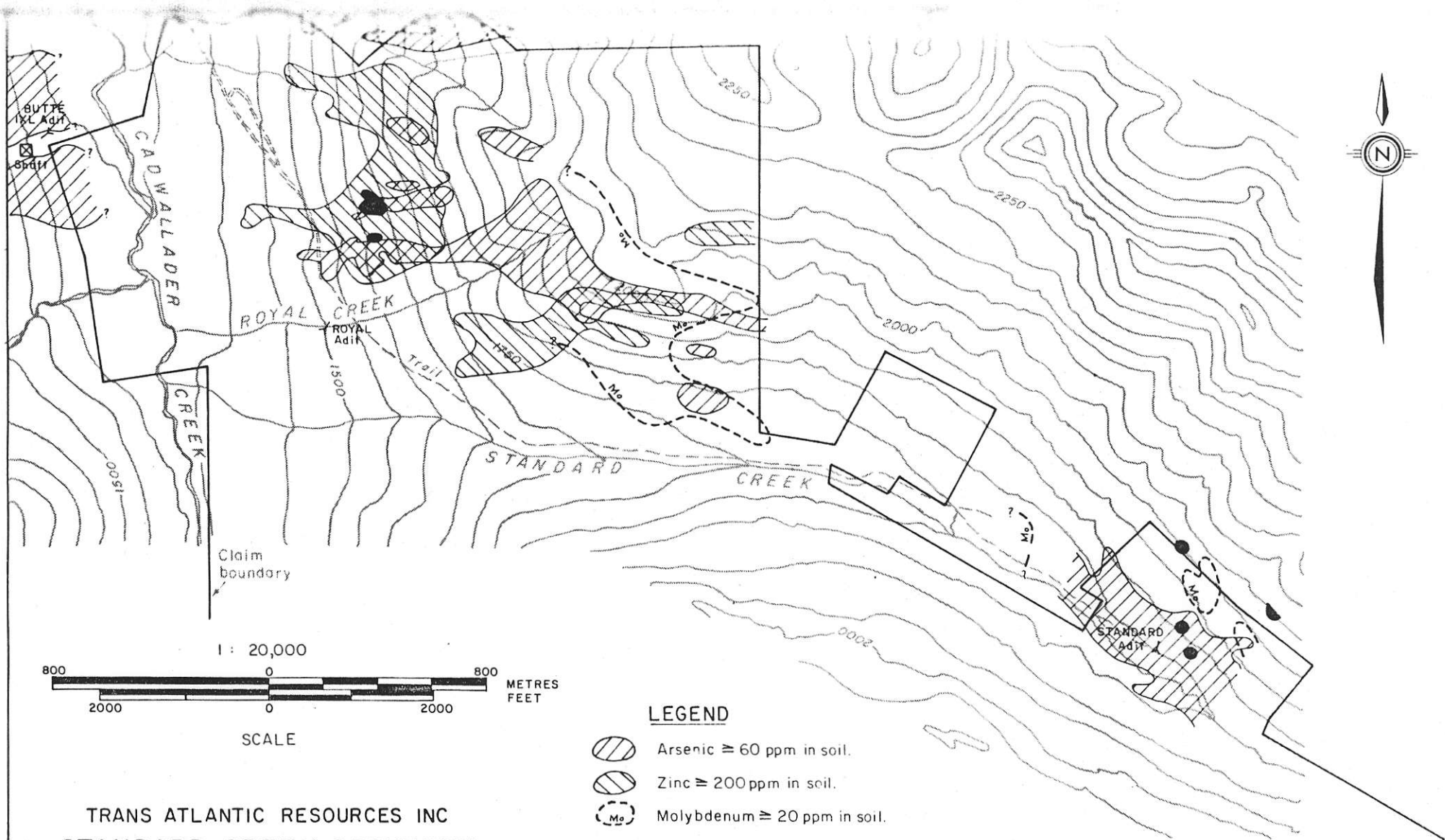

**LEGEND**

- Arsenic  $\geq 60$  ppm in soil.
- Zinc  $\geq 200$  ppm in soil.
- Molybdenum  $\geq 20$  ppm in soil.
- Anomalous Gold.

Contour interval = 50metres.

TRANS ATLANTIC RESOURCES INC  
**STANDARD CREEK PROPERTY**  
 LILLOOET MINING DIVISION - BRITISH COLUMBIA

**GEOCHEMICAL MAP**

Jan. 9, 1985

Figure 8

