

INDICATE NORTH
(True or Magnetic.)

Claims must be tied by direction and distance to at least one, preferably more than one, topographical feature, or to a land lot, section, township, or other recognizable point on printed maps of the district. Relationship of previously located claims should also be shown.
N.B. — The sketch for a group of claims may be placed on one affidavit.

820113

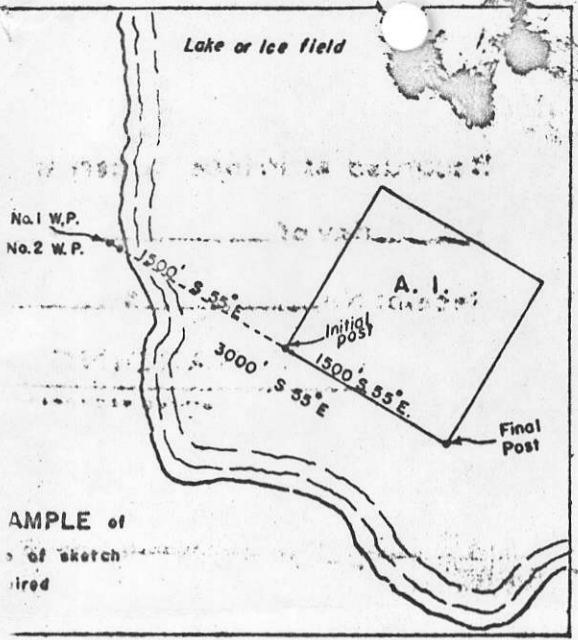

AMPLE of
of sketch
ired

This map is prepared to serve as a guide only. Positions of unsurveyed claims and placer leases are plotted from locators' sketches and are not guaranteed. Letters C.G. indicate claim is Crown-Granted. Symbol "C" indicates claim has forfeited.
B. C. DEPARTMENT OF MINES AND PETROLEUM RESOURCES

MAP 17M-1

RECORD NOS.

34412 - 34417

KINSKUCK.

• 1, 2, 3, 5, 7, 8. M.C.'s.

Plotted: Oct 29/69 J.F.



No. 2	No. 4	No. 6	No. 8
No. 1	No. 3	No. 5	No. 7

Tag No. 649576
Tag No. 649578
Tag No. 649520
Tag No. 649522
Tag No. 649519
Tag No. 649517
Tag No. 649521

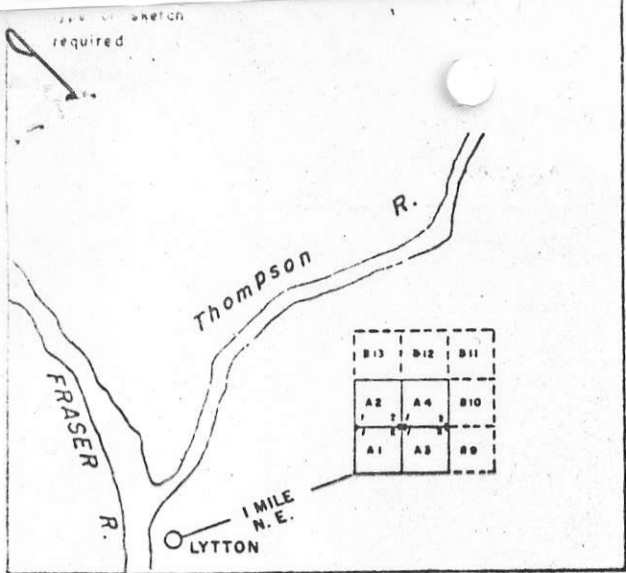

Claims must be tied by direction and distance to at least one, preferably more than one, topographical feature, or to a land lot, section, township, or other recognizable point on printed maps of the district. Relationship of previously located claims should also be shown.

N.B. — The sketch for a group of claims may be placed on one affidavit.

INDICATE NORTH
(True or Magnetic)

This map is prepared to serve as a guide only. Positions of unsurveyed claims and placer-leases are plotted from locators' sketches and are not guaranteed. Letters C.G. indicate claim is Crown-Granted. Symbol "C" indicates claim has forfeited.

B. C. DEPARTMENT OF MINES AND PETROLEUM RESOURCES

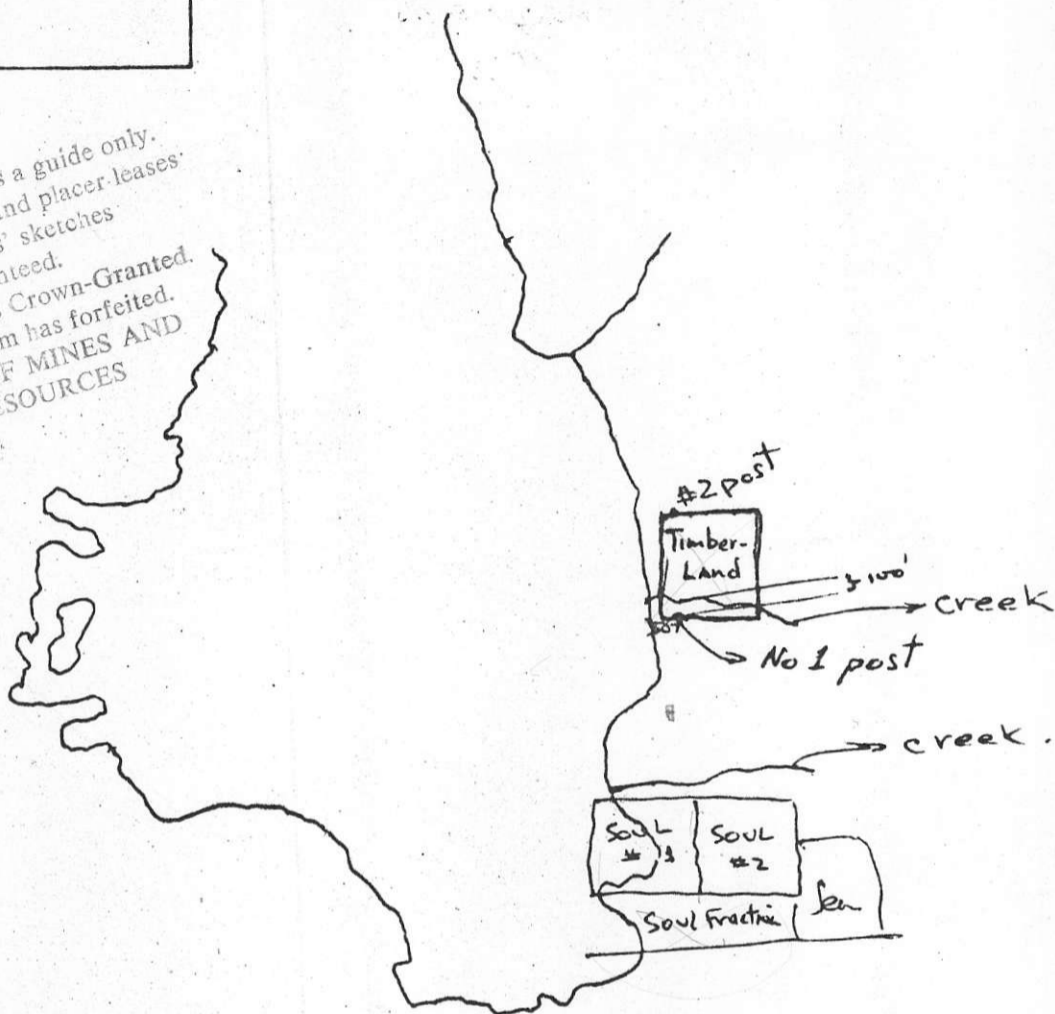

Skeena Oct 31 (21/1/69 D.S)

MAP 17 M-1

(33190, 91, 93, 94 M)

JEAN; TIMBERLAND, SOUL 1+2, MC'S

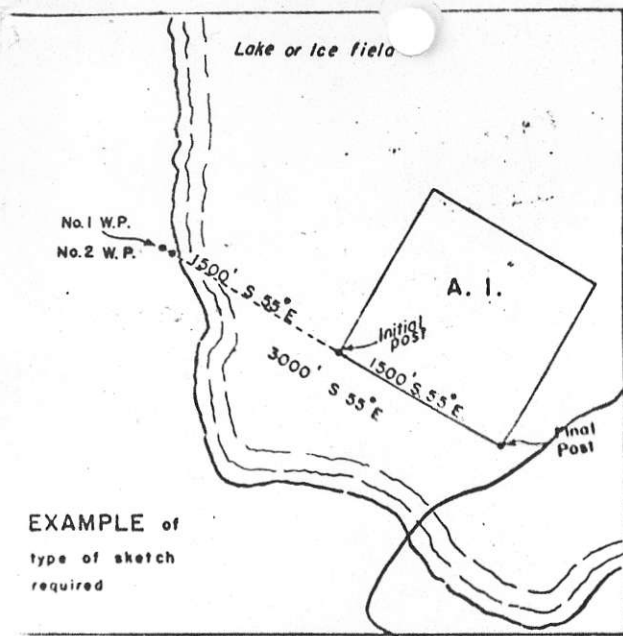

EXAMPLE of type of sketch required

Claims must be by direction and distance to at least one, preferably more than one, topographical feature, or to a land lot, section, township, or other recognizable point on printed maps of the district. Relationship of previously located claims should also be shown.

N.B. — The sketch for a group of claims may be placed on one affidavit.

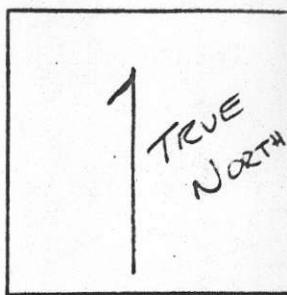

INDICATE NORTH (True or Magnetic.)

This map is prepared to serve as a guide only. Positions of unsurveyed claims and placer leases are plotted from locators' sketches and are not guaranteed. Letters C.G. indicate claim is Crown-Granted. Symbol "C" indicates claim is Crown-Granted. B. C. DEPARTMENT OF MINES AND PETROLEUM RESOURCES

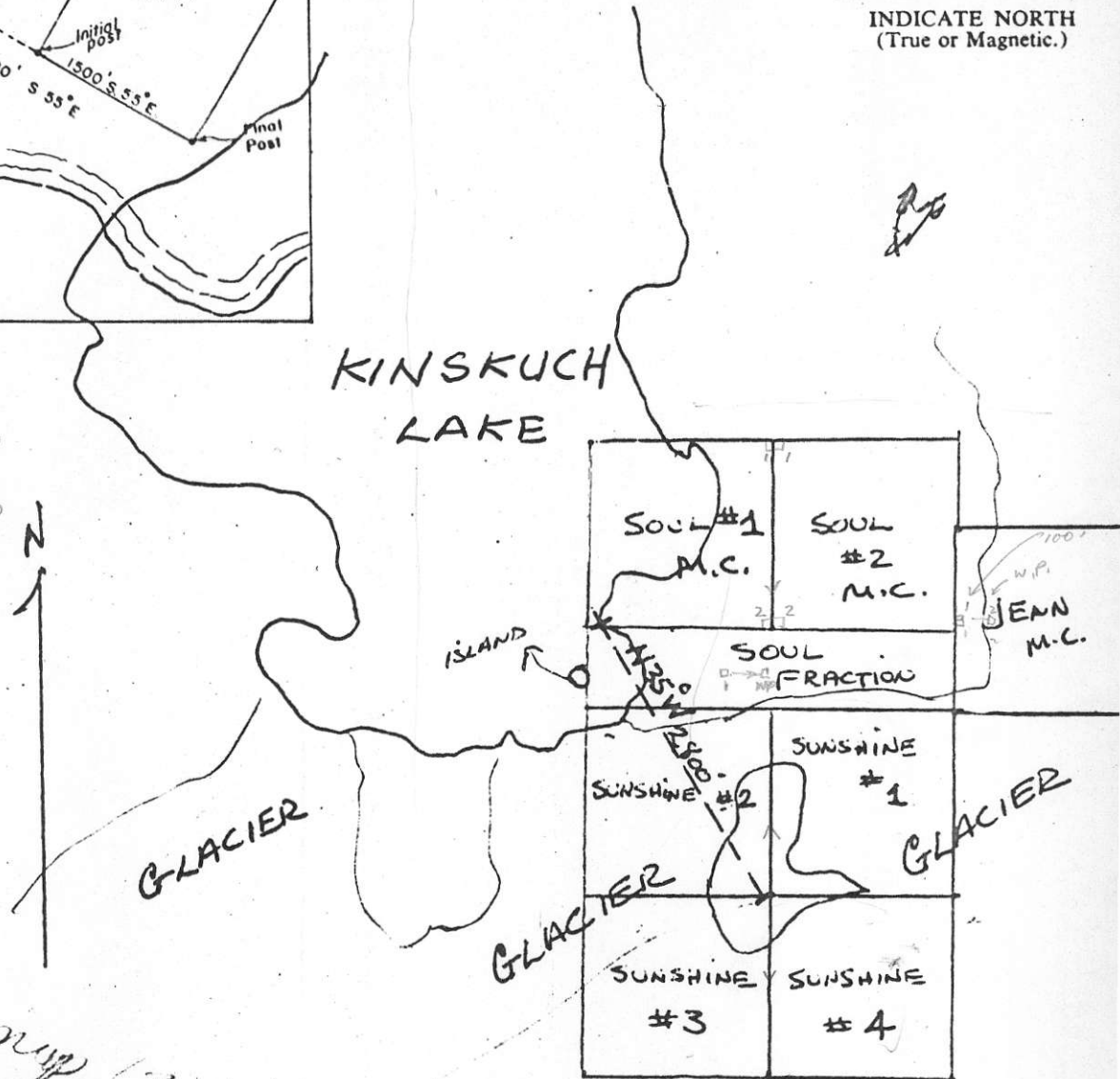

Map 17M-1

INITIAL AND FINAL POSTS FOR SUNSHINE # 1, 2, 3, 4, placed IN THE SAME PLACE BECAUSE

OF GLACIER Location line Due North on Sunshine #1 & 2 Due South " 3 & 4

LOCATION LINE FROM POSTS IS N35°W, 2800 FEET TOUCHING EDGE OF PENINSULA (ISLANDS OFF THIS PENINSULA)

RECORD NOS 34456-34459 SUNSHINE 1-4 M.C. MAP 17M-1

Plotted Oct 30/69 LF

SKETCH-PLAN

Show position of claim in relation to prior locations in vicinity and its position in relation to nearest named creeks, lakes, rivers, or other topographical features. Indicate north (true or magnetic).

N (True).

This map is prepared to serve as a guide only. Positions of unsurveyed claims and placer leases are plotted from locators' sketches and are not guaranteed. Letters C.G. indicate claim is Crown-Granted. S, m'hol "C" indicates claim has forfeited. B. C. DEPARTMENT OF MINES AND PETROLEUM RESOURCES

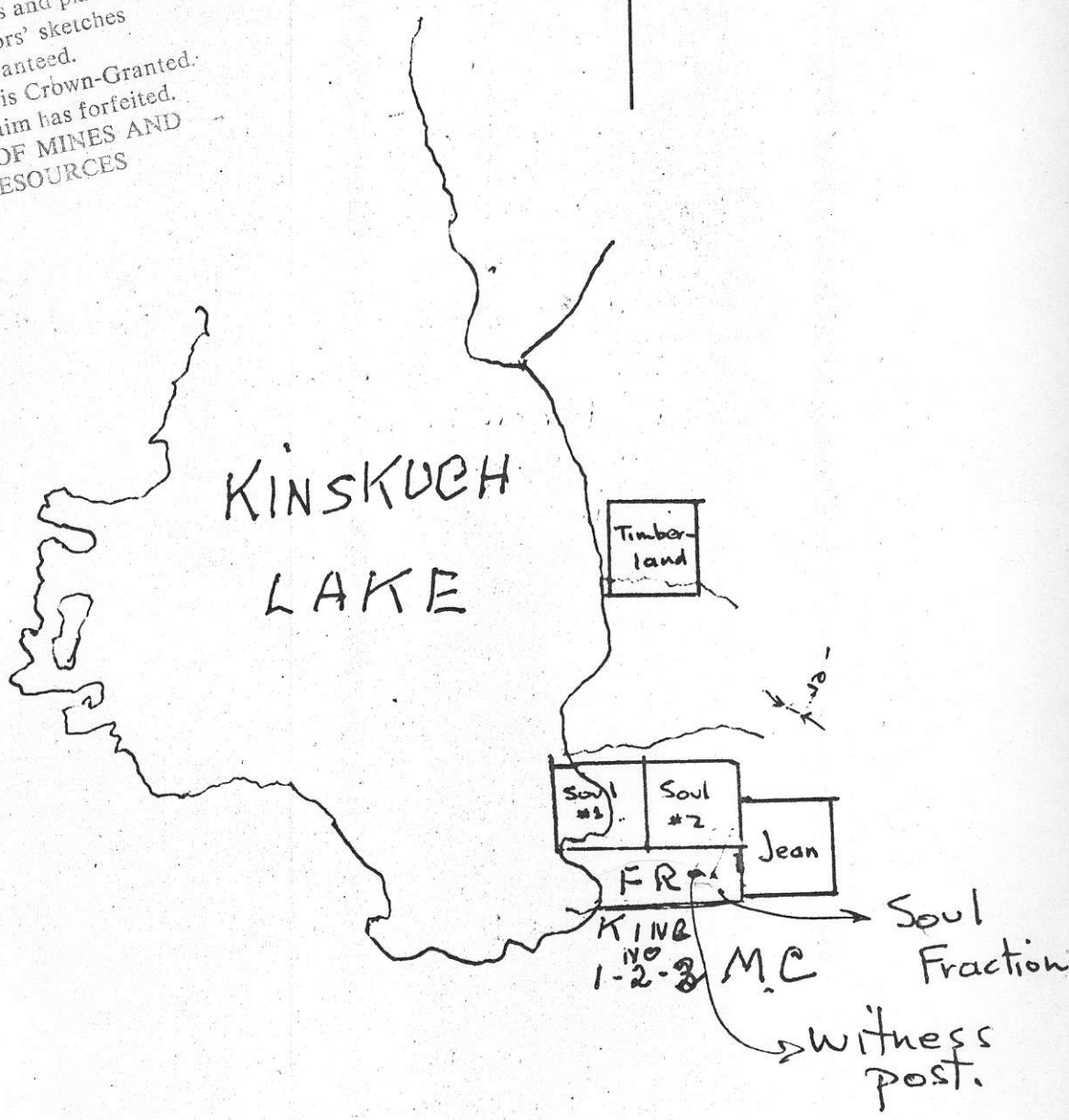

MAP 17M-1

Soul FR. M.C.

Record Numbers	33192 M
Mining Division	Skeena
Map Number	17m-1
Date of Return	Nov 15
Time Completed	3/11/69
INITIALS	DL

Skeena Div.

33192
33295-33360
33367-33412

113

15318

Map No. IX 171



REINSTATED

Record No. 26107

FOR UNOFFICIAL USE ONLY

FORM A
(Mineral Act)

Skeena Mining Division. Name of Mineral Claim K. Lake #2
 Mining Receipt No. 70393D Tag No. 581304
 Located by Robert Zielinski F.M.C. No. 36500
 Address 2942 West 22nd Avenue, Vancouver, 8, B.C.
 Agent for _____ F.M.C. No. _____
 Address _____

The claim is situate Relocating the Reina Blanca #3 M.C. and joining the
Lavender #1 M.C. on the west and Woodland M.C. on the North.
Situated 15 miles North of Alice Arm.

_____ feet to the right and _____ feet to the left of the location-line.
 The direction of the location-line is E 0° The length of the claim is 1500 feet.
 The claim was located on the 17th day of June, 19 65 Recorded at
Prince Rupert, B.C., this 21 day of June, 19 65

Nº 199040

(FOR AUDIT PURPOSES ONLY.)

H. W. HARDING

Mining Recorder.

C. of W.	Recorded	M.R.	Date of Expiry	Record Date	Transfers (Bills of Sale, Assignments, Conveyances)
SURVEY PENDING		<u>210</u>	<u>2344/65</u>		<u>Map of A-11</u> <u>of locations etc before</u> <u>5/16/66</u> B/S: All int. to Forest Kerr Mines Ltd.
SURVEY PENDING		<u>210</u>	<u>411/66</u>		
C/L	<u>June 10/66</u>		<u>June 21/67</u>	<u>Jul 6/65</u>	
C/L	<u>June 1/67</u>	<u>86958 D</u>	<u>June 21/68</u>		
C/L	<u>Jun 8/68</u>	<u>11630E</u>	<u>Jun 21/69</u>		
C/L	<u>May 21/69</u>	<u>11778E</u>	<u>Jun 21/70</u>		

C. of W.	Recorded		Date of Expiry	Record Date	Transfers (Bills of Sale, Assignments, Conveyances)

Options, Agreements, etc.	Record or Filing Date	Grouping Notices, Including Names of Claims
	Apr 7/66	<p><u>NOTICE TO NUMBER THREE GROUP: 32 Claims</u> Lavender, Grizzly, Riena Blanca, 2,4,6,8,K.Lake 2 & 4, King 95-100, 131-142, 11-16, 71-76, and 89 & 91.</p>
FOR UNOFFICIAL USE ONLY		