

KERR ADDISON MINES LIMITED
405 - 1112 WEST PENDER STREET
VANCOUVER 1. B.C.

820109

103P/11

COPY

E. C. Jacka

Lynda Krupp

Kinskuch Option - Assessment Work

August 25, 1970

Enclosed please find a photostat copy of the geophysical report which Mr. Sirola wrote describing the work done on the Kinskuch optioned claims.

This copy for your files.

Lynda Krupp.

LJK/SEL

COPY

August 25, 1970

The Mining Recorder's Office,
Court House,
Prince Rupert, B.C.

Gentlemen:

This letter is in reference to telephone conversations between the Assistant Mining Recorder and myself regarding assessment work due on claims in the Kinskuch Lake area of the Skeena Mining Division.

The claims involved are: Jean, Timberland, Soul #1 and #2, Soul Fraction, Sunshine #1 - 4, Ted #1 - 6, Ted Fraction, and the Kinskuch #1 - 3, 5, 7, and 8 Mineral Claims. It is our intention to file assessment work on the above claims for a period of one year and on July 27th, we did file an Application for Certificate of Work and a Notice to Group form. Our geophysical report is due on August 25th (late filing), however our Resident Geologist, Mr. Bill Sirola, became ill last week and has been unable to sign the report. We hope to obtain his signature by the end of this week and will forward two copies of his report immediately. It is my understanding that you have telephoned your Victoria office and obtained permission from them to accept our late filing.

Thank you for your efforts on our behalf.

Yours sincerely,

Lynda Krupp, (Mrs. W.)

Secretary to:

W. M. Sirola,
Resident Geologist.

WMS/1k

KERR ADDISON MINES LIMITED
405 - 1112 WEST PENDER STREET
VANCOUVER 1. B.C.

COPY

E. C. Jacka

Lynda Krupp

Kinskuch Option - Assessment Work

Aug. 6, 1970

Re your memo of August 4th concerning the Sunshine 1 - 4 M.C.'s, enclosed please find a photocopy of a letter received today from the mining recorder in Prince Rupert. The report is now ready and awaits Mr. Sirola's signature and seal.

Regards,

Lynda Krupp

LJK/sel
Encl.

OUR FILE A 25

YOUR FILE _____

ADDRESS YOUR REPLY _____

TO _____



Court House
Prince Rupert, British Columbia

August 4, 1970

RECEIVED
AUG 6 1970

KERR ADDISON L. MINES LTD.
Per. _____

Mr. W. M. Sirola
405 - 1112 West Pender Street
Vancouver 1, British Columbia

Dear Sir:

We have received the affidavit on application for Certificate of Work for Mineral Claims in the vicinity of Kinskuch Lake and also the Grouping Notice. We have noted that the Geophysical Reports will follow within one month from the date of filing.

Yours truly,

H. W. Harding
MINING RECORDER

HWH:pt

KERR ADDISON MINES LIMITED

(FOR INTER-OFFICE USE ONLY)

RECEIVED
AUG 6 1970

KERR ADDISON MINES LTD.

To..... W. M. Sirola From..... E. C. Jacka Per.....

Subject..... Kinskuch Option - Assessment Work Date August 4, 1970

Further to my memo of June 29th, will you tell me what action has been taken with reference to claims Sunshine 1 - 4 held in the name of J. S. Falconer, which were due for assessment work on July 25, 1970.



E. C. Jacka

ECJ:lfr

BRITISH COLUMBIA MINING RECEIPT

Mining Division Special

Issued at Vancouver

No 48305 E

Date July 27, 1970

RECEIVED from William M. Hilder

the sum of Eighty one ⁰⁰/₁₀₀ Dollars,

in payment of Reading notice to group

Covering TEAN, KIMBERLAND, SOULI #1-2, SOUL FR,

SUNSHINE #1-4, TED FR, TED #1-6, KINSKUCH #1-3, 5,

7-8 Certificates of work (6) on the

above except KINSKUCH #1-3, 5, 7-8.

Signature Jim Turner

Office Sub-mining Recorder

\$ 81.00



DEPARTMENT OF MINES AND PETROLEUM RESOURCES

MINERAL ACT FORM B

SUB-MINING RECORDER RECEIVED JUL 27 1970 M.R. # \$ VANCOUVER, B.C.

Affidavit on Application for Certificate of Work

I, W. M. Sirola, Agent for James S. Falconer, & Kerr Addison Mines Ltd. 405 - 1112 West Pender Street, Vancouver 1, B.C.

Free Miner's Certificate No. 89137 Date issued May 29, 1970 Free Miner's Certificate No. 84620, 90544 Date issued April 31, 1970

make oath and say:—

I have done, or caused to be done, work on the Timberland, Kinskuch #1, #2, #3 and #5 to apply to: Jean, Timberland, Soul #1, #2, and Soul Fraction, Sunshine #1, #2, #3, and #4; Ted Fraction, and Ted #1, #2, #3, #4, #5, Mineral Claim(s) and #6.

Record No.(s) 33191, 34412, 34413, 34414, 34415; 33190, 33191, 33193, 33194, 33192, 34456, 34457, 34458, 34459, 35237, 35238, 35239, 35240, 35241, 35242, 35243. situate at Kinskuch Lake, 30 miles southeast of Stewart, B.C.

in the Skeena Mining Division, to the value of at least sixteen hundred one hundred dollars, since the 25th day of July, 1969

The following is a detailed statement of such work:—

(Set out full particulars of the work done in the twelve months in which such work is required to be done.)

- 21,000 feet of line cutting and chaining
21,000 feet of magnetometer survey
5 miles of I.P. Survey
for a total value of sixteen hundred dollars (\$1,600.00), or the equivalent of \$100.00 per claim for each of the above mentioned claims.
Geophysical Reports will follow within four weeks time.

That I have not and will not use the work declared herein in any way for the purposes of obtaining tax exemption on a Crown-granted mineral claim under the terms of the Taxation Act.

SWORN and subscribed to at VANCOUVER, B. C. this day of 19, before me JUL 27 1970 Sub - Mining Recorder

Handwritten signature of W. M. Sirola

* This affidavit may be taken by a person empowered to take affidavits by the Evidence Act of British Columbia.

Assessment

BRITISH COLUMBIA MINING RECEIPT

Mining Division Kerr

Issued at Uncovered No 47947 E

Date June 30, 1970

RECEIVED from Kerr Addison Mines Ltd.

the sum of six hundred 00 Dollars,

in payment of Recording cash - in lieu of work
ON KINSKUEH #1-3, 5, 7-8 (3442-17
July).

F.H.C. 26986 - May 28/70 - (INCE ENR)

Signature Jill Turner

Office Sub-mining Recorder

\$ 600.00

Kingman Assessment

Free Miners Cert & Plat
+ Cash ✓
Ming. Div.
Claim & Recd No. S.

Free Miners Cert & DATE
CASH 600
Mining Div.
Claim No. & Recd No.

KERR ADDISON MINES LIMITED
(FOR INTER-OFFICE USE ONLY)

Assessment
RECEIVED
JUL 2 1970

To..... W. M. Sirola
From..... E. C. Jacka
KERR ADDISON MINES LTD.
Per.....
Subject..... Kinskuch Option - Assessment Work
Date..... June 29, 1970

Please note that the following claims fall due for assessment work (or Payment in lieu of) on the dates shown.

- * July 2, 1970 - Kinskuch 1 - 3, 5, 7 & 8 (held in the name of Inge Fiva)
- ** July 25, 1970 - Sunshine 1 - 4 (held in the name of J. S. Falconer).

Yours very truly,

E. C. Jacka

E. C. Jacka

ECJ:lm

* ⁸ 600 CASH IN LIEU PAID JUNE 30/70

** File affidavits on time status nature & value of work & State that report is to follow.

cc - Claims.

Assessment

KERR ADDISON MINES LIMITED

(FOR INTER-OFFICE USE ONLY)

To..... W. M. Sirola From..... E. C. Jacka

Subject..... Kinskuch Option - Miner's Licences Date..... May 28, 1970

RECEIVED
MAY 29 1970

KERR ADDISON MINES LTD.

Please ensure that Inge Fiva and James S. Falconer ^{Per} renew their B.C. Miner's Licences for the year 1970-71, thereby keeping the proposed option claims in good standing.



E. C. Jacka

ECJ:lfr
Encls.

cc - *Legal*
cc - *Claims.*

Assessment

COPY

P. M. Kavanagh

Fred Chow

Kinskuch Copper Prospect - Option,
Staking of Additional Claims.

March 24, 1970.

The following description of additional staking should be included within the agreement:

The option agreement is contingent upon the success of Kerr Addison Mines to acquire by staking prior to June 1st, 1970 the open ground within the group of mineral claims plus adjacent ground deemed necessary to protect the claim group. From given information regarding previous staking, the following mineral claims are required:

Ted 1 M.C. adjoins Kinskuch 5 and 7 on the north, Jean M.C. (plus Ted Fraction to be staked) on the west, and open ground on the east and south boundary.

Ted Fraction M.C. fractional ground bounded by Kinskuch 3 and 5 M.C.'s on the north, Soul 2 M.C. on the west, Jean M.C. on the south, and Ted 1 M.C. on the east.

Ted 2 M.C. adjoins Soul Fraction and Sunshine 2 M.C.'s on the east, Ted 3 (to be staked) on the north, and open ground on the west and south.

Ted 3 M.C. adjoins Soul 1 M.C. on the east, Ted 2 (to be staked) on the south, Ted 4 M.C. on the N.E. corner, and open ground on the west and northwest.

Ted 4 M.C. adjoins Kinskuch 4 M.C. on the east, Soul 1 M.C. and Ted 3 (to be staked) on the south, Ted 5 M.C. (to be staked) on the north, and open ground on the west.

Ted 5 M.C. adjoins Kinskuch 2 M.C. on the east, Ted 4 (to be staked) on the south, Ted 6 (to be staked) on the north, and open ground on the west.

(continued - Page 2)

cc - Claims Data

COPY

- 2 -

Ted 6 M.C. adjoins Timberland M.C. on the east, Ted 5 (to be staked) on the south, and open ground on the north and west.



Fred Chow.

FC/lk

KERR ADDISON MINES LIMITED
405 - 1112 WEST PENDER STREET
VANCOUVER 1, B.C.

Assessment

COPY

March 18, 1970

Gold Commissioner,
Department of Mines & Petroleum Resources,
Victoria, B.C.

Dear Sir:

We would like copies of affidavits for the following claims:

<u>Claim Name</u>	<u>Record Number</u>
Kinskuch #1	34412 H
2	34413 H
3	34414 H
5	34415 H
7	34416 H
8	34417 H

These claims are situated in the Skeena M.D.

It would be greatly appreciated if we could have these by March 26th if possible. Thank you.

Yours truly,

John C. Lund,
P. Eng.

JCL/lk

c.c. Claims Data

Lin #1 Record No.

Kin #2 25276. Located 12th April 65. Recorded 26th April 65 - Expiry Apr. 26/68.

Kin #3 25278. Located 12th Apr, 65. Recorded 26th Expiry. Apr, 26/68.

Kin #5 25280. Located 12th Apr, 65, Recorded 26th Apr/65 Expiry - Apr, 26/68

Kin #7 25282. Located 12th Apr/65 Recorded. 26th Apr/65 Expiry Apr, 26/68

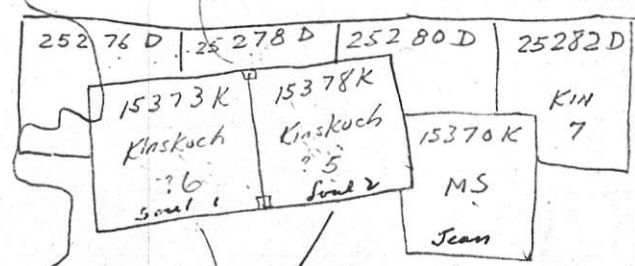

Recorded 2 Sept
Staked 25 Aug/68

$$\frac{2620}{1500} \times 1160$$

cc - Claims.

Assessment

FORM C
ORIGINAL



DEPARTMENT OF MINES AND PETROLEUM RESOURCES
MINERAL ACT

MINING DIVISION Skeena

No. 48887-891

CERTIFICATE OF WORK

Record No. See particulars on attached sheet Mineral Claim

THIS IS TO CERTIFY that an affidavit setting out a detailed statement of the work done on the ~~above claims in other~~ claims shown on the ~~map of~~ attached sheet, ~~is~~, made by James S. Falconer

has this day been filed in my office, and in pursuance of the provisions of the *Mineral Act* in that behalf I do now issue ~~this~~ certificate of work in respect of ~~the above claims of~~ these claims the recorded owner at this date.

Dated at Prince Rupert this 25th day of August, 19 69

Mining Receipt No. 32247E

Nº 55964 B

Mining Recorder.

AUDIT NO. 55964B MINING REC. NO. 32247E AMT. \$ 26.00

NUMBER OF YEARS
AND TYPE OF WORK
(EACH CLAIM)

TOTAL
YEARS

NAME OF GROUP SOUL GROUP NOTICE NUMBER 1152 DATE FILED Aug. 25/69
(IF ANY)

CERTIFICATE OF WORK NUMBER(S)	NAME OF CLAIM	RECORD NUMBER(S)	WORK DONE SINCE (LAST ANNIV. DATE)	PENALTY FEES	NUMBER OF YEARS AND TYPE OF WORK (EACH CLAIM)					TOTAL YEARS
					ORDINARY	ROAD OR TRAIL	LEGAL SURVEY	SURVEY		
<u>Aug. 25/69</u>										
48887	JEAN	33190	Sept. 2/68	-	1					1
48888	TIMBERLAND	33191	Sept. 2/68	-	1					1
48889	SOUL FRACTION	33192	Sept. 2/68	-	1					1
48890	SOUL #1	33193	Sept. 2/68	-	1					1
48891	SOUL #2	33194	Sept. 2/68	-	1					1
TOTAL PENALTY FEES _____					TOTAL CERTIFICATES <u>5</u>					

KINSKUCH COPPER PROSPECT

MINERAL CLAIMS IN STRONA MINING DIVISION, B.C.

14 FULL SIZE CLAIMS + 1 FRACTION

NAME	RECORD No	METAL TAG No.	LOCATED BY	DATE LOCATED	DATE RECORDED	c. of W.
JEAN	33 190	649 502	James S. Falconer	Aug 25/68	Sept 2/68	Due Sept 2/70 Grad to Sept 1/69 SOUL GROUP SOUL #1 SOUL #2 SOUL FR.
TIMBERLAND	33 191	649 501	J. M. Falconer	Aug 25/68	Sept 2/68	
SOUL #1	33 193	649 504	James S. Falconer	Aug 25/68	Sept 2/68	
SOUL #2	33 194	649 503	James S. "	Aug 25/68	Sept. 2/68	
SOUL FR.	33 192	649 505	James S. "	Aug 25/68	Sept 2/68	
KINSKUCH #1	34 412	649 515	Inge Fiva	June 23/69	July 2/69	Due July 2/70
KINSKUCH 2	34 413	649 516	Inge Fiva	June 23/69	July 2/69	✓
KINSKUCH 3	34 414	649 517	Inge Fiva	June 23/69	July 2/69	✓
KINSKUCH 5	34 415	649 519	Inge Fiva	June 23/69	July 2/69	✓
KINSKUCH 7	34 416	649 521	Inge Fiva	June 23/69	July 2/69	✓
KINSKUCH 8	34, 417	649 522	Inge Fiva	June 23/69	July 2/69	✓
SUNSHINE #1	34 456	649 523	James S. Falconer	July 24/69	July 25/69	Due July 25/70 P&R report. ✓
SUNSHINE 2	34 457	649 526	" " "	July 24/69	" - /" "	✓
SUNSHINE 3	34 458	649 525	" " "	" 24/69	" - /" "	✓
SUNSHINE 4	34 459	649 524	" " "	" 24/69	" - /" "	✓

Inge Fiva - F.M.C. # 26986 issued at Alice
 Claim, B.C. - May 28/70

TED FRACTION	35237	916106	A.T. LAROSE	APRIL 9/70	APRIL 13/70
TED #1	35238	916107	"	"	"
TED #2	35239	916105	"	APRIL 5/70	"
TED #3	35240	916104	"	"	"
TED #4	35241	916103	"	"	"
TED #5	35242	916102	"	"	"
TED #6	35243	916101	"	"	"

Diamond Drilling - Kinskuch h. Group.

DDH70-1

Location: Line 5SE + 350 NE
Bearing: S 35° W
Inclination: -45°
Length: 750'

Target - Test IP High. (Metal factor)

DDH70-2

Location: Line 20+50 SE
00 NE
Bearing: N 35° E
Inclination: -60°
Length: -750'

Target :- To test IP (M.F.) high
NE of Base line. and
penetrate low IP. Area.

425-6500 MR. BOYD. 682

425-6500

Time for survey at Linskuch Lake, July 20/70

Travelling	days
Building camp.	2,
Laying out grid + chaining lines.	1.
Mag survey.	4.
Digging holes in snow.	2.
I.P. survey	4.
Drafting	6 1/2
	<u>2 1/2</u>

Total days. — 22.0

I. P. survey completed with
3 electrode array $a = 200'$.

Two test lines with Wenner array,
 $a = 400'$
on line $4+00SE$, and long along lake
shore.

Instruments. Time domain, I.P. unit,

Magnetometer, # 176,

Lines chained.	5 miles.
Mag survey	5 miles.
I.P. survey, three electrode array, $a = 200'$	3.6 miles.
I.P. survey, Wenner array $a = 400'$	0.5 miles.
Total miles I.P. survey	<u>4.1 miles.</u>