

INTER OFFICE MEMO

812762

CYPRUS EXPLORATION CORPORATION LTD.
VANCOUVER OFFICE

Date: November 20, 1968

To: Mr. D. W. Tully

From: Mr. J. B. P. Sawyer

Subject: PHONE CALL TO N.B. VOLLO RE REPORTED DRILL HOLE
INTERSECTION OF ORE GRADE COPPER IN B.C. - VERBAL
COMMUNICATION FROM E.S. ALLEN, LOS ANGELES, NOV. 5/68

I was able to contact Nels Vollo by phone from Los Angeles on November 8, 1968 and enquired of him if he had any knowledge of where the 100 feet of drill core estimated to run 2% copper, reported to E.S. Allen by one of Scurry Rainbow's geologists, might have come from. Vollo had no previous knowledge of this intersection and suggested that it most likely comes from the Kimberley Copper property which, as you know, is along the N.E. contact of the Iron Mask.

Kimberley, in which Phillips Petroleum have 55% interest, have obtained some good values in copper by drilling and bulldozer work over a distance of some 4 or 5 claim lengths, however, the mineralization is not continuous, apparently, and distribution of values is erratic. Vollo suggests that this report, if correct, of 2% over 100 ft. of drill core length, would not be their best intersection.

Royal Canadian Ventures hold ground to the south of Kimberley, and Pinnacle Mines, controlled by Fidelity Investments, Toronto, have claims south of the R.C.V. claims.

This information was given verbally to Mr. J. G. Hansen in Los Angeles on November 8, 1968.

J.B.P. Sawyer

JBPS/jel

File Copy

CYPRUS EXPLORATION CORPORATION, LTD.
510 WEST HASTINGS STREET
VANCOUVER 2, BRITISH COLUMBIA
TELEPHONE: 683-9304

October 31, 1968

Mr. Nels B. Vollo,
Royal Canadian Ventures Ltd.
Ste. #270, 180 Seymour Street,
KAMLOOPS, B.C.

Dear Nels:

We are returning herewith your copy of the Sulmac I.P. report on your Royal Group, as requested. I have made a copy of this.

We have all the data from this group presently under review and will contact you in the near future with regard to possible participation by Cyprus in further work on this property.

Yours very truly,

CYPRUS EXPLORATION CORPORATION, LTD.

J. B. Paul Sawyer
Regional Manager - Western Canada

JBPS/jel

Enc.

c.c. Mr DWT.

INTER OFFICE MEMO

CYPRUS EXPLORATION CORPORATION LTD.

VANCOUVER OFFICE

Date: October 11, 1968

To: Mr. D. W. Tully

From: Mr. J. B. Paul Sawyer

Subject: ROYAL CANADIAN VENTURES LTD. - *Highland Valley Property*

A meeting was held at 8 p.m. on October 9th in Kamloops with Nels Vollo regarding the claims held by Royal Canadian Ventures Ltd. in the Highland Valley. This claim group has been held since the early 1960's by Royal Canadian Ventures Ltd. and is known as the Royal Group. In 1967 several claims formerly belonging to Lornex and which came open for staking were picked up by Vollo and added to the Royal Group.

Previous work on the original claims has consisted of geological mapping, I.P. and magnetometer work, and a limited amount of diamond drilling. No field work has been done on the former Lornex claims.

We have today received from Vollo, a set of reports describing the work to date on the property. A further report on this will be made after a study of the data has been completed.

Royal Canadian Ventures Ltd. are looking for a down payment of the order of \$20,000 to \$25,000 followed by cash and work commitments. A 70% interest would be available. A possible deal was not discussed in any detail.

Some time was also spent making a quick review of the area north of Kamloops Lake about which I understand you have had earlier discussions with Vollo. He advises that he has now almost completed the arrangements to acquire control of the area of interest, and will be contacting us further in the near future on this matter.

J.B. Sawyer

JBPS/jel

Copy to Mr. Tully

CYPRUS EXPLORATION CORPORATION, LTD.
510 WEST HASTINGS STREET
VANCOUVER 2, BRITISH COLUMBIA
TELEPHONE: 683-9304

September 24, 1968

Mr. N. B. Vollo,
Royal Canadian Ventures Ltd.,
Ste. #270, 180 Seymour Street,
KAMLOOPS, B.C.

Dear Nels:

We are returning herewith your reports on the Chuchi claim group by Morreau and Woodard (E.M. Survey-I.P. Survey) and yourself.

Don Tully and I have considered this prospect, and have concluded that it does not quite fill the bill as far as Cyprus is concerned. We will, therefore, be unable to undertake any work on it.

We wish to thank you for giving us the opportunity to consider this prospect. We will be glad to consider any other proposals you may have at any time.

Yours very truly,

CYPRUS EXPLORATION CORPORATION, LTD.

J. B. P. Sawyer
Regional Manager - Western Canada

JBPS/jel

Encls.

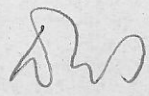

INTER OFFICE MEMO

CYPRUS EXPLORATION CORPORATION LTD.

VANCOUVER OFFICE

Date: September 12, 1968

To: Mr. D. W. Tully
From: Mr. J. B. Paul Sawyer
Subject: NELS VOLLO



Nels Vollo called this morning, I think wanting a decision on the Chuchi Lakes group. Since I have not had an opportunity to discuss this with you, I did not give him a definite answer. He will be in his office tomorrow, September 13th, and would like you to give him a call.

He mentioned also that he has things pretty well settled in connection with the property north of Kamloops Lake about which, I understand, you have had discussions with him earlier.

It may be of interest that Vollo reports that the results of recent drilling on the Arlington ground in the Highland Valley were negative.

JBPS/jel

*Mr. JBPSawyer
per: J. Lavigne*

File

INTER OFFICE MEMO

CYPRUS EXPLORATION CORPORATION LTD.

VANCOUVER OFFICE

Date: September 5, 1968

To: Mr. D. W. Tully
From: Mr. J. B. Paul Sawyer
Subject: ROYAL CANADIAN VENTURES - CHUCHI LAKE PROPERTY
93N/1 B.C.

I visited this property with Nels Vollo on August 28th, 1968.

Vollo bases his "confidence" in this property on the occurrence of zones of siliceous "tuffite" rock associated with sulphide mineralization and on a very weak I.P. anomaly detected on claim, Wag 29. He makes the comparison with the Mattagami camp and particularly with the Orchan property. This may be a valid comparison, however, the weight of evidence from the results of all the work done to date suggests other more likely explanations of the observed phenomena.

Morreau and Woodard carried out an EM survey and an I.P. survey over the claims. The results of the EM work were negative. The I.P. survey outlined one very weak anomaly as mentioned, and J.A. Woodard was very guarded in his comments on this anomaly. It could be due to disseminated magnetite or even to overburden. An EM-16 survey carried out over the property did indicate several conductors, none of which correspond with the weak I.P. anomaly. This may suggest that the I.P. effect is not due to overburden since the depth of penetration of the EM-16 equipment is very low.

Noranda Exploration Company held an option on the property in 1965 and drilled five holes in the only area of outcrop on the property. They intersected low grade lead-zinc mineralization. They estimated a possible 80,000 tons of 7.5% combined lead-zinc. From their drill logs it is apparent they also intersected short sections carrying silver values as high as 5 ozs. per ton, but generally the silver content is less than 1 oz. They confined their drilling to the one area, and apparently did no other work elsewhere on the property.

Any evaluation of this prospect can only be based on the results of the earlier work by Van Metals, by Noranda, and by Royal Canadian Ventures themselves. The field examination adds nothing to the picture. The mineralization visible in the one area of exposed outcrop is of sub-ore grade.

DW

Vollo points out that the metal factors for the area of the weak I.P. anomaly are of the same order as those obtained over the deep orebody at Orchan. It is entirely possible that the results on the Chuchi Lake property are due to ore at depth as they were at Orchan, and of course, the only way to find out is to drill it which is what Royal Canadian Ventures want to persuade us or some other company to do. Apparently they are not interested in spending their own money to drill this zone. I think a gravity survey would probably provide more useful information than many of the electrical surveys already done. Unfortunately, the attempt by Royal Canadian Ventures to carry out a gravity survey was abortive due to poor operators or some similar trouble.

On balance of all the available data, I must conclude that while this prospect cannot be completely eliminated as a site of an economic orebody, to go ahead and do further drilling would constitute "taking a flyer", and if we are so inclined, I could suggest better places for this kind of exercise.

I have not communicated any decision to Vollo, principally because of lack of time. Would you please advise whether you wish me to do this or whether you will be contacting him. I have returned Vollo's copy of the Noranda report to him since he was anxious to have it back. We have a copy in this office now. The three original reports which you left on my desk are attached.

J. B. Paul Sawyer

per: *J. Blavigne*

JBPS/jel

Attachments

Paul

This Does not appear to be our "piece of coke" from your communication. Please advise H&S accordingly

DWD
16 Sept/68

File - R.P. Ventures - Church

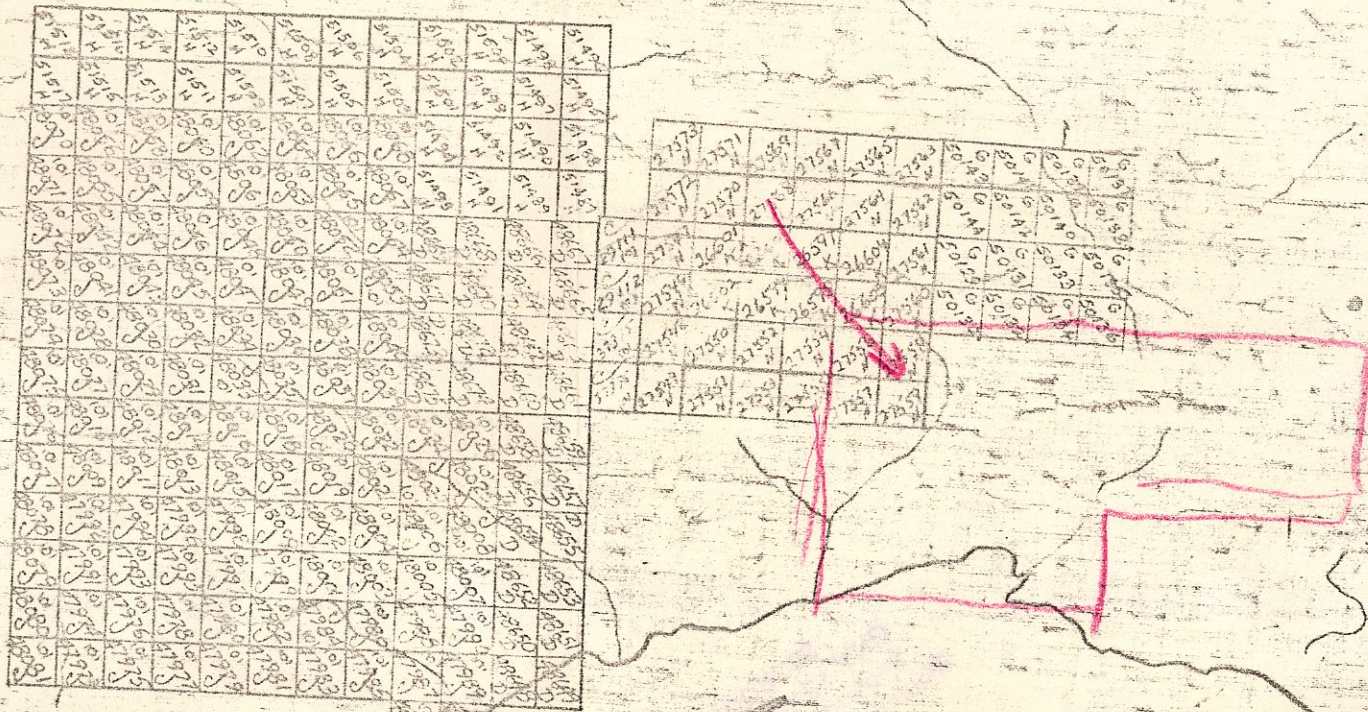

780690C

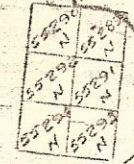
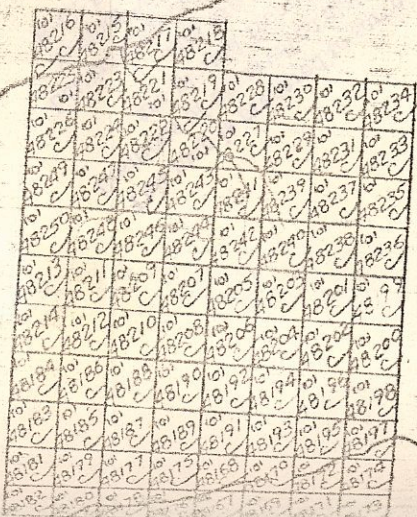

CHIT (NATION)

Tizgay Lo

This map is prepared to serve as a guide only.
Positions of unsurveyed claims and placer leases
are plotted from locators' sketches
and are not guaranteed.
Letters C.G. indicate claim is Crown-Granted.
Symbol "C" indicates claim has forfeited.
B. C. DEPARTMENT OF MINES AND
PETROLEUM RESOURCES