

CALTOR SYNDICATE  
 LOIS & DUKE CLAIMS  
 LETAIN LAKE AREA, B.C.

Mapping by G. Macdonald.

Scale 1" = 750'

- LEGEND
- Di Diorite
  - MD: Meta-Diorite
  - S Serpentine
  - P Peridotite
  - V Volcanic (?) Fine grained greenish rock
  - SV Serpentinized Volcanic
  - A Argillite
  - mm Fault
  - Contact
  - ls Limestone
  - x Soil Sample Location
  - ☼ Swampy Area

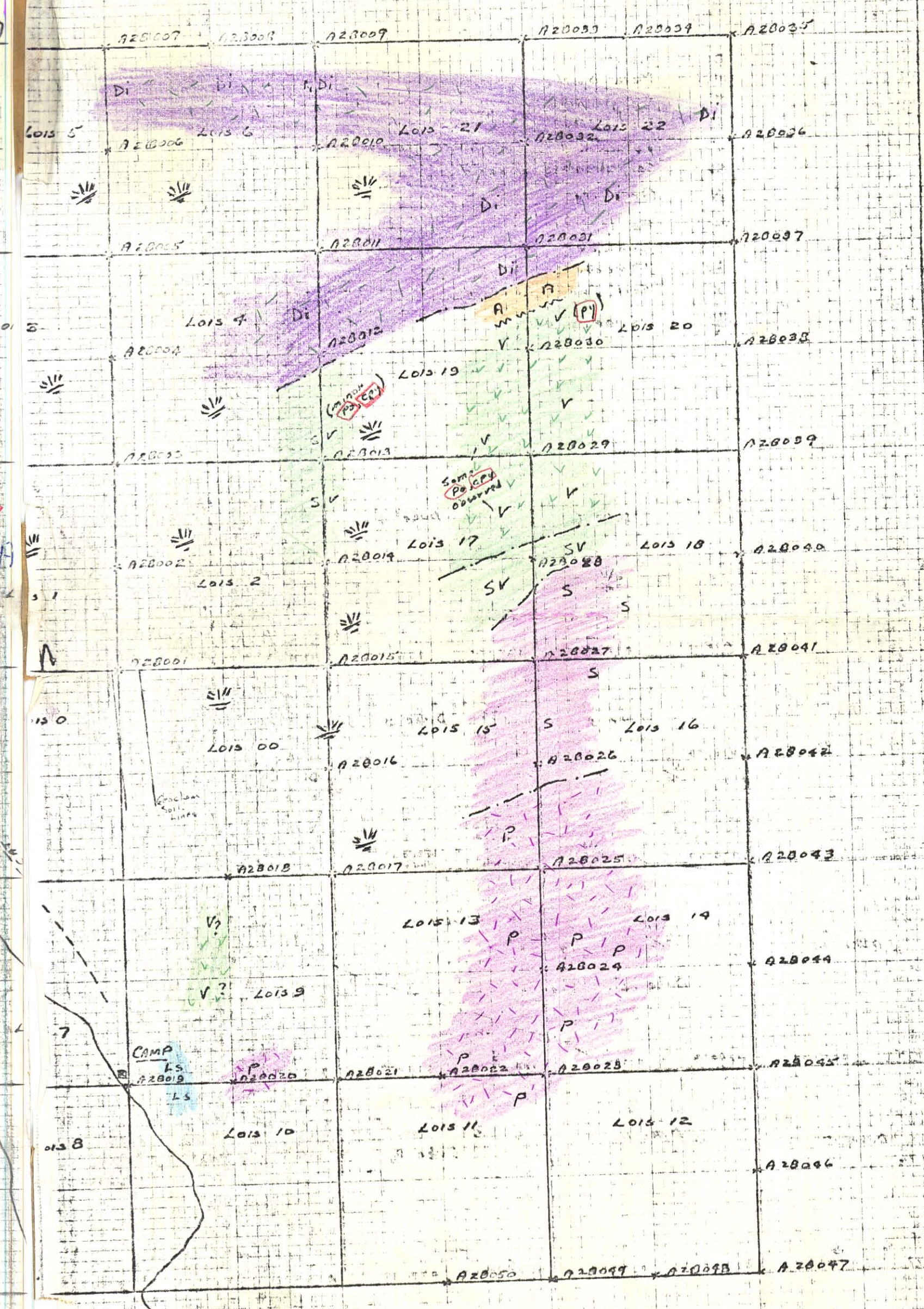
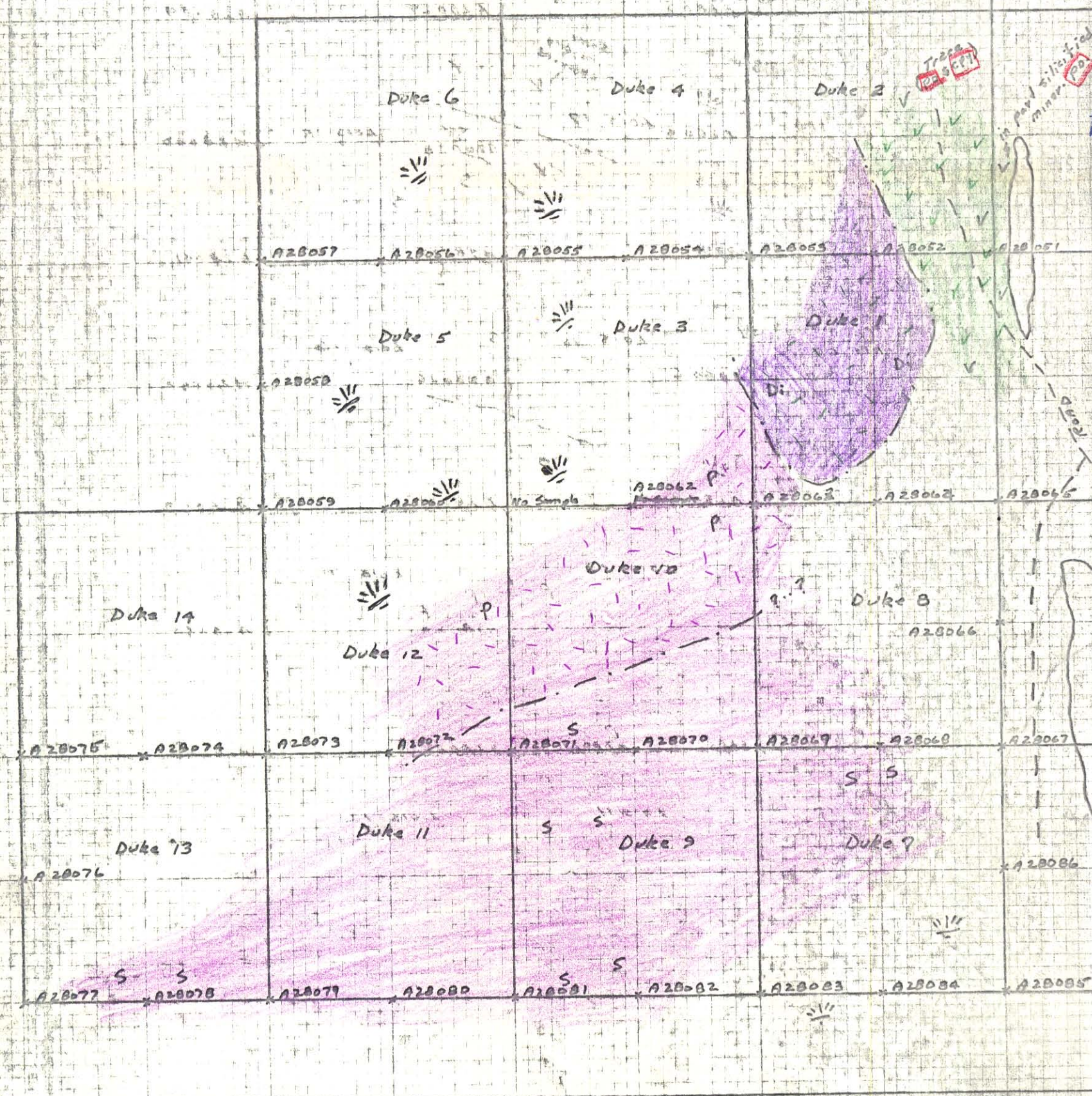

0 1 2  
 inches  
 0 1 2 3 4 5  
 centimetres

BRITISH COLUMBIA  
 GEOLOGICAL SURVEY

This reference scale bar has been added to the original image. It will scale at the same rate as the image, therefore it can be used as a reference for the original size.

1041-7  
 Prop. Sub.  
 King mtn  
 812271