

812228

SAN JACINTO EXPLORATIONS LTD. (N.P.L.)

TIO BURACHO GROUP

GREENWOOD MINING DIVISION

BRITISH COLUMBIA

REPORT ON

FRACTURE DENSITY AND GEOPHYSICAL CORRELATION

BY

D.A. CHAPMAN & ASSOCIATES LIMITED

#2 - 515 Granville Street

Vancouver 2, B.C.

Telephone 685-3281

SEPTEMBER, 1967.

T A B L E O F C O N T E N T S

	<u>Page</u>
LOCALE	1
GENERAL GEOLOGY	1
SUMMARY OF FRACTURE DENSITY ANALYSIS	1 & 2
RECOMMENDATIONS	2



LOCALE

The Tio Buracho claim group is in the Greenwood Mining Division, British Columbia, approximately 3 miles east of Greenwood, B.C.

GENERAL GEOLOGY

The Paleozoic sedimentary and volcanic rocks have been metamorphosed and are partly to completely silicified to form jasperoid and cherts. The limestones are in part replaced by the lime-silicate minerals, notably epidote and garnet, and in places these lime-silicate rocks contain sufficient sulphides to constitute low grade ore.

Three types of mineral occurrences are general for the region:

- (a) chalcopyrite, pyrite and magnetite occurring with the lime-silicate minerals;
- (b) pyrrhotite, arsenopyrite and pyrite occurring near the margins of intrusive bodies;
- (c) quartz veins, bearing galena, sphalerite, chalcopyrite and pyrite and assaying gold and silver, occurring in and around intrusive bodies.

SUMMARY OF FRACTURE DENSITY ANALYSIS

1. Two anomalous zones are indicated by the results of the air photo study.
2. The larger anomaly lies in the Marshall Claim. The contact probability isogram indicates there are two possible stress domes in the underlying metamorphics, which may be caused by a plunging fold axis or an intrusive plug that has not penetrated its cupola.

SUMMARY OF FRACTURE DENSITY ANALYSIS (Cont'd)

3. The main tectonic control would appear to be a broad-sheared zone 1,500 feet in width that strikes approximately N 60° E across the claim group, which is intersected by a large regional E-W fault that controls Providence Creek. From past regional studies of this area, these E-W tectonic features appear as a control to most of the mineral occurrences. This particular fault passes from the Phoenix camp to the east through Providence Mine, Marguerite Mine and on up Deadwood Creek to Copper Camp. Conjugate to this system are N-S faults and it would appear that old mineral occurrences tend to be situated at or near these intersections.

RECOMMENDATIONS

1. A 200-foot drilling grid on anomaly #1.

Respectfully submitted,



D.A. Chapman.

DAC/jm

September 26, 1967.

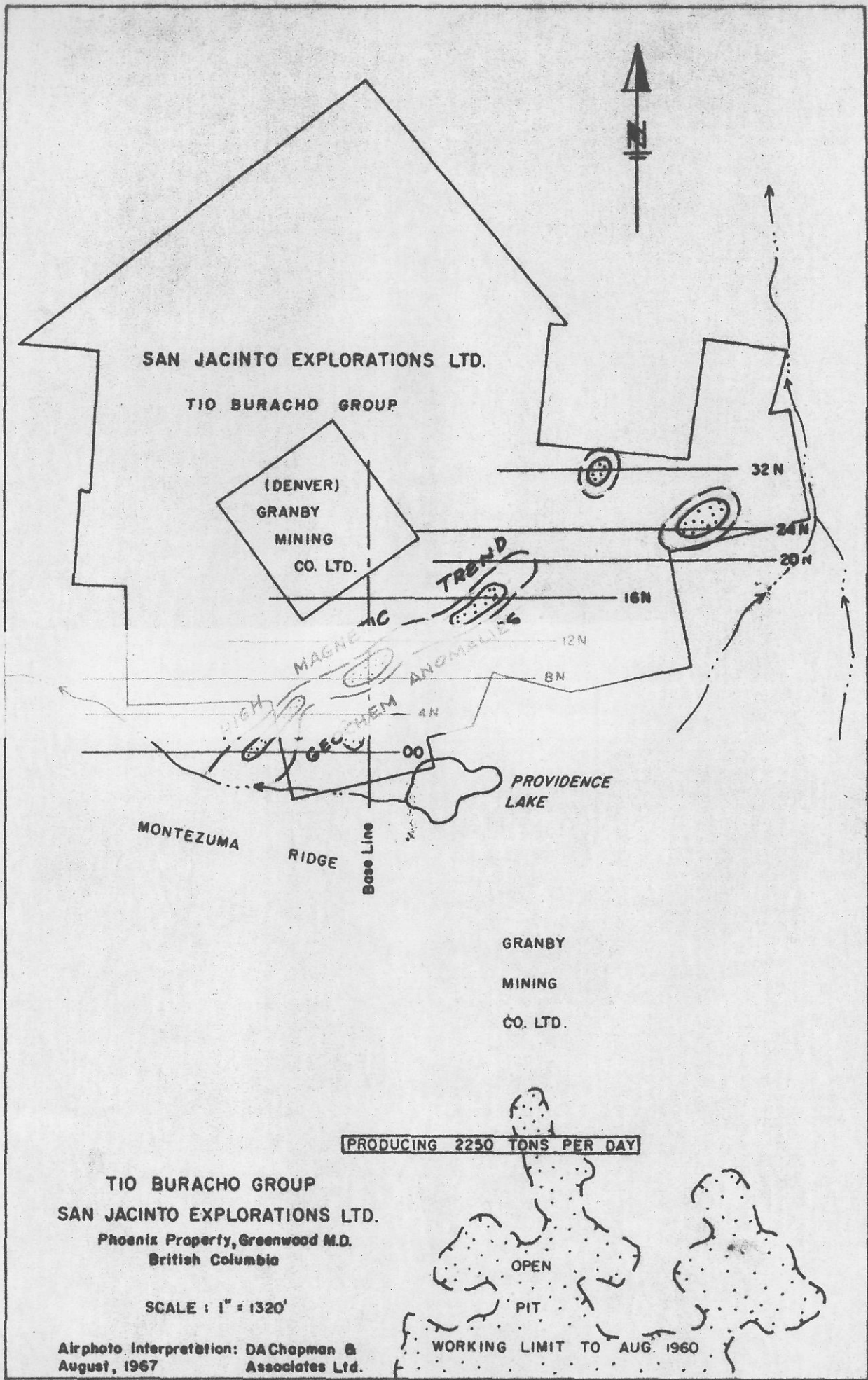

SAN JACINTO EXPLORATIONS LTD.

TIO BURACHO GROUP

(DENVER)
GRANBY
MINING
CO. LTD.

TREND

MAGNETIC ANOMALIES

32N
24N
20N
16N
12N
8N
4N
00

PROVIDENCE LAKE

MONTEZUMA RIDGE
Base Line

GRANBY
MINING
CO. LTD.

PRODUCING 2250 TONS PER DAY

TIO BURACHO GROUP
SAN JACINTO EXPLORATIONS LTD.
Phoenix Property, Greenwood M.D.
British Columbia

SCALE : 1" = 1320'

Airphoto Interpretation: DA Chapman & Associates Ltd.
August, 1967

OPEN
PIT

WORKING LIMIT TO AUG. 1960

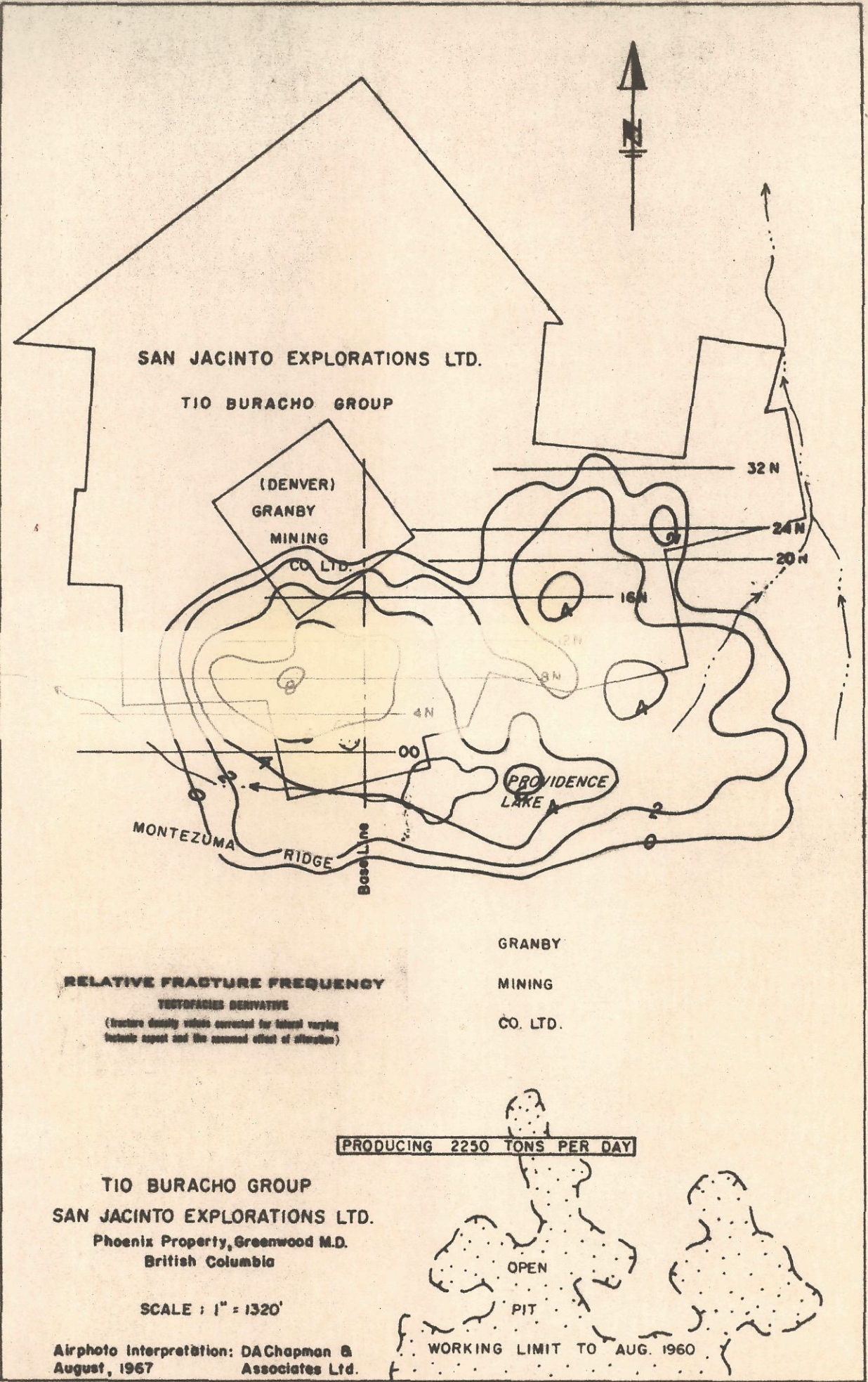

SAN JACINTO EXPLORATIONS LTD.

TIO BURACHO GROUP

(DENVER)
GRANBY
MINING
CO. LTD.

32 N

24 N

20 N

16 N

12 N

8 N

4 N

00

PROVIDENCE
LAKE

MONTEZUMA
RIDGE

Baseline

GRANBY

MINING

CO. LTD.

RELATIVE FRACTURE FREQUENCY

TECTONICS DERIVATIVE

(fracture density values corrected for lateral varying tectonic aspect and the assumed effect of alteration)

PRODUCING 2250 TONS PER DAY

TIO BURACHO GROUP

SAN JACINTO EXPLORATIONS LTD.

Phoenix Property, Greenwood M.D.
British Columbia

SCALE : 1" = 1320'

Airphoto Interpretation: DA Chapman &
August, 1967 Associates Ltd.

OPEN

PIT

WORKING LIMIT TO AUG. 1960

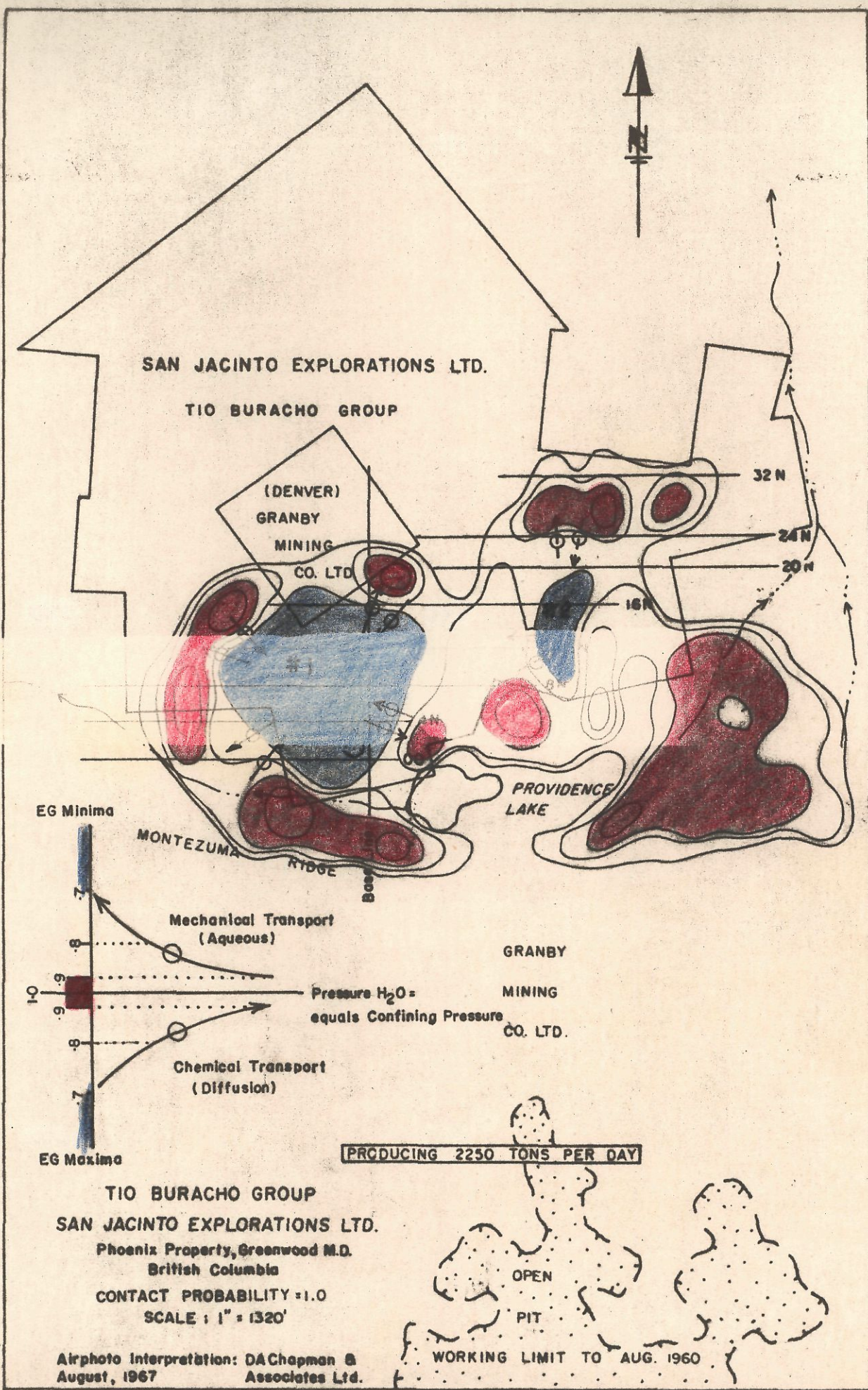

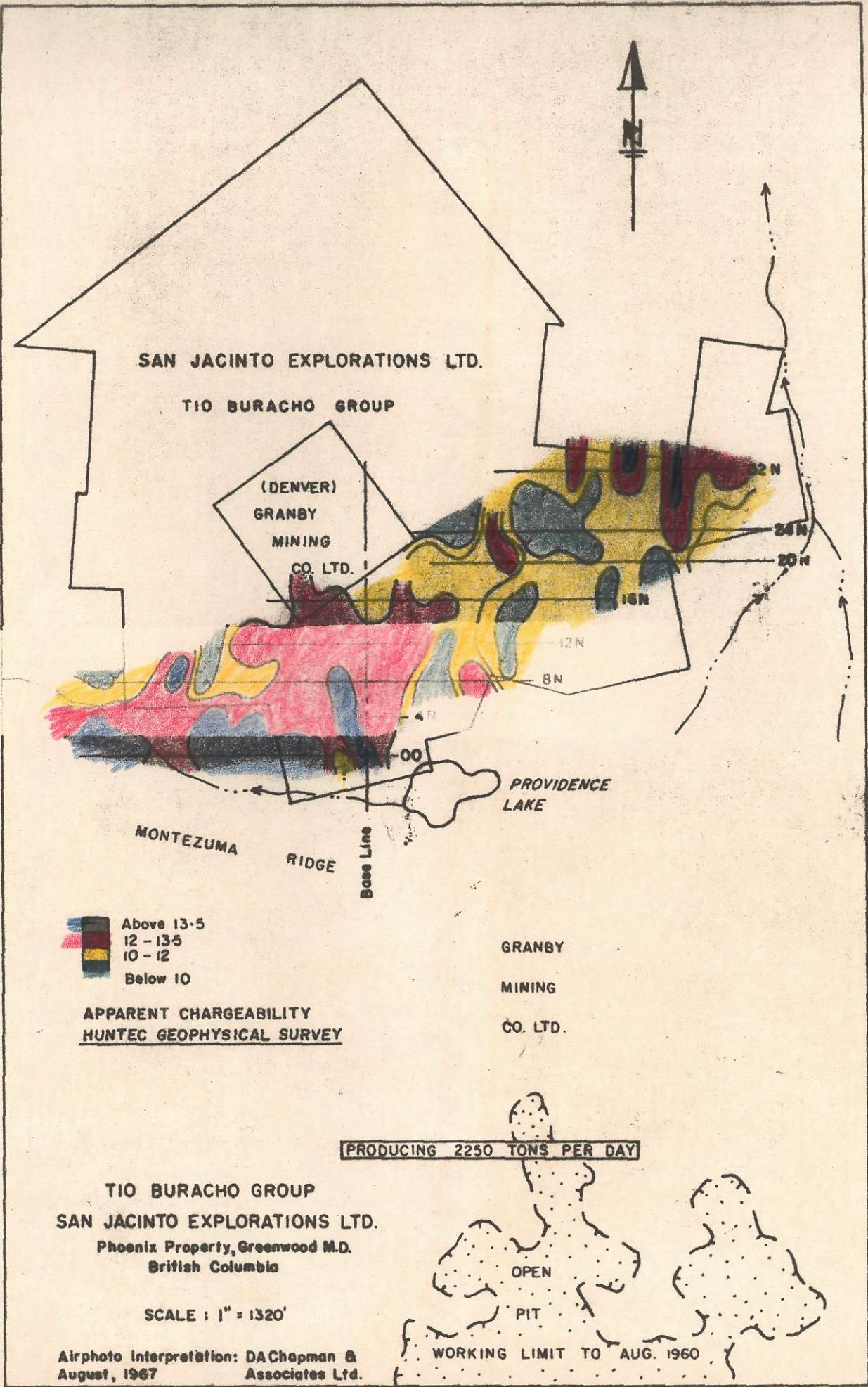

SAN JACINTO EXPLORATIONS LTD.

TIO BURACHO GROUP

(DENVER)
GRANBY
MINING
CO. LTD.

PROVIDENCE
LAKE

MONTEZUMA
RIDGE

Base Line

Above 13.5
12 - 13.5
10 - 12
Below 10

GRANBY
MINING
CO. LTD.

APPARENT CHARGEABILITY
HUNTEC GEOPHYSICAL SURVEY

PRODUCING 2250 TONS PER DAY

TIO BURACHO GROUP
SAN JACINTO EXPLORATIONS LTD.
Phoenix Property, Greenwood M.D.
British Columbia

OPEN
PIT

SCALE: 1" = 1320'

WORKING LIMIT TO AUG. 1960

Airphoto Interpretation: DA Chapman &
August, 1967 Associates Ltd.

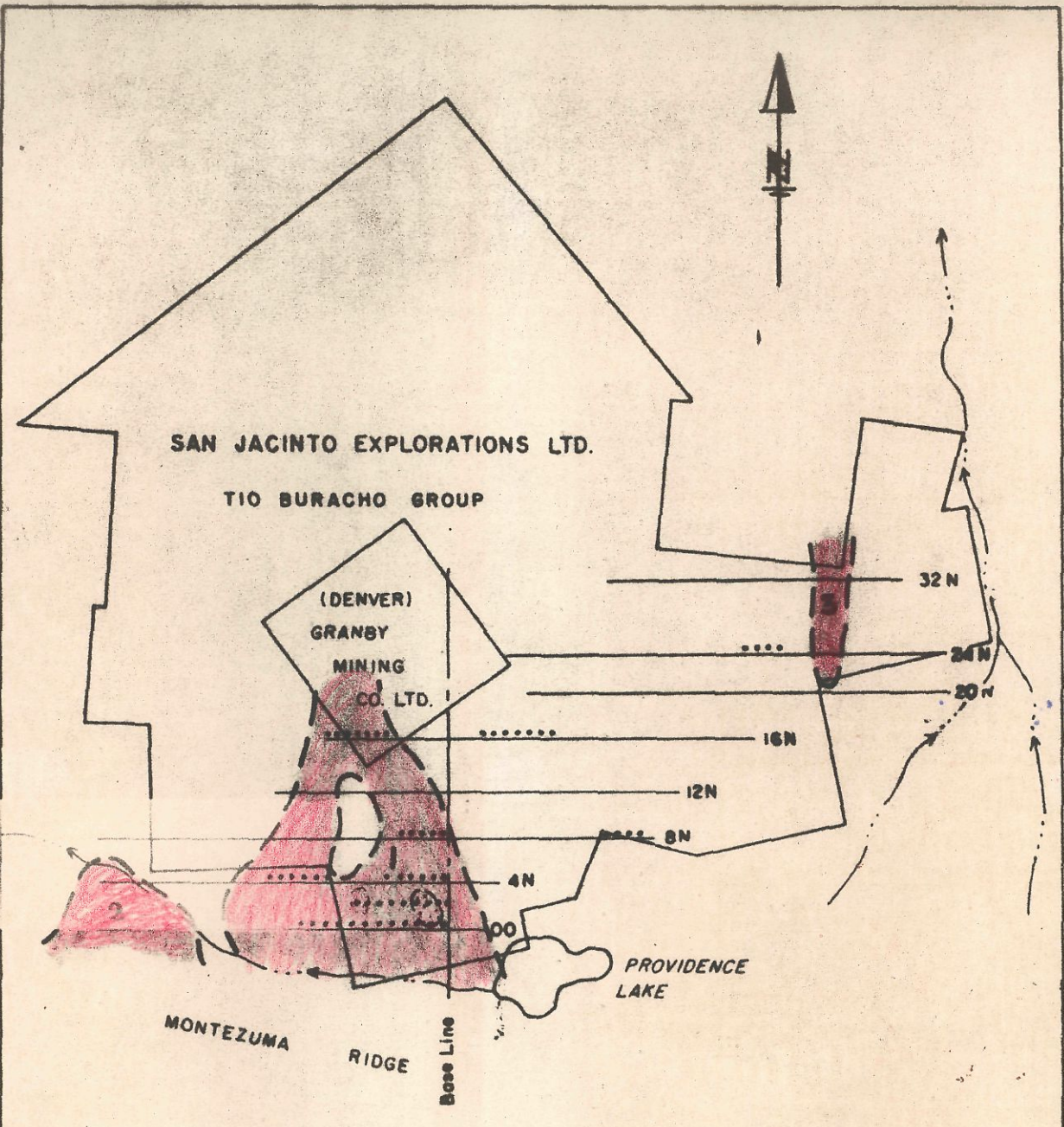

HUNTEC
GEOPHYSICAL SURVEY



ANOMALOUS I.P. ZONE

..... RECOMMENDED TRENCH

GRANBY
MINING
CO. LTD.

PRODUCING 2250 TONS PER DAY

TIO BURACHO GROUP
SAN JACINTO EXPLORATIONS LTD.
Phoenix Property, Greenwood M.D.
British Columbia

SCALE : 1" = 1320'

Airphoto Interpretation: DA Chapman &
August, 1967 Associates Ltd.

