

82-E
Prop. Submission
Deadwood Creek

812120

GEOLOGICAL REPORT

ON THE

DEADWOOD CREEK PROPERTY
GREENWOOD MINING DIVISION

BRITISH COLUMBIA

for

FURY EXPLORATIONS LTD (N.P.L.)

July 11, 1972

Thomas R. Tough, P.Eng.,
Consulting Geologist

TABLE OF CONTENTS

	Page
LOCATION AND ACCESS.....	1
PROPERTY.....	1
OWNERSHIP.....	2
LOGISTICS.....	2
GEOLOGY.....	2
MINERALIZATION.....	2
HISTORY.....	3
PRESENT WORK.....	3
EXPLORATION PROGRAMMES.....	3
ESTIMATE OF COSTS OF EXPLORATION PROGRAMMES	4
CERTIFICATE.....	5

MAP INDEX

	Scale
LOCATION MAP	1" = 134 miles
PROPERTY OUTLINE	1" = 3000 feet
GEOCHEMICAL SOIL SAMPLING	1" = 200 feet

Consulting Geologists
519 - 602 WEST HASTINGS STREET
VANCOUVER 2, B. C.

00/2

The Board of Directors
Fury Explorations Ltd (NPL)
433-355 Burrard Street,
Vancouver 1, B.C.

July 11, 1972

Dear Sirs:

RE: DEADWOOD CREEK PROPERTY
GREENWOOD MINING DIVISION, BRITISH COLUMBIA

The following is a brief report based on a personal examination of your Deadwood Creek claims on July 5, 1972.

LOCATION AND ACCESS (49° 118° SE)

The claims are located approximately two miles south west of Greenwood, B.C. in the Greenwood Mining Division south central British Columbia. Access is via gravelled mine access and logging roads from Greenwood.

PROPERTY

The Deadwood Creek property consists of 21 contiguous located and crown-granted mineral claims. They are as follows:

<u>Claim Name</u>	<u>Record No.</u>	<u>Expiry Date</u>
Ven # 1 - 4 incl.	35575-78 incl.	November 19, 1972
Vendela # 5-6 incl.	31687-88 incl.	March 20, 1973
Anton # 3-4 incl.	34578-79 incl.	December 9, 1972
Anton # 5-6 incl.	31685-86 incl.	March 20, 1973
Sef # 1	31939	April 13, 1973
Serf # 2 Fr.	31940	April 13, 1973
Vicki	25133	April 12, 1973
Zoe # 1-4 incl.	35684-87 incl.	March 8, 1973
Arn # 1-2 incl.	35738-39 incl.	April 10, 1973

<u>Claim Name</u>	<u>Record No.</u>	<u>Expiry Date</u>
Arn # 3 Fr.	35740	April 10 1973
Tonay Fr.	Lot 1907	
Great Hesper	Lot 3259	
Eureka	Lot 1887	

OWNERSHIP

The claims are held by Fury Explorations Ltd (N.P.L.) by option to purchase agreement.

LOGISTICS

The logistics regarding all phases of exploration are good.

GEOLOGY

The eastern portion of the property is underlain by sediments of the Anarchist Group which are intruded by diorite of Cretaceous Nelson Intrusions. The most eastern extremities cover serpentinite.

The western claim area is underlain by conglomerates and chert. Underlying the chert is interbedded siltstone and greywacke. The general strike of the sediments is 350° with steep dips to the west and east.

The northeastern and eastern areas are underlain by diorite. Along the south side of Haas Creek granitized sediments or paragneiss occur.

MINERALIZATION

There are numerous pits and trenches on the property most revealing chalcopryrite, pyrite and pyrrhotite. The chalcopryrite and pyrite occur as disseminations or fracture fillings in diorite whereas the pyrrhotite

occurs in a generally massive form in the eastern portion of the property where diorite intrudes metasediments. Chalcopyrite was also noted in small pits along Haas Creek occurring as fracturing fillings in brecciated paragneiss.

HISTORY

Some 22 million tons of copper ore was mined from the Deadwood Creek and Pheonix Mining Camps during the early part of the present century. Only the Pheonix Mine is still operating. Current activity has been centered around some of the past producers but production has been limited.

During 1962 Skomac Mines Ltd (NPL) optioned a portion of the property but there are no available records of any work having been performed.

During the summer of 1967 Utah Construction and Mining Co. ran 5.8 miles of induced polarization survey and diamond drilled two holes on the western portion of the property apparently encountering mainly chert.

PRESENT WORK

During April and June 1972 a small number of soil samples were collected by J. R. Glass, Geologist and submitted for copper and molybdenum determination.

The results are shown on an enclosed map. Results for copper in soils varied between 55 ppm and 9,875 ppm whereas the molybdenum values ranged between 0.5 ppm and 75 ppm.

EXPLORATION PROGRAMMES

Because of the preliminary geochemical results the entire property should be soil sampled in conjunction with geological mapping and a magnetometer survey. After completion of the above programmes a limited drilling

programme should be carried out on areas of significance.

ESTIMATE OF COSTS OF EXPLORATION PROGRAMMES

Establish a grid, 20 miles @ \$150/mile	\$3,000.00
Geological Mapping	2,000.00
Geochemical Survey 1000 samples @ \$5/sample assay for Cu and Mo	5,000.00
Drilling, 3000 feet-rotary drilling at \$4/foot	12,000.00
Engineering and Supervision	3,000.00
Contingencies	3,000.00
	<hr/>
	\$28,000.00
	<hr/> <hr/>

It is estimated that the above programmes should take approximately three months to complete.

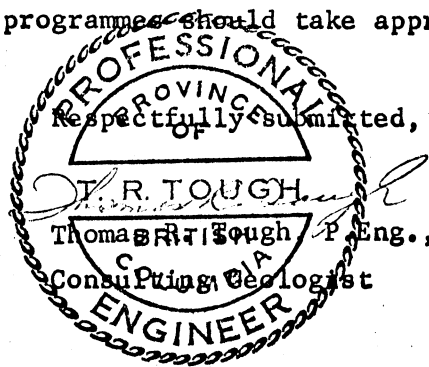

July 11, 1972
Vancouver, B.C.

CERTIFICATE

I, Thomas R. Tough, of the City of Vancouver, in the Province of British Columbia, do hereby certify:

That I am a Consulting Geologist and an associate of T.R. Tough & Associates Ltd., with offices at 519-602 West Hastings Street, Vancouver, B.C.

I further certify:

1. That I am a graduate of the University of British Columbia (1965) and hold a B.Sc. degree in Geology.
2. I have been practising in my profession for the past six years and have been active in the mining industry for the past thirteen years.
3. I am registered with the Association of Professional Engineers of British Columbia.
4. This report is based on information obtained by the writer during a personal examination of the property on July 5, 1972, from a study of available data from government and other publications.
5. I have no direct or indirect interest whatsoever in the property described herein, nor in the securities of Fury Explorations Ltd (NPL) and do not expect to receive any interest therein.

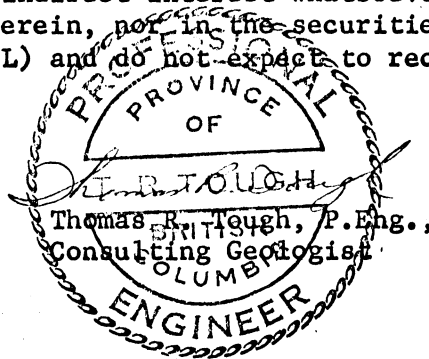

July 11, 1972

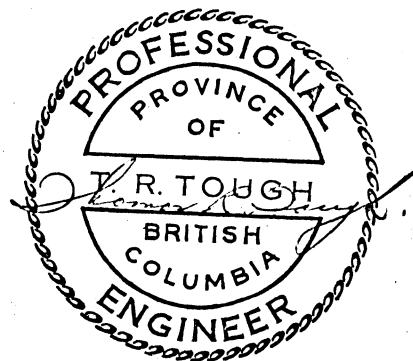
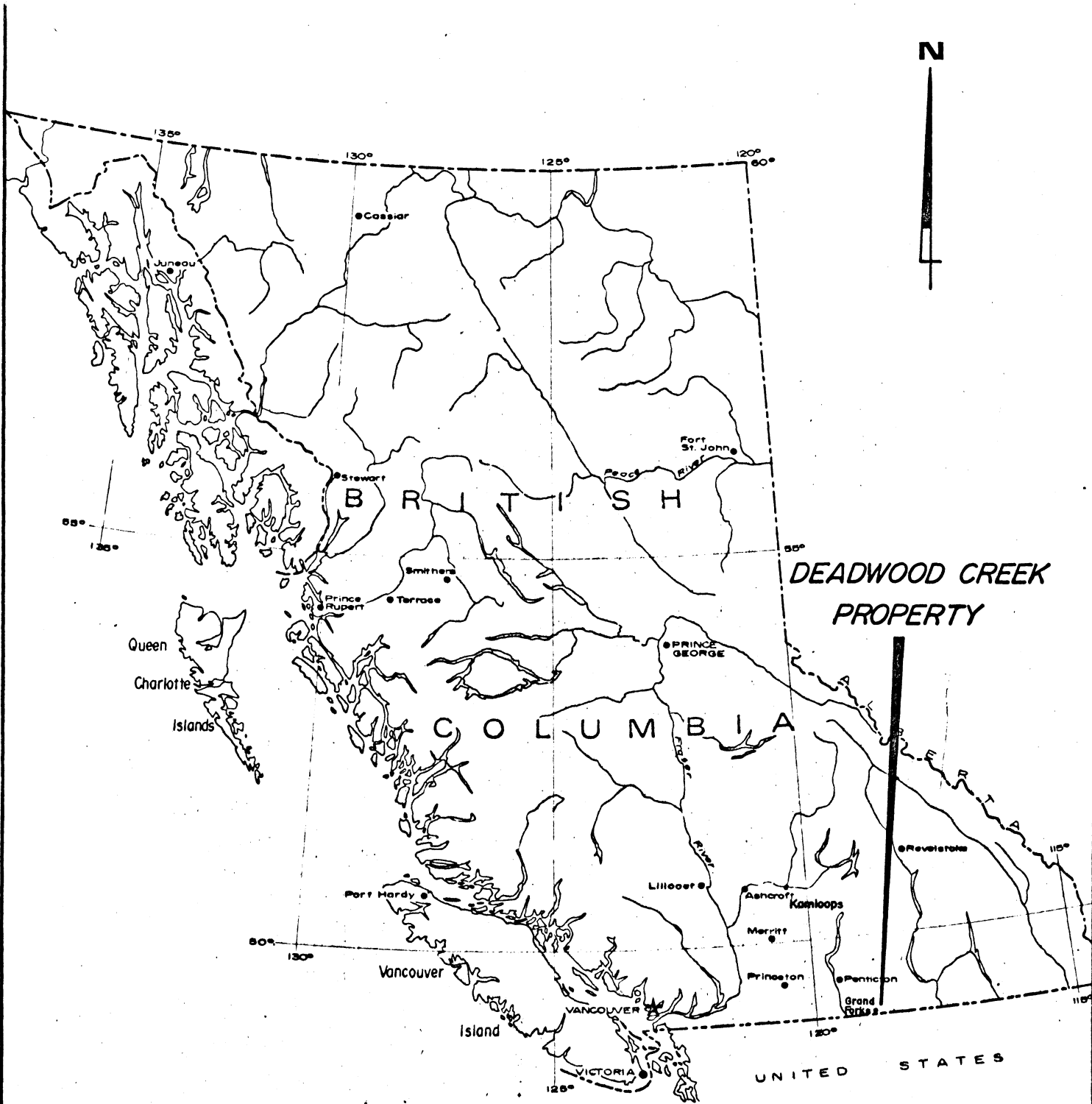

T.R. TOUGH & ASSOCIATES LTD.

FURY EXPLORATIONS LTD.
DEADWOOD CREEK PROPERTY
 GREENWOOD M.D.
 GRAND FORKS, B.C.
LOCATION MAP

SCALE 1" = 134 mi

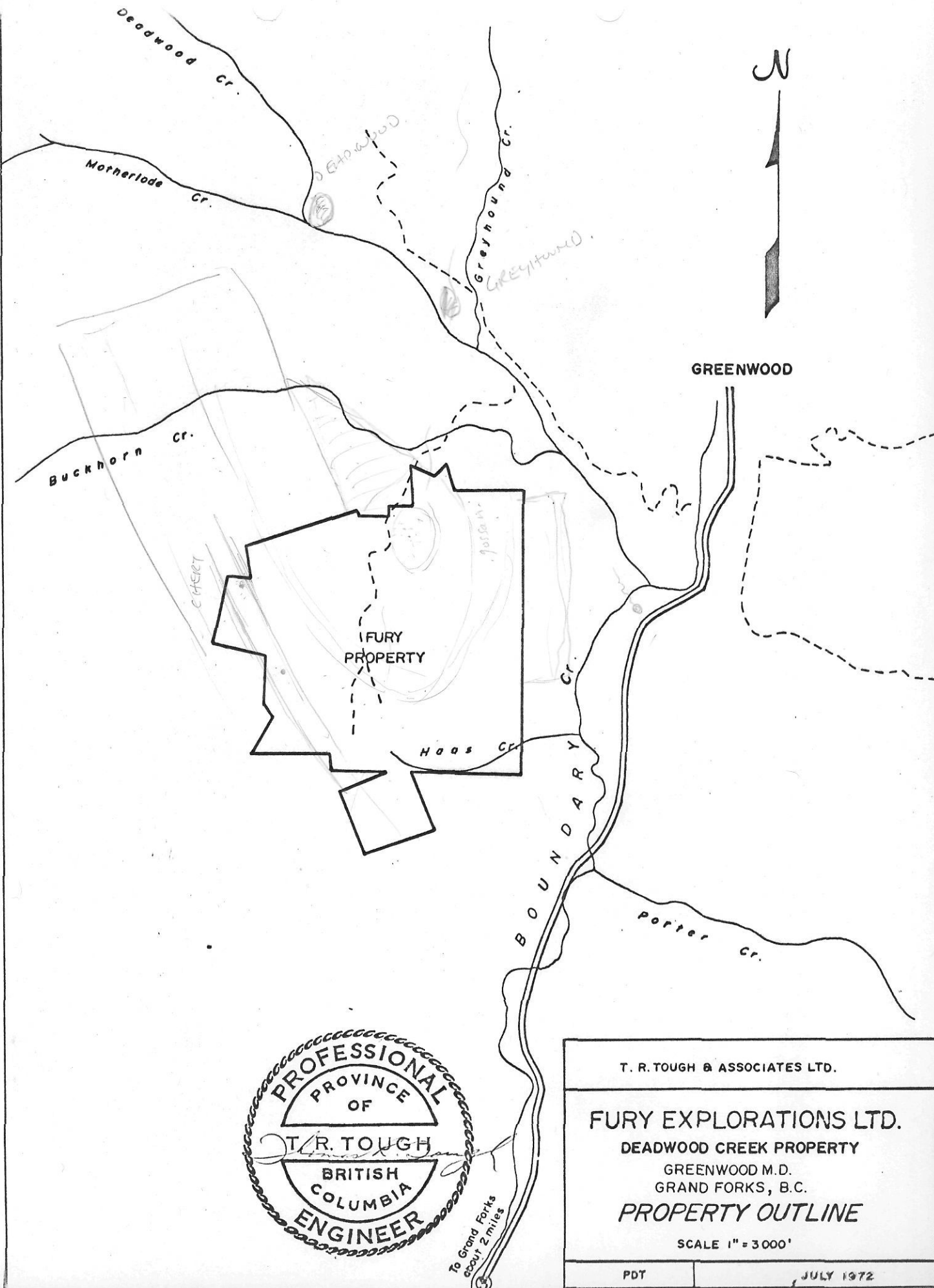

To Grand Forks
about 2 miles

T. R. TOUGH & ASSOCIATES LTD.	
FURY EXPLORATIONS LTD. DEADWOOD CREEK PROPERTY GREENWOOD M.D. GRAND FORKS, B.C. PROPERTY OUTLINE	
SCALE 1" = 3000'	
PDT	JULY 1972