

Inter-Office Letter

COMPANY		DATE	July 6th, 1971
FROM:	R. W. Nusbaum	TO:	A. E. Aho J. S. Brock
SUBJECT:	<u>Jay Group - Property Submittal</u>	ATTN. OF:	

alc to Aho
92H

SUMMARY

The Jay Group, a new prospect located 25 miles north of Princeton, B.C., is underlain by Nicola volcanics showing weak prophyllitic alteration, weak fracturing and no copper mineralization.

CONCLUSIONS

The fresh appearing, weakly fractured volcanics appear to contain little or no potential for copper mineralization near surface or at depth.

RECOMMENDATIONS

No further work recommended.

INTRODUCTION

The Jay Group of claims was submitted to Dynasty for examination by the owner, J. D. Butterworth. Half a day was spent on the claim group examining outcrops. Weather was fair and warm.

LOCATION

The claim group is located 25 miles north of Princeton, B.C., 2 miles east of highway No. 5 on the summit between Otter Creek and Missezula Lake. Lat. 49°46'N, Long. 120°31'W. N.T.S. 92-H-East Half.

ACCESS

Access is by paved highway No. 5, 25 miles north of Princeton, B.C. then east about 2 miles on old logging and ranch roads suitable for 4-wheel-drive vehicles. B. C. Hydro is in the process of clearing right-of-way and erecting power lines through the centre of the claim group.

Inter-Office Letter

COMPANY		DATE
		July 6th, 1971
FROM:	TO:	
SUBJECT:		
	ATTN. OF:	

- 2 -

PROPERTY AND OWNERSHIP

The claim group consists of 85 claims owned by J. D. Butterworth, 4727 Wesley Drive, Delta, B.C. Assessment is due on all of the claims between February and April, 1972.

TOPOGRAPHY

General and local relief of 500 feet with elevations of 3,500 to 4,000 feet. The terrain is gentle to moderate rolling hills covered with soil and glacial debris. Vegetation consists of coarse grass and patch brush and timber, mainly Ponderosa pine.

HISTORY OF OCCURRENCE

A new prospect with no exploration done to date. A report on the prospect written in May, 1971, by D. C. Malcom, recommends more exploration.

GENERAL GEOLOGY

The claims are underlain by volcanic rocks of the Triassic Nicola Group consisting of varicoloured, mainly purple and green, lava, fine grained and occasionally porphyritic. North-south trending shear zones of weakly parallel-fractured rocks and flow breccia are occasionally seen.

MINERALIZATION

No copper mineralization was seen in any of the numerous outcrops. A trace of malachite was seen on a fracture of a piece of volcanic float. The rock is generally very fresh appearing with only occasional fracture coatings of epidote. No sulfide minerals or indications of sulfide minerals at depth were seen.

Inter-Office Letter

COMPANY		DATE
		July 6th, 1971
FROM:	TO:	
SUBJECT:		
	ATTN. OF:	

- 3 -

The general area is geologically favourable for prospecting with active properties on three sides of the Jay Group; Tormont to the north, Adonis Mines and Pageant Mines to the west, and AMAX to the south and southwest, however, the Jay Group itself appears to contain little or no potential.

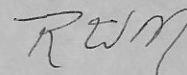

R. W. Nusbaum

RWN/mp

JAY GROUP

SIMILKAMEEN AND NICOLA MINING DIVISIONS

SUMMARY

The Jay Group of ⁸⁵76 claims is unexplored and well located between Princeton and Merritt near the No. 5 Highway. The claims are along the east contact of the Pike Mountain batholyth in Nicola siliceous tuffs and agglomerates which contain indications of copper mineralization.

Geological mapping, prospecting, ground magnetometer surveys and geochemical surveys, methods successful in locating deposits in the area, are recommended.

CLAIMS

Seventy-six located claims, ten in the Similkameen Mining Division and sixty-six in the Nicola Mining Division of British Columbia.

<u>Claim</u>	<u>Assessment Due</u>
Jay 5-14	February 6, 1972
Jay 17-26	February 7, 1972
Jay 80-88	February 6, 1972
Jay 90-98	February 7, 1972
Feb 69-78	February 20, 1972
Lil 1-12	March 20, 1972
PL 1-10	March 21, 1972
PL 11-14	March 22, 1972
PL 15-18	April 25, 1972
Nick 87-90	April 24, 1972
BLUE 51-62	May 20, 1972

OWNERSHIP

Owned by J. D. Butterworth, 202--1836 West 5th Avenue, Vancouver, B. C. 4727 WESLEY DRIVE
PHONE 943-3744 DELTA, B. C.

LOCATION

Latitude: 49° 48' North
Longitude: 120° 33' West
Elevation: 4,000 feet

The claims are 25 miles north of Princeton, 2 miles east of the Princeton to Merritt Highway No. 5 on the Summit between Otter Creek and Missezula Lake. They are reached by Highway No. 5 and logging roads. A gas pipe line and power line crosses the property.

TOPOGRAPHY

The claims cover the height of land between the Similkameen and the Nicola area. It is lightly timber covered and partly logged.

GENERAL GEOLOGY

The Princeton to Merritt area is underlain by Triassic Nicola Group sediments, volcanic fragmentals and flows deposited in an explosive volcanic-marine sediment environment. The area is east of the Coast Ranges and it is intruded by major batholyths, stocks, plugs and dikes. The Okanogan or Pennask batholyth lies to the east of Summers Creek and Missezula Lake and the Pike Mountain batholyth lies to the west. The Copper Mountain stock lies towards the southern part of the district. The rocks are extensively faulted by a series of major north and northwest trending faults, and by numerous intersecting smaller faults. Breccia, fracture and crushed zones are widespread.

Near Princeton, the Ingerbelle and Copper Mountain deposits are estimated to contain 76 million tons averaging 0.53% copper found in intensely faulted and fractured Nicola rocks adjacent to the Mesozoic intrusives.

wide spaced!

On Summers Creek the ore deposits are extensive surface copper-pyrite deposits which in preliminary drilling, appear commercial. They occur in Nicola rocks, near the contact of a granodiorite intrusive, in crushed and faulted zones.

CLAIM GEOLOGY

The Jay claims are underlain by Nicola volcanics and are staked along the east contact of the Pike Mountain batholyth. The claims are unmapped and unprospected but they are in part underlain by siliceous volcanics and ^{very little & only float} some disseminated Chalcopyrite and Pyrite has been found on them while staking.

The major Otter Creek Fault lies to the west and the Summers Creek Fault lies to the east and brecciation is extensive. ^{Flow breccia}

CONCLUSIONS

The Jay claims are an unexplored, well located group in Nicola volcanics along the east contact of the Pike Mountain batholyth. They contain some Chalcopyrite-Pyrite mineralization.

RECOMMENDATIONS

The claims should be prospected, geologically mapped and soil sampled. A ground magnetometer survey is recommended.

If this work is successful it would outline near surface Pyrite-Chalcopyrite mineralization over appreciable areas showing magnetic high anomalies and copper and zinc geochemical anomalies in the same areas.

ESTIMATED COSTS

Magnetometer Survey	15 line miles @ \$150/line mile	\$ 2,250
Geochemical Survey		2,500
Transportation		500
Prospecting		1,000
Geology		1,000
Supervision		1,000
Consulting		500
Recording		500
Contingencies		750
Estimated Total		<hr/> \$10,000

Report by

D. C. Malcom

D. C. Malcom, P. Eng.

May 6, 1971

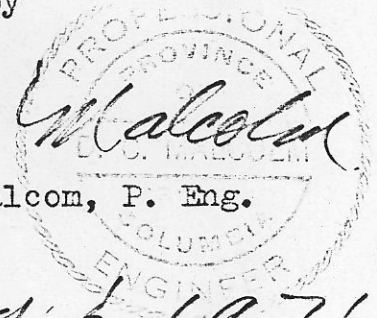

CERTIFICATE

This is to certify that:

- (1) I, DOUGLAS COLE MALCOLM am a resident of Vancouver, B. C. and live at 2290 West 23rd Avenue.
- (2) I am a graduate of the University of British Columbia, with the degree of Bachelor of Applied Science in Geological Engineering (1935).
- (3) I am a member of the Association of Professional Engineers of British Columbia and Ontario and have practised my profession continuously since graduation.
- (4) I have not, directly or indirectly, received or expect to receive, any interest, direct or indirect, in the Jay Claims.
- (5) This report is based on information supplied by Mr. Evan Sleeman and on a general knowledge of the area.

May 4, 1971
Vancouver, B. C.

D. C. MALCOLM, P. Eng.

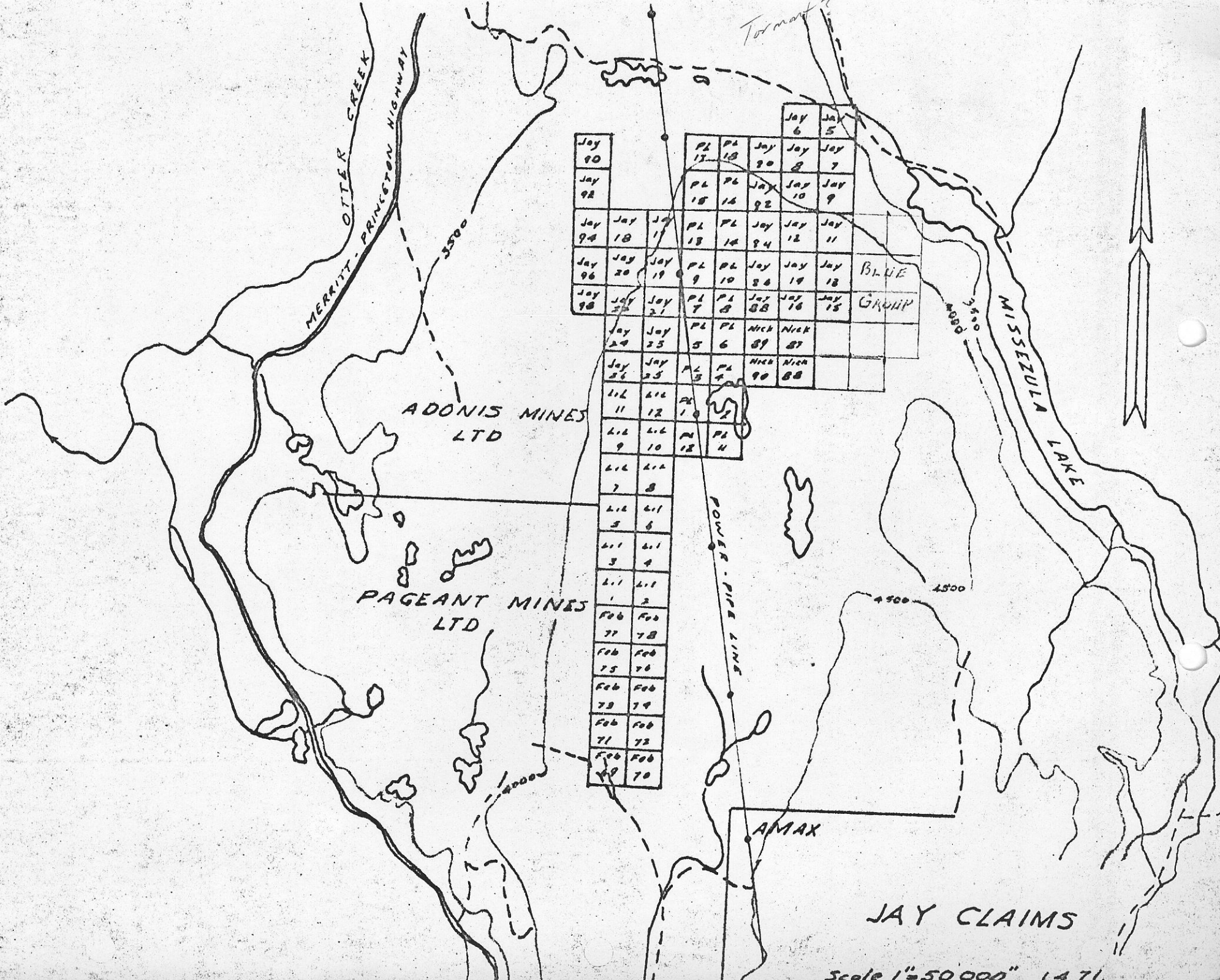

Jay 90						Jay 6	Jay 5	
Jay 92			PL 17	PL 18	Jay 90	Jay 8	Jay 7	
Jay 94	Jay 18	Jay 17	PL 18	PL 14	Jay 94	Jay 12	Jay 11	
Jay 96	Jay 20	Jay 19	PL 9	PL 10	Jay 84	Jay 14	Jay 13	BLUE
Jay 98	Jay 22	Jay 21	PL 7	PL 8	Jay 88	Jay 16	Jay 15	GROUP
Jay 24	Jay 25		PL 5	PL 6	Nick 89	Nick 87		
Jay 26	Jay 25		PL 3	PL 4	Nick 90	Nick 88		

Lil 11	Lil 12	PL 1	PL 2
Lil 9	Lil 10	PL 12	PL 14
Lil 7	Lil 8		
Lil 5	Lil 6		
Lil 3	Lil 4		
Lil 1	Lil 2		

Feb 77	Feb 78
Feb 75	Feb 76
Feb 73	Feb 74
Feb 71	Feb 72
Feb 69	Feb 70

Scale 1"=50 000" 1:471.

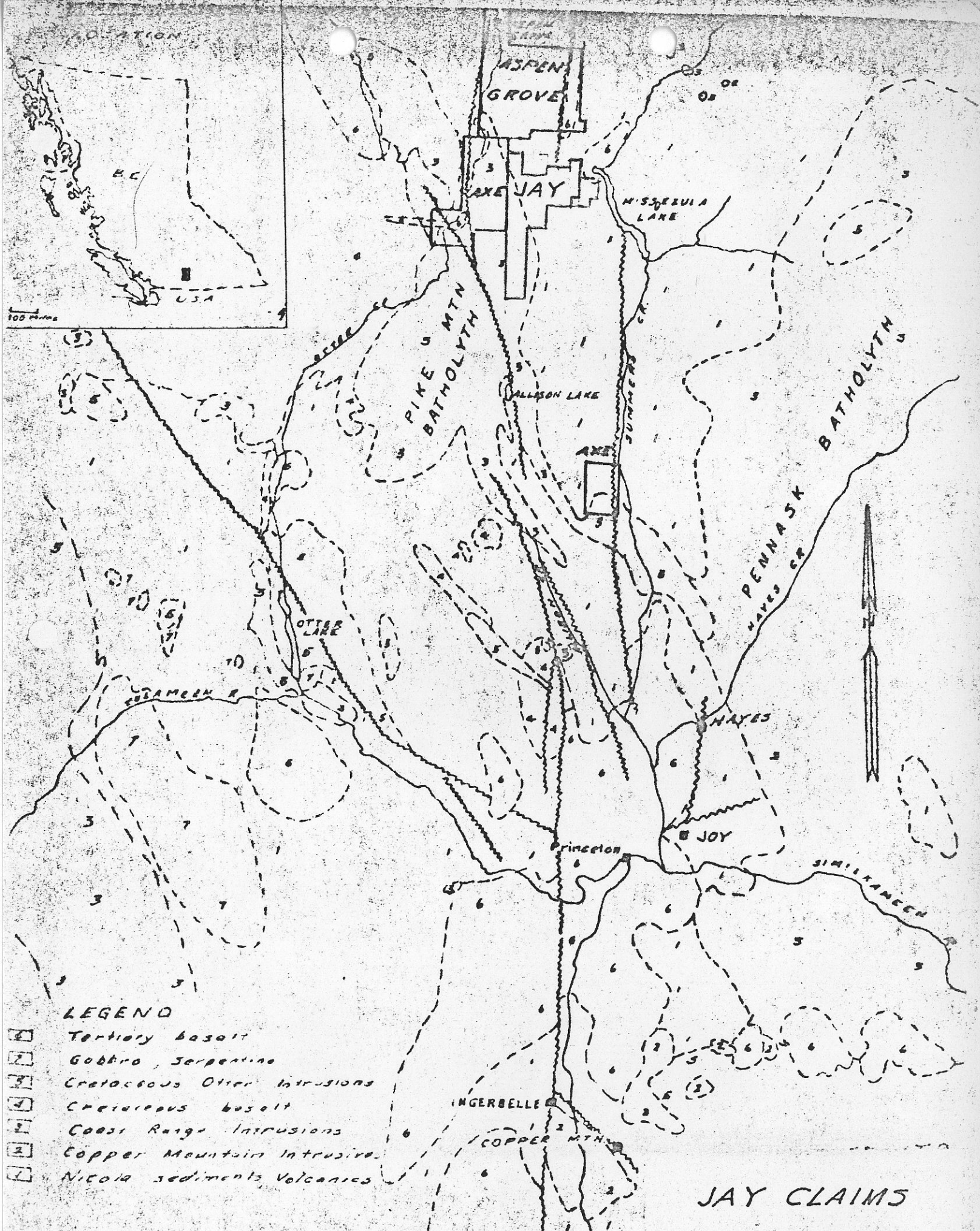

LEGEND

- 1 Tertiary basalt
- 2 Gabbro, Serpentine
- 3 Cretaceous Otter intrusions
- 4 Chertaceous basalt
- 5 Coast Range intrusions
- 6 Copper Mountain Intrusive
- 7 Nicola sediments, Volcanics

JAY CLAIMS

Scale 1" = 4 Miles 1,4,71.

PHONE CALL

Date 16 June Time 2pm

To Alco

WHILE YOU WERE OUT

Mr. J. Butterworth
(Prospector)
of

Phone 943 - 3744

Telephoned Please call

Called to see you Will call again

Wants to see you Returned your call

MESSAGE PO Adams 25 miles
N of Princeton. Please phone
if interested in further
details.

Operator OK.

called Butterworth. June 17/71
20 mi N of Prudhoe

6-8 mi N of ~~the~~ property w of Massena
Bo claim - low prospect.

staked on aeromag & "good area"

took same samples from town line

Some cp of py - in snow

Dry Malcolm checked & wrote report.

Malcolm call him for further details

(see of work summary.)

hill at Tenassan.

\$10,000 & 20%