

924 Prop. Sub.
811755

S. Peckovitch

SHEET NO. 1
FILE NO. 305384/396

J. R. WILLIAMS & SON LTD.

MUTUAL 5-5821

PROVINCIAL ASSAYERS

Coguchella Lake

580 NELSON STREET

VANCOUVER 2, B. C., July 23rd 19 68 B.

RESULTS of Assays made on samples of ore submitted by: **Messrs., Cyprus Explorations Limited.**

MARK	Silver ozs/ton
4708-E	0.05
4709-E	0.10
4710-E	0.20
4711-E	0.10
4712-E	0.25
4713-E	0.05
4714-E	0.20
4715-E	0.35
4716-E	0.15
4717-E	0.05
4718-E	0.25
4719-E	0.70
4720-E	0.10

Assays made by:

J. Moore

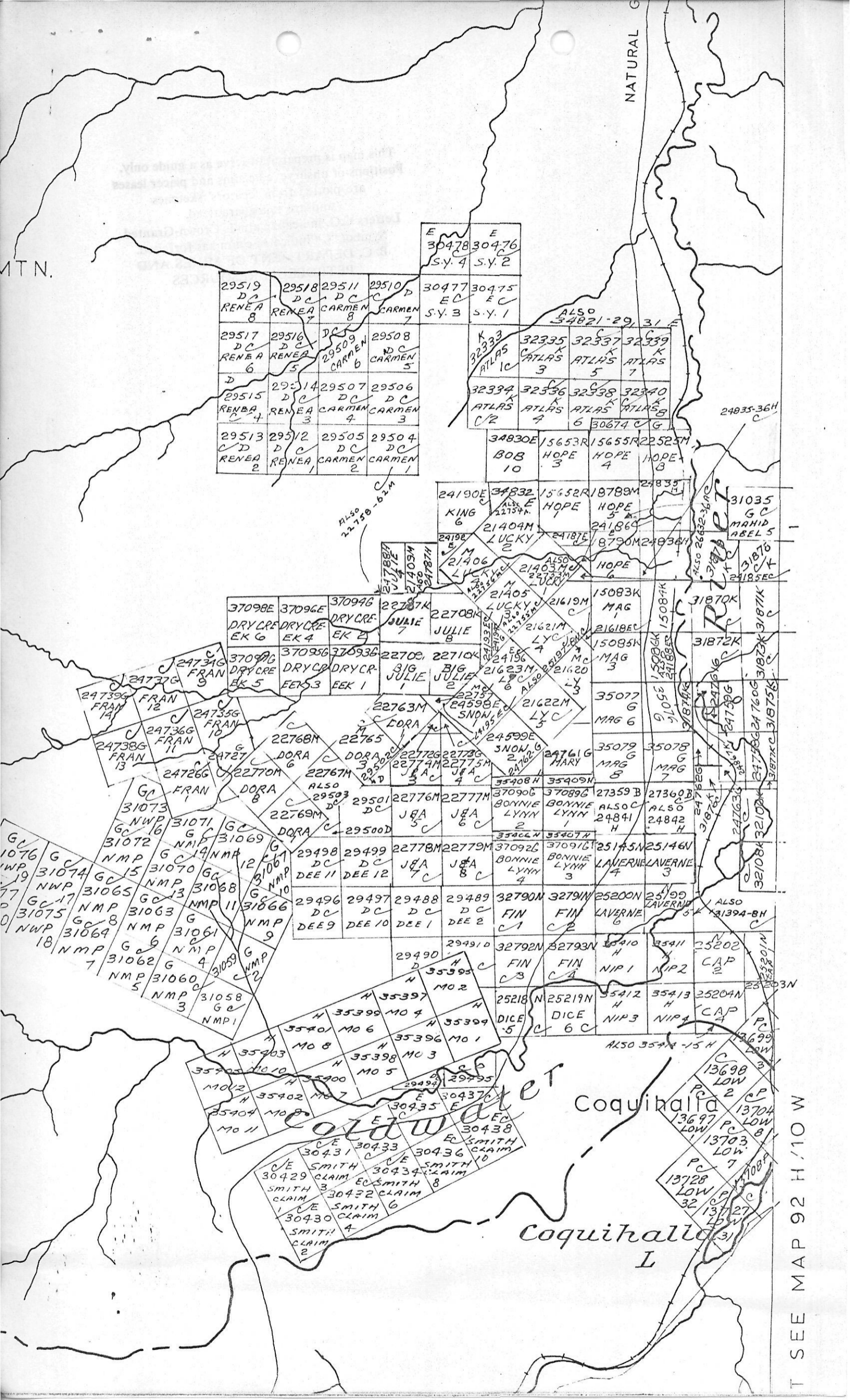

NATURAL

MTN.

E
30478 30476
S.Y. 4 S.Y. 2

29519 D RENEA 8	29518 D RENEA 7	29511 D CARMEN 8	29510 D CARMEN 7
29517 D RENEA 6	29516 D RENEA 5	29509 D CARMEN 6	29508 D CARMEN 5
29515 D RENEA 4	29514 D RENEA 3	29507 D CARMEN 4	29506 D CARMEN 3
29513 D RENEA 2	29512 D RENEA 1	29505 D CARMEN 2	29504 D CARMEN 1

ALSO 34821-29, 31 E

32333 K ATLAS 10	32335 K ATLAS 3	32337 K ATLAS 5	32339 K ATLAS 7
32334 K ATLAS 12	32336 K ATLAS 4	32338 K ATLAS 6	32340 K ATLAS 8

34830E BOB 10	15653R HOPE 3	15655R HOPE 4	22525M HOPE 3
24190E KING 6	34832 E 22754N	15652R HOPE 1	18789M HOPE 5
24192 LUCKY 2	21404M LUCKY 2	24187E HOPE 6	24839 HOPE 4

37098E DRYCRE EK 6	37096E DRYCRE EK 4	37094E DRYCRE EK 2	22707K JULIE 7	22708K JULIE 8
37097G DRYCRE EK 5	37095G DRYCRE EEK 3	37093G DRYCRE EEK 1	22702 BIG JULIE 1	22710K BIG JULIE 2

24739G FRAN 12
24737G FRAN 9
24739G FRAN 14
24736G FRAN 10
24738G FRAN 13
24727
24726G
24727
24727
24727
24727

31073
31072
31074
31075
31076
31077
31078
31079
31080
31081
31082
31083
31084
31085
31086
31087
31088
31089
31090
31091
31092
31093
31094
31095
31096
31097
31098
31099
31100

22763M DORA	22765 DORA	22768M DORA	22767M DORA	22769M DORA
22770M DORA	22771M DORA	22772M DORA	22773M DORA	22774M DORA
22775M DORA	22776M DORA	22777M DORA	22778M DORA	22779M DORA

29498 DC DEE 11	29499 DC DEE 12	29496 DC DEE 9	29497 DC DEE 10	29488 DC DEE 1	29489 DC DEE 2	29490 DC DEE 3	29491 DC DEE 4	29492 DC DEE 5	29493 DC DEE 6	29494 DC DEE 7	29495 DC DEE 8
-----------------------	-----------------------	----------------------	-----------------------	----------------------	----------------------	----------------------	----------------------	----------------------	----------------------	----------------------	----------------------

35393 MO 2
35394 MO 3
35395 MO 4
35396 MO 5
35397 MO 6
35398 MO 7
35399 MO 8
35400 MO 9
35401 MO 10
35402 MO 11
35403 MO 12
35404 MO 13
35405 MO 14
35406 MO 15
35407 MO 16
35408 MO 17
35409 MO 18
35410 MO 19
35411 MO 20
35412 MO 21
35413 MO 22
35414 MO 23
35415 MO 24
35416 MO 25
35417 MO 26
35418 MO 27
35419 MO 28
35420 MO 29
35421 MO 30
35422 MO 31
35423 MO 32
35424 MO 33
35425 MO 34
35426 MO 35
35427 MO 36
35428 MO 37
35429 MO 38
35430 MO 39
35431 MO 40
35432 MO 41
35433 MO 42
35434 MO 43
35435 MO 44
35436 MO 45
35437 MO 46
35438 MO 47
35439 MO 48
35440 MO 49
35441 MO 50
35442 MO 51
35443 MO 52
35444 MO 53
35445 MO 54
35446 MO 55
35447 MO 56
35448 MO 57
35449 MO 58
35450 MO 59
35451 MO 60
35452 MO 61
35453 MO 62
35454 MO 63
35455 MO 64
35456 MO 65
35457 MO 66
35458 MO 67
35459 MO 68
35460 MO 69
35461 MO 70
35462 MO 71
35463 MO 72
35464 MO 73
35465 MO 74
35466 MO 75
35467 MO 76
35468 MO 77
35469 MO 78
35470 MO 79
35471 MO 80
35472 MO 81
35473 MO 82
35474 MO 83
35475 MO 84
35476 MO 85
35477 MO 86
35478 MO 87
35479 MO 88
35480 MO 89
35481 MO 90
35482 MO 91
35483 MO 92
35484 MO 93
35485 MO 94
35486 MO 95
35487 MO 96
35488 MO 97
35489 MO 98
35490 MO 99
35491 MO 100

T SEE MAP 92 H/10 W

92 H/11E + 92 H/10W

27359 - 60 B © Gerald Kay
Kamloops.
Rested?

350 ⁷⁶₇₇78 } G Clayton
79 } Poomey
June 13/67

35394 H } Maurice
↓ } E Racine
405 } 14 July/67

408 - 9 (FR) } FRANK
↓ } Ovington
415 } 17 July/67

370 ⁸⁹90 } G See Nicola
91 } M.D. Bennett
92 }

25145 N } S. Pelkovic
46 } Blueberry M. Co.
Oct 7/68

24761 G Blueberry
2~~7~~ } Mui Co

25199 N } Oct 14/68
200 } Blueberry Mq.

24599 E

24762 Blueberry Mq
Co
June 30/68

