

811691

Prop.
Submission
82L-5

ATLAS EXPLORATIONS LIMITED

330 MARINE BUILDING
355 BURRARD STREET
VANCOUVER 1, B.C.

PROPERTY EXAMINATION - 82-L-5

PROPERTY #12 JIM GROUP, WESTWOLD

SUMMARY

A Cretaceous (?) stock intrudes argillaceous rocks. Intrusive berars molybdenite along fracture planes. Samples of intrusive and mineralized collar rocks gave low assay values.

CONCLUSIONS

Mineralization is not extensive enough to be of interest to us at the present time.

RECOMMENDATIONS

No further work to be done.

INTRODUCTION

The property was submitted to Atlas by A. Brewer in January 1970. Examination of the property took place in early June, 1970. Four hours were spent on the property but all areas of known mineralization were seen.

LOCATION

The property is located south of Westwold, B.C. at approximately $50^{\circ}25'N$ lat., and $119^{\circ}45'W$ long.

ACCESS

From Westwold by 4-wheel-drive vehicle - a distance of 7 miles.

PROPERTY AND OWNERSHIP

The Claims are jointly held by Brewer, Brewer and Jourdain of Vernon B.C.

TOPOGRAPHY

Mountainous.

HISTORY OF THE OCCURRENCE

Has been held by present vendors for 4 years. Has been drilled on two occasions; first by Bralorne Pioneer and second by an individual. Both dropped their option.

GENERAL GEOLOGY

Cretaceous granite (porphyritic) intrudes argillaceous sedimentary rocks (Cache Creek). Contact zones are hornfelsed. Tertiary volcanics cap the upper parts of the intrusion; only the western flank is exposed.

MINERALIZATION

Molybdenite is distributed along fractures in the granite. Not well fractured in general and very little introduced quartz or alteration. Hornfels outcrop north of Adelphi Creek carries small amount of molybdenite and traces of chalcopyrite. (see assays No. 1137 and 1138).

COMMENTS

The intrusive does not show favourable signs for mineralization of ore grade. Molybdenite where present is somewhat coarse-grained. Copy of report by Paul Lafleur is appended. Tungsten mineralization is not substantiated by assays.

M.E. Coates
July 12, 1970

MEC:js



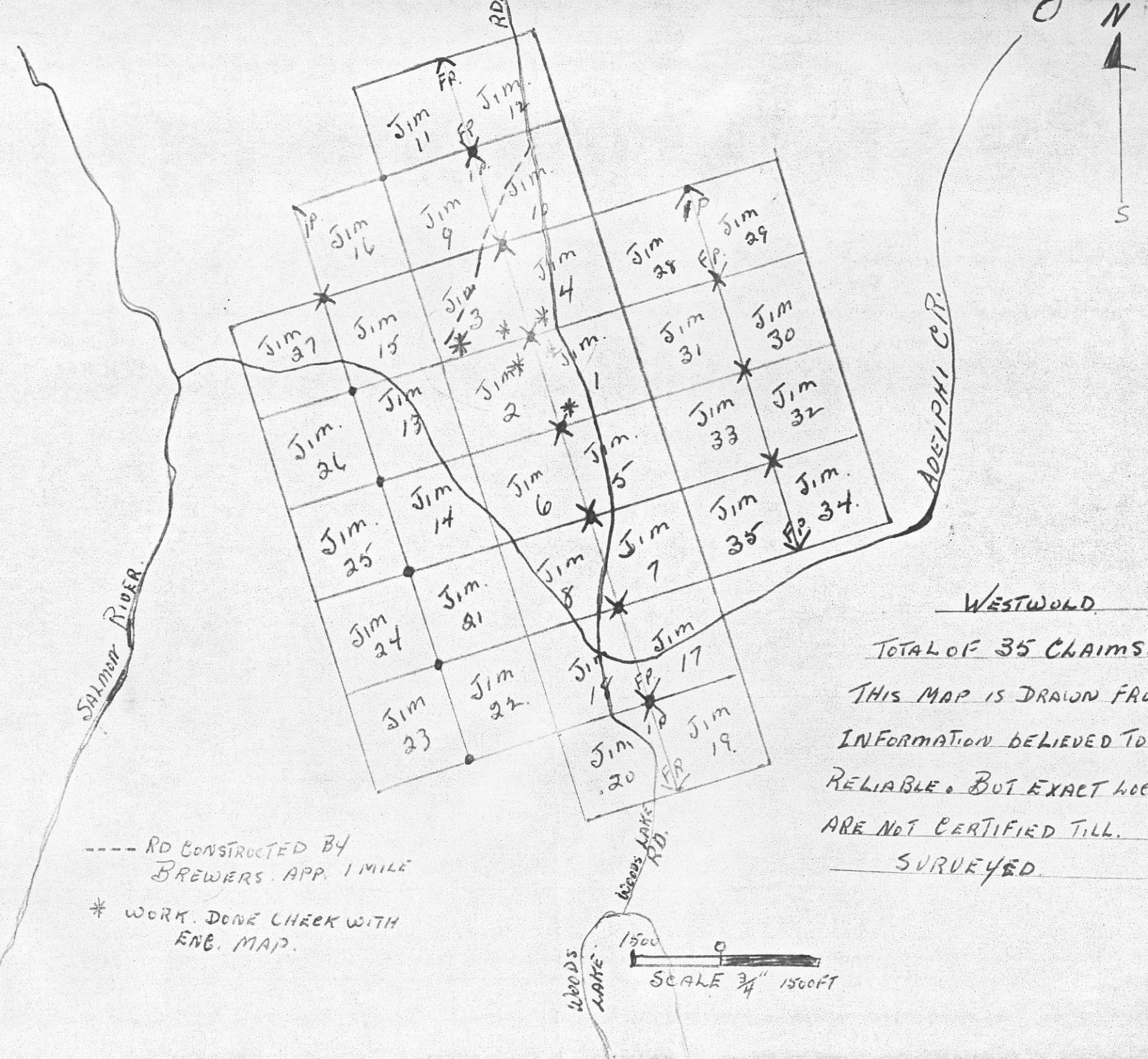

--- RD CONSTRUCTED BY
 BREWERS. APP. 1 MILE

* WORK DONE CHECK WITH
 ENG. MAP.

WESTWOOD

TOTAL OF 35 CLAIMS.

THIS MAP IS DRAWN FROM
 INFORMATION BELIEVED TO BE
 RELIABLE. BUT EXACT LOCATIONS
 ARE NOT CERTIFIED TILL
SURVEYED.

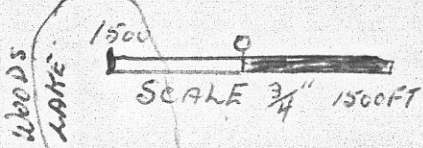

WESTWOLD JIM PROPERTY

16W

12W

8W

4W

BASE
LINE

4E

245

285

325

365

405

445

485

525

605

Geochemical Soil Survey



SCALE in FEET

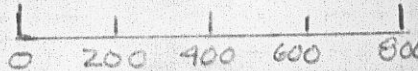

Tertiary
Basalt
capping

BASE
LINE

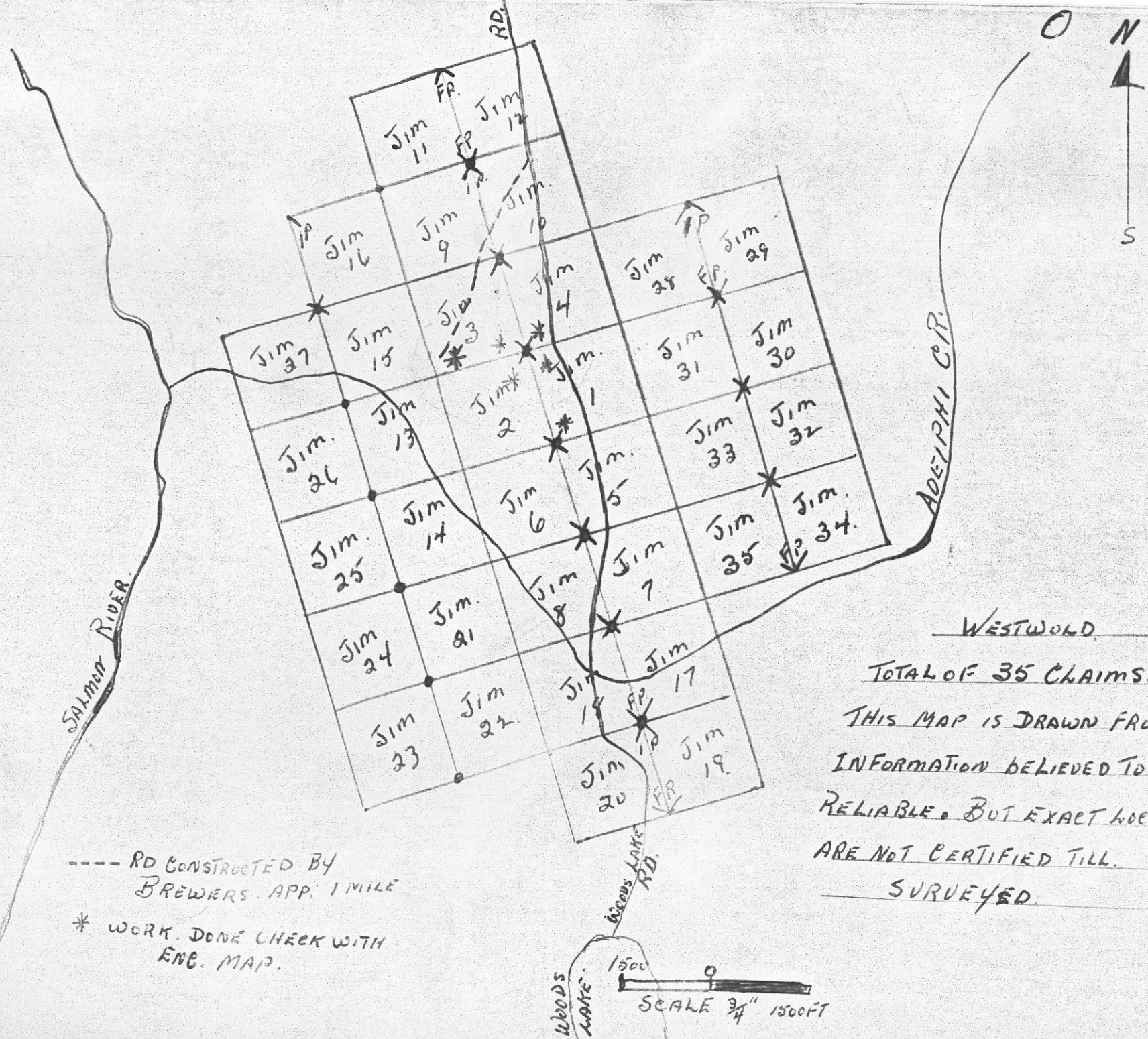

--- RD CONSTRUCTED BY
 BREWERS. APP. 1 MILE
 * WORK DONE CHECK WITH
 ENG. MAP.

WESTWOLD

TOTAL OF 35 CLAIMS.
 THIS MAP IS DRAWN FROM
 INFORMATION BELIEVED TO BE
 RELIABLE. BUT EXACT LOCATIONS
 ARE NOT CERTIFIED TILL
SURVEYED.

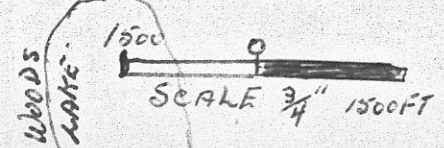

Tungsten

Westwold Jim Property
 "W" Geochemistry - soil
 1" = 400 feet.

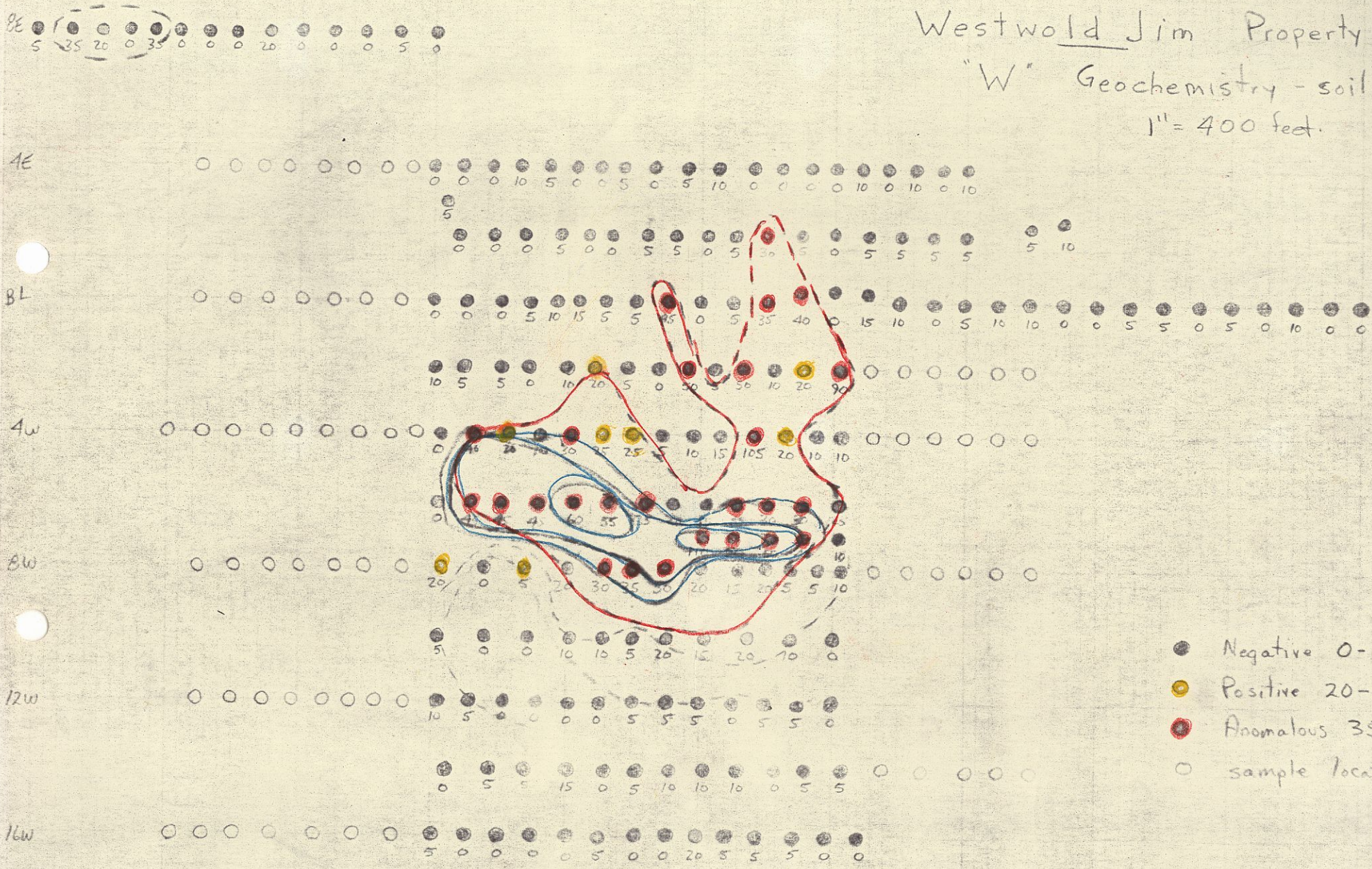

- Negative 0-19 ppm
- Positive 20-34 ppm
- Anomalous 35+ ppm
- sample location

19

Montest

Pringle Ck

Westwold

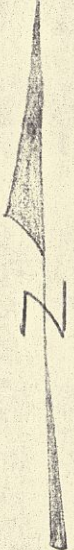

Scale: 1 inch = 1 mile

Salmon

Lapsed Jim claims

Jim Group

Adelphi Ck

Woods L.

Salmon River

Cain Ck



305

325

345

365

385

405

425

445

465

485

4E

2E

BASE
LINE

2W

4W

6W

8W

10W

BASE
LINE



P.O. Box 3050,
Whitehorse, Y.T.

August 8, 1970

Mr. A. Brewer,
RR#4,
Vernon, B.C.

Dear Mr. Brewer:

At the request of our Vancouver Office I forwarded all the data on the Westwold property to them so that it could be delivered to Ivan Greg. This was done 3 weeks ago so Ivan should have everything if you contact him.

I hope that this has not caused you too much inconvenience.

Yours truly,

ATLAS EXPLORATIONS LIMITED

M.E. (Tim) Cotes, P.Eng.

MEC:js

Jul 31, 1970
RR#1, Vernon B6
Phone 542-2074

Mr. Tim Coates

Dear Tim would you please
send the Reports and maps back
to me on the west wold molly as
we need them

Yours Very Truly
Alfred Brewer

P.O. Box 3050,
Whitehorse, Y.T.

July 27, 1970

Mr. Ivan Greg,
803-1450 Burnaby St
Vancouver, B.C.

Dear Ivan:

In my haste in gathering up the items which you wanted for the Jim Group, I hope you haven't been caused too much inconvenience without the claim map.

Also enclosed is a small sketch map showing Hg values for the samples we collected. They would be interesting as a base-metal indicator but I am afraid that they are too low to be of interest as far as Mercury deposits are concerned.

Hope that you are having a successful season.

Best regards.

Yours sincerely,

ATLAS EXPLORATIONS LIMITED

(for) M.E. (Tim) Coates, P.Eng.

Encls.

MEC:js

P.O. Box 3050,
Whitehorse, Y.T.

July 12, 1970

Mr. Ivan Greg,
c/o Mr. J.S. Brock,
Atlas Explorations Limited,
330-355 Burrard Street,
Vancouver 1, B.C.

Dear Mr. Greg:

Enclosed are your overdue originals for the JIM Group
at Westwold.

Assay samples which I took at the property - one from
the quartz monzonite porphyry and the second from the
hornfels collar near Adelphi Creek - gave very low moly
results. I do not think that we will be further interested
in the property at this time.

Yours sincerely,
ATLAS EXPLORATIONS LIMITED

M.E. (Tim) Coates, P.Eng.

Encls.

MEC:js

cc: J.S. Brock

Jan 7th 1970
RR4, Vernon B.C.
Phone 542, 2074

Mr Tim Coates

Dear Sir I Received a letter from
Mr J. S. Brock asking me to forward the
Report on our West Wold Molly and tungsten
Claims to you. There are 35 Claims all adjoining
Please Return this Report

Yours Very Truly
Alfred Brewer

January 9, 1970

Mr. A. Brewer,
RR4,
Vernon, B.C.

Dear Mr. Brewer:

I received the copy of the report on your West Wold property today. It sounds interesting and I would like to have the opportunity of looking at it in the spring. I shall be in the area in April and May and should like to arrange a visit to the property with you at that time. I shall contact you at a later date to let you know of my exact schedule.

I have taken the liberty of making a copy of the report and map so that I may examine them at greater depth. I am returning your original copy as you requested.

Thank you very much for the report and I am looking forward to meeting you in the spring.

Best regards,

Yours truly,

ATLAS EXPLORATIONS LIMITED

M.E. (Tim) Coates, P.Eng.

Encl.

MEC/js

January 5th, 1970

Mr. Alfred Brewer,
R.R. #4,
Vernon, B.C.

Dear Mr. Brewer:

Thank you very much for your letter of December 22nd. We would be interested in receiving a copy of your engineers report. If you would forward your report to one of our geologist, Mr. Tim Coates, he will contact you at a later date.

Yours truly,

ATLAS EXPLORATIONS LIMITED,

J. S. Brock,
Vice-President Exploration

JSB/mp

RECEIVED

DEC 27 1969

Dec 22nd 1969

RR 4, Vernon BC

Phone-542-2074



Atlas Exploration Co

Dear Sirs you might be interested to know that we have 35 claims between here and Kamloops carrying both Molly and Tungsten and also have an Engineer Report on the Property that we could send you upon Request. The Power is very handy to the Property and also the CNR Railway. If you would be interested please write and we could send you the Report on the Property. Yours Very Truly
Alfred Brewer

SKETCH of GEOLOGY WESTWOLD JIM PROPERTY Westwold, B.C.

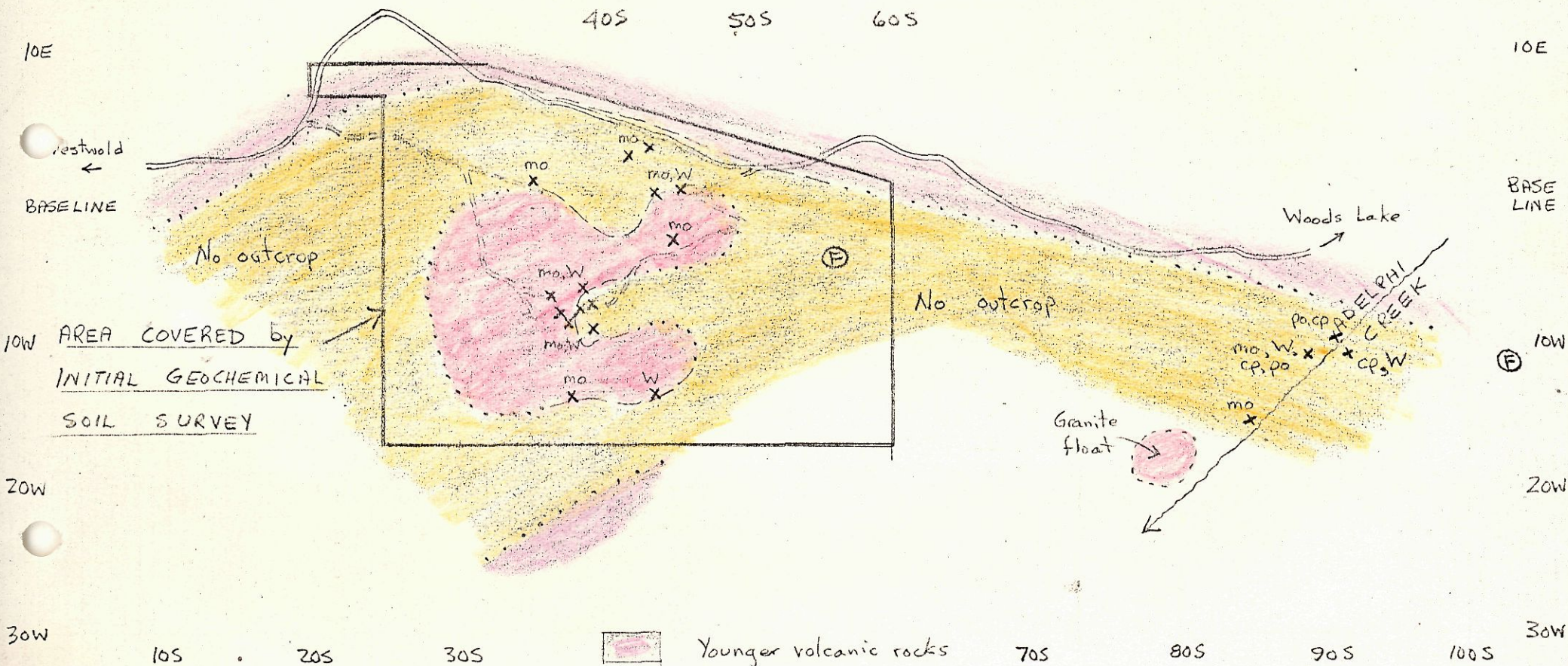
Scale: 1 inch = 1000 feet



- | | | |
|---|------------------------------|------|
|  | Younger volcanic rocks | 70S |
|  | Granite - granodiorite | 80S |
|  | Meta morphic rocks | 90S |
| X | Mineralization seen in place | 100S |
| ⓔ | Mineralized float | |
| mo | molybdenite | |
| W | scheelite | |
| cp | chalcopyrite | |
| po | pyrrhotite | |

10W AREA COVERED by
INITIAL GEOCHEMICAL
SOIL SURVEY

No outcrop

No outcrop

Granite float

Woods Lake

ADOLPHUS CREEK

20E

20E

10E

10E

BASELINE

BASELINE

10W

10W

20W

20W

30W

30W

10S

20S

30S

70S

80S

90S

100S