

INTER OFFICE MEMO

811612

CYPRUS EXPLORATION CORPORATION LTD.
VANCOUVER OFFICE

Date: April 3, 1969

To: Mr. D. W. Tully
From: Mr. J. B. P. Sawyer
Subject: Re: Eagle River Mines prospect submissions

G. Wolansky today submitted for our consideration the claims recently staked in the Semlin-Anglesey area. These are the claims adjoining^{to} the south of our area E claims.

Eagle River Mines is a private company belonging to Wolansky.

They have approximately 100 claims, including 30 optioned from Ashdown. Wolansky is interested in optioning the property now on the following terms:

1. Cash payments:
 - \$4,000 May 1, 1969
 - \$4,000 November 1, 1969
 - \$4,000 May 1, 1970
2. Eagle River Mines would retain 30% interest.

Attached is a copy of an assessment work report on part of the area, written by M. Stadnyk. As you are aware, A. C. Skerl has done work in this area in past and according to Wolansky considers it worthy of further investigation.

Wolansky reports chalcopryrite, bornite and pyrite in basic volcanics. He had samples with him which carried chalcopryrite and bornite mineralization. He also reports an earlier mention of above normal radio-activity in part of the area of his claim.

I have indicated that we will consider this and advise him if we have any interst.

I also took the opportunity to reaffirm that we would be interested in making a field examination of Wolansky's molybdenite prospect in the Yukon when snow conditions permit. He reports three feet of snow on the ground still at this time, in the Carcross Area.

JBPS/lm

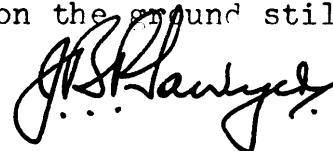

APRIL 2 / 69.

→ Eagle River Mines. (S. Wolansky)

approx 100 claims including 30 from Ashdown.

Chalk, basalt, pyx. in volcanics.

S.W. mentioned report of radioactivity in area.

Deal	Cash	\$4000	1/5/69
		\$4000	1/11/69
		\$4000	1/5/70

Plus 30% interest.

S. Wolansky,
Suite 306,
222 Ash St.,
New Westminster.

524-4264

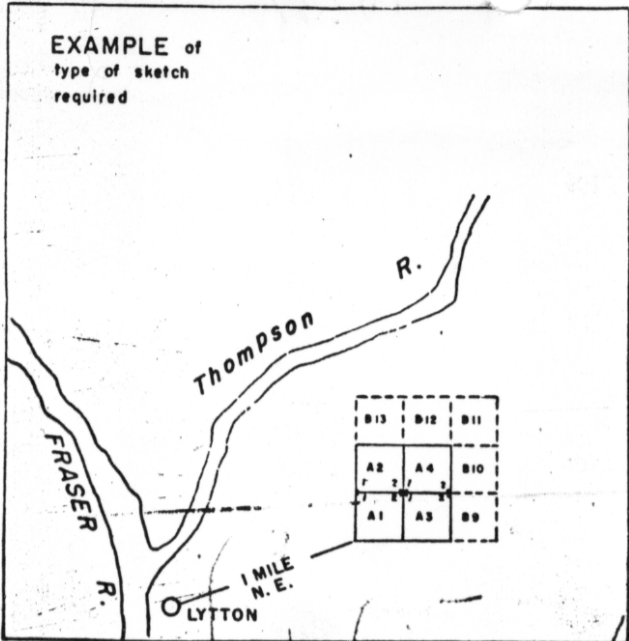

Claims must be tied by direction and distance to at least one, preferably more than one, topographical feature, or to a land lot, section, township, or other recognizable point on printed maps of the district. Relationship of previously located claims should also be shown.

N.B.— The sketch for a group of claims may be placed on one affidavit.

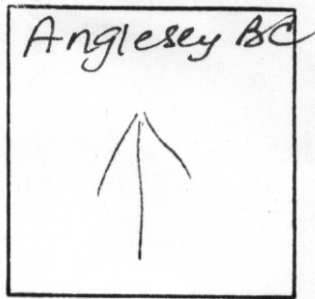

INDICATE NORTH (True or Magnetic)

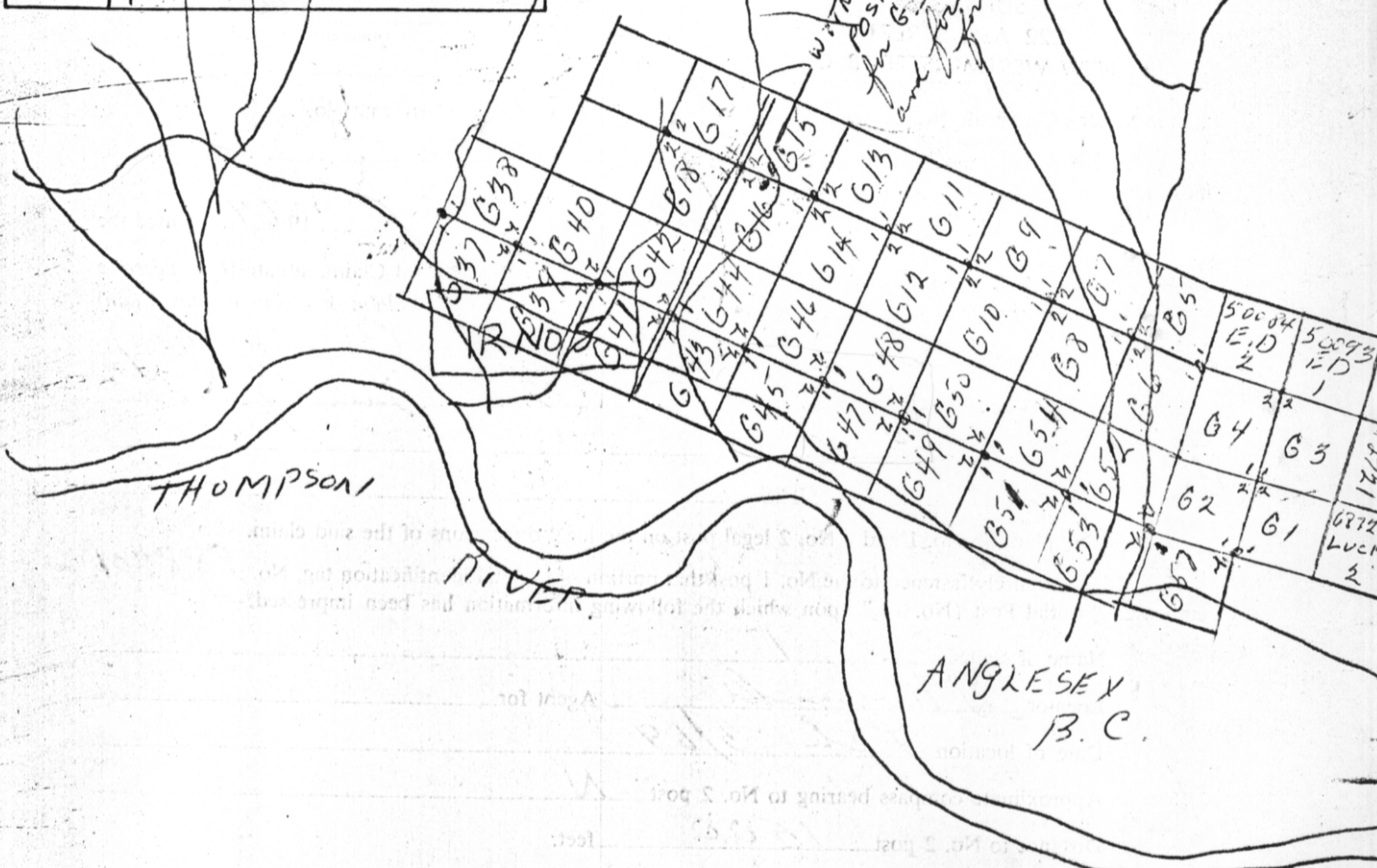

92I/14E

76237-272

Wolanski staking sketch
 ? G Claims
 ↑