

LEGEND

CENOZOIC

- MIOCENE OR EARLIER - KAMLOOPS GROUP**
 5. RHYOLITE, ANDESITE AND BASALT; ASSOCIATED TUFFS, BRECCIAS AND AGGLOMERATES, MAY INCLUDE SOME YOUNGER BASALTS
 6. TRANQUILLE BEDS; CONGLOMERATE, SANDSTONE, SHALE TUFF; THIN COAL SEAMS.

MESOZOIC

- LOWER CRETACEOUS - KINGSVALE GROUP**
 4. RHYOLITE, ANDESITE AND BASALT; ASSOCIATED TUFFS, BRECCIAS AND AGGLOMERATES; ARKOSE, CONGLOMERATE
JURASSIC AND (?) LATER
 3. IRON MASK BATHOLITH; SYENITE, MONZONITE DIORITE, GABBRO
UPPER TRIASSIC - NICOLA GROUP
 2. GREENSTONE, ANDESITE, BASALT, AGGLOMERATE, BRECCIA, TUFF; MINOR ARGILLITE, LIMESTONE, AND CONGLOMERATE.

PALÆOZOIC

- CARBONIFEROUS AND PERMIAN - CACHE CREEK GROUP(?)**
 1. ARGILLITE, QUARTZITE, HORNSTONE, LIMESTONE, SHEARED CONGLOMERATE, BRECCIA, GREENSTONE, AND SERPENTINE.

- == ROAD
 --- CONTACT
 ▨ SAND

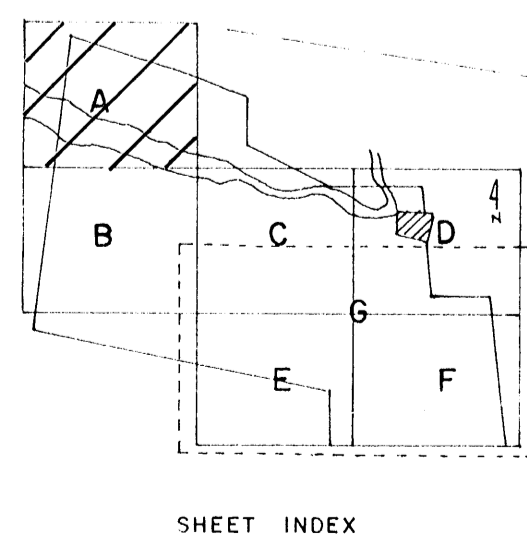

SHEET INDEX

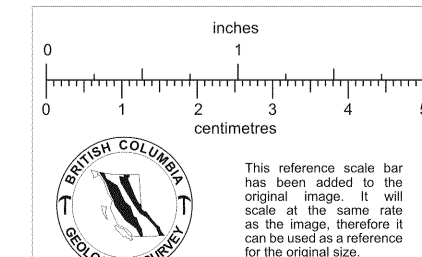
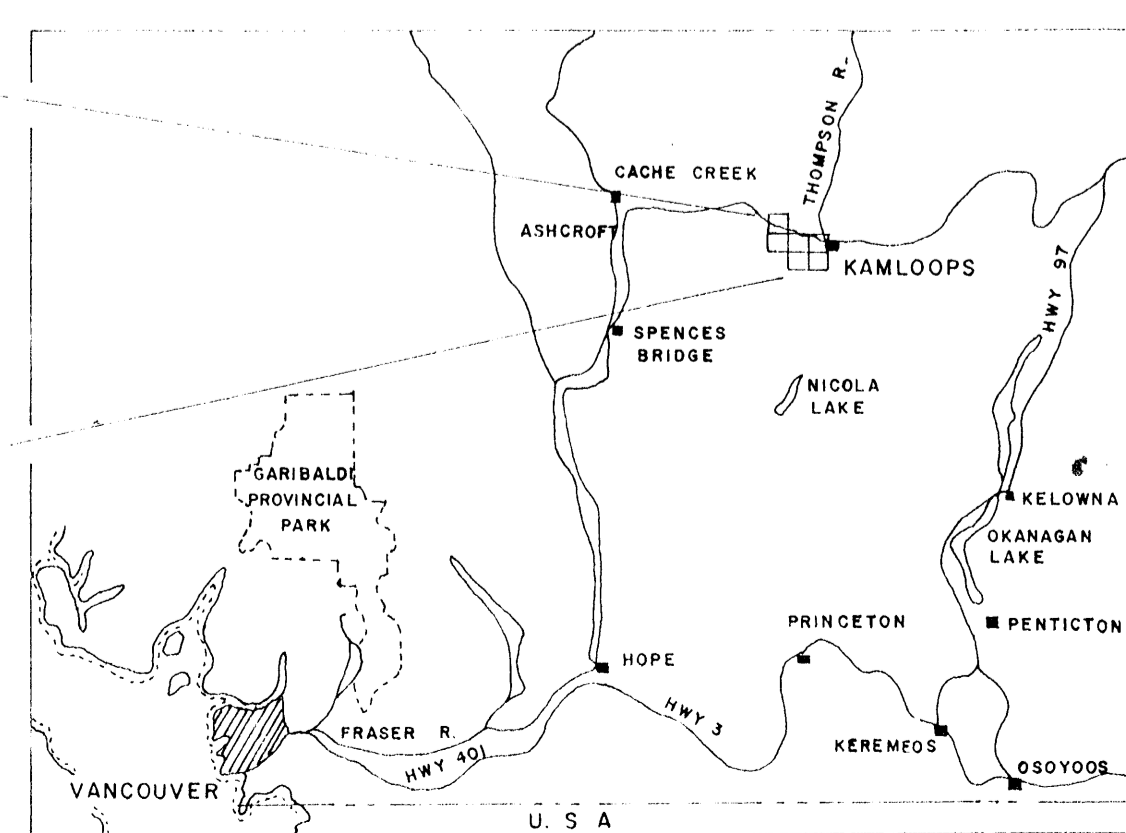

SANDNER ASSOCIATES			
KAMLOOPS - AFTON AREA			
GENERAL GEOLOGY			
Scale 1in = 1/4mi			
DRAWN	AR	JOB NO.	FIG NO.
DATED	June 15-72	1204	A
CHECKED	<i>[Signature]</i>		