

92 I/10 W (M)

TO NORTH SEE MAP 92 I/15 W

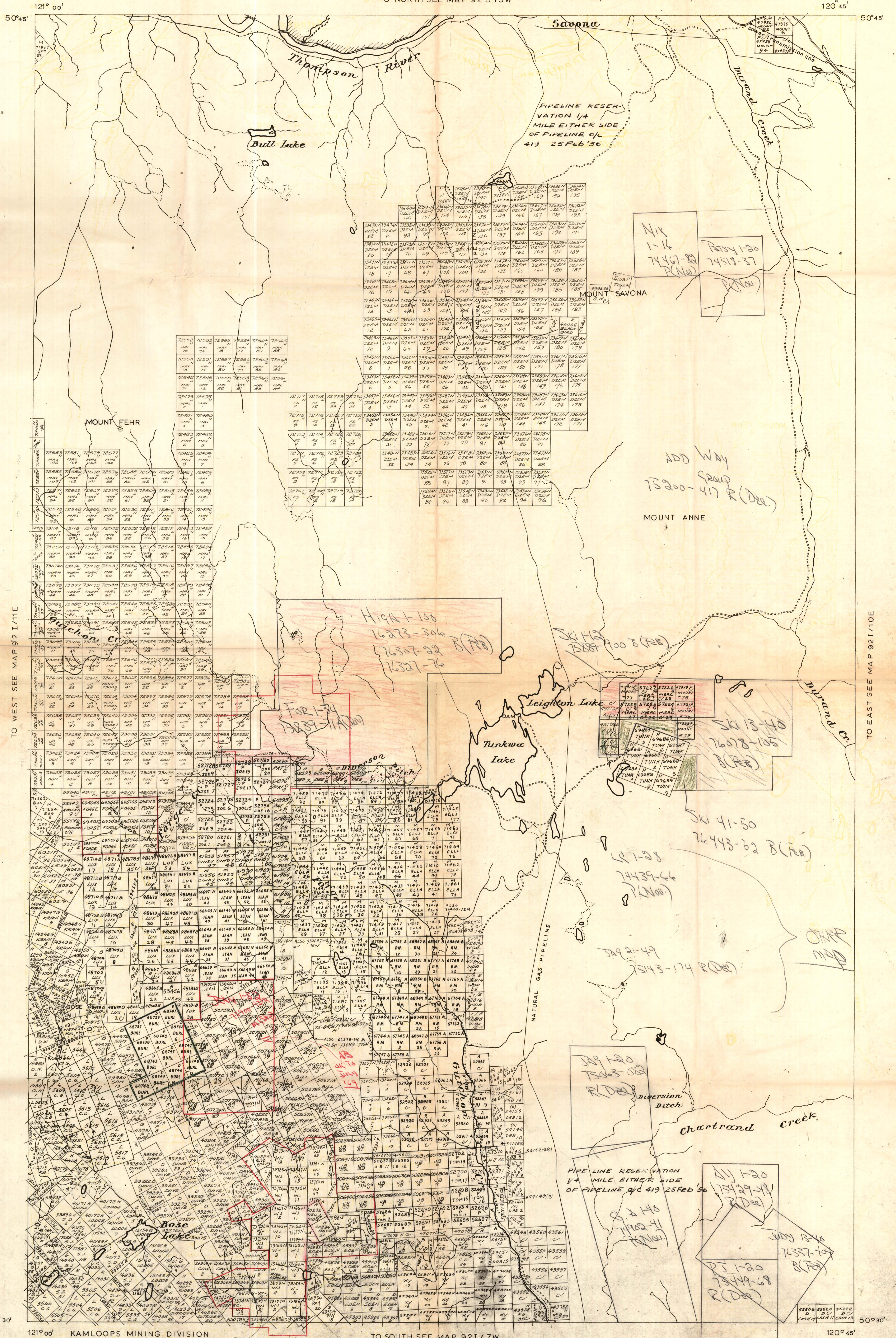

TO WEST SEE MAP 92 I/11 E

TO EAST SEE MAP 92 I/10 E

KAMLOOPS MINING DIVISION

TO SOUTH SEE MAP 92 I/7 W

DEPARTMENT OF MINES AND PETROLEUM RESOURCES
 VICTORIA, B. C.

MINERAL CLAIM MAP 92 I/10 W (M)

SCALE 1/2 MILE TO 1 INCH

RECEIVED
 FEB 13 1969
REGISTERED

For up-to-date information on claims in any area you should apply to the Mining Recorder for the Mining Division concerned.

Up to 3/2/69

This map is prepared to serve as a guide to the positions of located mineral claims and Prospecting Leases only. Unsurveyed claims and leases are plotted from locators' sketches and are not guaranteed. Letters C.G. indicate Crown-Granted Symbol 'C' indicates claim has forfeited.

Department of Mines and Petroleum Resources
 Victoria, B.C.

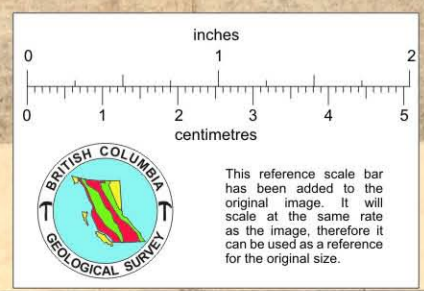

92 I/10 W (M)