

811434

SUMMARY REPORT
A, CLE AND C CLAIMS
KAMLOOPS AREA

By: C.F. Millar,
Jan. 1966

85 BONNYMUIR DRIVE

C. F. MILLAR, B.A.Sc., P.Eng.

Consulting Engineer

WEST VANCOUVER, BRITISH COLUMBIA
CANADA

TELEPHONE 922-5088

SUMMARY REPORT

on

"A", "Cle", and "C" CLAIMS

Kamloops M.D.

by

C. F. Millar, B.A.Sc., P.Eng.

Consulting Engineer

January 27, 1966

SUMMARY

The property consists of 44 claims owned by G. F. Sanft, 3508 St. Georges, North Vancouver, B.C. These claims are located roughly eight miles south of the City of Kamloops, just west of the Kamloops-Merritt highway.

Topographic conditions are such that the mineralized zones can be mined by open pit methods. Access and exploration work are also facilitated by the generally flat, treeless landscape. Overburden is widespread.

The geology is comparable with other important properties in the Kamloops area, and consists of Iron Mask intrusives containing altered and mineralized zones, as well as being in contact with earlier volcanic and sedimentary rocks. Economic mineralization consists predominantly of various copper minerals, with associated low gold and silver values, contained in highly altered phases of the intrusive rocks.

It is too early to say what the potential of this property is. The drilling done so far has proven the existence of commercial values in the Joker Adit area, and has indicated widespread low grade values elsewhere. The geophysical work has indicated several large anomalous areas, both over and also away from these drilled areas. The geological setting resembles that of the other major copper-bearing zones in the vicinity. These features combine to make the property one of considerable prospective merit, and worthy of a fairly extensive exploration program.

A preliminary exploration program costing an estimated \$50,000, involving extensive I.P. surveys plus 4,000 feet of drilling, is recommended.

SUMMARY REPORT ON
"A", "Cle", and "C" CLAIMS
Kamloops M.D.

INTRODUCTION

The following report is drawn from certain old reports plus the writer's experience in the area, gained while working for New Jersey Zinc Company Ltd., and Rolling Hills Copper Mines Limited.

The current developments on the Galaxy and other properties in the Kamloops area indicate that a large scale mining-milling operation may soon commence. The present time is thus a favourable one in which to carry out exploration work on the "A", "Cle" and "C" claims, which are, in the writer's opinion, one of the best relatively undeveloped prospects in the Kamloops Area.

PROPERTY

A search in the Mines Office shows that as of January 22, 1966, the following claims were owned by G. F. Sanft, 3508 St. George's Ave., North Vancouver, B.C.:

"A" Nos. 1 - 16

"Cle" " 1 - 10

"C" " 1 - 18

A map showing the general location of these claims is enclosed with this report. Also shown are the Galaxy, Cominco, and Rolling Hills properties which are currently undergoing development.

TOPOGRAPHY

The topography of the claims area is generally one of low relief

TOPOGRAPHY - (continued)

and is made up mainly of rolling grassland. Elevations are such that transportation to any of the possible millsites would encounter no serious adverse grades. Sufficient water for diamond drilling may be had by arrangement with the owners of the surface rights.

GEOLOGY AND MINERALIZATION

Bedrock outcrops are scarce, however sufficient information is on hand to place the majority of the claims over one or other of the various phases of the Iron Mask Batholith, or else astride its contact with earlier and/or later rocks. Generally speaking, the intrusive within the claims area is in contact with earlier sedimentary and volcanic rocks to the east, is overlain by later volcanic rocks to the south, and continues west and north past the claim boundaries. Most if not all of the geological features which accompany ore at the other main copper occurrences - Galaxy - Cominco - Rolling Hills - etc. are present in the claims area. These features include intensely altered zones in syenite, diorite-picrite contacts, and diorite-volcanic-sedimentary contacts.

Mineralization is apparently widespread. Copper values have been found in at least three localities within the claims area. Economic values are presently confined to one small area which was diamond drilled by Commercial Minerals Ltd. during 1956. In this area, copper minerals are mainly native copper and chalcocite, and occasional high silver values are believed to be associated with specular hematite lenses. This zone occurs as a gently dipping zone of intense chlorite-albite alteration in syenodiorite.

WORK DONE

The claims area has undergone several periods of exploration.

WORK DONE (continued)

The first activity commenced over 40 years ago and progressed slowly, mainly due to the efforts of one man, and involved scattered shafts and tunnels - all quite shallow. A second phase took place during the middle 1950's and involved diamond drilling at least 29 vertical holes, in at least three localities. Eighteen holes near the Joker adit blocked out commercial values in a zone well suited for open pit mining. Another 8 holes, located near an old shaft, 2,300' N.E. of the Joker adit, encountered highly altered igneous rock, containing low (0.15% Cu) values plus a few sections of 0.5% Cu. Three holes located 800 ft. south of these latter 8 holes encountered ^{? in hydrothermally altered ground ??} olivine basalt (picrite?) containing several 10 foot runs of 0.33% Cu. Since nearly all of these holes were put down "blind", i.e. with little or no geological, geophysical, or geochemical control, the values encountered are considered by the writer to indicate widespread mineralization. This drilling was limited to shallow depths and small hole sizes. Core recoveries were poor - averaging only 50% - however sludge samples were collected.

An I.P. survey was conducted over the general area by New Jersey Zinc during the latter part of 1956. This survey consisted of long lines, generally on 400' centers, run in N.E.-S.W. directions. The writer's recollection is that it showed several strong anomalies trending N.N.E.-S.S.W. and passing west of Separation Lake. Another I.P. survey was made over the A Nos. 1, 2, 7, 8 and 9 claims in 1965, and located at least two zones of interest, one of which was very pronounced.

The accompanying drilling plan and assays show the ore zone found in the Joker adit area, which averages 350 ft. long, 120 ft. wide, and of varying thickness. Averaging the assays of these holes gives a

WORK DONE - (continued)

grade of 0.66% Cu plus gold and silver values. This ore zone may be cut off by erosion to the north and east, however is still in evidence in the most southerly and all but one of the most westerly holes. Another zone, roughly parallel and deeper than the main zone, occurs in holes No. 4 and 10. Both zones may possibly join together at hole No. 14, which encountered 90 feet of 0.55% Cu. Further drilling in this area will undoubtedly discover more ore.

CONCLUSIONS

- ✓1. Copper mineralization is apparently widespread.
- ✓2. Commercial values occur in at least one locality, where they are well suited for open pit mining.
- ✓3. I.P. surveys indicate anomalous conditions over considerable dimensions.
4. A considerable amount of work is justified by the results obtained so far. *eh*

RECOMMENDATIONS

1. An I.P. survey should be run at relatively wide spacings - say 400 ft. - over the whole claims area, and at 200 ft. intervals over areas of interest derived from the wide spaced survey, and/or the known ore-bearing areas. The cost of this work would probably average \$500 per claim.
2. Follow-up drilling should then be done to test the I.P. anomalies and/or attempt to extend the known ore horizon. A minimum drilling program would probably involve 2,000 ft. on the I.P. anomalies, plus another 2,000 ft. around the

RECOMMENDATIONS - (continued)

Joker adit. The cost of this work would probably average \$7.00 per foot for diamond drilling or \$3.00 per foot for percussion drilling.

The total capital outlay considered necessary for a first-stage program would therefore probably run around \$50,000.

It is recommended that this program be undertaken.

C. F. Millar

C. F. Millar, B.A.Sc., P.Eng.
Consulting Engineer.

CFM/bm

January 27, 1966.

TABLE OF DRILLING RESULTS - JOKER ADIT AREA

<u>Hole No.</u>	<u>Depth</u>	<u>Footage</u>	<u>Sludge Assays</u>	<u>Core Assays</u>	<u>Core Assays</u>	<u>Remarks</u>
1	0-32	32		9.4 oz Ag	0.25% Cu	High Ag assoc. hematite?
2	17-40	23	0.66% Cu	1.3 oz Ag	0.8 % Cu	
3	19-39	20	1.31% Cu		0.76% Cu	
4	25-45	20	0.95% Cu		1.22% Cu	
	70-79	9	1.05% Cu		0.57% Cu	2nd zone?
5	25-40	15	0.95% Cu		0.76% Cu	
6	--	-	--		--	Not completed
7	50-70	20	1.18% Cu		0.99% Cu	
8	43-63	20	0.45% Cu		0.40% Cu	
9	53-73	20	--		0.25% Cu	
10	52-71	19	0.79% Cu		0.44% Cu	
	101-110	9	1.35% Cu		2.30% Cu	2nd zone?
11	79-84	5	--		0.80% Cu	
12	--	-	--		--	No ore
13	87-97	10	--		0.89% Cu	
14	65-155	90	--		0.55% Cu	
15	80-96	16	0.64% Cu		0.69% Cu	
16	--	-	--		--	No ore
17	--	-	--		--	No ore
18	73-82	15	--		1.50% Cu	

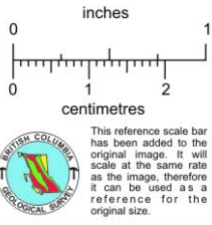

Scale: 1 inch - 4500 feet

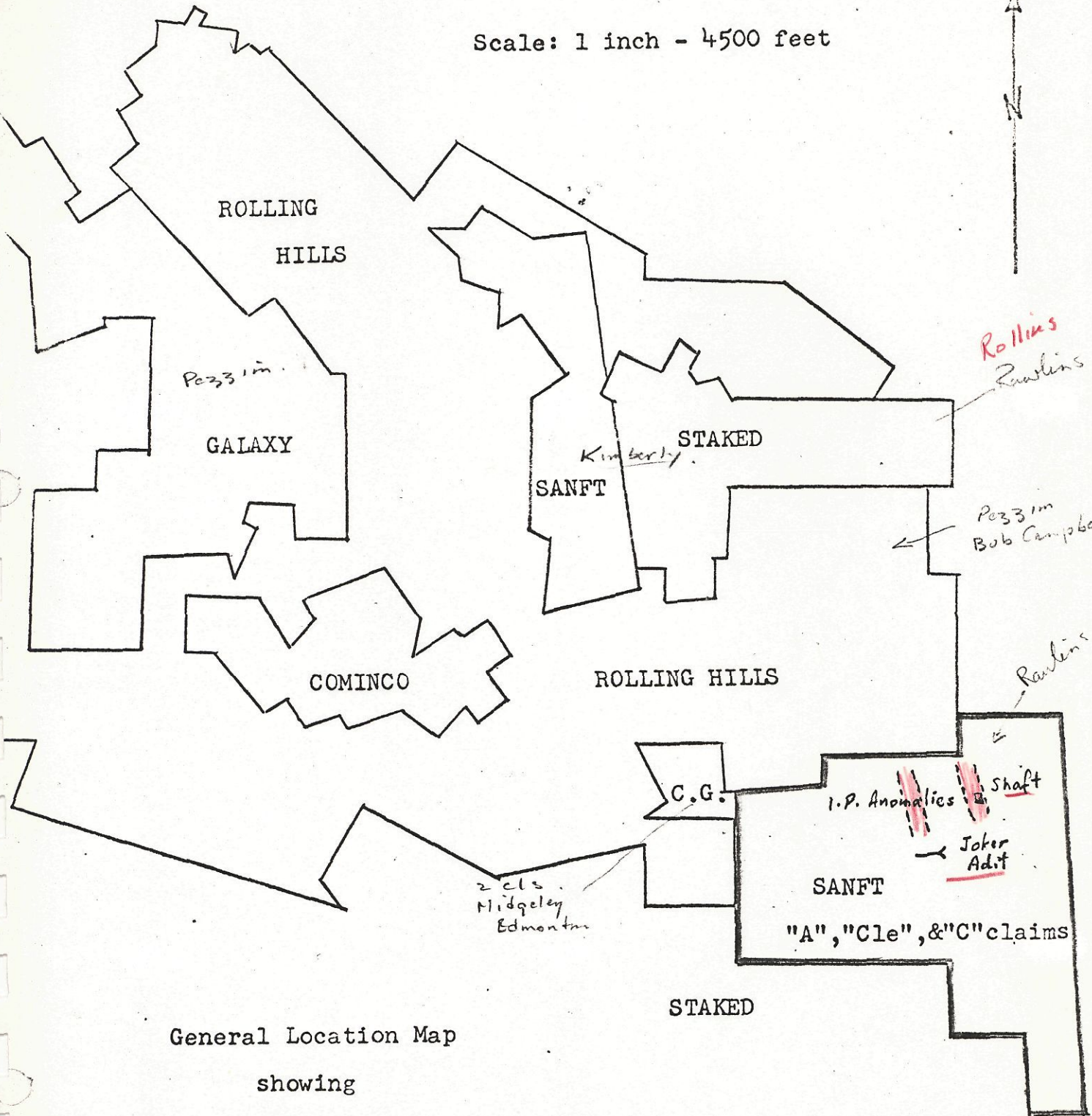

General Location Map
 showing
 Location of Mining Properties
 KAMLOOPS AREA

C. F. Millar Jan. 27/66

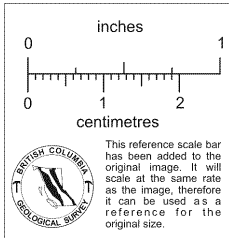
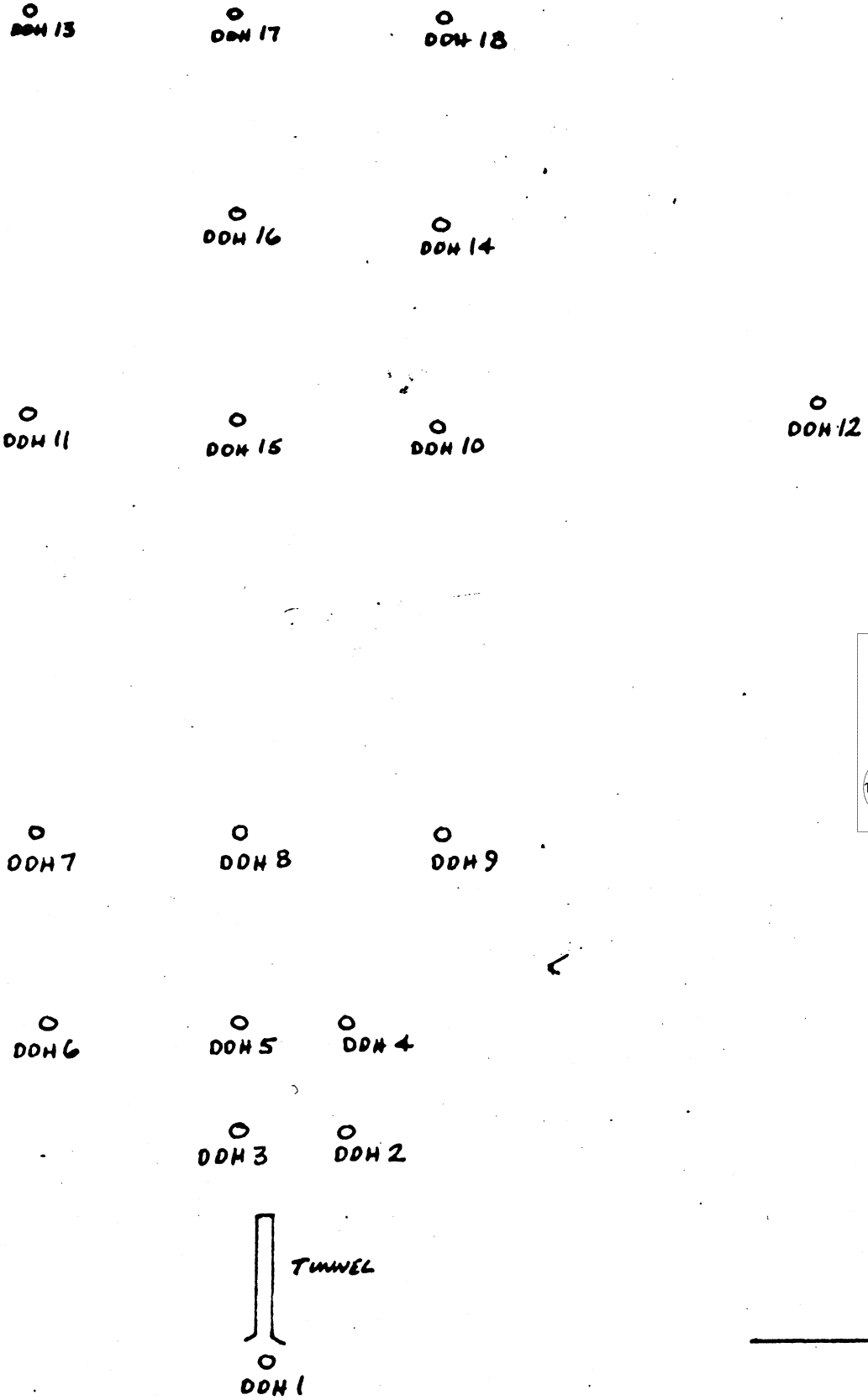

DIAMOND DRILL LOCATIONS
 JOKER ADIT AREA
 1 inch = 40 feet
 C. F. Miller Jan 1965