

811293

MERIDIAN EXPLORATIONS LTD.

Bracebridge Copper Property Option

Ft. Steele Mining Division
Kimberley Area, B. C.

82-F

Mr. W. K. Brown

Page 3

July 10, 1967

1. BOISE CREEK - PITT LAKE PROJECT (Cont.)

The writer visited the property with Dr. S. Ward on July 8th. E. Holt of Chapman, Wood & Griswold is progressing with surface mapping on 400 scale and integrating this with the mineralization being located by C. A. Langlois. Dr. Ward advised R. E. Chaplin on the I. P. Survey and some changes in field technique.

2. LUCKY LAKE PROJECT - SEMCO

A report from R. B. Stokes under date of July 5th and personal communication indicates this project is now underway on the ground.

After the mapped mineralized showings have been opened up with a gasoline rock drill as far as possible, it is planned to use an X-ray or Winkie type packsack drill to extend these zones beneath overburden.

Should this property respond to the test, a further payment is required by November 1, 1967 of \$15,000.00 otherwise notice of termination 60 days in advance is required.

3. BRACEBRIDGE COPPER PROPERTY - KIMBERLEY AREA, B. C.

Meridian Explorations Limited, a private company controlled by John Wolfe of Creston, has a 4-year option on the Bracebridge Copper property from Donald Jackson, an engineering employee of Cominco at Kimberley, B. C.

The property consists of 15 claims and Crown Grants located 33 miles by gravel road west of Marysville, B. C., astride the north fork of St. Mary's River on the southeast slope

Mr. W. K. Brown

Page 4

July 10, 1967

3. BRACEBRIDGE COPPER PROPERTY - KIMBERLEY AREA, B. C. (Cont.)

of Armour Peak near Office Creek in the Fort Steele Mining Division. The claims under option are numbered Don 1 - 2, Joe 1 - 2, Goat 1 - 8, Surprise M. C. 3560, Welcome M. C. 1389 and the Enterprise M. C. 1389. Map reference is Kaslo 82F/15E. There is no detailed geology available.

The property was first reported in 1904-05 when a limited surface trenching and short tunnel program exposed copper mineralization in quartz-carbonate veins on the Welcome, Enterprise and Surprise claims at elevations 4360-4700 south of the N. F. St. Mary's River. Old workings north of this river at elevations 5400-6200 are probably of the same age. Both the north and south zones of workings line on strike magnetic north-south and dip 75-45 degrees east for a length of 8000 feet. The intervening country below elevations 4360 is overburdened and covers a strike length over the zone of about one mile.

Newmont Mining Corporation drilled 3 AX size diamond drill holes in the southern extremity of this zone at elevation 4700 on the north boundary of the Welcome 1389 in 1960-1961. The results are unknown but the surface exposures are not impressive. Lenses of quartz veins up to a maximum width of 8 feet carrying chalcopyrite occur in a zone about 25 feet wide as exposed in Enterprise Creek. The host rock is an argillaceous sericite schist.

Cominco drilled 6 holes in the northern extremity of the same zone in 1966 some 8000 feet distant from Newmont's work. One hole (1A) intersected 97.5 feet averaging 1.4% copper and .82 oss. silver. Hole 3 was drilled in the same section but opposite direction and obtained 13.5 feet of 1.3% copper. On surface, the chalcopyrite quartz bearing 3 - 5 foot lenses are

Mr. W. K. Brown

Page 5

July 10, 1967

3. BRACEBRIDGE COPPER PROPERTY - KIMBERLEY, B. C. (Cont.)

irregularly spaced across a drag folded zone 85 feet wide. The surface drag folds suggest a "saddle" type of occurrence and explains why the impressive intersection in Hole 1A was not confirmed in Hole 3. This zone may be as wide as it is long by reason of drag folding. Three surface samples were taken across the 85 foot zone where Cominco worked last season.

A third surface sample across 28 feet was taken at elevation 4360 on the south side of the valley occupied by the north fork of St. Mary's River some 600 feet north and below Newmont's drilling. Extensive underground tunnels occur at this location and is the most impressive on the property.

The sample numbers are 4196, 7, 8, 9 but results are not expected for some time.

With the exception of the last mentioned exposure at elevation 4360, the remainder of the property showings are not impressive. Overburden conceals the full width of mineralization on this latter showing in all directions and deepens down the valley slope on strike to the north towards the north fork St. Mary's River.

An option involving a payment of \$1000. down and doing \$2000. worth of geophysics for a 80% interest is available.

A copy of the data submitted is being forwarded.

Two companion grab samples were taken from 8 surface pits over an area 600 x 1500 covering a mercury prospect south of Waldo, B. C. Cinnabar occurs in fractured limestone.

Diamond Drill Sampling Record

Hole No. 1	Sheet 1	Property Bracebridge	Length 40'	Lat. 2,000 N	Hor. Comp. 31' IX Core	Ver. Comp. 21'
District Ft. Steele M.D.	Bearing 065°	Dep. 2,000 E	Elev. 6,025'	True Dip	Total Recovery % 98	Logged by F. Polder
Commenced June 27, 1966	Dip -31°	Objective Test Cu near main showing	Location 50' north of main showing edit			
Completed July 8, 1966						

Footage From	To	Description	Shorts Feet	Sample No.	Length Feet	Analysis					Recovery %
						SiO ₂	Al ₂ O ₃	FeO	CaO	MgO	
		<u>SUMMARY OF INTERSECTIONS</u>									
		0.0 - 36.0' 36.0 - 40.0'			36.0' 4.0'	0.1 1.25	Tr. Tr.	0.35			
0.0'	40.0'	ARGILLITE: Lgy, variegated, grey green to buff, dolomitic laminae and bands to 2", banding 15-50° to core. Freely mineralized chalcopryite, pyrrhotite.									
		0.0 - 15.0' 15.0' - 36.0' 36.0 - 40.0'	0.6' HL1 HL1	66689 66690 66691	15.0' 21.0' 4.0'	0.045 0.155 1.25	Tr. Tr. Tr.	0.35			
10.0'	13.0'	Dolomitic bed - buff to grey, disseminated pyrrhotite, some chalcopryite along bedding planes.									
15.0'	20.0'	Chalcopryite conformable with banding.									
15.0'	17.0'	Argillaceous quartzite.									
29.0'	33.0'	Minor chalcopryite.									
36.0'	39.0'	Some chalcopryite.									
39.0'	40.0'	Silicified argillite.									
	40.0'	END OF HOLE.									

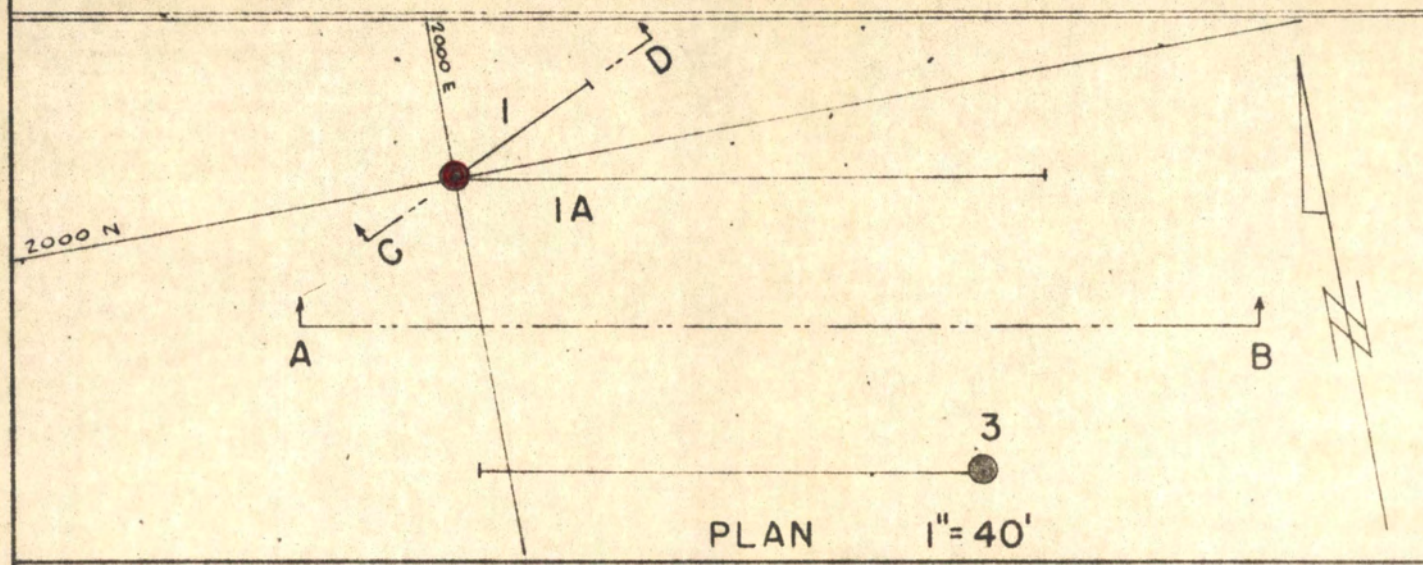
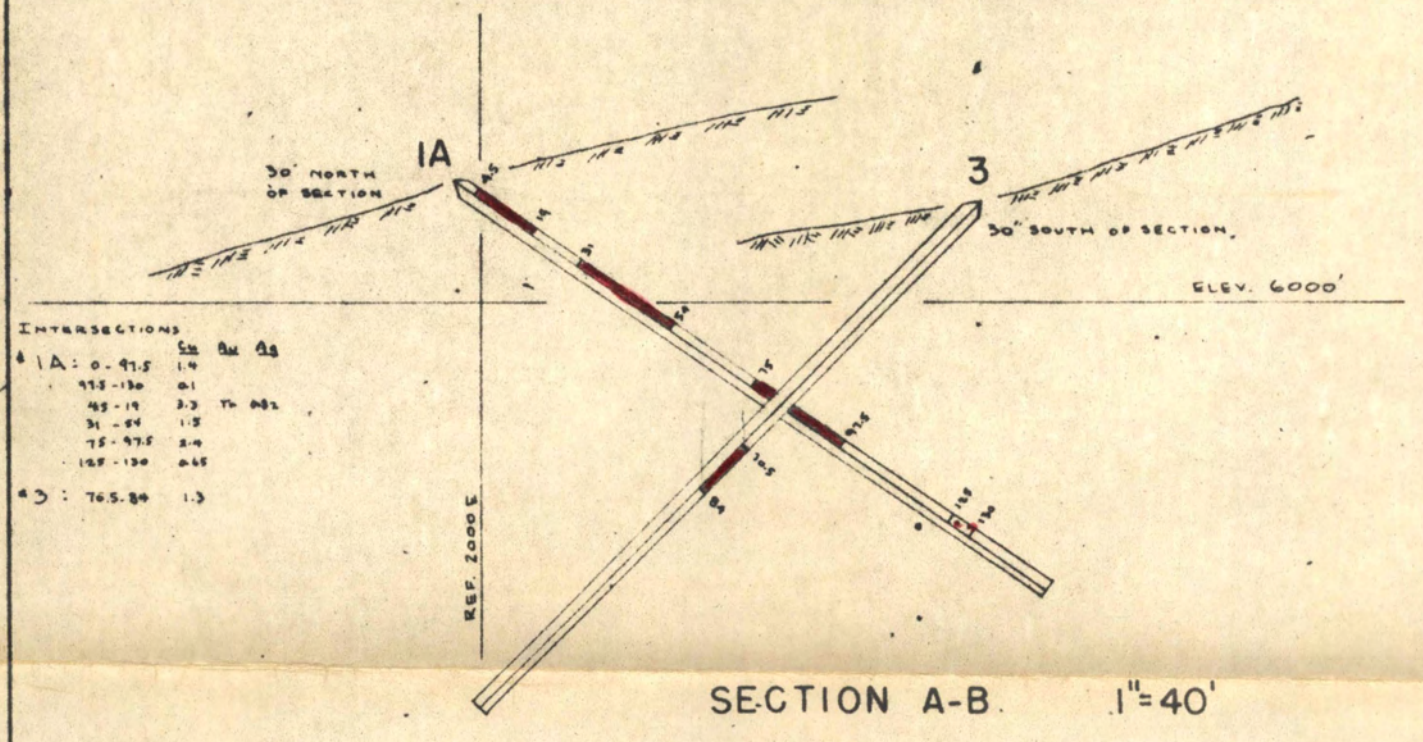
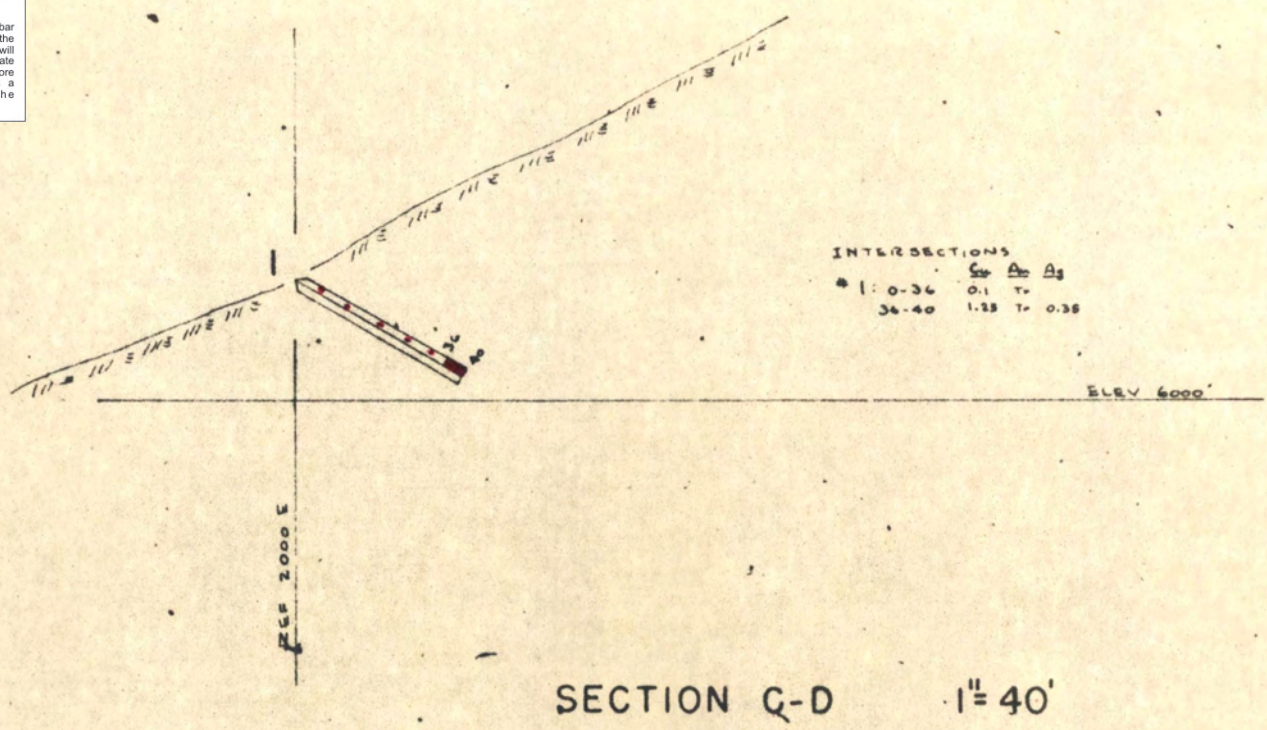
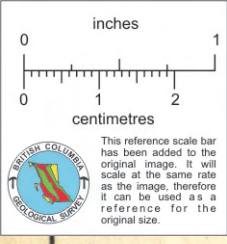

The Consolidated Mining and Smelting Company of Canada Limited

DRAWN BY: REC		TRACED BY:	
REVISED BY	DATE	REVISED BY	DATE

BRACE BRIDGE
DRILL HOLE 1, IA, 3

SCALE: 1" = 40' DATE: FEB 1967 PLATE:

Diamond Drill Sampling Record

Hole No. 1A	Sheet 1						
Property BRACKEN DOE	Length 150'	Lat. 2,000 N	Hor. Comp. 125'	Ver. Comp. 86'			
District Fort Steele N.D.	Bearing 100°	Dep. 2,000 E	Exposure II core	Total Recovery % 86			
Commenced August 1, 1966	Dip -35°	Elev. 6,025'	True Dip	Logged by F. Falder			
Completed " 23, 1966	Objective Test Cu near Main Showing.		Location 50' north of Main Showing Adit.				

Footage From	To	Description	Shorts Feet	Sample No.	Length Feet	Analysis					Recovery %
						% Cu	oz Au/T	oz Ag/T	% Pb	% Zn	
<u>SUMMARY OF INTERSECTIONS</u>											
		0.0' - 97.5'			97.5	1.4					
		97.5' - 130.0'			32.5	0.1					
		4.5' - 19.0'			14.5	3.3	Tr	0.82			
		31.0' - 54.0'			23	1.5					
		75.0' - 97.5'			22.5	2.4					
		125.0' - 130.0'			5	0.65					
0.0'	150.0'	SCHIST: Sericitic quartzose. Interbanded argillite, dolomite. Gray-green, grey and buff. Chalcopyrite conformable with banding and as disseminations.									
0.0'	4.5'	Argillite: Some dolomitic laminae, abundant crenulations, grey-green. Fracturing 35° to core.	0.5								
		0.0' - 4.5'		66678	4.5	0.058	Tr				
4.5'	7.0'	Limy Argillite: 30% dolomite bands, 30% quartz, 40% sericitized material. Schistosity 65° to core. Strong chalcopyrite, often enclosing dolomitic grains.									
		4.5' - 7'		66679	2.5	3.30	Tr	0.70			
7.0'	13.0'	Limy Argillite: Light grey-buff-greenish, some coarse carbonate. Fair to feeble chalcopyrite in bands and disseminations, strong quartz associated with better mineralized sections.	0.3								
		7.0' - 13.0'		66680	6	1.90	Tr	0.55			
13.0'	19.0'	Quartz-sericite schist: Dolomitic, banding 35° to core. Strong chalcopyrite.									
		13.0' - 19.0'		66681	6	4.80	0.005	1.15			

Diamond Drill Sampling Record



Hole No. 1A	Sheet 2			
Property BRACKERIDGE	Length	Lat.	Hor. Comp.	Ver. Comp.
District Fort Steele H.D.	Bearing	Dep.	Etch. at	Total Recovery %
Commenced August 1, 1966	Dip	Elev.	True Dip	Logged by
Completed " 2, 1966	Objective		Location	

Footage From	To	Description	Shorts Feet	Sample No.	Length Feet	Analysis					Recovery %
						% Cu	As/T	Ag/T	% Pb	% Zn	
19.0'	22.0'	Sericite Schist: Thin dolomite bands common, banding 60° to core.									
22.0'	24.0'	Mainly dolomite: Schistosity 50° to core, banding 70-75° to core, strongly fractured. Feeble disseminated chalcocopyrite.									
24.0'	26.0'	Dolomitic Argillite: Interlaminated dolomite and argillite, brown-buff, banding 45° to core. Trace chalcocopyrite.									
26.0'	31.0'	Sericite schist: Dolomitic interlamination.									
		19.0' - 31.0'	0.3	66682	12	0.025					
31.0'	38.0'	Quartz-sericite schist: White, grey, and buff; highly silicified. 1/2"ankerite band 45° to core. Strong chalcocopyrite, banded mineralization 55° to core.	0.5								
		36.0' - 9" carbonate band.									
		31.0' - 38.0'		66685	7	2.10					
38.0'	42.0'	Impure limestone band: Light grey and white, banding 60° to core.	Nil								
		38.0' - 42.0'		66684	4	0.05					
42.0'	45.5'	Quartz: milky and translucent, strong chalcocopyrite.	Nil								
		42.0' - 45.5'		66685	3.5	5.4	0.005	1.30			
45.5'	50.5'	Argillite: light and medium grey, thin bands white quartz, banding 45° to core.									
		45.5' - 50.5'		66686	5	0.64	Tr				

Diamond Drill Sampling Record

Hole No. 1A	Sheet 3			
Property BRACKENRIDGE	Length	Lat.	Hor. Comp.	Ver. Comp.
District Fort Steele M.D.	Bearing	Dep.	Etch. at	Total Recovery %
Commenced August 1, 1966	Dip	Elev.	True Dip	Logged by
Completed " 8, 1966	Objective		Location	

Footage		Description	Shorts Feet	Sample No.	Length Feet	Analysis					Recovery %
From	To					% Cu	Ag/T	As/T	% Pb	% Zn	
50.5'	54.0'	Quartz; weak chalcopyrite.	0.4								
		50.5' - 54.0'		66687	3.5	0.57					
54.0'	60.0'	Limy Argillite: Light grey and buff, dolomitic laminae, tale, thin silicified bands (2") banding 20° to core. Feeble chalcopyrite conformable and disseminated, commonly localized at quartz boundaries.									
		54.0' - 57.0'	1.5	66688	3	0.058					
		57.0' - 60.0'	Nil	66692	3	0.24					
60.0'	73.5'	Sericite Schist: Light grey and buff, some limy laminae, locally talcose or chloritic, quartz stringers with associated chalcopyrite, banding 50° to core.	1.1								
		60.0' - 65.0'		66695	5	0.17	Tr				
		65.0' - 70.0'		66694	5	0.07					
		70.0' - 75.0'		66695	5	0.29	Tr	0.2			
73.5'	85.5'	Limy Argillite: Abundant quartz, strong chalcopyrite, host mineralization commonly associated with brecciated carbonate.									
		75.0' - 80.0'		66696	5	5.0	Tr	1.0			
		80.0' - 85.0'		66697	5	2.3	Tr	0.5			
85.5'	97.5'	Sericite Schist: Interbanded argillite and schist, occasional 1/2" bands ankerite, strong chalcopyrite (Pyrrhotite) at 87' - 91' associated with brecciated carbonate in argillite and quartz host.	2								
		85.0' - 90.0'		66698	5	2.2					
		90.0' - 97.5'		66699	7.5	0.90	Tr	0.2			

Diamond Drill Sampling Record

Hole No. 1A	Sheet 4	Property BRADSHAW RIDGE	Length	Lat.	Hor. Comp.	Ver. Comp.
District Fert Steele M.D.	Bearing	Commenced August 1, 1966	Dip	Dep.	Etch. at	Total Recovery %
Completed " 23, 1966	Objective	Elev.	True Dip	Location	Logged by	

Footage From To	Description	Shorts Feet	Sample No.	Length Feet	Analysis					Recovery %
					% Cu	As/T	Mo/T	% Pb	% Zn	
97.5' 102.5'	Liny Argillite: Grey-green, liny laminae. 100.0' - 2" dolomitic band, 60° to core.	0.3								
	97.5' - 100.0'		87320	2.5	Tr					
102.5' 108.0'	Interbanded quartz sericite schist and impure limestone, banding 50° to core.									
	100.0' - 105.0'		87321	5	0.02					
	105.0' - 110.0'		87322	5	Nil					
108.0' 115.5'	Quartz sericite schist: Green, not liny.									
	110.0' - 115.0'		87323	5	Nil					
115.5' 125.0'	Quartz: Occasional 6" argillite band, brecciated carbonate. No mineralization.									
	115.0' - 120.0'		87324	5	Tr					
	120.0' - 125.0'		87325	5	0.07					
125.0' 139.0'	Quartz sericite schist: White and grey, talcose, 8" section with chalcopyrite.	3								
	125.0' - 130.0'		87326	5	0.65					
	130.0' - 135.0'		87327	5	Nil					
	135.0' - 140.0'		87328	5	"					
139.0' 140.0'	Quartz: Some brecciated carbonate.	0.5								
140.0' 150.0'	Sericite Schist: Abundant carbonate.									
	140.0' - 145.0'		87329	5	Nil					
	145.0' - 150.0'		87330	5	"					

Diamond Drill Sampling Record

Hole No. 1A Sheet 5
 Property BRACKENRIDGE Length _____ Lat. _____ Hor. Comp. _____ Ver. Comp. _____
 District Fort Steele M.D. Bearing _____ Dep. _____ Etch. at _____ Total Recovery % _____
 Commenced August 1, 1966 Dip _____ Elev. _____ True Dip _____ Logged by _____
 Completed " 25, 1966 Objective _____ Location _____

Footage From To	Description	Shorts Feet	Sample No.	Length Feet	Analysis					Recovery %
					% Cu	As/T	Ag/T	% Pb	% Zn	
150.0'	END OF HOLE.									

ROG:mas
 Trail Expl'n Office, Western District
 March 2, 1967

Distribution: Montreal Exploration (1)
 Western Exploration (1)
 Owner (1)
 Field (1)

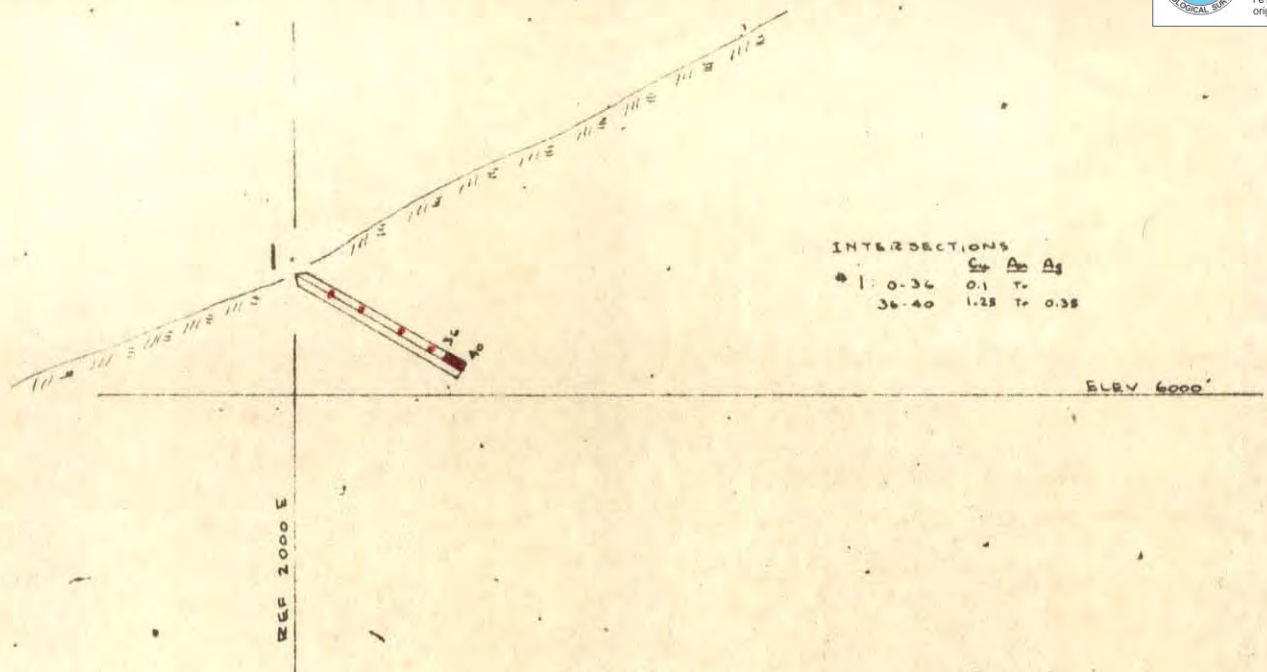
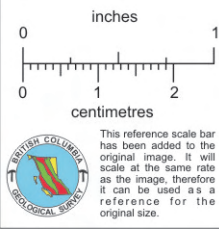

INTERSECTIONS

	Gr	Am	As
# 1: 0-36	0.1	Tr	
36-40	1.25	Tr	0.38

SECTION G-D 1"=40'

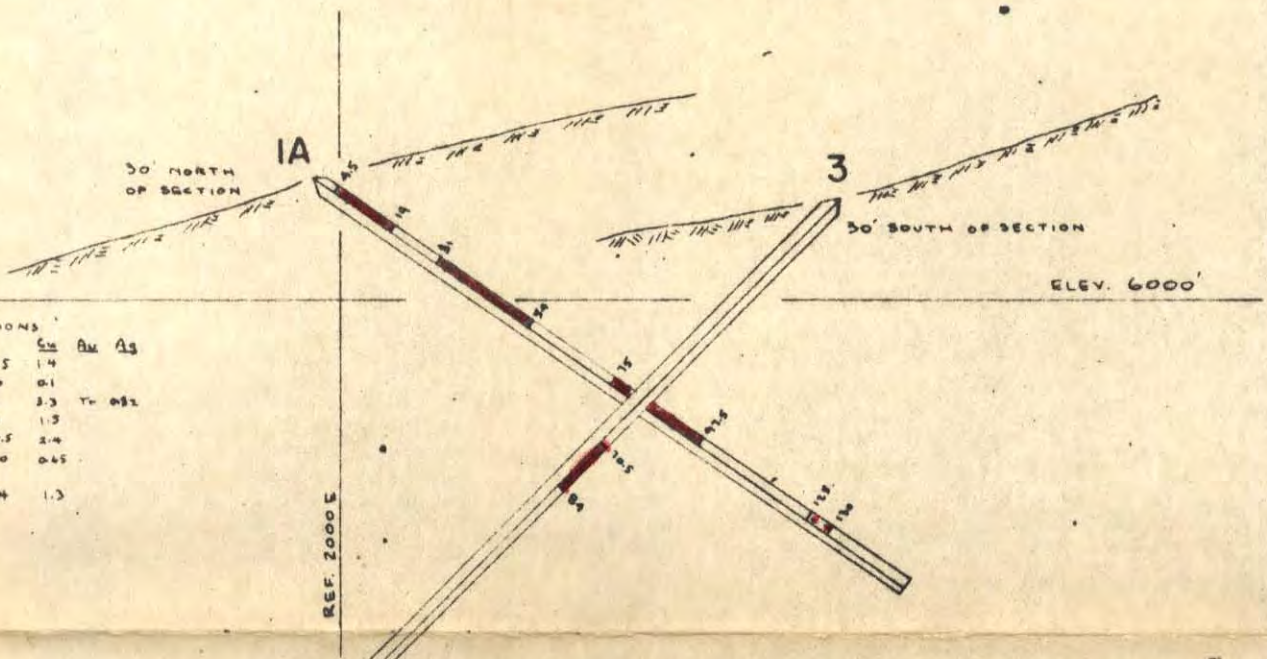

INTERSECTIONS

	Gr	Am	As
# IA: 0-91.5	1.4		
91.5-130	0.1		
45-19	2.3	Tr	0.82
31-54	1.3		
75-97.5	2.4		
128-130	0.45		
# 3: 70.5-84	1.3		

SECTION A-B 1"=40'

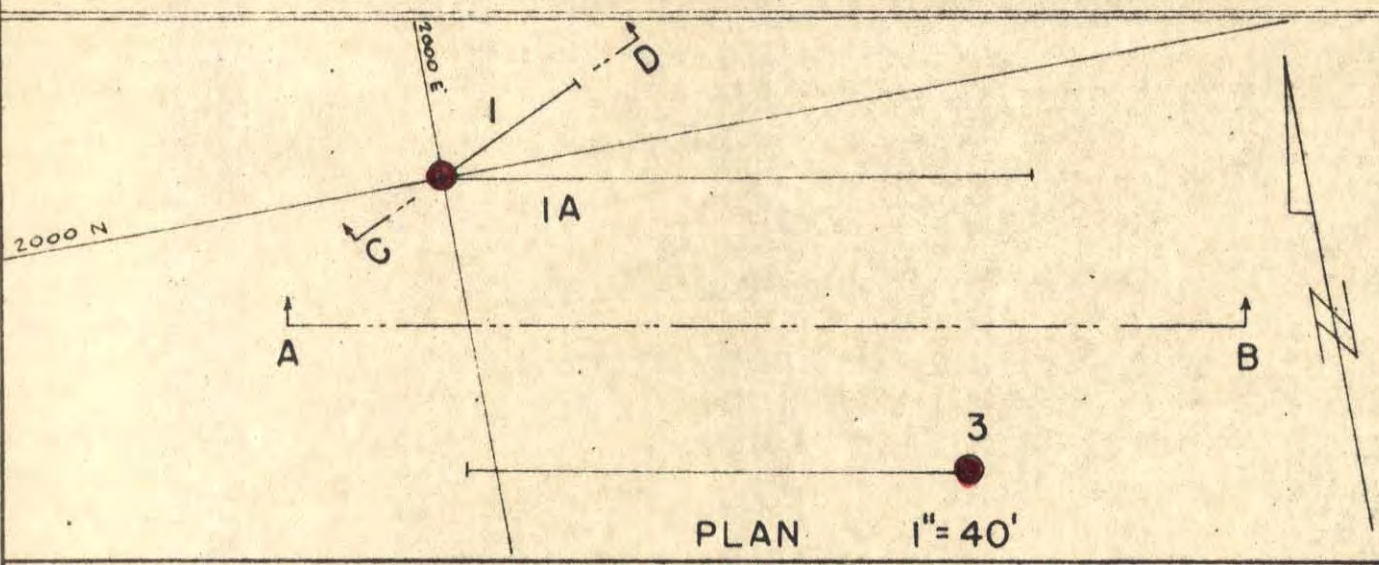

PLAN 1"=40'

The Consolidated Mining and Smelting Company of Canada Limited

DRAWN BY: REC		TRACED BY:	
REVISED BY	DATE	REVISED BY	DATE

BRACEBRIDGE
DRILL HOLE 1, IA, 3

SCALE: 1"=40'	DATE: FEB 1967	PLATE:
---------------	----------------	--------

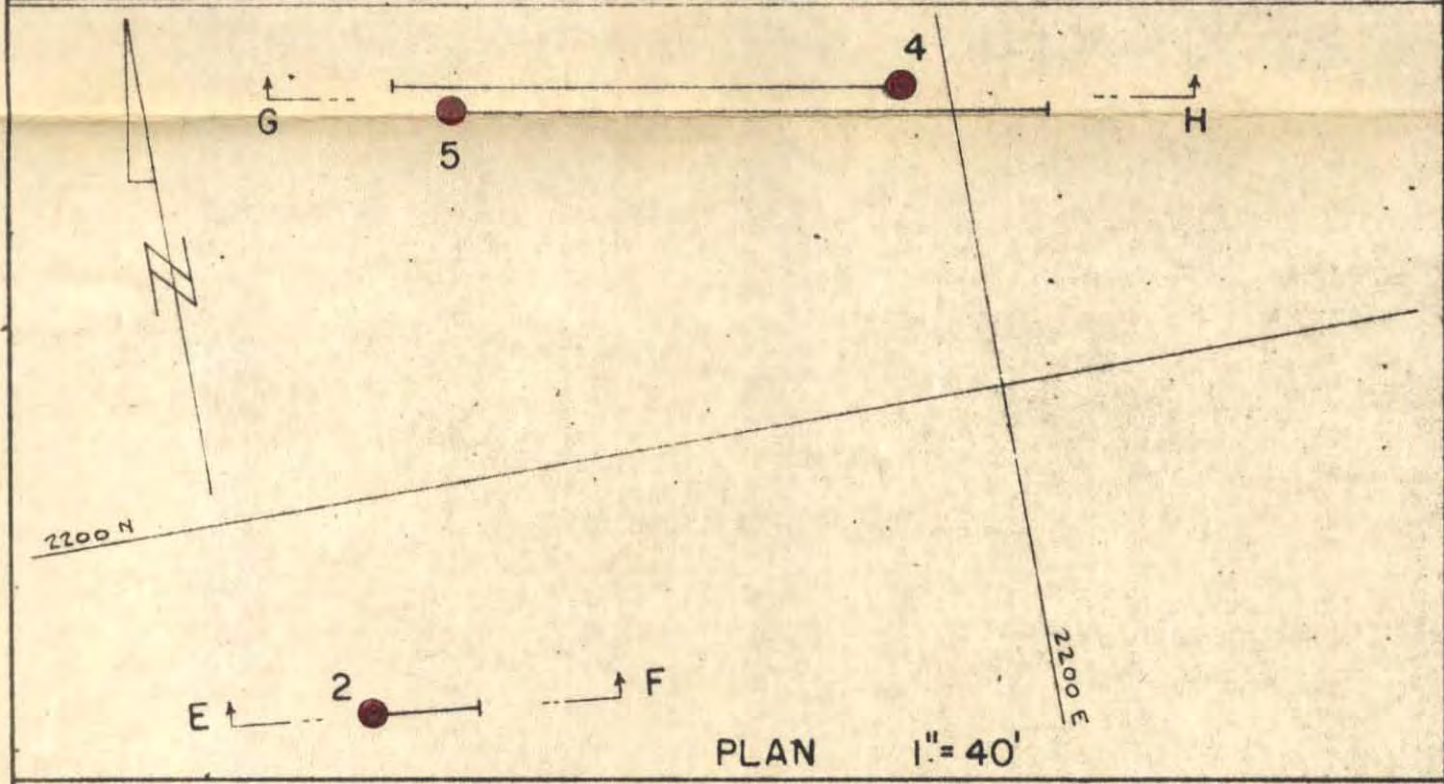
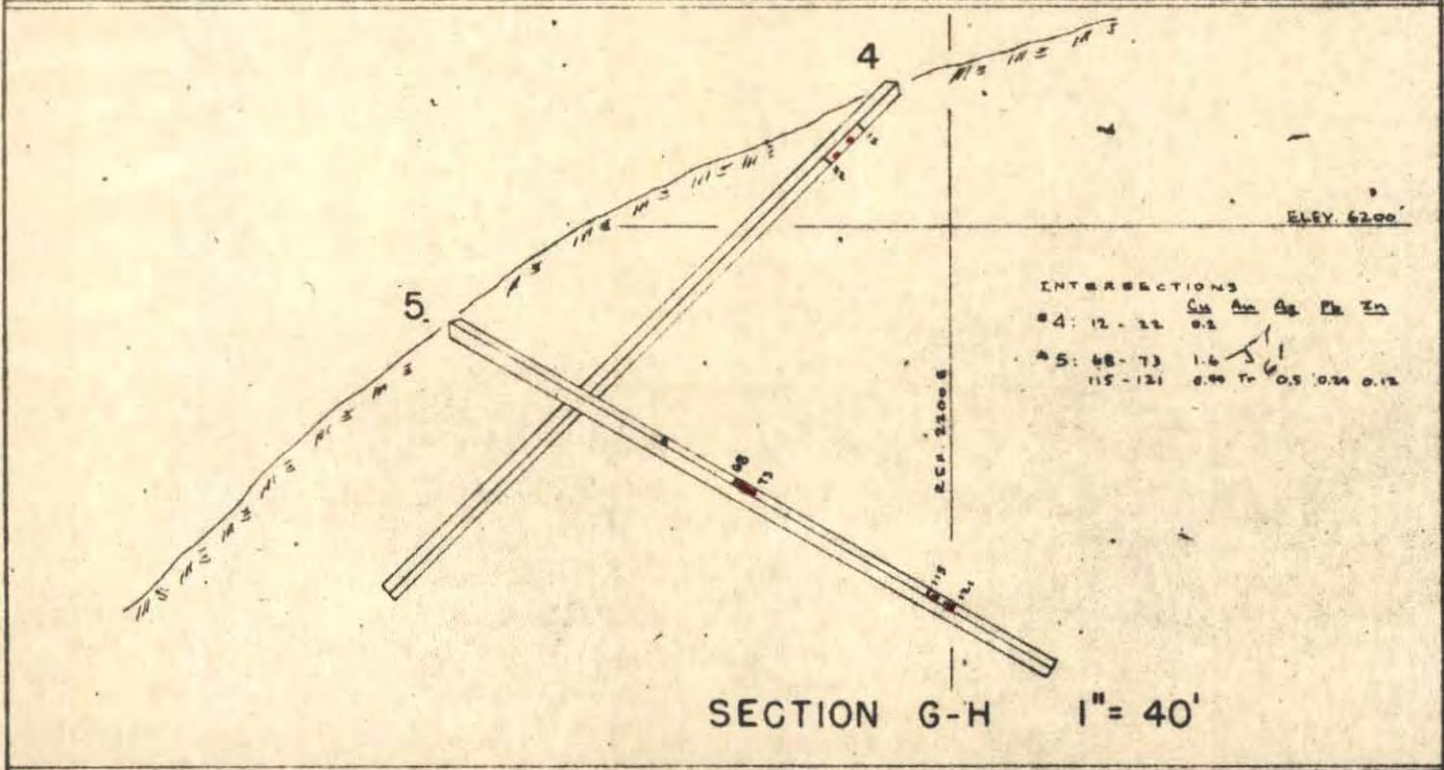
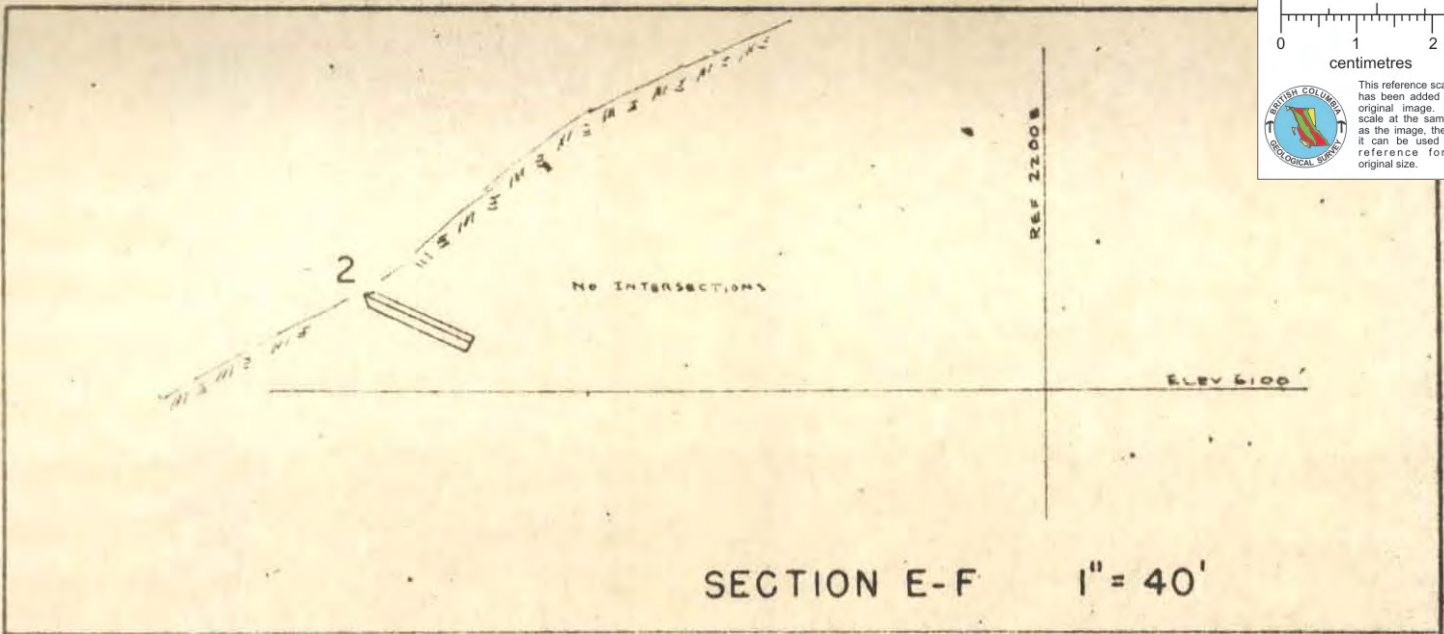
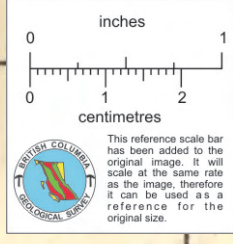

The Consolidated Mining and Smelting Company of Canada Limited

DRAWN BY: RGG		TRACED BY:	
REVISED BY	DATE	REVISED BY	DATE

**BRACEBRIDGE
DRILL HOLE 2, 4, 5**

SCALE: 1" = 40' DATE: FEB 1967 PLATE:

Diamond Drill Sampling Record

Hole No. 3	Sheet 1	Property BRACEBRIDGE	Length 149'	Lat. 1,920 N	Hor. Comp. 105'	Ver. Comp. 105'
District Fort Steele M.D.	Bearing 280°	Commenced July 23, 1966	Dip -45°	Dep. 2,097 E	EL core	Total Recovery % 70
Completed Aug. 29, 1966	Objective Test for Cu near Main Showing.	Elev. 6,020'	True Dip	Location 90' east of Main Showing Adit.	Logged by F. Felder	

Footage From	To	Description	Shorts Feet	Sample No.	Length Feet	Analysis				Recovery %
						% Cu	As/T	Ag/T		
		<u>SIGNIFICANT INTERSECTIONS</u>								
		70.5' - 84.0'			13.5	1.3				
0.0'	13.0'	Argillite: White and buff, sericitic, rusty laminations; dolomitic band at 9' - 10'; quartz sericite schist with weak chalcopyrite at 10' - 11'; dolomitic argillite at 11' - 13' isoclinally crumpled with limbs 25° to core.								
		5.0' - 9.0'	2	66658	4	Nil				
		9.0' - 10.0'	0.3	66659	1	Tr				
		10.0' - 11.0'	Nil	66660	1	Tr	Tr			
		11.0' - 13.0'	"	66661	2	Nil				
13.0'	22.0'	Quartz sericite schist, feeble chalcopyrite and pyrrhotite. Dolomitic band 40° to core at 15' - 16'; rusty ankerite at 19.5' - 20'; schistosity 70-75° to core at 20' - 22'.	1.8							
		13.0' - 15.5'		66662	2.5	Tr				
		15.5' - 16.5'		66663	1	Nil				
		16.5' - 18.0'		66664	1.5	Tr				
		18.0' - 23.5'		66665-66	5.5	0.025				
22.0'	70.5'	Argillite: Grey-green and buff, dolomitic, sericitic, banding 50°-60° to core, feeble chalcopyrite and pyrrhotite.	13.6							
		23.5' - 25.0'		66667	1.5	Nil				
		25.0' - 30.0'		66668	5	"				
		30.0' - 33.5'		66669	3.5	Tr				
		33.5' - 36.0'		66670	2.5	Nil				
		36.0' - 41.0'		66671	5	"				

Diamond Drill Sampling Record

Hole No. 3	Sheet 2			
Property BRACKENRIDGE	Length	Lat.	Hor. Comp.	Ver. Comp.
District Fort Steele M.D.	Bearing	Dep.	Etch. at	Total Recovery %
Commenced July 23, 1966	Dip	Elev.	True Dip	Logged by
Completed Aug. 29, 1966	Objective		Location	

Footage		Description	Shorts Feet	Sample No.	Length Feet	Analysis				Recovery %
From	To					% Cu	Ag/T	Ag/T		
70.5'	84.0'	41.0' - 44.0' 44.0' - 60.0' 60.0' - 70.5' Quartz sericite schist: Grey, buff, subordinate green; dolomitic, strong chalcopyrite. Quartz with carbonate and some silicified argillite at 75' - 79'.	6.5	66672 66673 66674	3 16 10.5	Nil " 0.105 Tr		0.10		
		70.5' - 79.0' 79.0' - 84.0'		66675 66676	8.5 5	1.00 Tr 1.90 Tr		0.45		
84.0'	149.0'	Argillite: Grey, buff, pale green; dolomitic, sericitic, quartzose, sometimes schistose; dolomitic bands sometimes brecciated. Chloritic, talcose at 105' - 106'. Bedding 80° at 115' - 124', 90° at 148' - 149'. Schistosity 80° at 105' - 106'. Trace chalcopyrite at 98' - 99' and 115' - 124'.	20.5							
		84.0' - 91.0' 91.0' - 95.0' 95.0' - 100.0' 100.0' - 105.0' 105.0' - 110.0' 110.0' - 115.0' 115.0' - 120.0' 120.0' - 125.0' 125.0' - 130.0' 130.0' - 135.0' 135.0' - 140.0' 140.0' - 145.0' 145.0' - 149.0'		66677 87331 87332 87333 87334 87335 87336 87337 87338 87339 87340 87341 87342	7 4 5 5 5 5 5 5 5 5 5 5 4	Nil Tr Tr Nil Nil " Tr Tr Nil Nil Nil Tr Tr				

Diamond Drill Sampling Record

Hole No. 3	Sheet 3			
Property BACERIDGE	Length	Lat.	Hor. Comp.	Ver. Comp.
District Fort Steele N.D.	Bearing	Dep.	Etch. at	Total Recovery %
Commenced July 25, 1966	Dip	Elev.	True Dip	Logged by
Completed Aug. 29, 1966	Objective		Location	

Footage From	To	Description	Shorts Feet	Sample No.	Length Feet	Analysis					Recovery %
						% Cu	% Zn	% Pb	% Ag	% S	
		<p>149.0'</p> <p>END OF HOLE.</p> <p>0.0' - 90.0' commenced July 25, completed July 28.</p> <p>90.0' -149.0' " August 24, " August 29.</p>									

RGG:smc
 Trail Expl'n Office, Western District
 March 3, 1967

Distribution: Montreal Exploration (1)
 Western Exploration (1)
 Owner (1)
 Field (1)

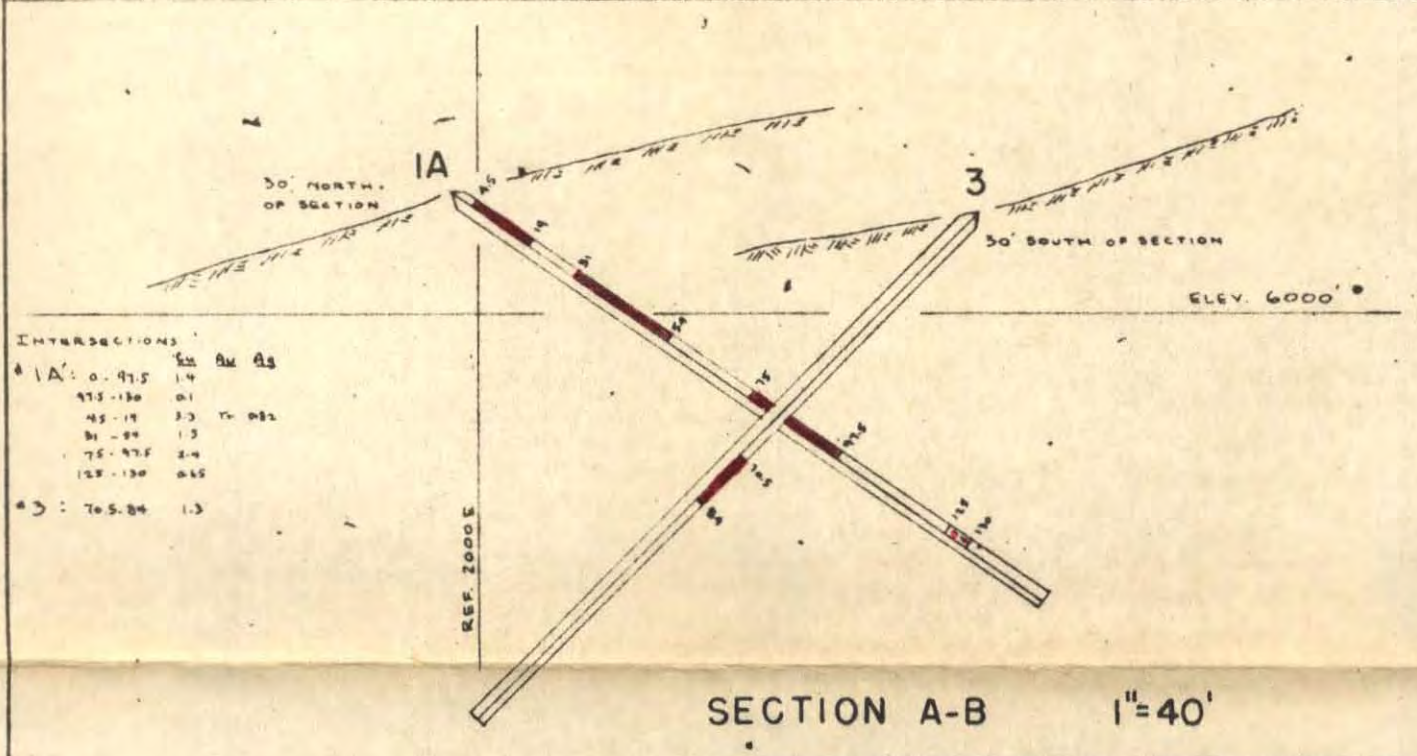
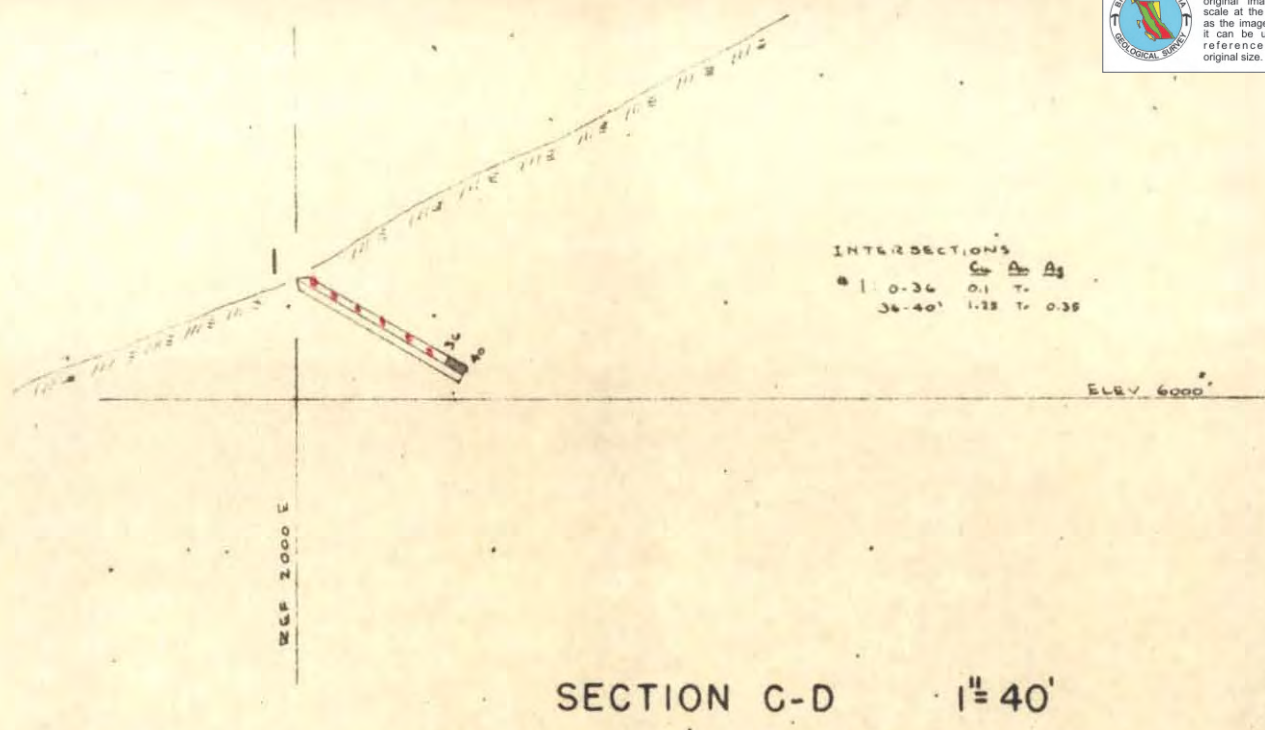
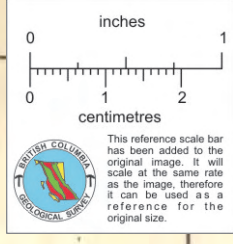

INTERSECTIONS

IA:	0-91.5	1.4
	97.5-130	0.1
	45-19	3.3 T. 0.82
	81-89	1.3
	75-97.5	2.4
	125-130	0.15
3:	70.5-84	1.3

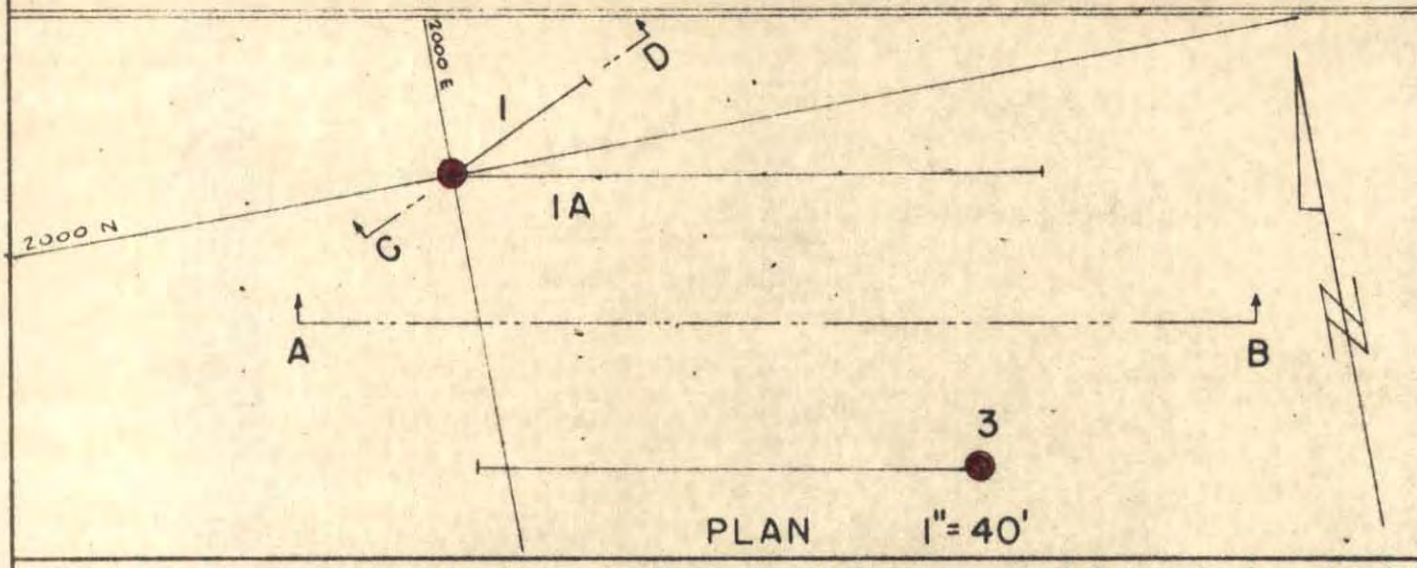

The Consolidated Mining and Smelting Company of Canada Limited

DRAWN BY: <i>RCC</i>		TRACED BY:	
REVISED BY	DATE	REVISED BY	DATE

BRACE BRIDGE
DRILL HOLE 1, IA, 3

SCALE: 1" = 40' DATE: FEB 1967 PLATE:

Diamond Drill Sampling Record

Hole No.	5	Sheet	1				
Property	BRACENT DOE	Length	145'	Lat.	2,276 N	Hor. Comp.	125'
District	Fort Steele N.D.	Bearing	100°	Dep.	2,098 E	Elevation	El Core
Commenced	Sept. 8, 1966	Dip	-30°	Elev.	6,180'	True Dip	
Completed	" 23, 1966	Objective	Test for Cu on strike north of Main Showing.		Location	350' north of Main Showing Adit.	
						Ver. Comp.	72'
						Total Recovery %	96
						Logged by	R.G. Gifford

Footage From	To	Description	Shorts Feet	Sample No.	Length Feet	Analysis					Recovery %
						% Cu	As/T	Ag/T	% Pb	% Zn	
		<u>SUMMARY OF INTERSECTIONS</u>									
		68.0' - 73.0'			5	1.60					
		115.0' - 121.0'			6	0.44	Tr	0.5	0.24	0.12	
0.0'	58.0'	SCHISTS: Mainly sericitic, also talcose and calcareous. Inter-banded light and dark grey in equal proportion. Generally laminated, usually 1/8" or less. Rare quartz veins. Bedding crumpled, characteristically shear folded (specimen at 53'), cleavage usually at greater angle to core than bedding (specimen at 41').									
0.0'	14.0'	Spotted texture, andalusite? (specimen at 10').									
		0.0' - 7.0' - Bedding crumpled, mainly 45° to core.									
		7.0' - 14.0' - " " " parallel to core.									
14.0'	58.0'	Bedding crumpled, mainly 45° to core. 15.0' - 6" quartz vein. 20.0' - 1" quartz vein. 35.0' - Siliceous for 6".									
58.0'	145.0'	DOLOMITIC SCHISTS: Dove grey, dark green; 30% dolomitic bands and pods (1"-3") interbanded with chloritic, sericitic schists. Chloritic (green) and sericitic (grey) zones alternate in 2' - 10' lengths. Contrasts with overlying unit by chloritic and dolomitic nature. Bedding crumpled and sheared as above, mainly 45° to core but all gradations		4484	5	0.018					

Diamond Drill Sampling Record

Hole No. 5	Sheet 3			
Property BRACKERIDGE	Length	Lat.	Hor. Comp.	Ver. Comp.
District Fort Steele M.D.	Bearing	Dep.	Etch. at	Total Recovery %
Commenced Sept. 8, 1966	Dip	Elev.	True Dip	Logged by
Completed 28, 1966	Objective		Location	

Footage From To	Description	Shorts Feet	Sample No.	Length Feet	Analysis				Recovery %
					% Cu	% Ag	% Pb	% Zn	
	Sample 121.0' - 125.0'		4497	5	0.011				
	125.0' - 131.0'		4498	5	0.009				
	131.0' - 136.0'		4499	5	0.011				
135.0' 145.0'	Sparse chalcopyrite.								
	Sample 136.0' - 141.0'		4500	5	0.009				
	141.0' - 145.0'		4401	4	0.09				
145.0'	END OF HOLE.								
	Shorts 0.0' - 40.0'	4		40					90%
	40.0' - 98.0'	N11		58					100%
	98.0' - 111.0'	1		13					90%
	111.0' - 145.0'	N11		34					100%

RGG:mc
 Trail Exploration Office, Western District
 March 3, 1967
 Distribution: Montreal Exploration (1)
 Western Exploration (1)
 Owner (1)
 Field (1)

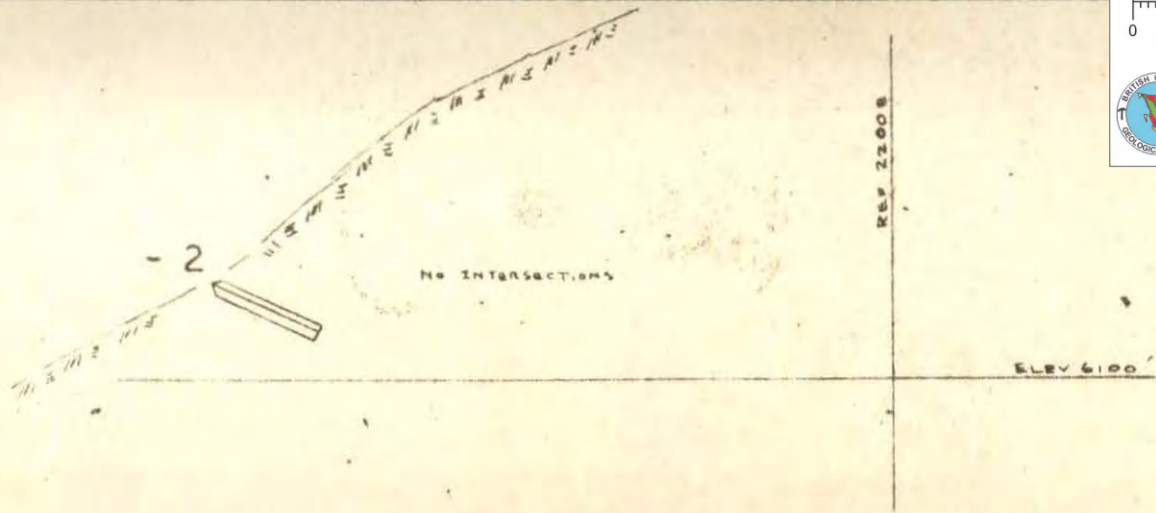
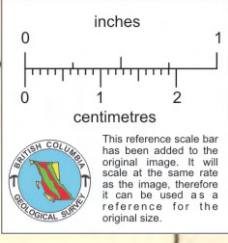

SECTION E-F 1" = 40'

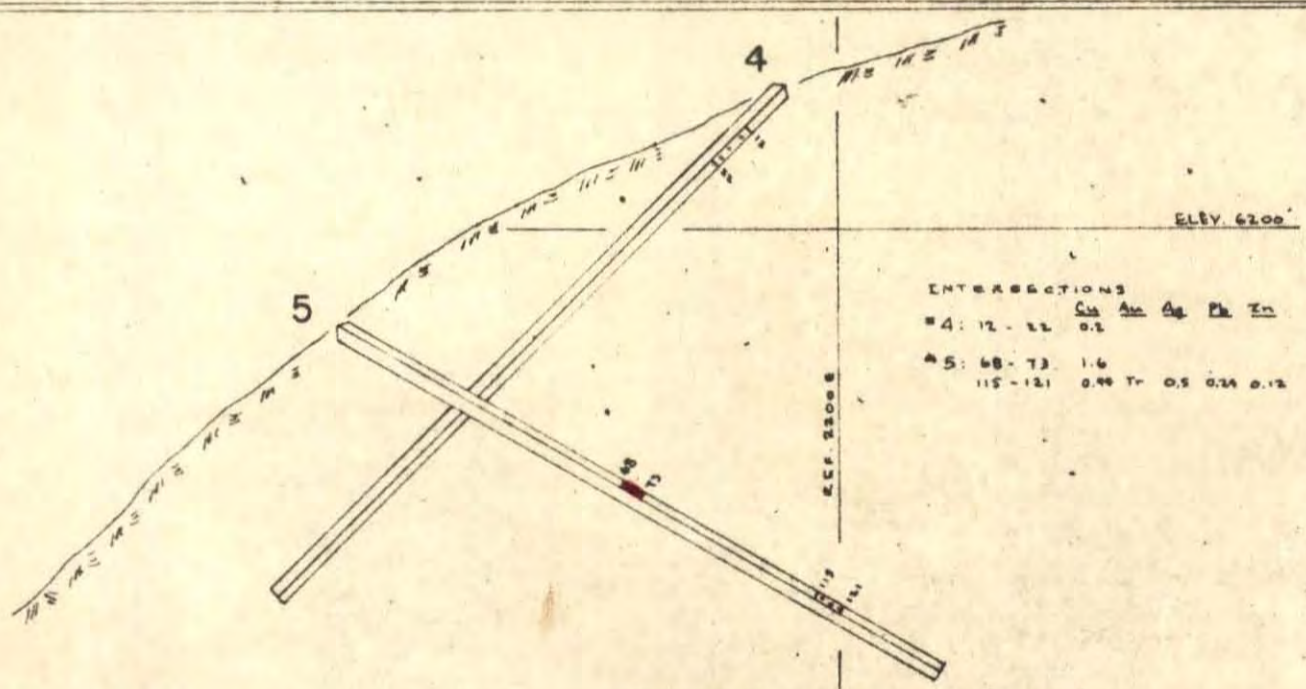

SECTION G-H 1" = 40'

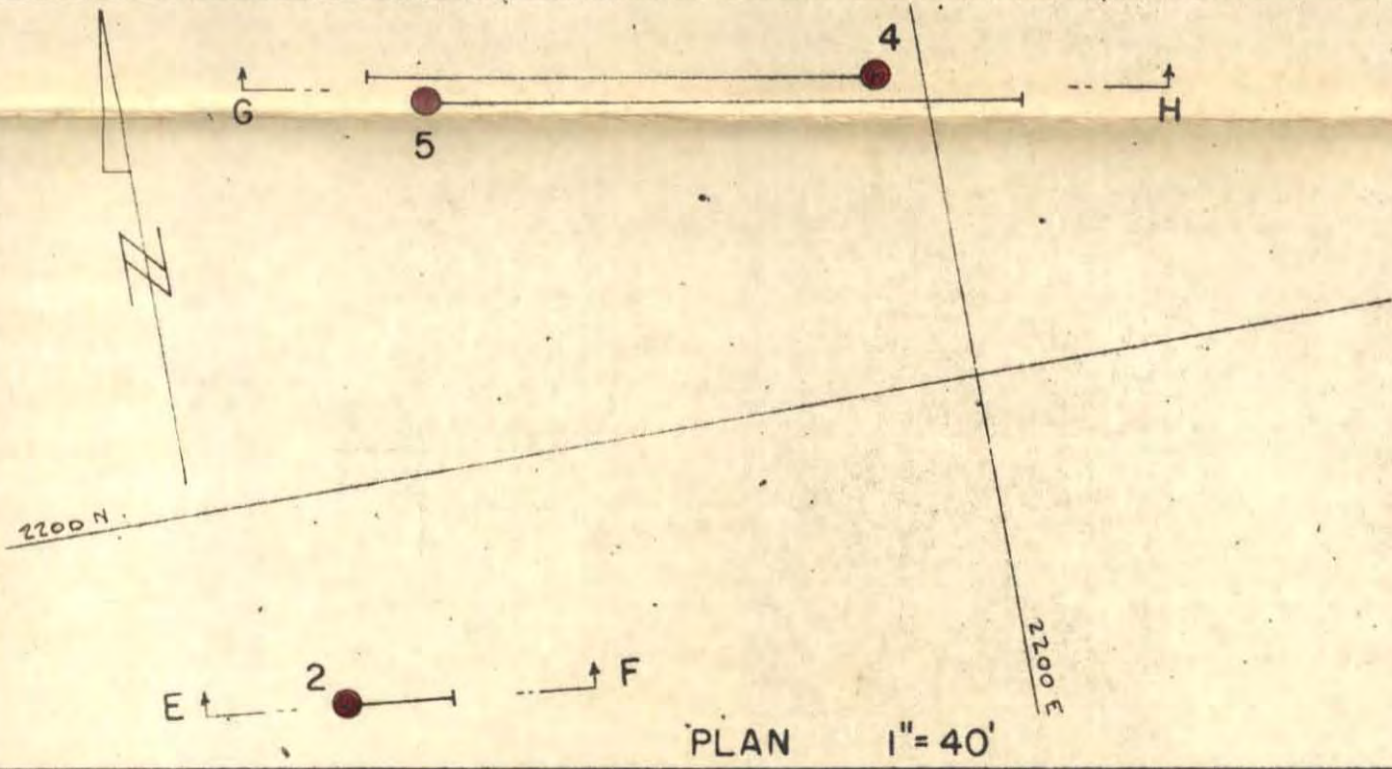

PLAN 1" = 40'

The Consolidated Mining and Smelting Company of Canada Limited

DRAWN BY: RGG		TRACED BY:	
REVISED BY	DATE	REVISED BY	DATE

BRACEBRIDGE
DRILL HOLE 2, 4, 5

SCALE: 1" = 40' DATE: FEB 1967 PLATE:

The Consolidated Mining and Smelting Company of Canada Limited

ASSAY CERTIFICATE

KIMBERLEY, B.C. AUGUST 16 1966

G. WEBBER SPECIALS

Hold No.	DESCRIPTION	Lot	Moisture %	Gold OZ.	Silver OZ.	Copper Wet %	Lead Wet %	Zinc Wet %	Iron Wet %	Sulphur %	Insol. %	Alumina %	Lime %	Mag. %	Bone Phosph. %	%	%	%
0° 15°	66689 C ✓					.045												
15° 36°	66690 C ✓			TRACE		.155												
36° 40°	66691 C ✓			TRACE	0.35	1.25												

OFFICIAL SERIAL No. 4527

ASSAYER

CHIEF ASSAYER *H. White*

The Consolidated Mining and Smelting Company of Canada Limited

ASSAY CERTIFICATE

G. WEBBER SPECIALS

KIMBERLEY, B.C. AUGUST 16 1966

From	To	DESCRIPTION	Lot	Moisture %	Gold Ozs.	Silver Ozs.	Copper Wet %	Lead Wet %	Zinc Wet %	Iron Wet %	Sulphur %	Insol. %	Alumina %	Lime %	Mag. %	Bone Phosph. %	%	%	%
4 ⁶	7 ⁰	66679 C	✓		TRACE	0.70	3.30												
7 ⁰	12 ⁸	66680 C	✓		TRACE	0.55	1.90												
12 ⁸	19 ³	66681 C	✓		.005	1.15	4.80												
19 ³	31 ³	66682 C	✓				.025												
31 ³	35 ⁹	66683 C	✓				2.10												
35 ⁹	42 ⁰	66684 C	✓				.05												
42 ⁰	45 ⁶	66685 C	✓		.005	1.30	5.4												
45 ⁶	50 ⁶	66686 C	✓		TRACE		.064												
50 ⁶	54 ⁰	66687 C	✓				.57												
54 ⁰	57 ⁰	66688 C	✓				.038												

OFFICIAL SERIAL No. 4528

ASSAYER

CHIEF ASSAYER H. White

The Consolidated Mining and Smelting Company of Canada Limited

ASSAY CERTIFICATE

KIMBERLEY, B.C. AUGUST 16 1966

G. WEBBER SPECIALS

Hole No. 3	DESCRIPTION	Lot	Moisture %	Gold Oza.	Silver Oza.	Copper Wet %	Lead Wet %	Zinc Wet %	Iron Wet %	Sulphur %	Insol. %	Alumina %	Lime %	Mag. %	Bone Phosph. %	%	%	%
From To 5° 9°	66658 C ✓					NIL												
9° 10°	66659 C ✓					TRACE												
10° 11°	66660 C ✓			TRACE		TRACE												
11° 13°	66661 C ✓					NIL												
13° 15°	66662 C ✓					TRACE												
15° 16°	66663 C ✓					NIL												
16° 18°	66664 C ✓					TRACE												
18° 22°	66665, 66666 (Two TAGS) ✓			TRACE		.025												
23° 25°	66667 C ✓					NIL												
25° 30°	66668 C ✓					NIL												

OFFICIAL SERIAL No. 4526

ASSAYER

CHIEF ASSAYER H. White

The Consolidated Mining and Smelting Company of Canada Limited

ASSAY CERTIFICATE

KIMBERLEY, B.C. AUGUST 16 1966

G. WEBBER SPECIALS

Hole 3 (cont'd) From To	DESCRIPTION	Lot	Moisture %	Gold Ozs.	Silver Ozs.	Copper Wet %	Lead Wet %	Zinc Wet %	Iron Wet %	Sulphur %	Insol. %	Alumina %	Lime %	Mag. %	Bone Phosph. %	%	%	%
30° 33°	66669 C ✓					TRACE												
33° 36°	66670 C ✓					NIL												
36° 41°	66671 C ✓					NIL												
41° 44°	66672 C ✓					NIL												
44° 60°	66673 C ✓					NIL												
60° 70°	66674 C ✓			TRACE	0.10	0.103												
70° 79°	66675 C ✓			TRACE		1.00												
79° 84°	66676 C ✓			TRACE	0.45	1.90												
84° 91°	66677 C ✓					NIL												
Hole 1A 0° 4°	66678 C ✓			TRACE		0.038												

OFFICIAL SERIAL No. 4527

ASSAYER

CHIEF ASSAYER K. White

The Consolidated Mining and Smelting Company of Canada Limited

ASSAY CERTIFICATE

KIMBERLEY, B.C. AUGUST 17 1966

G WEBBER SPECIALS

From	To	DESCRIPTION	Est. Exp. No.	Moisture %	Gold Ozs.	Silver Ozs.	Copper Wet %	Lead Wet %	Zinc Wet %	Iron Wet %	Sulphur %	Insol. %	Alumina %	Lime %	Mag. %	Bone Phosph. %	%	%	%
55°	60°	46658 ✓	46920				0.24												
60°	65°	46659 ✓	46930		TRACE		0.17												
65°	70°	46660 ✓	46940				0.07												
70°	75°	46661 ✓	46950		TRACE	.2	0.29												
75°	80°	46662 ✓	46960		TRACE	1.0	5.0												
80°	85°	46663 ✓	46970		TRACE	.5	2.3												
85°	90°	46664 ✓	46980				2.2												
90°	97.5	46665 ✓	46990		TRACE	.2	0.90												
Grab Sample		46666	47000		TRACE	.05	NIL	.01	.02										

OFFICIAL SERIAL No. 4530

ASSAYER

CHIEF ASSAYER R. White

The Consolidated Mining and Smelting Company of Canada Ltd

ASSAY CERTIFICATE

KIMBERLEY, B.C.

1965

G. L. W. SPECIALS DRILL CORE

DESCRIPTION	Lot	Moisture %	Gold Oza.	Silver Ozs.	Copper Wet %	Lead Wet %	Zinc Wet %	Iron Wet %	Sulphur %	Insol. %	Alumina %	Lime %	Mag. %	Bone Phosph. %	%	%	%
87320					TRACE												
87321					.02												
87322					NIL												
87323					NIL												
87324					TRACE												
87325					.07												
87326					.65												
87327					NIL												
87328					NIL												
87329					NIL												

OFFICIAL SERIAL No. 4532

ASSAYER

CHIEF ASSAYER

H. White

The Consolidated Mining and Smelting Company of Canada Limited

ASSAY CERTIFICATE

KIMBERLEY, B.C. AUGUST 31 1946

G. L. WEBBER SPECIAL DRILL CORE

DESCRIPTION	Lot	Moisture %	Gold Ozs.	Silver Ozs.	Copper Wet %	Lead Wet %	Zinc Wet %	Iron Wet %	Sulphur %	Insol. %	Alumina %	Lime %	Mag. %	Bone Phosph. %	%	%	%
87331 C					TRACE												
87332 C					TRACE												
87333 C					NIL												
87334 C					NIL												
87335 C					NIL												
87336 C					TRACE												
87337 C					TRACE												
87338 C					NIL												
87339 C					NIL												
87340 C					NIL												

OFFICIAL SERIAL No. 4533

ASSAYER

CHIEF ASSAYER H. C. Hill

The Consolidated Mining and Smelting Company of Canada Limited

ASSAY CERTIFICATE

DRILL CORE KIMBERLEY EXPLORATION

KIMBERLEY, B.C.

OCTOBER 20 1916

DESCRIPTION	Lot	Moisture %	Gold Ozs.	Silver Ozs.	Copper Wet %	Lead Wet %	Zinc Wet %	Iron Wet %	Sulphur %	Insol. %	Alumina %	Lime %	Mag. %	Bone Phosph. %	%	%	%
4401					0.09												
4476					0.003												
4477					0.029												
4478					0.21												
4479					0.18												
4480					0.11												
4481					0.017												
4482					0.12												
4483					0.076												
4484					0.018												

OFFICIAL SERIAL No. 4547

ASSAYER

CHIEF ASSAYER *N. C. Trenholm*

The Consolidated Mining and Smelting Company of Canada Limited

ASSAY CERTIFICATE

DRILL CORE *KIMBERLEY EXPLORATION*

KIMBERLEY, B.C.

OCTOBER 20 1966

DESCRIPTION	Lot	Moisture %	Gold Oza.	Silver Oza.	Copper Wet %	Lead Wet %	Zinc Wet %	Iron Wet %	Sulphur %	Insol. %	Alumina %	Lime %	Mag. %	Bone Phosph. %	%	%	%
4485					0.077												
4486					0.26												
4487					1.60												
4488					0.09												
4489					0.13												
4490					0.205												
4491					0.028												
4492					0.012												
4493					0.006												
4494					0.007												

OFFICIAL SERIAL No. *4548*

ASSAYER

for CHIEF ASSAYER *N. A. Tenkalan*

The Consolidated Mining and Smelting Company of Canada Limited

ASSAY CERTIFICATE

DRILL CORE KIMBERLEY EXPLORATION

KIMBERLEY, B.C. OCTOBER 20 1966

DESCRIPTION	Lot	Moisture %	Gold Oza.	Silver Oza.	Copper Wet %	Lead Wet %	Zinc Wet %	Iron Wet %	Sulphur %	Insol. %	Alumina %	Lime %	Mag. %	Bone Phosph. %	%	%	%
4495					0.03												
4496			Trace	0.5	0.44	0.24	0.12										
4497					0.011												
4498					0.009												
4499					0.011												
4500					0.009												

OFFICIAL SERIAL No. 4549

ASSAYER

CHIEF ASSAYER N. A. Teubholm

CYPRUS EXPLORATION CORPORATION, LTD.
510 WEST HASTINGS STREET
VANCOUVER 2, B.C.

T
S
L

cc: WKB

Laboratories Limited

325 HOWE STREET - VANCOUVER 1, B.C.
TELEPHONE 684-1374

ASSAYERS
CHEMISTS
GEOCHEMISTS

CERTIFICATE OF ANALYSIS

SAMPLE(S) FROM Mr. D. W. Tully

REPORT NO.
V-2441

SAMPLE(S) OF ROCK BRACEBRIDGE Property
MERCURY Property

File

Sample No.	Gold (Au) oz:ton	Silver (Ag) oz:ton	Copper (Cu)%	Mercury (Hg)%
<u>DWT</u> 4196	0.02	4.60	19.42	---
<u>S.J.H.</u> 4197	0.02	0.40	2.42	---
<u>DWT</u> 4198	0.005	trace	1.84	---
<u>DWT</u> 4199	trace	2.10	11.00	---
<u>DWT</u> 3801	---	---	---	0.052
<u>DWT</u> 4200	---	---	---	0.043

E. Marysville Area

↓
SHOWING AT
N. END PROP.
Cominco 1966
option
S. END PROP.
Near Waldo
B.C.

TO	DATE
RETURN TO	COMMENTS
JUL 24 1967	
WKB	5
	6
	7
	8

oz:ton - Troy ounces per 2,000 lbs.

DATE July 19, 1967

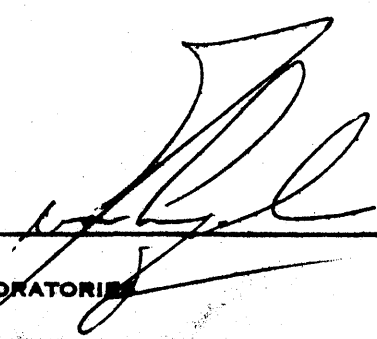
SIGNED 

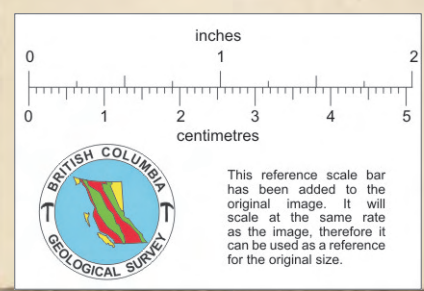
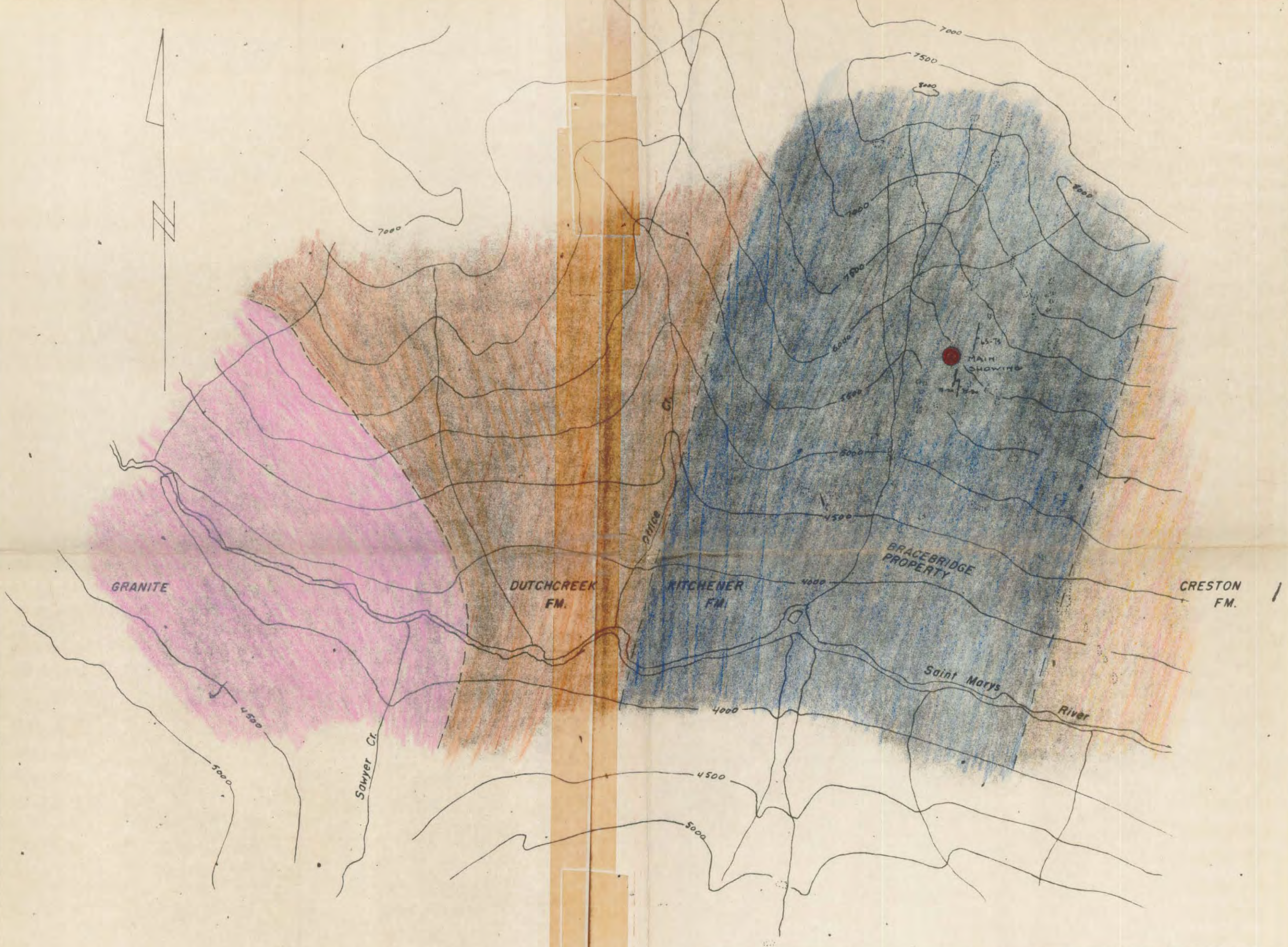

			
Drawn by: <i>FF.</i>		Traced by	
Revised by	Date	Revised by	Date
BRACEBRIDGE GEOLOGY		Scale: 1" = 1320'	Date: Sept. 9, 1966
			Plate:

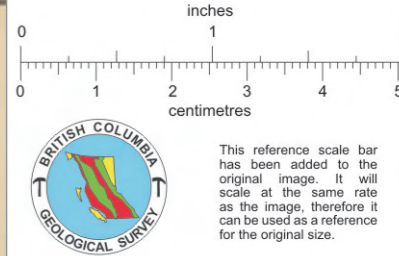



2200 N

2000 N

2000 E

2200 E

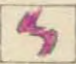
SURVEY CONTROL :
CHAIN, COMPASS, ALTIMETER

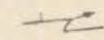
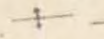
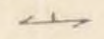
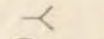
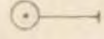
-  MINERALIZATION
-  SCHIST, ARGILLITE, DOLOMITE
- BEDDING, PLUNGE OF SMALL FOLDS 
- ANTICLINE, SYNCLINE 
- SCHISTOSITY 
- ADIT 
- DRILL HOLE 



Drawn by:	FF	Traced by:	
Revised by:	Date	Revised by:	Date
RCG	Feb/67		

BRACEBRIDGE
GEOLOGY

Scale: 1" = 40'

Date: SEPT. 1966

Plate:

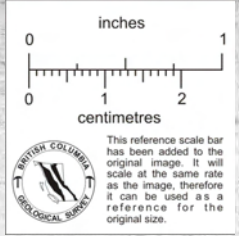

164

HILLSIDE DOWN ↑

COUNTRY ROCK IS ARGILLITE EXCEPT AS INDICATED.

Hg Showing.
 B.D. Pearson June 21, 1967
 1" = 100'

ORIG. SULFIDE THICKNESS ABOUT ONE FOOT MAX.

COMPLETELY OXIDIZED VEIN STRIKING APPROX. E-W.

HILLSIDE DOWN ↑

Ls Bluffs

↑ ~ 150

VIEW POINT

CLAIM LINE
 Az. ~ 164°

PATH

N ↑

↑ ~ 150

Ls & Py, Cin.

Bottle

ROAD

CIN. ON ROAD ~ 300' SOUTH

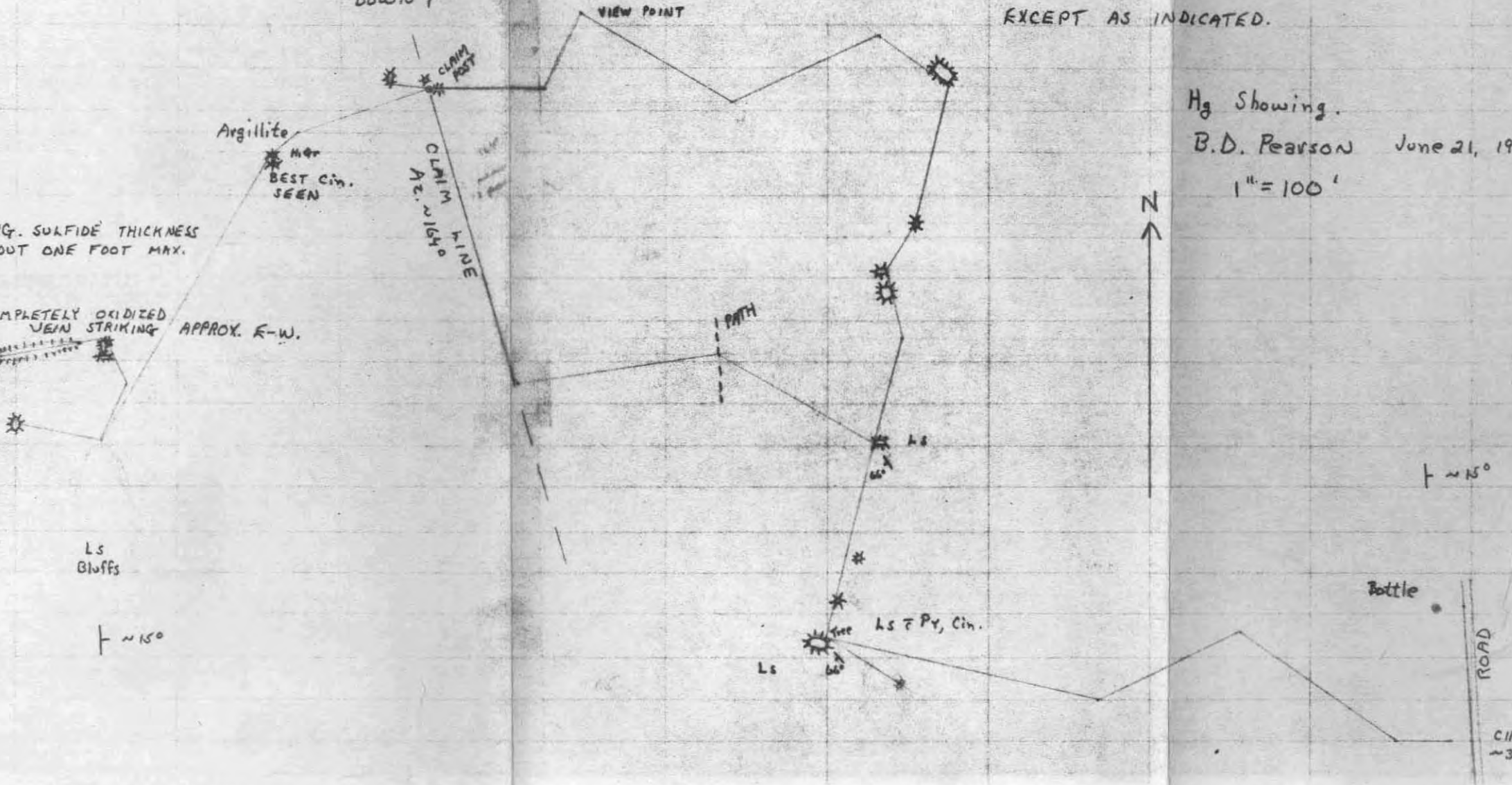

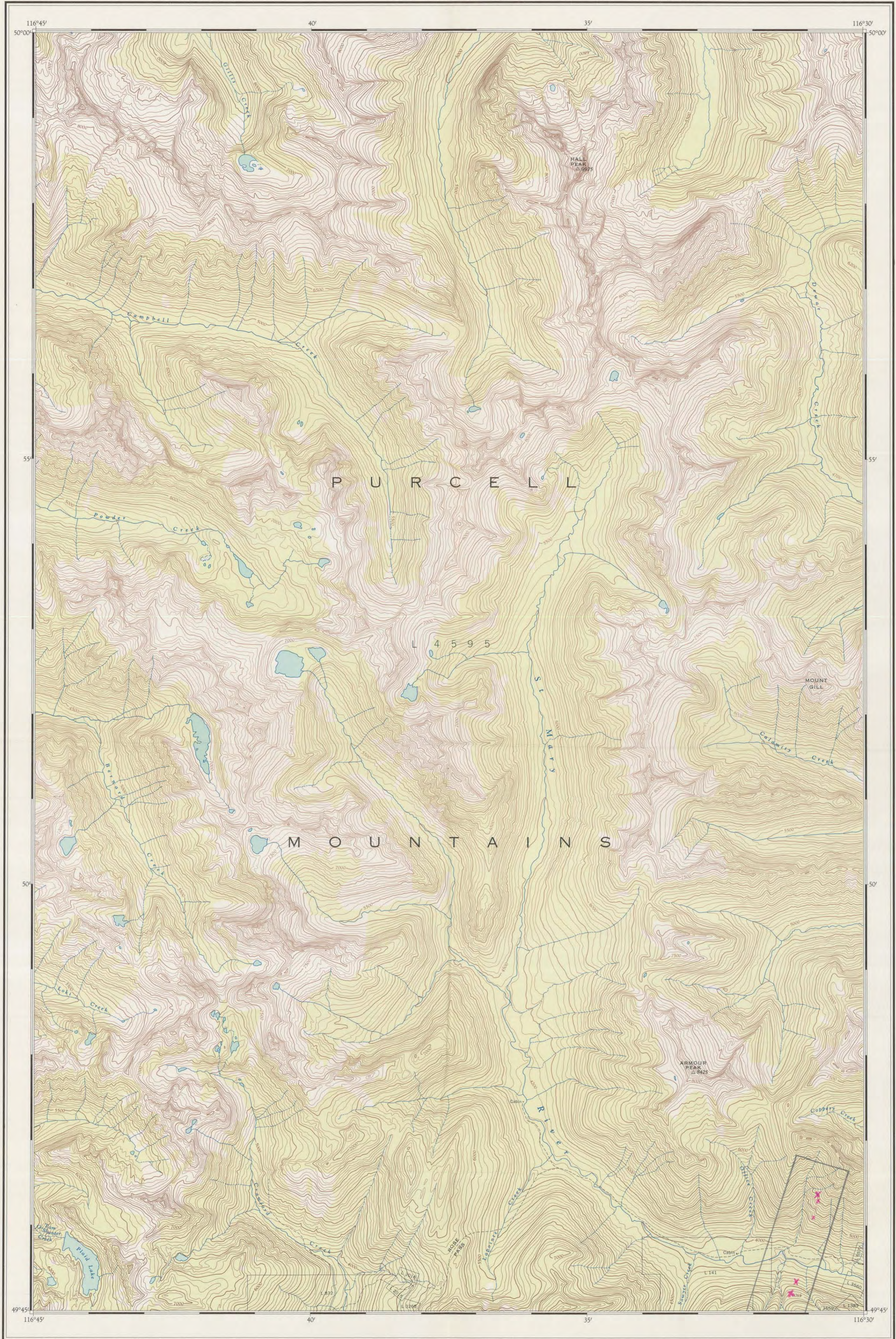

Produced and printed by the SURVEYS AND MAPPING BRANCH, DEPARTMENT OF MINES AND TECHNICAL SURVEYS, 1961, from air photographs taken in 1957. Copies may be obtained from the Map Distribution Office, Department of Mines and Technical Surveys, Ottawa.

Établie et imprimée par la DIRECTION DES LEVÉS ET DE LA CARTOGRAPHIE, MINISTÈRE DES MINES ET DES RELEVÉS TECHNIQUES en 1961, d'après les photographies aériennes prises en 1957. Ces cartes sont en vente au Bureau de distribution des cartes, ministère des Mines et des Relevés techniques, Ottawa.

KASLO
KOOTENAY DISTRICT
BRITISH COLUMBIA

SCALE 1:50,000 ÉCHELLE

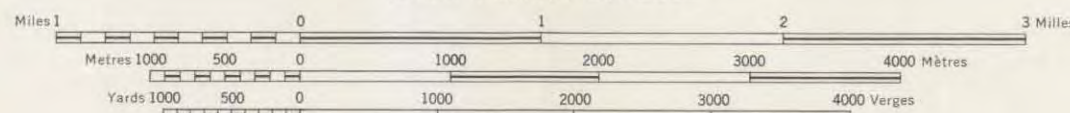

CONTOUR INTERVAL 100 FEET
Elevations in Feet above Mean Sea Level
North American Datum 1927
Transverse Mercator Projection
MAGNETIC DECLINATION 21°59' EAST
AT CENTRE OF MAP 1961
Annual change (decreasing) 3.6'

ÉQUIDISTANCE DES COURBES 100 PIEDS
Élévations en pieds au-dessus du niveau moyen de la mer
Réseau géodésique nord-américain unifié (1927)
Projection transverse de Mercator
DÉCLINAISON MAGNÉTIQUE AU CENTRE
DE LA FEUILLE EN 1961 21°59' EST
Variation annuelle (décroissant) 3.6'

- | | |
|---|---------------------------------------|
| Building..... Bâtiment..... | Barr..... Grange..... |
| School..... École..... | Post Office..... Bureau de poste..... |
| Church..... Église..... | Cemetery..... Cimetière..... |
| Lighthouse..... Phare..... | |
| River with bridge..... Rivière avec pont..... | |
| Stream, intermittent or dry..... Cours d'eau intermittent ou à sec..... | |
| Lake, intermittent, indefinite..... Lac intermittent, rive imprécise..... | |
| Marsh or Swamp..... Marais ou marécage..... | |
| Depression contours..... Courbes de ouverts..... | |

- | | |
|---|---|
| Roads: | Routes: |
| loose surface, dry weather..... | de gravier, période sèche..... |
| cart track..... | de terre..... |
| trail or portage..... | sentier ou portage..... |
| Railway, normal gauge, single track..... | Chemin de fer, voie unique (écartement normal)..... |
| Power transmission line..... | Ligne de transport d'énergie..... |
| Mine or Open cut..... | Mine ou fosse à ciel ouvert..... |
| Horizontal control point, with elevation..... | Point géodésique avec cote..... |
| Bench mark, with elevation..... | Repère de nivellement avec cote..... |

TABLEAU D'ASSEMBLAGE DU SYSTÈME DE RÉFÉRENCE CARTOGRAPHIQUE NATIONAL, 117°00' 116°15'

82 K/2 W	82 K/2 E	82 K/1 W
82 F/15 W	KASLO	82 F/16 W
82 F/10 W	82 F/10 E	82 F/9 W

INDEX TO ADJOINING SHEETS OF THE NATIONAL TOPOGRAPHIC SYSTEM

