

EXAMPLE of
type of sketch
required

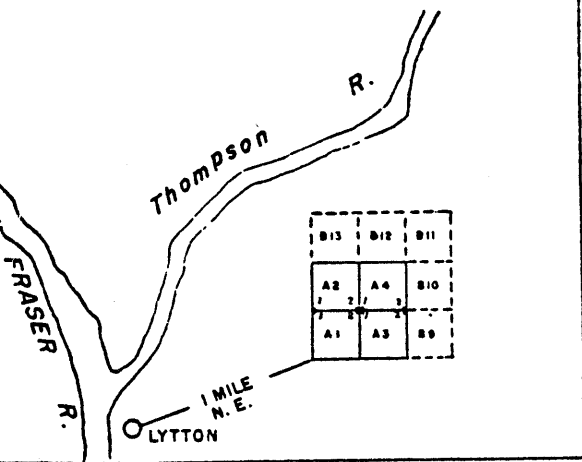

Claims must be tied by direction and distance to at least one, preferably more than one, topographical feature, or to a land lot, section, township, or other recognizable point on printed maps of the district. Relationship of previously located claims should also be shown.

N.B. — The sketch for a group of claims may be placed on one affidavit.

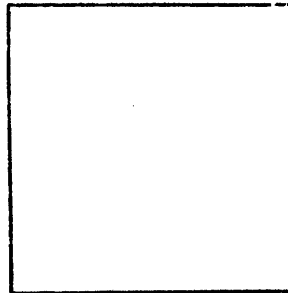

INDICATE NORTH
(True or ~~Magnetic~~)

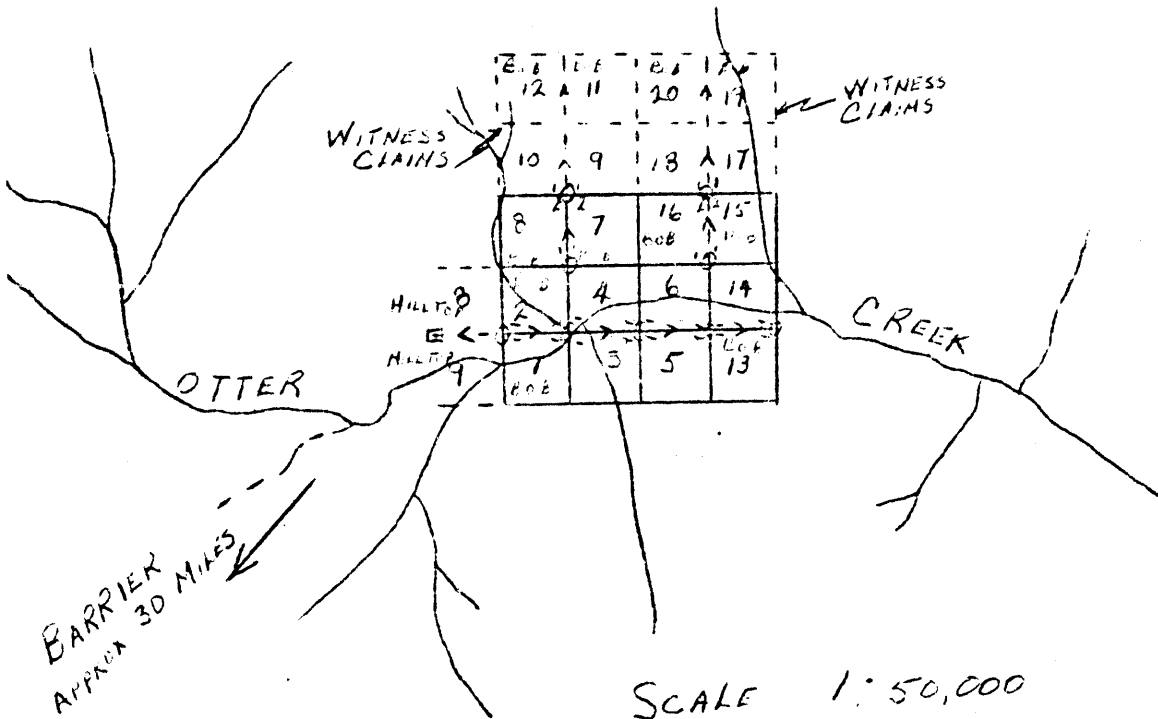

SCALE 1:50,000

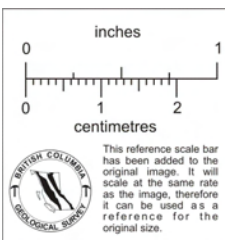

811024