

Diamond Drill Sampling



810668

82G
Bracebridge Prop.
Meridian Res. 1966

Hole No. 1	Sheet 1	Lat. 2,000 N	Hor. Comp. 34°	Ver. Comp. 21°
Property Bracebridge	Length 40'	Dep. 2,000 E	Etch. of EX Core	Total Recovery % 98
District Ft. Steele H.D.	Bearing 065°	Elev. 6,025'	True Dip	Logged by F. Forder
Commenced June 27, 1966	Dip -31°	Objective Test Cu near main showing	Location 50' north of main showing adit	
Completed July 8, 1966				

Footage		Description	Shorts Feet	Sample No.	Length Feet	Analysis					Recovery %
From	To					% Cu	ppm Ag/T	ppm Au/T	% Pb	% Zn	
SUMMARY OF INTERSECTIONS											
0.0 - 36.0'											
36.0 - 40.0'											
0.0'	40.0'	ARGILLITE: limy, sericitized, grey green to buff, dolomitic laminae and bands to 2", banding 45-50° to core. Poorly mineralized chalcopyrite, pyrrhotite.			36.0'	0.1	Tr.				
					4.0'	1.25	Tr.	0.35			
			0.6'	66689	15.0'	0.045					
			HL1	66690	21.0'	0.155	Tr.				
			HL1	66691	4.0'	1.25	Tr.	0.35			
10.0'	13.0'	Dolomitic bed - buff to grey, disseminated pyrrhotite, some chalcopyrite along bedding planes.									
15.0'	20.0'	Chalcopyrite conformable with banding.									
15.0'	17.0'	Argillaceous quartzite.									
29.0'	33.0'	Minor chalcopyrite.									
36.0'	39.0'	Some chalcopyrite.									
39.0'	40.0'	Silicified argillite.									
40.0'	40.0'	END OF HOLE.									

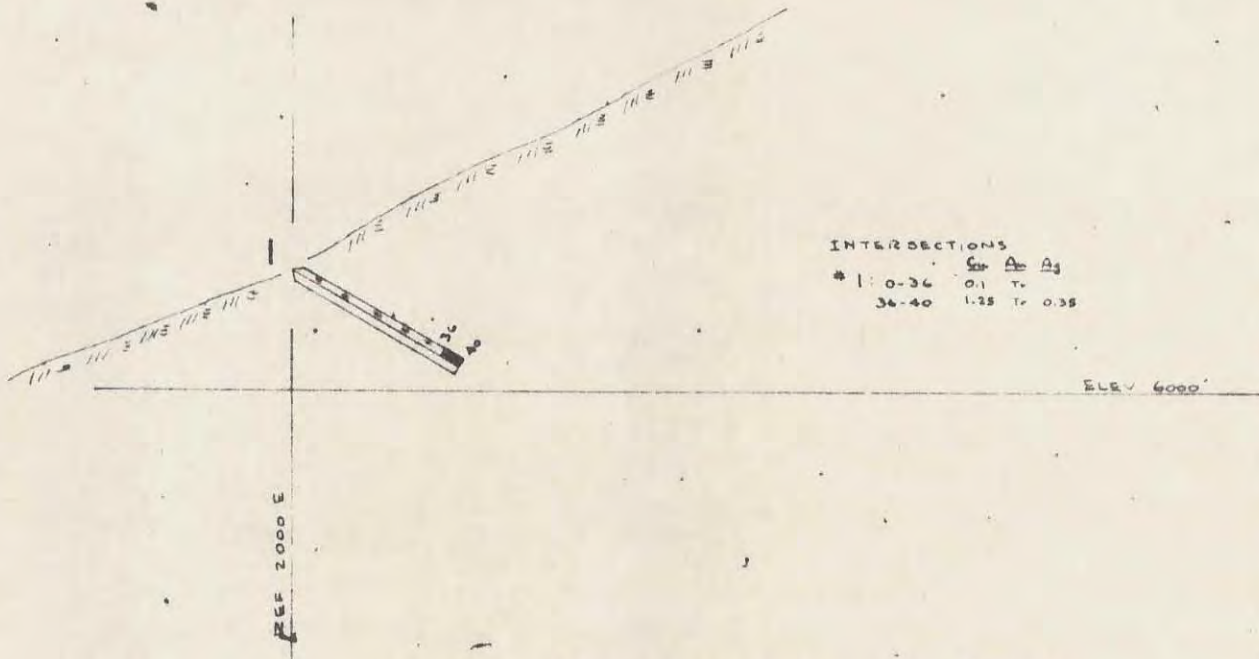

INTERSECTIONS

#	Gr	A	A ₂
1-0-36	0.1	T	
36-40	1.25	T	0.35

SECTION Q-D 1"=40'

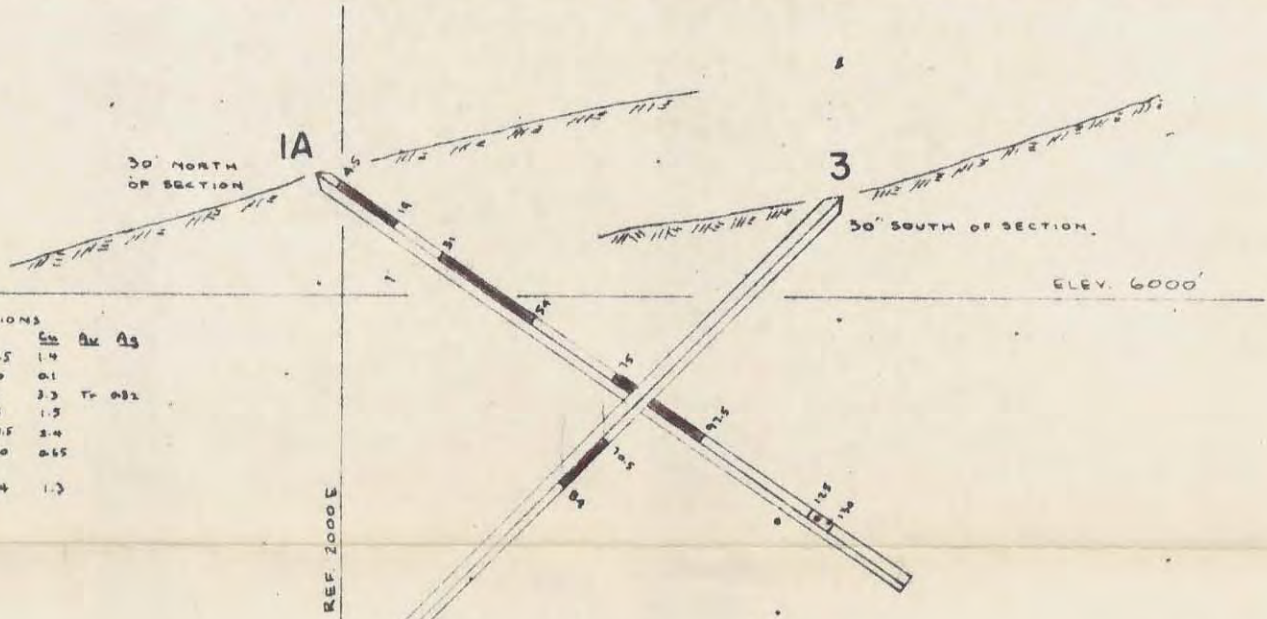

INTERSECTIONS

#	Gr	A	A ₂
1A: 0-97.5	1.4		
97.5-130	0.1		
45-19	3.3	T	0.82
31-84	1.5		
75-97.5	3.4		
125-130	0.65		
AD: 705.84	1.3		

SECTION A-B 1"=40'

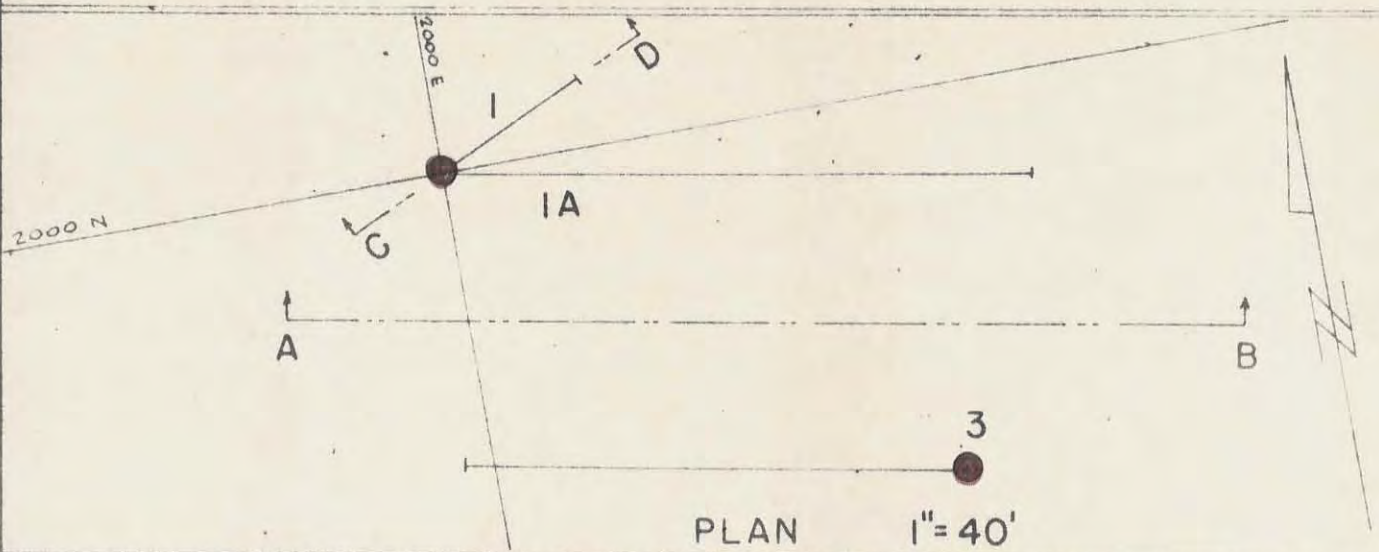

PLAN 1"=40'

The Consolidated Mining and Smelting Company of Canada Limited

DRAWN BY:	REC	TRACED BY:	
REVISED BY:	DATE	REVISED BY:	DATE

BRACE BRIDGE
DRILL HOLE 1, IA, 3

SCALE: 1"=40'

DATE: FEB 1967

PLATE:

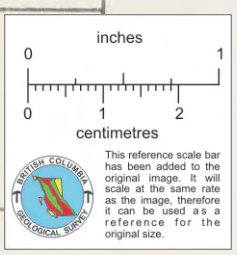

Diamond Drill Sampling Record



Hole No. 1A	Sheet 1						
Property BRACEBRIDGE	Length 150'	Lat. 2,000 N	Hor. Comp. 123'	Ver. Comp. 86'			
District Fort Steele M.D.	Bearing 100°	Dep. 2,000 E	Exposure NE core	Total Recovery % 86			
Commenced August 1, 1966	Dip -55°	Elev. 6,025'	True Dip	Logged by F. Faldor			
Completed " 25, 1966	Objective Test Cu near Main Showing.		Location 50' north of Main Showing Adit.				

Footage From	To	Description	Shorts Feet	Sample No.	Length Feet	Analysis					Recovery %
						% Cu	oz Au/T	oz Ag/T	% Pb	% Zn	
<u>SUMMARY OF INTERSECTIONS</u>											
		0.0' - 97.5'			97.5	1.4					
		97.5' - 130.0'			32.5	0.1					
		4.5' - 19.0'			14.5	3.3	Tr	0.82			
		31.0' - 54.0'			23	1.5					
		75.0' - 97.5'			22.5	2.4					
		125.0' - 130.0'			5	0.65					
0.0'	150.0'	SCHIST: Sericitic quartzose. Interbanded argillite, dolomite. Grey-green, grey and buff. Chalcopyrite conformable with banding and as disseminations.									
0.0'	4.5'	Argillite: Some dolomitic laminae, abundant oremlations, grey-green. Fracturing 55° to core.	0.3								
		0.0' - 4.5'		66678	4.5	0.058	Tr				
4.5'	7.0'	Limy Argillite: 50% dolomite bands, 50% quartz, 40% sericitized material. Schistosity 65° to core. Strong chalcopyrite, often enclosing dolomitic grains.									
		4.5' - 7'		66679	2.5	3.30	Tr	0.70			
7.0'	13.0'	Limy Argillite: Light grey-buff-greenish, some coarse carbonate. Fair to feeble chalcopyrite in bands and disseminations, strong quartz associated with better mineralized sections.	0.3								
		7.0' - 13.0'		66680	6	1.90	Tr	0.55			
13.0'	19.0'	Quartz-sericite schist: Dolomitic, banding 55° to core. Strong chalcopyrite.									
		13.0' - 19.0'		66681	6	4.80	0.005	1.15			

Diamond Drill Sampling Record



Hole No. 1A	Sheet 2	Lat.	Hor. Comp.	Ver. Comp.
Property BRACKERIDGE	Length	Dep.	Etch. at	Total Recovery %
District Fort Steele M.D.	Bearing	Elev.	True Dip	Logged by
Commenced August 1, 1966	Dip		Location	
Completed " 2, 1966	Objective			

Footage From	To	Description	Shorts Feet	Sample No.	Length Feet	Analysis					Recovery %
						% Cu	CS Au/T	OS Ag/T	% Pb	% Zn	
19.0'	22.0'	Sericite Schist: Thin dolomite bands common, banding 60° to core.									
22.0'	24.0'	Mainly dolomite: Schistosity 50° to core, banding 70-75° to core, strongly fractured. Feeble disseminated chalcopryrite.									
24.0'	26.0'	Dolomitic Argillite: Interlaminated dolomite and argillite, brown-buff, banding 45° to core. Trace chalcopryrite.									
26.0'	31.0'	Sericite schist: Dolomitic interlamination.									
		19.0' - 31.0'	0.3	66682	12	0.025					
31.0'	38.0'	Quartz-sericite schist: White, grey, and buff; highly silicified. 1/2" ankerite band 45° to core. Strong chalcopryrite, banded mineralization 55° to core.	0.5								
		36.0' - 9" carbonate band.									
		31.0' - 38.0'		66683	7	2.10					
38.0'	42.0'	Impure limestone band: Light grey and white, banding 60° to core.	Nil								
		38.0' - 42.0'		66684	4	0.05					
42.0'	45.5'	Quartz: milky and translucent, strong chalcopryrite.	Nil								
		42.0' - 45.5'		66685	3.5	5.4	0.005	1.30			
45.5'	50.5'	Argillite: Light and medium grey, thin bands white quartz, banding 45° to core.									
		45.5' - 50.5'		66686	5	0.064	Tr				

Diamond Drill Sampling Record



Hole No. 1A	Sheet 3	Property BRACKENRIDGE	Length	Lat.	Hor. Comp.	Ver. Comp.
District Fort Steele N.D.	Bearing	Commenced August 1, 1966	Dip	Dep.	Etch. at	Total Recovery %
Completed " 25, 1966	Objective	Elev.	True Dip	Location	Logged by	

Footage From	To	Description	Shorts Feet	Sample No.	Length Feet	Analysis					Recovery %
						% Cu	Ag/T	As/T	% Pb	% Zn	
50.5'	54.0'	Quartz: Weak chalcopyrite. 50.5' - 54.0'	0.4	66687	3.5	0.57					
54.0'	60.0'	Limy Argillite: Light grey and buff, dolomitic laminae, talc, thin silicified bands (2") banding 20° to core. Feeble chalcopyrite conformable and disseminated, commonly localized at quartz boundaries. 54.0' - 57.0' 57.0' - 60.0'	1.5 Nil	66688 66692	3 3	0.058 0.24					
60.0'	73.5'	Sericite Schist: Light grey and buff, some limy laminae, locally talcose or chloritic, quartz stringers with associated chalcopyrite, banding 50° to core. 60.0' - 65.0' 65.0' - 70.0' 70.0' - 75.0'	1.1	66693 66694 66695	5 5 5	0.17 0.07 0.29	Tr		0.2		
73.5'	85.5'	Limy Argillite: Abundant quartz, strong chalcopyrite, best mineralization commonly associated with brecciated carbonate. 75.0' - 80.0' 80.0' - 85.0'		66696 66697	5 5	5.0 2.3	Tr	1.0 0.5			
85.5'	97.5'	Sericite Schist: Interbanded argillite and schist, occasional 1/2" bands ankerite, strong chalcopyrite (Pyrrhotite) at 87' - 91' associated with brecciated carbonate in argillite and quartz host. 85.0' - 90.0' 90.0' - 97.5'	2	66698 66699	5 7.5	2.2 0.90	Tr		0.2		

Diamond Drill Sampling Record



Hole No. 1A	Sheet 4	Property BRACKENRIDGE	Length	Lat.	Hor. Comp.	Ver. Comp.
District Fort Steele M.D.	Bearing	Commenced August 1, 1966	Dip	Dep.	Etch. at	Total Recovery %
Completed " 23, 1966	Objective	Elev.	True Dip	Location	Logged by	

Footage From	To	Description	Shorts Feet	Sample No.	Length Feet	Analysis					Recovery %
						% Cu	Ag/T	Au/T	% Pb	% Zn	
97.5'	102.5'	Limy Argillite: Grey-green, limy laminae. 100.0' - 2" dolomitic band, 60' to core.	0.3								
		97.5' - 100.0'		87320	2.5	Tr					
102.5'	108.0'	Interbanded quartz sericite schist and impure limestone, banding 50' to core.									
		100.0' - 105.0'		87321	5	0.02					
		105.0' - 110.0'		87322	5	Nil					
108.0'	115.5'	Quartz sericite schist: Green, not limy.									
		110.0' - 115.0'		87323	5	Nil					
115.5'	126.0'	Quartz: Occasional 6" argillite band, brecciated carbonate. No mineralization.									
		115.0' - 120.0'		87324	5	Tr					
		120.0' - 125.0'		87325	5	0.07					
126.0'	139.0'	Quartz sericite schist: White and grey, talcose, 8" section with chalcopyrite.	3								
		125.0' - 130.0'		87326	5	0.65					
		130.0' - 135.0'		87327	5	Nil					
		135.0' - 140.0'		87328	5	"					
139.0'	140.0'	Quartz: Some brecciated carbonate.	0.5								
140.0'	150.0'	Sericite Schist: Abundant carbonate.									
		140.0' - 145.0'		87329	5	Nil					
		145.0' - 150.0'		87330	5	"					

Diamond Drill Sampling Record



Hole No. 14	Sheet 5			
Property BRACENIDGE	Length	Lat.	Hor. Comp.	Ver. Comp.
District Fort Steele N.D.	Bearing	Dep.	Etch. at	Total Recovery %
Commenced August 1, 1966	Dip	Elev.	True Dip	Logged by
Completed " 25, 1966	Objective		Location	

Footage		Description	Shorts Feet	Sample No.	Length Feet	Analysis				Recovery %
From	To					% Cu	^{ppm} Ag/T	^{ppm} Au/T	% Pb	
	150.0'	END OF HOLE.								

RGG:ms
Trail Expl'n Office, Western District
March 2, 1967

Distribution: Montreal Exploration (1)
 Western Exploration (1)
 Owner (1)
 Field (1)

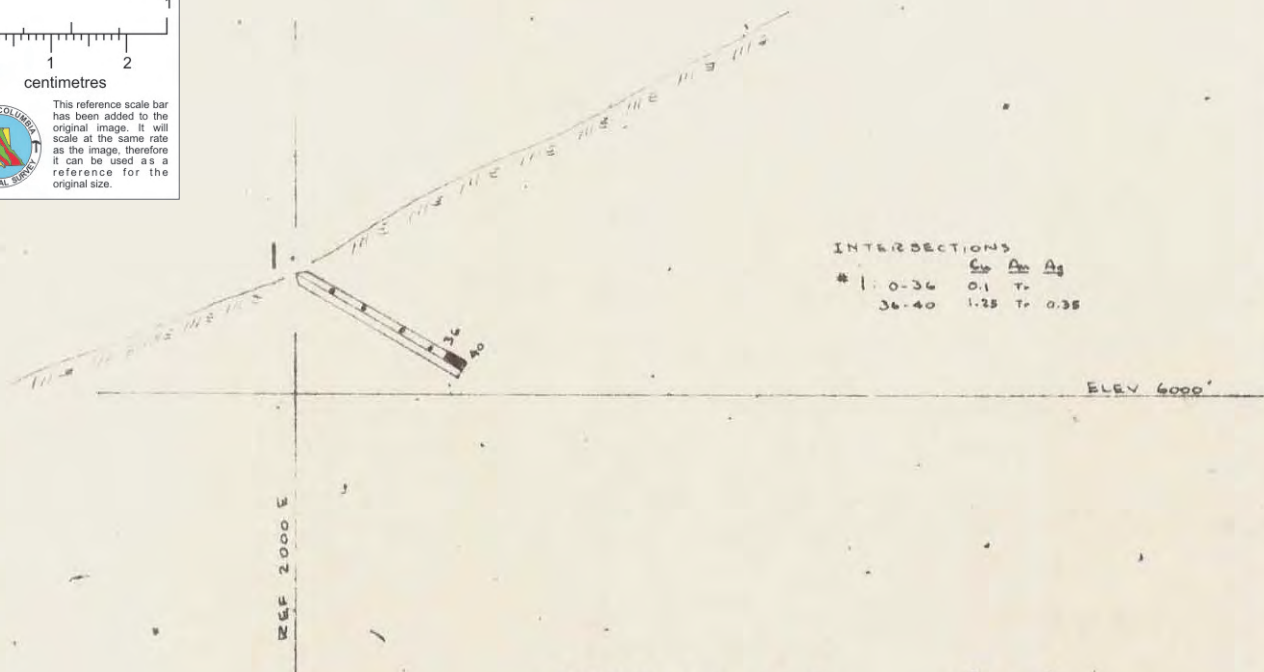
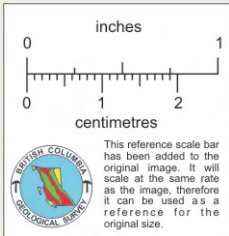

INTERSECTIONS

#	Cu	Ag	Tr
1	0.36	0.1	Tr
36-40	1.25	Tr	0.35

SECTION C-D 1" = 40'

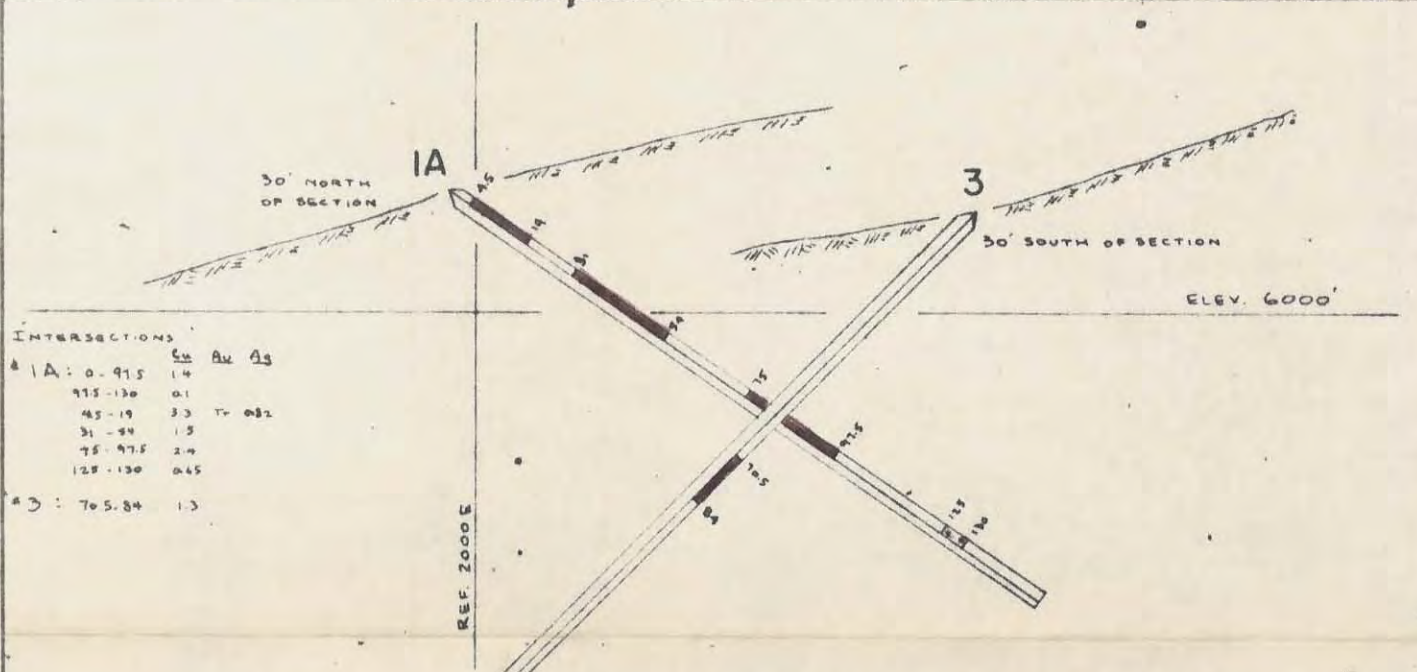

INTERSECTIONS

#	Cu	Ag	Tr
IA	0.915	1.4	
975-130	0.1		
45-19	3.3	Tr	0.82
31-54	1.5		
75-975	2.4		
125-130	0.45		
3	705.84	1.3	

SECTION A-B 1" = 40'

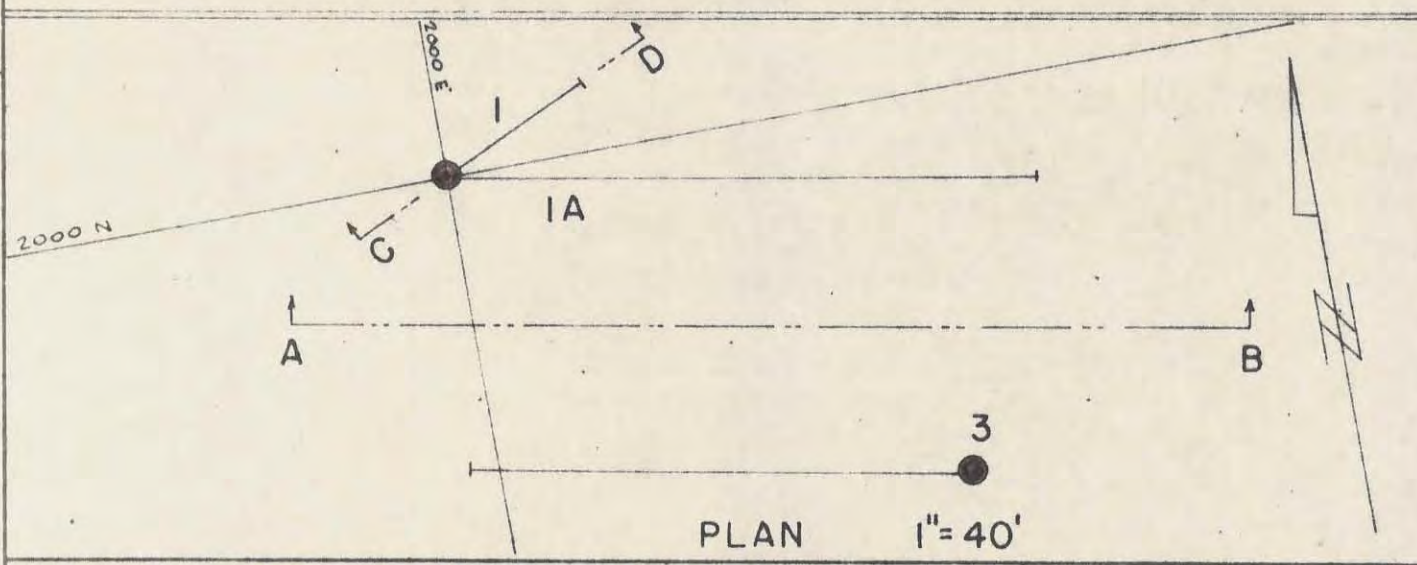

PLAN 1" = 40'

The Consolidated Mining and Smelting Company of Canada Limited

DRAWN BY: <i>RCC</i>		TRACED BY:	
REVISED BY	DATE	REVISED BY	DATE

BRACEBRIDGE
DRILL HOLE 1, IA, 3

SCALE: 1" = 40'	DATE: FEB 1967	PLATE:
-----------------	----------------	--------

Diamond Drill Sampling Record



Hole No. 2	Sheet 1	Lat. 2,155 N	Hor. Comp. 22'	Ver. Comp. 10'
Property BRACEBRIDGE	Length 24'	Dep. 2,059 E	BRACEBRIDGE EX core	Total Recovery %
District Fort Steele M.D.	Bearing 095°	Elev. 6,120'	True Dip	Logged by F. Felder
Commenced July 11, 1966	Dip -3°	Objective Test for Cu north of Main Showing.	Location 200' north of the Main Showing Adit.	
Completed July 14, 1966				

Footage		Description	Shorts Feet	Sample No.	Length Feet	Analysis					Recovery %																
From	To																										
0.0'	24.0'	Sericite schist: Trace chalcoppyrite.																									
	24.0'	END OF HOLE.																									
		Hole abandoned due to caving ground.																									
<p>RCG:gas Trail Expl'n Office, Western District March 2, 1967</p> <hr/> <table border="0"> <tr> <td>Dist.;</td> <td>Montreal</td> <td>Exploration</td> <td>(1)</td> </tr> <tr> <td></td> <td>Western</td> <td>"</td> <td>(1)</td> </tr> <tr> <td></td> <td>Owner</td> <td></td> <td>(1)</td> </tr> <tr> <td></td> <td>Field</td> <td></td> <td>(1)</td> </tr> </table>												Dist.;	Montreal	Exploration	(1)		Western	"	(1)		Owner		(1)		Field		(1)
Dist.;	Montreal	Exploration	(1)																								
	Western	"	(1)																								
	Owner		(1)																								
	Field		(1)																								

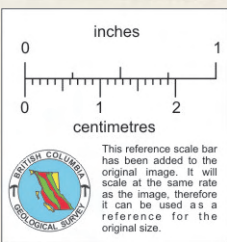

SECTION E-F 1" = 40'

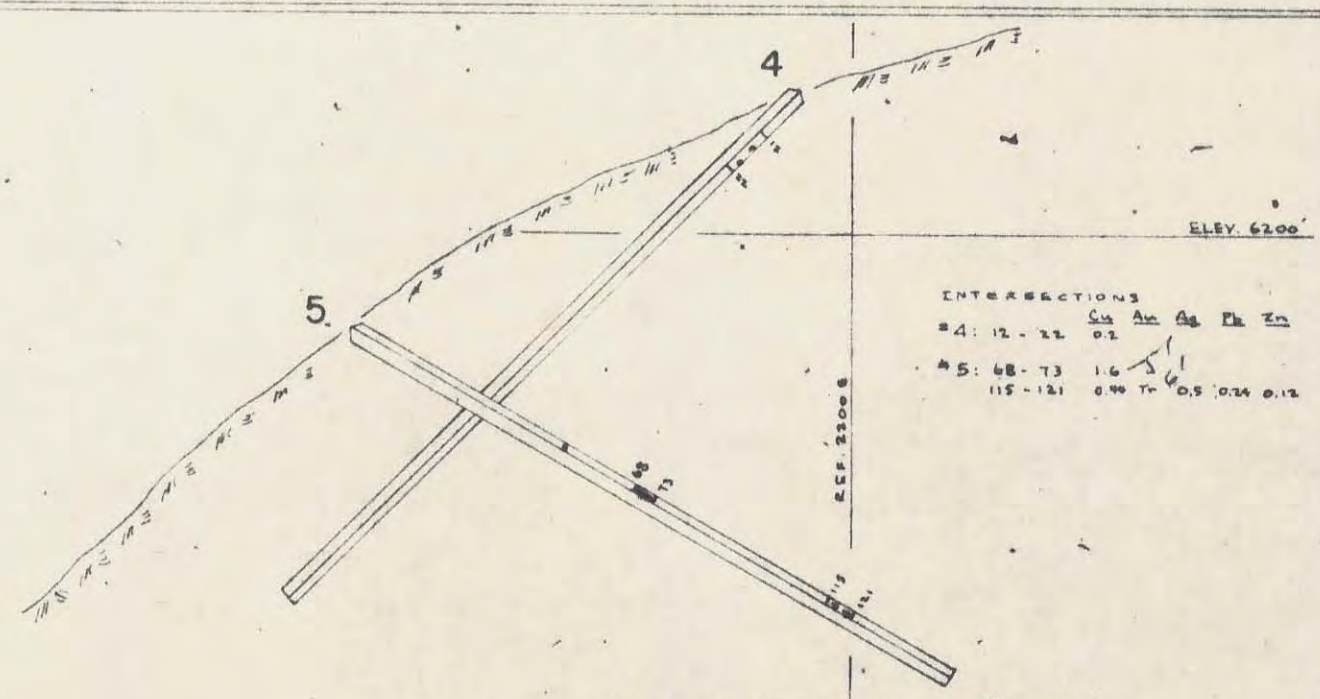

SECTION G-H 1" = 40'

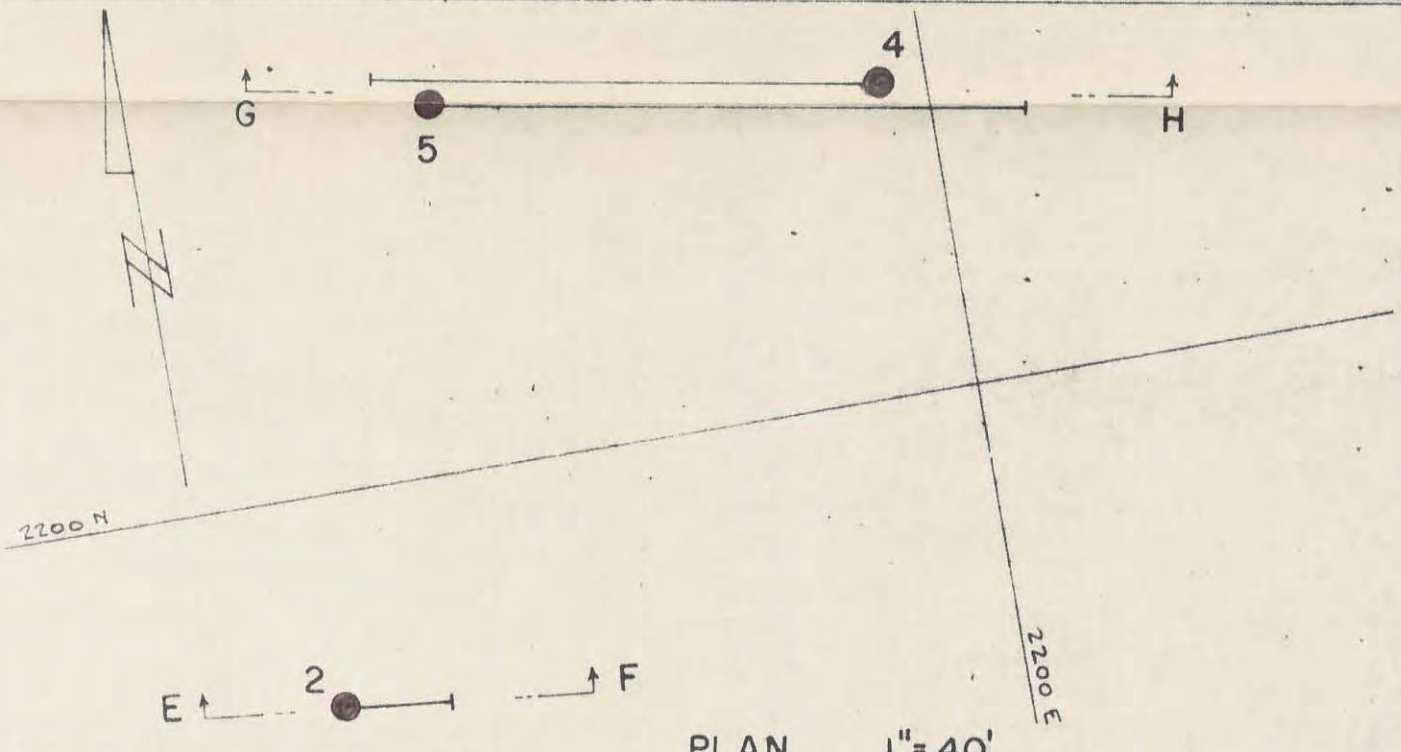

PLAN 1" = 40'

The Consolidated Mining and Smelting Company of Canada Limited

DRAWN BY: RGG		TRACED BY:	
REVISED BY	DATE	REVISED BY	DATE

BRACEBRIDGE
DRILL HOLE 2, 4, 5

SCALE: 1" = 40' DATE: FEB 1967 PLATE:

Diamond Drill Sampling Record



Hole No. 5	Sheet 1	Property BRACKENRIDGE	Length 149'	Lat. 1,920 N	Hor. Comp. 105'	Ver. Comp. 105'
District Fort Steele M.D.	Bearing 280°	Commenced July 23, 1966	Dip 45°	Dep. 2,097 E	Strike EX core	Total Recovery % 70
Completed Aug. 29, 1966	Objective Test for Cu near Main Showing.	Elev. 6,020'	True Dip	Location 90' east of Main Showing Adit.	Logged by F. Felder	

Footage From	To	Description	Shorts Feet	Sample No.	Length Feet	Analysis				Recovery %
						% Cu	AS Au/T	AS Ag/T		
		<u>SIGNIFICANT INTERSECTIONS</u>								
		70.5' - 84.0'			13.5	1.5				
0.0'	13.0'	Argillite: White and buff, sericitic, rusty laminations; dolomitic band at 9' - 10'; quartz sericite schist with weak chalcopyrite at 10' - 11'; dolomitic argillite at 11' - 13' isoclinally crumpled with limbs 25° to core.								
		5.0' - 9.0'	2	66658	4	Nil				
		9.0' - 10.0'	0.3	66659	1	Tr				
		10.0' - 11.0'	Nil	66660	1	Tr	Tr			
		11.0' - 13.0'	"	66661	2	Nil				
13.0'	22.0'	Quartz sericite schist, feeble chalcopyrite and pyrrhotite. Dolomitic band 40° to core at 15' - 16'; rusty ankerite at 19.5' - 20'; schistosity 70-75° to core at 20' - 22'.	1.8							
		13.0' - 15.5'		66662	2.5	Tr				
		15.5' - 16.5'		66663	1	Nil				
		16.5' - 18.0'		66664	1.5	Tr				
		18.0' - 23.5'		66665-66	5.5	0.025				
24.0'	70.5'	Argillite: Gray-green and buff, dolomitic, sericitic, banding 50° - 60° to core, feeble chalcopyrite and pyrrhotite.	13.6							
		23.5' - 25.0'		66667	1.5	Nil				
		25.0' - 30.0'		66668	5	"				
		30.0' - 33.5'		66669	3.5	Tr				
		33.5' - 36.0'		66670	2.5	Nil				
		36.0' - 41.0'		66671	5	"				

Diamond Drill Sampling Record



Hole No. 3	Sheet 3	Lat.	Hor. Comp.	Ver. Comp.
Property BRACKERIDGE	Length	Dep.	Etch. at	Total Recovery %
District Fort Steele H.D.	Bearing	Elev.	True Dip	Logged by
Commenced July 23, 1966	Dip		Location	
Completed Aug. 29, 1966	Objective			

Footage From	To	Description	Shorts Feet	Sample No.	Length Feet	Analysis				Recovery %
						\$ Cu	oz Au/T	oz Ag/T		
		149.0' END OF HOLE. 0.0' - 90.0' commenced July 23, completed July 28. 90.0' -149.0' " August 24, " August 29.								

RGG:gmc
 Trail Expl'n Office, Western District
 March 5, 1967

Distribution: Montreal Exploration (1)
 Western Exploration (1)
 Owner (1)
 Field (1)

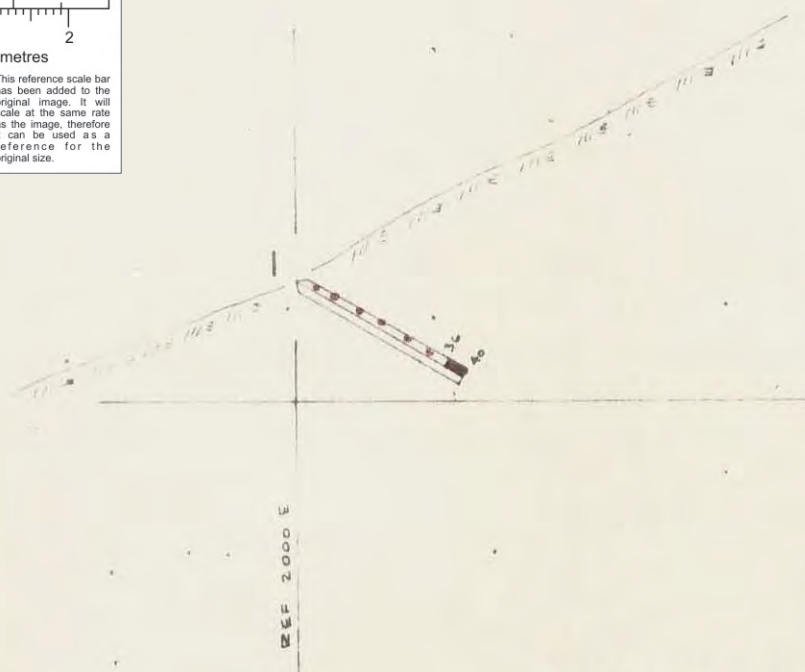
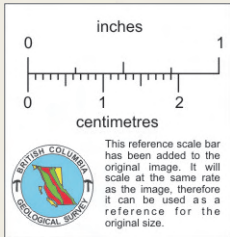

INTERSECTIONS

#	C ₁	A ₁	A ₂
1	0-36	0.1	-
	36-40'	1.25	Tr 0.35

SECTION C-D 1"=40'

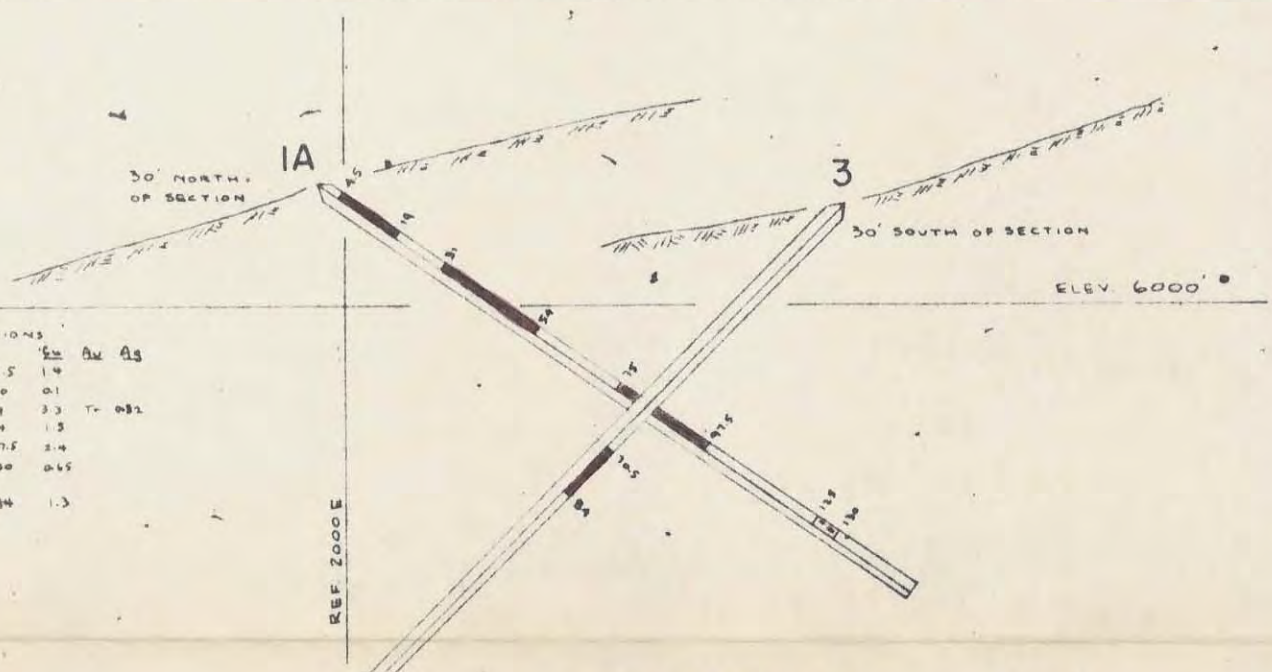

INTERSECTIONS

#	C ₁	A ₁	A ₂
IA	0-91.5	1.4	
	91.5-130	0.1	
	45-19	3.3	Tr 0.82
	31-54	1.5	
	75-97.5	2.4	
	125-130	0.65	
3	70.5-84	1.3	

SECTION A-B 1"=40'

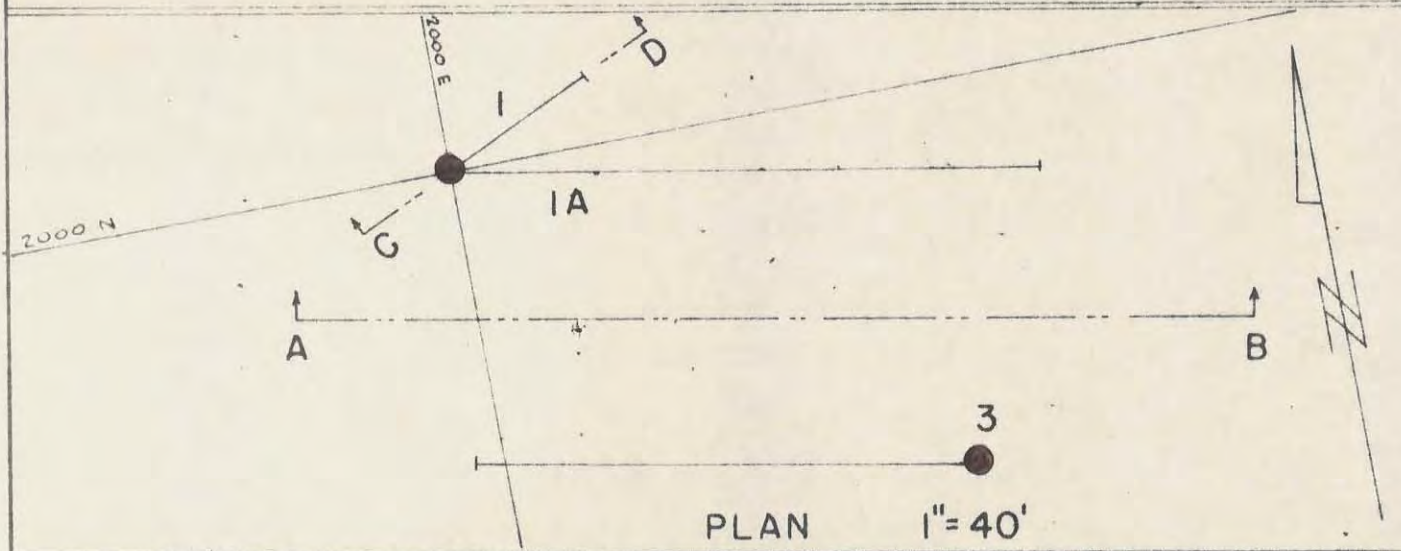

PLAN 1"=40'

The Consolidated Mining and Smelting Company of Canada Limited

DRAWN BY: REC		TRACED BY:	
REVISED BY	DATE	REVISED BY	DATE

BRACE BRIDGE
DRILL HOLE 1, IA, 3

SCALE: 1"=40' DATE: FEB 1967 PLATE:

Diamond Drill Sampling Record



Hole No. 4	Sheet 1	Property BRACEBRIDGE	Length 150'	Lat. 2,265 N	Hor. Comp. 106'	Ver. Comp. 106'
District Fort Steele M.D.	Bearing 280°	Dep. 2,190 E	280°	IX core	Total Recovery % 83	
Commenced August 31, 1966	Dip -45°	Elev. 6,230'		True Dip	Logged by R.G. Gifford	
Completed Sept. 7, 1966	Objective Test for Cu north of Main Showing.			Location 350' north of Main Showing Adit.		

Footage		Description	Shorts Feet	Sample No.	Length Feet	Analysis				Recovery %
From	To					% Cu				
		SUMMARY OF INTERSECTIONS:								
		12.0' - 22.0'			10	0.2				
0.0'	158.0'	SCHISTS: Sericitic, talcose, calcareous. Similar in type as Hole No. 5 (0' - 58'). Bedding tightly crumpled, generally 90° to core. Often rusty (close proximity to surface). Generally weak chalcopyrite.								
		Sample 0' - 7.0' (waste)		4476	7	0.003				
		7' - 12.0' "		4477	5	0.029				
12.0'	13.0'	Very rusty, estimate 1% chalcopyrite.								
		Sample 12.0' - 17.0' (Mineralized)		4478	5	0.21				
17.0'	22.0'	Rusty patches, estimate 1/2 - 1% chalcopyrite, trace malachite.								
		Sample 17.0' - 22.0' (Mineralized)		4479	5	0.18				
		22.0' - 27.0' (Waste)		4480	5	0.11				
138.0'	150.0'	Feeble chalcopyrite, best section at 148' - 150' est. 0.1% Cu.								
		Sample 132' - 138' (waste)		4481	6	0.017				
		138' - 144' (mineralized)		4482	6	0.12				
		144' - 150' "		4483	6	0.076				
	150.0'	END OF H LE.								
		Shorts 0' - 54'	18		54					70%
		54' - 150'	7		96					93%
RGG:gmc										
Trail Expl'n, Western District										
March 2, 1967										
Dist.: Montreal (1) Western Expl'n (1)										
Owner (1) Field (1)										

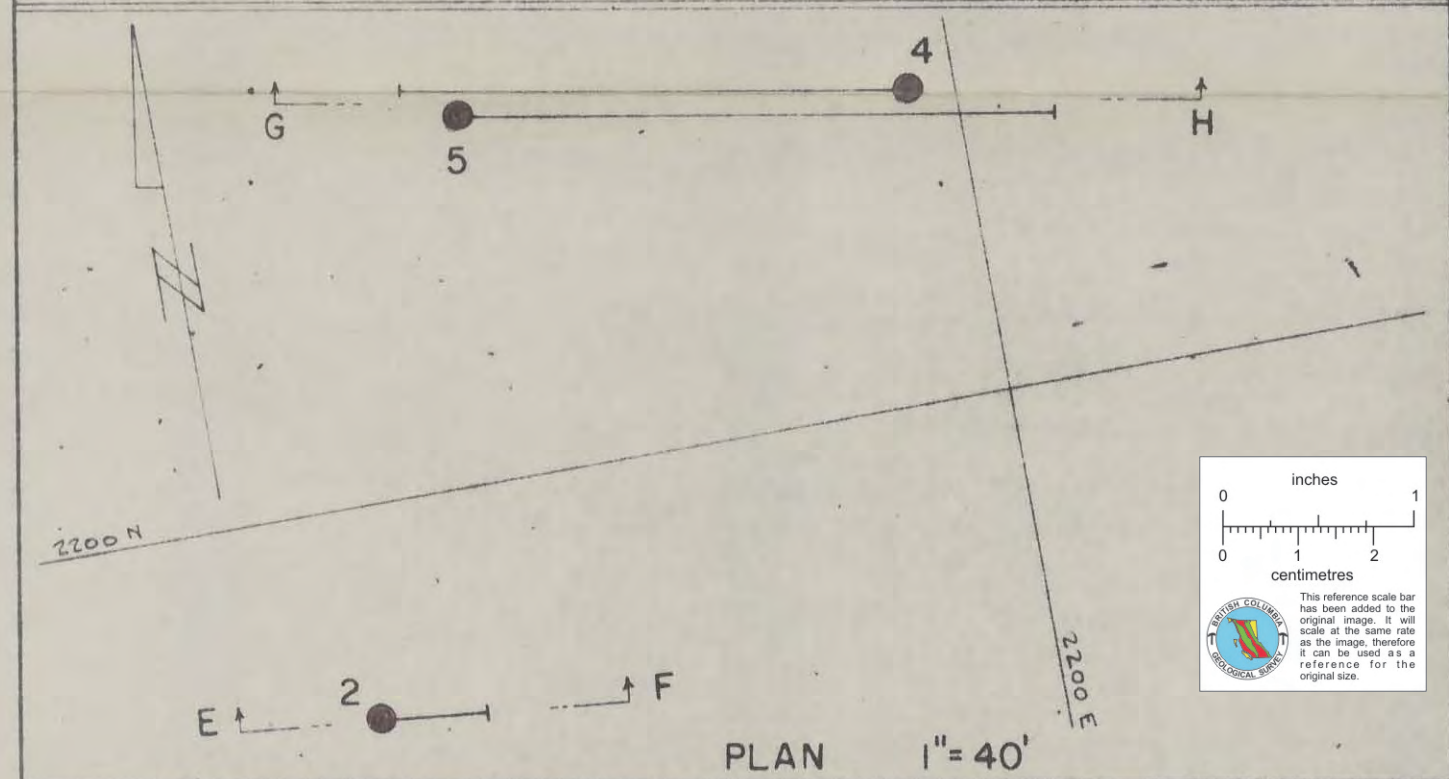
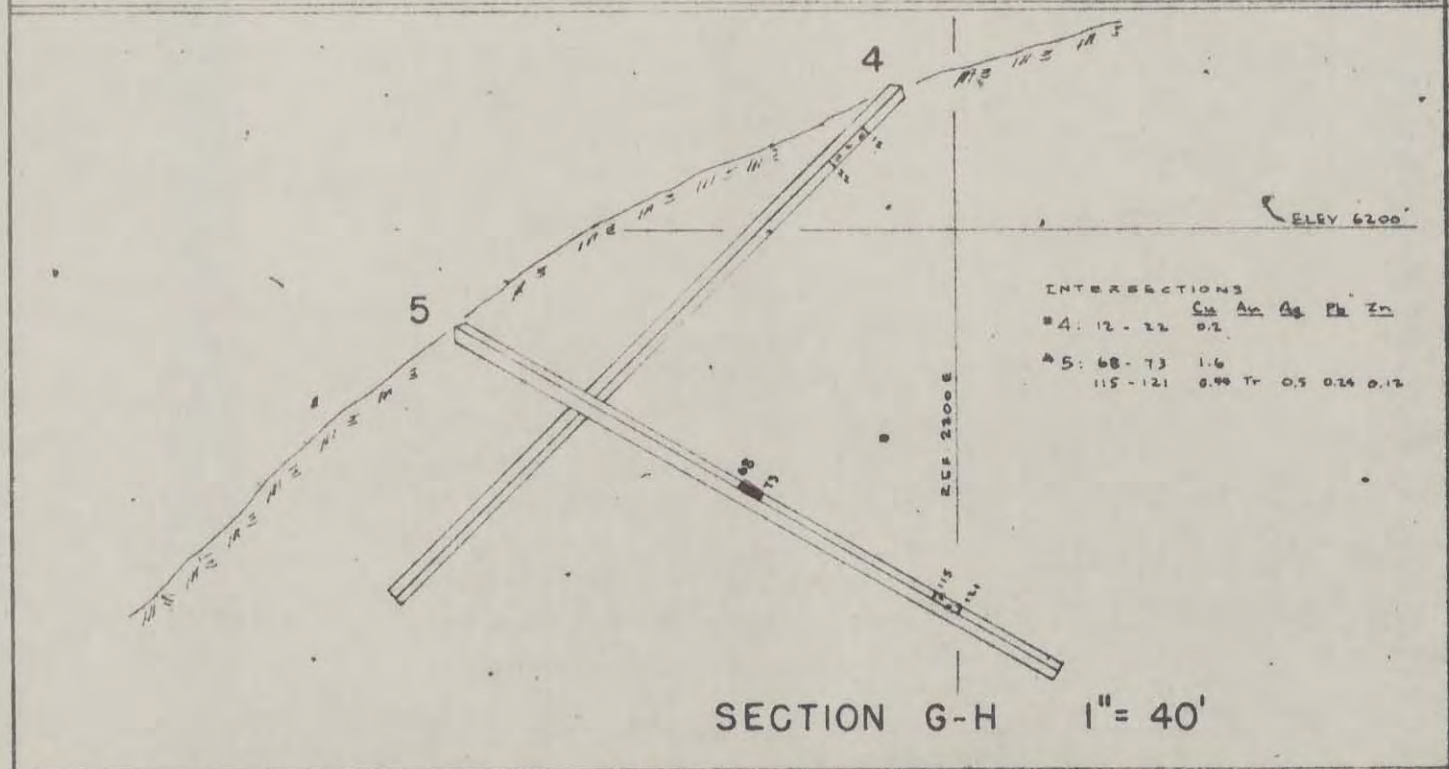
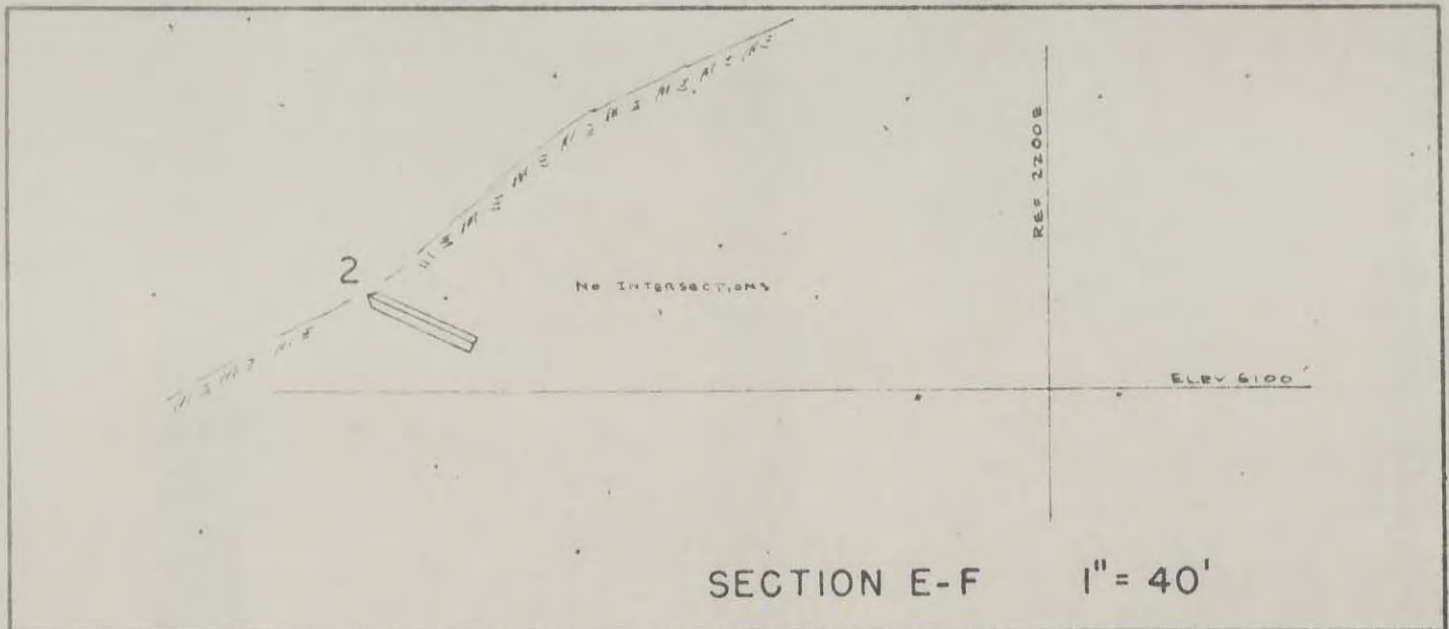

The Consolidated Mining and Smelting Company of Canada Limited

DRAWN BY: RGG		TRACED BY:	
REVISED BY	DATE	REVISED BY	DATE

BRACEBRIDGE
DRILL HOLE 2, 4, 5

SCALE: 1" = 40'

DATE: FEB 1967

PLATE:

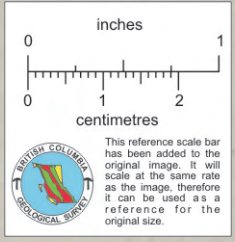
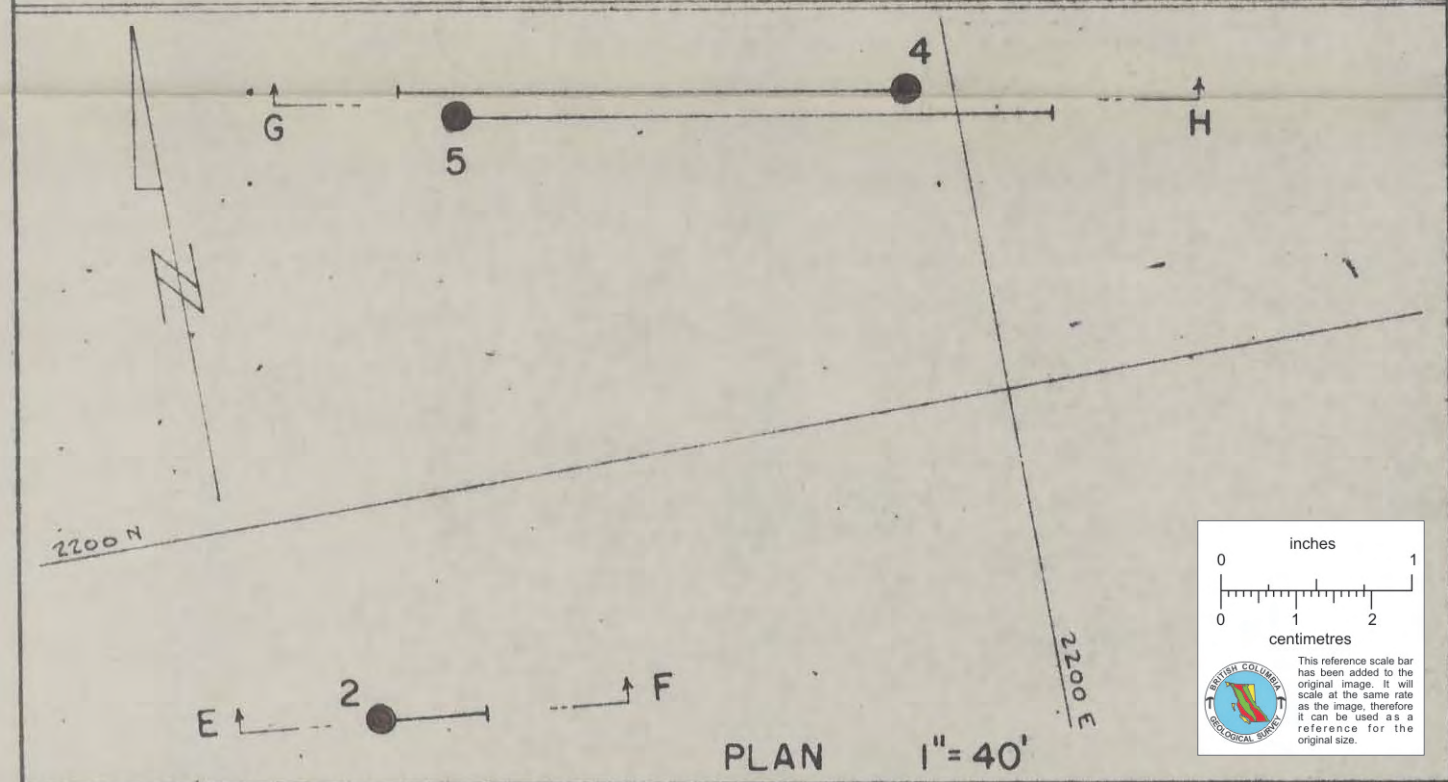
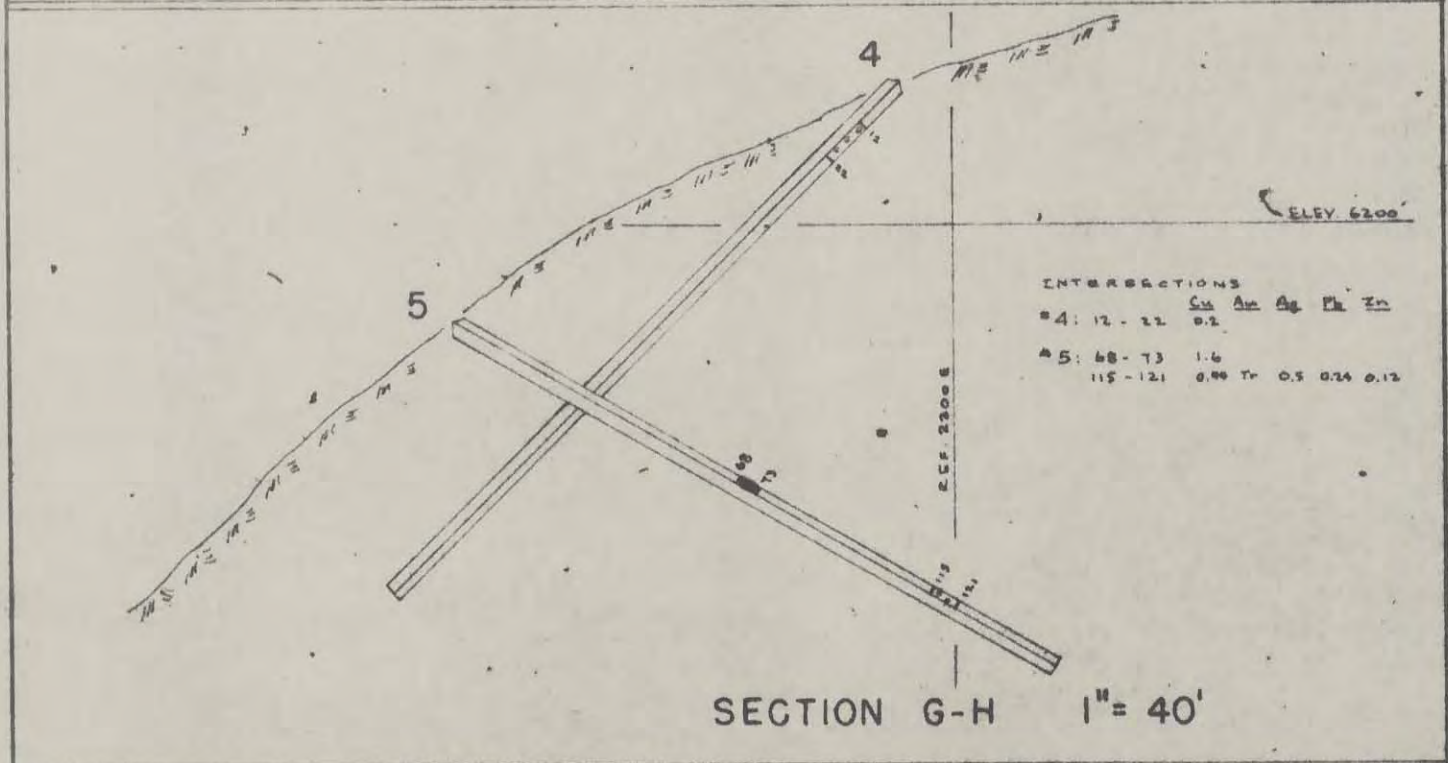
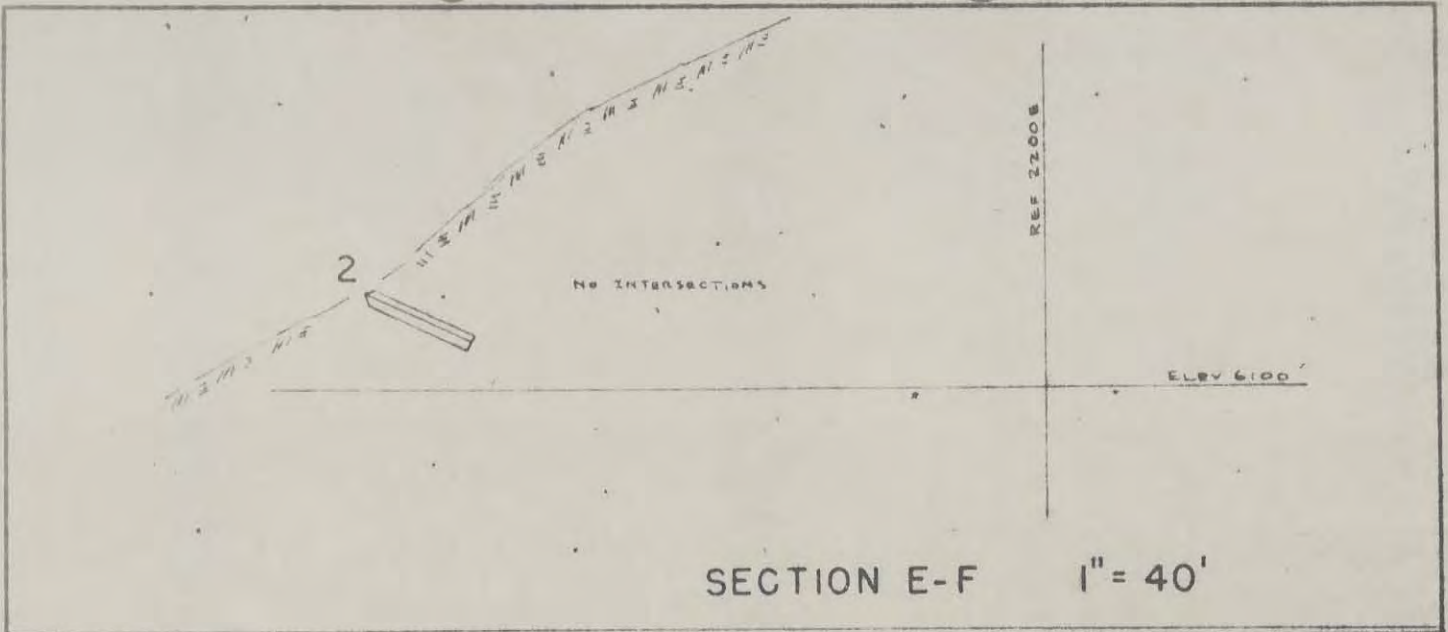

The Consolidated Mining and Smelting Company of Canada Limited

DRAWN BY: RGG		TRACED BY:	
REVISED BY:	DATE:	REVISED BY:	DATE:

**BRACEBRIDGE
DRILL HOLE 2, 4, 5**

SCALE: 1" = 40' DATE: FEB 1967 PLATE:

Diamond Drill Sampling Record



Hole No. **5** Sheet **1**
 Property **BRACKENIDGE** Length **145'** Lat. **2,276 N** Hor. Comp. **13°** Ver. Comp. **72°**
 District **Fort Steele N.D.** Bearing **100°** Dep. **2,098 E** Elevation **El Core** Total Recovery % **96**
 Commenced **Sept. 8, 1966** Dip **-30°** Elev. **6,180'** True Dip _____ Logged by **R.G. Gifford**
 Completed **" 28, 1966** Objective **Test for Cu on strike north of Main Showing.** Location **350' north of Main Showing Adit.**

Footage From	To	Description	Shorts Feet	Sample No.	Length Feet	Analysis					Recovery %
						% Cu	% Al ₂ O ₃	% SiO ₂	% Pb	% Zn	
		<u>SUMMARY OF INTERSECTIONS</u>									
		68.0' - 73.0'			5	1.68					
		115.0' - 121.0'			6	0.44	Tr	0.5	0.24	0.12	
<u>0.0'</u>	<u>58.0'</u>	<u>SCHISTS:</u> Mainly sericitic, also talcose and calcareous. Inter-banded light and dark grey in equal proportion. Generally laminated, usually 1/8" or less. Rare quartz veins. Bedding crumpled, characteristically shear folded (specimen at 53'), cleavage usually at greater angle to core than bedding (specimen at 41').									
0.0'	14.0'	Spotted texture, andalusite? (specimen at 10'). 0.0' - 7.0' - Bedding crumpled, mainly 45° to core. 7.0' - 14.0' - " " " parallel to core.									
14.0'	58.0'	Bedding crumpled, mainly 45° to core. 15.0' - 6" quartz vein. 20.0' - 1" quartz vein. 35.0' - Siliceous for 6".									
<u>58.0'</u>	<u>145.0'</u>	Sample 53.0' - 58.0' <u>DOLOMITIC SCHISTS:</u> Dove grey, dark green; 30% dolomitic bands and pods (1"-3") interbanded with chloritic, sericitic schists. Chloritic (green) and sericite (grey) zones alternate in 2' - 10' lengths. Contrasts with overlying unit by chloritic and dolomitic nature. Bedding crumpled and sheared as above, mainly 45° to core but all gradations		4484	5	0.018					

Diamond Drill Sampling Record



Hole No. 5	Sheet 2	Property BRACEBRIDGE	Length	Lat.	Hor. Comp.	Ver. Comp.
District Fort Steele M.D.	Bearing	Commenced Sept. 8, 1966	Dip	Dep.	Etch. at	Total Recovery %
Completed " 23, 1966	Objective			Elev.	True Dip	Logged by
					Location	

Footage		Description	Shorts Feet	Sample No.	Length Feet	Analysis					Recovery %
From	To					% Cu	% Ag/T	% Ag/T	% Pb	% Zn	
		from 0° to 90°. Quartz often associated with dolomite rich sections, in this association dolomite is often brecciated (specimen at 69'). Dolomite bands usually parallel bedding, sometimes crosscut along cleavage (specimen at 64' and 70'). Chalcopyrite, subordinate pyrrhotite commonly associated with chloritic sections rich in dolomite and quartz, mineralization generally weak. 6" fair galena at 119'.									
58.0'	115.0'	Generally sparse chalcopyrite. Best section 4" estimate 10% Cu at 73'.									
		Sample 58.0' - 63.0'		4485	5	0.077					
		63.0' - 68.0'		4486	5	0.25					
		68.0' - 73.0'		4487	5	1.60					
		73.0' - 78.0'		4488	5	0.99					
		78.0' - 83.0'		4489	5	0.13					
		83.0' - 88.0'		4490	5	0.205					
		88.0' - 93.0'		4491	5	0.028					
		93.0' - 98.0'		4492	5	0.012					
		98.0' - 103.0'		4493	5	0.006					
		103.0' - 109.0'		4494	6	0.007					
		109.0' - 115.0'		4495	6	0.03					
115.0'	121.0'	Fair chalcopyrite, 6" fair galena at 119'.									
		Sample 115.0' - 121.0'		4496	6	0.44	Tr	0.5	0.24	0.12	
121.0'	135.0'	Grey sericite schist, not mineralized.									

Diamond Drill Sampling Record



Hole No. 5	Sheet 3			
Property BRACKERIDGE	Length	Lat.	Hor. Comp.	Ver. Comp.
District Fort Steele M.D.	Bearing	Dep.	Etch. at	Total Recovery %
Commenced Sept. 8, 1966	Dip	Elev.	True Dip	Logged by
Completed " 20, 1966	Objective		Location	

Footage		Description	Shorts Feet	Sample No.	Length Feet	Analysis				Recovery %
From	To					% Cu	Am/T	% Ag/T	% Pb	
		Sample 121.0' - 125.0'		4497	5	0.011				
		125.0' - 131.0'		4498	5	0.009				
		131.0' - 136.0'		4499	5	0.011				
135.0'	145.0'	Sparse chalcopyrite.								
		Sample 136.0' - 141.0'		4500	5	0.009				
		141.0' - 145.0'		4401	4	0.09				
	145.0'	END OF HOLE.								
		Shorts 0.0' - 40.0'	4		40					90%
		40.0' - 98.0'	Nil		58					100%
		98.0' - 111.0'	1		13					90%
		111.0' - 145.0'	Nil		34					100%

RAG:gas
 Trail Exploration Office, Western District
 March 3, 1967

Distribution: Montreal Exploration (1)
 Western Exploration (1)
 Owner (1)
 Field (1)

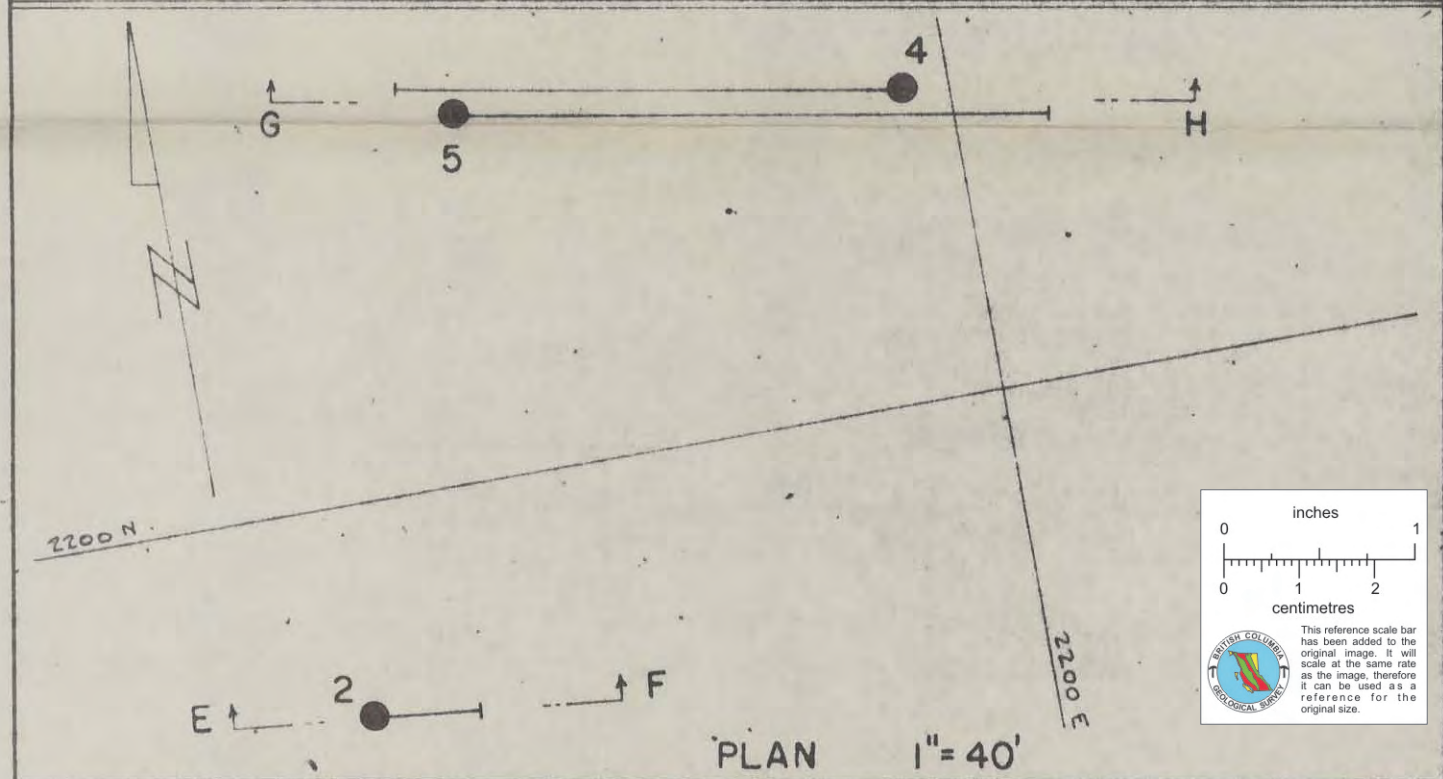
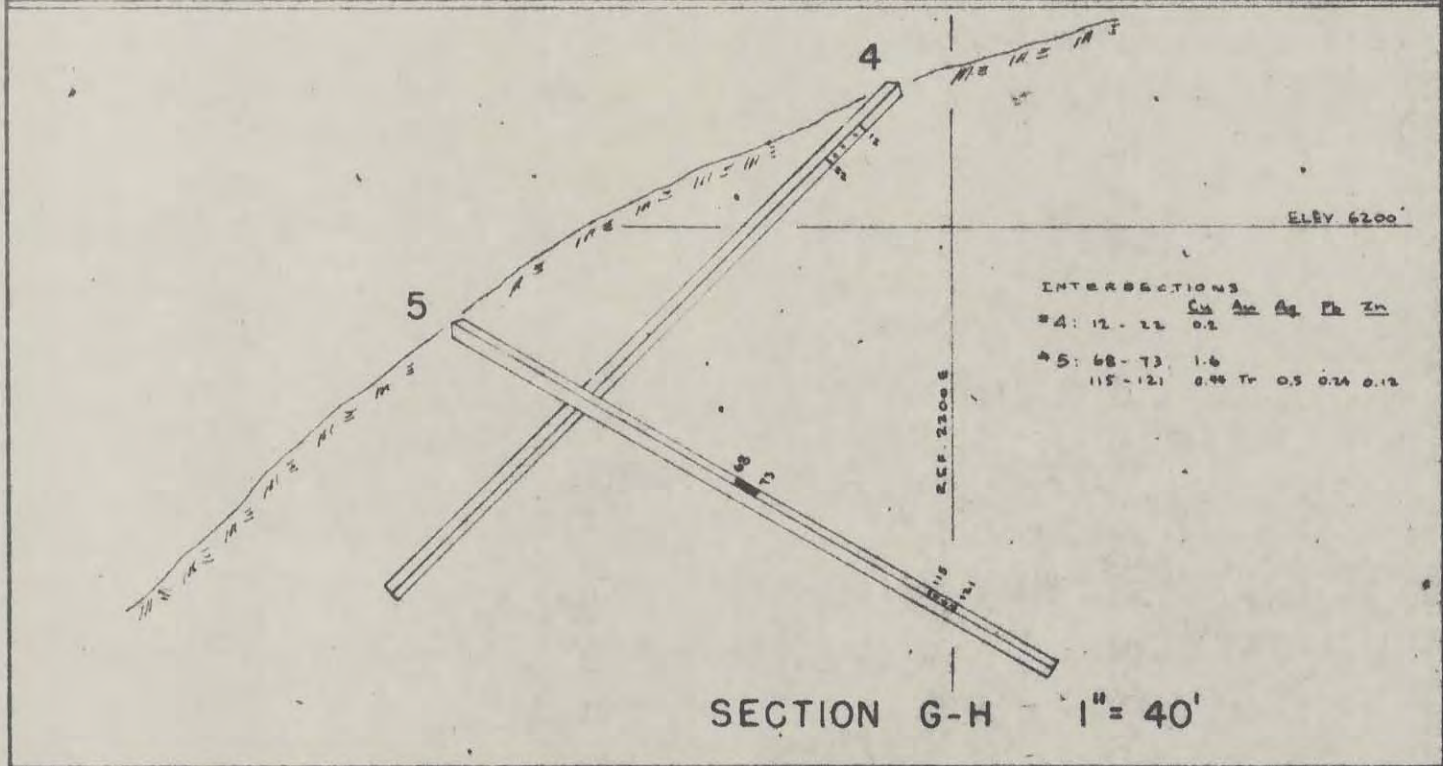
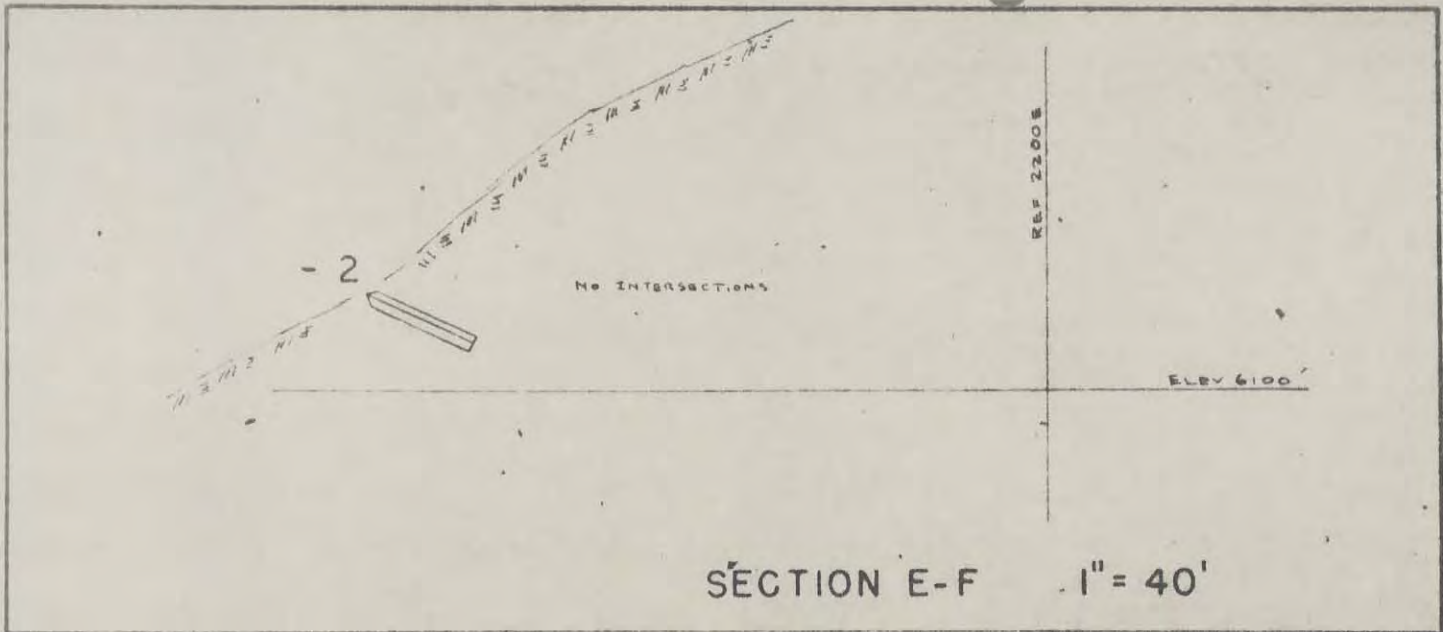

The Consolidated Mining and Smelting Company of Canada Limited

DRAWN BY: RGG		TRACED BY:	
REVISED BY	DATE	REVISED BY	DATE

**BRACEBRIDGE
DRILL HOLE 2, 4, 5**

SCALE: 1" = 40'

DATE: FEB 1967

PLATE:

The Consolidated Mining and Smelting Company of Canada Limited

ASSAY CERTIFICATE

KIMBERLEY, B.C. AUGUST 16 1966

G. WEBBER SPECIALS

Hole No. 3	DESCRIPTION	Lot	Moisture %	Gold Ozs.	Silver Ozs.	Copper Wet %	Lead Wet %	Zinc Wet %	Iron Wet %	Sulphur %	Insol %	Alumina %	Lime %	Mag. %	Bone Phosph. %	%	%	%
From To 5° 9°	66658 C ✓					NIL												
9° 10°	66659 C ✓					TRACE												
10° 11°	66660 C ✓			TRACE		TRACE												
11° 13°	66661 C ✓					NIL												
13° 15°	66662 C ✓					TRACE												
15° 16°	66663 C ✓					NIL												
16° 18°	66664 C ✓					TRACE												
18° 22°	66665, 66666 (Two TAGS) ✓			TRACE		.025												
23° 25°	66667 C ✓					NIL												
25° 30°	66668 C ✓					NIL												

OFFICIAL SERIAL No. 4526

ASSAYER

CHIEF ASSAYER H. White

The Consolidated Mining and Smelting Company of Canada Limited

ASSAY CERTIFICATE

KIMBERLEY, B.C. AUGUST 16 1966

G. WEBBER SPECIALS

Hold 3 (Cont'd) From To	DESCRIPTION	Lot	Moisture %	Gold Ozs.	Silver Ozs.	Copper Wet %	Lead Wet %	Zinc Wet %	Iron Wet %	Sulphur %	Insol %	Alumina %	Lime %	Mag. %	Bone Phosph. %	%	%	%
30° 33°	66669 C ✓					TRACE												
33° 36°	66670 C ✓					NIL												
36° 41°	66671 C ✓					NIL												
41° 44°	66672 C ✓					NIL												
44° 60°	66673 C ✓					NIL												
60° 70°	66674 C ✓			TRACE	0.10	1.03												
70° 79°	66675 C ✓			TRACE		1.00												
79° 84°	66676 C ✓			TRACE	0.45	1.90												
84° 91°	66677 C ✓					NIL												
Hold 1A 0° 4°	66678 C ✓			TRACE		0.38												

OFFICIAL SERIAL No. 4527

ASSAYER

CHIEF ASSAYER K. White

The Consolidated Mining and Smelting Company of Canada Limited

ASSAY CERTIFICATE

KIMBERLEY, B.C. AUGUST 16 1966

G. WEBBER SPECIALS

Hole 1A (cont'd)		DESCRIPTION	Lot	Moisture %	Gold Ozs.	Silver Ozs.	Copper Wet %	Lead Wet %	Zinc Wet %	Iron Wet %	Sulphur %	Insol. %	Alumina %	Lime %	Mag. %	Bone Phosph. %	%	%	%
From	To																		
4 ⁶	7 ⁰	66679 C ✓			TRACE	0.70	3.30												
7 ⁰	12 ⁸	66680 C ✓			TRACE	0.55	1.90												
12 ⁸	19 ³	66681 C ✓			.005	1.15	4.80												
19 ³	31 ³	66682 C ✓					.025												
31 ³	33 ⁹	66683 C ✓					2.10												
33 ⁹	42 ⁰	66684 C ✓					.05												
42 ⁰	45 ⁴	66685 C ✓			.005	1.30	5.4												
45 ⁴	50 ⁶	66686 C ✓			TRACE		.064												
50 ⁶	54 ⁰	66687 C ✓					.57												
54 ⁰	57 ⁰	66688 C ✓					.038												

OFFICIAL SERIAL No. 4528

ASSAYER

CHIEF ASSAYER H. White

The Consolidated Mining and Smelting Company of Canada Limited

ASSAY CERTIFICATE

KIMBERLEY, B.C. AUGUST 16 1966

G. WEBBER SPECIALS

Half	DESCRIPTION	Lot	Moisture %	Gold Ozs.	Silver Ozs.	Copper Wet %	Lead Wet %	Zinc Wet %	Iron Wet %	Sulphur %	Insol. %	Alumina %	Lime %	Mag. %	Bone Phosph. %	%	%	%
From To																		
0° 15°	66689 C ✓					.045												
15° 36°	66690 C ✓			TRACE		.155												
36° 40°	66691 C ✓			TRACE	0.35	1.25												

OFFICIAL SERIAL No. 4527

ASSAYER

CHIEF ASSAYER H. White

The Consolidated Mining and Smelting Company of Canada Limited

ASSAY CERTIFICATE

KIMBERLEY, B.C. AUGUST 17 1966

G WEBBER SPECIALS

From	To	DESCRIPTION	Exp. No.	Moisture %	Gold Ozs.	Silver Ozs.	Copper Wet %	Lead Wet %	Zinc Wet %	Iron Wet %	Sulphur %	Insol. %	Alumina %	Lime %	Mag. %	Bone Phosph. %	%	%	%
55°	60°	46658 ✓	46920				0.24												
60°	65°	46659 ✓	46930		TRACE		0.17												
65°	70°	46660 ✓	46940				0.07												
70°	75°	46661 ✓	46950		TRACE	.2	0.29												
75°	80°	46662 ✓	46960		TRACE	1.0	5.0												
80°	85°	46663 ✓	46970		TRACE	.5	2.3												
85°	90°	46664 ✓	46980				2.2												
90°	97.5	46665 ✓	46990		TRACE	.2	0.90												
Grab Sample		46666	47000		TRACE	.05	NIL	.01	.02										

OFFICIAL SERIAL No. 4530

ASSAYER

CHIEF ASSAYER

K. White

The Consolidated Mining and Smelting Company of Canada Limited

ASSAY CERTIFICATE

KIMBERLEY, B.C. August 24 1966

G.L.W. SPECIALS DRILL CORE

DESCRIPTION	Lot	Moisture %	Gold Ozs.	Silver Ozs.	Copper Wet %	Lead Wet %	Zinc Wet %	Iron Wet %	Sulphur %	Insol. %	Alumina %	Lime %	Mag. %	Bone Phosph. %	%	%	%
87320					TRACE												
87321					.02												
87322					NIL												
87323					NIL												
87324					TRACE												
87325					.07												
87326					.65												
87327					NIL												
87328					NIL												
87329					NIL												

OFFICIAL SERIAL No. 4532

ASSAYER

CHIEF ASSAYER

K. White

The Consolidated Mining and Smelting Company of Canada Limited

ASSAY CERTIFICATE

KIMBERLEY, B.C. AUGUST 31 1966

G. L. WEBBER SPECIAL DRILL CORE

DESCRIPTION	Lot	Moisture %	Gold Ozs.	Silver Ozs.	Copper Wet %	Lead Wet %	Zinc Wet %	Iron Wet %	Sulphur %	Insol. %	Alumina %	Lime %	Mag. %	Bone Phosph. %	%	%	%
87331 C					TRACE												
87332 C					TRACE												
87333 C					NIL												
87334 C					NIL												
87335 C					NIL												
87336 C					TRACE												
87337 C					TRACE												
87338 C					NIL												
87339 C					NIL												
87340 C					NIL												

OFFICIAL SERIAL No. 4533 ASSAYER CHIEF ASSAYER H. C. Pate

The Consolidated Mining and Smelting Company of Canada Limited

ASSAY CERTIFICATE

KIMBERLEY, B.C. AUGUST 31 1966

G L WEBBER SPECIAL DRILL CORE

DESCRIPTION	Lot	Moisture %	Gold Ozs.	Silver Ozs.	Copper Wet %	Lead Wet %	Zinc Wet %	Iron Wet %	Sulphur %	Insol. %	Alumina %	Lime %	Mag. %	Bone Phosph. %	%	%	%
87341 C					TRACE												
87342 C					TRACE												

OFFICIAL SERIAL No. 4533 ASSAYER CHIEF ASSAYER [Signature]

The Consolidated Mining and Smelting Company of Canada Limited

ASSAY CERTIFICATE

KIMBERLEY, B.C. OCTOBER 20 1966

DRILL CORE KIMBERLEY EXPLORATION

DESCRIPTION	Lot	Moisture %	Gold Ozs.	Silver Ozs.	Copper Wet %	Lead Wet %	Zinc Wet %	Iron Wet %	Sulphur %	Insol. %	Alumina %	Lime %	Mag. %	Bone Phosph. %	%	%	%
4401					0.09												
4476					0.003												
4477					0.029												
4478					0.21												
4479					0.18												
4480					0.11												
4481					0.017												
4482					0.12												
4483					0.076												
4484					0.018												

OFFICIAL SERIAL No. 4547

ASSAYER

CHIEF ASSAYER N. A. Trenholm

The Consolidated Mining and Smelting Company of Canada Limited

ASSAY CERTIFICATE

KIMBERLEY, B.C. OCTOBER 20 1966

DRILL CORE KIMBERLEY EXPLORATION

DESCRIPTION	Lot	Moisture %	Gold Oza.	Silver Oza.	Copper Wet %	Lead Wet %	Zinc Wet %	Iron Wet %	Sulphur %	Insol. %	Alumina %	Lime %	Mag. %	Bone Phosph. %	%	%	%
4485					0.077												
4486					0.26												
4487					1.60												
4488					0.09												
4489					0.13												
4490					0.205												
4491					0.028												
4492					0.012												
4493					0.006												
4494					0.007												

OFFICIAL SERIAL No. 4548

ASSAYER

for CHIEF ASSAYER

N. A. Trenholm

The Consolidated Mining and Smelting Company of Canada Limited

ASSAY CERTIFICATE

KIMBERLEY, B.C. OCTOBER 20 1966

DRILL CORE KIMBERLEY EXPLORATION

DESCRIPTION	Lot	Moisture %	Gold Oza.	Silver Oza.	Copper Wet %	Lead Wet %	Zinc Wet %	Iron Wet %	Sulphur %	Insol. %	Alumina %	Lime %	Mag. %	Bone Phosph. %	%	%	%
4495					0.03												
4496			Trace	0.5	0.44	0.24	0.12										
4497					0.011												
4498					0.009												
4499					0.011												
4500					0.009												

OFFICIAL SERIAL No. 4549

ASSAYER

CHIEF ASSAYER N.A. Trenholm