

93L-15

810587

BIG ONION PROSPECT

Report on Norandas 1964 program

R. A. RUTHERFORD

ASTLAIS PROPERTY  
WORK DONE DURING 1964 FIELD SEASON

STAKING:

Three fractional claims were staked and recorded as follows:

<u>Claim</u>	<u>Locator</u>	<u>Date of Staking</u>
Astlais # 9	R. A. Rutherford	July 14th, 1964
Astlais #10	R. A. Rutherford	July 14th, 1964
Astlais # 9	R. A. Rutherford	July 21st, 1964

These claims were staked as agent for Noranda Exploration Co. Ltd. and their approximate location is shown on the accompanying sketches.

LINE CUTTING:

There was 2500 feet of cross line extensions cut on the old 1963 grid. Also a new E - W baseline was cut and turned off every 200 feet for a length of 1500 feet.

SURVEYING:

Fifteen man days were spent surveying in proposed diamond drill hole locations and claim posts.

FLAGGING:

In order to facilitate positioning in proposed air photography, a few claim posts were marked with white sheeting. Their approximate positions are shown on an accompanying sketch.

BULLDOZING:

Bulldozing in 1964 consisted of repairing and widening the previously existing switchback access road, constructing drill sites, and digging a few new trenches.

GEOCHEMISTRY:

Seventy-one soil samples were collected from the "C" zone along the edge of the roads and trenches to complete the "C" zone soil sampling started in 1963. The results have been plotted and are shown on an accompanying map.

GEOPHYSICS:

A few low-frequency J.E.M. traverses were done on the property and the plotted results are shown on an included map.

DIAMOND DRILLING:

Two diamond drill holes were drilled, one 50 foot vertical hole, and one 200 foot 45° hole bearing due N. The results have been summarized and shown in the accompanying logs and sections.

ROCK SAMPLING:

Periodic grab samples were taken from the trenches on the property for assaying. Their approximate locations and values are shown on the enclosed map.

<u>Type of Work</u>	<u>Man Days</u>
Expediting	4
Staking	2
Prospecting	3
Rock Sampling	1
Surveying	15
Trenching and Road Construction Supervision	12
Soil Sampling	3
Mapping	4
Camp Construction (core rack etc.)	5
Flagging Claim Posts	6
Geophysics	4
Drill Move Supervision	3
Line Cutting	10
Drafting and Report Writing	8
Logging and Splitting Core	4
TOTAL:	<u>84</u>

R. A. Rutherford,  
Geologist.



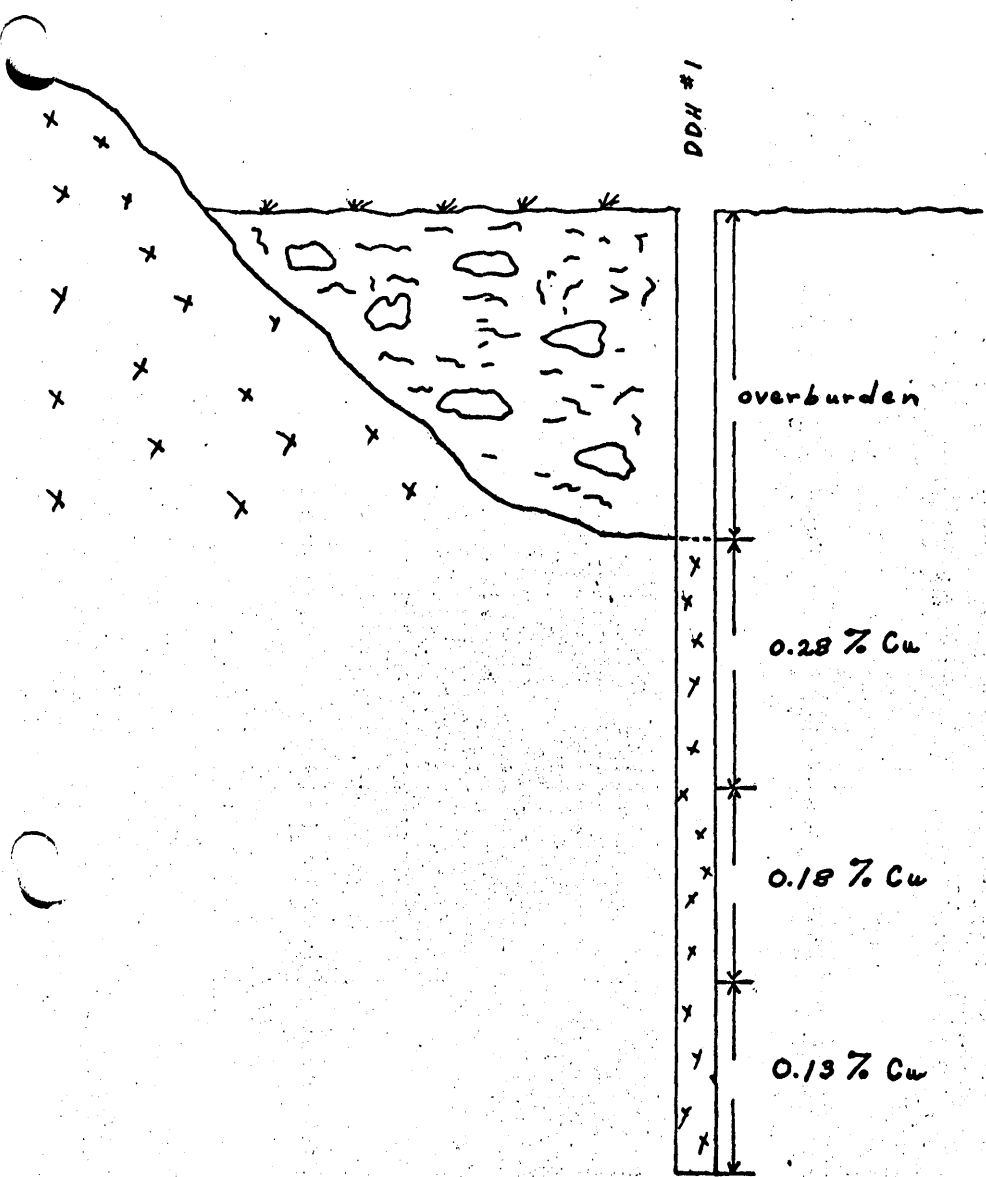

Astlais Property

Section DDH #1

VYP porphyry

Scale: 1" = 10'

RAR/64

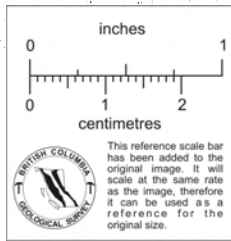



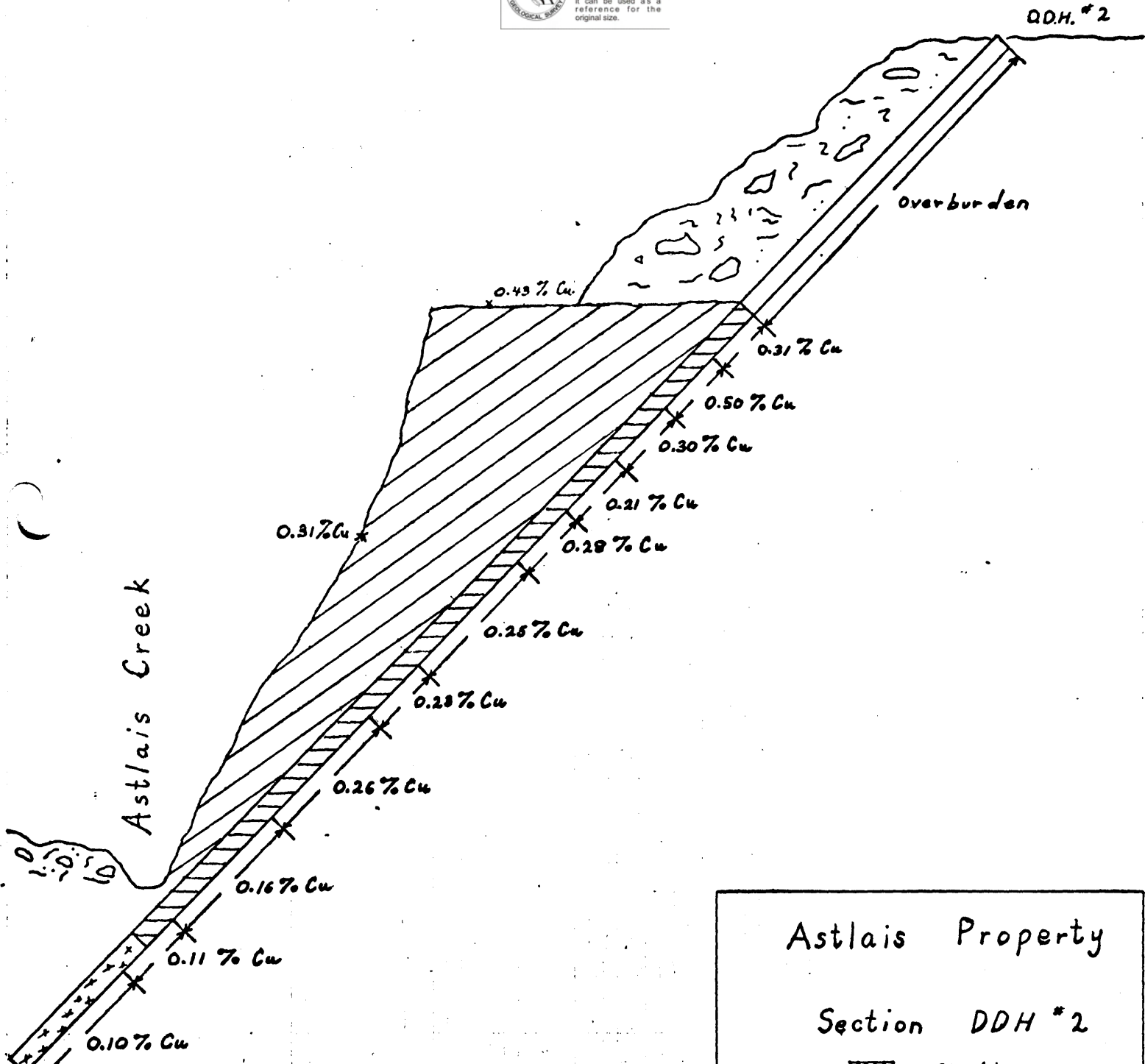
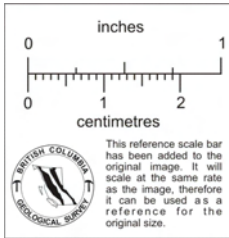



Astlais Property

Section DDH #2

	Rhyolite
	Porphyry
x	grab sample

Scale: 1" = 20'

RAR/62

# NORANDA EXPLORATION CO. LTD.

ASTLAIS PROPERTY

## SAMPLE REPORT

DATE July 5th - 8th, 1964

SAMPLE NO.	PLACE	LOCATION	Cu	Ag	MoS <sub>2</sub>	SAMPLED BY
			WGT. PER CENT	PER CENT	WGT. PER CENT	
B 6812	A 14	Astlais Trenches - Grab Samples	0.06	Tr	Tr	A. R.
B 6813	A 45	"	0.08	Tr	Tr	"
B 6814	A 50	"	1.26	0.12	0.005	"
B 6815	A 51	"	1.63	0.12	0.01	"
B 6816	A 110	"	0.68	0.08	0.005	"
B 6817	A 130	"	0.30	0.06	0.005	"
B 6818	A 152	"	0.32	Tr	0.005	"
B 6819	A 166	"	0.21	Tr	0.005	"
B 6820	A 168	"	0.30	Tr	0.01	"
B 6821	A 193	"	0.26	Tr	0.005	"
B 6822	A 64	"	1.04	Tr	0.01	"
B 6823	A 169	"	0.13	Tr	Tr	"
B 6825	70S - Ast. Ck.	"	0.31			"
6532	A 51	Check grab by Dr. A. M. Bell	1.49			A. M. B.
F 6533	70S - Ast. Ck.		0.43			"
F 6534	A 53	Astlais Trenches - Grab Samples	0.91			A. R.
F 6535	A 53	"	0.30			"
F 6536	A 53	"	0.39			"



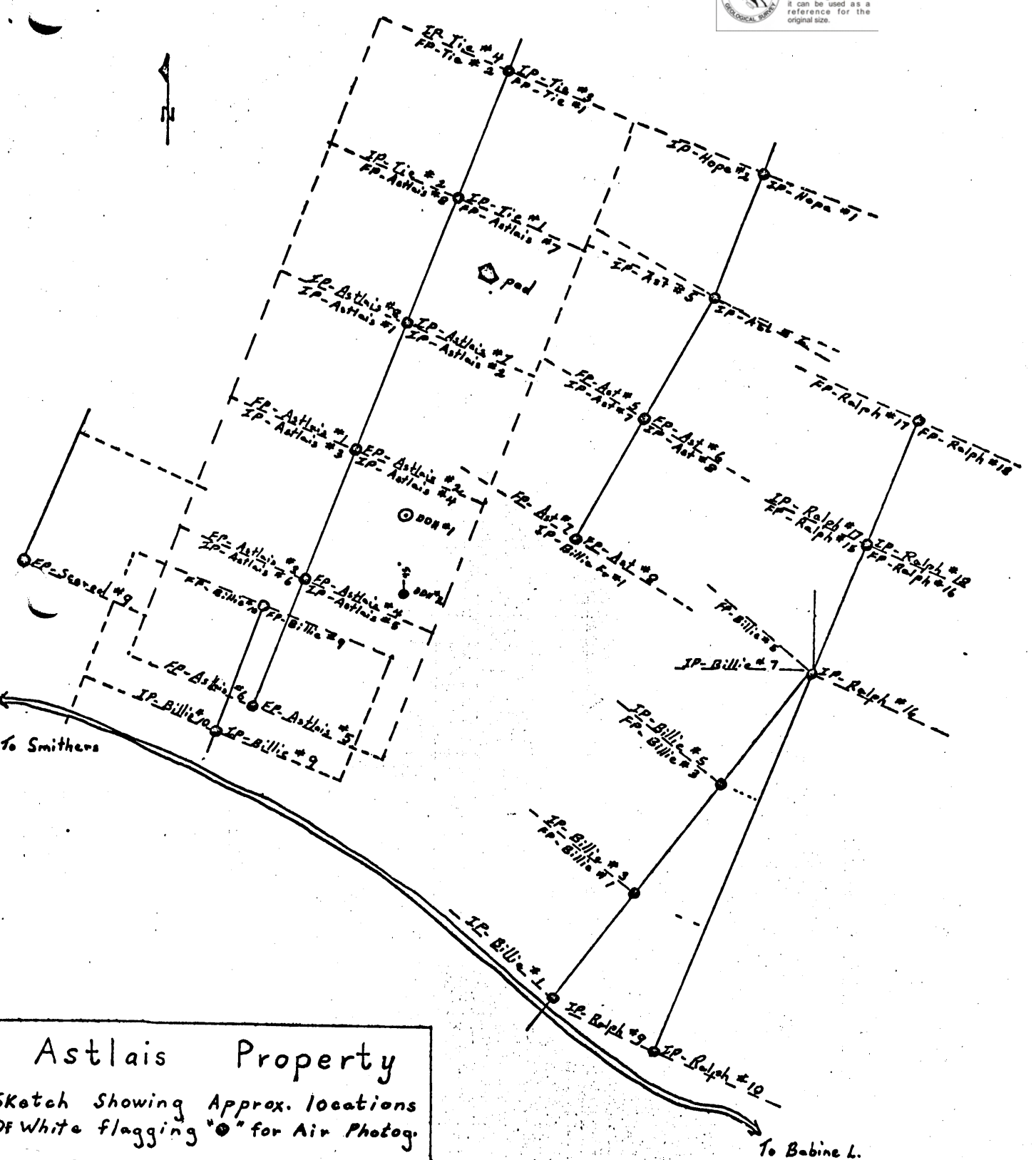
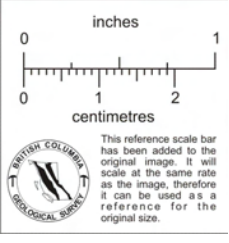

# Astlais Property

Sketch Showing Approx. locations  
of White flagging "●" for Air Photog.

flagging

- IP - initial claim post
- FP - final claim post
- DDH - diamond drill hole

Scale: 1" = approx. 1500'

AR/64

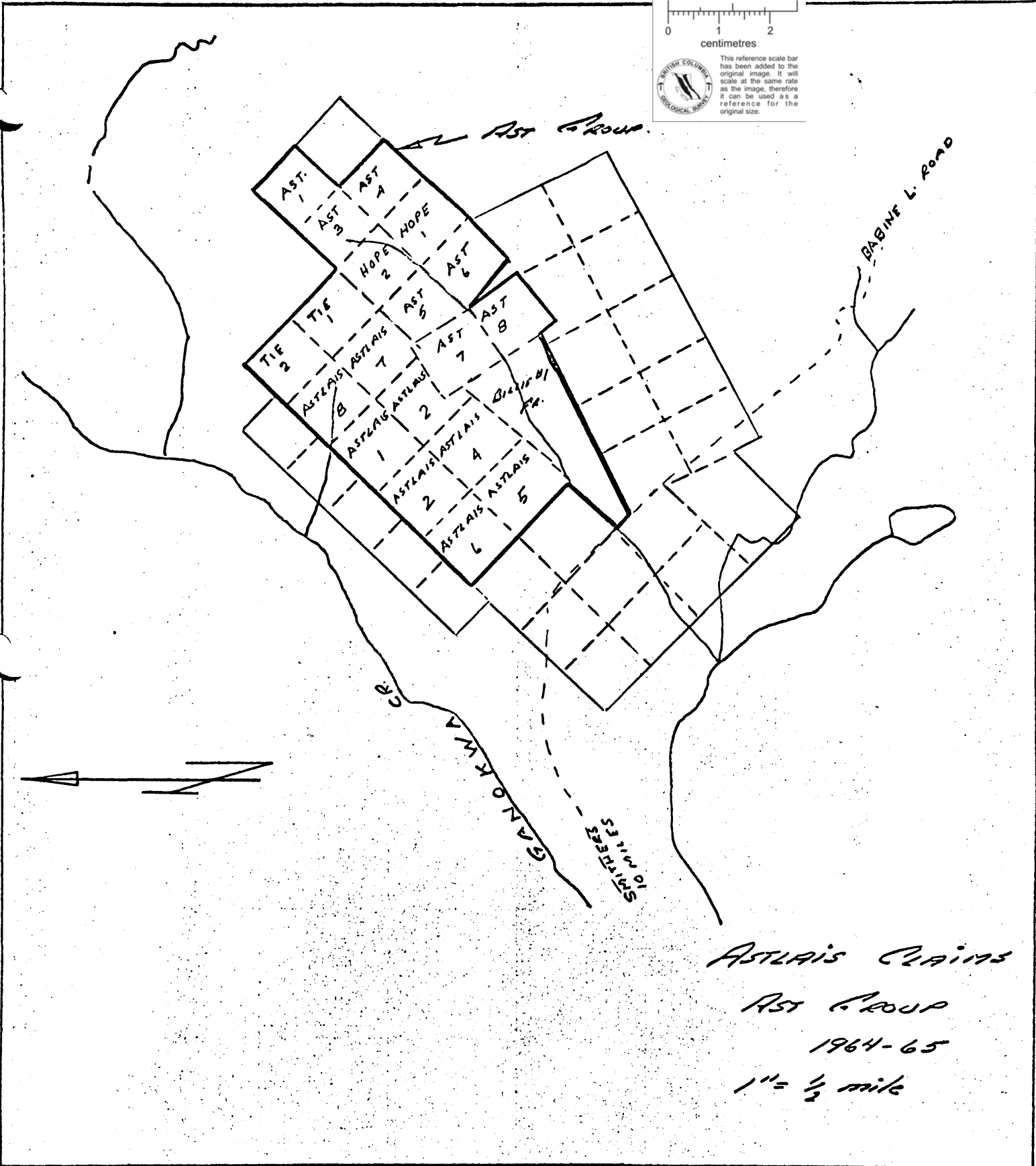
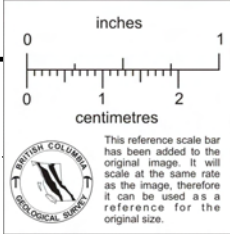

*Astlaish Claims*  
*AST GROUP*  
*1964-65*  
*1" = 1/2 mile*

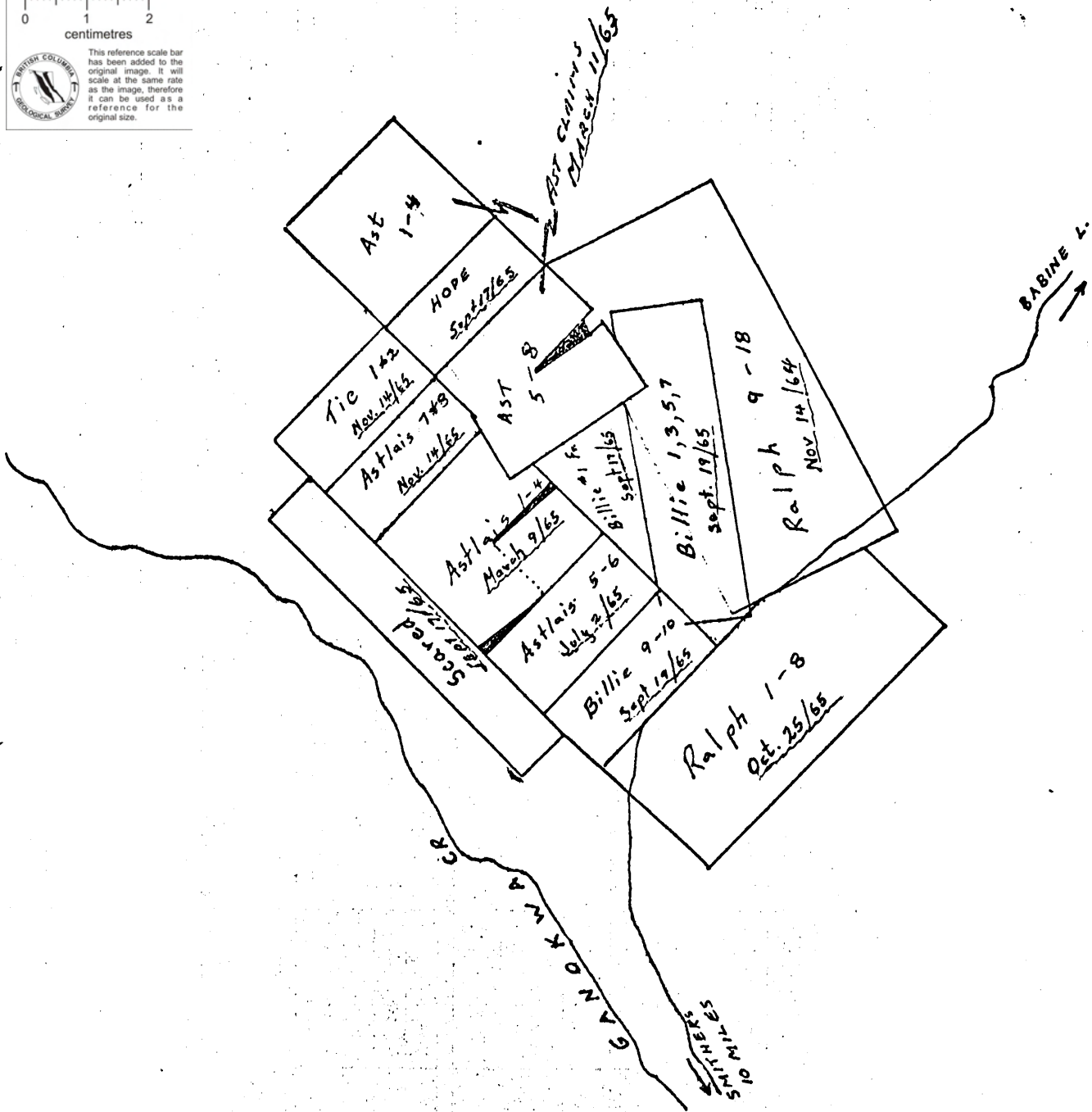
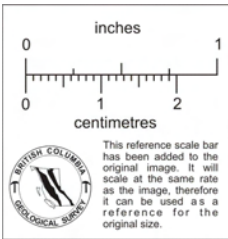

# Astlais Property

SKETCH SHOWING  
CLAIM EXPIRY DATES

Scale: 1" = 1/2 mile

▬: Fractional claims staked July/64

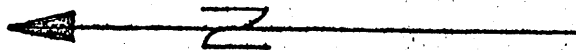

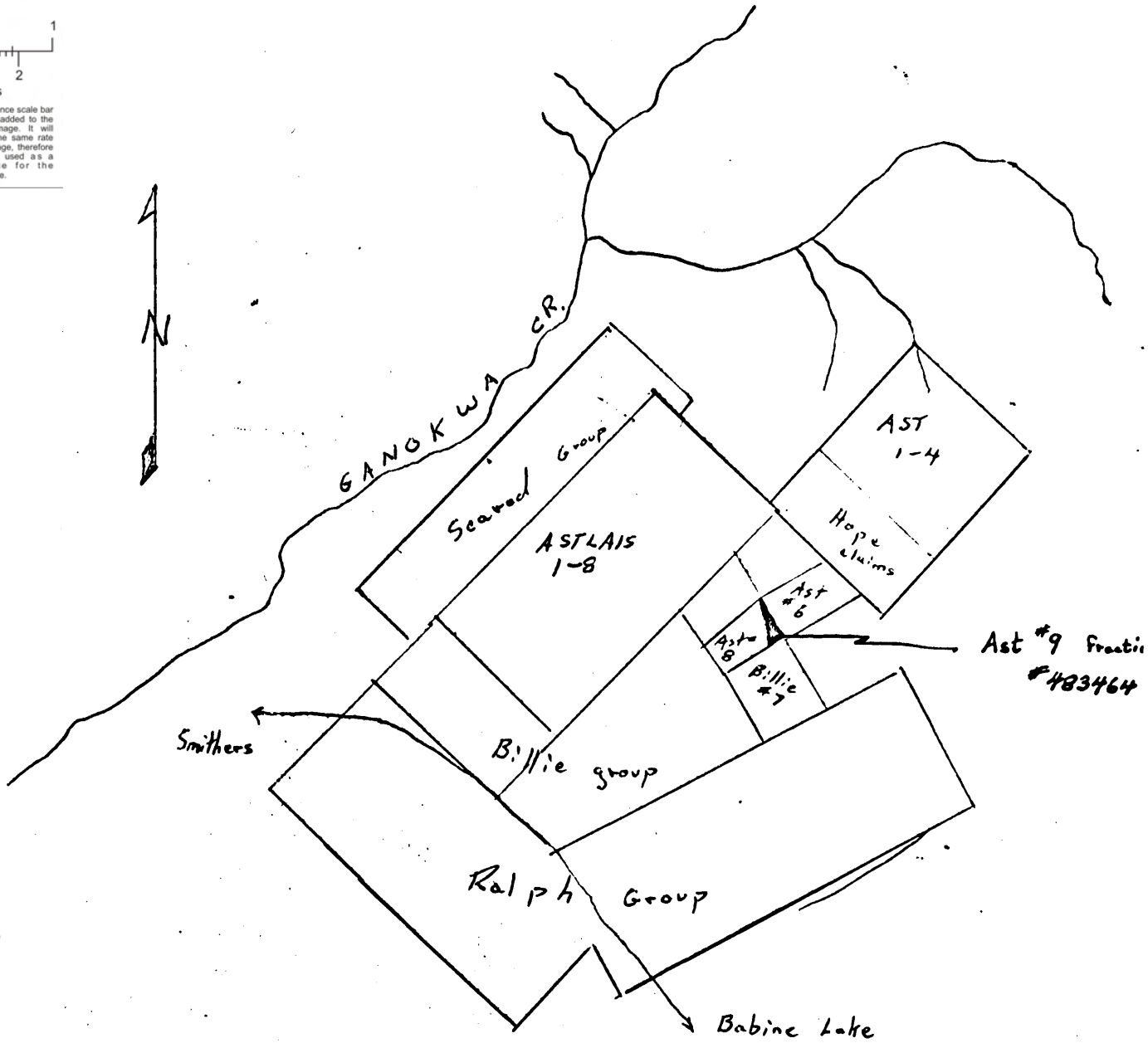
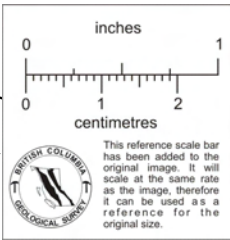

Fractional Claim AST #9  
 STAKED BY R.A. Rutherford  
 July 21 1964  
 F. MINERS CERT. NO 24474  
 DATE OF ISSUE :- April 17, 1964

SKETCH SHOWING  
 AST #9 Fraction

OMINECA M. D.

SCALE : 1 INCH = 1/2 MILE

A.R.

22/64