

PROSPECTUS OF WANN RIVER CROWN GRANT CLAIMS
(Lot Numbers 4657 - 4669 - 4670 in Atlin B.C. District)

PROPERTY LOCATION

Above mentioned lots are located on the Wann River between Edgar Lake and Taku Arm of Lake Tagish (approx 59°27'N 134°15'W) about 3 miles south of the Old Engineer's Gold Mine - For details of position on river and adjacent claims see attached map.

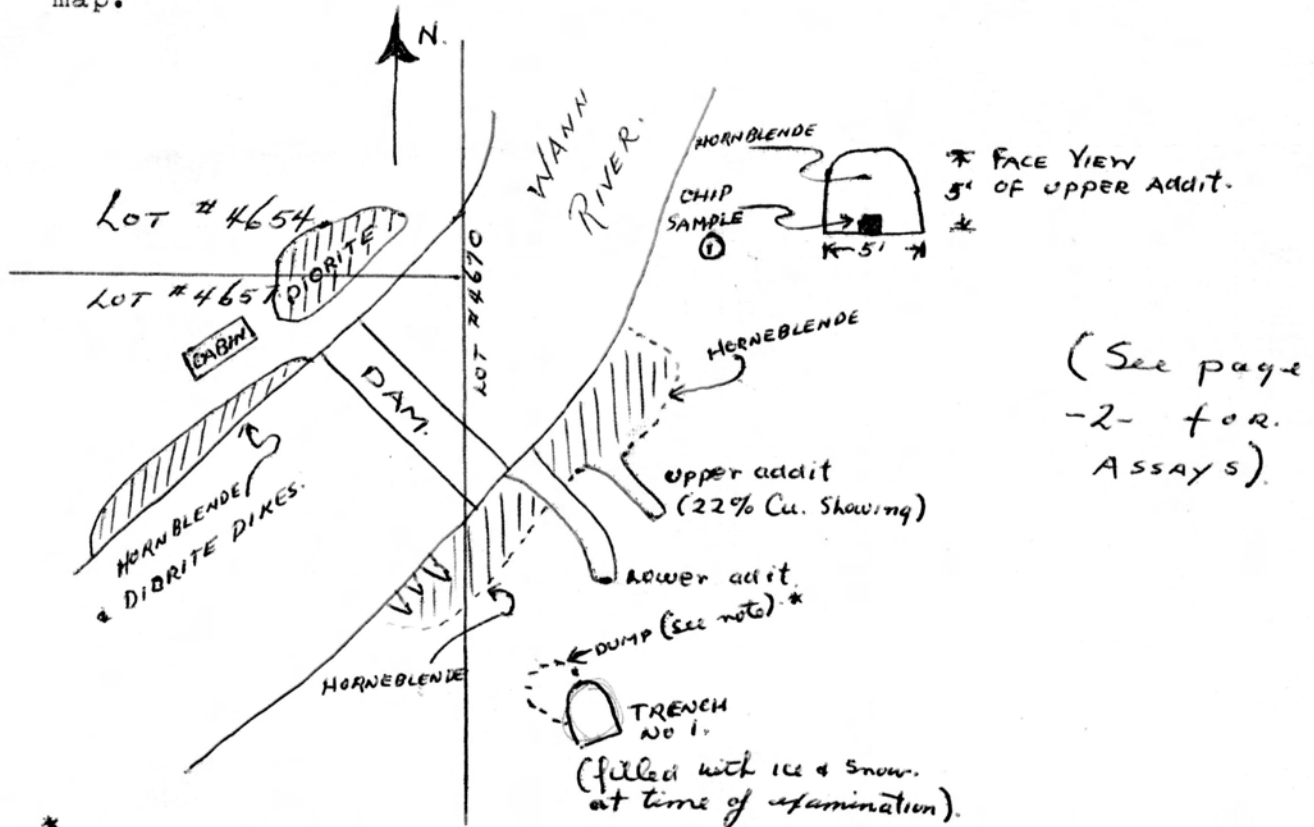

(See page
-2- for
ASSAYS)

* Note: Dump contains pieces of nearly solid pyrrhotite and pieces of heavily disseminated Chalcopyrite (see assay # ②) and pyrrhotite (see assay # ③) in hornblende.

MINERALIZATION & SHOWINGS (Cont'd)

← trench 3 (no mineralization).

In addition to the three assays shown, there is one other containing a 22% copper plus good weights of silver and gold content. This sample from the dump at the upper adit is no doubt a 'picked sample'. This sample was brought to Hudson Bay Exploration & Development Co Ltd by a Mr W.D. Geddes who formerly held these claims. It is unfortunate that more details on this assay are not available. They are presently held in the confidential files of the Hudson Bay Exploration & Development Co Ltd stored in their now vacant Whitehorse office.

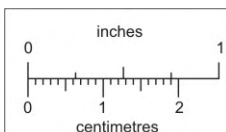

This reference scale bar has been added to the original image. It will scale at the same rate as the image, therefore it can be used as a reference for the original size.



HISTORY

Copper first discovered in 1900 - tunnel dug 20 feet following the seam of copper. This claim was dropped when the tunnel was flooded by a power dam project for the Engineer Gold Mine. Showings rediscovered in 1952 by a Mr W.D. Geddes. He in partnership with at least three others obtained an examination by Hudson Bay Exploration & Development Co Ltd's chief Yukon Geologist a Mr Ken Gamey. At time of this examination the ground and showings were mainly covered with ice and snow affording only a cursory inspection. Mr Gamey recommended the property for diamond drilling but the recommendation was turned down by Mr W.E. Green General Manager of the Company at Flin Flon, Manitoba. He did not see the property but stated that his company was fully committed by previously optioned properties. Because of this and other disappointments the claims were dropped and remained dormant until June 1956 when Mr R.L. North applied for the leases which were subsequently finalized on 6 Dec 1956.

PERSONS INVOLVED

Only two people are involved; they are R.L. North and C.W. Albertson both of Whitehorse Y.T. Although the claims are in the name of R.L. North, a full 50/50 partnership exists between them. There are no other persons involved.

OBJECTIVES

The main objectives are to arrange & complete a satisfactory examination of the property with the ultimate goal of development ~~XXXXXX~~ if the mineralization present is in justifiable quantities.

ASSAY REPORTS

① Chip Sample 1.0' width.

.01	Au	oz.
.43	Ag	oz
5.22	Cu	%
Tr	Zn	%.
-	Ni	%.

② Assay of Chalcopyrite.
in dump, trench 1.

.01	Au	oz.
tr.	Ag	oz.
5.68	Cu	%
tr	Zn.	%.
tr.	Ni.	%

③ Assay of Pyrrhotite.
in dump - trench 1.

tr	Au	oz
tr	Ag	oz.
.62	Cu	%
tr.	Zn	%.
.74	Ni	%.

C.W. Albertson
C.W. Albertson a.

R.L. North.

TAKW ARM

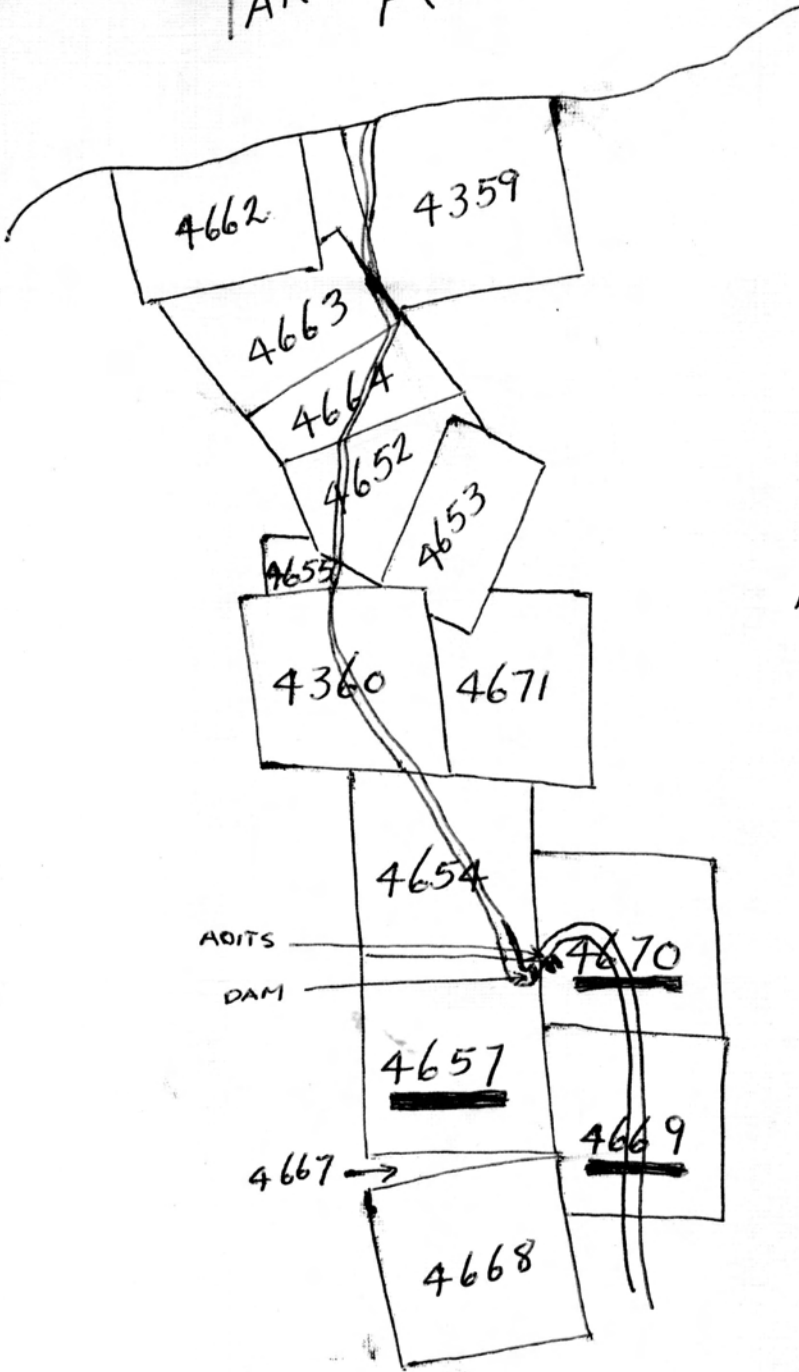

CLAIM NRS
4670 - 4669 - 4657
underlined

