

924 Property Submitted

Rupert Inlet

CYPRUS EXPLORATION CORPORATION, LTD.

810388

INTER OFFICE MEMO

VANCOUVER OFFICE

TO: Mr. J.G. Hansen

DATE December 5th 1967

FROM: Mr. D.W. Tully

SUBJECT: Rupert Inlet - Copper Showings

file

→ Robert Zielinski, prospector and former official of Forest-Kerr Mines, came into our office on November 27th with four grab samples. These samples are reported to be from the south side of Rupert Inlet, 7 miles south of Port Hardy, B.C., at the north end of Vancouver Island. They assayed respectively:

	<u>Silver</u>	<u>Copper</u>
Sample 1	Tr.	3.15%
Sample 2	1.30 ozs.	9.20%
Sample 3	.85 ozs.	3.80%
Sample 4	.25 ozs.	.25%

Zielinski was back in this office today and discussed the results.

Zielinski reports that Utah Mining and Construction are currently drilling a copper orebody on the north side of Rupert Inlet about 1 mile from his claims. The tonnage and grade of the Utah orezone is variously reported to be in the many millions of tons and probably less than 1% Copper. In excess of 100 holes have already been drilled.

Zielinski reports that Murray Pezim, a colleague of Isaac Shulman, has formed a new company called Rupert Minerals Limited of five million share capitalization on the claims where the samples reportedly came from. Pezim is reported to have taken down the vendor's interest, 750,000 shares and optioned 500,000 shares from the treasury at .10¢. He has possibly optioned another block at .35¢ but the amount and price are not certain.

Zielinski has suggested that Pezim is looking for a deal with Cyprus whereby we could take down treasury stock beginning at .50¢ a share and option the remainder of the treasury at higher prices. This could work out to a 75-25 deal.

continued /2

CYPRUS EXPLORATION CORPORATION, LTD.

INTER OFFICE MEMO

VANCOUVER OFFICE

DATE December 5th 19 67

TO: Mr. J.G. Hansen
FROM: Mr. D.W. Tully
SUBJECT: Rupert Inlet - Copper Showings

- 2 -

Other companies holding claims in the area around Rupert Inlet in the immediate vicinity of Utah Mining and Construction Company's holdings are:

- 1) Riviera Mining
- 2) Magnet Explorations Limited
- 3) Forest-Kerr Mines Limited

I plan to make an examination of the copper showings where the samples reported above came from.

Key map attached. (FOR FCP)

DWT/hh
Attachment

DWT

cc: Irish, W.O.
Perry, F.C.

PHONE: 685-5821

CERTIFICATE OF ASSAY

DEC 13 ENT'D
dmb

File No. 299321/324

J. R. WILLIAMS & SON LTD.

PROVINCIAL ASSAYERS AND CHEMISTS

Office and Laboratory:

580 Nelson Street, Vancouver 2, B. C.

I **Hereby Certify** that the following are the results of assays made by me upon samples of Ore
herein described and received from M. Cyprus Explorations, Ltd. Nov. 28, 1967.

MARKED	GOLD		SILVER		Copper		GROSS TOTAL VALUE	
	Ounces Per Ton	Value Per Ton	Ounces Per Ton	Value Per Ton	Per Cent.	Value Per Ton	Per Cent.	Value Per Ton
		\$		\$		\$		\$
3051-7	Trace		0.55		3.15			
30518	Trace		1.30		9.20			
30519	Trace		0.85		3.80			
30520	Trace		0.25		0.25			

R Zielinski

JOB NO. VCR OFF

Gold calculated at \$ _____ per ounce.

Silver calculated at _____ cents per ounce.

Calculated at _____ cents per lb.

Calculated at _____ cents per lb.

Calculated at _____ cents per lb.

NOTE—Pulps of Samples retained 2 months from date of Receipt.
Rejects 1 week unless otherwise instructed.

[Signature]

Provincial Assayer.

ETCH OF NEW STAKING
 RUPERT INLET
 SEPT. 1967

92-L-11

5 MILES
 TO PORT HARDY, B.C.

THESE CLAIMS HAVE BEEN TIED IN TO THE TOPOGRAPHY AND EXISTING CLAIMS WHERE EVER POSSIBLE. IN THIS SKETCH THEY ARE SHOWN AS ACCURATELY AS POSSIBLE WITH RESPECT TO THE EXISTING CLAIMS AND THEREBY DISREGARDING THEIR LOCATION WITH RESPECT TO TOPOGRAPHY PARTLY. SIGNIFICANT DISCREPANCIES IN MAPS OF THE AREA, AND ALSO PLOTTING OF EXISTING CLAIMS ON THE STAKING MAP WITH RESPECT TO TOPOGRAPHY HAVE BEEN NOTED.

THIS SKETCH IS A COMPROMISE BETWEEN TOPOGRAPHY AND TRUE CLAIM POSITIONS AS THEY WERE FOUND IN THE FIELD AND IS AN HONEST ATTEMPT TO FIT THE NEW CLAIM BLOCK OF 271 TO THE EXISTING CLAIM BLOCK AND A FEW MAIN TOPOGRAPHIC FEATURES.

K. B. Sanders
 Sept. 25, 1967.

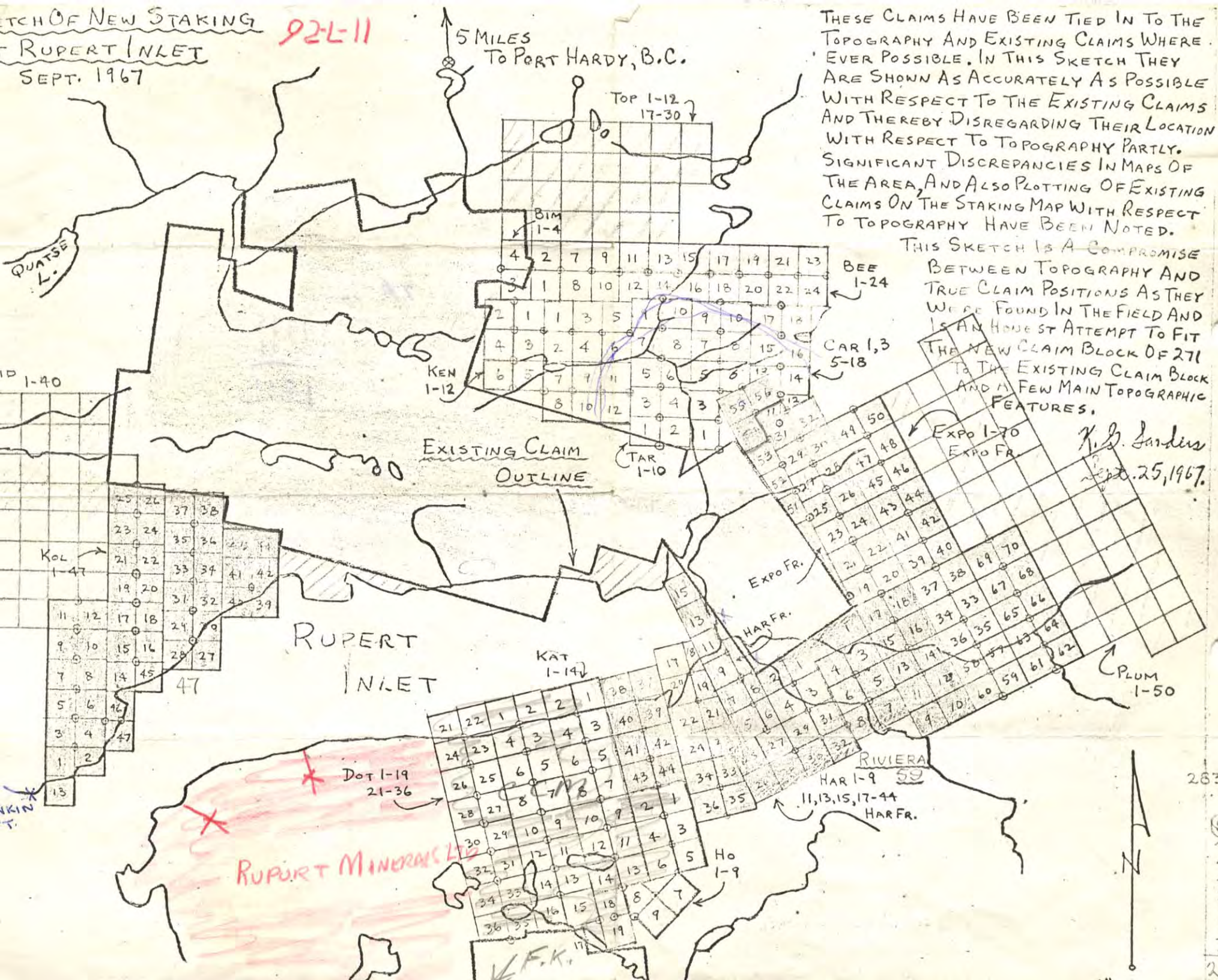

283
 58
 47
 45
 35
 33
 33
 283

SKETCH OF NEW STAKING
AT RUPERT INLET
 SEPT. 1967

THESE CLAIMS HAVE BEEN TIED IN TO THE TOPOGRAPHY AND EXISTING CLAIMS WHERE EVER POSSIBLE. IN THIS SKETCH THEY ARE SHOWN AS ACCURATELY AS POSSIBLE WITH RESPECT TO THE EXISTING CLAIMS AND THEREBY DISREGARDING THEIR LOCATION WITH RESPECT TO TOPOGRAPHY PARTLY. SIGNIFICANT DISCREPANCIES IN MAPS OF THE AREA, AND ALSO PLOTTING OF EXISTING CLAIMS ON THE STAKING MAP WITH RESPECT TO TOPOGRAPHY HAVE BEEN NOTED.

THIS SKETCH IS A COMPROMISE BETWEEN TOPOGRAPHY AND TRUE CLAIM POSITIONS AS THEY WERE FOUND IN THE FIELD AND IS AN HONEST ATTEMPT TO FIT THE NEW CLAIM BLOCK OF 271 TO THE EXISTING CLAIM BLOCK AND A FEW MAIN TOPOGRAPHIC FEATURES.

K. B. Gardner
 Sept. 25, 1967.

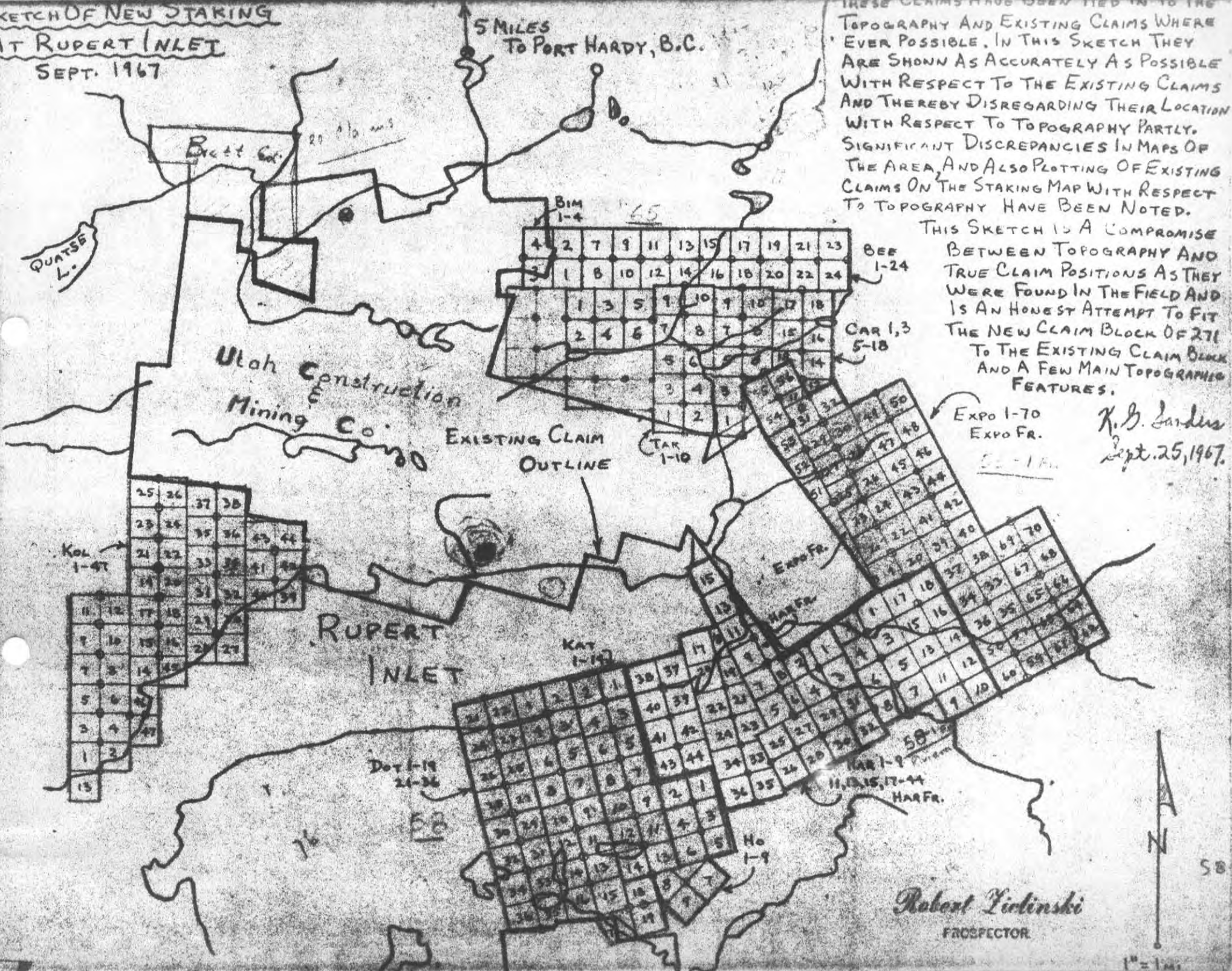

Robert Zielinski
 PROSPECTOR

SKETCH OF NEW STAKING
AT RUPERT INLET
 SEPT. 1967

5 MILES
 TO PORT HARDY, B.C.

THESE CLAIMS HAVE BEEN TIED IN TO THE TOPOGRAPHY AND EXISTING CLAIMS WHERE EVER POSSIBLE. IN THIS SKETCH THEY ARE SHOWN AS ACCURATELY AS POSSIBLE WITH RESPECT TO THE EXISTING CLAIMS AND THEREBY DISREGARDING THEIR LOCATION WITH RESPECT TO TOPOGRAPHY PARTLY. SIGNIFICANT DISCREPANCIES IN MAPS OF THE AREA, AND ALSO PLOTTING OF EXISTING CLAIMS ON THE STAKING MAP WITH RESPECT TO TOPOGRAPHY HAVE BEEN NOTED.

THIS SKETCH IS A COMPROMISE BETWEEN TOPOGRAPHY AND TRUE CLAIM POSITIONS AS THEY WERE FOUND IN THE FIELD AND IS AN HONEST ATTEMPT TO FIT THE NEW CLAIM BLOCK OF 271 TO THE EXISTING CLAIM BLOCK AND A FEW MAIN TOPOGRAPHIC FEATURES.

K. B. Sanders
 Sept. 25, 1967.

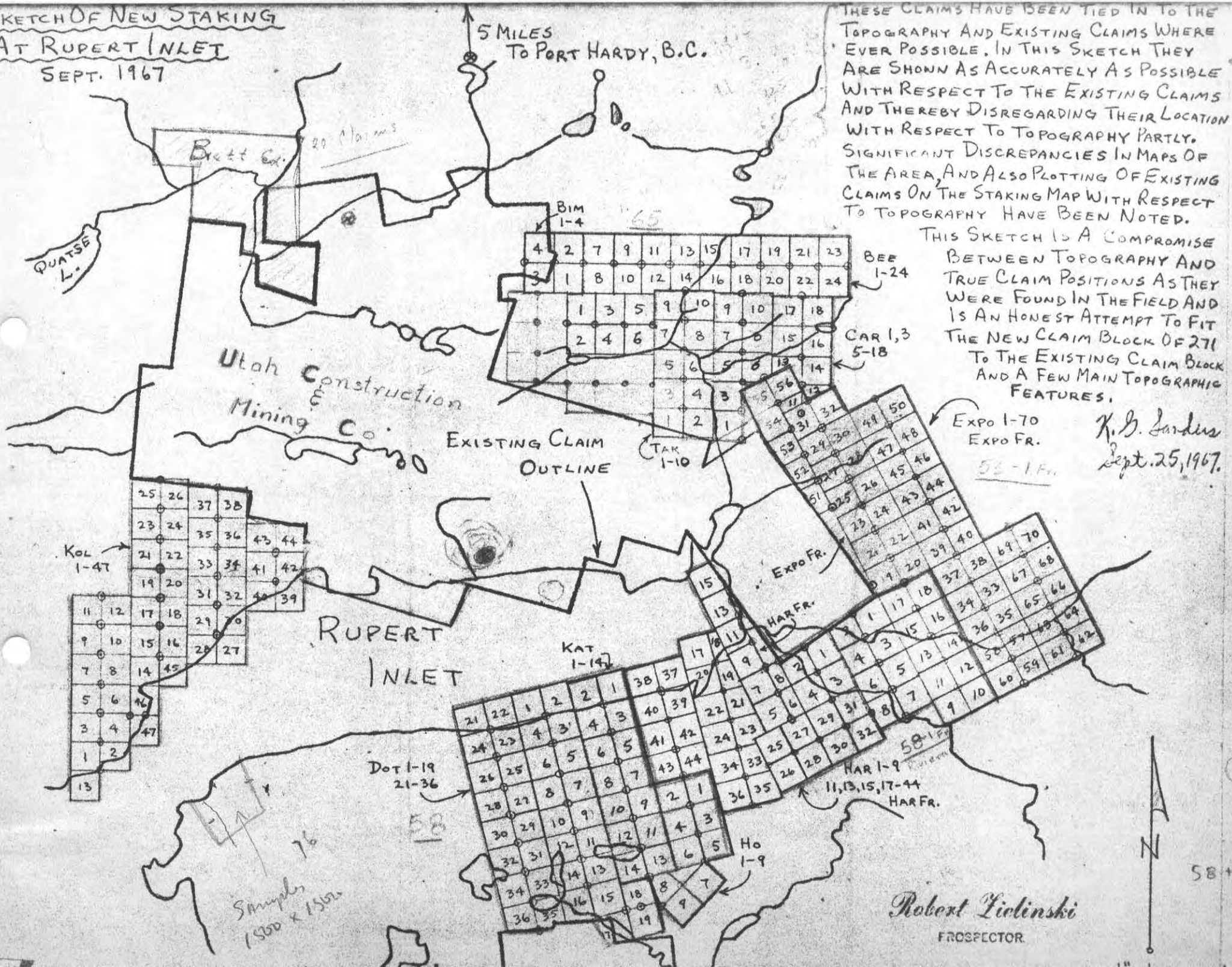

Robert Zielinski
 PROSPECTOR

76
 Samples
 1500 x 1500

58
 N

TO NORTH SEE MAP 92 L/1/2

TO NORTH SEE MAP 92 L/1/4 W

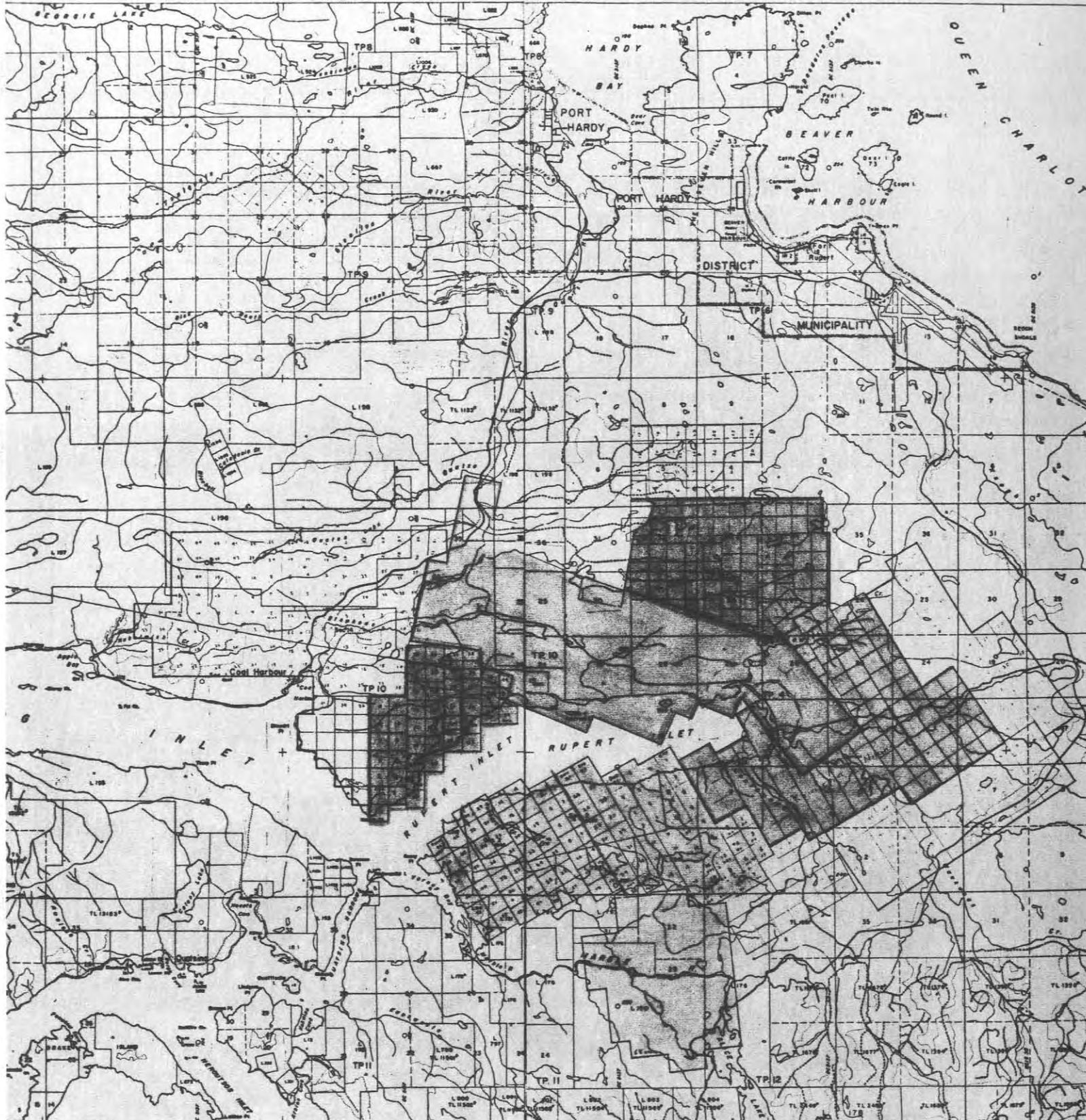

TO SOUTH SEE MAP 92 L/1/2
 HERBERT FORBES
 DEPARTMENT OF LANDS, FORESTS
 AND WATER RESOURCES
 SURVEYS AND MAPPING BRANCH
 AIR DIVISION
 VICTORIA, B.C.
INTERIM MAP 92 L/1/2 E
 SCALE: 1 INCH = 1/2 MILE

Herbert Forbes
 Designer and drawn by the 40th Station
 of the Survey of Canada and the
 aerial photographs used are the
 property of the Department of
 Transport.

LEGEND
 BOUNDARY OF SURVEY PLAT CLASS B
 BOUNDARY OF SURVEY PLAT CLASS C
 BOUNDARY OF SURVEY PLAT CLASS D
 BOUNDARY OF SURVEY PLAT CLASS E
 BOUNDARY OF SURVEY PLAT CLASS F
 BOUNDARY OF SURVEY PLAT CLASS G
 BOUNDARY OF SURVEY PLAT CLASS H
 BOUNDARY OF SURVEY PLAT CLASS I
 BOUNDARY OF SURVEY PLAT CLASS J
 BOUNDARY OF SURVEY PLAT CLASS K
 BOUNDARY OF SURVEY PLAT CLASS L
 BOUNDARY OF SURVEY PLAT CLASS M
 BOUNDARY OF SURVEY PLAT CLASS N
 BOUNDARY OF SURVEY PLAT CLASS O
 BOUNDARY OF SURVEY PLAT CLASS P
 BOUNDARY OF SURVEY PLAT CLASS Q
 BOUNDARY OF SURVEY PLAT CLASS R
 BOUNDARY OF SURVEY PLAT CLASS S
 BOUNDARY OF SURVEY PLAT CLASS T
 BOUNDARY OF SURVEY PLAT CLASS U
 BOUNDARY OF SURVEY PLAT CLASS V
 BOUNDARY OF SURVEY PLAT CLASS W
 BOUNDARY OF SURVEY PLAT CLASS X
 BOUNDARY OF SURVEY PLAT CLASS Y
 BOUNDARY OF SURVEY PLAT CLASS Z

TO SOUTH SEE MAP 92 L/1/4 W
 HERBERT FORBES
 DEPARTMENT OF LANDS, FORESTS
 AND WATER RESOURCES
 SURVEYS AND MAPPING BRANCH
 AIR DIVISION
 VICTORIA, B.C.
INTERIM MAP 92 L/1/4 W
 SCALE: 1 INCH = 1/2 MILE

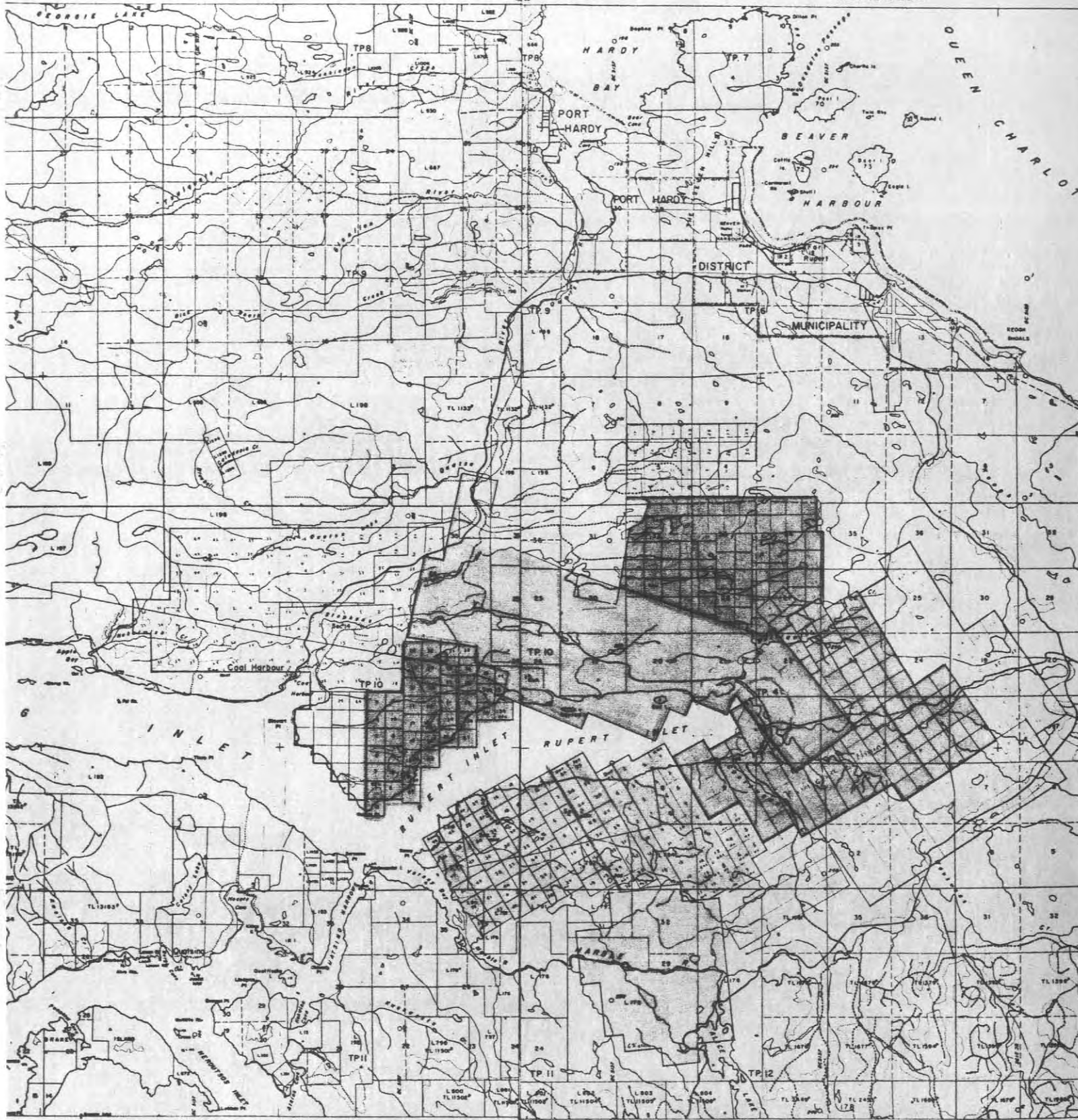

TO SOUTH SEE MAP NO L73 E
 BRITISH COLUMBIA
 DEPARTMENT OF LANDS, FORESTS
 AND WATER RESOURCES
 SURVEYS AND MAPPING BRANCH
 AIR DIVISION
 VICTORIA, B.C.
INTERIM MAP 92 L/12 E
 SCALE: 1 INCH = 1/2 MILE

Robert F. Schick
 DRAWN

*Designed and drawn by the Air Division
 5077 from official surveys and from
 aerial photographs cover 1950
 at the request of the Department of
 Lands.*

LEGEND

- 1000 FT. CONTOUR
- 2000 FT. CONTOUR
- 3000 FT. CONTOUR
- 4000 FT. CONTOUR
- 5000 FT. CONTOUR
- 6000 FT. CONTOUR
- 7000 FT. CONTOUR
- 8000 FT. CONTOUR
- 9000 FT. CONTOUR
- 10000 FT. CONTOUR
- 11000 FT. CONTOUR
- 12000 FT. CONTOUR
- 13000 FT. CONTOUR
- 14000 FT. CONTOUR
- 15000 FT. CONTOUR
- 16000 FT. CONTOUR
- 17000 FT. CONTOUR
- 18000 FT. CONTOUR
- 19000 FT. CONTOUR
- 20000 FT. CONTOUR
- 21000 FT. CONTOUR
- 22000 FT. CONTOUR
- 23000 FT. CONTOUR
- 24000 FT. CONTOUR
- 25000 FT. CONTOUR
- 26000 FT. CONTOUR
- 27000 FT. CONTOUR
- 28000 FT. CONTOUR
- 29000 FT. CONTOUR
- 30000 FT. CONTOUR
- 31000 FT. CONTOUR
- 32000 FT. CONTOUR
- 33000 FT. CONTOUR
- 34000 FT. CONTOUR
- 35000 FT. CONTOUR
- 36000 FT. CONTOUR
- 37000 FT. CONTOUR
- 38000 FT. CONTOUR
- 39000 FT. CONTOUR
- 40000 FT. CONTOUR
- 41000 FT. CONTOUR
- 42000 FT. CONTOUR
- 43000 FT. CONTOUR
- 44000 FT. CONTOUR
- 45000 FT. CONTOUR
- 46000 FT. CONTOUR
- 47000 FT. CONTOUR
- 48000 FT. CONTOUR
- 49000 FT. CONTOUR
- 50000 FT. CONTOUR
- 51000 FT. CONTOUR
- 52000 FT. CONTOUR
- 53000 FT. CONTOUR
- 54000 FT. CONTOUR
- 55000 FT. CONTOUR
- 56000 FT. CONTOUR
- 57000 FT. CONTOUR
- 58000 FT. CONTOUR
- 59000 FT. CONTOUR
- 60000 FT. CONTOUR
- 61000 FT. CONTOUR
- 62000 FT. CONTOUR
- 63000 FT. CONTOUR
- 64000 FT. CONTOUR
- 65000 FT. CONTOUR
- 66000 FT. CONTOUR
- 67000 FT. CONTOUR
- 68000 FT. CONTOUR
- 69000 FT. CONTOUR
- 70000 FT. CONTOUR
- 71000 FT. CONTOUR
- 72000 FT. CONTOUR
- 73000 FT. CONTOUR
- 74000 FT. CONTOUR
- 75000 FT. CONTOUR
- 76000 FT. CONTOUR
- 77000 FT. CONTOUR
- 78000 FT. CONTOUR
- 79000 FT. CONTOUR
- 80000 FT. CONTOUR
- 81000 FT. CONTOUR
- 82000 FT. CONTOUR
- 83000 FT. CONTOUR
- 84000 FT. CONTOUR
- 85000 FT. CONTOUR
- 86000 FT. CONTOUR
- 87000 FT. CONTOUR
- 88000 FT. CONTOUR
- 89000 FT. CONTOUR
- 90000 FT. CONTOUR
- 91000 FT. CONTOUR
- 92000 FT. CONTOUR
- 93000 FT. CONTOUR
- 94000 FT. CONTOUR
- 95000 FT. CONTOUR
- 96000 FT. CONTOUR
- 97000 FT. CONTOUR
- 98000 FT. CONTOUR
- 99000 FT. CONTOUR
- 100000 FT. CONTOUR

TO SOUTH SEE MAP NO L70 W
 BRITISH COLUMBIA
 DEPARTMENT OF LANDS, FORESTS
 AND WATER RESOURCES
 SURVEYS AND MAPPING BRANCH
 AIR DIVISION
 VICTORIA, B.C.
INTERIM MAP 92 L/12 W
 SCALE: 1 INCH = 1/2 MILE

Robert F. Schick
 DRAWN



TO SOUTH SEE MAP 92 L/2 E
 DEPARTMENT OF LANDS, FORESTS AND WATER RESOURCES
 SURVEYS AND MAPPING BRANCH
 AIR DIVISION
 VICTORIA, B.C.
INTERIM MAP 92 L/2 E
 SCALE: 1 INCH = 1/2 MILE

Robert Schmidt
 Checked and drawn by the Air Station
 Map and aerial photographs used here
 are the property of the Department of
 Lands.

LEGEND

Unimproved land
 Improved land
 Crown land
 Private land
 ... (various symbols and descriptions) ...

TO SOUTH SEE MAP 92 L/2 W
 DEPARTMENT OF LANDS, FORESTS AND WATER RESOURCES
 SURVEYS AND MAPPING BRANCH
 AIR DIVISION
 VICTORIA, B.C.
INTERIM MAP 92 L/1 W
 SCALE: 1 INCH = 1/2 MILE

Robert Schmidt

822-510 West Hastings Street
Vancouver 2, B.C.
August 23, 1966

REGISTERED

Mr. Robert Zielinski
2942 West 22nd Avenue
VANCOUVER, B.C.

Dear Sir:

This letter is notice that we will not be requiring the need of your house in Alice Arm and will also confirm severence of the Rental Agreement signed July 20th, 1966.

Very truly yours

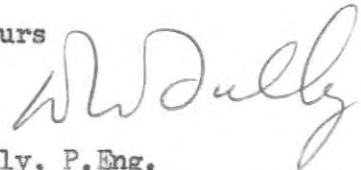

Donald W. Tully, P. Eng.
Cyprus Exploration Corporation, Ltd..

DWT/ds

POST OFFICE REGISTRATION RECEIPT			Date Stamp		
No. 21916			VANCOUVER 24 1966		
To (Name) R Zielinski					
(Post Office) Vanc					
MAXIMUM INDEMNITY PAYABLE TO: Canada and United States (Other Countries: Enquire at Post Office)			FRAGILE OR PERISHABLE ARTICLES ARE NOT REGISTERED AGAINST DAMAGE. THIS RECEIPT IS NECESSARY IF ENQUIRY IS DESIRED		
P.M.s Initials	Fee	Indemnity	P.M.s Initials	Fee	Indemnity
	.35.....	25.00		.50.....	75.00
	.45.....	50.00		.60.....	100.00

822 - 510 West Hastings Street
Vancouver 2, B.C.
August 1, 1966

Mr. I. Bill Gruenthal
Marsh & McLennan Limited
510 West Hastings Street
Standard Building
Vancouver 2, B.C.

Dear Mr. Gruenthal:

Enclosed please find a cheque for the amount of \$15.00 to cover an insurance policy on a house rented by myself at Alice Arm, B.C. from Mr. Robert Zielinski of 2942 West 22nd Avenue, Vancouver, B.C..

Yours truly

DWT/ds
Encl. (1)

Donald W. Tully, P.Eng.
Cyprus Exploration Corporation, Ltd..

822 - 510 West Hastings Street
Vancouver 2, B.C.
August 1, 1966

REGISTERED

Mr. Robert Zielinski
2942 West 22nd Avenue
VANCOUVER, B.C.

Dear Mr. Zielinski:

Enclosed herewith by registered mail are several plans of the Kinskuch Lake development which you loaned me about two weeks ago.

Very truly yours

DWT/ds

Donald W. Tully, P.Eng.
Cyprus Exploration Corporation, Ltd.

Enclosures

POST OFFICE REGISTRATION RECEIPT			Date Stamp		
No. 9989			1 VIII 1966		
To (Name) Zielinski					
(Post Office) Van					
MAXIMUM INDEMNITY PAYABLE TO: Canada and United States (Other Countries: Enquire at Post Office)			FRAGILE OR PERISHABLE ARTICLES ARE NOT REGISTERED AGAINST DAMAGE. THIS RECEIPT IS NECESSARY IF ENQUIRY IS DESIRED		
P.M.s Initials	Fee	Indemnity	P.M.s Initials	Fee	Indemnity
<i>W</i>	.35.....	25.00		.50.....	75.00
	.45.....	50.00		.60.....	100.00

50 B (3/65)

No. 5 **THE ROYAL BANK OF CANADA**
 VANCOUVER BRANCH
 685 WEST HASTINGS STREET
 VANCOUVER, B.C. 20 July 1966

PAY TO THE ORDER OF MR. ROBERT ZIELINSKI \$ 50⁰⁰/_{xx}

PAID

PERSONAL JUL 22 1966 DONALD W. TULLY
 CHECKING ACCOUNT THE ROYAL BANK OF CANADA
 VANCOUVER Donald W. Tully

⑆00010⑆003⑆ 621⑆453⑆0⑆ RENT ON HOUSE BUSINESS
 R. ZIELINSKI
 B.C. From July 25 to Aug 25/66

No. 6 **THE ROYAL BANK OF CANADA**
 VANCOUVER BRANCH
 685 WEST HASTINGS STREET
 VANCOUVER, B.C. 20 July 1966

PAY TO THE ORDER OF MR. ROBERT ZIELINSKI \$ 130⁰⁰/_{xx}

PAID

PERSONAL JUL 22 1966 DONALD W. TULLY
 CHECKING ACCOUNT THE ROYAL BANK OF CANADA
 VANCOUVER Donald W. Tully

⑆00010⑆003⑆ 621⑆453⑆0⑆ Wages for 2 weeks
 and transportation
 Plane Report

2942 West 22nd Avenue
Vancouver 8, B.C.

Mr. P. Nielson
Alice Arm
B.C.

Dear Mr. Nielson:

I have rented my house and the lot on which it is situated in Alice Arm on a monthly basis to D.W. Tully, 822-510 West Hastings Street, Vancouver, B.C. beginning July 25th, 1966.

The sole occupancy is under the direction of D.W. Tully.

Yours truly

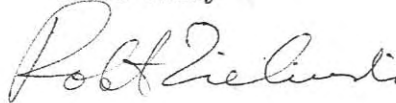

Robert Zielinski.

RZ/ds

822-510 West Hastings Street
Vancouver 2, B.C.
July 21, 1966

REGISTERED

Mr. Robert Zielinski
2942 West 22nd Avenue
Vancouver 8, B.C.

Dear Sir:

Enclosed herewith is a copy of a Lease on your house
in the village of Alice Arm, B.C. signed by you and myself to-
day.

Yours truly

DWT/ds
Encl. (1)

Donald W. Tully, P.Eng..

This Indenture,

made in duplicate the 20th day of July in the year of our

Lord one thousand nine hundred and sixty-six

In Pursuance of the "Short Form of Leases Act"

Between

ROBERT ZIELINSKI of 2942
West 22nd Avenue, in the
City of Vancouver, Province
of British Columbia

Insert full Name,
Street Address and
Occupation of each
Party.

hereinafter called the "lessor" of the FIRST PART; and

DONALD W. TULLY of 822-
510 West Hastings Street,
in the City of Vancouver,
Province of British Columbia

hereinafter called the "lessee" of the SECOND PART;

WITNESSETH, that the said lessor doth demise unto the said lessee, his executors, administrators and assigns, **ALL AND SINGULAR** that certain parcel or tract of land and premises, situate, lying and being in the Village of Alice Arm, Skeena Mining Division,

of in the Province of British Columbia, more particularly known and described as follows:-

House and adjoining building on
lot situated in the Village of
Alice Arm, Skeena Mining Division,
said to be owned and insured by
Robert Zielinski

From the 25th day of July
one thousand nine hundred and sixty-six for the term of a monthly basis
thence ensuing.

YIELDING therefor during the said term the rent of Fifty

dollars (\$ 50.00)

of lawful money of Canada payable on the following days and times, that is to say:

Rent of \$50.00 per month payable on the 25th of each month commencing July 25th, 1966 and renewable on a monthly basis at the option of the second party.

THAT the said lessee covenants with the said lessor to pay rent; **AND** to pay rates for water, electricity, gas and telephone.

AND to repair,

AND to keep up fences; **AND** not to cut down timber;

AND the said lessor may enter and view state of repair, **AND** that the said lessee will repair according to notice.

THAT the said lessee will not use premises as a shop.

AND will not assign without leave. **And** will not sub-let without leave.

AND that he will leave premises in good repair.

AND that he will not carry on any business that shall be deemed a nuisance on the premises.

PROVISO for re-entry by the said lessor on non-payment of rent, or non-performance of covenants.

PROVISO for re-entry on seizure or forfeiture of the said term.

THE said lessor covenants with the said lessee for quiet enjoyment.

PROVIDED ALWAYS and it is hereby agreed by and between the parties hereto that if the term hereby granted shall be at any time seized or taken in execution or in attachment by any creditor of the lessee or if the lessee shall make any assignment for the benefit of creditors, or becoming bankrupt or insolvent shall take the benefit of any Act that may be in force for bankrupt or insolvent debtors, the then current rent shall immediately become due and payable and the said term shall immediately become forfeited and void.

AND it is hereby declared and agreed that in case the premises hereby demised or any part thereof shall at any time during the term granted be burned down, or damaged by fire, or tempest, so as to render the same unfit for the purpose of the lessee then and so often as the same shall happen the rent hereby reserved, or a proportionate part thereof, according to the nature and extent of the injury sustained and all remedies for recovering the same shall be suspended and abated until the said premises shall at the option of the lessor have been rebuilt or made fit for the purpose of the lessee.

PROVIDED ALWAYS and it is hereby agreed by and between the parties hereto that if the said lessee shall hold over after the expiration of the term hereby granted and the lessor shall accept rent, the new tenancy thereby created shall be a tenancy from month to month and not a tenancy from year to year, and shall be subject to the covenants and conditions herein contained so far as the same are applicable to a tenancy from month to month.

Wherever the singular or the masculine are used in this document, the same shall be deemed to include the plural or the feminine, or the body politic or corporate; also the heirs, executors, administrators, successors and assigns of the respective parties hereto, where the context or the parties so require.

IN WITNESS WHEREOF, the said parties hereto have hereunto set their Hands and Seals.

SIGNED, SEALED AND DELIVERED

By the Lessor

In the presence of

Signature of Witness *Donna Smalley*
Street Address *822-510 West Hastings*
City or Town *Vancouver, B.C.*
Occupation of Witness *Secretary*

Robert Zielinski
ROBERT ZIELINSKI

SIGNED, SEALED AND DELIVERED

By the Lessee

In the presence of

Signature of Witness *Donna Smalley*
Street Address *822-510 West Hastings*
City or Town *Vancouver, B.C.*
Occupation of Witness *Secretary*

Donald W. Tully
DONALD W. TULLY

ACKNOWLEDGMENT OF OFFICER OF A CORPORATION

I HEREBY CERTIFY that, on the _____ day of _____, 19____, at _____, in the Province of British Columbia, (Whose identity has been proved by the evidence on _____), who is personally known to me, of _____ oath of _____ appeared before me and acknowledged to me that he is the _____ of _____, and that he is the person _____ of the said _____ and affixed the seal of the _____ to the said Instrument, who subscribed his name to the annexed instrument as _____ that he was first duly authorized to subscribe his name as aforesaid, and affix the said seal to the said Instrument, and that such corporation is legally entitled to hold and dispose of land in the Province of British Columbia.

IN TESTIMONY whereof I have hereunto set my Hand and Seal of Office, at _____ in the Province of British Columbia, this _____ day of _____ in the year of our Lord one thousand nine hundred and _____

A Notary Public in and for the Province of British Columbia
A Commissioner for taking affidavits for British Columbia

NOTE—Where the person making the acknowledgment is personally known to the Officer taking the same, strike out the words in brackets.

Date _____ 19____

—TO—

House Lease
(STATUTORY FORM)

Form No. 176 House Lease.
WILSON STATIONERY COMPANY LIMITED • CLARK & STUART CO. LTD

FOR WITNESS

Province of British Columbia
To Wit:

I, _____ of the _____ of _____, in the Province of British Columbia, make oath and say:

1. I was personally present and did see the within instrument duly signed and executed by _____ the part _____ thereto, for the purposes named therein.
2. The said instrument was executed at _____
3. I know the said part _____, and that _____ of the full age of twenty-one years.
4. I am the subscribing witness to the said instrument and am of the full age of sixteen years.

Sworn before me at _____ }
In the Province of British Columbia, this _____ }
day of _____, 19____ }

A Notary Public in and for the Province of British Columbia
A Commissioner for taking affidavits for British Columbia

ACKNOWLEDGMENT OF MAKER

I HEREBY CERTIFY that, on the _____ day of _____, 19____, at _____, in the _____ of _____, (whose identity has been proved by the evidence on _____), who is personally known to me, appeared before me and acknowledged to me that _____ the person _____ mentioned in the annexed instrument as the maker thereof, and whose name _____ subscribed thereto as part _____, that _____ know the contents thereof, and that _____ executed the same voluntarily, and _____ of the full age of twenty-one years.

IN TESTIMONY whereof I have hereunto set my Hand and Seal of Office, at _____ in the Province of British Columbia, this _____ day of _____ in the year of our Lord one thousand nine hundred and _____

A Notary Public in and for the Province of British Columbia
A Commissioner for taking affidavits for British Columbia

NOTE—Where the person making the acknowledgment is personally known to the Officer taking the same, strike out the words in brackets.

Babine Lake Area Attracts Interest

Copper exploration interest is growing in the Babine Lake area of northern B.C. where several promising discoveries have been reported.

Largely responsible for the northward rush is Granby Mining's Granisle Copper, a \$12 million operation, scheduled to go into production later this year. Granisle has reserves of 22.7 million tons grading .53 per cent copper.

STAKING RUSH

A prospector just back from the area said, "The country is getting very excited, there is a lot of staking up there."

Major strikes, but not confirmed, are reported to have been made by Noranda Mines and Falconbridge. Several small companies have moved into the Babine, about 400 miles north of Vancouver, and staked claims.

The price of claims have jumped phenomenally in the last year.

PROGRAM SWITCH

Noranda has been drilling in the area for two years and is said to have switched its program from one of exploration to development. Recent discoveries by Noranda have caused the big mining company to upgrade possible production plans.

Falconbridge is said to have

four drills working to the north of Noranda which, in turn, is north of Granisle. Work on the Falconbridge claims is said to be encouraging.

Assays on some of the properties are reported to be averaging from .85 per cent to 1.5 per cent copper.

Also said to be busy in the new area are Kerr-Addison, Conwest, Torwest, Buttle-Trojan, Bethex, Giant Exploration, Silver Bute and Norfal.

DELTA ACCEPTANCE APPOINTMENT



WESTERN OILS

OVER THE COUNTER

By C. M. Oliver and Company Ltd.
INDUSTRIALS

TODAY'S CLOSE

Stock	Sales	High	Low	Close	Net Ch'ge
All Rox	2000	19½	19	19½	- ½
Alminex	100	425	425	425	- 5
A Led	46800	23½	22	22	-1½
Anchor	1000	10½	10½	10½	- 1
Asamera	900	390	385	385	-10
Banff	500	\$15½	15½	15½	
Calvert	2000	36½	36	36½	+ ½
CS Pete	1100	252	252	252	
C Ex Gas	6200	315	300	315	- 5
C Gridoil	100	415	415	415	- 5
C Homestd	1200	220	212	212	
Cdn Sup O	2250	\$18%	18%	18%	- ¼
Cdn Tricnt	500	400	400	400	+400
Cent Del	375	\$11½	11	11	- ¼
Charter O	200	390	390	390	+10
Chieftan D	100	630	630	630	+ 5
C West P	500	144	144	144	
Dome Pete	200	\$15½	15	15	- ½
Dynam	14425	395	385	390	- 5
Fargo	500	350	340	340	- 5
French Pt	1050	420	405	410	- 5
Gr Plains	100	\$11%	11½	11½	+ ¾
Gt C Oilsds	160	\$11½	11½	11½	
Int Hell	14200	258	250	250	- 1
Mill City	5600	210	200	209	+11
N Cont	2200	31	31	31	
N Davies	1500	18	18	18	+ 1
N Americn	1500	34	33	33	- 1
NC Oils	1000	340	340	340	
Numac	1900	154	151	152	- 3
Numac wt	2500	39	36	39	+ 2
Okalta	1020	18	18	18	
Permo	2000	26	24½	24½	-1½
Petrol	2600	61	61	61	- 1
Place G	13100	249	243	248	+ 3
Ponder	1500	43	40½	43	+ 3
Prairie il	8600	435	450	450	
Provo Gas	4800	240	236	240	+ 4
Ranger	5850	215	210	214	+ 4
Ranger R	18950	3½	2½	2½	- ½
Scurry Rn	6175	\$30¼	29½	30¼	+2¼
Spoon	29375	86	83	84	- 1
Triad Oil	3020	215	213	215	+ 1
U Canso	1200	265	260	261	+ 1
Un Reef P	2000	24	24	24	-1½
W Decalta	850	320	315	320	+ 5
W Decit w	100	160	160	160	- 1

Total Sales: 2,500,000.

INVESTMENT FUNDS

	Bid	Ask
All Cdn Com	7.35	8.06
All Cdn Div	9.42	10.32
Amer Growth	5.66	6.19
Adanac	2.79	3.05
Andreae Eq	3.27	3.57
Assoc Inv	5.66	5.71
Beaubran	39.16	42.53
Canafund	51.34	53.91
Cda Growth	5.92	6.51
Cda Secur	4.91	5.40
Cdn Growth Pt	9.83	9.83
Cdn Energy	9.75	10.68
Cdn Inv Fund	3.97	4.36
Cdn Scudder	15.04	
Cdn Security	6.07	6.65
Cdn Trusteed	4.76	5.20
Cardinal Comp	4.90	4.90
Cardinal Div	4.60	4.60
Champion	7.14	7.76
Collect Fund	6.07	6.60
Collectif A	7.03	7.64
Collectif B	5.30	5.47

	Bid	Ask
Atkins	.08	.16
Seaboard Life	..	13.00
Seaboard Wts	..	6.00

MINES AND OILS

Aspen Grove	.65	.70
Alamos	..	.06
Bell Tahsis	.28	.30
Big I	.65	.68
Big Lake	.21	.32
Bonanza	..	.90
Calix	1.50	1.55
Canzac	.27	.29
Coronet	.45	.55
Coast Silver	.65	.68
Cleveland	.25	.30
Columbia R	2.20	2.25
Comet	..	.55
Cumont	.60	.70
Cultus	.80	.85
Forest K	.33	.35
Frontier	.30	.35
Gibraltar	1.05	1.10
George Copper	.25	..
Glen Copper	..	1.40
Golden Gate	..	.80
Guichon	.15	.17
Kootenay Base	.06	..
Kel-Glen	..	.50
Int Copper	.32	..
Makaoo	.03	.04
Marshall	..	.62
Minex	.17	.18
Native Mines	.60	.70
New Hamil	.02	.03
Noland	.20	.23
New Wall	.35	.41
Oro	.70	.75
North Pac	1.15	1.20
Pine Lake	..	.32
Plateau	.57	.60
Quilchena	.37	.40
Reco Silver	.15	.16
Red Rock	.14	.15
Salmo	.07	.08
Rainbow	.33	.35
Silvan	.09	.10
South Pac	..	.65
South Seas	1.27	1.30
Stellako	.45	.50
Stikine	.19	.25
Slave Pt	.28	.30
Sunloch	.30	..
Taiga	.06	.10
Taylor Wind	.02	.03
TC Expl	.45	.48
Trans West	.12½	.20
Vastlode	.60	.65
Vimy	.06½	.08
Wingdam	.09	.11
Yreka	..	.75

CALGARY LIVESTOCK

CALGARY (CP)—On offer to 11 a.m.: 600 cattle and calves. Trade was fully active the bulk of slaughter cattle being cows or medium to canner quality. Today's receipts were about fully divided between slaughter cattle and replacements. Slaughter steers and heifers were closing steady. Good cows were about \$1 or more lower for the week. Other grades were about 50 cents lower. Bulls were

31721
31722
31723
31724
31725
31726
31727
31728
31729
31730

C 31343

RESER.
0224287
LAND LOT
L-3753
See Registry Office
C.G.

OLD FORT
MTN.

RESER
0224287

31323	31322	31309	31304	31275	31274
31331	31320	31307	31302	31273	31272
31329	31328	31304	31302	31271	31270
31327	31326	31302	31300	31269	31268
31325	31324	31301	31299	31267	31266
31323	31322	31299	31297	31265	31264
31321	31320	31297	31295	31263	31262
31319	31318	31295	31293	31261	31260
31317	31316	31293	31291	31259	31258
31315	31314	31291	31289	31257	31256
31313	31312	31289	31287	31255	31254
31311	31310	31287	31285	31253	31252
31309	31308	31285	31283	31251	31250
31307	31306	31283	31281	31249	31248
31305	31304	31281	31279	31247	31246
31303	31302	31279	31277	31245	31244
31301	31300	31277	31275	31243	31242
31299	31298	31275	31273	31241	31240
31297	31296	31273	31271	31239	31238
31295	31294	31271	31269	31237	31236
31293	31292	31269	31267	31235	31234
31291	31290	31267	31265	31233	31232
31289	31288	31265	31263	31231	31230
31287	31286	31263	31261	31229	31228
31285	31284	31261	31259	31227	31226
31283	31282	31259	31257	31225	31224
31281	31280	31257	31255	31223	31222
31279	31278	31255	31253	31221	31220
31277	31276	31253	31251	31219	31218
31275	31274	31251	31249	31217	31216
31273	31272	31249	31247	31215	31214
31271	31270	31247	31245	31213	31212
31269	31268	31245	31243	31211	31210
31267	31266	31243	31241	31209	31208
31265	31264	31241	31239	31207	31206
31263	31262	31239	31237	31205	31204
31261	31260	31237	31235	31203	31202
31259	31258	31235	31233	31201	31200
31257	31256	31233	31231	31199	31198
31255	31254	31231	31229	31197	31196
31253	31252	31229	31227	31195	31194
31251	31250	31227	31225	31193	31192
31249	31248	31225	31223	31191	31190
31247	31246	31223	31221	31189	31188
31245	31244	31221	31219	31187	31186
31243	31242	31219	31217	31185	31184
31241	31240	31217	31215	31183	31182
31239	31238	31215	31213	31181	31180
31237	31236	31213	31211	31179	31178
31235	31234	31211	31209	31177	31176
31233	31232	31209	31207	31175	31174
31231	31230	31207	31205	31173	31172
31229	31228	31205	31203	31171	31170
31227	31226	31203	31201	31169	31168
31225	31224	31201	31199	31167	31166
31223	31222	31199	31197	31165	31164
31221	31220	31197	31195	31163	31162
31219	31218	31195	31193	31161	31160
31217	31216	31193	31191	31159	31158
31215	31214	31191	31189	31157	31156
31213	31212	31189	31187	31155	31154
31211	31210	31187	31185	31153	31152
31209	31208	31185	31183	31151	31150
31207	31206	31183	31181	31149	31148
31205	31204	31181	31179	31147	31146
31203	31202	31179	31177	31145	31144
31201	31200	31177	31175	31143	31142
31199	31198	31175	31173	31141	31140
31197	31196	31173	31171	31139	31138
31195	31194	31171	31169	31137	31136
31193	31192	31169	31167	31135	31134
31191	31190	31167	31165	31133	31132
31189	31188	31165	31163	31131	31130
31187	31186	31163	31161	31129	31128
31185	31184	31161	31159	31127	31126
31183	31182	31159	31157	31125	31124
31181	31180	31157	31155	31123	31122
31179	31178	31155	31153	31121	31120
31177	31176	31153	31151	31119	31118
31175	31174	31151	31149	31117	31116
31173	31172	31149	31147	31115	31114
31171	31170	31147	31145	31113	31112
31169	31168	31145	31143	31111	31110
31167	31166	31143	31141	31109	31108
31165	31164	31141	31139	31107	31106
31163	31162	31139	31137	31105	31104
31161	31160	31137	31135	31103	31102
31159	31158	31135	31133	31101	31100
31157	31156	31133	31131	31099	31098
31155	31154	31131	31129	31097	31096
31153	31152	31129	31127	31095	31094
31151	31150	31127	31125	31093	31092
31149	31148	31125	31123	31091	31090
31147	31146	31123	31121	31089	31088
31145	31144	31121	31119	31087	31086
31143	31142	31119	31117	31085	31084
31141	31140	31117	31115	31083	31082
31139	31138	31115	31113	31081	31080
31137	31136	31113	31111	31079	31078
31135	31134	31111	31109	31077	31076
31133	31132	31109	31107	31075	31074
31131	31130	31107	31105	31073	31072
31129	31128	31105	31103	31071	31070
31127	31126	31103	31101	31069	31068
31125	31124	31101	31099	31067	31066
31123	31122	31099	31097	31065	31064
31121	31120	31097	31095	31063	31062
31119	31118	31095	31093	31061	31060
31117	31116	31093	31091	31059	31058
31115	31114	31091	31089	31057	31056
31113	31112	31089	31087	31055	31054
31111	31110	31087	31085	31053	31052
31109	31108	31085	31083	31051	31050
31107	31106	31083	31081	31049	31048
31105	31104	31081	31079	31047	31046
31103	31102	31079	31077	31045	31044
31101	31100	31077	31075	31043	31042
31099	31098	31075	31073	31041	31040
31097	31096	31073	31071	31039	31038
31095	31094	31071	31069	31037	31036
31093	31092	31069	31067	31035	31034
31091	31090	31067	31065	31033	31032
31089	31088	31065	31063	31031	31030
31087	31086	31063	31061	31029	31028
31085	31084	31061	31059	31027	31026
31083	31082	31059	31057	31025	31024
31081	31080	31057	31055	31023	31022
31079	31078	31055	31053	31021	31020
31077	31076	31053	31051	31019	31018
31075	31074	31051	31049	31017	31016
31073	31072	31049	31047	31015	31014
31071	31070	31047	31045	31013	31012
31069	31068	31045	31043	31011	31010
31067	31066	31043	31041	31009	31008
31065	31064	31041	31039	31007	31006
31063	31062	31039	31037	31005	31004
31061	31060	31037	31035	31003	31002
31059	31058	31035	31033	31001	31000

A BABINE

OLD FORT

Reserve.
0224287

Newman Id.

25580
25581
25582
25583
25584
25585
25586
25587
25588
25589
25590
25591
25592
25593
25594
25595
25596
25597
25598
25599
25600
25601
25602
25603
25604
25605
25606
25607
25608
25609
25610
25611
25612
25613
25614
25615
25616
25617
25618
25619
25620
25621
25622
25623
25624
25625
25626
25627
25628
25629
25630
25631
25632
25633
25634
25635
25636
25637
25638
25639
25640
25641
25642
25643
25644
25645
25646
25647
25648
25649
25650
25651
25652
25653
25654
25655
25656
25657
25658
25659
25660
25661
25662
25663
25664
25665
25666
25667
25668
25669
25670
25671
25672
25673
25674
25675
25676
25677
25678
25679
25680
25681
25682
25683
25684
25685
25686
25687
25688
25689
25690
25691
25692
25693
25694
25695
25696
25697
25698
25699
25700

NEWMAN PEN
FAGAN

Walt Schwartz

SKENNA
OMENICA