

1:5000

SULPHURETS LAKE

W.A. 59 m


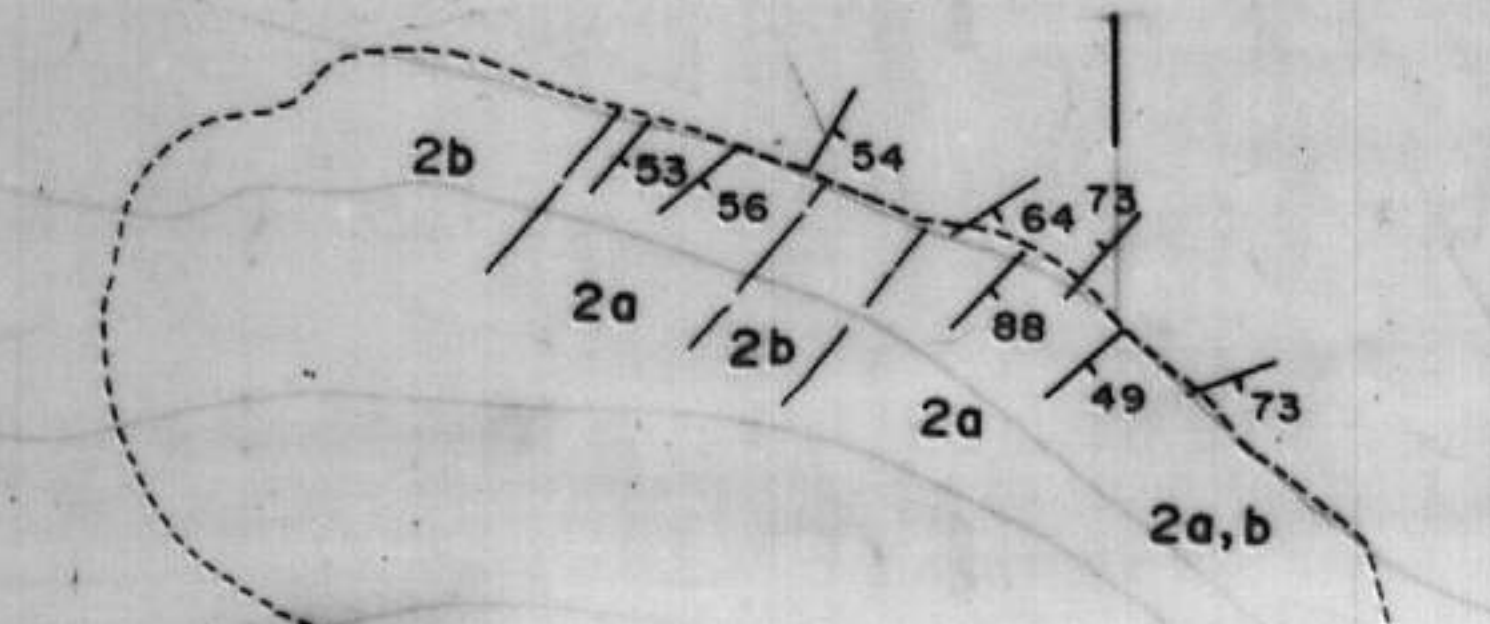
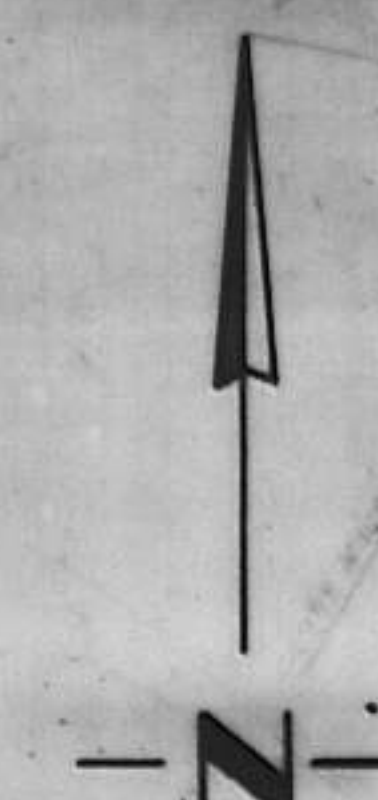

GEOLOGICAL LEGEND

- 1a. Basaltic tuff, red rocks of units 3 and 4, up uncertain with respect to rocks of Unit 2
- 2. Upper Volcanic-Carbonaceous Unit
- 2a. Upper basaltic flow breccia, tuff, minor basaltic layers
- 2b. Basaltic, argillaceous tuff
- 2c. Basaltic tuff
- 2d. Carbonaceous sediments
- 3. Basaltic, andesitic tuff, minor basaltic flows
- 3a. Basaltic, andesitic, thin bedded
- 3b. Basaltic, andesitic, thick bedded
- 3c. Basaltic, andesitic, thin bedded
- 3d. Basaltic, andesitic, thick bedded
- 3e. Basaltic, andesitic, thin bedded
- 3f. Basaltic, andesitic, thick bedded
- 3g. Basaltic, andesitic, thin bedded
- 3h. Basaltic, andesitic, thick bedded
- 3i. Basaltic, andesitic, thin bedded
- 3j. Basaltic, andesitic, thick bedded
- 3k. Basaltic, andesitic, thin bedded
- 3l. Basaltic, andesitic, thick bedded
- 3m. Basaltic, andesitic, thin bedded
- 3n. Basaltic, andesitic, thick bedded
- 3o. Basaltic, andesitic, thin bedded
- 3p. Basaltic, andesitic, thick bedded
- 3q. Basaltic, andesitic, thin bedded
- 3r. Basaltic, andesitic, thick bedded
- 3s. Basaltic, andesitic, thin bedded
- 3t. Basaltic, andesitic, thick bedded
- 3u. Basaltic, andesitic, thin bedded
- 3v. Basaltic, andesitic, thick bedded
- 3w. Basaltic, andesitic, thin bedded
- 3x. Basaltic, andesitic, thick bedded
- 3y. Basaltic, andesitic, thin bedded
- 3z. Basaltic, andesitic, thick bedded

- 4. Carbonaceous Sedimentary Rocks
- 4a. Argillite, silty, minor sandstone, thin bedded
- 4b. Argillite, silty, minor sandstone, thick bedded
- 4c. Argillite, silty, minor sandstone, thin bedded
- 4d. Argillite, silty, minor sandstone, thick bedded
- 4e. Argillite, silty, minor sandstone, thin bedded
- 4f. Argillite, silty, minor sandstone, thick bedded
- 4g. Argillite, silty, minor sandstone, thin bedded
- 4h. Argillite, silty, minor sandstone, thick bedded
- 4i. Argillite, silty, minor sandstone, thin bedded
- 4j. Argillite, silty, minor sandstone, thick bedded
- 4k. Argillite, silty, minor sandstone, thin bedded
- 4l. Argillite, silty, minor sandstone, thick bedded
- 4m. Argillite, silty, minor sandstone, thin bedded
- 4n. Argillite, silty, minor sandstone, thick bedded
- 4o. Argillite, silty, minor sandstone, thin bedded
- 4p. Argillite, silty, minor sandstone, thick bedded
- 4q. Argillite, silty, minor sandstone, thin bedded
- 4r. Argillite, silty, minor sandstone, thick bedded
- 4s. Argillite, silty, minor sandstone, thin bedded
- 4t. Argillite, silty, minor sandstone, thick bedded
- 4u. Argillite, silty, minor sandstone, thin bedded
- 4v. Argillite, silty, minor sandstone, thick bedded
- 4w. Argillite, silty, minor sandstone, thin bedded
- 4x. Argillite, silty, minor sandstone, thick bedded
- 4y. Argillite, silty, minor sandstone, thin bedded
- 4z. Argillite, silty, minor sandstone, thick bedded

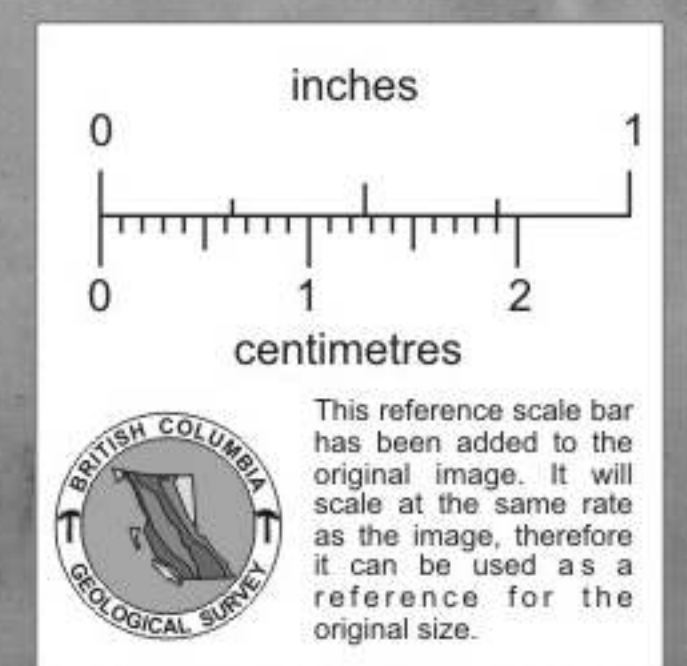

- SYMBOLS**
- Outcrop
 - Outcrop-noted, but not mapped
 - Geological Contact, definite/approximate
 - SS Strike and Dip of S
 - SS Flow Partitioning Dike with Dip
 - SS Strike and Dip of S
 - Location with Plunge
 - Fault, major
 - Fault, minor
 - Ferricrete
 - Diamond Drill Hole
 - Grid Station

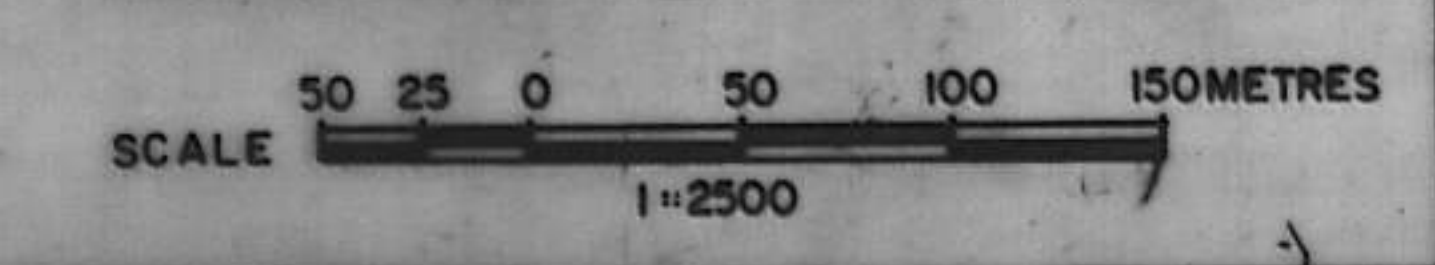

SULPHURETS GOLD CORPORATION

1989

TEDRAY 13 PROPERTY
COMPILATION MAP
PROPERTY GEOLOGY

John Payne Date: Oct, 1989
 H. Payne, J.P. NT S. 10-9-B / 81 Frank Mackay Grid Cell
 Report No. 1066 Figure No. 4

804207