

802691

SUMMARY REPORT ON THE  
TANTALUS RESOURCES LTD.  
TREATY CREEK PROJECT

ISKUT AREA  
SKEENA MINING DIVISION  
BRITISH COLUMBIA

J. Chapman, F.G.A.C.  
W. Raven, F.G.A.C.  
A. Walus, M.Sc.

January 31, 1991

OREQUEST



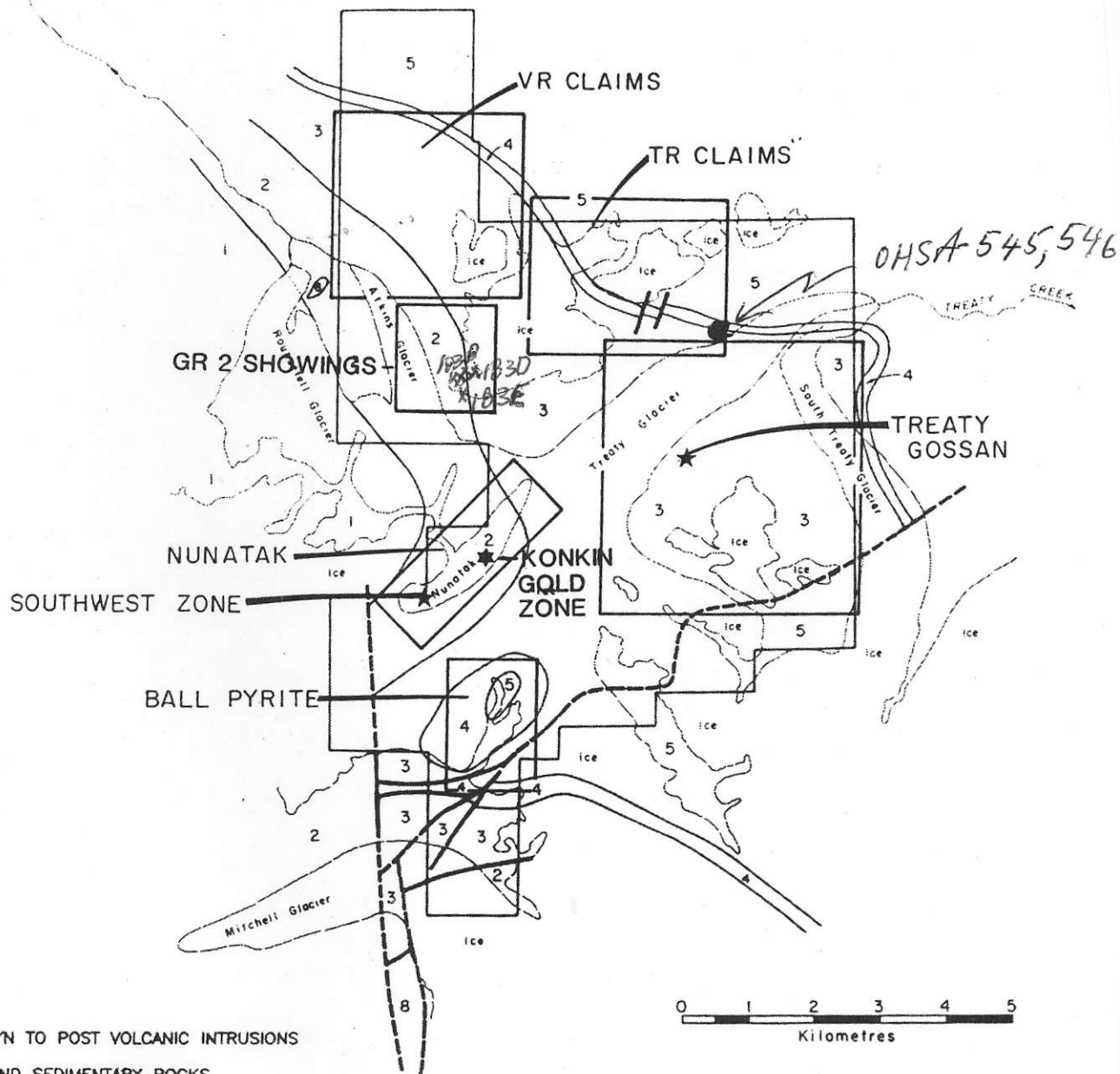

**LEGEND:**

**JURASSIC**

8 SYN TO POST VOLCANIC INTRUSIONS

**VOLCANIC AND SEDIMENTARY ROCKS  
TRIASSIC TO JURASSIC**

**MIDDLE JURASSIC: SPATSIZI GROUP**

5 SILTSTONE SEQUENCE  
Salmon River Formation - sandstone, siltstone

**LOWER JURASSIC: HAZELTON GROUP**

4 FELSIC VOLCANIC SEQUENCE  
Mount Dilworth Formation - rhyolite to dacitic volcanics

3 PYROCLASTIC - EPICLASTIC SEQUENCE  
Betty Creek Formation - pyroclastic volcanics and sediments

2 ANDESITE SEQUENCE  
Upper Unuk River Formation - andesite sequence

1 LOWER SEDIMENTARY SEQUENCE  
(Lower Unuk River Formation) - clastic sediments

**SYMBOLS**

— GEOLOGIC CONTACT - approximate

- - - FAULT (defined, inferred)



**OREQUEST**

**TANTALUS RESOURCES LTD.**

**Figure 5**

**TREATY CREEK PROJECT  
PROPERTY GEOLOGY  
AND INDEX MAP**

British Columbia  
NTS: 104 B/9E

December 1990

Drafting: RWR

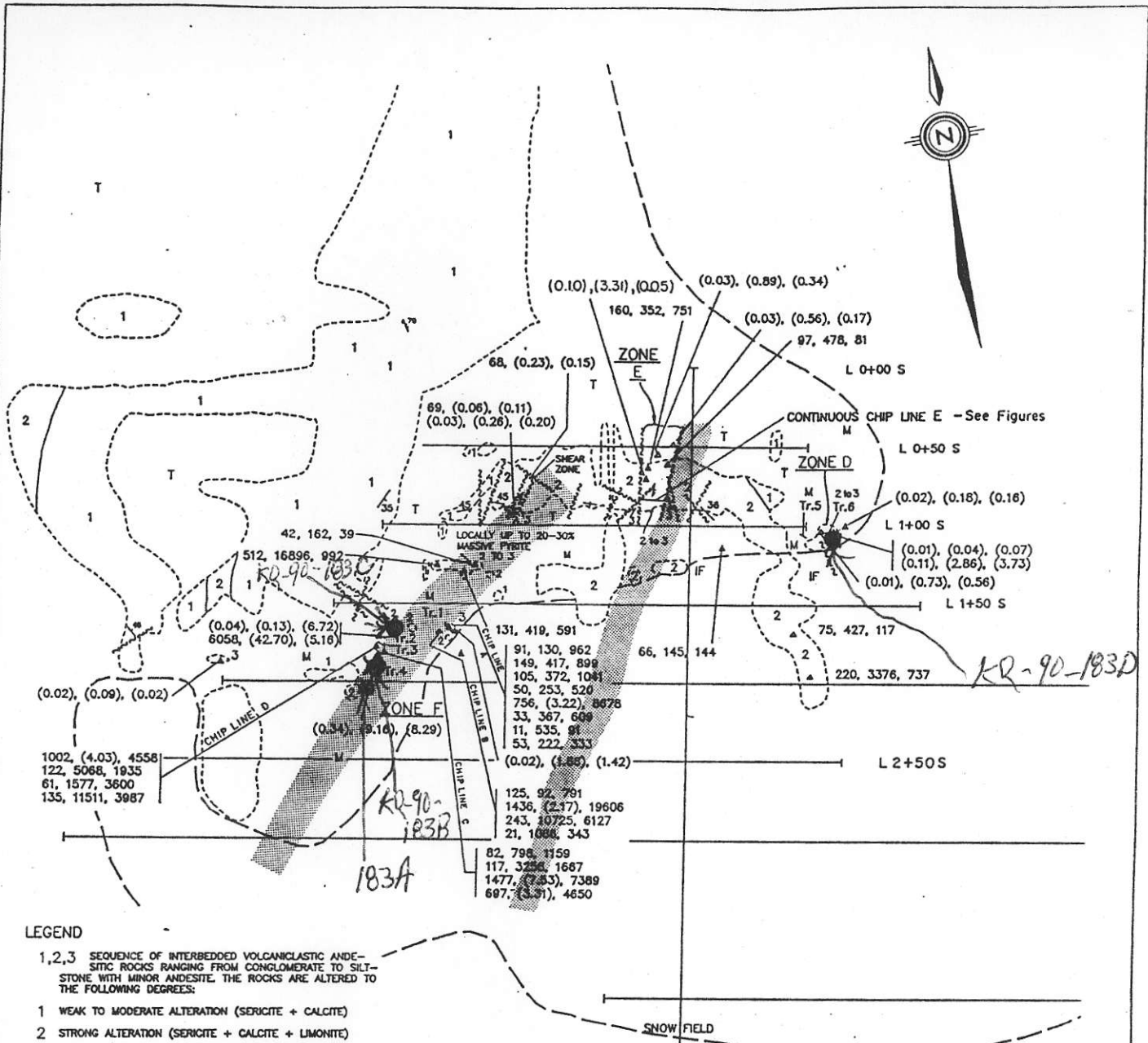

**LEGEND**

- 1,2,3 SEQUENCE OF INTERBEDDED VOLCANICLASTIC AND-  
SITIC ROCKS RANGING FROM CONGLOMERATE TO SILT-  
STONE WITH MINOR ANDESITE. THE ROCKS ARE ALTERED TO  
THE FOLLOWING DEGREES:
- 1 WEAK TO MODERATE ALTERATION (SERICITE + CALCITE)
- 2 STRONG ALTERATION (SERICITE + CALCITE + LIMONITE)
- 3 COMPLETE ALTERATION (SERICITE + QUARTZ + PYRITE  
± CLAYS), ALSO MINOR LIMONITE AND MANGANESE,  
LOCALLY GALENA, SPHALERITE, STIBNITE, CHALCOPYRITE
- ∕∕<sub>90</sub> BEDDING (VERTICAL, INCLINED)
- ∕∕<sub>30</sub> FOLIATION/SCHISTOSITY (VERTICAL, INCLINED)
- ∕∕<sub>45</sub> VEIN (VERTICAL, INCLINED)
- FAULT/SHEAR
- OUTCROP
- X SMALL OUTCROP
- M MORaine
- T TALUS
- GEOLOGICAL CONTACT
- ▨ UTEM CONDUCTOR
- TR-7 TRENCH NUMBER
- ↖ TRENCH LOCATION
- ▲ ROCK SAMPLE
- △ FLOAT SAMPLE

(0.15), (0.01), (0.01)  
Cu,Pb,Zn VALUES  
BRACKETED VALUES ARE REPORTED IN %  
UNBRACKETED VALUES ARE REPORTED IN ppm

**ABBREVIATIONS**

- CPY CHALCOPYRITE
- GA GALENA
- PY PYRITE
- lim LIMONITE
- SPH SPHALERITE
- STIB STIBNITE
- QTZ QUARTZ

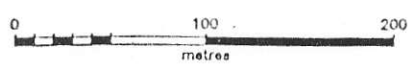

**OREQUEST**

TANTALUS RESOURCES LTD.

Figure 7a  
TREATY CREEK PROJECT  
Skeena Mining Division  
GR-2 SHOWINGS  
COMPILATION MAP  
COPPER, LEAD & ZINC RESULTS  
British Columbia  
NTS: 104 B/9E

JANUARY 1991

Drafting RWR

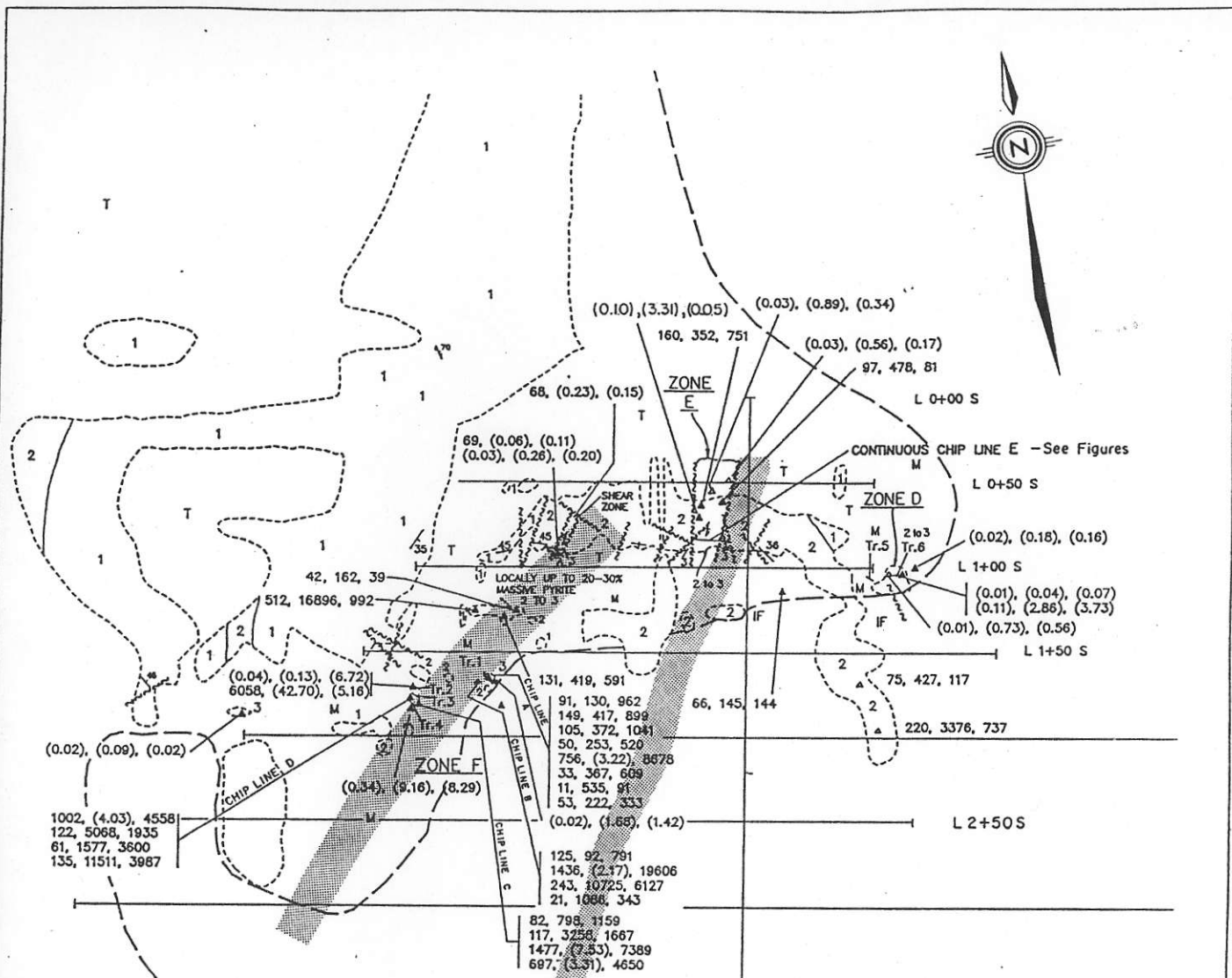

**LEGEND**

- 1,2,3 SEQUENCE OF INTERBEDDED VOLCANICLASTIC ANDESITIC ROCKS RANGING FROM CONGLOMERATE TO SILTSTONE WITH MINOR ANDESITE. THE ROCKS ARE ALTERED TO THE FOLLOWING DEGREES:
  - 1 WEAK TO MODERATE ALTERATION (SERICITE + CALCITE)
  - 2 STRONG ALTERATION (SERICITE + CALCITE + LIMONITE)
  - 3 COMPLETE ALTERATION (SERICITE + QUARTZ + PYRITE ± CLAYS). ALSO MINOR LIMONITE AND MANGANESE. LOCALLY GALENA, SPHALERITE, STIBNITE, CHALCOPYRITE
- $\frac{1}{\infty}$  BEDDING (VERTICAL, INCLINED)
- $\frac{100}{\infty}$  FOLIATION/SCHISTOSITY (VERTICAL, INCLINED)
- $\frac{100}{\infty}$  VEIN (VERTICAL, INCLINED)
- FAULT/SHEAR
- OUTCROP
- x SMALL OUTCROP
- M MORaine
- T TALUS
- GEOLOGICAL CONTACT
- ▨ UTEM CONDUCTOR
- TR-7 TRENCH NUMBER
- ↖ TRENCH LOCATION
- ▲ ROCK SAMPLE
- △ FLOAT SAMPLE

(0.15), (0.01), (0.01)  
 Cu,Pb,Zn VALUES  
 BRACKETED VALUES ARE REPORTED IN %  
 UNBRACKETED VALUES ARE REPORTED IN ppm

**ABBREVIATIONS**

- CPY CHALCOPYRITE
- GA GALENA
- PY PYRITE
- lim LIMONITE
- SPH SPHALERITE
- STB STIBNITE
- QTZ QUARTZ

**OREQUEST**

TANTALUS RESOURCES LTD.

Figure 7a  
 TREATY CREEK PROJECT  
 Skeena Mining Division  
 GR-2 SHOWINGS  
 COMPILATION MAP  
 COPPER, LEAD & ZINC RESULTS  
 British Columbia  
 NTS: 104 B/9E

JANUARY 1991

Drafting RWR

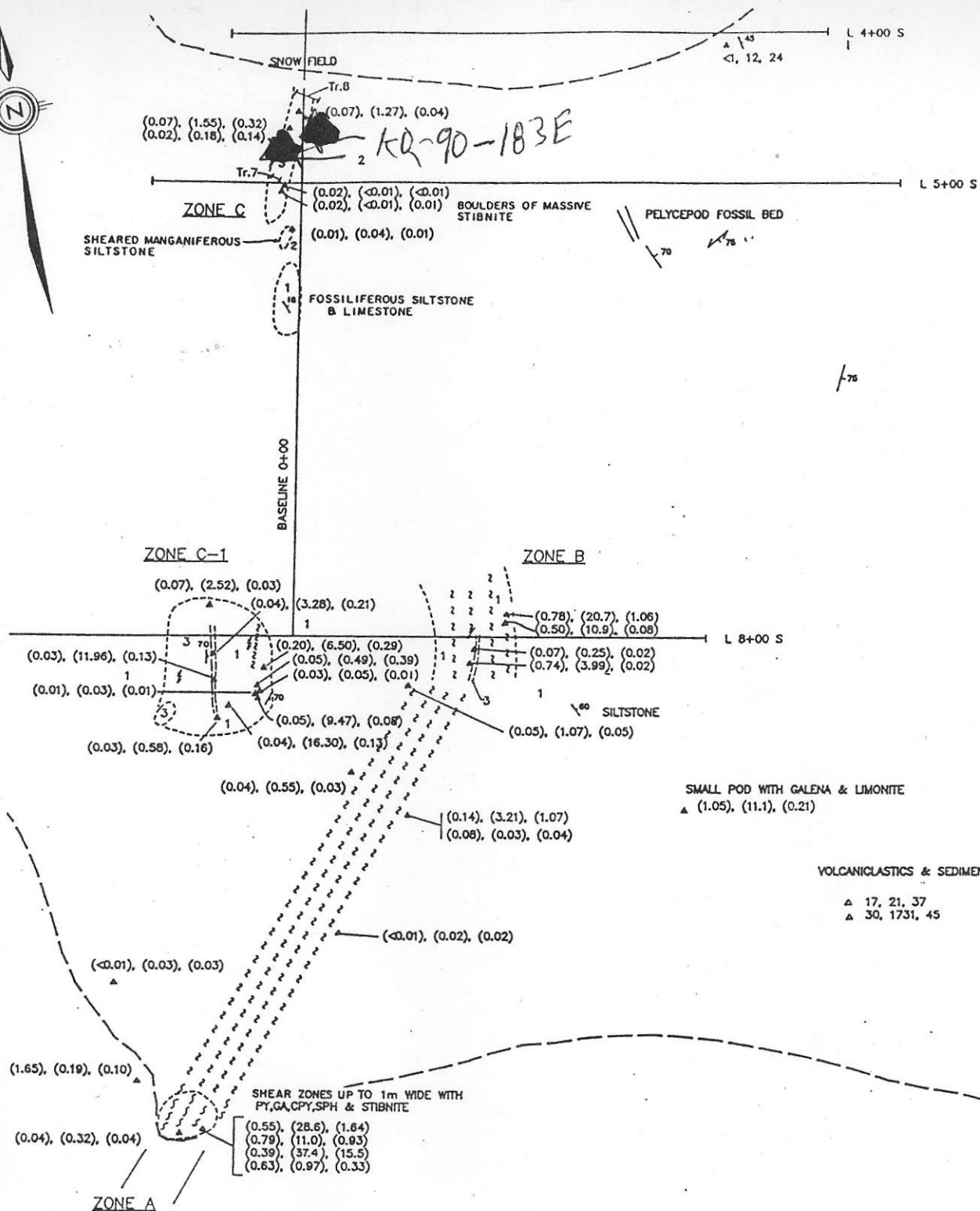

END

2,3 SEQUENCE OF INTERBEDDED VOLCANICLASTIC ANDI-SITIC ROCKS RANGING FROM CONGLOMERATE TO SILTSTONE WITH MINOR ANDESITE. THE ROCKS ARE ALTERED TO THE FOLLOWING DEGREES:

WEAK TO MODERATE ALTERATION (SERICITE + CALCITE)  
 STRONG ALTERATION (SERICITE + CALCITE + LIMONITE)  
 COMPLETE ALTERATION (SERICITE + QUARTZ + PYRITE ± CLAYS), ALSO MINOR LIMONITE AND MANGANESE, LOCALLY GALENA, SPHALERITE, STIBNITE, CHALCOPYRITE

BELONGING (VERTICAL, INCLINED)  
 FOLIATION/SCHISTOSITY (VERTICAL, INCLINED)  
 VEIN (VERTICAL, INCLINED)  
 FAULT/SHEAR  
 OUTCROP  
 SMALL OUTCROP  
 MORaine  
 TALUS  
 GEOLOGICAL CONTACT

TR-7 TRENCH NUMBER  
 TRENCH LOCATION  
 ROCK SAMPLE  
 FLOAT SAMPLE

(0.15), (0.01), (0.01)  
 Cu, Pb, Zn VALUES  
 BRACKETED VALUES ARE REPORTED IN %  
 UNBRACKETED VALUES ARE REPORTED IN ppm

ABBREVIATIONS  
 CPY CHALCOPYRITE  
 GA GALENA  
 PY PYRITE  
 SPH SPHALERITE  
 STIB STIBNITE  
 QTZ QUARTZ

0 100 200  
 metres

**OREQUEST**

TANTALUS RESOURCES LTD.

Figure 6a  
**TREATY CREEK PROJECT**  
 Skeena Mining Division  
**GR-2 SHOWINGS**  
**COMPILATION MAP**  
 COPPER, LEAD & ZINC RESULTS  
 British Columbia  
 NTS: 104 B/9E

JANUARY 1991 Drafting RWR