

From Phase I  
Report, Jan 8/90  
Tantalus

802681

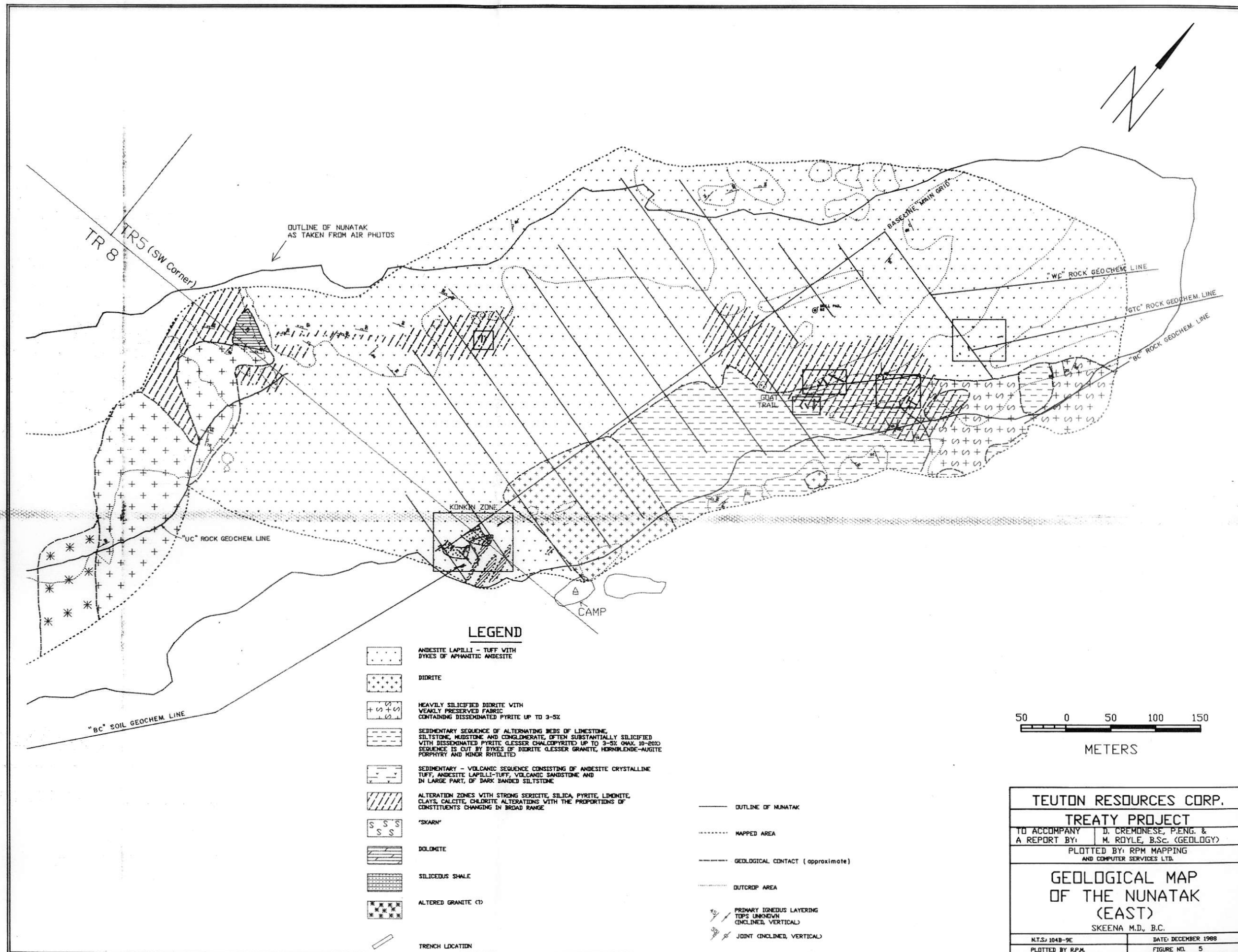



**RIDGE ZONE**

▲ 15938-60

▲ 15939-590

15940-0.200  
15941-0.190  
▲ 15961-1.401

▲ 15942-500

**SOUTHWEST ZONE**  
SEE FIGURES 17 & 18

▲ 15390-0.095

▲ 15945-0.184      15391-0.034      ▲ 15392-0.089

▲ 15943-150      ▲ 15394-0.157

▲ 15944 (nd)      15393-0.112

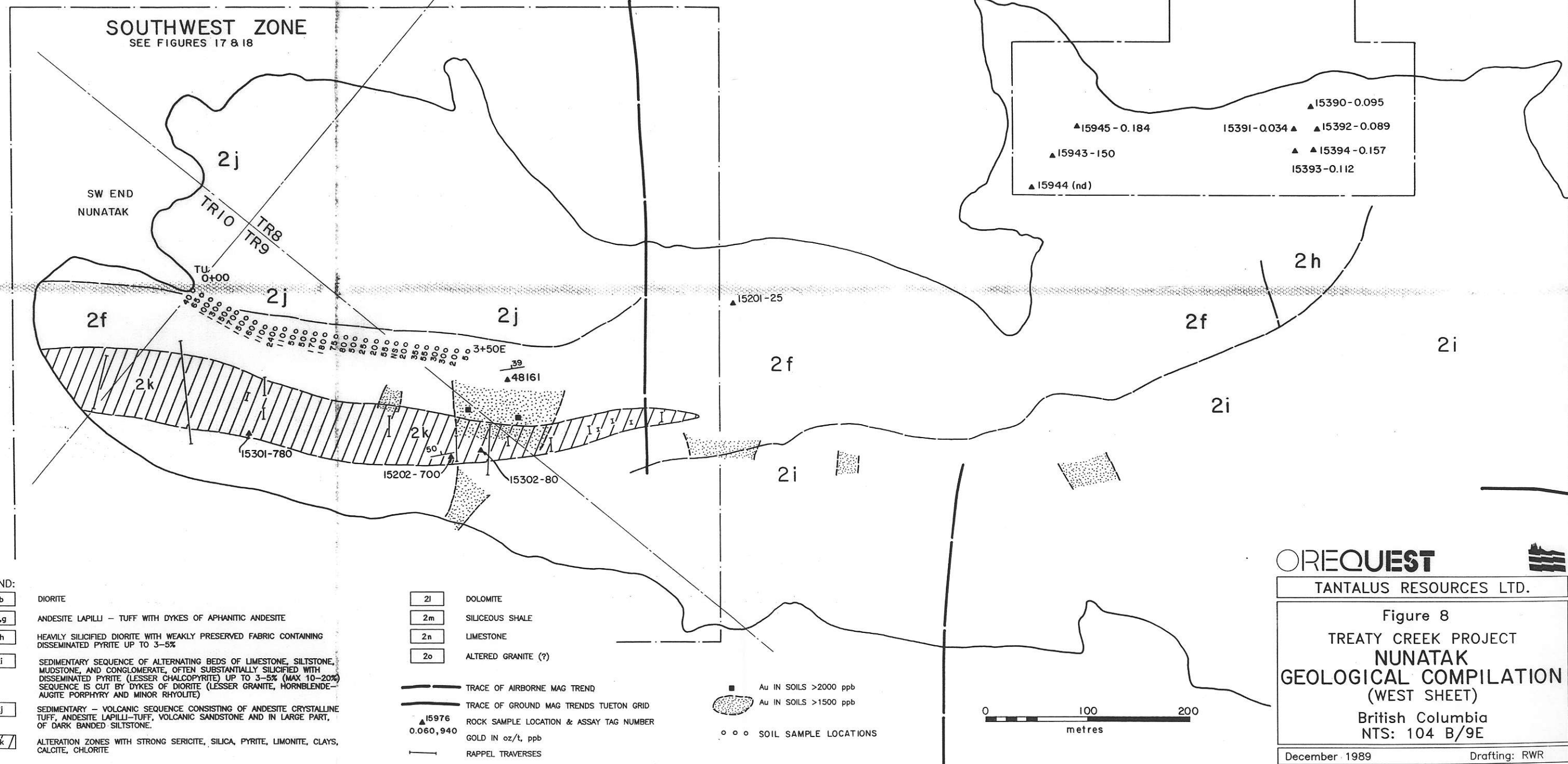

**LEGEND:**

2b DIORITE

2f,g ANDESITE LAPILLI - TUFF WITH DYKES OF APHANITIC ANDESITE

2h HEAVILY SILICIFIED DIORITE WITH WEAKLY PRESERVED FABRIC CONTAINING DISSEMINATED PYRITE UP TO 3-5%

2i SEDIMENTARY SEQUENCE OF ALTERNATING BEDS OF LIMESTONE, SILTSTONE, MUDSTONE, AND CONGLOMERATE, OFTEN SUBSTANTIALLY SILICIFIED WITH DISSEMINATED PYRITE (LESSER CHALCOPYRITE) UP TO 3-5% (MAX 10-20% SEQUENCE IS CUT BY DYKES OF DIORITE (LESSER GRANITE, HORNBLende-AUGITE PORPHYRY AND MINOR RHYOLITE)

2j SEDIMENTARY - VOLCANIC SEQUENCE CONSISTING OF ANDESITE CRYSTALLINE TUFF, ANDESITE LAPILLI-TUFF, VOLCANIC SANDSTONE AND IN LARGE PART, OF DARK BANDED SILTSTONE.

2k ALTERATION ZONES WITH STRONG SERICITE, SILICA, PYRITE, LIMONITE, CLAYS, CALCITE, CHLORITE

2l DOLOMITE

2m SILICEOUS SHALE

2n LIMESTONE

2o ALTERED GRANITE (?)

— TRACE OF AIRBORNE MAG TREND

— TRACE OF GROUND MAG TRENDS TUETON GRID

▲ 15976  
0.060,940 ROCK SAMPLE LOCATION & ASSAY TAG NUMBER

— RAPPTEL TRAVERSES

■ Au IN SOILS >2000 ppb

● Au IN SOILS >1500 ppb

○ ○ ○ SOIL SAMPLE LOCATIONS

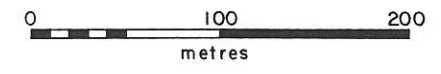

**OREQUEST**

TANTALUS RESOURCES LTD.

Figure 8

TREATY CREEK PROJECT

**NUNATAK**

**GEOLOGICAL COMPILATION**

(WEST SHEET)

British Columbia

NTS: 104 B/9E

December 1989      Drafting: RWR

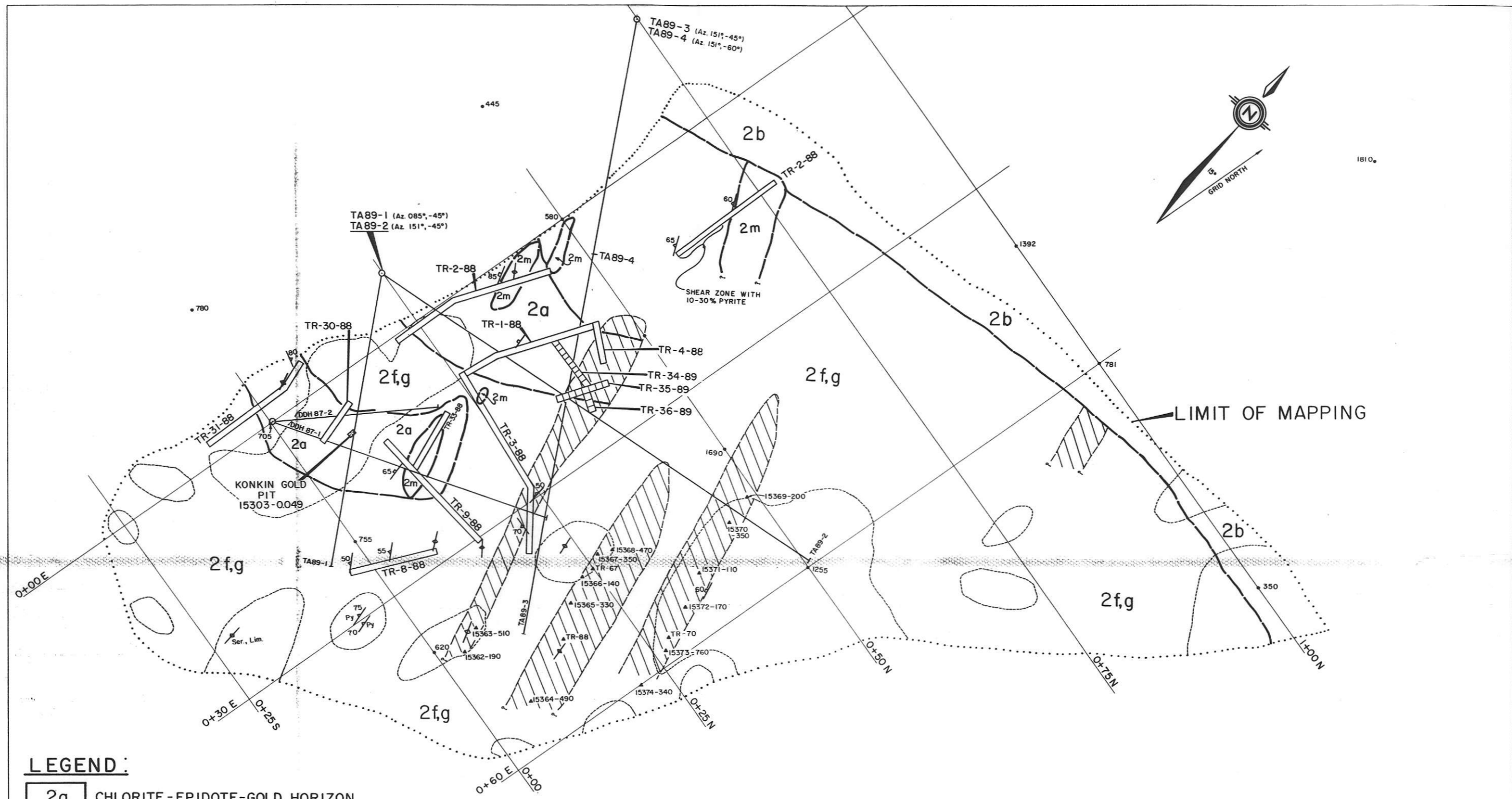

**LEGEND:**

- 2a CHLORITE-EPIDOTE-GOLD HORIZON
- 2b DIORITE
- 2f,g ANDESITE LAPILLI TUFF WITH DYKES OF APHANITIC ANDESITE
- 2m SILICEOUS SHALE
- 2n LIMESTONE

- GEOLOGICAL CONTACT (APPROXIMATE)
- OUTCROP AREA
- SHEARS (inclined, vertical)
- JOINT (inclined, vertical)
- TRENCH
- DRILL HOLE COLLAR

- ROCK SAMPLE LOCATION  
Assay tag no. - Au (ppb)
- 1988 SOIL SAMPLE  
Au (ppb)

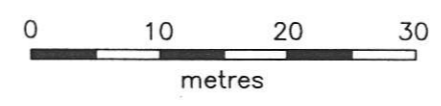

**OREQUEST**  
TANTALUS RESOURCES LTD.

Figure 9  
TREATY CREEK PROJECT  
KONKIN GOLD ZONE  
GEOLOGICAL COMPILATION MAP  
SKEENA MINING DIVISION  
British Columbia  
NTS: 104 B/9E

December 1989      Drafting: RWR

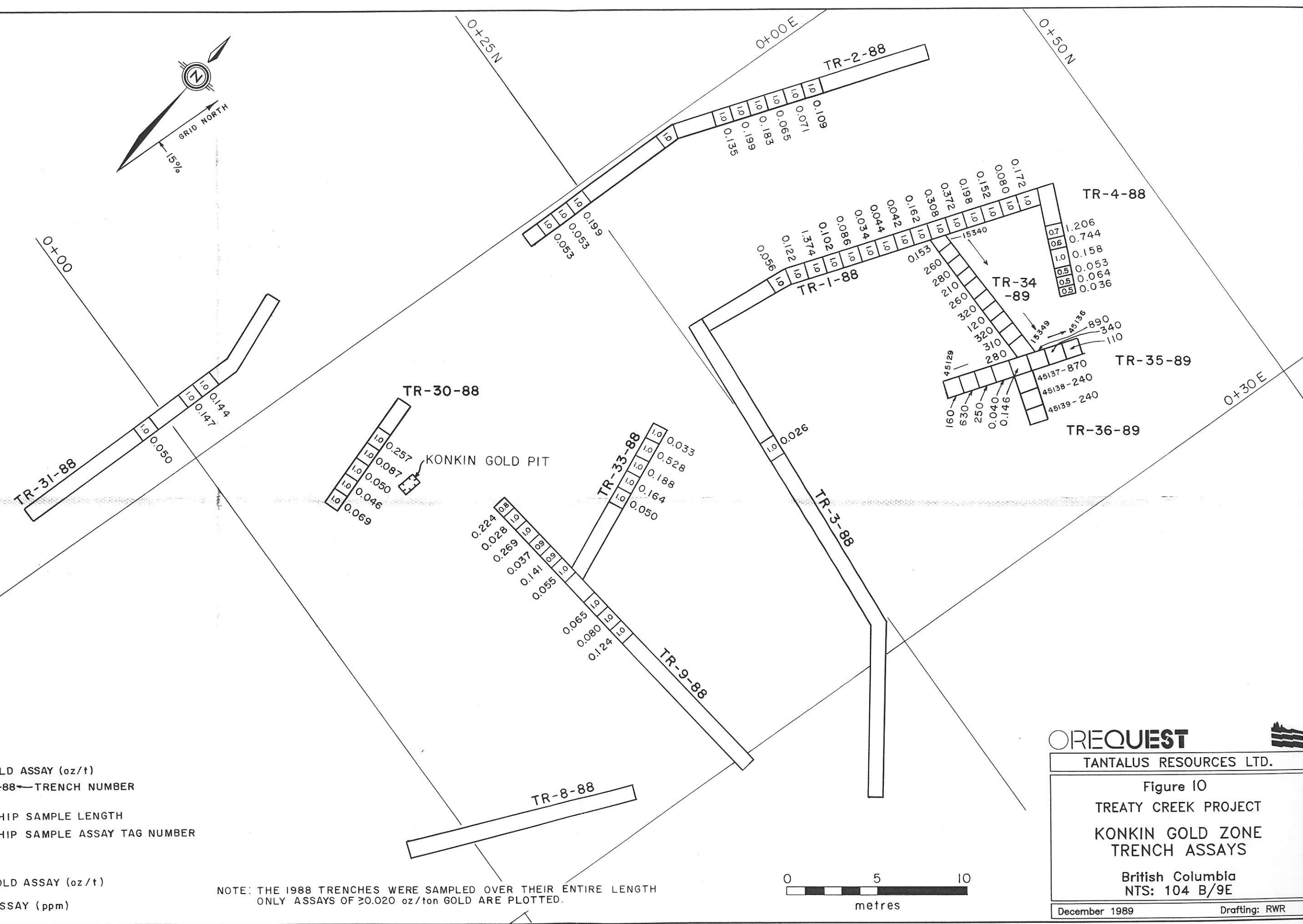
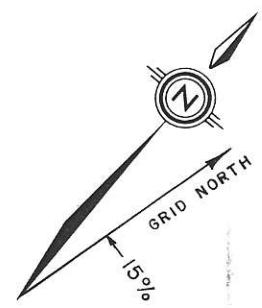

**LEGEND:**

GOLD ASSAY (oz/t)  
 TR-30-88 ← TRENCH NUMBER  
 CHIP SAMPLE LENGTH  
 CHIP SAMPLE ASSAY TAG NUMBER  
 GOLD ASSAY (ppm)

NOTE: THE 1988 TRENCHES WERE SAMPLED OVER THEIR ENTIRE LENGTH  
 ONLY ASSAYS OF ≥0.020 oz/ton GOLD ARE PLOTTED.

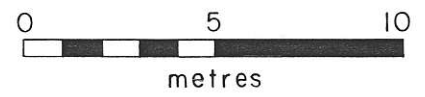

**OREQUEST**

TANTALUS RESOURCES LTD.

Figure 10  
 TREATY CREEK PROJECT  
 KONKIN GOLD ZONE  
 TRENCH ASSAYS

British Columbia  
 NTS: 104 B/9E

December 1989      Drafting: RWR

LOOKING SOUTHWEST

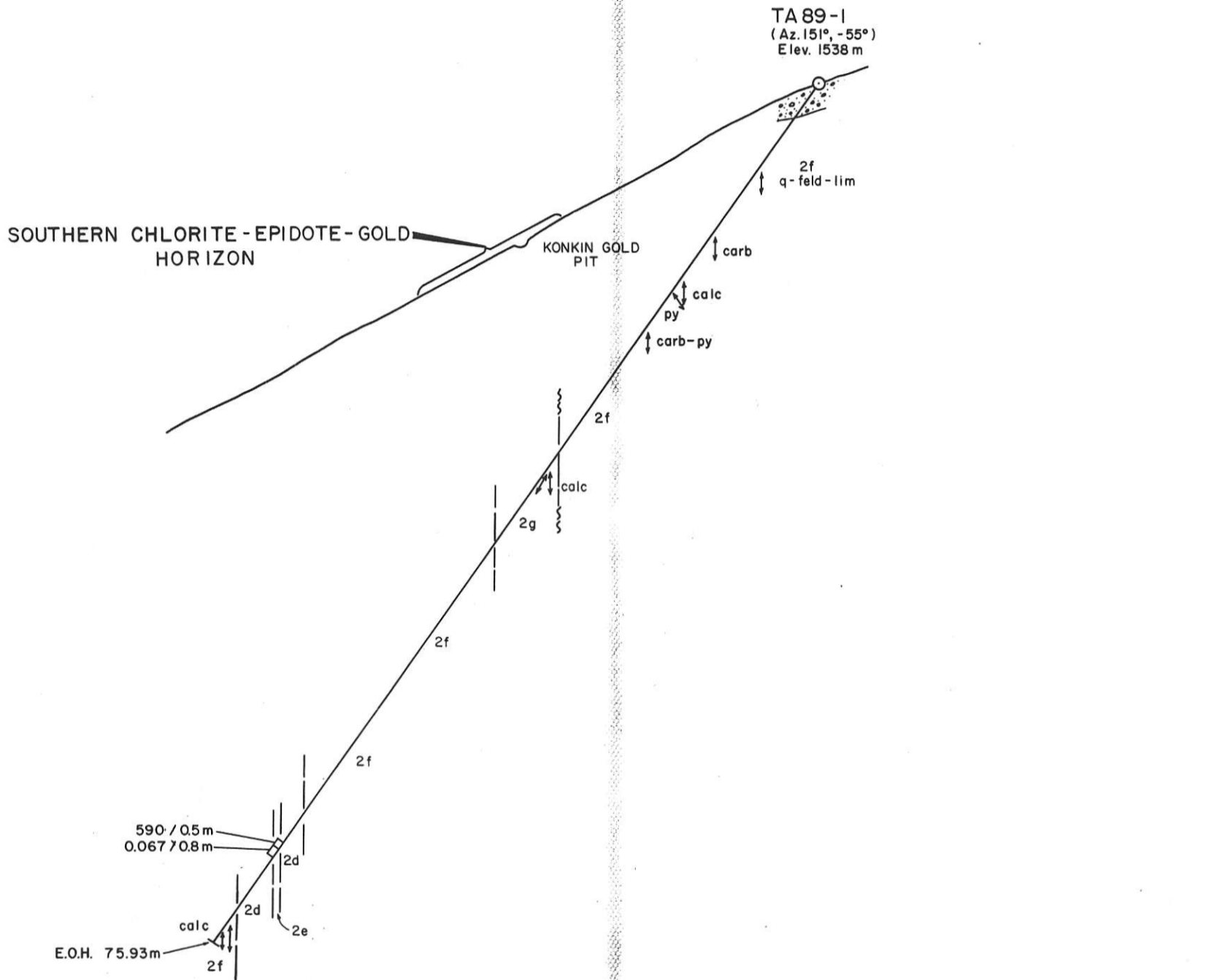

SYMBOLS

- VEIN
- FAULT
- LITHOLOGIC CONTACT
- GOLD ASSAY (ppb) over INTERVAL (metres)
- GOLD ASSAY (oz/t) over INTERVAL (metres)
- OVERBURDEN

NOTE: ONLY GOLD VALUES OF  $\geq 500$  ppb ARE PLOTTED

LEGEND:

- 2a CHLORITE-EPIDOTE-GOLD HORIZON
- 2b DIORITE
- 2c DACITE - tr - 5% py
- 2d DACITE - 5 - 20% py
- 2e DACITE >20% py
- 2f ANDESITE LAPILLI-CRYSTAL TUFF - tr -5% py
- 2g ANDESITE LAPILLI-CRYSTAL TUFF >5% py

ABBREVIATIONS

- q QUARTZ
- feld FELDSPAR
- calc CALCITE
- carb CARBONATE
- ep EPIDOTE
- hem HEMATITE
- lim LIMONITE
- ser SERICITE
- cpy CHALCOPYRITE
- py PYRITE

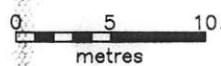

**OREQUEST**

TANTALUS RESOURCES LTD.

Figure 12  
TREATY CREEK PROJECT  
KONKIN ZONE  
DRILL SECTION TA-89-1

British Columbia  
NTS: 104 B/9E

December 1989

Drafting: RWR

LOOKING SOUTH

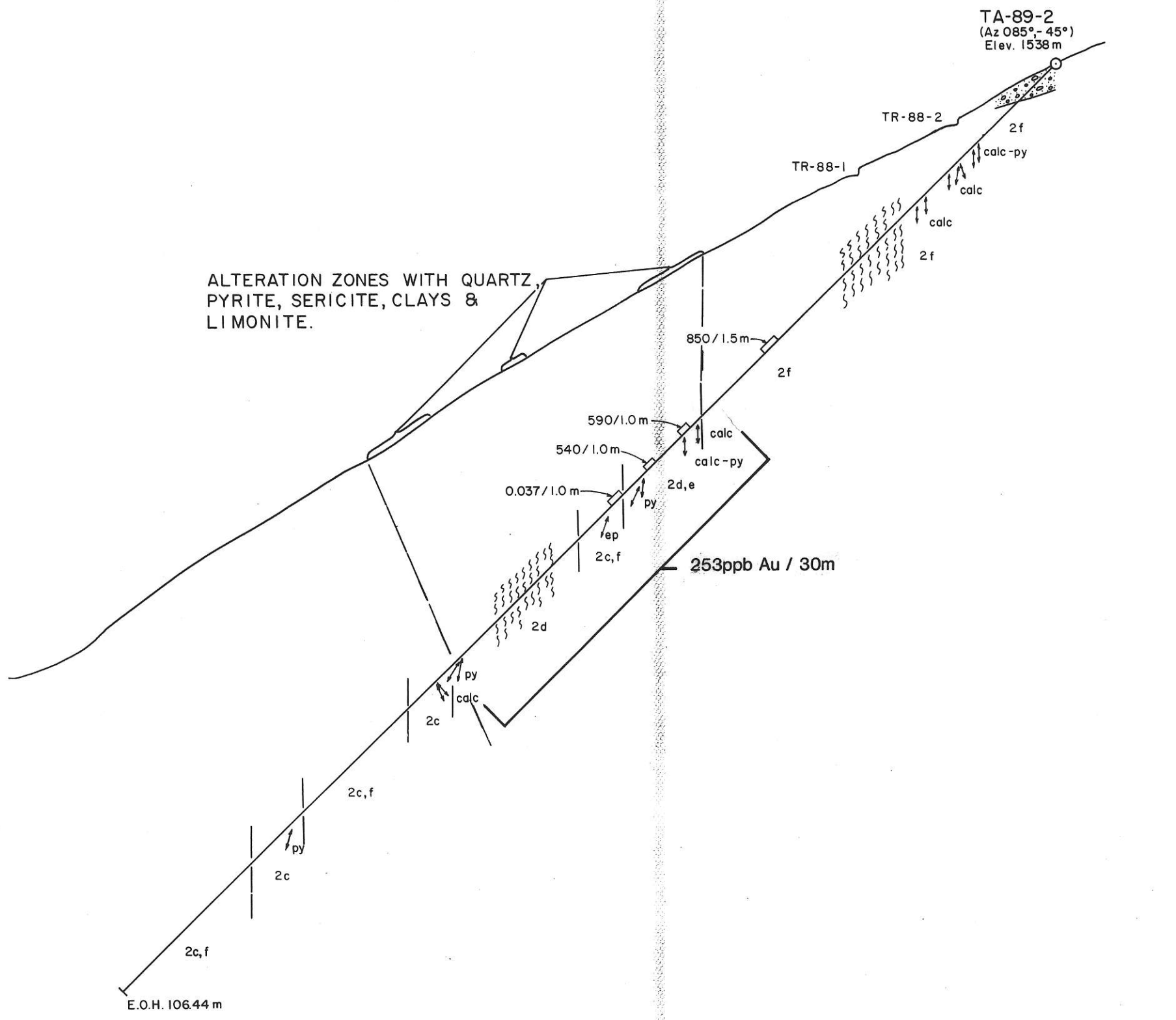

- VEIN
- FAULT
- LITHOLOGIC CONTACT
- GOLD ASSAY (ppb) over INTERVAL (metres)
- GOLD ASSAY (oz/t) over INTERVAL (metres)
- OVERBURDEN

NOTE: ONLY GOLD VALUES OF  $\geq 500$  ppb ARE PLOTTED

LEGEND:

- 2a CHLORITE-EPIDOTE-GOLD HORIZON
- 2b DIORITE
- 2c DACITE - tr - 5% py
- 2d DACITE - 5 - 20% py
- 2e DACITE >20% py
- 2f ANDESITE LAPILLI-CRYSTAL TUFF - tr - 5% py
- 2g ANDESITE LAPILLI-CRYSTAL TUFF >5% py

ABBREVIATIONS

- q QUARTZ
- feld FELDSPAR
- calc CALCITE
- carb CARBONATE
- ep EPIDOTE
- hem HEMATITE
- lim LIMONITE
- ser SERICITE
- cpy CHALCOPYRITE
- py PYRITE



**OREQUEST**

TANTALUS RESOURCES LTD.

Figure 13  
TREATY CREEK PROJECT  
KONKIN ZONE  
DRILL SECTION TA-89-2  
British Columbia  
NTS: 104 B/9E

December 1989

Drafting: RWR

LOOKING SW

TA-89-3  
(Az 151°, -45°)  
Elev. 1555 m

TA-89-4  
(Az 151°, -60°)  
Elev. 1555 m

NORTHERN CHLORITE-EPIDOTE-GOLD HORIZON

TR-88-4

TR-89-36

310ppb Au / 38m

710ppb Au / 18.7m

E.O.H. 129.62m

LEGEND:

- 2a CHLORITE-EPIDOTE-GOLD HORIZON
- 2b DIORITE
- 2c DACITE - tr - 5% py
- 2d DACITE - 5 - 20% py
- 2e DACITE >20% py
- 2f ANDESITE LAPILLI-CRYSTAL TUFF - tr -5% py
- 2g ANDESITE LAPILLI-CRYSTAL TUFF >5% py

SYMBOLS

- ↔ VEIN
- ~~~~ FAULT
- LITHOLOGIC CONTACT
- 590/0.5m — GOLD ASSAY (ppb) over INTERVAL (metres)
- 0.067/0.8m — GOLD ASSAY (oz/t) over INTERVAL (metres)
- OVERBURDEN

ABBREVIATIONS

- q QUARTZ
- feld FELDSPAR
- calc CALCITE
- carb CARBONATE
- ep EPIDOTE
- hem HEMATITE
- lim LIMONITE
- ser SERICITE
- cpy CHALCOPYRITE
- py PYRITE

OREQUEST

TANTALUS RESOURCES LTD.

Figure 14  
TREATY CREEK PROJECT  
KONKIN ZONE  
DRILL SECTION TA-89-3 & 4  
British Columbia  
NTS: 104 B/9E

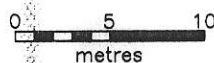

NOTE: ONLY GOLD VALUES OF ≥ 500 ppb ARE PLOTTED

December 1989

Drafting: RWR

LEGEND:

- 2b DIORITE
- 2f ANDESITE LAPILLI - TUFF WITH DYKES OF APHANITIC ANDESITE
- 2h HEAVILY SILICIFIED DIORITE WITH WEAKLY PRESERVED FABRIC CONTAINING DISSEMINATED PYRITE UP TO 3-5%
- 2i SEDIMENTARY SEQUENCE OF ALTERNATING BEDS OF LIMESTONE, SILTSTONE, MUDSTONE, AND CONGLOMERATE, OFTEN SUBSTANTIALLY SILICIFIED WITH DISSEMINATED PYRITE (LESSER CHALCOPYRITE) UP TO 3-5% (MAX 10-20%) SEQUENCE IS CUT BY DYKES OF DIORITE (LESSER GRANITE, HORNBLende-AUGITE PORPHYRY AND MINOR RHYOLITE)
- 2j SEDIMENTARY - VOLCANIC SEQUENCE CONSISTING OF ANDESITE CRYSTALLINE TUFF, ANDESITE LAPILLI-TUFF, VOLCANIC SANDSTONE AND IN LARGE PART, OF DARK BANDED SILTSTONE.
- 2k ALTERATION ZONES WITH STRONG SERICITE, SILICA, PYRITE, LIMONITE, CLAYS, CALCITE, CHLORITE

- SYMBOLS
- RAPPEL SAMPLING SITES
  - BEDDING, inclined
  - FOLIATION, inclined
  - VEIN, inclined
  - JOINT/FRACTURE, inclined

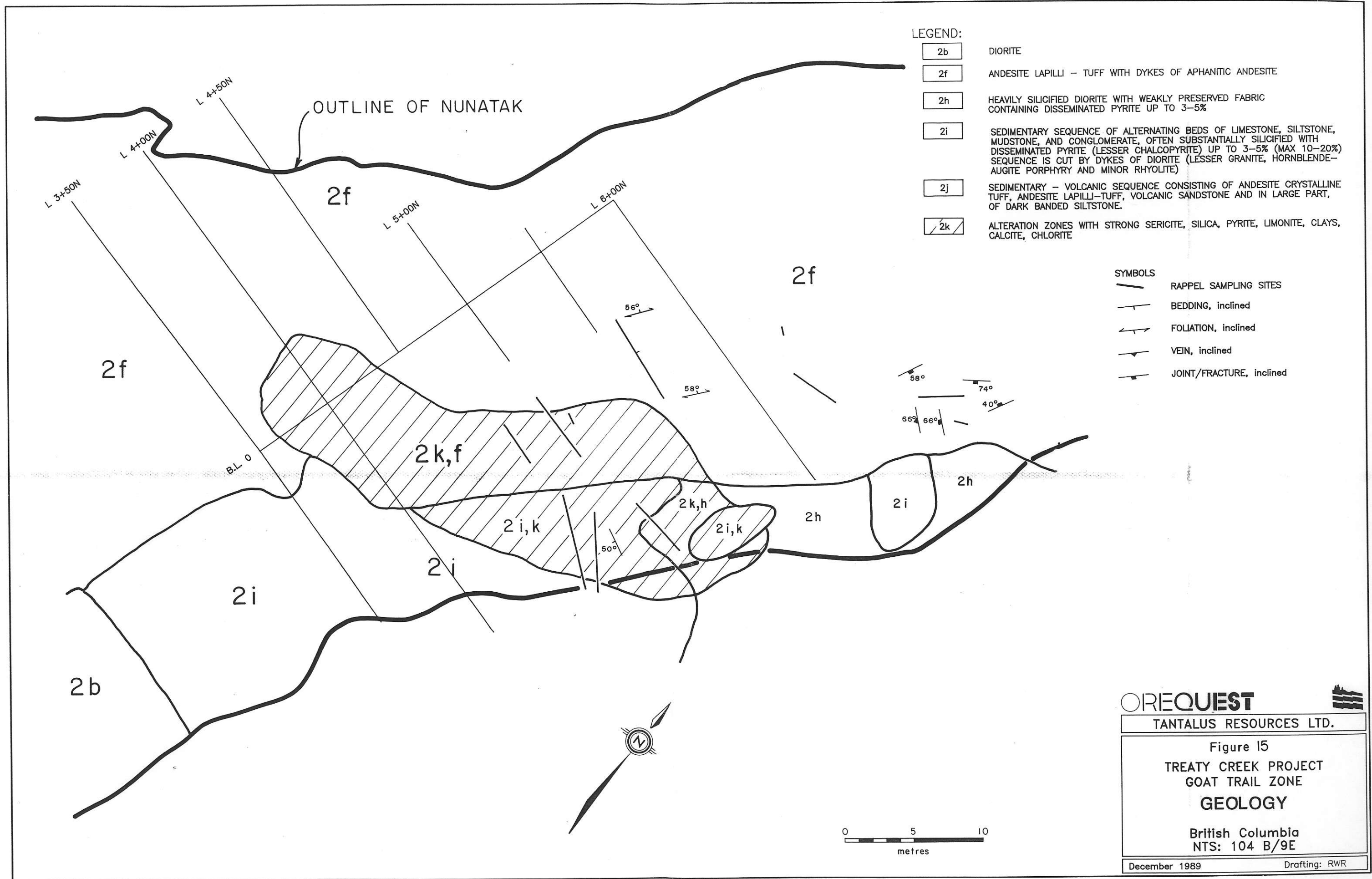

**OREQUEST**

TANTALUS RESOURCES LTD.

Figure 15  
TREATY CREEK PROJECT  
GOAT TRAIL ZONE  
**GEOLOGY**

British Columbia  
NTS: 104 B/9E

December 1989 Drafting: RWR



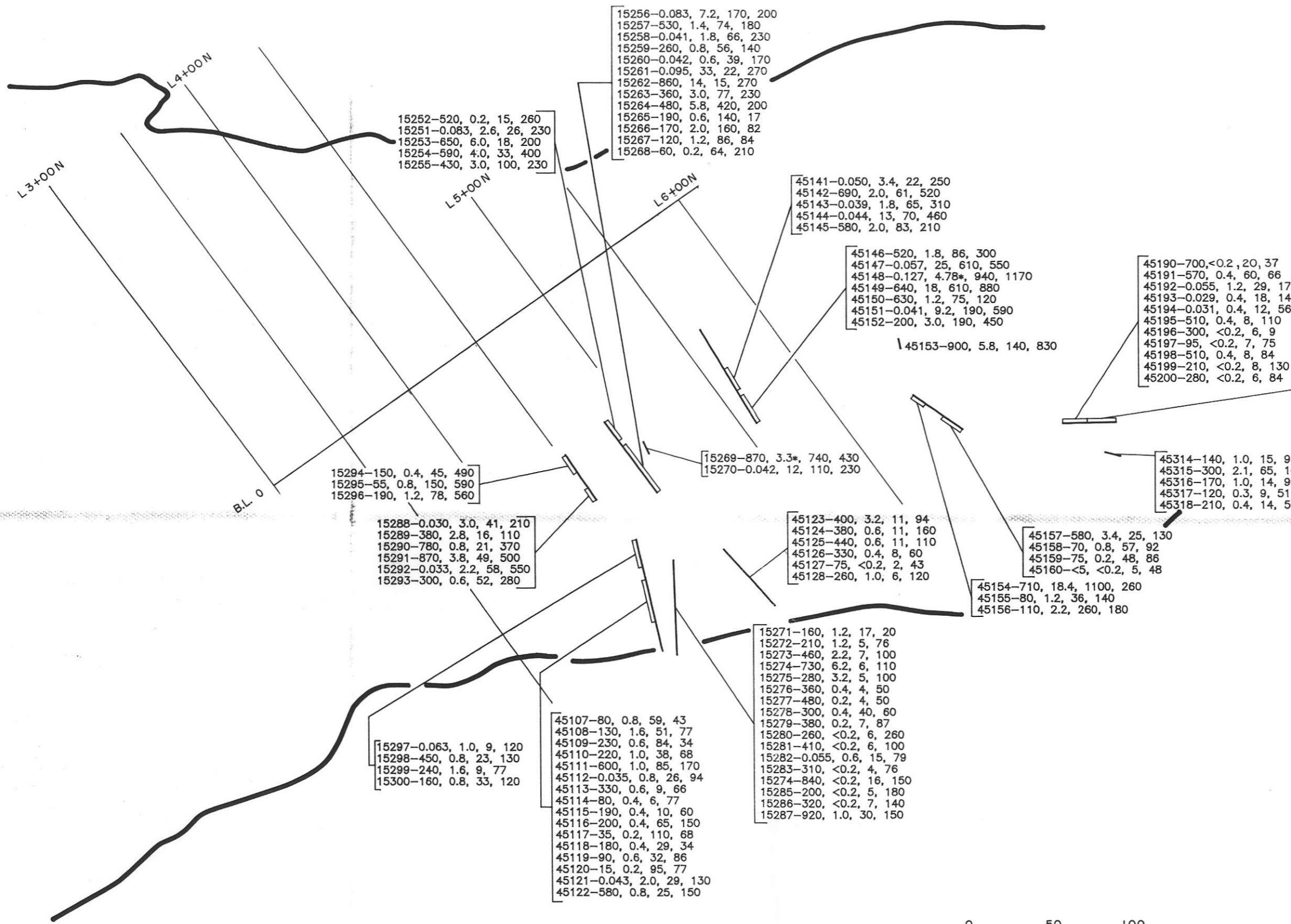

15252-520, 0.2, 15, 260  
 15251-0.083, 2.6, 26, 230  
 15253-650, 6.0, 18, 200  
 15254-590, 4.0, 33, 400  
 15255-430, 3.0, 100, 230

15256-0.083, 7.2, 170, 200  
 15257-530, 1.4, 74, 180  
 15258-0.041, 1.8, 66, 230  
 15259-260, 0.8, 56, 140  
 15260-0.042, 0.6, 39, 170  
 15261-0.095, 33, 22, 270  
 15262-860, 14, 15, 270  
 15263-360, 3.0, 77, 230  
 15264-480, 5.8, 420, 200  
 15265-190, 0.6, 140, 17  
 15266-170, 2.0, 160, 82  
 15267-120, 1.2, 86, 84  
 15268-60, 0.2, 64, 210

45141-0.050, 3.4, 22, 250  
 45142-690, 2.0, 61, 520  
 45143-0.039, 1.8, 65, 310  
 45144-0.044, 13, 70, 460  
 45145-580, 2.0, 83, 210

45146-520, 1.8, 86, 300  
 45147-0.057, 25, 610, 550  
 45148-0.127, 4.78\*, 940, 1170  
 45149-640, 18, 610, 880  
 45150-630, 1.2, 75, 120  
 45151-0.041, 9.2, 190, 590  
 45152-200, 3.0, 190, 450

45153-900, 5.8, 140, 830

45190-700, <0.2, 20, 37  
 45191-570, 0.4, 60, 66  
 45192-0.055, 1.2, 29, 170  
 45193-0.029, 0.4, 18, 140  
 45194-0.031, 0.4, 12, 56  
 45195-510, 0.4, 8, 110  
 45196-300, <0.2, 6, 9  
 45197-95, <0.2, 7, 75  
 45198-510, 0.4, 8, 84  
 45199-210, <0.2, 8, 130  
 45200-280, <0.2, 6, 84

45301-700, 1.6, 48, 448  
 45302-291, 0.7, 15, 290  
 45303-0.031, 3.8, 384, 387  
 45304-410, 2.0, 36, 160  
 45305-240, 1.2, 60, 119  
 45306-220, 0.8, 17, 109  
 45307-80, 0.5, 7, 57  
 45308-230, 0.7, 8, 61  
 45309-100, 0.4, 9, 50

15294-150, 0.4, 45, 490  
 15295-55, 0.8, 150, 590  
 15296-190, 1.2, 78, 560

15269-870, 3.3\*, 740, 430  
 15270-0.042, 12, 110, 230

45314-140, 1.0, 15, 94  
 45315-300, 2.1, 65, 103  
 45316-170, 1.0, 14, 90  
 45317-120, 0.3, 9, 51  
 45318-210, 0.4, 14, 56

45319-160, 0.2, 4, 78

15288-0.030, 3.0, 41, 210  
 15289-380, 2.8, 16, 110  
 15290-780, 0.8, 21, 370  
 15291-870, 3.8, 49, 500  
 15292-0.033, 2.2, 58, 550  
 15293-300, 0.6, 52, 280

45123-400, 3.2, 11, 94  
 45124-380, 0.6, 11, 160  
 45125-440, 0.6, 11, 110  
 45126-330, 0.4, 8, 60  
 45127-75, <0.2, 2, 43  
 45128-260, 1.0, 6, 120

45157-580, 3.4, 25, 130  
 45158-70, 0.8, 57, 92  
 45159-75, 0.2, 48, 86  
 45160-<5, <0.2, 5, 48

45154-710, 18.4, 1100, 260  
 45155-80, 1.2, 36, 140  
 45156-110, 2.2, 260, 180

15271-160, 1.2, 17, 20  
 15272-210, 1.2, 5, 76  
 15273-460, 2.2, 7, 100  
 15274-730, 6.2, 6, 110  
 15275-280, 3.2, 5, 100  
 15276-360, 0.4, 4, 50  
 15277-480, 0.2, 4, 50  
 15278-300, 0.4, 40, 60  
 15279-380, 0.2, 7, 87  
 15280-260, <0.2, 6, 260  
 15281-410, <0.2, 6, 100  
 15282-0.055, 0.6, 15, 79  
 15283-310, <0.2, 4, 76  
 15274-840, <0.2, 16, 150  
 15285-200, <0.2, 5, 180  
 15286-320, <0.2, 7, 140  
 15287-920, 1.0, 30, 150

15297-0.063, 1.0, 9, 120  
 15298-450, 0.8, 23, 130  
 15299-240, 1.6, 9, 77  
 15300-160, 0.8, 33, 120

45107-80, 0.8, 59, 43  
 45108-130, 1.6, 51, 77  
 45109-230, 0.6, 84, 34  
 45110-220, 1.0, 38, 68  
 45111-600, 1.0, 85, 170  
 45112-0.035, 0.8, 26, 94  
 45113-330, 0.6, 9, 66  
 45114-80, 0.4, 6, 77  
 45115-190, 0.4, 10, 60  
 45116-200, 0.4, 65, 150  
 45117-35, 0.2, 110, 68  
 45118-180, 0.4, 29, 34  
 45119-90, 0.6, 32, 86  
 45120-15, 0.2, 95, 77  
 45121-0.043, 2.0, 29, 130  
 45122-580, 0.8, 25, 150

**SAMPLE RESULTS**

SAMPLE No.	Au ppb	Ag oz/t	Cu ppm	As ppm
15288-300	7.87*	220	930	
or				
SAMPLE No.	Au oz/t	Ag ppm	Cu ppm	As ppm
15288-0.017	18.2	220	930	

**SYMBOLS**  
 / RAPPEL SAMPLE SITE

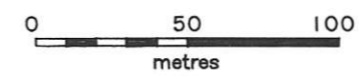

**OREQUEST**  
 TANTALUS RESOURCES LTD.

Figure 16  
 TREATY CREEK PROJECT  
 GOAT TRAIL ZONE  
**ROCK GEOCHEMISTRY**  
 Au, Ag, Cu & As  
 British Columbia  
 NTS: 104 B/9E

December 1989      Drafting: RWR

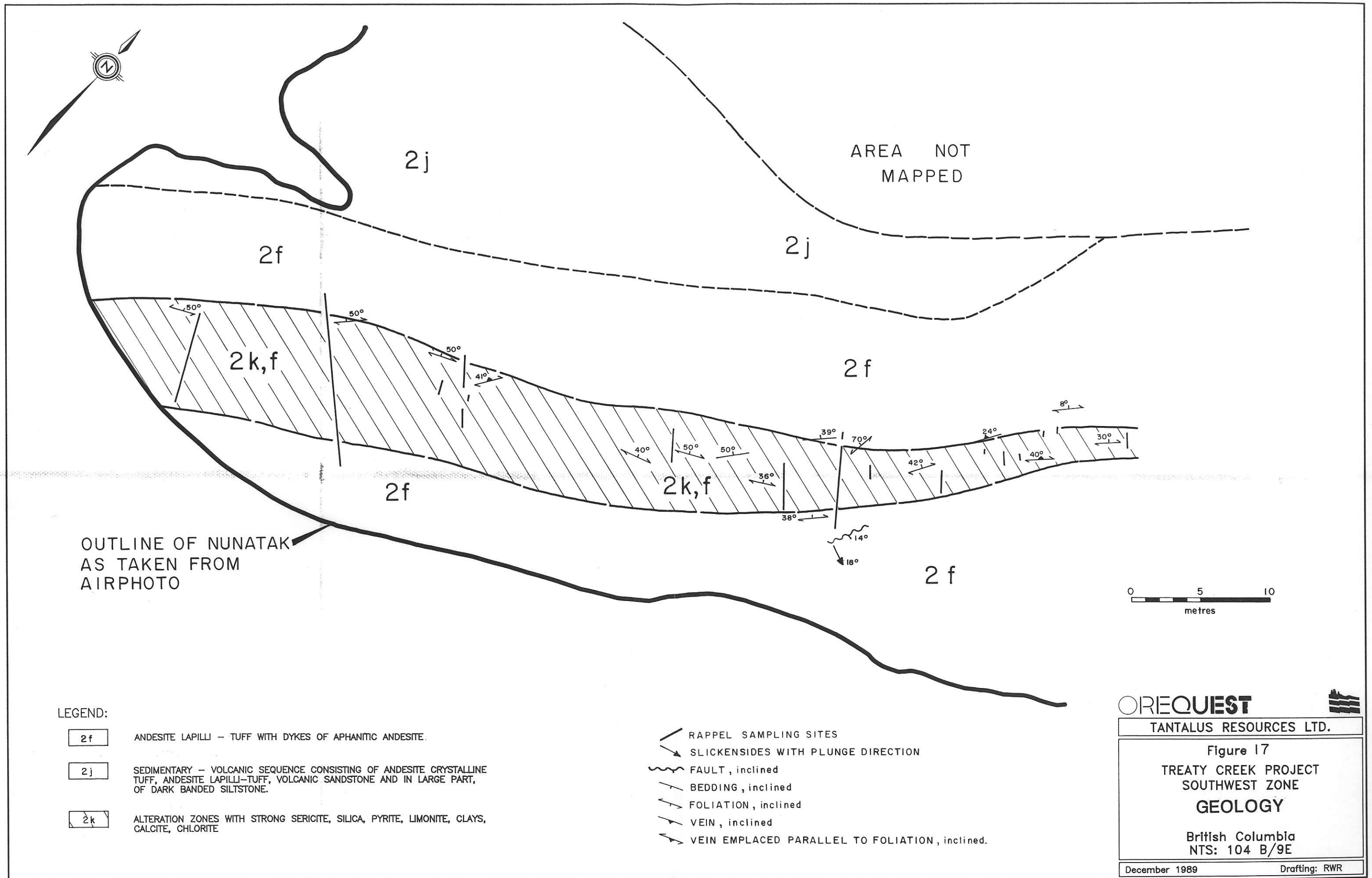

OUTLINE OF NUNATAK  
AS TAKEN FROM  
AIRPHOTO

AREA NOT  
MAPPED

LEGEND:

- 2f ANDESITE LAPILLI - TUFF WITH DYKES OF APHANITIC ANDESITE.
- 2j SEDIMENTARY - VOLCANIC SEQUENCE CONSISTING OF ANDESITE CRYSTALLINE TUFF, ANDESITE LAPILLI-TUFF, VOLCANIC SANDSTONE AND IN LARGE PART, OF DARK BANDED SILTSTONE.
- 2k ALTERATION ZONES WITH STRONG SERICITE, SILICA, PYRITE, LIMONITE, CLAYS, CALCITE, CHLORITE

- RAPPEL SAMPLING SITES
- SLICKENSIDES WITH PLUNGE DIRECTION
- FAULT, inclined
- BEDDING, inclined
- FOLIATION, inclined
- VEIN, inclined
- VEIN EMPLACED PARALLEL TO FOLIATION, inclined.

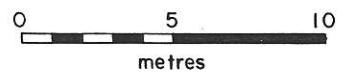

**OREQUEST**  
TANTALUS RESOURCES LTD.

Figure 17  
TREATY CREEK PROJECT  
SOUTHWEST ZONE  
**GEOLOGY**

British Columbia  
NTS: 104 B/9E

December 1989      Drafting: RWR

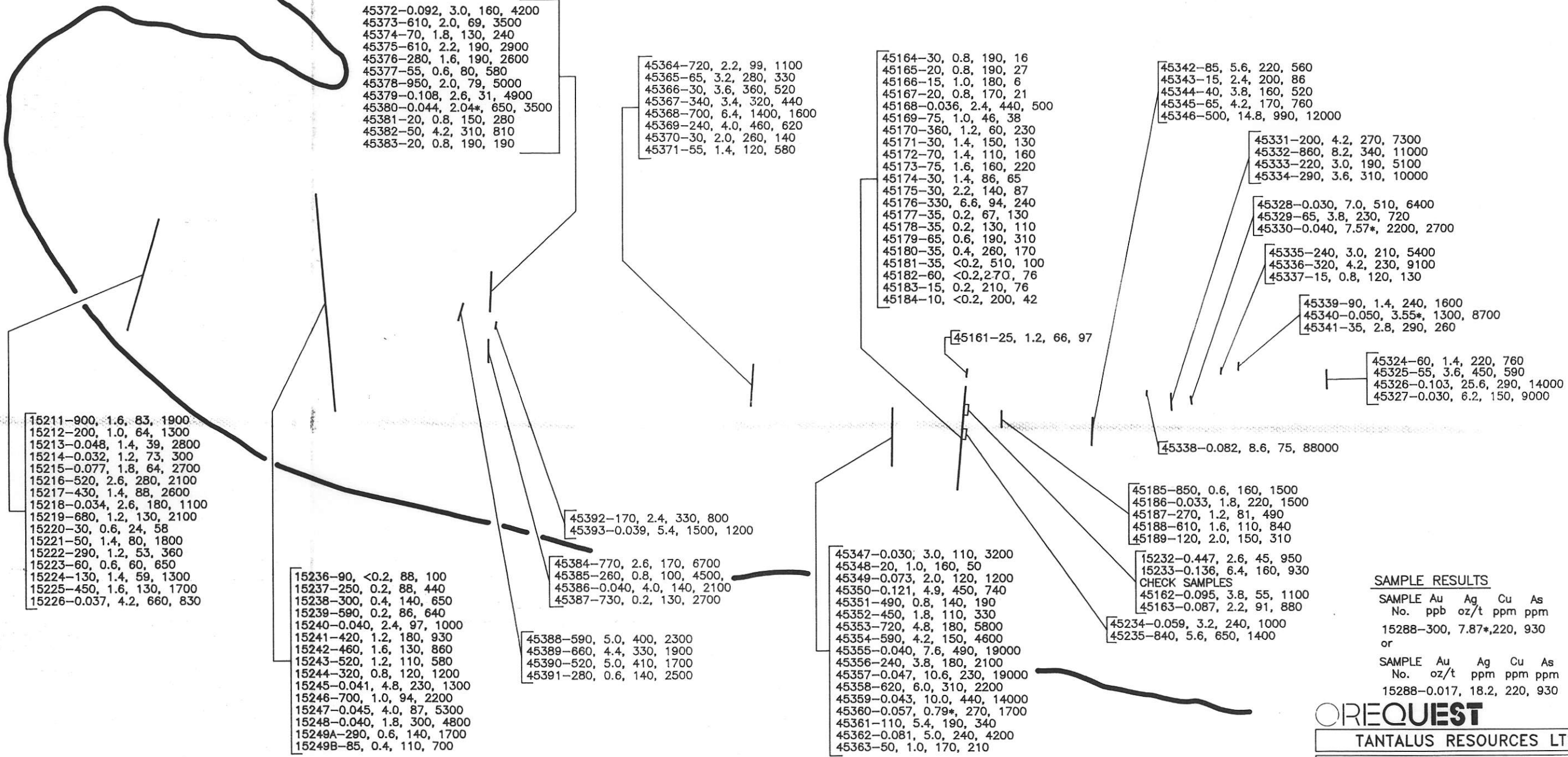

**SAMPLE RESULTS**

SAMPLE No.	Au ppb	Ag oz/t	Cu ppm	As ppm
15288-300	7.87*	220	930	
or				
SAMPLE No.	Au oz/t	Ag ppm	Cu ppm	As ppm
15288-0.017	18.2	220	930	

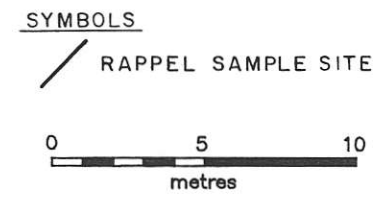

**OREQUEST**

TANTALUS RESOURCES LTD.

Figure 18

TREATY CREEK PROJECT  
 SOUTHWEST ZONE

**ROCK GEOCHEMISTRY**  
 Au, Ag, Cu & As  
 British Columbia  
 NTS: 104 B/9E

December 1989      Drafting: RWR

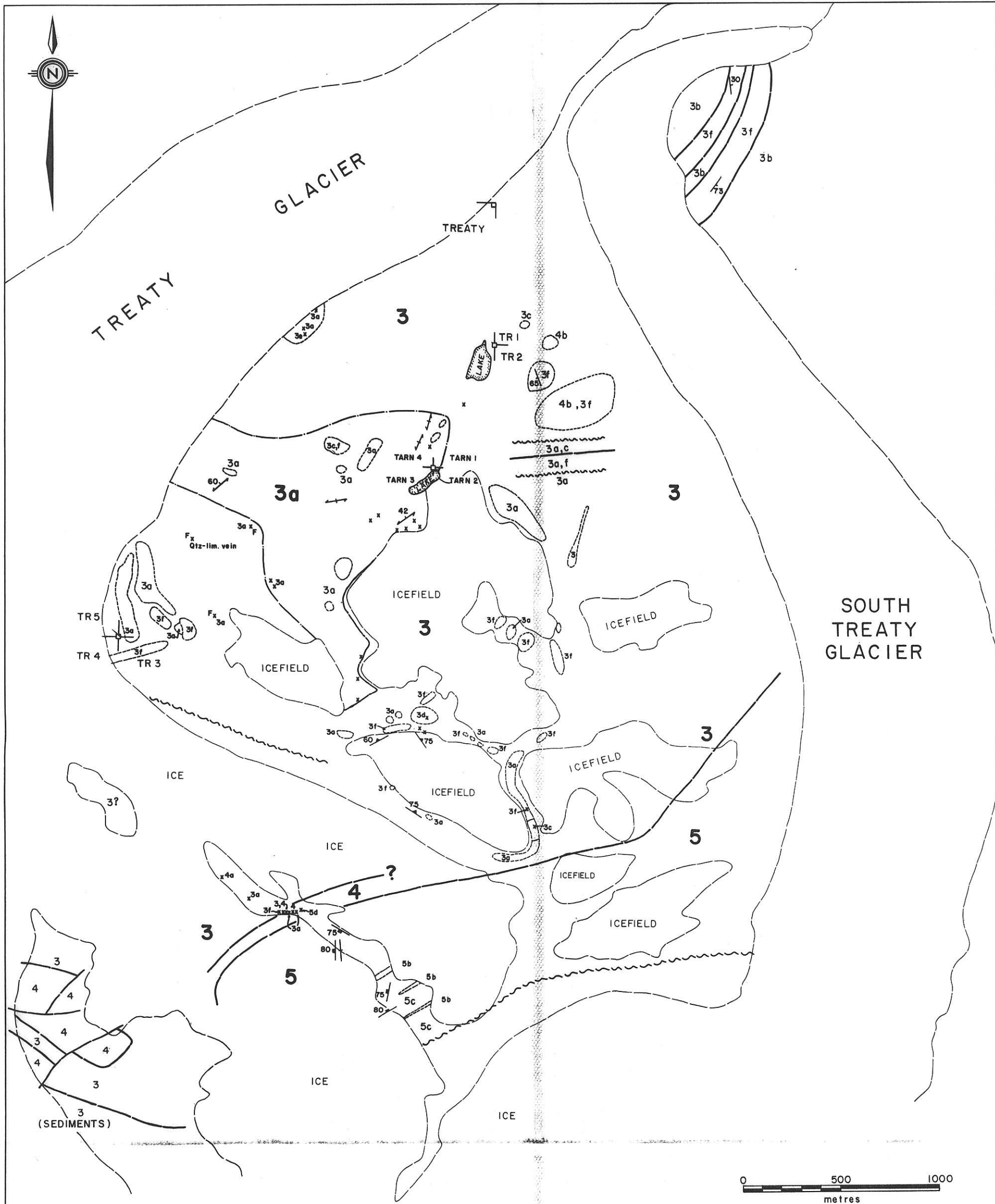

**LEGEND**

**VOLCANIC AND SEDIMENTARY ROCKS  
TRIASSIC TO JURASSIC**

**MIDDLE JURASSIC: SPATSIZI GROUP**

**5 SALMON RIVER FORMATION**

- 5b Rhythmically bedded siltstone
- 5c Thickly bedded sandstone
- 5d Limestone lenses
- 5e Andesite tuffs

**LOWER JURASSIC: HAZELTON GROUP**

**4 MOUNT DILWORTH FORMATION**

Felsic volcanic sequence of dacitic to rhyolitic composition including dust tuff, crystal and lithic tuff.

**3 BETTY CREEK FORMATION**

- 3a Massive, green and grey andesitic to dacitic tuff, lapilli tuff, tuff breccia and minor flows
- 3b Bedded, heterogeneous, red, green, and grey volcanic breccia, lapilli tuff, crystal and lithic tuff, commonly hematitic.
- 3c Basaltic to andesitic pillow lavas
- 3f Bedded, hematitic siltstone, sandstone, and conglomerate; locally fossiliferous

**SYMBOLS**

- x OUTCROP, SMALL OUTCROP
- FOLIATION (vertical, inclined)
- BEDDING (vertical, inclined)
- FRACTURE
- VEIN
- GEOLOGICAL CONTACT
- FAULT
- ALTERATION ZONE: Pyrite-quartz-sericite ± carbonate ± clay, locally foliated to schistose.
- F FLOAT
- LEGAL CORNER POST

**OREQUEST**

TANTALUS RESOURCES LTD.

Figure 19  
TREATY CREEK PROJECT  
TREATY GOSSAN  
GEOLOGY

British Columbia  
NTS: 104 B/9E

December 1989

Drafting: RWR

GEOLOGY IN PART AFTER R.V. KIRKHAM (PERSONAL COMMUNICATION)



**LEGEND:**

- TRIASSIC TO JURASSIC HAZELTON GROUP
  - MIDDLE JURASSIC
    - 5 SALMON RIVER FORMATION - argillites
  - LOWER JURASSIC
    - 4 MOUNT DILWORTH FORMATION - rhyolite to dacite
    - 3 BETTY CREEK FORMATION - andesite tuff and lapilli tuff
  - ..... LIMIT OF MAPPING
  - GEOLOGICAL CONTACT (defined, inferred)
  - 60/ BEDDING STRIKE & DIP
  - ▲ ROCK SAMPLE LOCATION
- | Assay Tag No. | Au (ppb) | Ag (ppm) | Cu (ppm) | As (ppm) |
|---------------|----------|----------|----------|----------|
| 15319         | <5       | <0.2     | 5        | 4        |
| 15318         | <5       | <0.2     | 3        | 9        |
| 15317         | 10       | <0.2     | 12       | 21       |
| 15316         | <5       | <0.2     | 4        | 4        |
| 15315         | <5       | <0.2     | 7        | 5        |
| 15314         | <5       | <0.2     | 5        | 6        |
| 15313         | <5       | <0.2     | 6        | 5        |

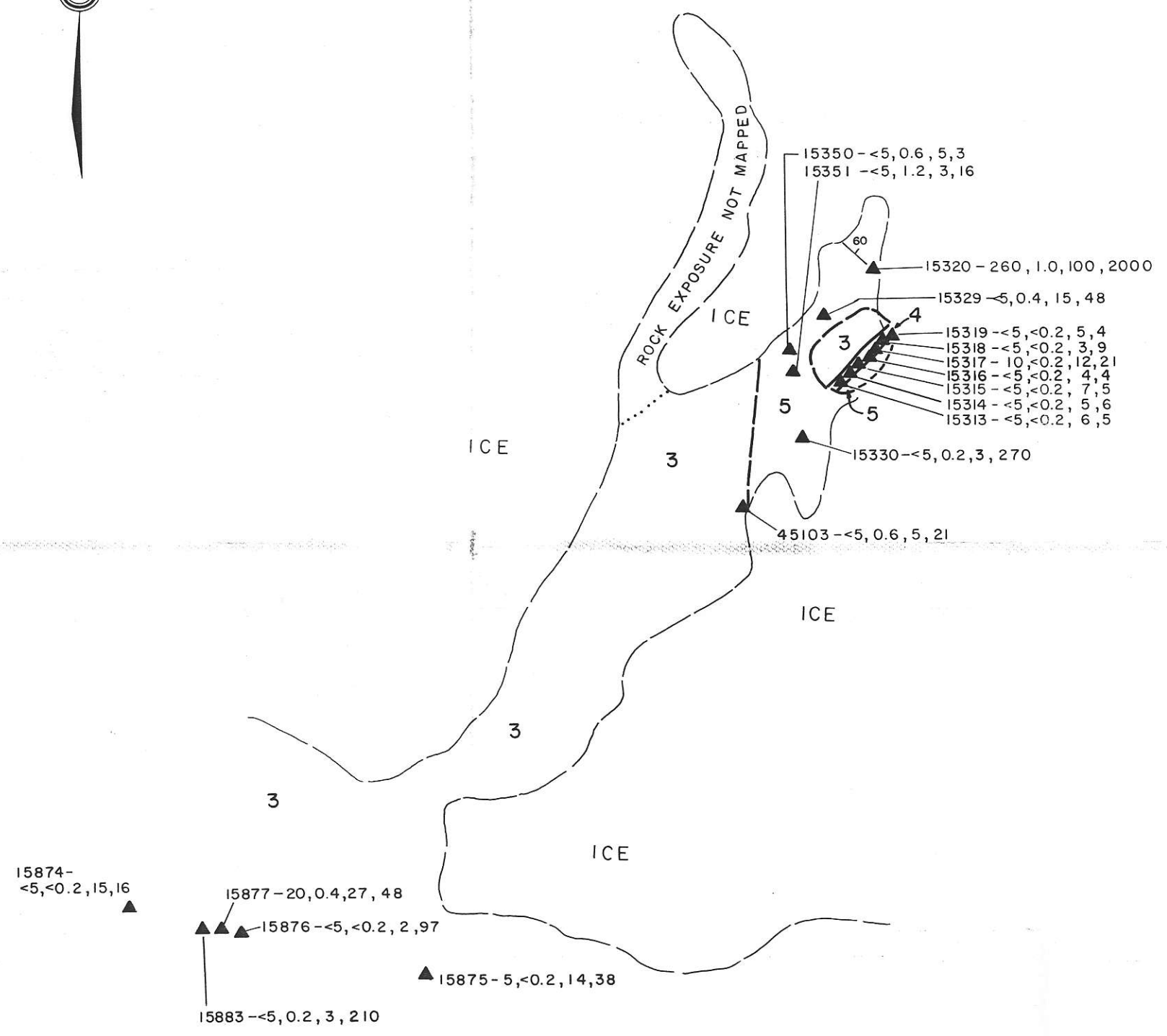

**OREQUEST**

TANTALUS RESOURCES LTD.

Figure 22  
TREATY CREEK PROJECT  
BALL PYRITE ZONE  
GEOLOGY and  
GEOCHEMISTRY  
British Columbia  
NTS: 104 B/9E

December 1989      Drafting: RWR

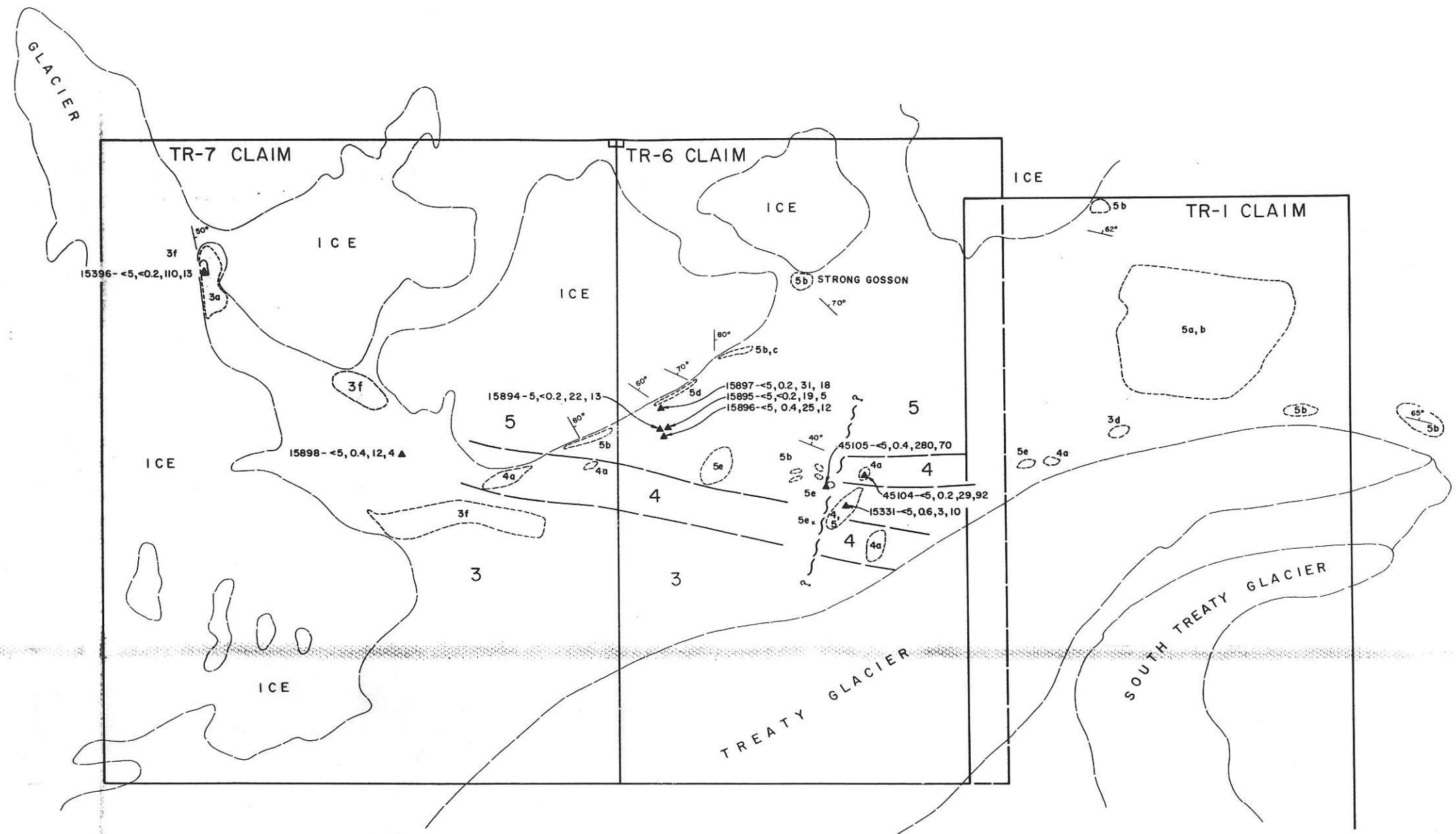

**LEGEND**

- VOLCANIC AND SEDIMENTARY ROCKS  
TRIASSIC TO JURASSIC**
- MIDDLE JURASSIC: SPATSIZI GROUP**  
**5 SALMON RIVER FORMATION**  
 5b Rhythmically bedded siltstone  
 5c Thickly bedded sandstone  
 5d Limestone lenses  
 5e Andesite tuffs
- LOWER JURASSIC: HAZELTON GROUP**  
**4 MOUNT DILWORTH FORMATION**  
 Rhyolite to dacitic volcanics including dust, crystal, lithic and lapilli tuffs  
 4a Massive to bedded airfall tuffs
- 3 BETTY CREEK FORMATION**  
 3a Massive, green and grey andesitic to dacitic tuff, lapilli tuff, tuff breccia and minor flows  
 3d Atkins Porphyry: hornblende and feldspar porphyritic andesite  
 3f Bedded, hematitic siltstone, sandstone, and conglomerate; locally fossiliferous

**SYMBOLS**

- Outcrop, small outcrop
- Bedding, inclined
- Geological contact
- Fault, assumed
- Rock sample location  
Assay tag no. - Au, Ag, Cu, As  
(ppb) (ppm) (ppm) (ppm)
- Legal corner post

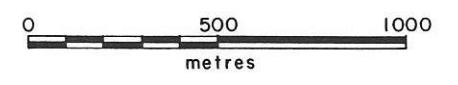

**OREQUEST**  
**TANTALUS RESOURCES LTD.**

Figure 23  
**TREATY CREEK PROJECT**  
 TR 1, 6 & 7 CLAIMS  
**GEOLOGY and**  
**ROCK GEOCHEMISTRY**  
 British Columbia  
 NTS: 104 B/9E