

R. V. KIRKHAM  
R. V. KIRKHAM

802342

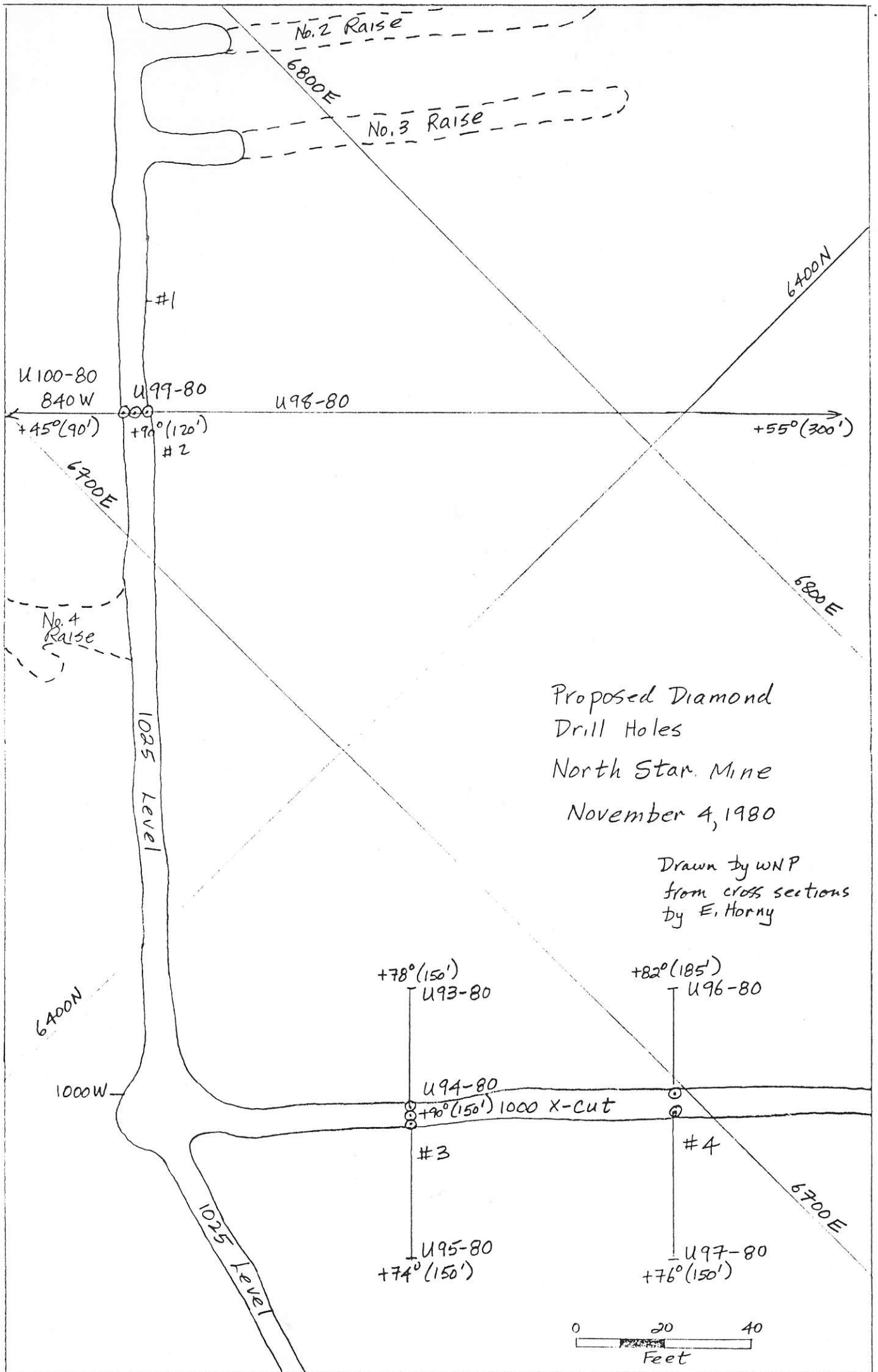

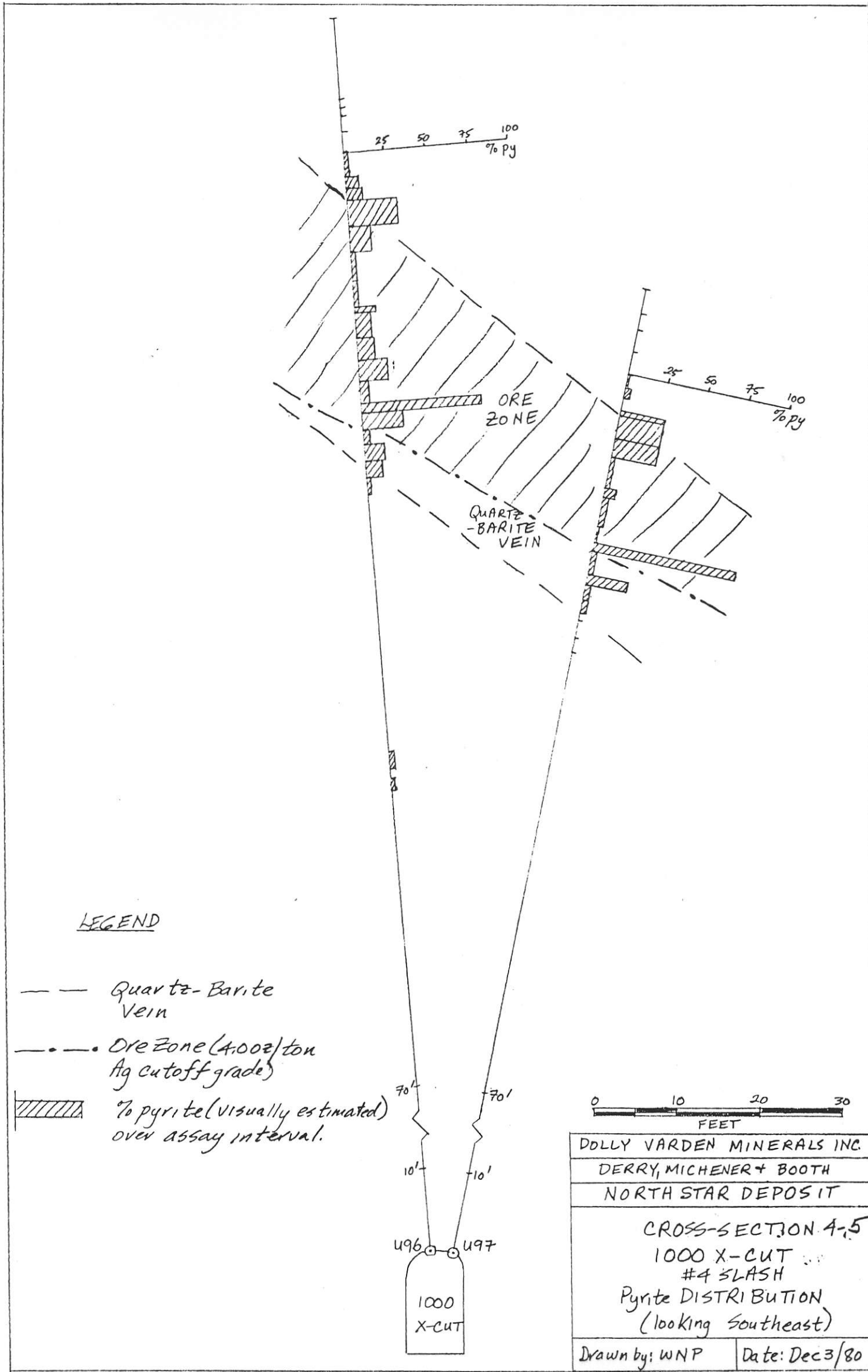

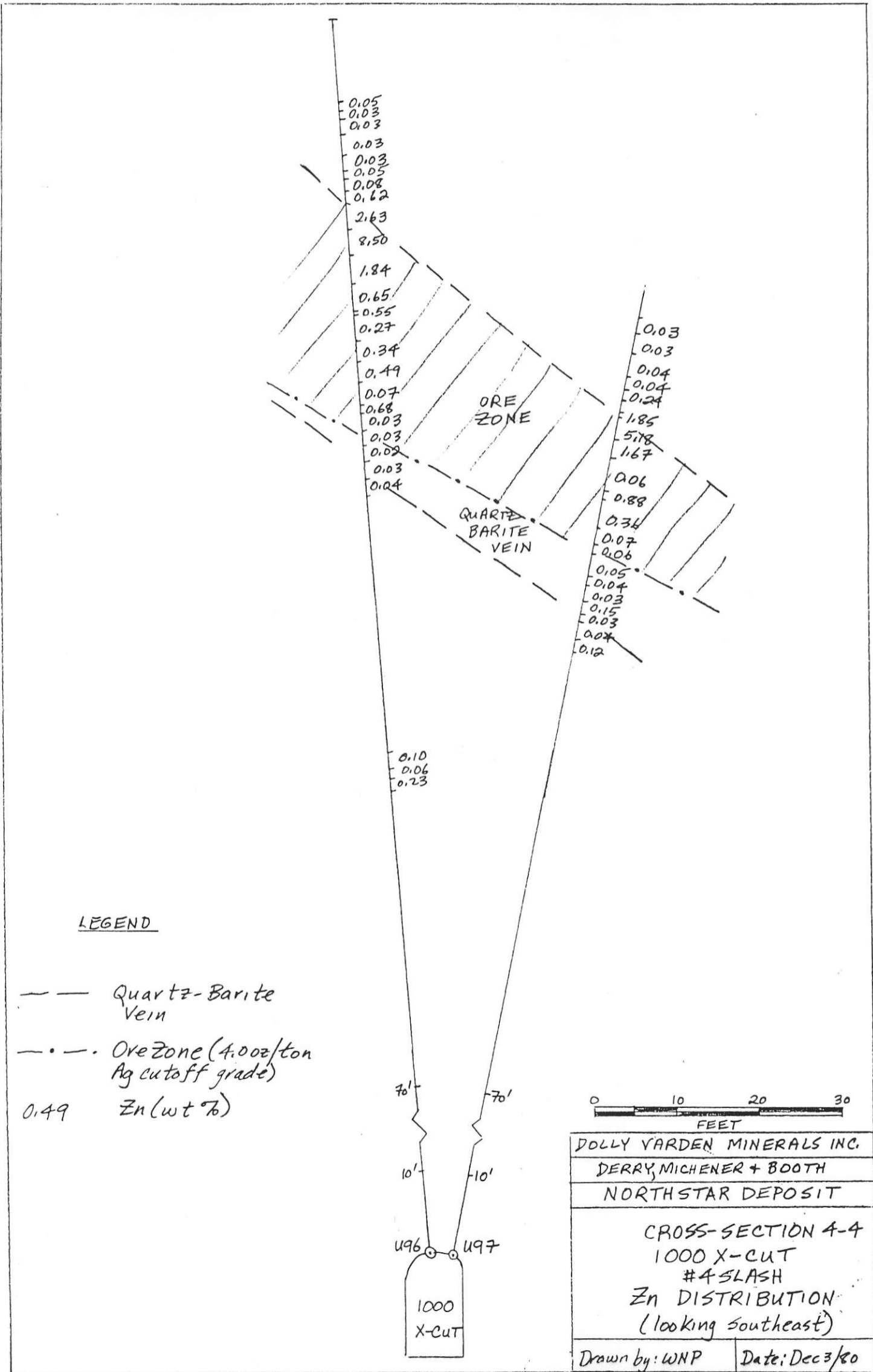

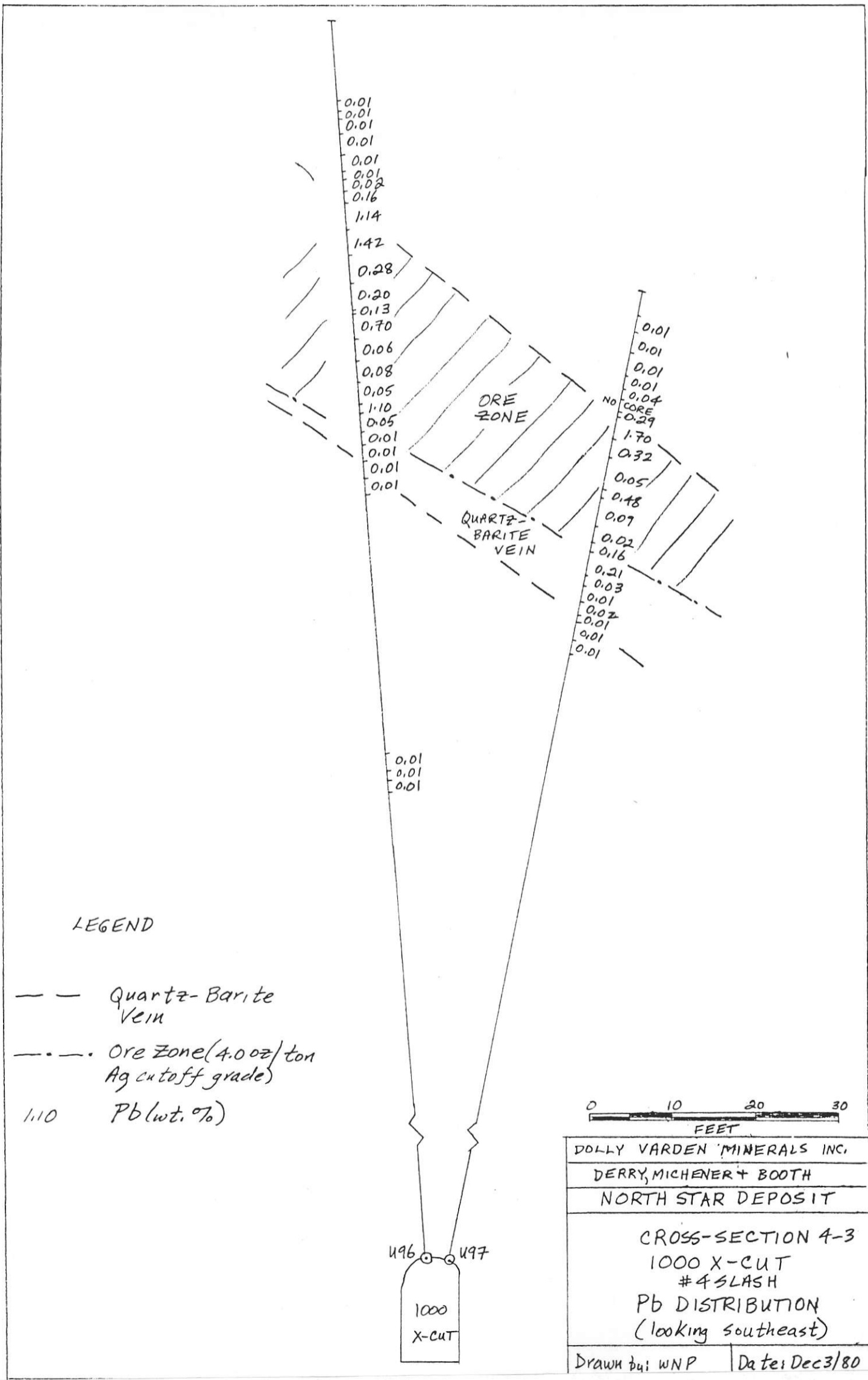

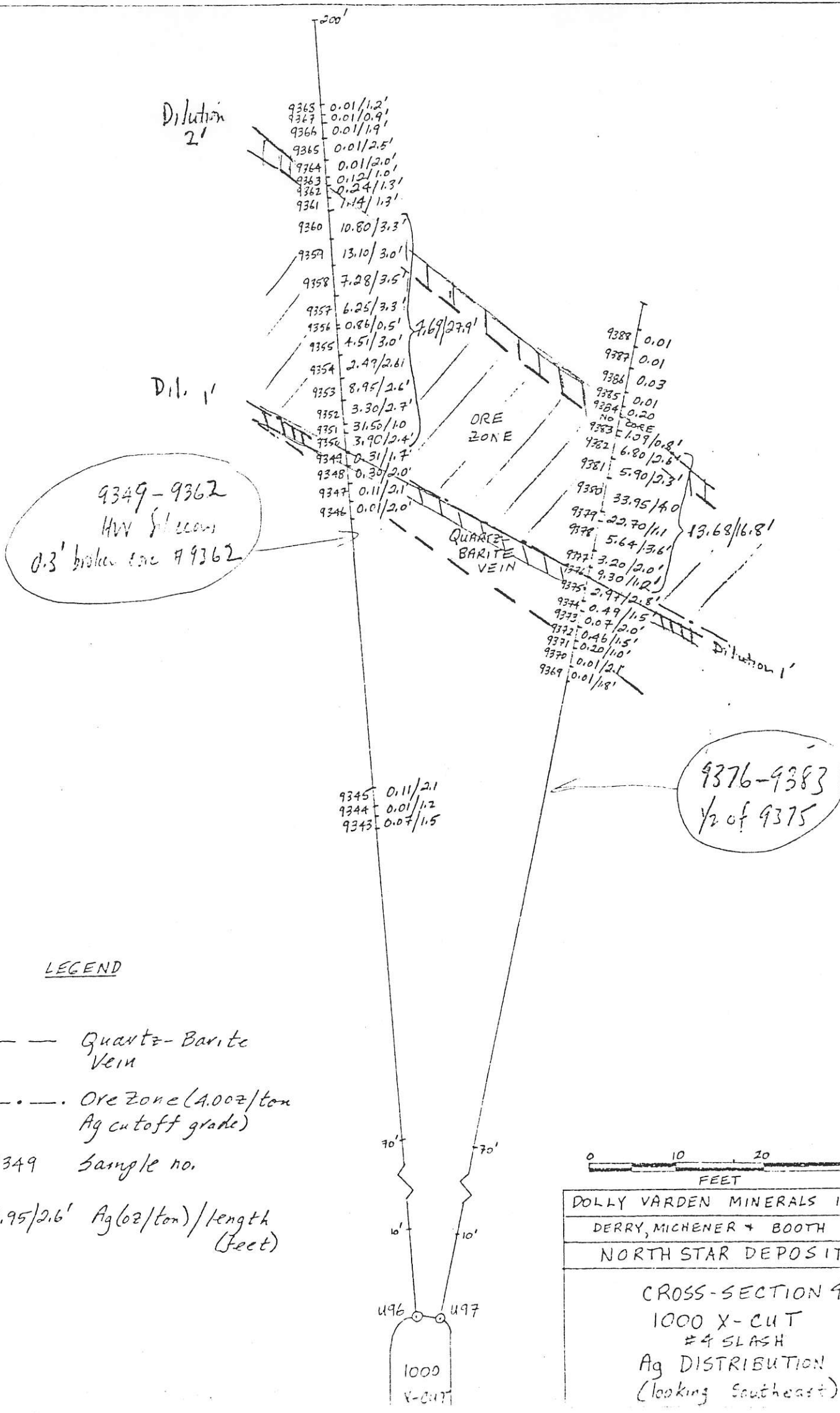

Dilution 2'

Dil. 1'

9349-9362  
HW Silicons  
0.3' broken conc #9362

9376-9383  
1/2 of 9375

LEGEND

- — Quartz-Barite Vein
- . - . Ore Zone (A.002/ton Ag cutoff grade)
- 9349 Sample no.
- 8.95/2.6' Ag(oz/ton)/length (feet)

0 10 20 30  
FEET

DOLLY VARDEN MINERALS INC.  
DERRY, MICHENER & BOOTH  
NORTH STAR DEPOSIT

CROSS-SECTION 4-2  
1000 X-CUT  
#4 SLASH  
Ag DISTRIBUTION  
(looking Southeast)

9365 0.01/1.2'  
9367 0.01/0.9'  
9366 0.01/1.9'  
9365 0.01/2.5'  
9364 0.01/2.0'  
9363 0.12/1.0'  
9362 0.24/1.3'  
9361 1.14/1.3'

9360 10.80/3.3'  
9359 13.10/3.0'  
9358 7.28/3.5'  
9357 6.25/3.3'  
9356 0.86/0.5'  
9355 4.51/3.0'  
9354 2.49/2.61  
9353 8.95/2.6'  
9352 3.30/2.7'  
9351 31.56/1.0  
9350 3.90/2.4'  
9349 0.31/1.7'  
9348 0.30/2.0'  
9347 0.11/2.1  
9346 0.01/2.0'

9345 0.11/2.1  
9344 0.01/1.2  
9343 0.07/1.5





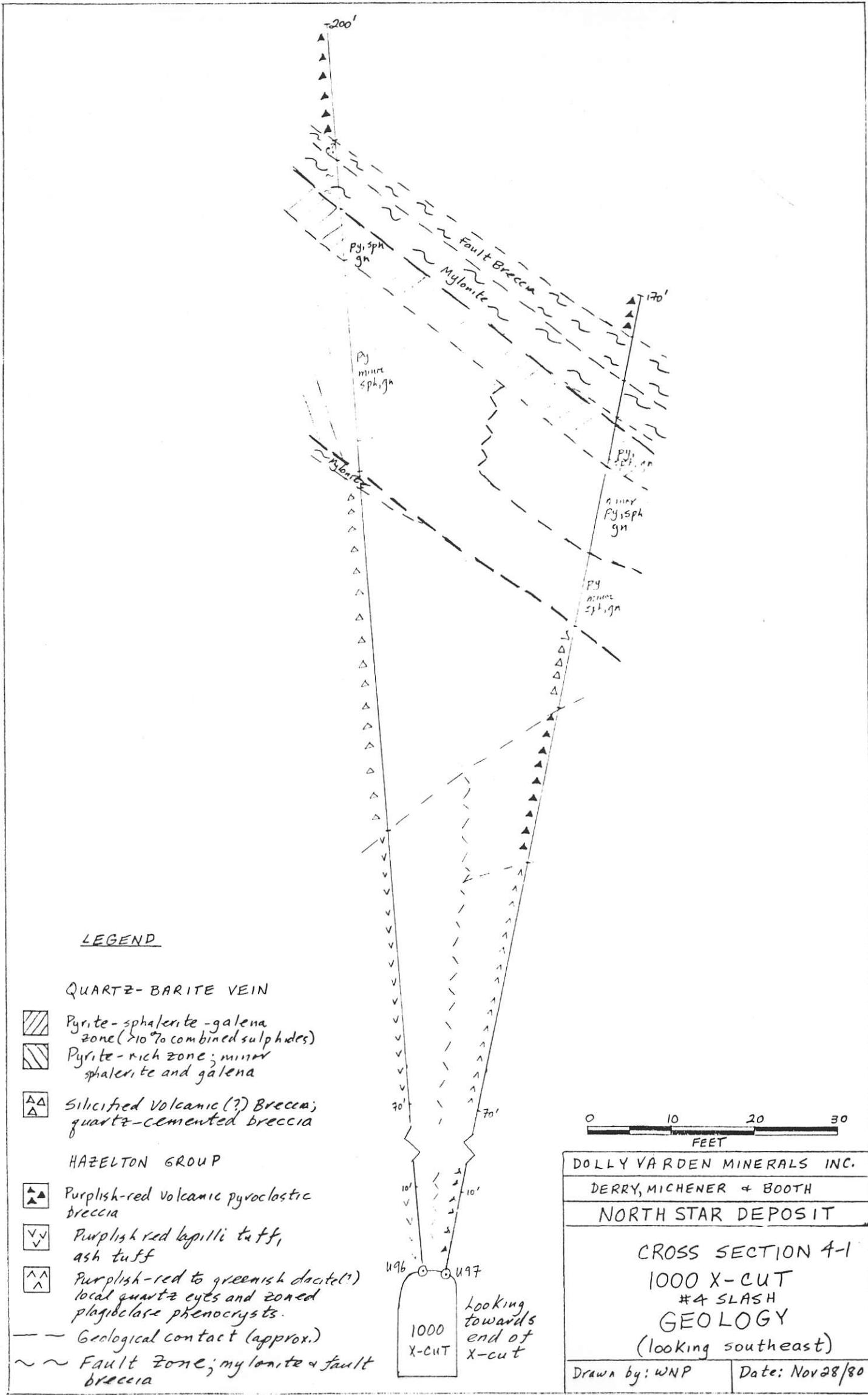

9388 0.01  
9387 0.01  
9386 0.03  
9385 0.01  
9384 0.20  
9383 1.09/0.8'  
9382 6.80/2.6'  
9381 5.90/2.3'  
9380 33.95/4.0  
9379 22.70/1.1  
9378 5.64/3.6'  
9377 3.20/2.0'  
9376 9.30/1.2'  
9375 2.94/2.8'  
9374 0.49/1.5  
9373 0.07/2.0'  
9372 0.46/1.5  
9371 0.20/1.0  
9370 0.01/2.1  
9369 0.01/1.8'

70' 70'  
10' 10'  
496 497

1000 X-CUT

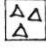

LEGEND

- QUARTZ-BARITE VEIN
-  Pyrite-sphalerite-galena zone (>10% combined sulphides)
  -  Pyrite-rich zone; minor sphalerite and galena
  -  Silicified Volcanic (?) Breccia; quartz-cemented breccia
- HAZELTON GROUP
-  Purplish-red volcanic pyroclastic breccia
  -  Purplish red lapilli tuff, ash tuff
  -  Purplish-red to greenish dacite(?) local quartz eyes and zoned plagioclase phenocrysts.
- Geological contact (approx.)
- ~ ~ Fault Zone; mylonite & fault breccia

0      10      20      30  
FEET

DOLLY VARDEN MINERALS INC.	
DERRY, MICHENER & BOOTH	
NORTH STAR DEPOSIT	
CROSS SECTION 4-1	
1000 X-CUT	
#4 SLASH	
GEOLOGY	
(looking southeast)	
Drawn by: WNP	Date: Nov 28/80

1000 X-CUT  
Looking towards end of X-cut

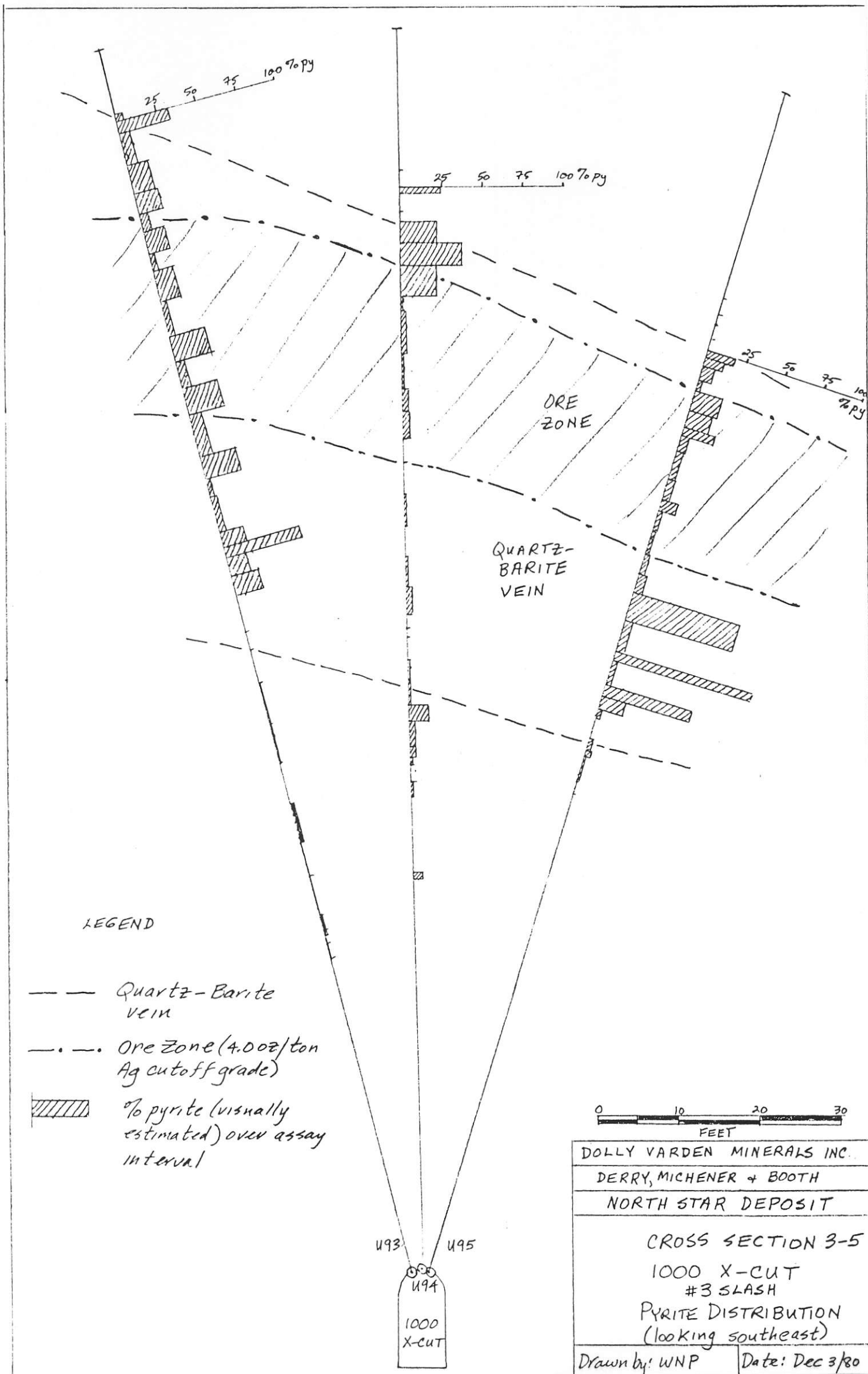

LEGEND

- Quartz-Barite vein
- - - Ore Zone (4.00oz/ton Ag cutoff grade)
- % pyrite (visually estimated) over assay interval



DOLLY VARDEN MINERALS INC.  
DERRY, MICHENER + BOOTH  
NORTH STAR DEPOSIT

CROSS SECTION 3-5  
1000 X-CUT  
#3 SLASH  
PYRITE DISTRIBUTION  
(looking southeast)

Drawn by: WNP Date: Dec 3/80

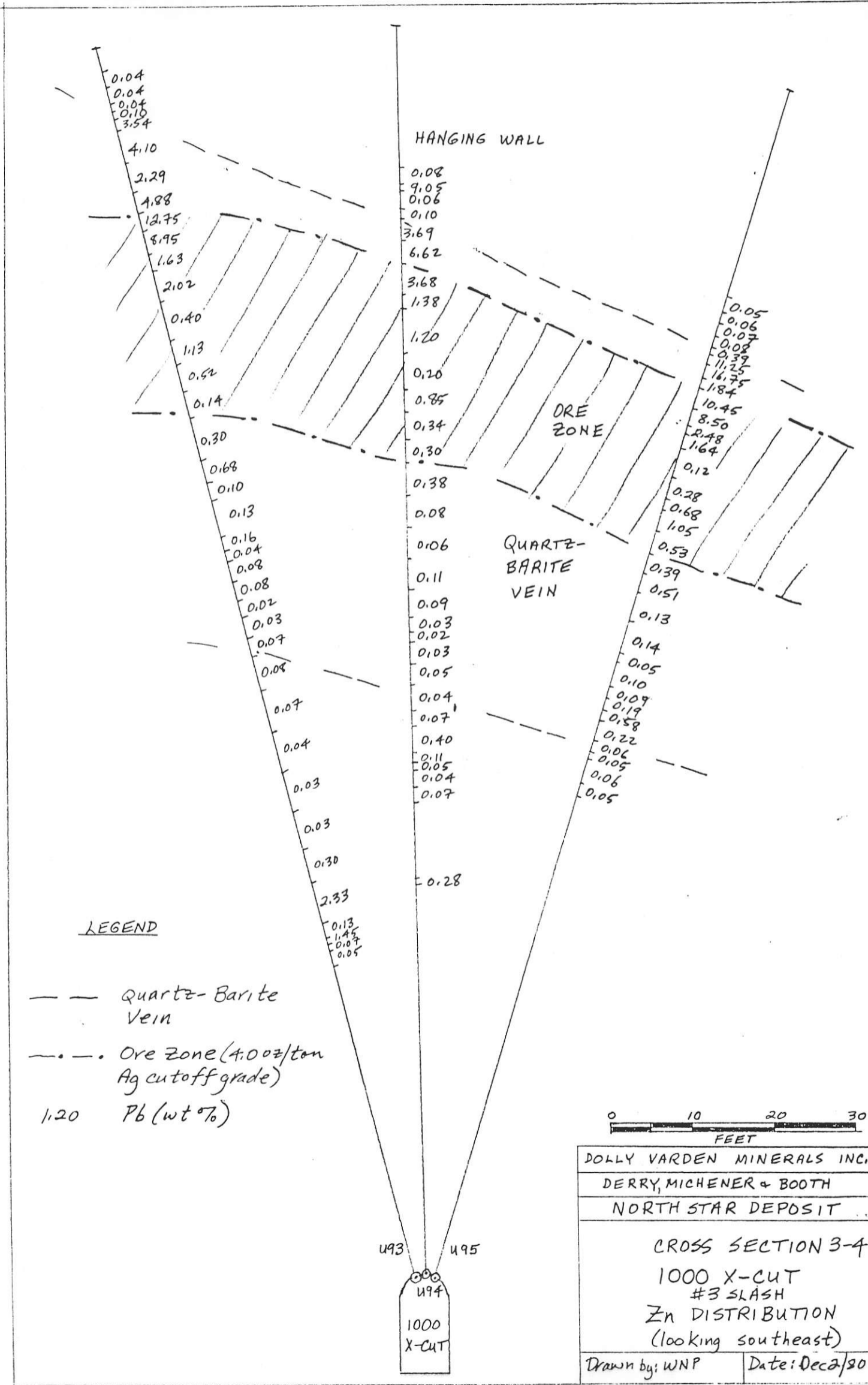



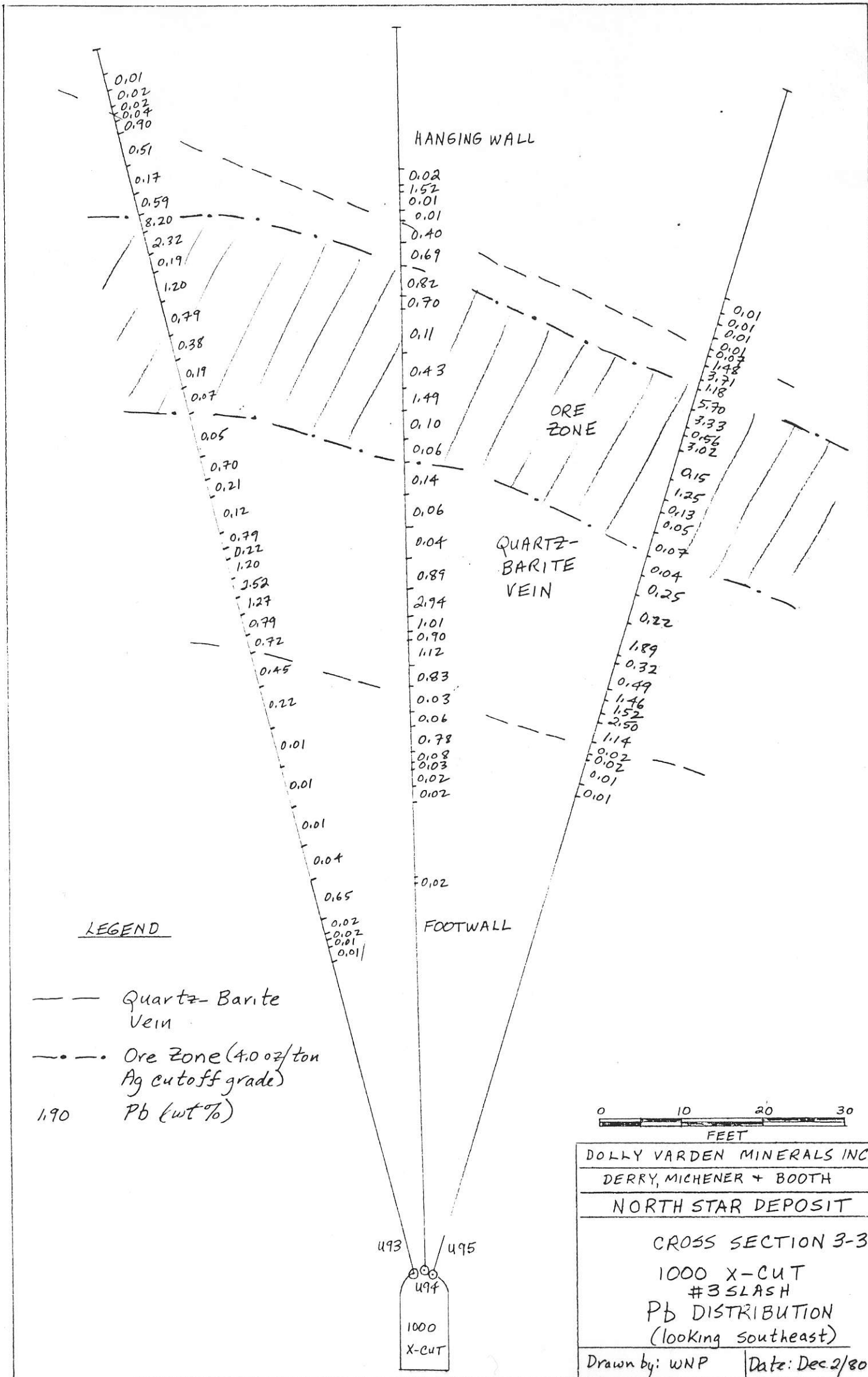

DOLLY VARDEN MINERALS INC.  
 DERRY, MICHENER + BOOTH  
 NORTH STAR DEPOSIT  
 CROSS SECTION 3-3  
 1000 X-CUT  
 #3 SLASH  
 PB DISTRIBUTION  
 (looking southeast)  
 Drawn by: WNP | Date: Dec 2/80

HANSEINGWALL

9277-9306  
40% of 9293

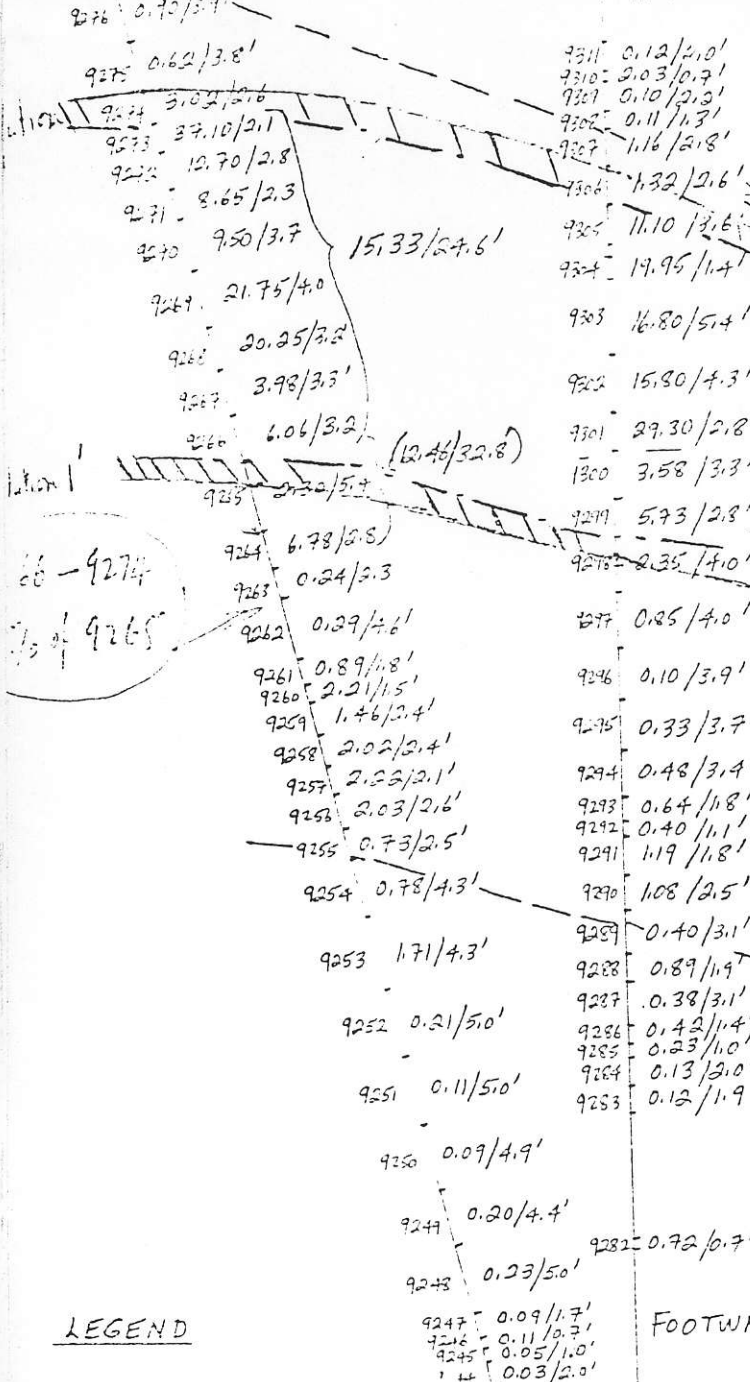

ORE ZONE

QUARTZ-BARITE VEIN

1/2 of 9336  
9326-9335  
1/2 of 9325

LEGEND

- Quartz-Barite Vein
- Ore Zone (4.00 oz/ton Ag cutoff grade)
- 26 Sample no.
- 95/1.4' Ag(oz/ton)/length (feet)

FOOTWALL

Ore Section within Vein



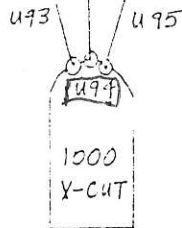

DOLLY VARDEN MINERALS INC.	
DERRY, MICHENER + BOOTH	
NORTH STAR DEPOSIT	
CROSS SECTION 3-2	
1000 X-CUT	
#3 SLASH	
Ag DISTRIBUTION	
(Looking southeast)	
Drawn by: WNP	Date: Nov 28/80

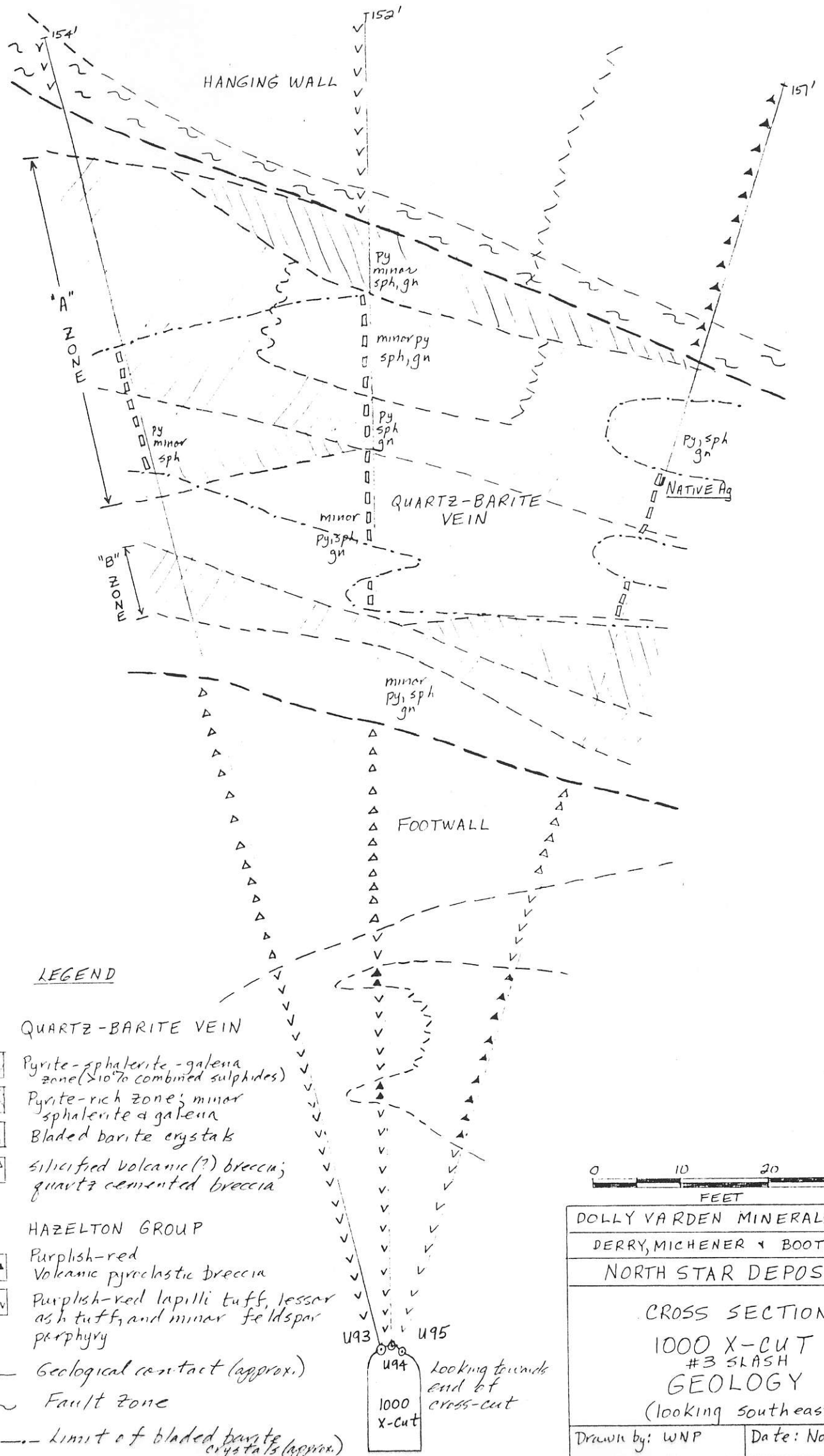



LEGEND

QUARTZ-BARITE VEIN

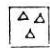
-  Pyrite-sphalerite-galena zone (>10% combined sulphides)
-  Pyrite-rich zone; minor sphalerite & galena
-  Bladed barite crystals
-  silicified volcanic (?) breccia; quartz cemented breccia

HAZELTON GROUP

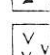
-  Purplish-red volcanic pyroclastic breccia
-  Purplish-red lapilli tuff, lesser ash tuff, and minor feldspar porphyry

- - - Geological contact (approx.)
- ~ ~ ~ Fault zone
- . - . Limit of bladed barite crystals (approx.)



DOLLY YARDEN MINERALS INC.	
DERRY, MICHENER & BOOTH	
NORTH STAR DEPOSIT	
CROSS SECTION 3-1	
1000 X-CUT	
#3 SLASH	
GEOLOGY	
(looking southeast)	
Drawn by: WNP	Date: Nov. 15/80

U93 U95  
U94  
1000 X-cut  
Looking towards end of cross-cut

LEGEND

- ++ Lamprophyre dyke
- QUARTZ ± BARITE ± CALCITE VEIN
- Q = Quartz only    QBx = Quartz breccia
- QB = Quartz-barite
- QC = Quartz-calcite

- △△ silicified Volcanic (?) Breccia (VB<sub>s</sub>); quartz-cemented breccia (VB<sub>Q</sub>)

HAZELTON GROUP

- ▲▲ Purplish-red volcanic pyroclastic breccia (VB)
- ∨∨ Purplish red lapilli tuff (V<sub>LT</sub>); ash tuff (V<sub>AT</sub>)
- ▲▲ Purplish-red to greenish dacite (?); quartz-feldspar porphyry and feldspar porphyry (V<sub>P</sub>)

— Geological contact (approx.)

~ Fault; M = mylonite

| 9.4/55 Ag(oz/ton)/length.

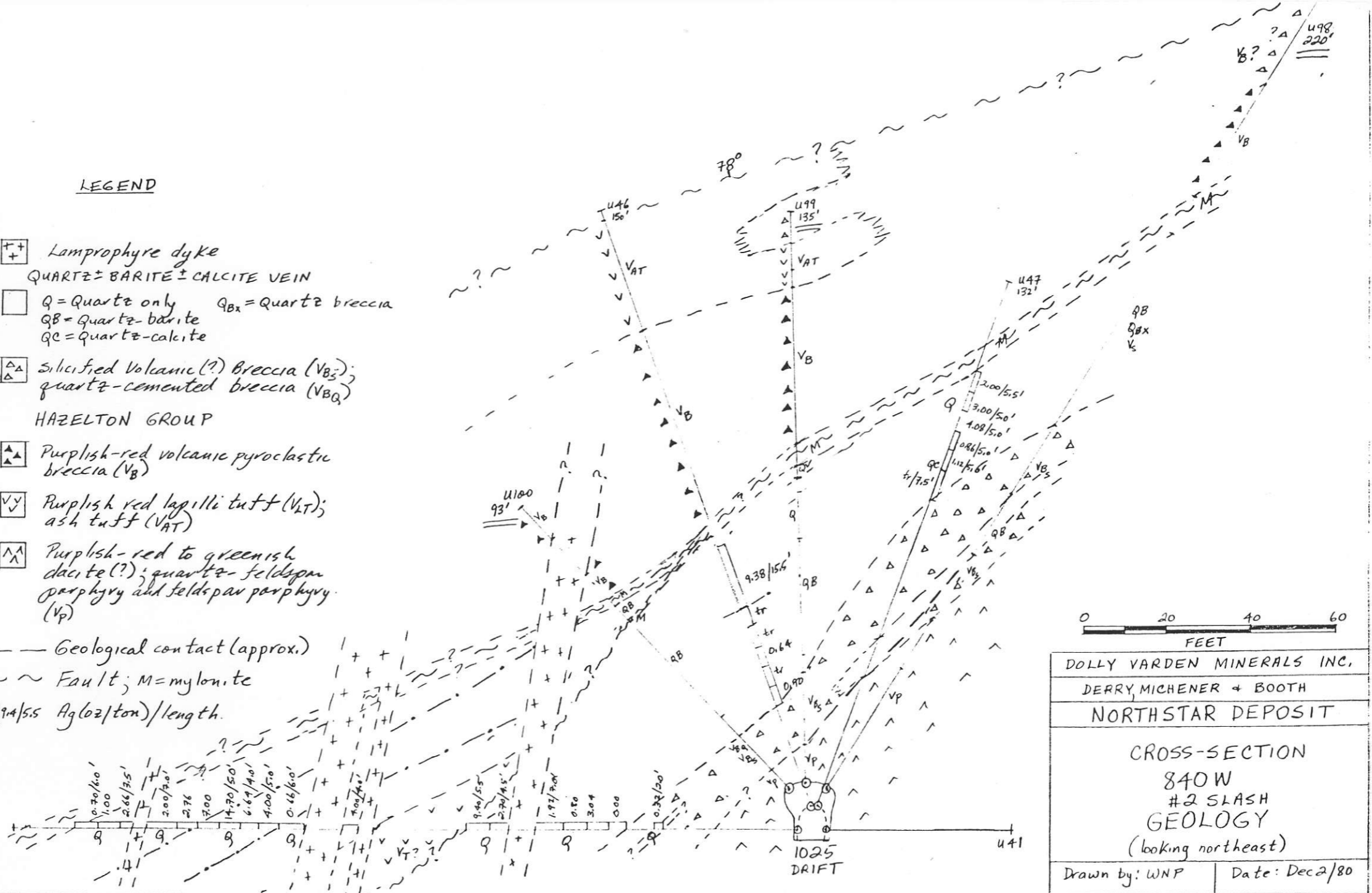

DOLLY VARDEN MINERALS INC.  
 DERRY, MICHENER + BOOTH  
 NORTHSTAR DEPOSIT

CROSS-SECTION  
 840W  
 #2 SLASH  
 GEOLOGY  
 (looking northeast)

Drawn by: WNP    Date: Dec 2/80