

APPROX.  
ASTRO.

CANEX HED CLAIMS.

MAG 16 297900	MAG 15 297899	MAG 13 297897	MAG 14 297898
18 -902	17 -901	11 -895	12 -896
20 -904	19 -903	9 -895	10 -894
22 -906	21 -905	7 -891	8 -892
24 -908	23 -907	5 -889	6 -890
26 -910	25 -909	3 -887	4 -888

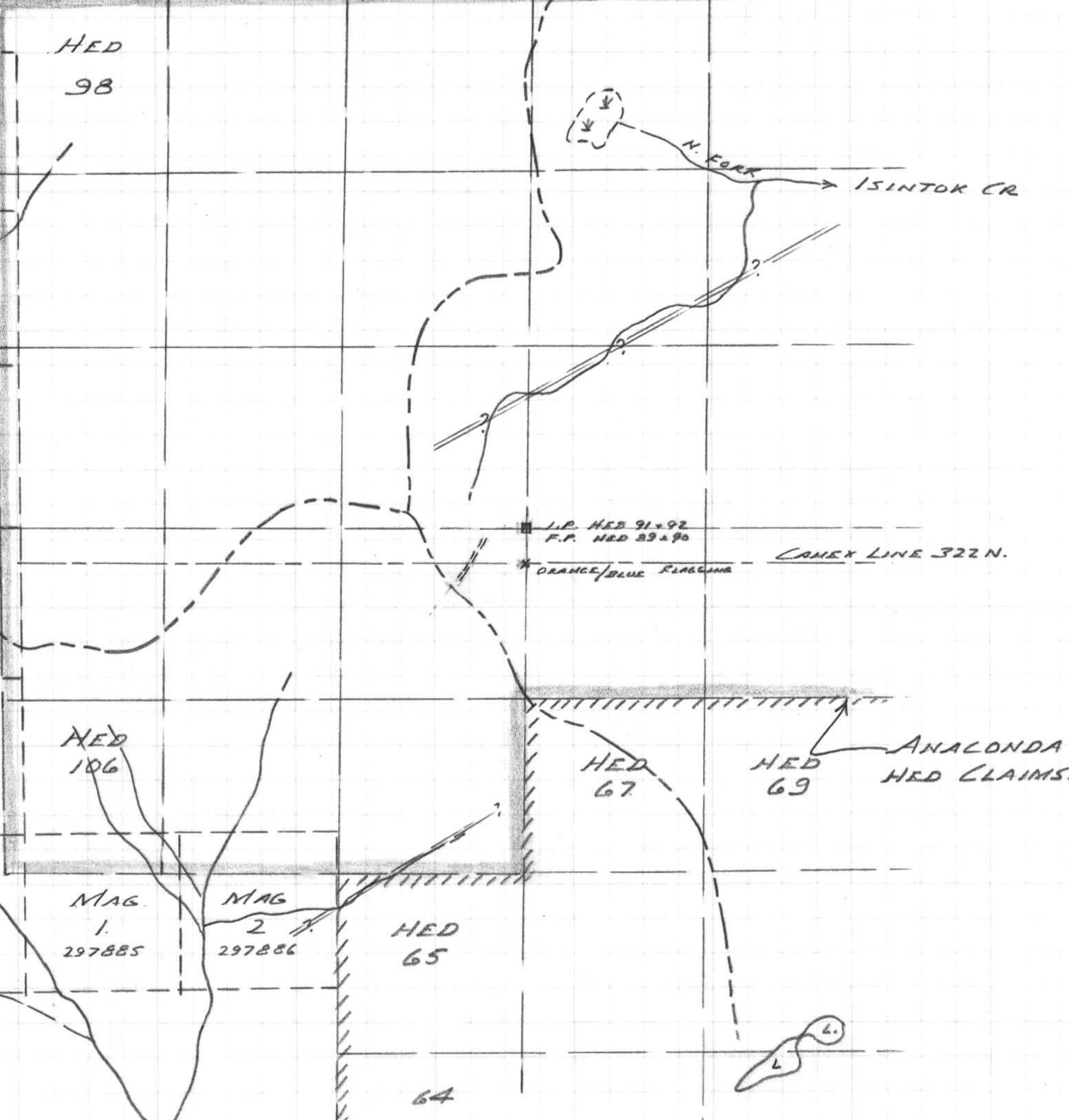

**LEGEND:**

- STREAM.
- LAKE
- SWAMP
- HEIGHT OF LAND LINE
- GLACIAL STAIN w/ DIRECTION OF MOVEMENT.
- PHOTO-LINEAMENT (FAULT?)
- (a), (b), etc. MATCH-POINTS RE. AIR PHOTO & PLANIMETRIC MAP DETAIL

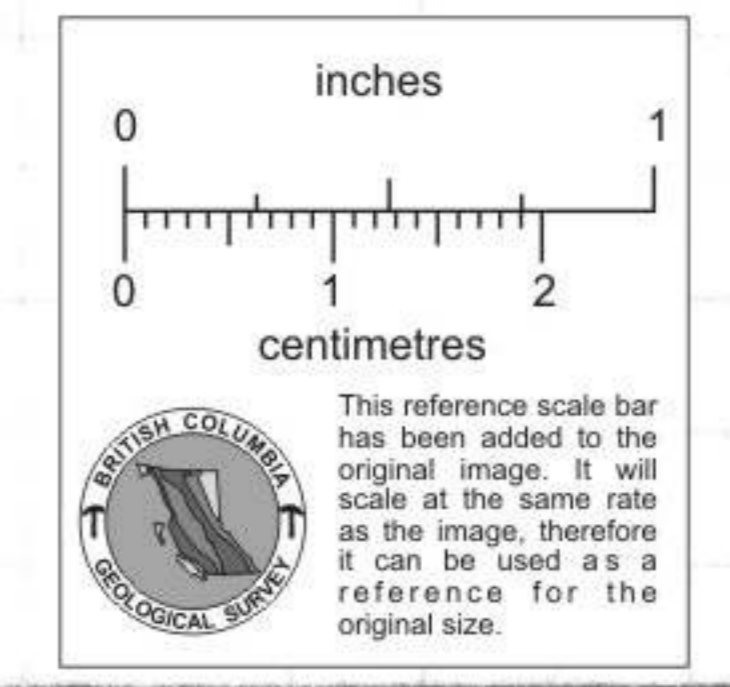

**MAG GROUP # 72-1**  
**REGIONAL TOPOGRAPHY & LINEAMENTS**  
 COMPOSITE BASED ON: MAP 92 H/9 @ 1:50,000  
 MAP 92 H/9 a @ 1" = 1/2 MI.  
 AIR PHOTOS S.C. 9250-247-248-249-250  
 S.C. 9251-10-11-12-13  
 S.C.D.M. MIN. REF. MAPS.  
 SCALE: 1" = 1320' AUG. 2, OCT. 4, 1972  
 W. M. Sharp, P. Eng.

801807