

1600 N

1700 N

1800 N

1900 N

K125

K123 (core destroyed)

4690 * 2 fault
prob out of 10 from 300 x fault extending S.W. through
4690 * 2 X-C (and things like also?)

33° true dip

0.1 0.3 0.5 0.7

Very fine gr.

Silt
mud

4800

4755 Contour

K124 estimated K247

K124

bed (?)

Overbedded
grey brown
ghosts in Cal.
(no sediments!)

Silt
mud

broken gangue
mass beds fault
no red mud in

4690 W. LAT.

col K124

801802

4690 W. LAT
SEC 10, 075 E.

K 123-124-125

KAM-KOTIA

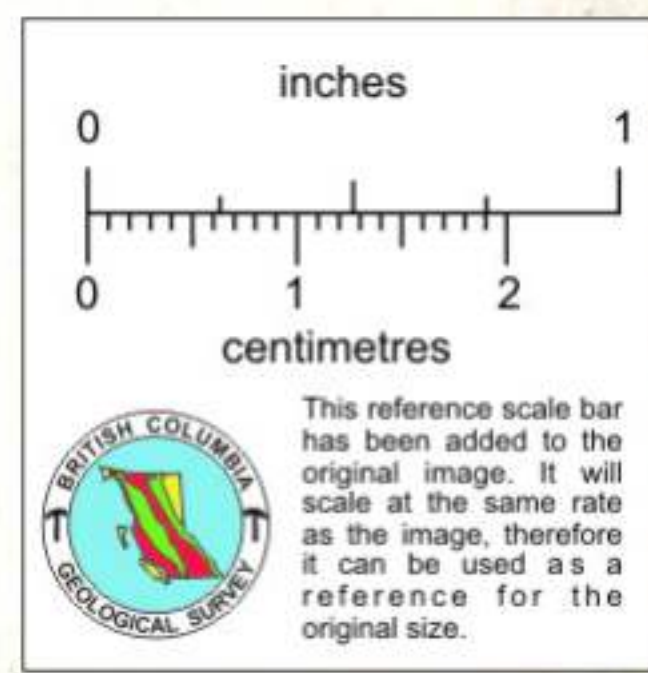

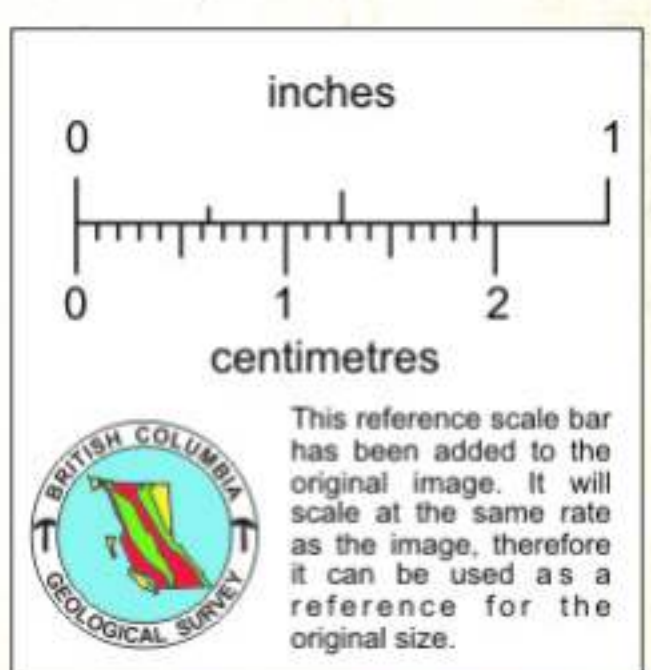
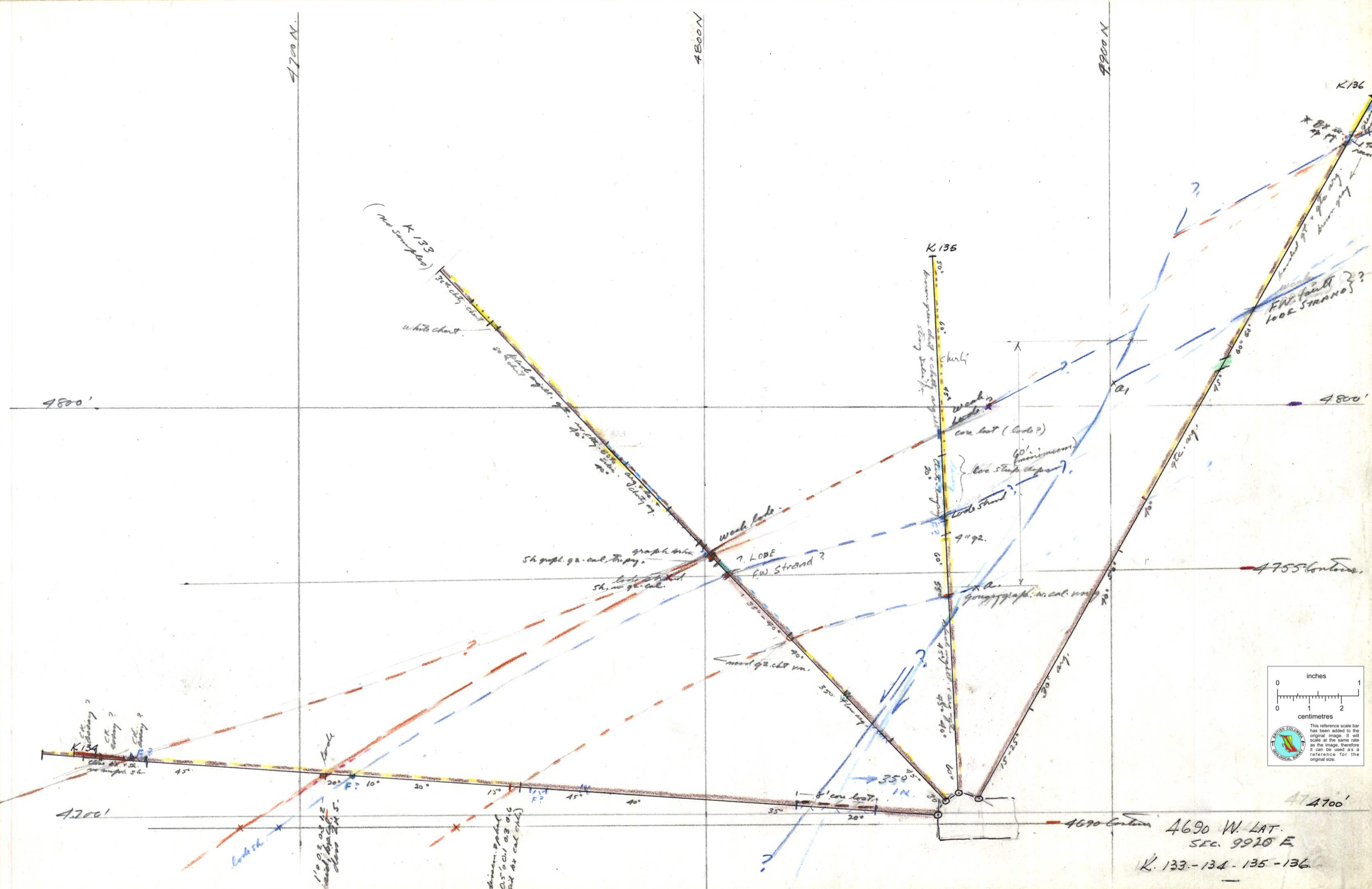

474700'
 4690 W. LAT.
 SEC. 9920 E
 K. 133-134-135-136

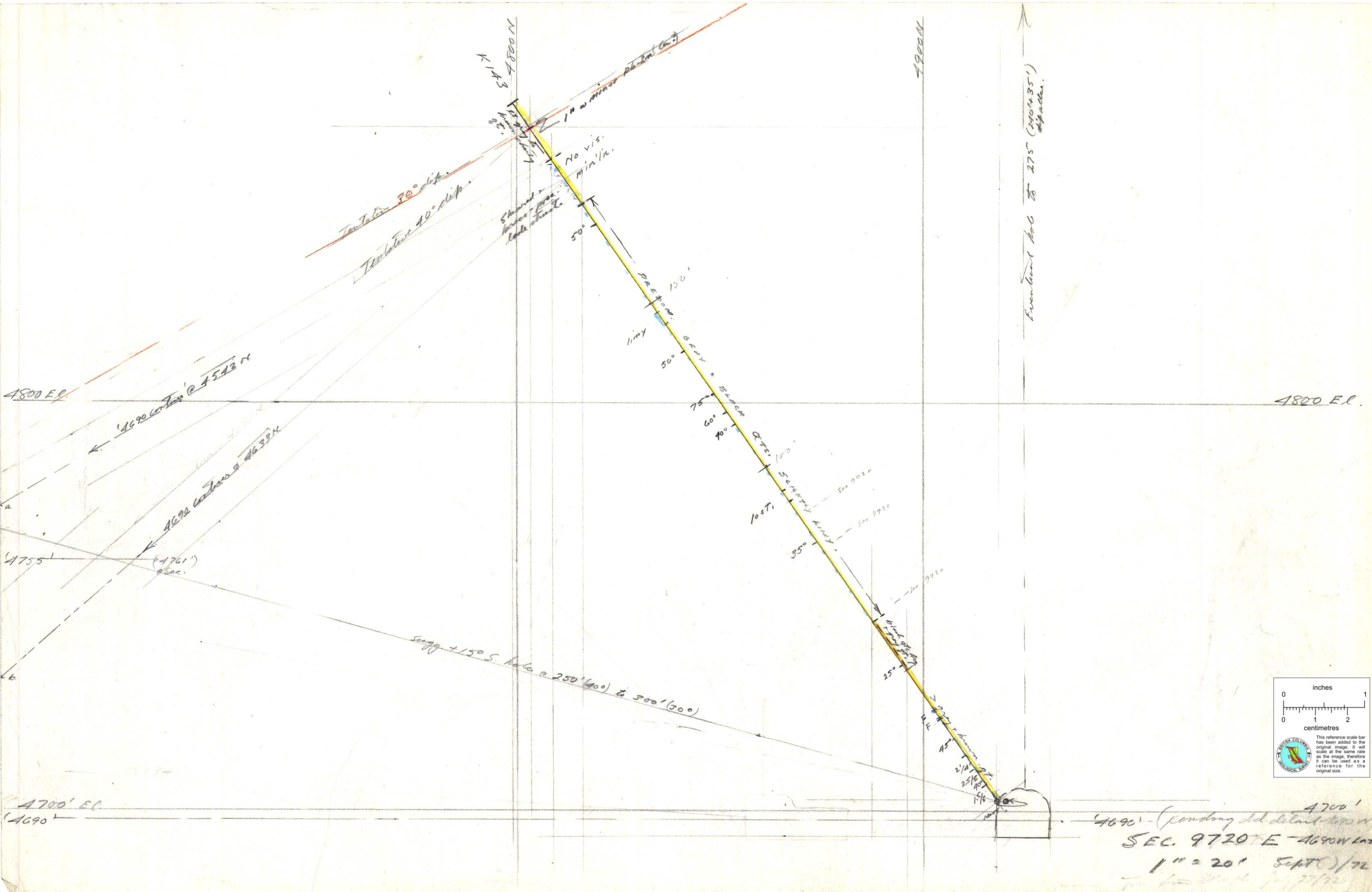

Estimated bog at 27° (40+35') dip.

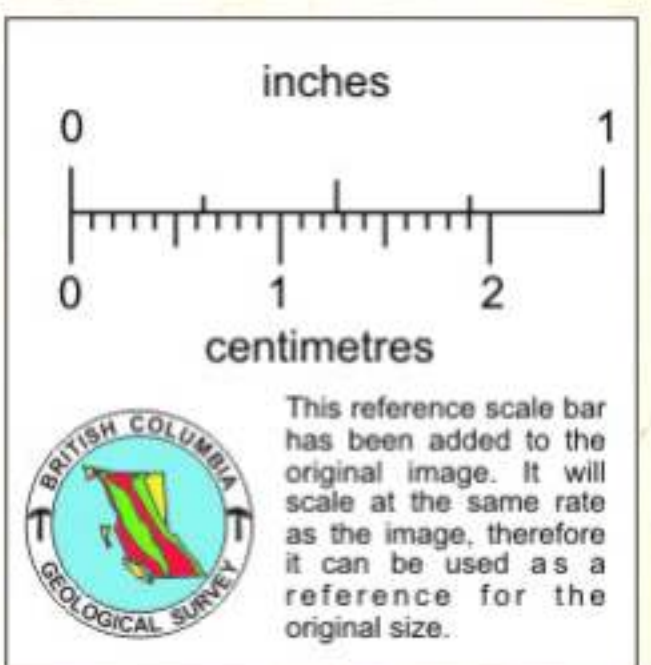

4700'
(4690') (pending detail) 4700'
SEC. 9720 E - 4690 W LOT
1" = 20' Sept 1972
Tom [unclear] July 23/72