

Box 1179,
Merritt, B. C.

4 December 1967.

Mr. F. A. McGonigle,
Consolidated Skeena Mines Ltd.,
716 - 602 W. Hastings St.,
Vancouver 2, B. C.

*Prop not yet assigned
to any one Company
or group; Dec 21/67.*

Dear Mr. McGonigle,

Inspection Report on J W Group of Mr. Art Smith
Copper Prospect.

A brief inspection was made of the J W Group of mineral claims on October 29, 1967. Mr. Art Smith was accompanying.

The Group consists of four claims, J W 3, 4, 5, and 6, owned by Mr. Art Smith of Wells, B. C.

The claims are situated 4 miles South of the Mamit Lake - Lac LaJeune road, from a point 9 miles East of the Mamit Lake road. They are in the headwaters of Quenville Creek, at 4700 ft. elevation, and are accessible by road.

Depth of overburden varies, but probably averages 3 or 4 feet, with deeper moraine ridges. There are numerous outcroppings in the area.

On the J W claims, the rock is diorite, and is probably a stock.

One trench on a shear striking S 70 E and dipping steep to the South was inspected. This was about two feet wide and mineralized with pyrite, sparse chalcopryrite and bornite.

Rubeanic tests on soil samples taken have shown good values. These are being sent in for laboratory tests for verification.

One - half mile to the North, the E - W fracturing is predominant in red-purple vesicular flows.

Copper mineralization was observed in one deep cut, apparently made from production around an old shaft. Trenching and drilling was done over a wide area by Dunmore Mining around 1956.

There was reported magnetite and copper mineralization at a point 2 miles North of the J W claims, as well.

The Dunmore Mining property is described in the Geological Survey Memoir 249, page 126 (54).

The accompanying sketch shows the location and the Geo-Chem reconnaissance done during the visit.

Preliminary rubebanic results suggest parallel structures to that seen during the visit.

Respectfully submitted,

Yours truly,

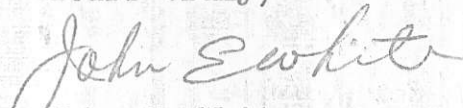
John E. White.

cc Mr. W. M. Sharp
Mr. Art Smith.

encl.

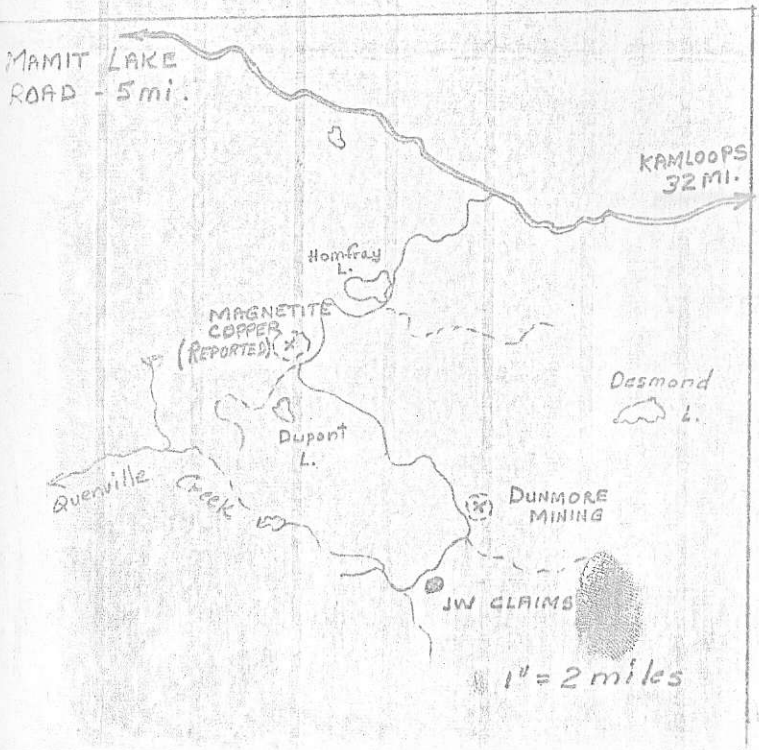
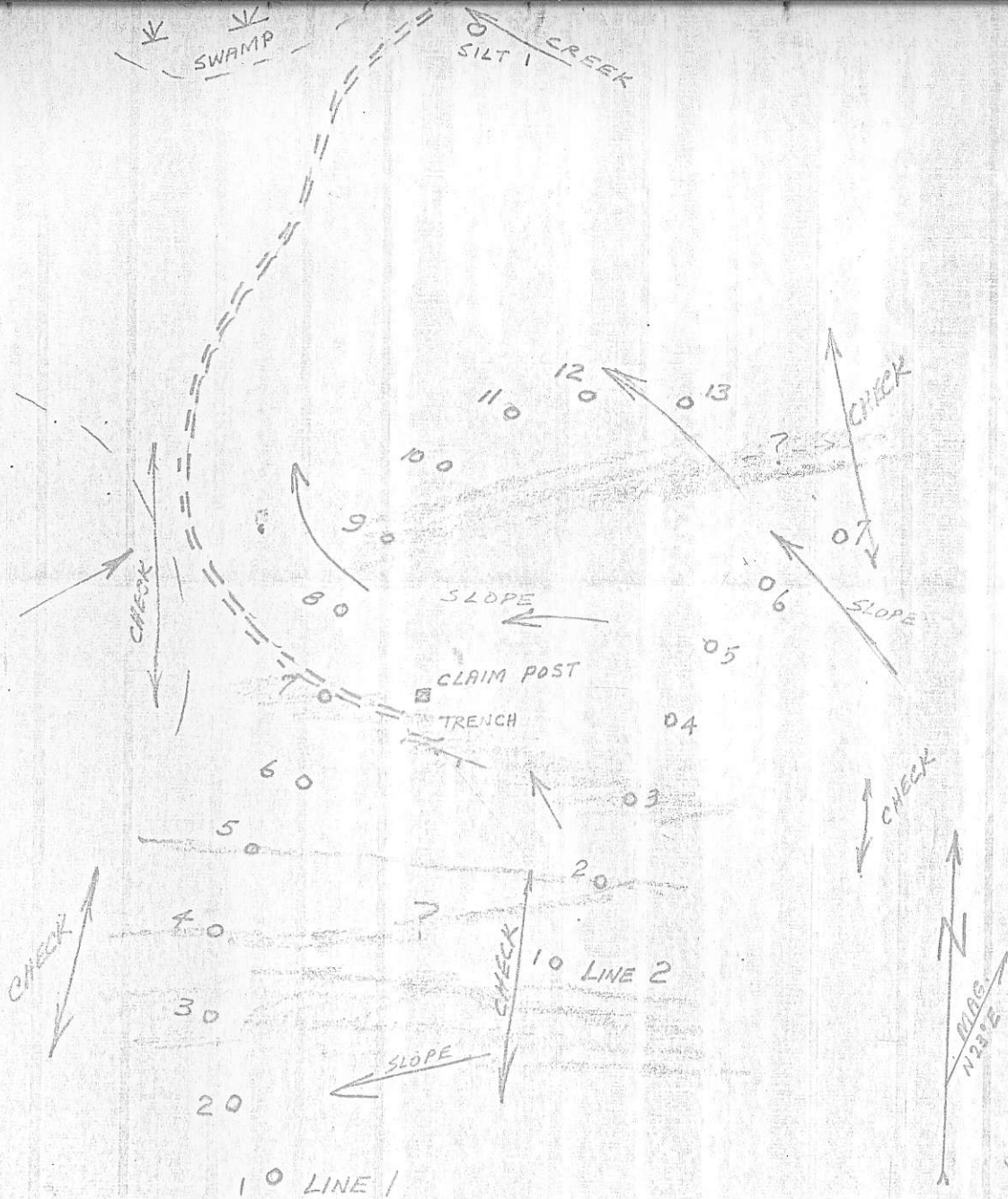

SKETCH MAP
JW CLAIMS

GEO-CHEM RECCE.

SCALE: 1" = 40' DEC. 1967

John E. White

— Preliminary rubebanic anomalies and check areas for follow-up and for trenching.

Laboratory tests pending