

Claims must be tied by direction and distance to at least one, preferably more than one, topographical feature, or to a land lot, section, township, or other recognizable point on printed maps of the district. Relationship of previously located claims should also be shown.

N.B. — The sketch for a group of claims may be placed on one affidavit.

May 12/69

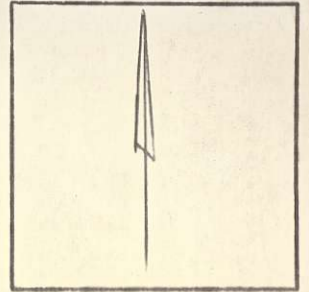

INDICATE NORTH (True or Magnetic)

Paid P. Wyssen \$250.⁰⁰
for staking and registering
14 claims - (w. done up - keep
& revision by Mr. Weber!)

P. Wyssen 'inherited' main
Group from Basil

STANANUMS R.

Top Note

Mt. Baldwin

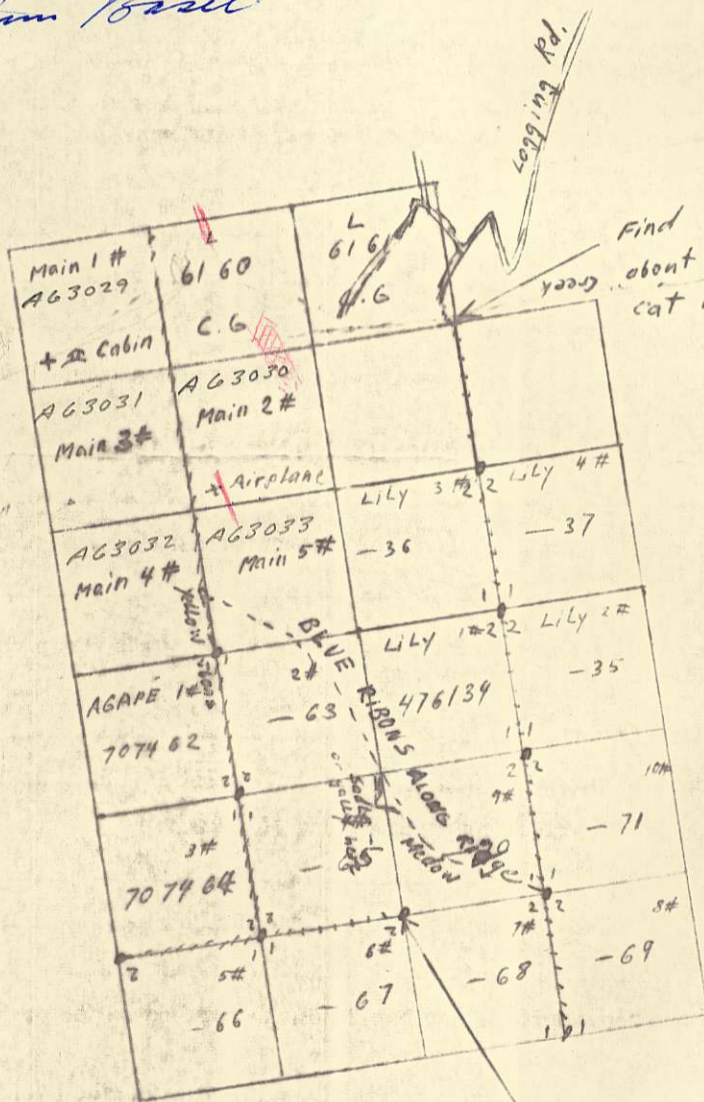

Find Blue and yellow ribbons
about 200 yards
from Main Rd. on
cat road

Raffuse Cr.

R. N. A. I. C. H. I. N.

Post on Meadow before top off Ridge.
well mark with yellow ribbons plus blase

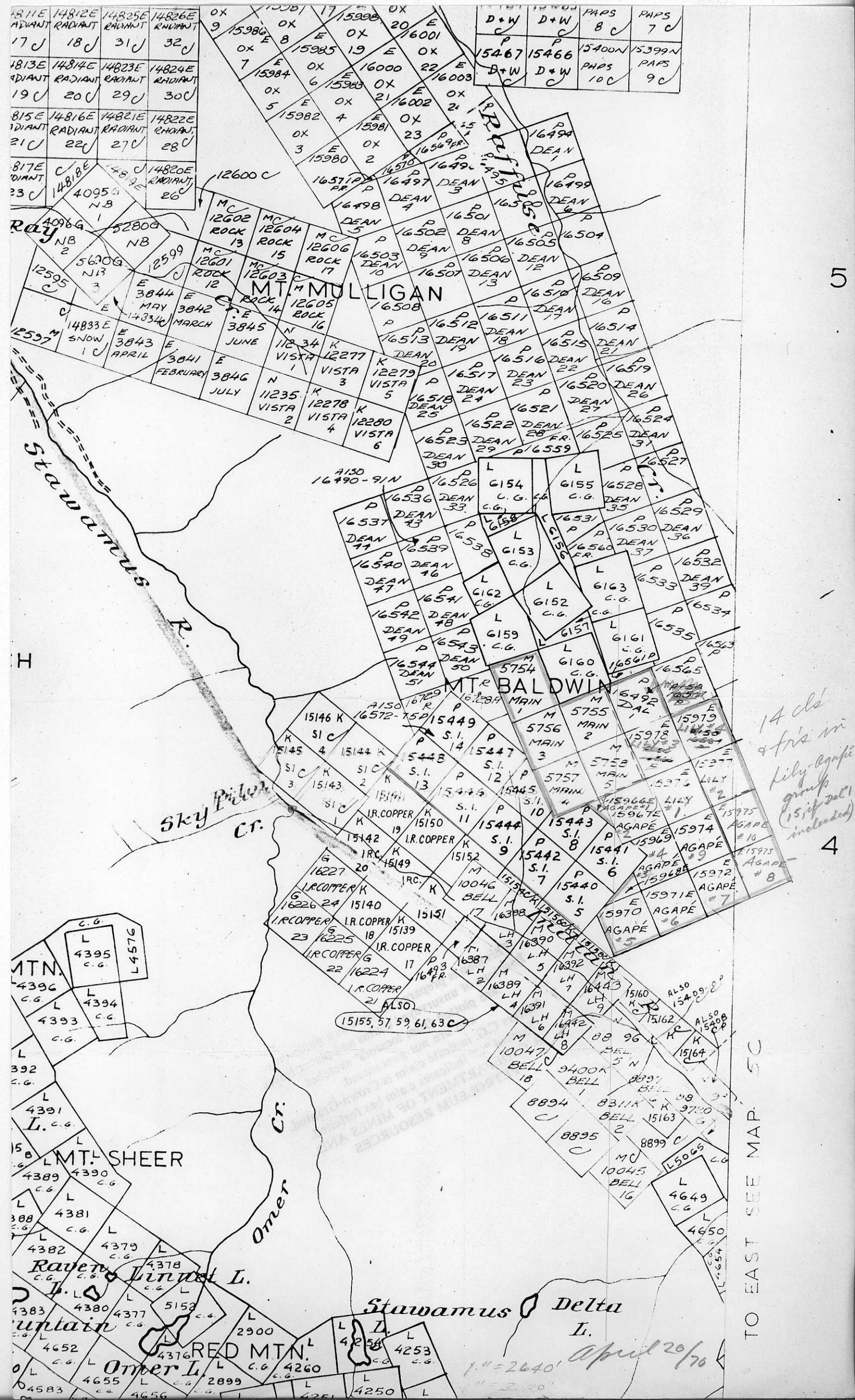

14811E RADIANT 17C	14812E RADIANT 18C	14825E RADIANT 31C	14826E RADIANT 32C
14813E RADIANT 19C	14814E RADIANT 20C	14823E RADIANT 29C	14824E RADIANT 30C
14815E RADIANT 21C	14816E RADIANT 22C	14821E RADIANT 27C	14822E RADIANT 28C
14817E RADIANT 23C	14818E RADIANT 24C	14820E RADIANT 26C	

D+W C	D+W C	PAPS 8C	PAPS 7C
15467 D+W C	15466 D+W C	15400N PAPS 10C	15399N PAPS 9C

4096G NB 2	5280G NB 1	5630G NB 3	2599 C
12595 C	14833E SNOW 1C	3843 E APRIL	3844 E MAY
14834E SNOW 1C	3843 E APRIL	3844 E MAY	3842 E MARCH
3841 E FEBRUARY	3846 E JULY	11834 K VISTA	12277 K VISTA

12600C	12602 MC ROCK 13	12604 MC ROCK 15	12606 MC ROCK 17	12603 MC ROCK 12	12605 MC ROCK 14	12606 MC ROCK 16	12607 MC ROCK 18
12608 MC ROCK 19	12609 MC ROCK 20	12610 MC ROCK 21	12611 MC ROCK 22	12612 MC ROCK 23	12613 MC ROCK 24	12614 MC ROCK 25	12615 MC ROCK 26

16490-91N A150	16526 DEAN 33	16537 DEAN 43	16538 DEAN 44	16539 DEAN 45	16540 DEAN 46	16541 DEAN 47	16542 DEAN 48	16543 DEAN 49	16544 DEAN 50	16545 DEAN 51
16527 DEAN 32	16528 DEAN 34	16529 DEAN 35	16530 DEAN 36	16531 DEAN 37	16532 DEAN 38	16533 DEAN 39	16534 DEAN 40	16535 DEAN 41	16536 DEAN 42	16537 DEAN 43

15146 K SIC	15145 K SIC	15144 K SIC	15143 K SIC	15142 K SIC	15141 K SIC	15140 K SIC	15139 K SIC	15138 K SIC	15137 K SIC	15136 K SIC
15135 K SIC	15134 K SIC	15133 K SIC	15132 K SIC	15131 K SIC	15130 K SIC	15129 K SIC	15128 K SIC	15127 K SIC	15126 K SIC	15125 K SIC

4396 C.G.	4395 C.G.	4394 C.G.	4393 C.G.
4392 C.G.	4391 C.G.	4390 C.G.	4389 C.G.
4388 C.G.	4387 C.G.	4386 C.G.	4385 C.G.
4384 C.G.	4383 C.G.	4382 C.G.	4381 C.G.

4380 C.G.	4379 C.G.	4378 C.G.	4377 C.G.
4376 C.G.	4375 C.G.	4374 C.G.	4373 C.G.
4372 C.G.	4371 C.G.	4370 C.G.	4369 C.G.
4368 C.G.	4367 C.G.	4366 C.G.	4365 C.G.

15155, 57, 59, 61, 63C	15151 K IR. COPPER	15150 K IR. COPPER	15149 K IR. COPPER	15148 K IR. COPPER	15147 K IR. COPPER	15146 K IR. COPPER	15145 K IR. COPPER	15144 K IR. COPPER	15143 K IR. COPPER	15142 K IR. COPPER
15141 K IR. COPPER	15140 K IR. COPPER	15139 K IR. COPPER	15138 K IR. COPPER	15137 K IR. COPPER	15136 K IR. COPPER	15135 K IR. COPPER	15134 K IR. COPPER	15133 K IR. COPPER	15132 K IR. COPPER	15131 K IR. COPPER

TO EAST SEE MAP 5C

April 20/70

5

4

171-W- Esplanade Ave.,
North Van., B.C.

801487

April 18/70

Dear Al:

I hope you don't mind my returning
the enclosed to you, with some suggestions
for a revised statement that would fit
into my field days, and also include
a daily rate that would probably be more
readily accepted by the Dept. of Mines.

Received April 23/70

If you could write up a statement
similar to the one enclosed, I think it
would be more suitable to include with
my geol. geochem report for assessment credits.

However, if the enclosed would not appear
to fit the facts make the necessary changes.

Hoping you can return this at high
velocity!

Best regards to yourself & Tillie.

Bill Sharp.

P.S. Encl. also your copy of the letter from J. Egdell
dated Dec. 10/69

(Copy of letter forwarded by A. Shumko)
Dept. of Mines & Petrol Resources -

Mr. Bert Christensen
6241 Halifax St.,
Burnaby, B.C.

"Dec. 10, 1969"

Dear Sir:

Re: Vancouver Mining Division
Contravened Sect. 12, Mineral Act.

This is to advise that according to the maps and records in this office, it appears that you have contravened Sect. 12 of the Mineral Act by locating:

- (1) "Dean Nos 57-59", Rec. Nos 16564 and 566 located Nov. 6/69 (Recorded Nov. 17/69) over the same ground located and recorded May 12/69 by Peter Wyssen, Box 493, Squamish, B.C. as the "Lilly", Rec. Nos 15978-15979, mineral claims.
- (2) "Dean No. 60" Rec. No. 16567, loc. Nov. 6/69 (rec. Nov. 17/69) over the same ground located and recorded Aug. 3/69 by A. Shumko, Box 254, Squamish B.C. as the "Dol. No. 1", Rec. No. 16492, mineral claim.
- (3) Dean 61-64, Record Nos 16572-575, loc. Nov. 6/69 (recorded Nov. 19, 1969) over the same ground recorded Nov. 21/68 by Bill Demmitt, R.R. #2, Hope, B.C. as the S.I. Nos 9-14, Rec. Nos 15444-4499 mineral claims.

Yours very truly,

J. Egdell,
Gold Comm.

cc. Peter Wyssen.
A. Shumko
Bill Demmitt
Chief Gold Comm., Victoria, B.C.

Footnote: A. Shumko notes "The present claim maps are wrong, as they show Dean(?) owning some of our claims."