

Loc 15 627856 28/11/65 14/12/65	Loc 13 627854 28/11/65 14/12/65	Loc 11 627852 28/11/65 14/12/65	Loc 9 627850 28/11/65 14/12/65	Reg 20 627849 20/11/65 7/12/65	Reg 19 627848 20/11/65 7/12/65	Reg 12 488972 11/11/65 24/11/65	Reg 11 488971 11/11/65 24/11/65	Loc 6 627843 15/11/65 1/12/65	Loc 5 627842 15/11/65 1/12/65
Loc 16 627859 "	Loc 14 627855 "	Loc 12 627853 "	Loc 10 627851 "	Reg 18 627847 "	Reg 17 627846 "	Reg 10 448792 "	Reg 9 448793 "	Loc 4 627841 "	Loc 3 627840 "
Loc 20 627864 27/11/65 14/12/65	Loc 17 627858 27/11/65 14/12/65	Reg 15 627836 13/11/65 29/11/65	Reg 13 627834 13/11/65 29/11/65	Reg 2 488968 30/10/65 16/11/65	Reg 1 488967 30/10/65 16/11/65	Reg 5 627831 6/11/65 22/11/65	Reg 8 627833 6/11/65 22/11/65	Loc 2 627839 15/11/65 1/12/65	Loc 1 627838 15/11/65 1/12/65
Loc 20 627864 27/11/65 14/12/65	Loc 18 627859 27/11/65 14/12/65	Reg 16 627837 13/11/65 29/11/65	Reg 14 627835 13/11/65 29/11/65	Reg 3 488969 30/10/65 16/11/65	Reg 4 488970 30/10/65 16/11/65	Reg 6 627830 6/11/65 22/11/65	Reg 7 627832 6/11/65 22/11/65	Loc 7 627844 15/11/65 1/12/65	Loc 8 627845 15/11/65 1/12/65

West Post #1+2
in Loc 9-16

NOE ↑

252°
approx. sea in v. 50' water
N80W. ←

12 witness post

Dist to 7000' from I.P.'s

Problems summer 65
located photo fall, 1965

Recorded - Skeene M.D.; Photos Report
Coast District

16/11/65
14/12/65

801407

Reg 0 Loc 4C
to Final
Anderson Reg. 8/66

to report
FIG 2

Box #1 Showing.

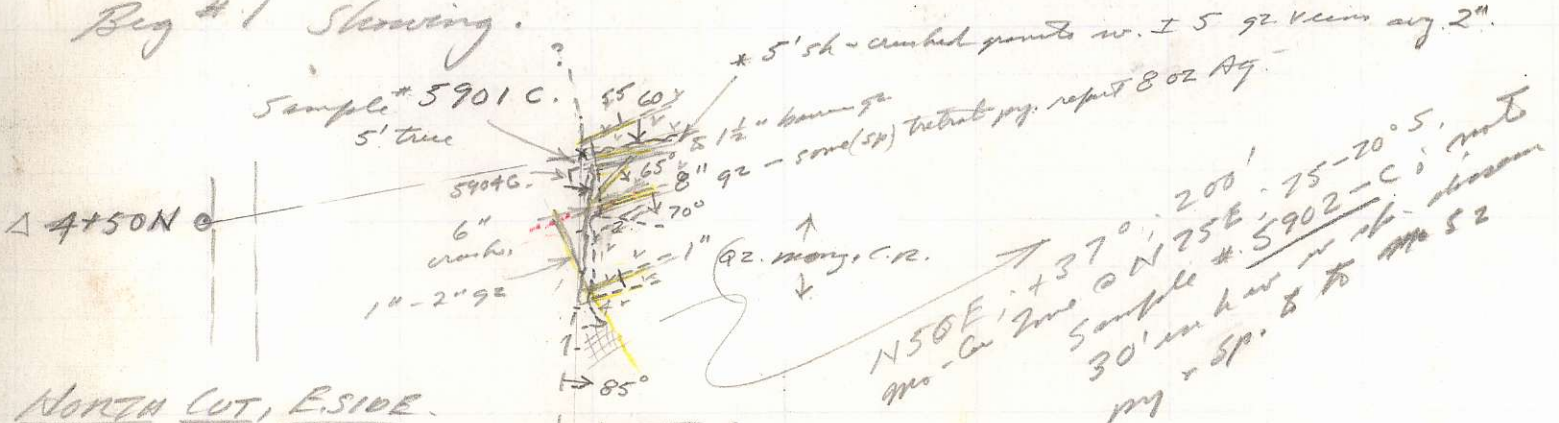

NORTH CUT, E. SIDE.
OP ROAD Aug 8/66 - Plotted

Main Showings @ EL 1790'
 Better mos2 assemblages & results in small qz veins; with
 layer piece white bull qz are essentially barren. Pract. net
 spacing from $\frac{3}{4}$ " & greater, note high grade peti ment'ln has
 very sp. assoc py. 10' d/s = 5.5. #5.

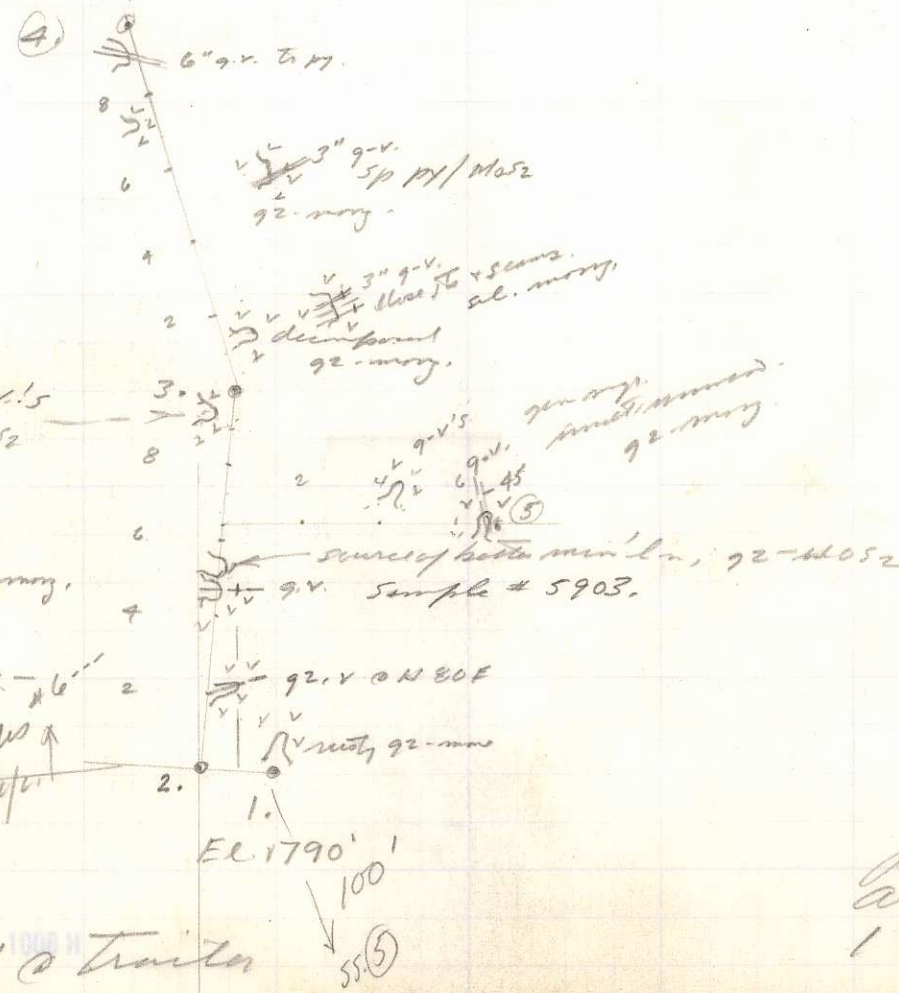

to report
Fig 3.
Principal QUARTZ
- MOS2 EXPOSURE.
2 SOIL SAMPLES.
leave room
for d/s
soil samples

Reg Jc
Aug 8 - 9/66
1" 50'

EL # 800' @ tractor 55(5)

To report
FIG. 2

Reg #4 N. Sluicing

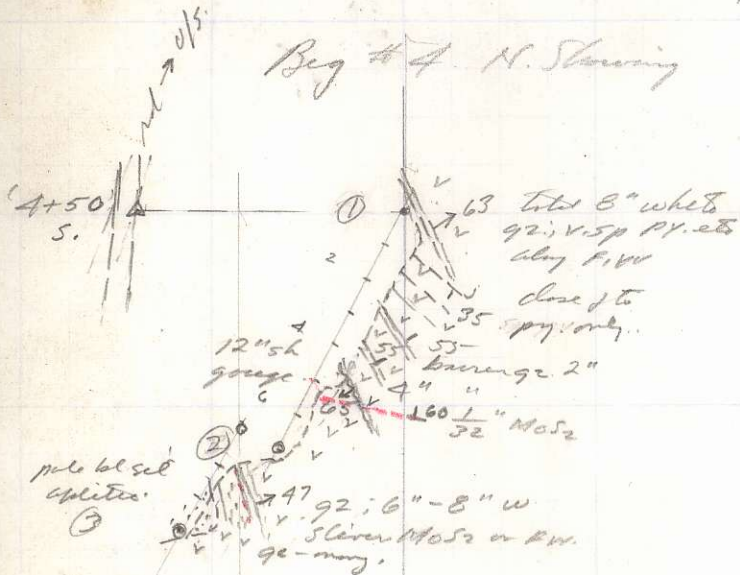

Plotted

Reg #4 South Sluicing



Plotted

S. S. Big - Joe

PHONE: MUTUAL 5-5821

File No. 272163/166

CERTIFICATE OF ASSAY

J. R. WILLIAMS & SON LTD.

PROVINCIAL ASSAYERS AND CHEMISTS

Office and Laboratory:

580 Nelson Street, Vancouver 2, B. C.

I Hereby Certify that the following are the results of assays made by me upon samples of Ore herein described and received from Mr. W. M. Sharp August 18th 19 66.

Table with columns: MARKED, GOLD (Ounces Per Ton, Value Per Ton), SILVER (Ounces Per Ton, Value Per Ton), Copper (Per Cent., Value Per Ton), MoS2 (Per Cent., Value Per Ton), GROSS TOTAL VALUE (2000 lbs. Per Ton). Rows include samples 5901 C, 5902 C, 5903 C, and 5904 C.

Gold calculated at \$.....per ounce.

Silver calculated at.....cents per ounce.

Calculated at.....cents per lb.

Calculated at.....cents per lb.

Calculated at.....cents per lb.

NOTE—Pulps of Samples retained 2 months from date of Receipt. Rejects 1 week unless otherwise instructed.

Signature of Provincial Assayer

T

S

L

Laboratories Limited

325 HOWE STREET - VANCOUVER 1, B.C.

TELEPHONE 684-1374

ASSAYERS
CHEMISTS
GEOCHEMISTS

CERTIFICATE OF ANALYSIS

SAMPLE(S) FROM **Mr. William M. Sharp**

REPORT NO.

V0906-1

SAMPLE(S) OF **SOIL**

RESULTS IN PARTS PER MILLION

note: - not
MoS2

	SAMPLE No	Cu	Pb	Zn	Ag	Ni	Mo	Perfluor Car
1	BJ #1						10	nil
2	2						20	"
3	3						160	"
4	4						160	trace
5	5						40	"
6	6						105	"
7	7						60	"
8	8						225	"
9	9						70	nil
10	10						115	"
11	11						20	"
12								
13		Hot HCl extraction						
14		Mo determined by dithionite method						
15		colorimetric, with titration or higher						
16		Mo concns, using dithionite						
17								
18								
19								
20								
21								
22								
23								
24								

DATE

Aug 17/66

SIGNED

DIVISION OF TECHNICAL SERVICE LABORATORIES

