

11

MINOTERIN SPECIMENS  
TO BE DEPOSITED AT THE U.S. GEOLOGICAL SURVEY  
WASHINGTON, D.C. IMMEDIATELY UPON RECEIPT  
AND TO BE KEPT IN THE U.S. GEOLOGICAL SURVEY  
MUSEUM OF NATURAL HISTORY, WASHINGTON, D.C.  
THE U.S. GEOLOGICAL SURVEY WILL BE RESPONSIBLE  
FOR THE PROTECTION OF THESE SPECIMENS

See for report stony strata @ N 45-60 W,  
Page 130; same 223.  
Zone to med-gr. granite stock

WEST

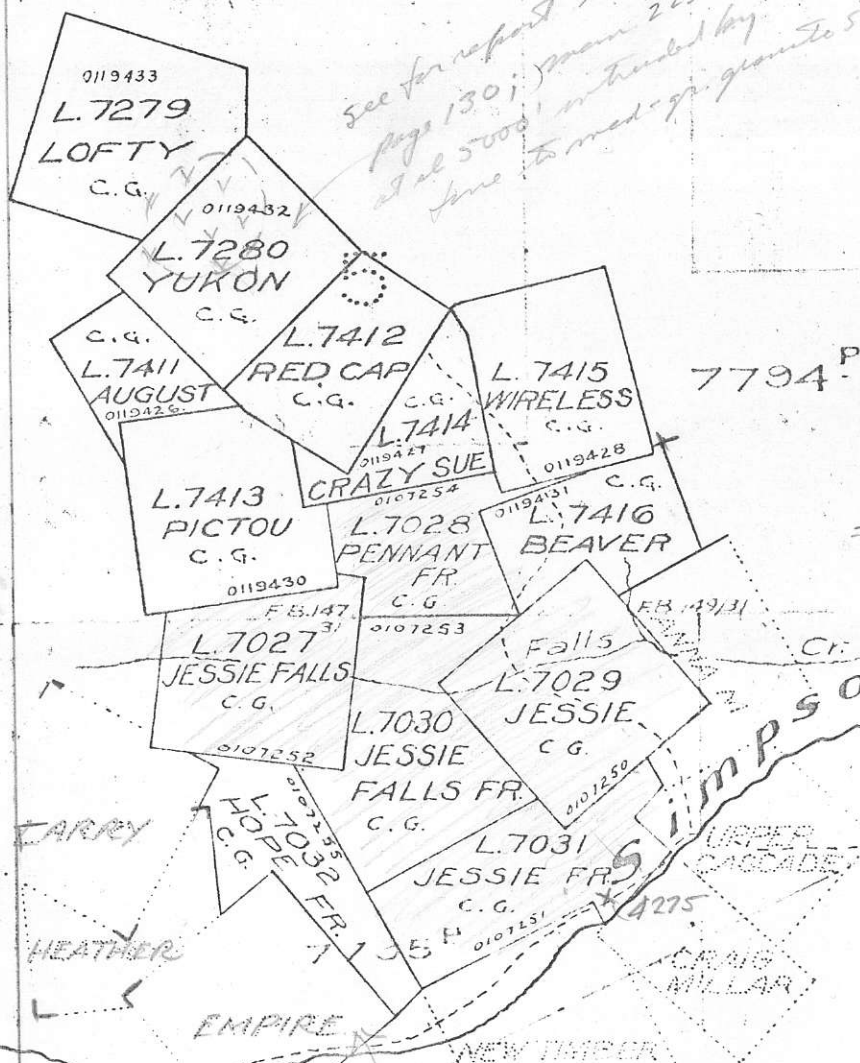

4

Creek

= N. Fork Simpson Cr.

ves. intended by small di stock loc. east of 4700' vein - Note paired same veins on Jessie (by sandstone) stock

Tramway

True North

801243  
Boval



note rel. position of  
midnight 3-4  
per Arco 500 r  
1000 scale.

M-8  
L. 7411-G  
L. 7027-32  
L. 7279-80

Falls

Simpson

CR. RUTH

11800 N  
BLANCHE

11802 N  
RUTH

11801 N  
BIG CASCADE

11799 N  
CASCADE  
FALLS

32638 M  
MIDNIGHT  
4

32637 M  
MIDNIGHT  
3

32636 M  
MIDNIGHT  
2

32635 M  
MIDNIGHT  
1

34417 B  
MIDNIGHT  
17

34416 B  
MIDNIGHT  
16

34415 B  
MIDNIGHT  
15

34414 B  
MIDNIGHT  
14

34413 B  
MIDNIGHT  
13

34412 B  
MIDNIGHT  
12

34411 E  
MIDNIGHT  
11

38197  
MIDNIGHT  
19

38202  
MIDNIGHT

3820  
MIDNIGHT

3819  
MIDNIGHT

21671 K  
KLONDAK  
No. 1

21672 K  
KLONDAK  
No. 2

True

16009 M  
ALEXANDER

16007 M  
PINE CREEK  
No. 6

22711 M  
ALEXANDER

13115 H  
FLEET  
No. 4

13114 H  
FLEET

13113 H  
FLEET

13117 H  
FLEET  
No. 2

13118 H  
FLEET

13577 E  
LAKE VIEW  
No. 2

13576 E  
LAKE VIEW  
No. 1

22714 M  
BLUE BELL  
No. 2

22716 M  
BLUE BELL  
No. 3

22713 M  
BLUE BELL  
No. 1

16052 M  
PINE CREEK  
No. 3

16053 M  
PINE CREEK  
No. 4

16054 M  
PINE CREEK  
No. 4

16006 M  
PINE CREEK  
No. 5

16008 M  
CRAIG MILLAR

16008 M  
CRAIG MILLAR

16009 M  
ALEXANDER

16007 M  
PINE CREEK  
No. 6

15918 M  
JEEP  
No. 11

15916 M  
JEEP  
No. 9

15917 M  
JEEP  
No. 10

15914 M  
JEEP  
No. 7

15915 M  
JEEP  
No. 8

14591 B  
M-42

14592 B  
M-28

14593 B  
M-29

14594 B  
M-50

14595 B  
M-49

14596 B  
M-60

14597 B  
M-59

14600 B  
M-61

14601 B  
M-68

14583 B  
M-44

14584 B  
M-20

14585 B  
M-27

14586 B  
M-50

14587 B  
M-48

14588 B  
M-47

14589 B  
M-61

14590 B  
M-68

14585 B  
M-46

14586 B  
M-24

14587 B  
M-25

14588 B  
M-25

14589 B  
M-24

14590 B  
M-24

14591 B  
M-24

14592 B  
M-24

14593 B  
M-45

14594 B  
M-45

14595 B  
M-45

14596 B  
M-45

14597 B  
M-45

14598 B  
M-45

14599 B  
M-45

14600 B  
M-45

14601 B  
M-45

14602 B  
M-45

14603 B  
M-45

14604 B  
M-45

14605 B  
M-45

14606 B  
M-45

14607 B  
M-45

14608 B  
M-45

14609 B  
M-45

14610 B  
M-45

14611 B  
M-45

14612 B  
M-45

14613 B  
M-45

14614 B  
M-45

14615 B  
M-45

14616 B  
M-45

14617 B  
M-45

14618 B  
M-45

14619 B  
M-45

14620 B  
M-45

14621 B  
M-45

14622 B  
M-45

14623 B  
M-45

14624 B  
M-45

14625 B  
M-45

14626 B  
M-45

14627 B  
M-45

14628 B  
M-45

14629 B  
M-45

14630 B  
M-45

14631 B  
M-45

14632 B  
M-45

14633 B  
M-45

14634 B  
M-45

14635 B  
M-45

14636 B  
M-45

14637 B  
M-45

14638 B  
M-45

14639 B  
M-45

14640 B  
M-45

14641 B  
M-45

14642 B  
M-45

14643 B  
M-45

14644 B  
M-45

14645 B  
M-45

14646 B  
M-45

14647 B  
M-45

14648 B  
M-45

14649 B  
M-45

14650 B  
M-45

14651 B  
M-45

14652 B  
M-45

14653 B  
M-45

14654 B  
M-45

14655 B  
M-45

14656 B  
M-45

14657 B  
M-45

14658 B  
M-45

14659 B  
M-45

14660 B  
M-45

14661 B  
M-45

14662 B  
M-45

14663 B  
M-45

14664 B  
M-45

14665 B  
M-45

14666 B  
M-45

14667 B  
M-45

14668 B  
M-45

14669 B  
M-45

14670 B  
M-45

14671 B  
M-45

14672 B  
M-45

14673 B  
M-45

14674 B  
M-45

14675 B  
M-45

14676 B  
M-45

14677 B  
M-45

14678 B  
M-45

14679 B  
M-45

14680 B  
M-45

14681 B  
M-45

14682 B  
M-45

14683 B  
M-45

14684 B  
M-45

14685 B  
M-45

14686 B  
M-45

14687 B  
M-45

14688 B  
M-45

14689 B  
M-45

14690 B  
M-45