

4625 N LAZ

Other handster

4524

0.5 @ 7.3 5.5 1.5
 1.0 @ 32.3 4.2 21.9

44-148
 4415.7

30
 446124
 4413.8
 27

10
 33
 2

4100 N

11700 E

plotted

KANI KOTIA
 EAST DECLINE - S.E. END
 1" = 20' FEB. /77

801198

6000 E

Upper Carnation

P&S Float

||

MAIN LOOP

M. LOOP

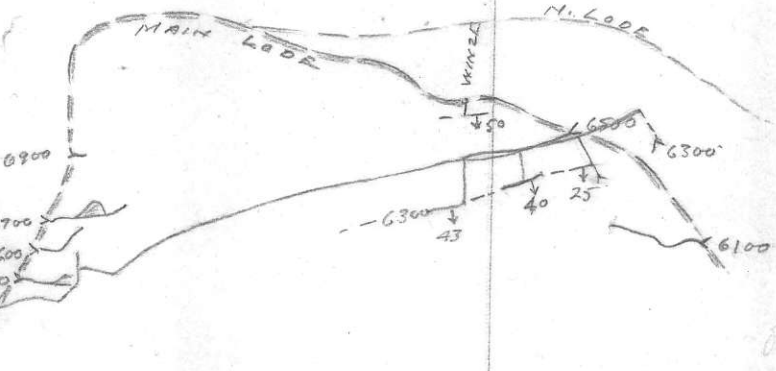

6400

4000 W

20'

Corn - 5480

7000 E

H. 2005

5480

1" = 800'

6500 6300

6100

43

40

55

P30

P45

P40

P35

P36

4000 N

P38

P60

P40

P55

P60

P50

13000 E

11000 E

--- circles and M-S

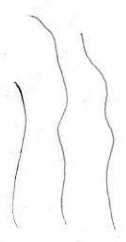

4000 N

15

0

70

