

field rep.

¹²
THUNDERBIRD MINES

801177

~~13~~ ¹⁴ ~~field daily~~

southern 9 western belts of I.R. 13 are out.

Prelimi. recce; can useful work be done or is it simply real estate value

* Forrest Walkers can be field rep. & guide

F. Walkers, Don Urasaki, & 2nd un-named member of council of 3.

First report to include only appraisal of I.R. # 13.

Also do quick drive-through appraisal of I.R. # 12 & # 14 Highland Valley - any direct geol. possibilities here - feasible to do geol. geochron. geophysics.

Summary D.C. to Don Urasaki / May 13/66.

Fee 100⁰⁰/day plus expenses for any of our senior men. Initial report 300 - 500 map.

N.E. & S.W. corners put in areas of shallow cover: If direct exploration not feasible, strategic aim of prop is such that good chance of making deal (real estate value) with major

other bearers of equity or \pm equity put'd: -

I.R. 14; I.R. 12. (North of Nicola at Skookum Cr.

I.R. # 13 on Skookum Cr.

I.R. # 9 Near town of Lower Nicola.

Of less, but consid. interest are I.R. # 12 @ 24 mi take.

Try to meet Don Donaldson on this to follow thru - air photo coverage?

Letter

re Thunderland
I.R. # 13.

\$50,000⁰⁰

- address report :-
- Index maps
- Summary & Pic's - act's re develop
- Estimated costs, w. time sched
- Introduction
- Property, ownership details (as much history as possible)
- Location & Access
- History
- General Pictures
- Regional Geology
- Local Geology & Mineralogy

Summary Field Trip May 20/60.

- N.E. corner of I.R. 13 offers best
pos. for more O.B. & interception of ^{pos} ~~North~~
Surrey street. Woods.

WILLIAM M. SHARP, P. ENG.
CONSULTING GEOLOGICAL ENGINEER

I.R. # 13.

5/20/66

Field Notes

W. F. McKeown
Chain traverse perimeter,
STE. 808, 900 WEST HASTINGS ST.
VANCOUVER 1, B. C.

@ Sta 360

on N. brow of Smokey valley where w
50' relief over creek

Note claims (16) to be "located" (recorded) next week.

Photo ① - View S60E from 20'S of A 360, open pine bush, on F.W.

② - View due W from # 360 along cut W. side towards
Okanagan L. on background

@ S.W. Corner

I.R. lot survey
prob by former
on ranch of
partners

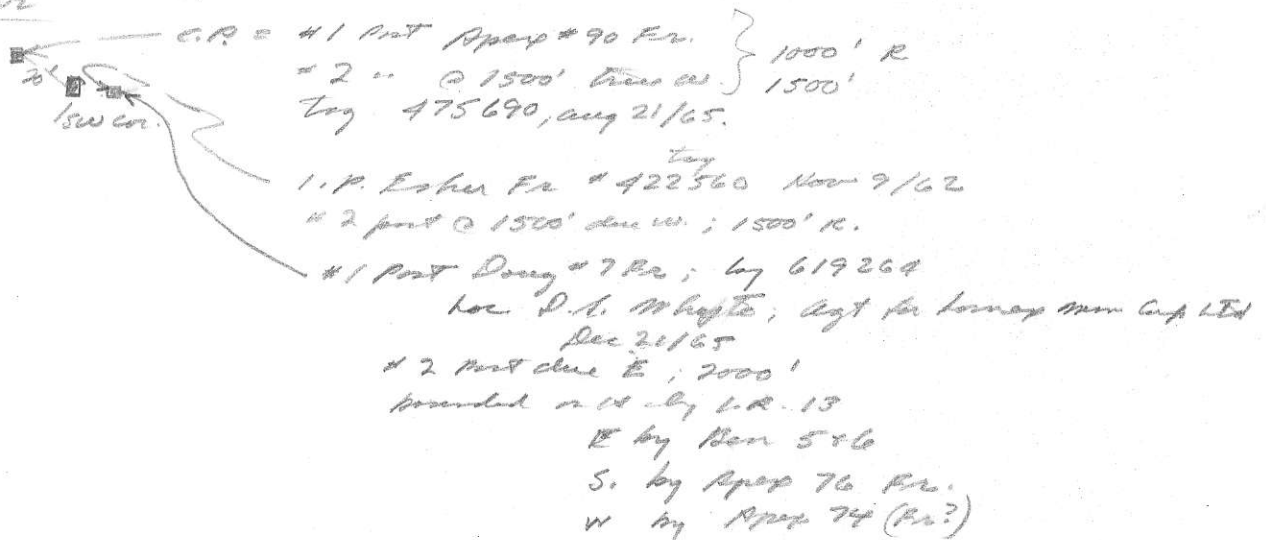

from #358 N 58E to Beth mine

from Doug #7 N 46E to W dump (W?) Beth p.t. near (corner lobby)
#2 post

from #353 + 250'E + 50'N Photo #3
View of Beth mine @ N 50° E

photo #4
View Hylal Valley to Okanagan L
look N 27° W.

Ascroft -- Beth camp -- 26 miles. Sp Rs - as high as 18.

Curvy, L.R. # 13. 5/20/66 (2)
 W.S. & Forest Walker
 Cook's Ferry Road - 150-200

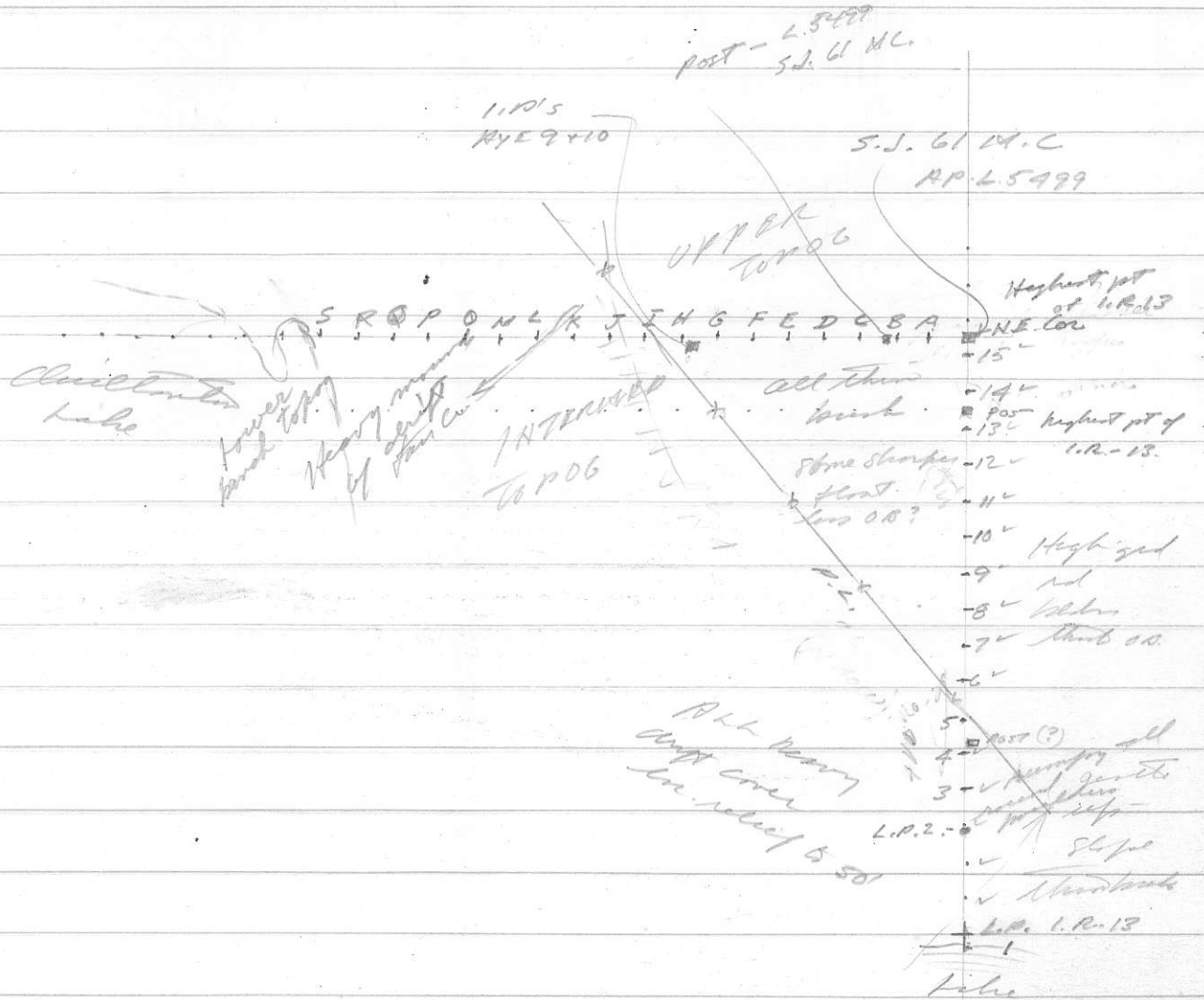

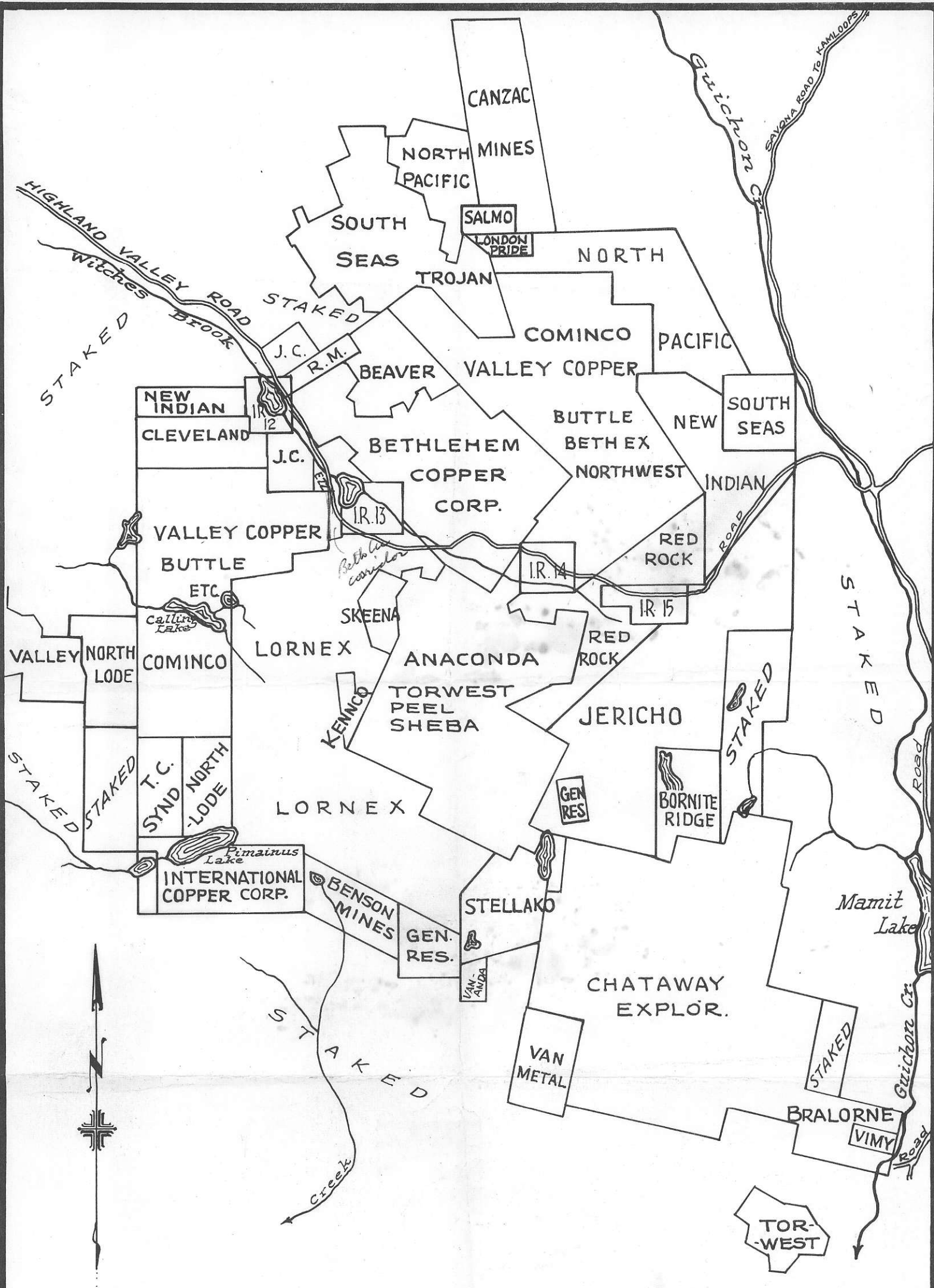

HIGHLAND VALLEY PROPERTIES

Claim Group locations, approximate.

The Merritt Herald