

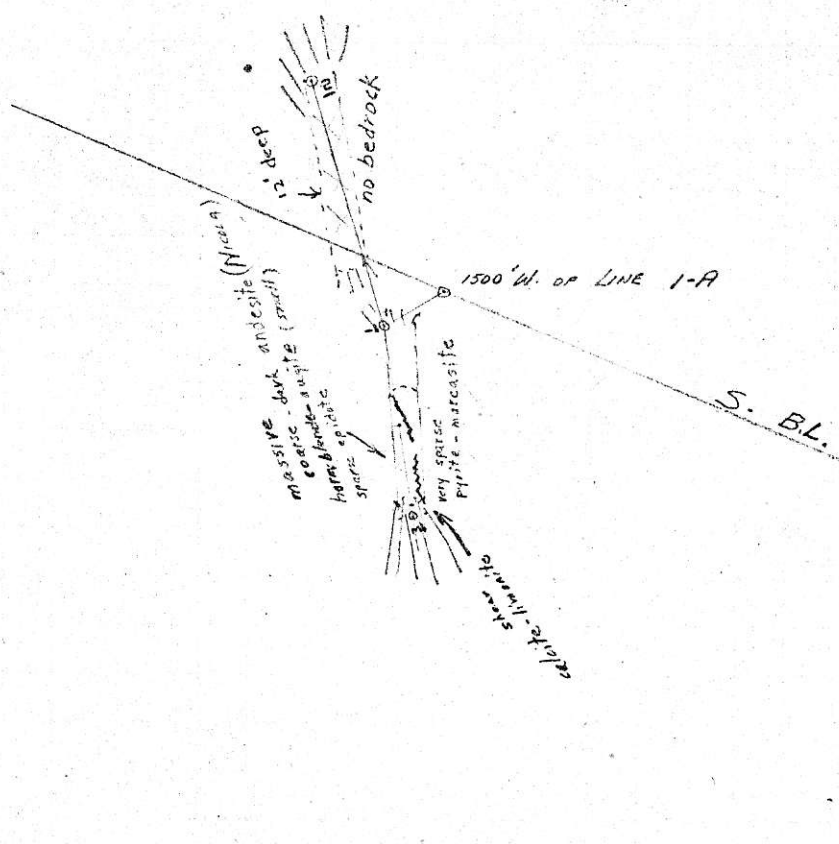

Sc. 1" = 100'

TRENCH 1-67



Echo Trenching

REC'D from S.W. Oct 16/57

TRENCH #5

sc. 1" = 100'



2940

800'

NICOLOA BUTCROPS
(FLOAT? CONTACT MATERIAL)

CREEK

NICOLOA
INTENSE FRACTURING
much Fe CO₃ + oxides, etc.
very minor Cu bits.
calcite - also very fine fract. planes
calcite cemented.
some Mn spots.

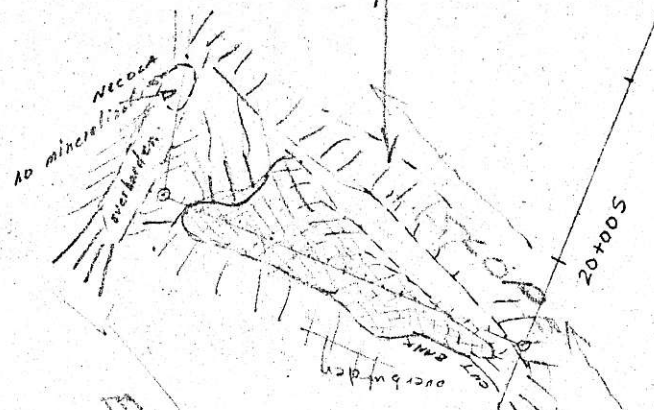

EDGE

DROP

ROAD

WATER SOURCE?

STEEP SLOPE

SLOPE

SLOPE

NICOLOA BUTCROPS

Echo Trenching
Rec'd. from J.W. OR 10/67

TRENCH 6 SHEET 1
AREA
50' 1" = 100'

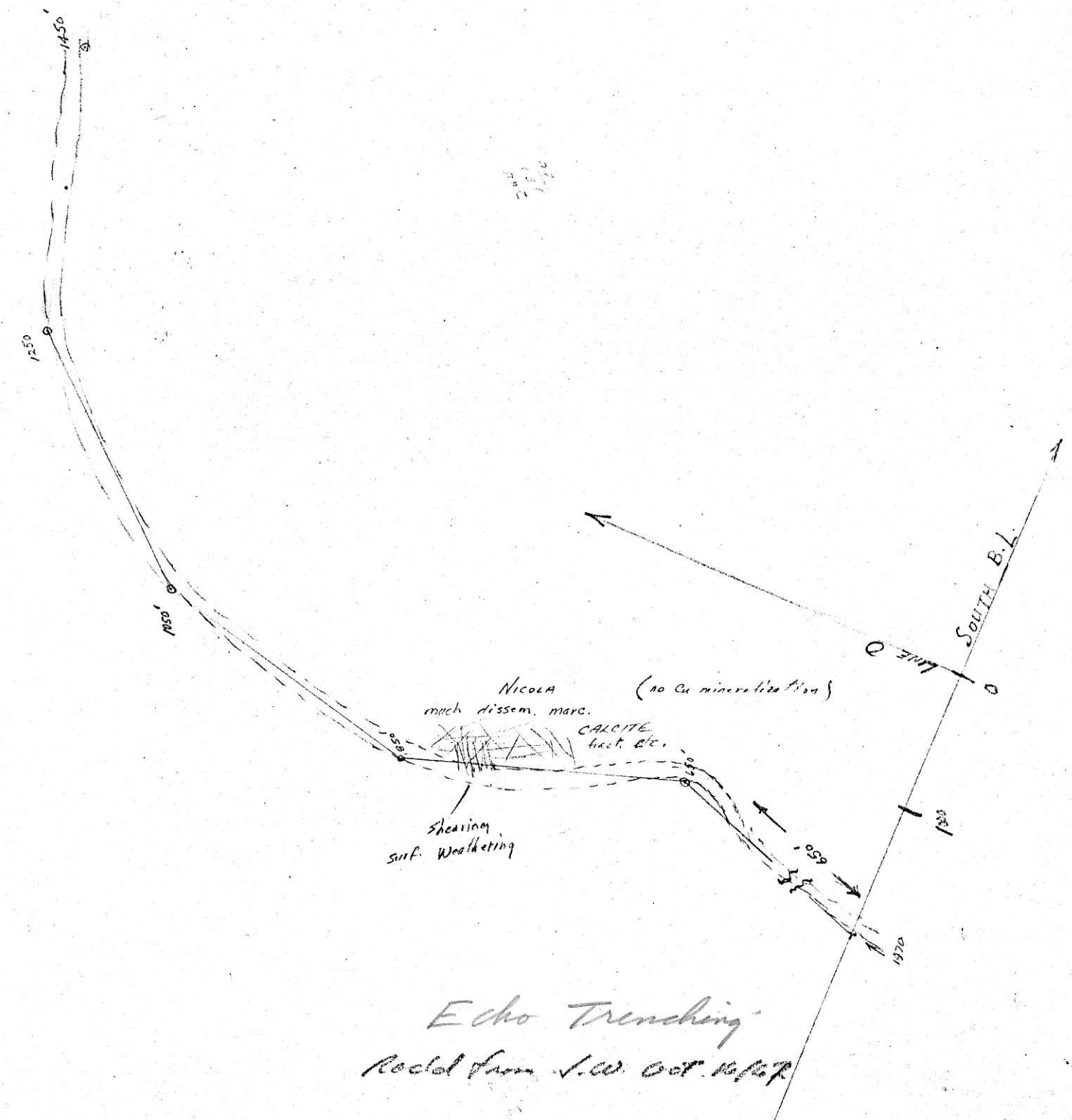

Echo Trenching
Recol from J.W. Oct. 1967



22
1/10
96

310
310
310

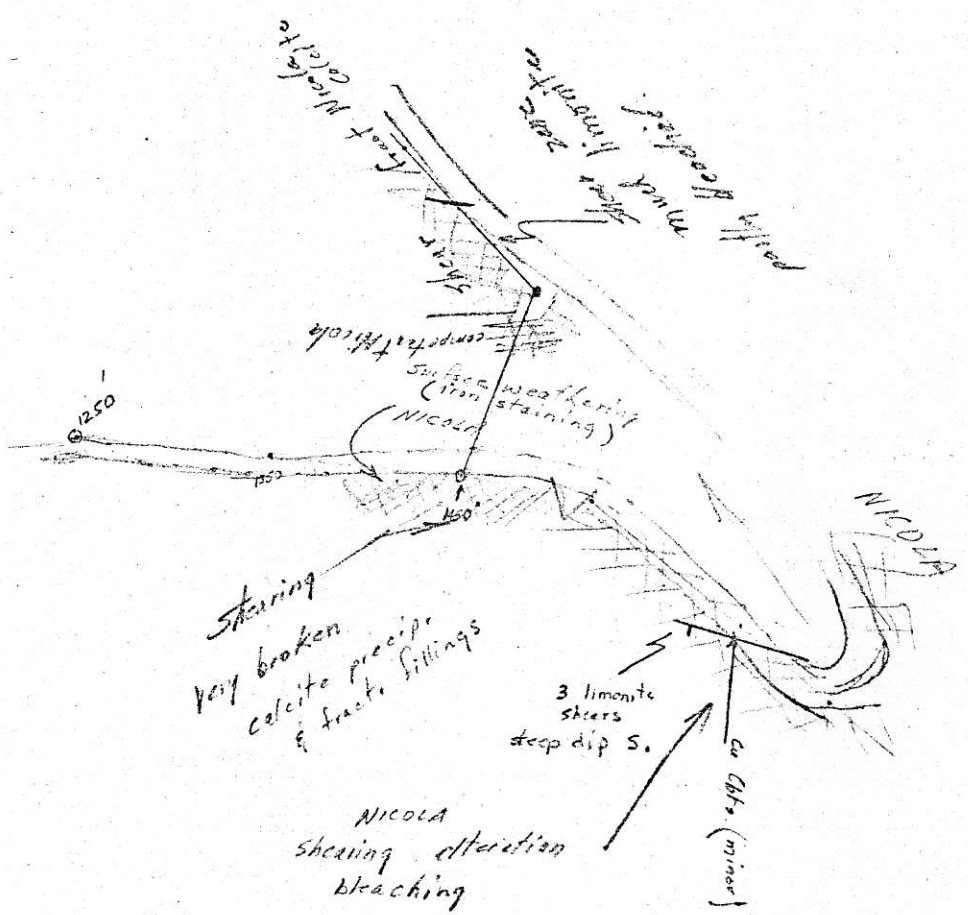

Recol'd from S.W.
Oct 16/67.

Aug 7/67.

Suggested Trenching Echo 1-60 claims,
plus miscell. following due, all subject to
S.W. current ruberonic checking (comp. Wed. next).

(A) Echo 1-60 gp - due Aug 14/67

1. Trench: NW E-11 / SW E-13; also N.E. E-13.
2. " SW E-60; thence S. to gr-vlc contact.
3. " S. end E-51 (note open A. to South)
4. " South half E-35 (contact).
5. " North half (a) E-55 & E-56.

- above planned to S.W. with advice that
W.A. expects to visit on week-end (Sat eve, at
Merrett, or earlier at camp.

(B) other poss trenching - not communicated to S.W.
at present (Aug. 7).

1. S.E. corner E-65 / N.E. E-13.
2. Gen corner E 68, 69, 75, 78. (drainage area?)
3. N.E. E-73.
4. N.E. quarter of E-85.