

1st set - up

- #1 - finished @ 360' ; -32° - Granduc sampled & log.
- #2 - 35° ; 255' - arroyo out. Granduc sampled & log.
- #3 - 40° & 540' (lost in sand & heavy) sampled by Wiley Thompson, Carap, also by Granduc sample & log.

#4 @ -55° & 550' on line of #2 ✓ outcrop loppa sampled by outcrops

2nd set - up
#5 - 71' @ oct 28/64 (dubly on dated break-down)

LEGEND

- QUARTZ-FELD. GRANULITES, BRECCIAS, ETC.
- GREENISH (ANDESITIC) TUFFACEOUS ROCKS.
- LIMESTONE, OR LIMY ROCKS.
- DARK, F. GR. DYKES.
- QUARTZ OR SILICIFICATION.
- PYRITE, MARCASITE, FE-CBTS., ETC.
- CHALCOPYRITE; VEINLETS & DISSEMINATION.
- LINATION - FRACTURES OR "GRAIN"
- BEDDING, INCLINED & VERTICAL.
- JOINTS, SLIP-SLIPS, ETC.
- OUTCROP BOUNDARY.

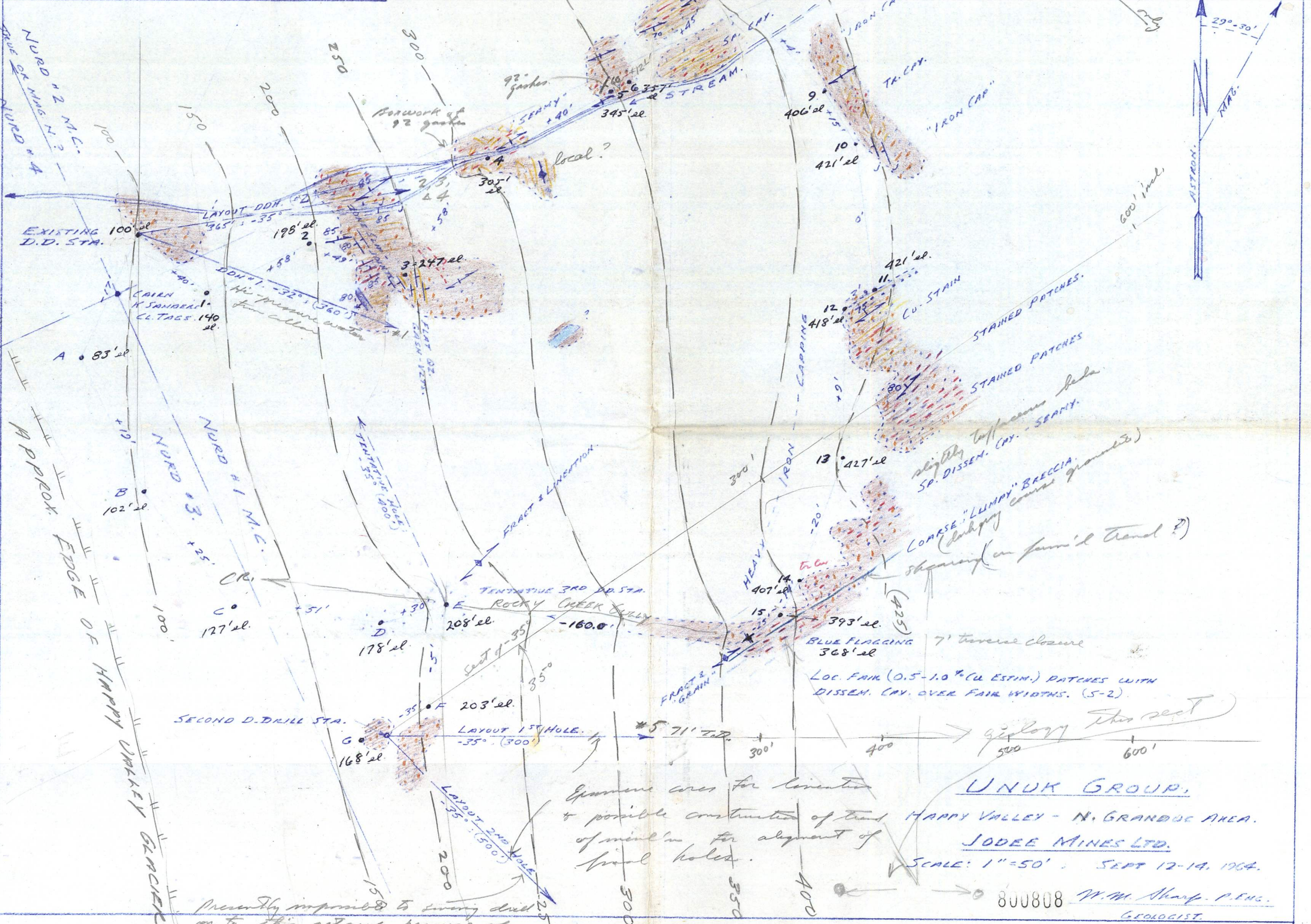
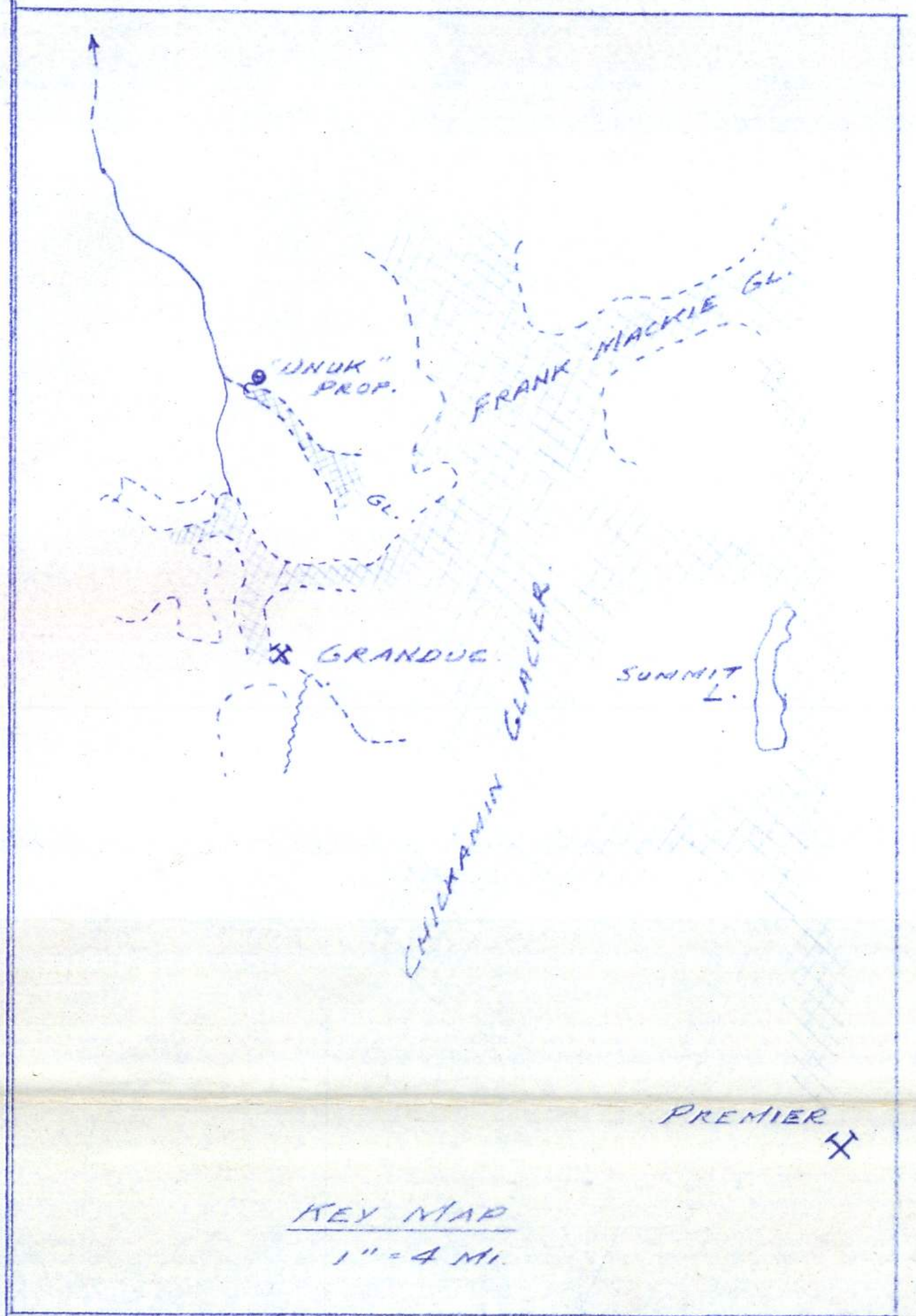

Examine area for lamination & possible construction of trend of mineral for alignment of final holes.

UNUK GROUP,
HAPPY VALLEY - N. GRANDUC AREA.
JODEE MINES LTD.
SCALE: 1" = 50'. SEPT 12-14, 1964.

800808 W.M. Sharp, P. ENG. GEOLOGIST

Previously proposed to survey drill on to this set-up because of set-up space limitation.