

Kleanza Smithers - Fri for 2-3 weeks --

800790

Denore BC  
Aug 24/68

MR. W. M. Sharpe,  
Suite 808 - 900 W. Hastings St.  
Vanouver BC.

Dear Bill,

Phone Dick  
Bates H.A.

Also Bill V-H  
re. trip up.

Very sorry to have delayed reply  
to your letter. As usual and  
like all of us - I'm so darned  
busy.

I have just about completed  
three maps for you showing  
geo-chem values, covering the  
Cu. Mo. zone and the sulphur zone.

— will probably have some specific  
questions on the EM method.

Expect to mail these things to you  
within a couple of days.

Dick

Mr! no burned tents as yet.

**GRIFFITHS, McLELLAND & Co.**

**BARRISTERS & SOLICITORS**

THOMAS O. GRIFFITHS, B.A., LL.B.  
FRANK G. P. LEWIS, B.A., LL.B.  
(MEMBER OF YUKON BAR)  
D. W. SMALL, B. COMM., LL.B.  
J. RAYMOND MACLEOD, B. SC., LL.B.  
JAMES L. BARRETT, LL.B.  
GLEN McDONALD, LL.B.

*Kleanza file*

AREA CODE 604  
TELEPHONE 682-6671  
CABLE ADDRESS "TYRONE"

818 ROGERS BUILDING  
470 GRANVILLE STREET  
VANCOUVER 2, B. C.

REPLY ATTENTION OF Mr. Small.

OUR FILE NO. SK 4309

June 16th, 1966.

William M. Sharp, Esq.,  
Consulting Geologist,  
808 - 900 West Hastings Street,  
VANCOUVER 1. B. C.

Dear Sir,

Re: Kleanza Mines Ltd. (N.P.L.).

Enclosed, for your information, please find the following:

Certificate of Assay dated May 19th, 1966;  
Certificate of Assay dated June 15th, 1966;  
Geochem. Grid dated May 6th, 1966;  
Geochem. Grid dated May 23rd, 1966;  
Map of Gem Claim.

Yours truly,

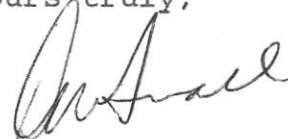

D.W. SMALL

DWS.hf

Encls.



PHONE: 876-4111

CABLE ADDRESS "ELDRICO"

FILE NO. **A.3-K.1-66-24329**

DATE **May 19, 1966**

To:

**Kleanza Mines Ltd.,**

**P.O. Box 2110**

**Terrace, B.C.**

**Certificate of Assay**  
**COAST ELDRIDGE**  
**ENGINEERS & CHEMISTS LTD.**  
 125 EAST 4TH AVE. VANCOUVER 10, CANADA

We Hereby Certify that the following are the results of assays made by us upon submitted Ore samples

MARKED	GOLD		SILVER	Copper (Cu)	Total Molybdenum (Mo)				
	OUNCES PER TON	VALUE PER TON	OUNCES PER TON	PER CENT.	PER CENT.	PER CENT.	PER CENT.	PER CENT.	PER CENT.
71151	0.02	0.70	0.2	0.10	0.005	CROESUS PROPERTY - WEST OF EXCELSIOR			
71152	0.04	1.40	15.4	0.94	0.005		TALTAPIN ORE DUMP - SILVER FOX SHAFT.		

1/30

Gold calculated at \$.....per ounce

Note. Rejects retained one week.  
Pulps retained one month.  
Pulps and rejects may be stored for a maximum of one year by special arrangement.

Unless it is specifically stated otherwise, gold and silver values reported on these sheets have not been adjusted to compensate for losses and gains inherent in the fire assay process.

*H. Stanger*

Provincial Assayer



PHONE: 876-4111

CABLE ADDRESS "ELDRICO"

FILE NO. **A.3-K.1-66-24917**DATE **June 15, 1966**

To: **Klonsaa Mines Ltd. (NPL)**  
**P. O. Box 2110**  
**Terrace, B.C.**  
**ATTENTION: Mr. R. H. Bates**  
**cc to:**  
**D. W. Small,**  
**Griffiths McLeland & Co.**  
**818 - 470 Granville Street**  
**Vancouver, B.C.**

**Certificate of Assay**  
**COAST ELDRIDGE**  
**ENGINEERS & CHEMISTS LTD.**  
 125 EAST 4TH AVE. VANCOUVER 10, CANADA

We Hereby Certify that the following are the results of assays made by us upon submitted Ore samples

MARKED	GOLD		SILVER	Copper (Cu)	PER CENT.	PER CENT.	PER CENT.	PER CENT.	PER CENT.
	OUNCES PER TON	VALUE PER TON	OUNCES PER TON	PER CENT.					
71154 <i>Copper Gross solid</i>	0.60	\$ 21.00	1.5	0.24					

/JP

Gold calculated at \$.....per ounce

Note. Rejects retained one week.  
 Pulps retained one month.  
 Pulps and rejects may be stored for a maximum of one year by special arrangement.

Unless it is specifically stated otherwise, gold and silver values reported on these sheets have not been adjusted to compensate for losses and gains inherent in the fire assay process.

*H. Stanger*

Provincial Assayer

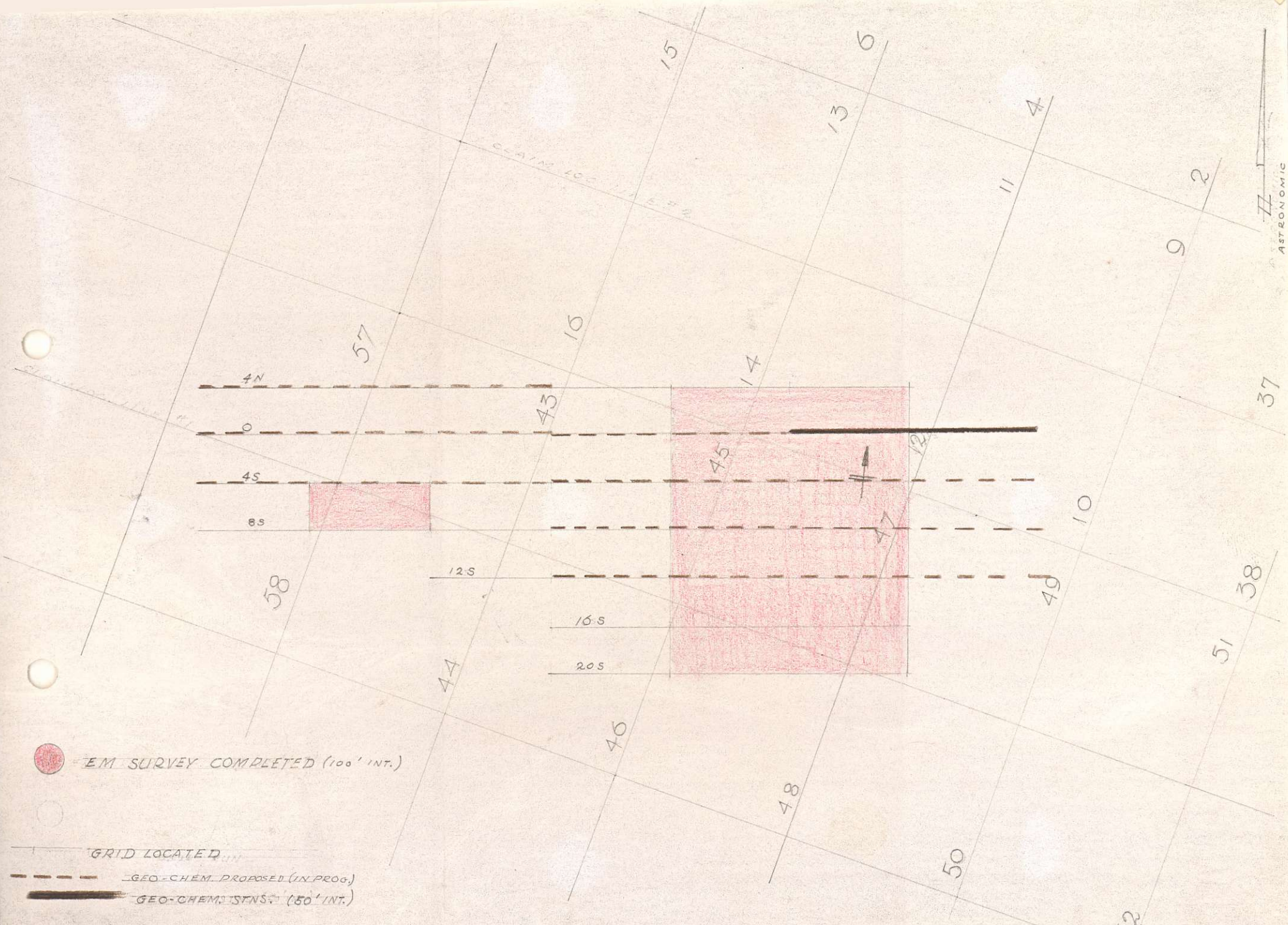

● EM SURVEY COMPLETED (100' INT.)

GRID LOCATED

--- GEO-CHEM. PROPOSED (IN PROG.)

— GEO-CHEM. STNS. (50' INT.)

46

CLAIM NO.



OLD TRENCH (EXCELSIOR)  
AND APPARENT STRIKE

*Kleanza Mines Ltd (N.P.L.)*

CROESUS PROPERTY

EM-GEO-CHEM GRID

MAY 6TH, 1966.

SCALE 1 IN = 1000 FT.

R. H. BATES

# kleanza mines ltd. <sup>(N.P.L.)</sup>

BOX 2110, TERRACE, B.C.

May 16th, 1966

Mr. W.M. Sharpe,  
Suite 808 - 900 West Hastings Street,  
Vancouver, B.C.

Dear Mr. Sharpe,

Re; Kleanza Mines Ltd (N.P.L.)

I wish to thank you for your letter dated May 11th, 1966 .

Your identification does throw some light on the Excelsior specimens forwarded to you . The restricted area of the trench is not actually the interesting feature of that particular part of the Croesus property. I have found through geo-chemical investigation, several anomalous zones in the vicinity, although somewhat irregular in trend ; some fairly good indications compared to results near the old opet cut or trench are apparent.

Naturally, as our grid axpands, the picture will take shape better.

Mr. Small has indicated that a visit to the Croesus property would work in well about the end of May. This would be agreeable with me. I can have a D-6 Mpower shift Cat on the property at the time of your visit depending upon whether I can commit ourselves definitely to a certain date.

Conditions here in and around Terrace are keeping heavy equipment working overtime, although I can as I say, obtain a D-6 if spoken for immediately.

I will have made a trip to the Gem and Black Bull showing by the time of your visit and completed some underground sampling, at least. In addition, I will try to have a rough geological map made for your convenience, showing relation of old showing to geo-chem results, EM anomalies, reads now on the ground etc.

I am phoning Mr. Small tonight regarding the planned visit.

Yours truly,

  
R.H. Bates

W.M. Sharpe, 2

(2)

May 16th, 1966

PS. Granby Mining Company conducted last year, a mag. grid survey over part of the same ground that we are now working on. We might benefit from their information. Possibly we might wish to purchase their completed map if they are willing to sell it.

I have spoken to Mr. Kieth Fahrni about this but as yet, it is indefinite.

Regarding the Geochem method mentioned in your letter, would you kindly arrange to have the necessary materials shipped to me for this method. It would work well on other showings on both the Taltapin and Croesus properties.

I am currently using the Rubenic acid method, as Copper is the main objective, although we are working in a Gold country. Possibly though, Gold would be associated with copper here.

The Gem and Black Bull showing is, as you are probably aware a Gold telluride show. With very little if any copper. Running from 1 to 2 oz. Au.; and roughly 2 oz. Ag. , dip is approx. 70° East. width is approx. 7 in. to 1½ ft. . The interesting feature is perhaps the surrounding country rock.

Our Copper anomalies are pointing to the area in which the downhill strike of this vein would be met.

RB

# kleanza mines ltd. <sup>(NPL)</sup>

BOX 2110, TERRACE, B.C.

MAY 03 1966

April 30th, 1966

Mr. Wm. Sharpe,  
808 - 900 West Hastings Street,  
Vancouver, B.C.

*fresh-up*

Dear Mr. Sharpe,

Re: Kleanza Mines Ltd (N.P.L.)

For your information, I will give you an idea of progress on the Croesus (Kleanza Mountain) Property, to date.

Firstly, I will advise that snow conditions are still a little heavy for examination of the Eastern parts of the property. On the West slopes, however, snow is completely melted to about 2000 ft. elevation. with about 1½ ft. still at 1680 ft. elev. on the South and South West.

I have rediscovered the old 'Excelsior' showing ( see photostat information.) and have forwarded to you express a sample representative of the old trench which is approx. 40 ft. in length. These samples were taken from the trench bottom and ore piled along the trench, therefore would probably run a little higher in Copper and other values than a true representative sample.

I do plan to cut a fresh trench across this same structure soon and will take a true sample at that time.

We are currently running EM survey on a grid which at this time is roughly 6000 by 3000 ft in area. Completed EM coverage to date is approximately 3000 by 2000 ft.

An anomaly is apparent in the vicinity of the 'Excelsior' showing also to the North and South of it, as well as to the East of it. The general area of the showing appears to be a shear zone.

If you should make a trip North at any time, you would accomplish something on the property as snow does not cover all of the old



W.M. Sharpe

April 30th, 1966 (Cont'd)

showings, In addition, I would like your advice on some matters concerning the EM survey.

I plan to carry out soil sampling in the vicinity of the 'Excelsior' as well as over several other areas on the property.

The Taltapin property is still heavy with snow. I think that May 15 to 20th would see most of the stuff melted.

Should you plan a trip in this vicinity, you might let me know some days ahead.

Yours truly,



R.H. (Dick) Bates

WILLIAM M. SHARP, P. ENG.  
CONSULTING GEOLOGICAL ENGINEER

STE. 808, 900 WEST HASTINGS ST.  
VANCOUVER 1, B. C.

August 15, 1966

Mr. R. H. Bates,  
Kleanza Mines Ltd.,  
P.O. Box 2110,  
Terrace, B.C.

Dear Dick:

Here's the E.M. report for your general information of procedures & interpretations employed by one contractor. Hope it is of some use to you; if not drop me a list of specific questions and I will see if I can find answers for you.

By the way, how is your geochem. compilation progressing; will be glad to have it any time now.

Burned down any more camps recently (your crew, I mean)?

Best regards,

Bill Sharp.

P.S. Please return the enclosed when you are through with them - no rush, however.

Encl.

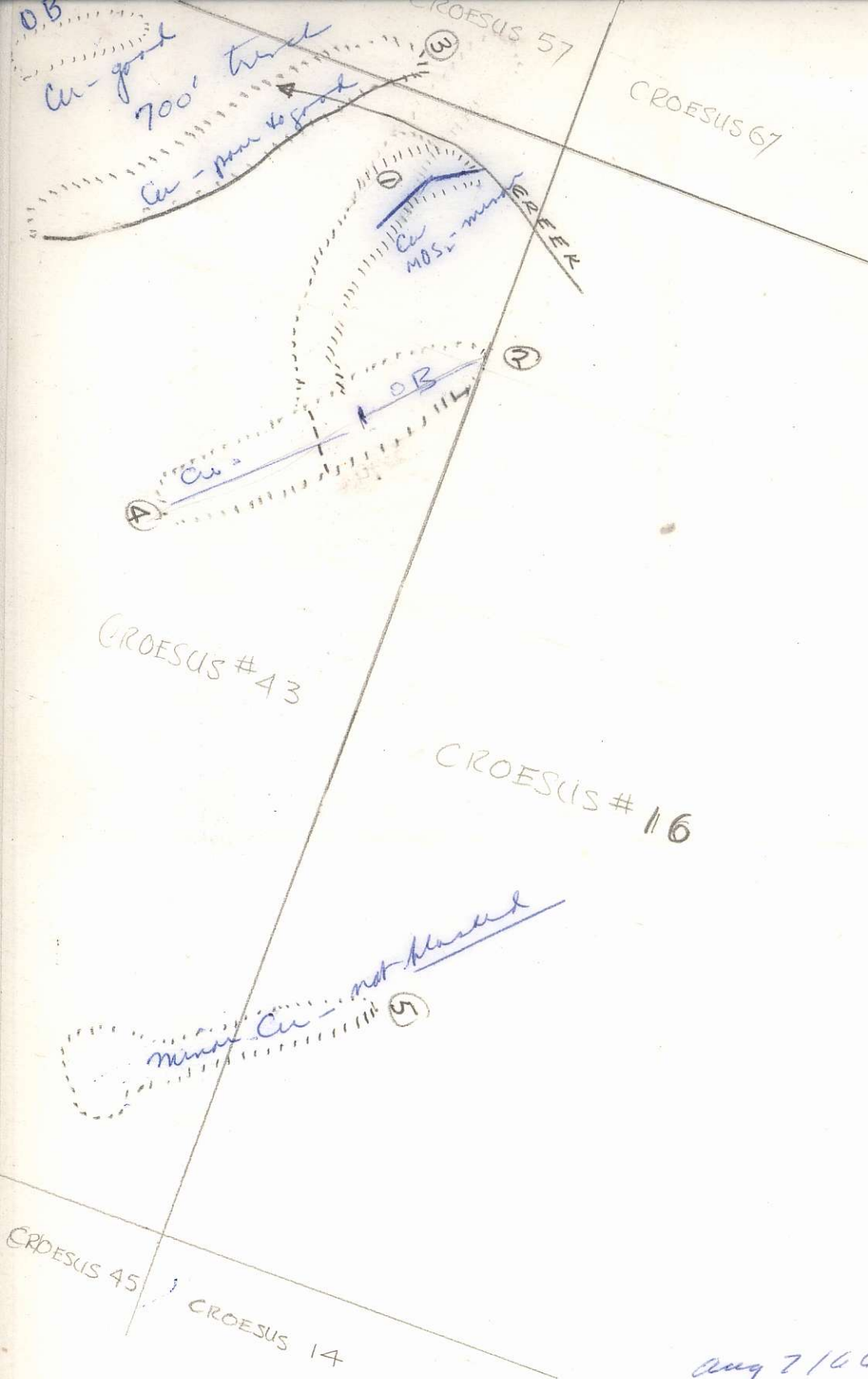

Chickadee - flat top.

150-200  
shallow slope

Aug 7/66

size claim group & map.  
grid map.  
soil & sample maps to date.  
Push's geol. interpretations, etc.  
new claims all in omuncji  
M.O. ? (check M.O. maps)



1 IN = 200 FT.

2014  
8/20

ASTROLOGICAL

CROESUS NO. 37

NO. 3 TRENCH

NO. 2 TRENCH

NO. 1 TRENCH

NO. 4 TRENCH

CROESUS NO. 16

CROESUS NO. 14

CROESUS NO. 43

CROESUS NO. 45

KLEANZA MINES LTD.  
CROESUS GROUP  
BATES ZONE  
PLAN OF TRENCHES  
1 IN. = 200 FT.

to 1" = 500'

R.H. BATES JULY 28/16

*270' to 290' high  
to fine highly  
siliceous granite  
9-10 x 20W*

*RO. 25*

NO. 5 TRENCH

750

725

IX CO. W.

SR. CROESUS NO. 37 & 39  
200 FT

(Loc. Line)

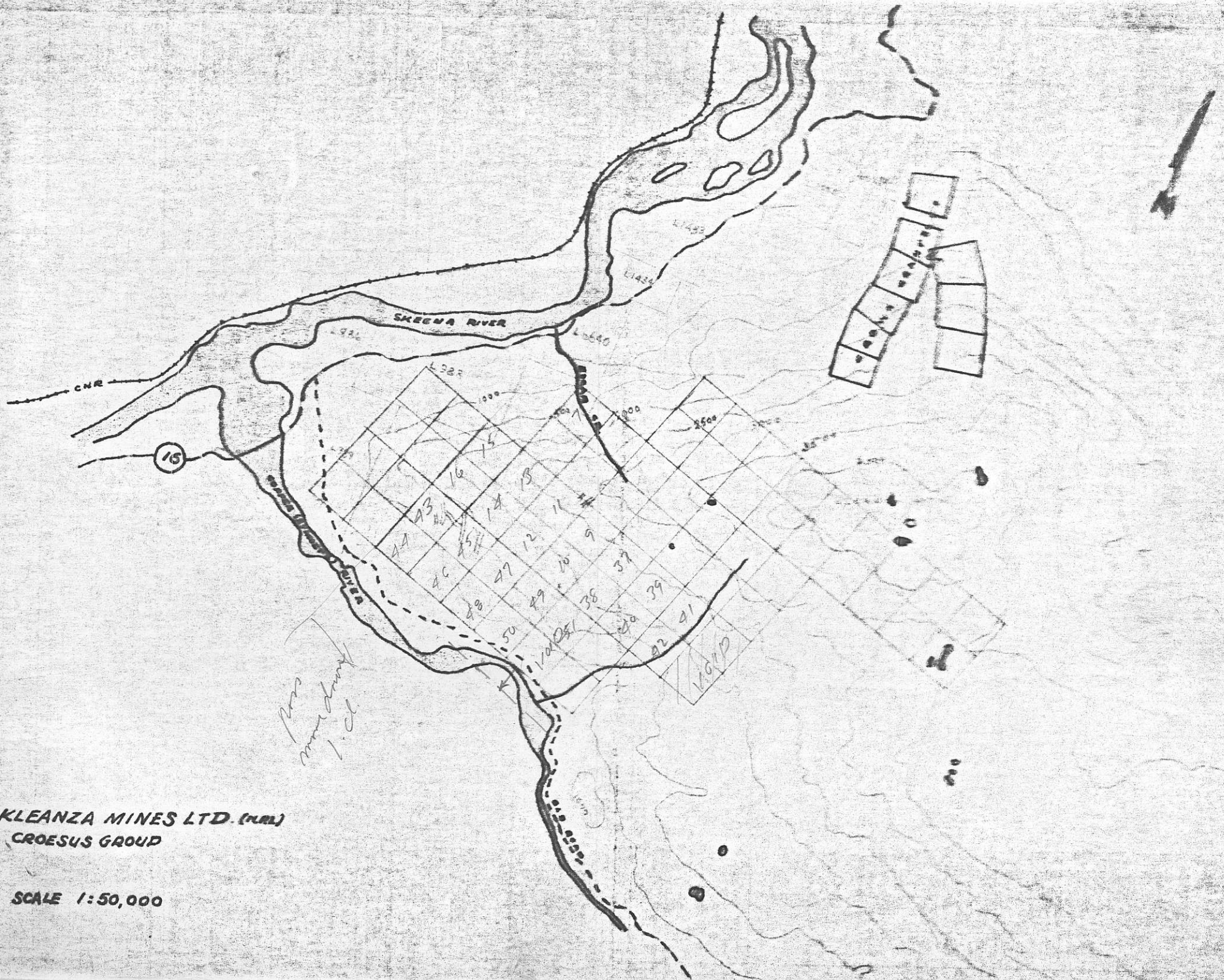

**KLEANZA MINES LTD. (P.L.C.)**  
**CROESUS GROUP**

**SCALE 1:50,000**

May 11, 1966.

Mr. R. H. Bates,  
Kleanza Mines Ltd.,  
Box 2110,  
Terrace, B.C.

Dear Mr. Bates:

Thank you for your letter of April 30th and the Excelsior trench samples - the latter picked up from Greyhound today.

The following is my somewhat restricted identification of the above trench material:

The wall rock appears to be a well carbonatized hornblendic intrusive (quartz diorite or granodiorite) which is also slightly kaolinized (clay odour) by ordinary weathering or, perhaps, by hydrothermal solutions associated with the mineralization. The rock, coming from the shear zone described in your earlier summary, is irregularly veined by quartz; some apparently-late calcite fills other fractures. Rather coarse-grained (cubic grains and clots) pyrite occurs within and adjacent to quartz stringers. In some pieces coarse blebs of chalcopyrite also occur in the quartz stringers. A soft black mineral with a metallic lustre and white streak is common (altered hornblende?) I did not notice any galena or sphalerite.

Reports by government engineers point out the normal local association of gold and silver with the lead, zinc, (and copper?) sulphides. It also appears that, at least locally, pyrite alone carries some gold and silver. With this in mind, and also by reason of the chalcopyrite content, I put in about 3/4 of the sample lot for Au - Ag - Cu assay. I should have these results in a few days for you and for Mr. Small. Your forthcoming sample of fresher material should be more representative and conclusive.

*Au = .01; Ag = .50; Cu = .08*

Your "E.M." survey should indicate the mineralized zones if the sulphide

Mr. R. H. Bates

- page two

---

content is 10% or more. It will also, as you know, respond to graphitic zones or wet, conductive fractures or shears. These can be sorted out by trenching.

I agree with your plan to carry out soil sampling - in preference to geophysical methods during the reconnaissance exploration stage. The G. S. C. "heavy-metals" method employing ammonium citrate (pH 8.5) and dithizone titrations would be very suitable.

I plan to visit you when Mr. Small and Associates are ready for a preliminary examination of their Smithers properties. I or Mr. Small will inform you some time prior to this trip.

Meanwhile, I wish you lots of success in your present program.

Yours very truly,

W. M. Sharp, P. Eng.

WMS/jm

c.c. Mr. D. W. Small

Sheets returned to T.K. from Moses, Box 56,  
via Mike to T.K.'s compiler Smithers, Rec'd. Aug 4/67.

FROM

T. Kellner

DEPARTMENT

Moses Mines

SEND TO

W.M. Sharp.

DATE

July 29, 1967

808, 900 W Hasting St. Van 1, B.C.

SUBJECT

KLEANZA.

MESSAGE

Bill, enclosed sheets for Kleanza, Copper River  
traverses, south side.

Consists of 3 Traverses

Sheet 1, Theo #1 on west of #2

Sheet 2, 3 Theo #2 on west of #4.

Sheets 4, 5, 6, Theo #4 - tied in to grid.

Have Heavy magnetic anomaly encountered in total  
of sheets 4, 5, 6. Traverse being plotted is  $110^\circ$ , on  
many back-sights was found to be  $\approx 100^\circ$ .

All traverses followed Road.

Traverse #2 is referred to steel drain culvert  
in road at East end of traverse.

Dick Bates has given Theo O Kellner  
these sheets