

Rec'd Nov. 1/66

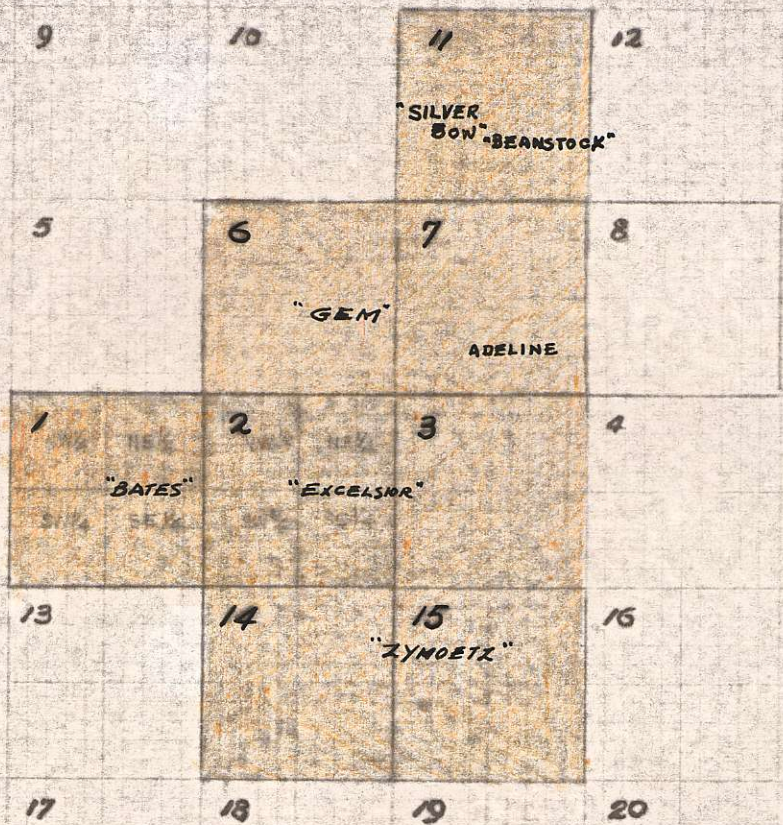

45N.
 11N
 20S
 58S

— EVALUATED RUBENIC REACTION STRIPS (100 FT. SEPARATION)

— EM COVERAGE: SHARPE S.E. 200

IN-LINE METHOD
 FIG. "A" CONFIGURATION
 100 FT. SEPARATION.

17W 0 15E 45E 85E

KLEANZA MINES LTD
 INDEX TO MAPS
 REACTION STR. EVALUATED
 CROESUS GEO-CHEM.
 R. H. BATES

800789

Rec'd Nov 1/66

Recess soil sampling completed to date



← W.P. LINE →

gen. massive
clay - will
not be soil-
sampled.

SOIL
SAMPLING COMPLETED

111
112
113
114

125
126
127
128

Σ = 8

20
18
14
22
18
20

$$\frac{112 + 1 \text{ Ft}}{= 113}$$

added 8
 $(113 = 112 + 1 \text{ Ft})$
 $+ 8$

 121

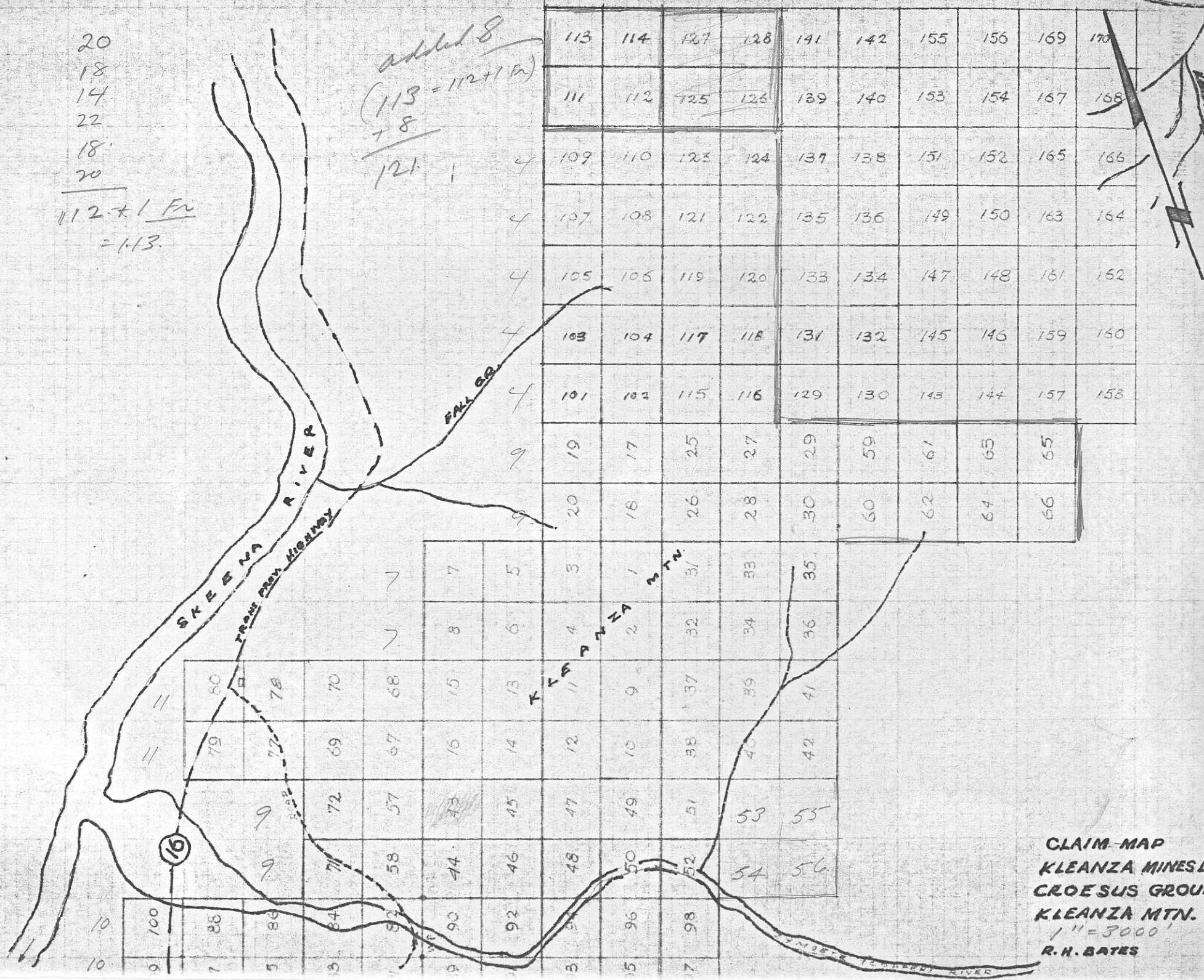

113	114	127	128	141	142	155	156	169	170
111	112	125	126	139	140	153	154	167	168
109	110	123	124	137	138	151	152	165	166
107	108	121	122	135	136	149	150	163	164
105	106	119	120	133	134	147	148	161	162
103	104	117	118	131	132	145	146	159	160
101	102	115	116	129	130	143	144	157	158
19	17	25	27	29	59	61	63	65	
20	18	26	28	30	60	62	64	66	

CLAIM MAP
 KLEANZA MINES
 CROESUS GROUP
 KLEANZA MTN.
 1" = 3000'
 R. H. BATES

ORIGINAL ON CLIPPING NO. 701
 45
 11N
 20S
 58S
 58S

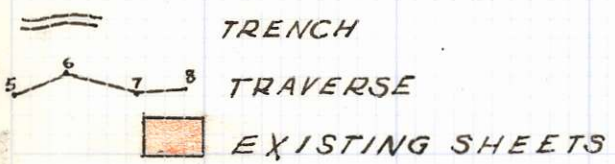
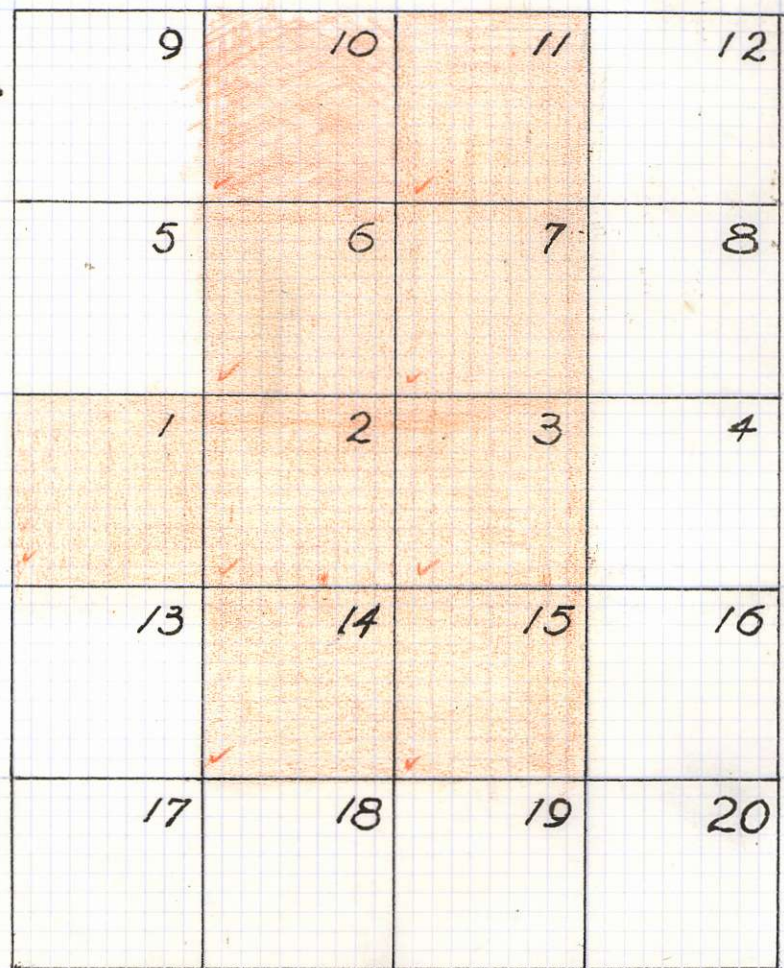

2. RUBENIC REACTION EVALUATION

E-M TILT ANGLES ($1/10$ IN. = 1° AT 100 FT. SEPARATION)
 UNIT - SHARPE SE 200
 IN LINE METHOD
 CONFIGURATION "A"

KLEANZA MINES LTD. (MPL.)
 INDEX TO MAPS
 CROESUS M.C.'S.

R. H. BATES

17W 16E 45E 85E