



Rec'd Oct. 2/69

ASSOCIATED GEOLOGICAL SERVICES LTD. / 807 Bank of Canada Bldg. Vancouver 1, B.C. / Telephone (674) 682-4314
#17-558 Howe Street

688-4745

Consulting / Property Examinations / Geological Surveys / Geo-chemical Surveys / Mine Development / Project Management

September 24, 1969.

Beeley

800771

93L

Mr. Beeley,
Government Agent,
B.C. Govt. Building,
Smithers, B.C.

Dear Sir:

RE: Zap Claim Group

I would like to call your attention to a possible infringement of the Zap Claim Group upon the previously staked Silver Cup Group. (Ref. Location Map, Zap Claim Group).

From the sixth to the fourteenth of September 1969, I staked the Zap Claims. These were recorded and grouped in Smithers, September 15, 1969.

According to the Government Claims Reference Map, there was the possibility that the Eastern Boundary of the Zap Claim Group^{is} infringing on the Western Ground of the Silver Cup Group.

On September 4 - 5, an assistant and myself, in order to establish the location of the Silver Cup Group by claim posts and/or location lines, searched the ground, beginning at the East end of Top Lake proceeding East to within 3/4 miles of Milk Creek. At no time, either during the search, staking or mapping, was there any evidence of staking of location lines or posts found.

A final search to locate the Silver Cup Group was made on September 13, 1969, at this time I was accompanied by W. M. Sharp, Mining Consultant. As before, no evidence of staking was found.



ASSOCIATED GEOLOGICAL SERVICES LTD. / 807 Bank of Canada Bldg., Vancouver 1, B. C. / Telephone **688-4745** ~~(671) 682-4314~~

~~17 - 558 Howe Street~~
Consulting / Property Examinations / Geological Surveys / Geo-chemical Surveys / Mine Development / Project Management

Page 2

For reference, I submit a photocopy of the Government Claims Reference Map and the Zap Claim Group location map (taken from the General Geology, Zap Claim Group, Telkwa Pass, B. C. map).

I would very much appreciate your looking into this matter so that the status of the Zap Claim Group may be clarified.

Respectfully yours,

ASSOCIATED GEOLOGICAL SERVICES

H. E. Madeisky

HEM/dla

Encl. 's

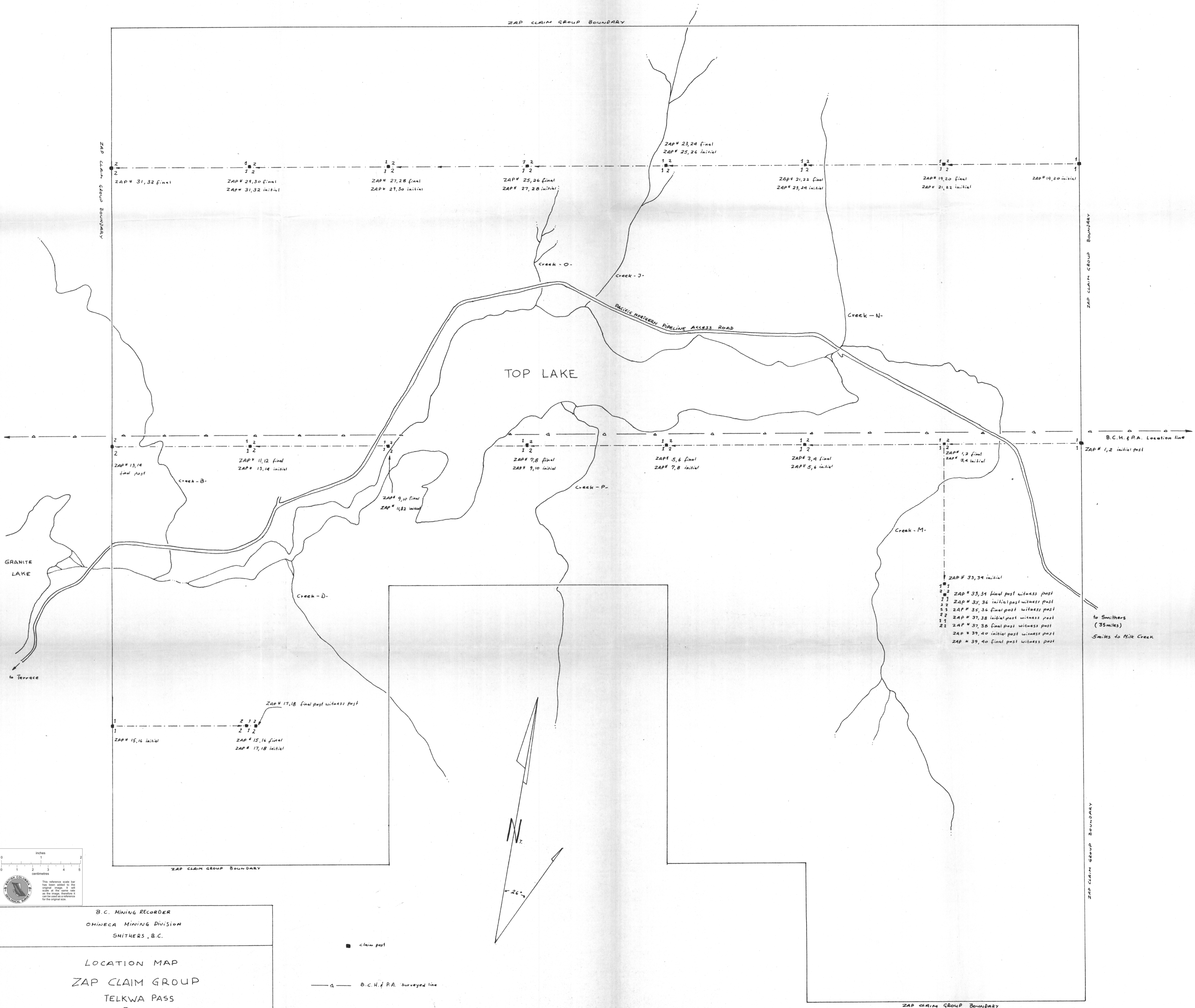

- 1 ZAP # 33,34 initial
- 2 ZAP # 33,34 final post witness post
- 3 ZAP # 35,36 initial post witness post
- 2 ZAP # 35,36 final post witness post
- 2 ZAP # 37,38 initial post witness post
- 1 ZAP # 37,38 final post witness post
- 2 ZAP # 39,40 initial post witness post
- ZAP # 39,40 final post witness post

to Smithers
(35 miles)
5 miles to Milk Creek

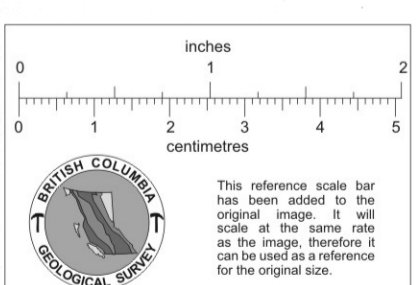

B.C. MINING RECORDER
OMNICA MINING DIVISION
SMITHERS, B.C.

LOCATION MAP
ZAP CLAIM GROUP
TELKWA PASS
B.C.

- claim post
- a — B.C.H. & P.A. surveyed line
- - - - ZAP CLAIM GROUP location line

PREPARED FROM: "GENERAL GEOLOGY, ZAP CLAIM GROUP, TELKWA PASS, B.C." MAP
H.E. MADRISNY, ASSOCIATED GEOLOGICAL SERVICES LTD.
SEPT. 24, 1969 SCALE: 1" = 400' H.E. MADRISNY