

800675
Mt. Milligan

 CONTINENTAL GOLD CORP

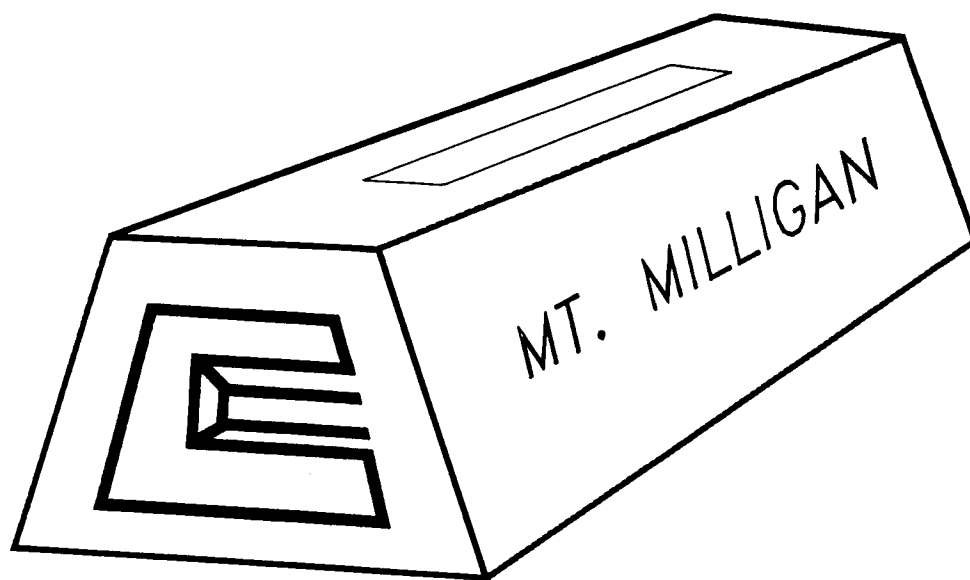

 BP RESOURCES CANADA LIMITED

THE
GOLD - COPPER
JOINT VENTURE

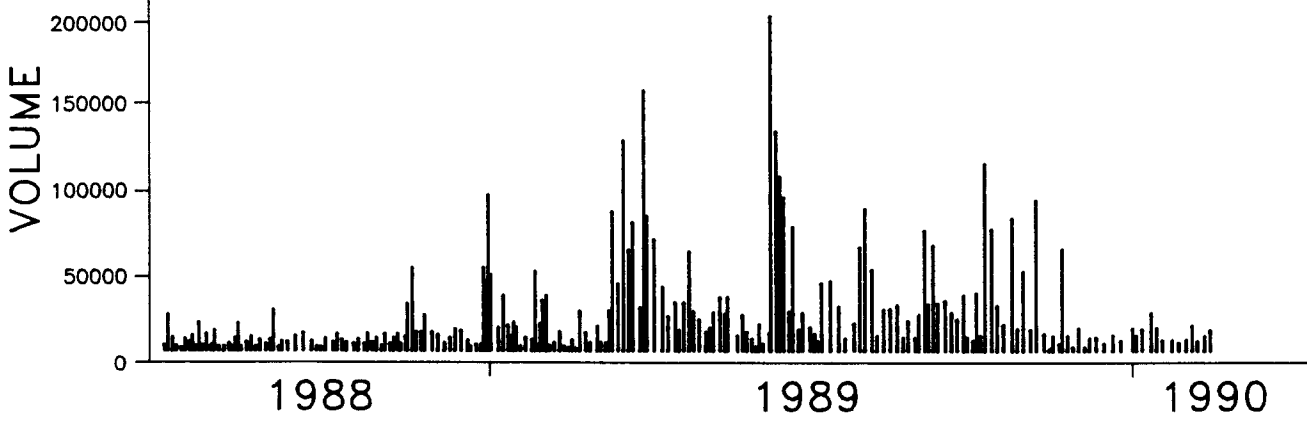
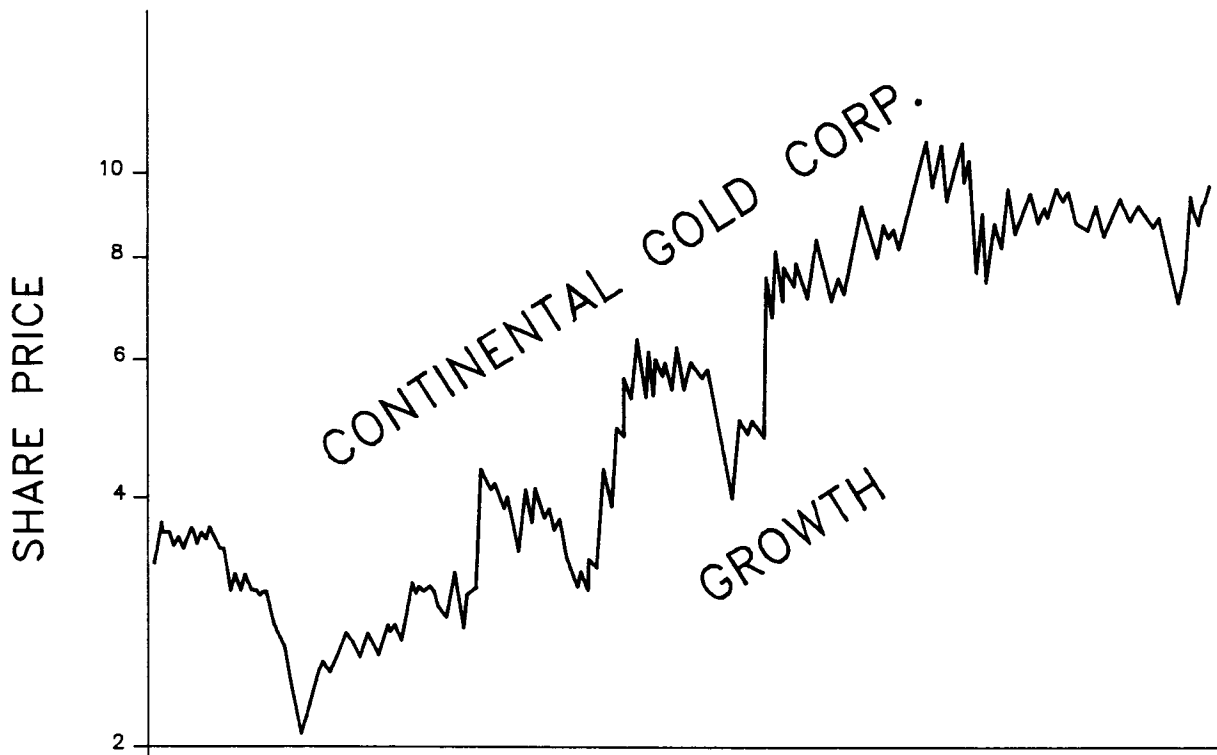

 CONTINENTAL GOLD CORP

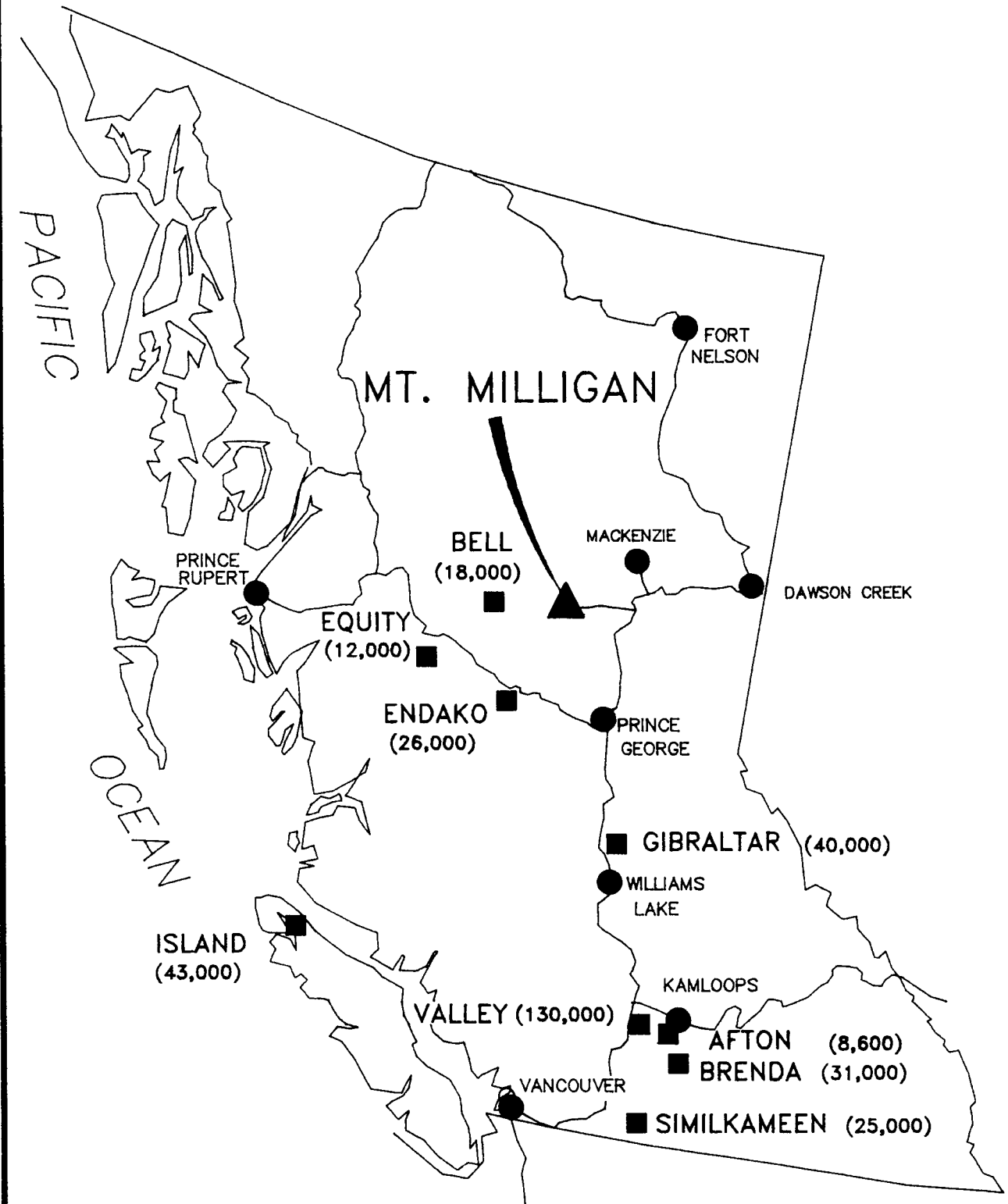

■ OPEN PIT MINE (TONS PER DAY)

 **CONTINENTAL GOLD CORP**
B.C. OPEN PIT MINES



MT. MILLIGAN

MACKENZIE

POWER SUBSTATION

■ BELL
(NORANDA)

FORT ST. JAMES

BURNS LAKE

TO PORT OF
PRINCE
RUPERT

■ ENDAKO
(PLACER DOME)

VANDERHOOF

PRINCE
GEORGE

To VANCOUVER



CONTINENTAL GOLD CORP
SITE LOCATION



42 SQUARE MILE
MT. MILLIGAN PROPERTY

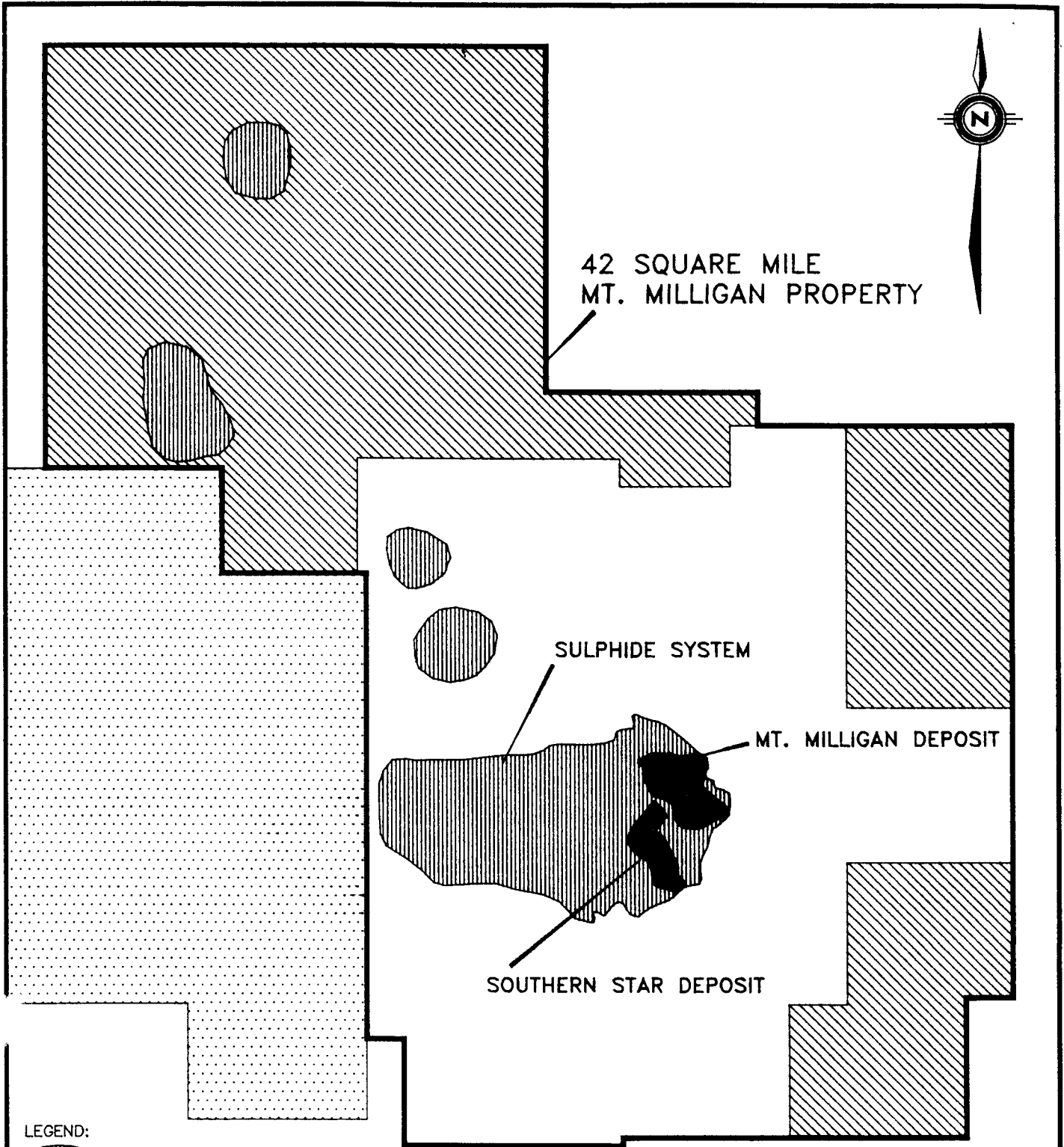

LEGEND:



DEPOSIT TARGETS

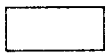

70% CONTINENTAL GOLD
30% BP RESOURCES CANADA



100% CONTINENTAL GOLD

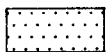

BP RESOURCES CANADA 100% OPTION



CONTINENTAL GOLD CORP
PROPERTY MAP

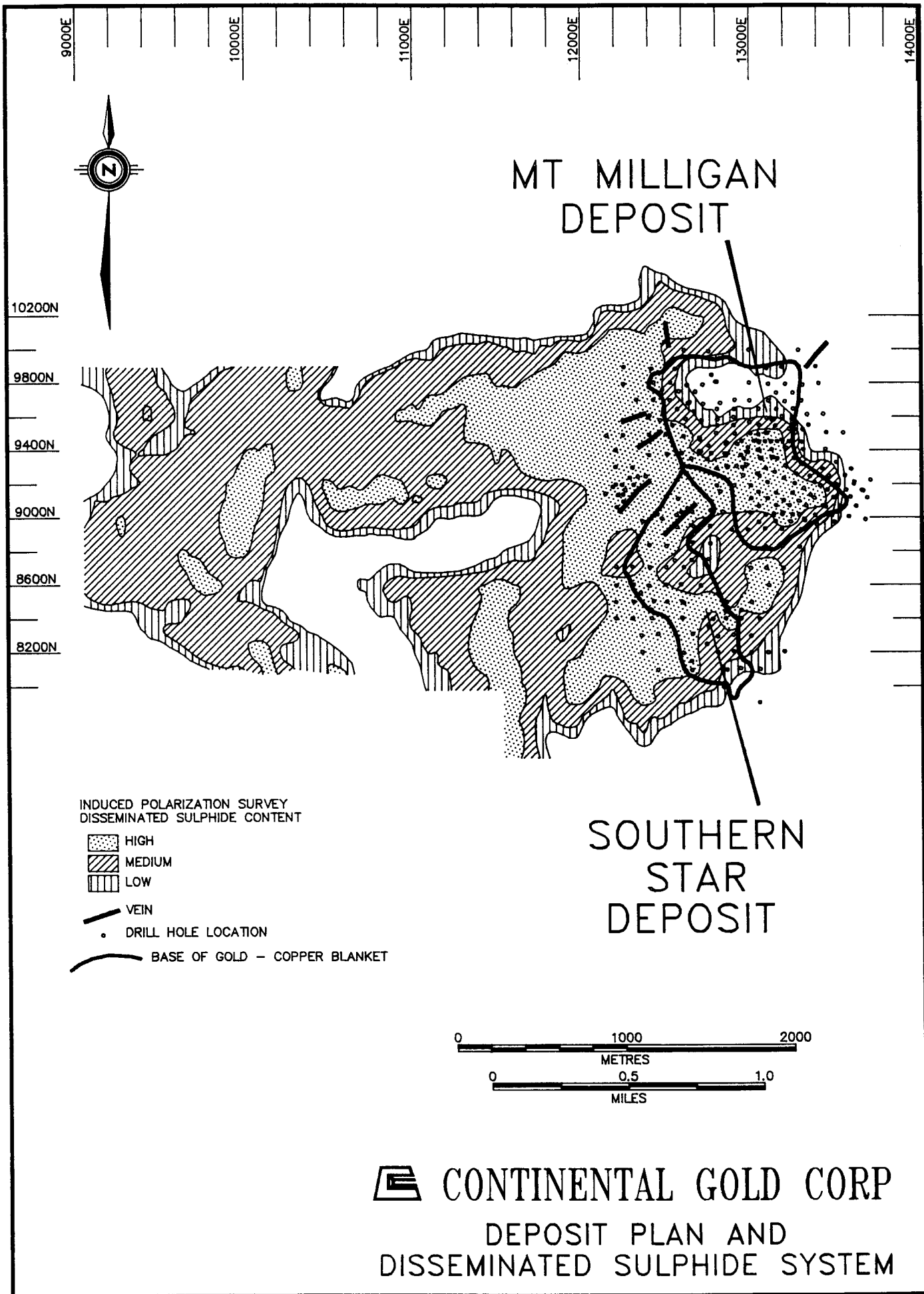

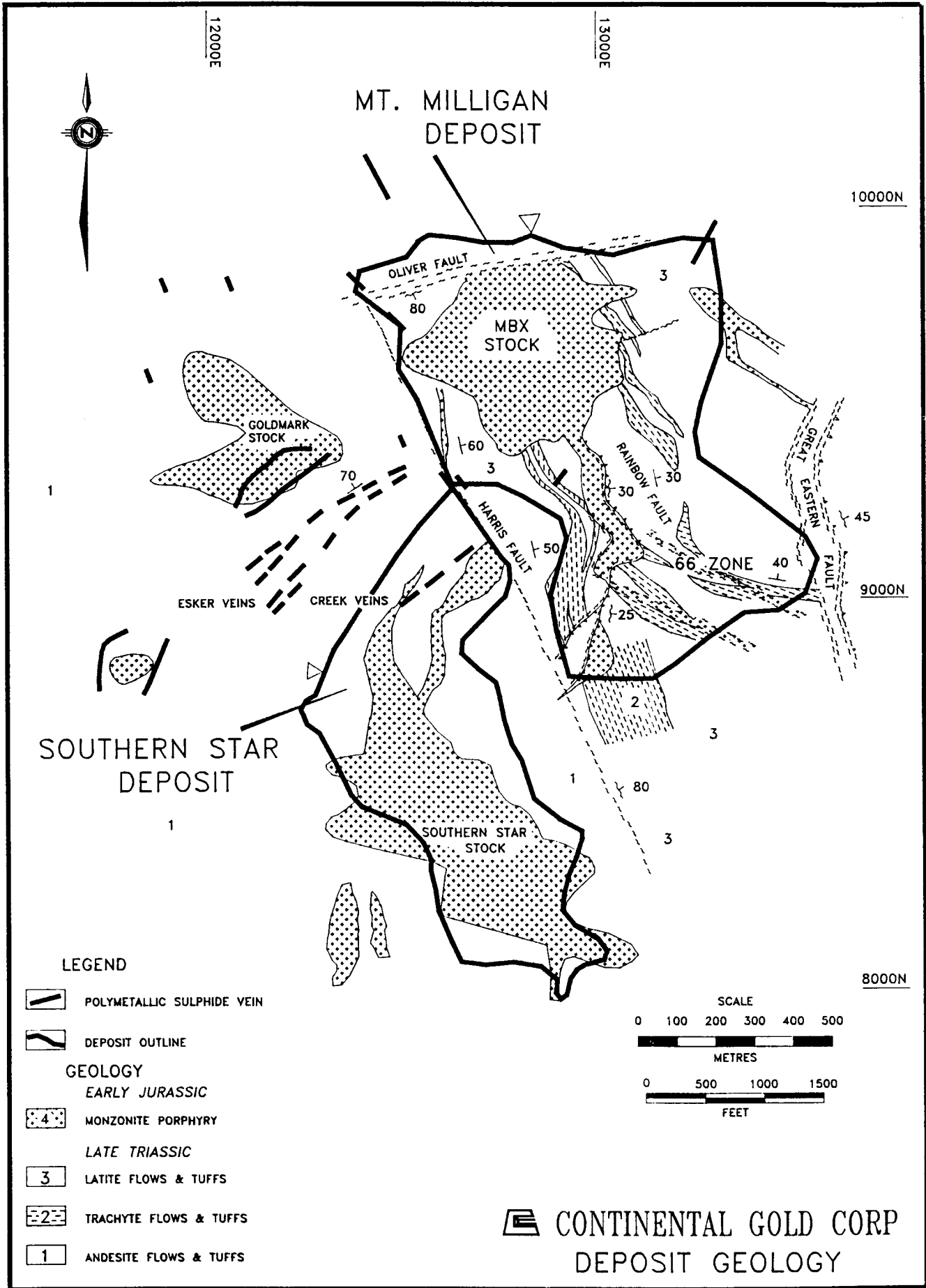

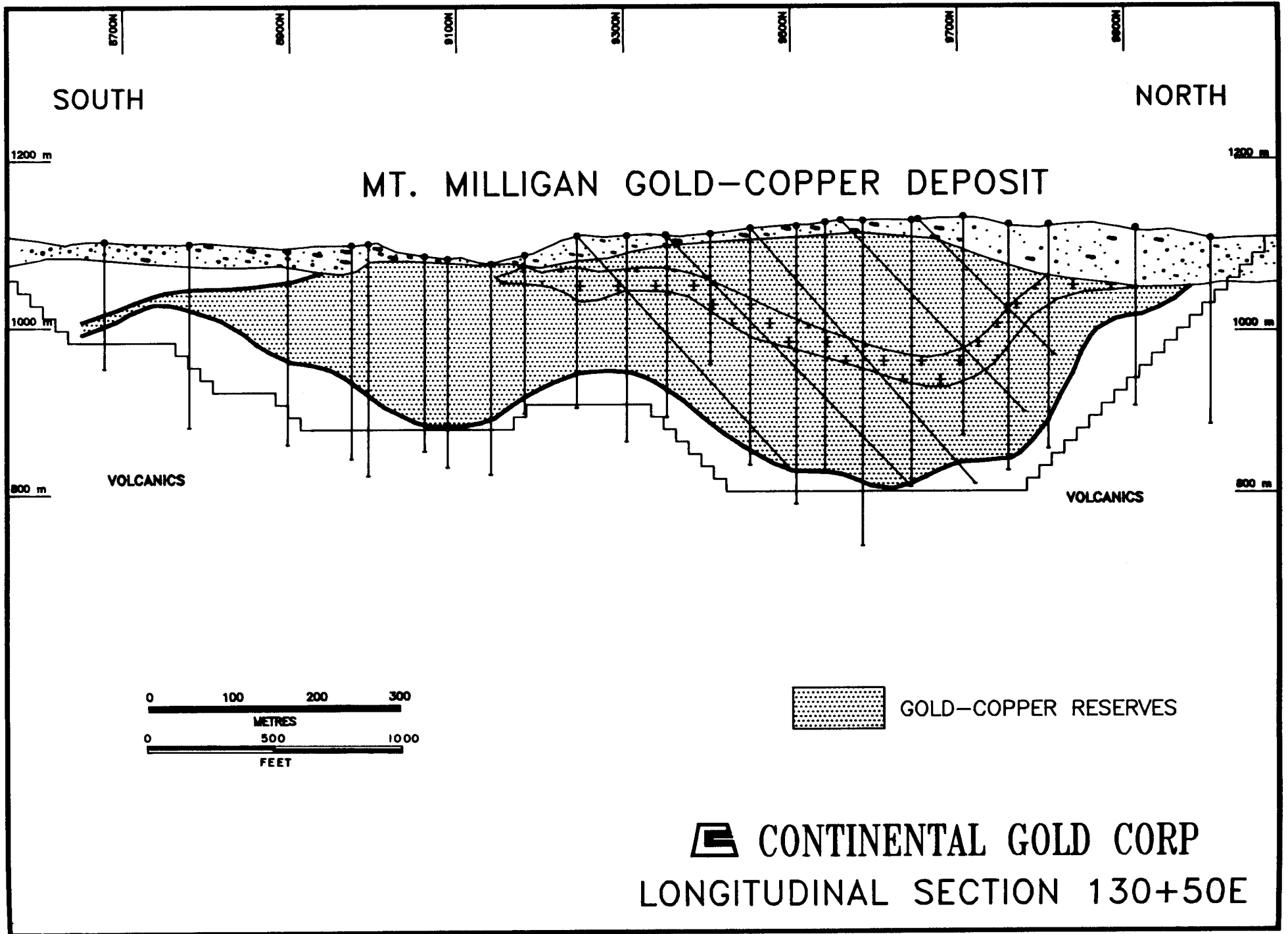

SOUTH

NORTH

MT. MILLIGAN GOLD-COPPER DEPOSIT

1200 m

1200 m

1000 m

1000 m

800 m

800 m

VOLCANICS

VOLCANICS

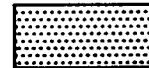
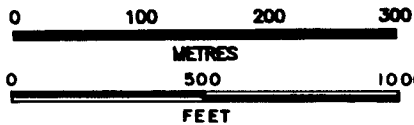

GOLD-COPPER RESERVES



CONTINENTAL GOLD CORP

LONGITUDINAL SECTION 130+50E

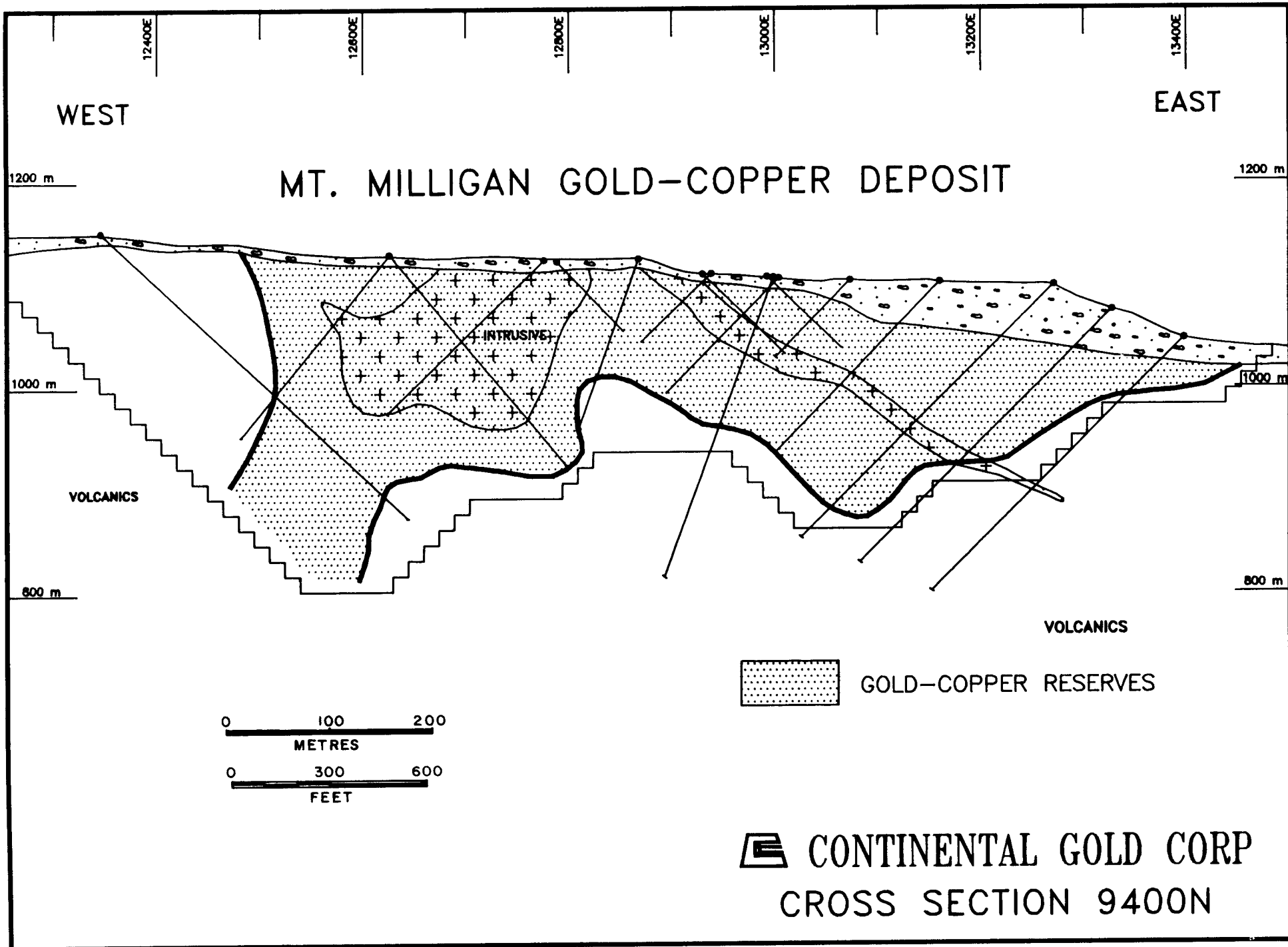

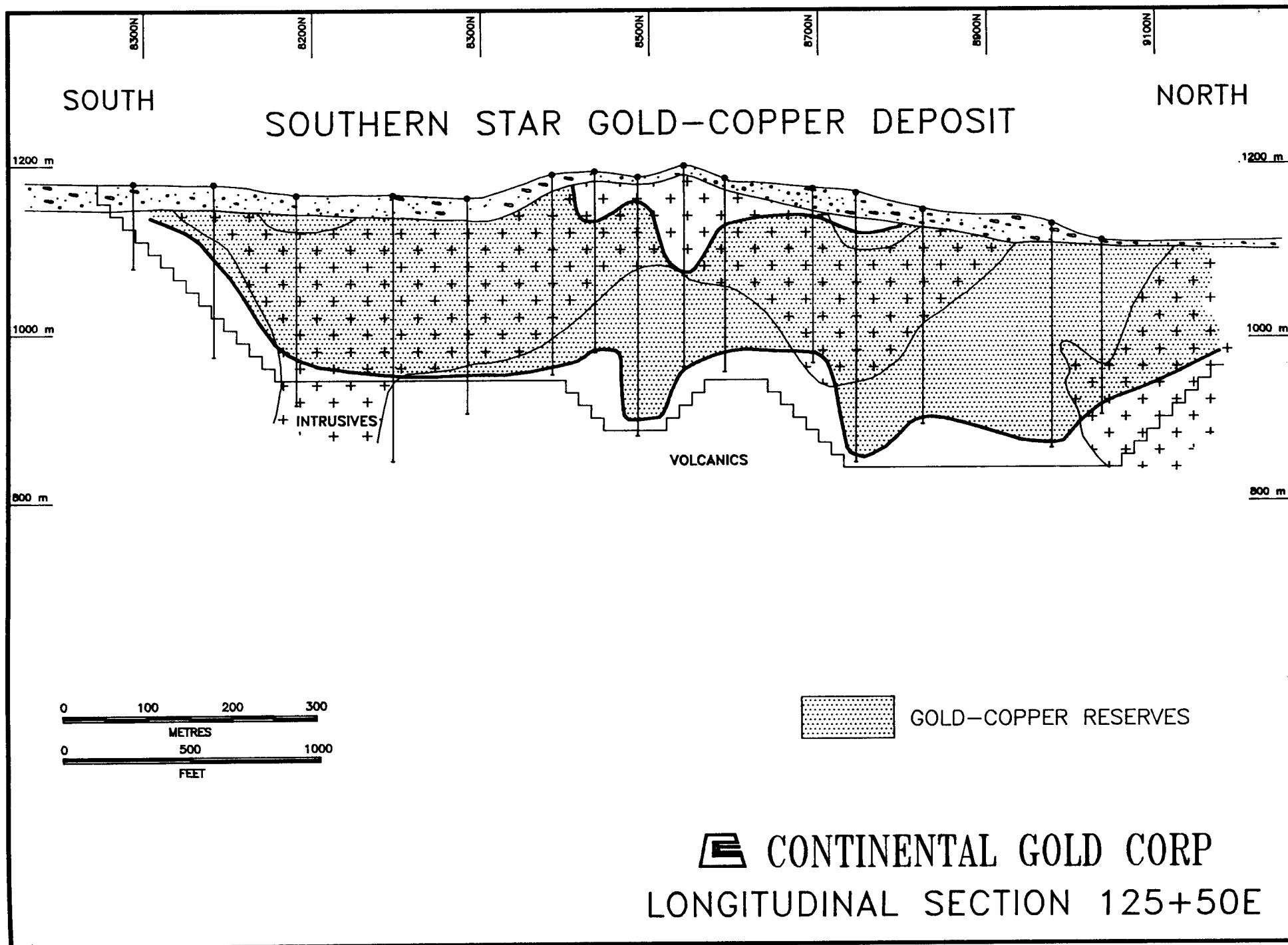

MBX ZONE DEEP DRILL HOLE ASSAY SUMMARY

SECTION LINE	HOLE	INTERCEPT WIDTH (FEET)	GRADE	
			COPPER %	GOLD oz/ton
9300N	89-354	775	0.31	0.017
	89-360	1266	0.27	0.016
	89-380	847	0.37	0.014
9400N	88-42	570	0.28	0.023
	88-60	460	0.41	0.047
	89-98	244	0.61	0.022
	89-99	665	0.31	0.024
	89-164	663	0.25	0.016
	89-170	335	0.35	0.027
9450N	89-223	348	0.29	0.015
	89-291	709	0.34	0.106
	89-295	839	0.38	0.018
	89-300	918	0.31	0.023
	89-306	654	0.23	0.024
	89-368	1202	0.44	0.020
9500N	88-68	884	0.39	0.017
	89-80	400	0.22	0.023
	89-105	679	0.47	0.023
	89-174	538	0.36	0.022
	89-176	722	0.42	0.016
9550N	89-201	866	0.37	0.018
	89-209	755	0.50	0.015
	89-211	308	0.43	0.021
	89-383	492	0.28	0.011
	89-391	1254	0.26	0.014
9600N	88-70	818	0.37	0.015
	89-76	841	0.24	0.012
	89-123	527	0.38	0.014
	89-175	676	0.33	0.019
	89-177	686	0.32	0.016
	89-178	391	0.37	0.015
9700N	88-65	545	0.38	0.012
	89-112	814	0.37	0.017
9800N	88-67	380	0.26	0.012
	89-115	725	0.32	0.019
	89-120	588	0.48	0.015
	89-122	674	0.48	0.017
	89-135	596	0.49	0.026
	89-140	436	0.45	0.012
	AVERAGE	677 FEET	0.36%	0.021 oz/ton

66 ZONE DRILL HOLE ASSAY SUMMARY

SECTION LINE	HOLE	INTERCEPT WIDTH (FEET)	GRADE	
			COPPER %	GOLD oz/ton
8900N	89-150	194	0.15	0.029
8975N	89-308	164	0.11	0.054
	89-353	781	0.02	0.027
9000N	89-101	213	0.07	0.038
	89-104	158	0.01	0.023
	89-116	184	0.04	0.039
	89-132	187	0.04	0.049
9070N	89-243	945	0.03	0.014
	89-249	400	0.08	0.030
	89-257	230	0.06	0.025
	89-334	428	0.02	0.029
9100N	89-88	381	0.06	0.042
	89-92	361	0.02	0.052
	89-108	237	0.33	0.028
	89-232	255	0.06	0.066
9150N	89-180	387	0.17	0.033
	89-184	369	0.02	0.099
	89-193	379	0.16	0.017
	89-270	517	0.04	0.022
9200N	88-66	258	0.05	0.062
	89-83	263	0.01	0.038
	89-84	284	0.06	0.063
	89-103	321	0.21	0.045
	89-163	318	0.06	0.021
	89-272	767	0.08	0.023
	89-284	249	0.16	0.036
9250N	89-373	1069	0.21	0.036
9270N	89-285	585	0.09	0.030
9300N	88-61	169	0.10	0.073
		246	0.12	0.045
	89-74	102	0.07	0.035
	89-77	308	0.17	0.045
9350N	89-314	669	0.21	0.026
9400N	88-29	268	0.09	0.069
	88-62	223	0.15	0.017
9500N	89-119	243	0.08	0.023
	AVERAGE	364 FEET	0.10%	0.036 oz/ton

SOUTHERN STAR ZONE DRILL HOLE ASSAY SUMMARY

SECTION LINE	HOLE	INTERCEPT WIDTH (FEET)	GRADE	
			COPPER %	GOLD oz/ton
8100N	89-350	263	0.25	0.017
	89-359	249	0.30	0.014
8150N	89-393	499	0.22	0.014
8200N	89-217	469	0.24	0.016
8300N	89-288	420	0.23	0.011
	89-298	601	0.31	0.026
	89-299	171	0.44	0.017
8400N	89-214	131	0.42	0.013
	89-278	151	0.57	0.033
	89-339	341	0.25	0.013
	89-362	334	0.27	0.010
	89-403	518	0.22	0.009
8500N	89-273	499	0.25	0.007
	89-330	597	0.27	0.008
	89-405	105	0.27	0.007
8600N	89-230	446	0.32	0.009
	89-244	486	0.27	0.005
	89-363	492	0.41	0.009
	89-365	243	0.34	0.011
8700N	89-265	230	0.21	0.012
	89-336	276	0.25	0.012
8750N	89-244	486	0.28	0.004
8800N	89-402	112	0.33	0.008
8850N	89-212	302	0.35	0.008
	89-252	289	0.28	0.004
8950N	89-256	453	0.43	0.010
	89-335	315	0.34	0.006
	89-394	682	0.31	0.006
9050N	89-342	203	0.23	0.010
	AVERAGE	357 FEET	0.30%	0.011 oz/ton

MT. MILLIGAN DEPOSIT METALLURGICAL TEST RESULTS

STANDARD FLOTATION COPPER CONCENTRATE PRODUCTION

	HEAD ASSAYS			CONCENTRATE GRADE		RECOVERY	
	WORK INDEX	Cu%	Au oz/ton	Cu%	Au oz/ton	Cu%	Au%
MBX	11.3	0.29	0.015	27	1.23	87.7	79.3
66	11.3	0.06	0.033	13	5.80	87.1	72.8
STARTER PIT	10.7	0.27	0.028	27	2.70	86.4	81.9
COMPOSITE	11.0	0.24	0.019	22	1.50	88.2	77.0

1. COARSE PRIMARY GRIND OF ORE TO 55% MINUS 200 MESH
2. BULK SULPHIDE FLOTATION CONCENTRATE
3. FINE GRIND OF BULK CONCENTRATE (10% OF MILL FEED) TO 95% MINUS 400 MESH
4. FLOTATION OF GOLD BEARING COPPER CONCENTRATE AS ABOVE

FURTHER MODEST INCREASES TO RECOVERY OF GOLD AND COPPER ARE EXPECTED WITH OPTIMIZATION WORK UNDERWAY.

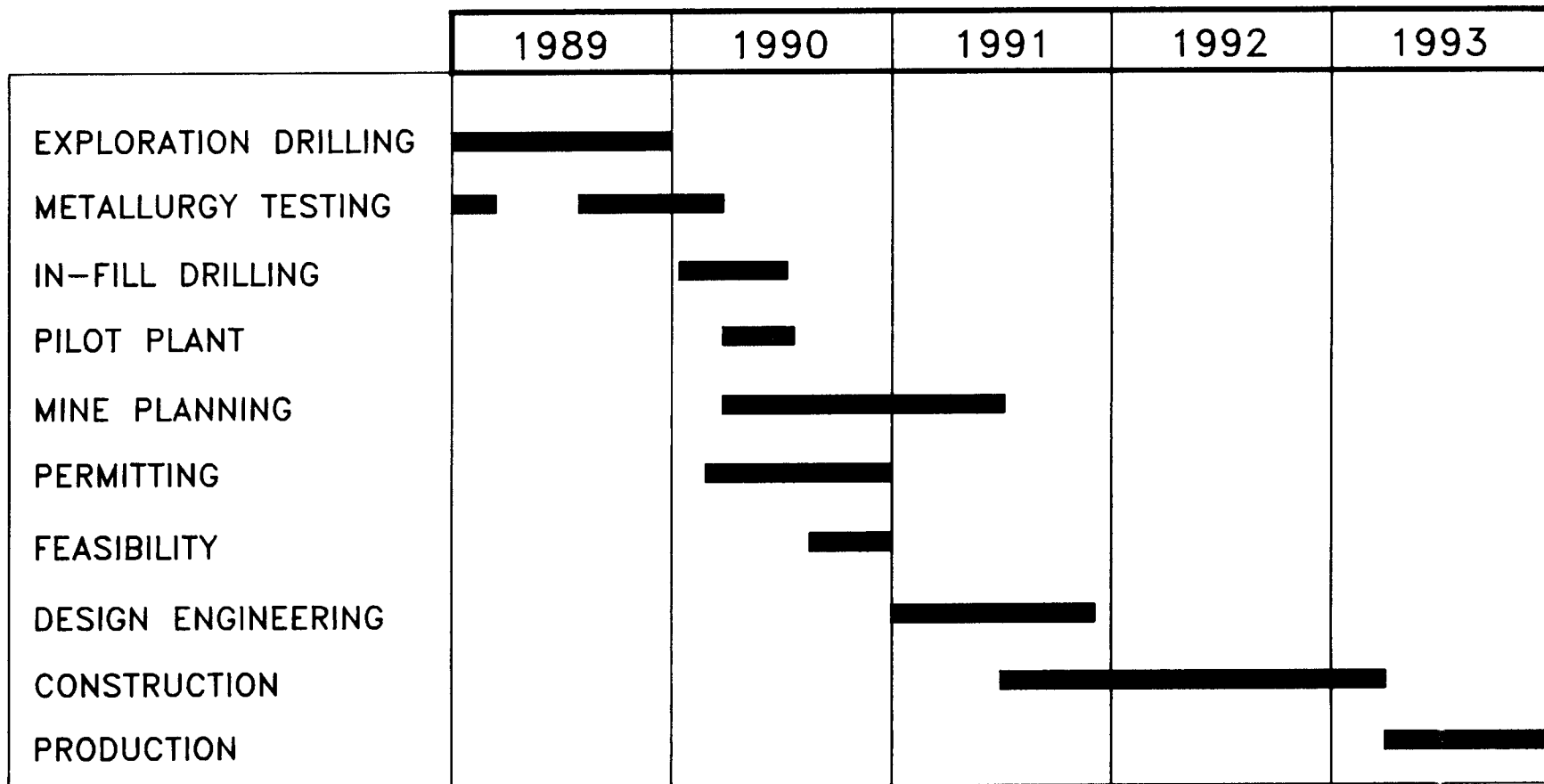

 CONTINENTAL GOLD CORP
DEVELOPMENT SCHEDULE

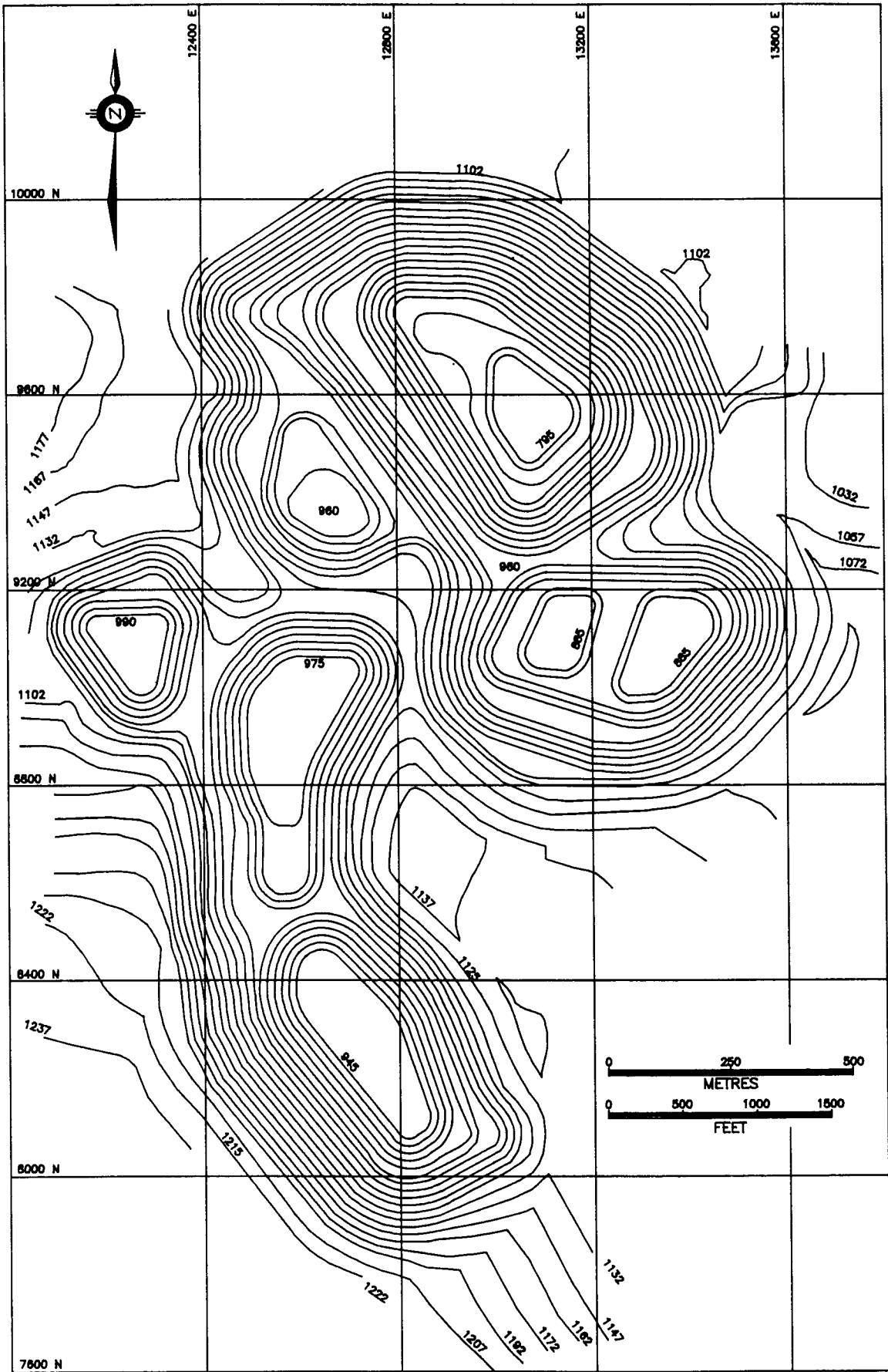

 CONTINENTAL GOLD CORP
OPEN PIT PLAN

MT. MILLIGAN MINE MODEL

MILLING RATE (tons/day)	60,000
MILLING RATE (tons/year)	22,000,000
MINE LIFE (years)	15+
PROJECT CAPITAL COSTS (C\$)	325,000,000
OPERATING COSTS (C\$/ton)	4.50

PROJECTED ANNUAL OPERATIONS

	ANNUAL AVERAGE YEAR 1-5	ANNUAL AVERAGE YEAR 1-10	ANNUAL AVERAGE YEAR 1-15
FEED GRADE GOLD (oz/ton)	0.023	0.019	0.016
FEED GRADE COPPER (%)	0.22	0.22	0.24
GOLD RECOVERY (%)	82	79	78
COPPER RECOVERY (%)	86	87	88
GOLD PRODUCTION (oz)	400,000	360,000	280,000
COPPER PRODUCTION (tons)	42,000	42,000	46,000
COST GOLD PRODUCTION (US \$/oz)	140	140	168
COST COPPER PRODUCTION (US \$/lb)	0.34	0.38	0.38
COST GOLD PRODUCTION (US \$/oz) (NET OF COPPER REVENUE)	33	40	45

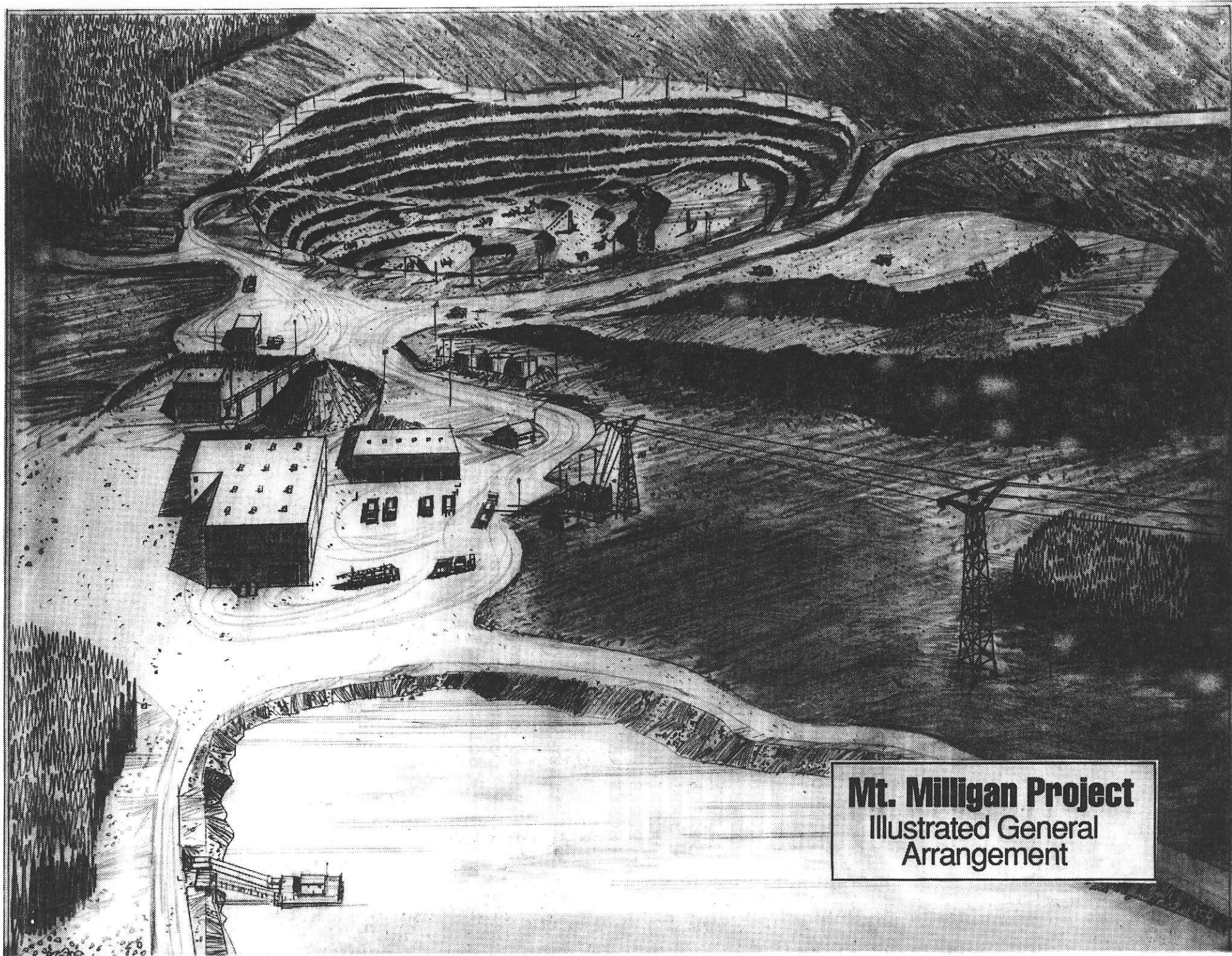

Mt. Milligan Project
Illustrated General
Arrangement

**CONTINENTAL GOLD CORP.
PROJECTED COST OF GOLD PRODUCTION
COMPARED TO LEADING NORTH AMERICAN GOLD PRODUCERS**

	<u>OPERATING COST</u> <u>(US \$/OZ GOLD)</u>	<u>MARKET CAP.</u> <u>(MM \$US)</u>
CONTINENTAL GOLD CORP. *	40	70
AMAX GOLD	105	1,300
HEMLO GOLD	120	1,500
BATTLE MOUNTAIN	135	1,300
CONTINENTAL GOLD CORP. **	140	70
FMC GOLD	150	860
TECK CORP.	175	1,900
FREEPORT GOLD	195	630
BOND INTERNATIONAL	202	730
CORONA CORP	210	1,400
ECHO BAY	210	2,100
NEWMONT GOLD	225	6,000
LAC MINERALS	227	1,700
PLACER DOME	232	5,000
CAMBIOR	235	370
AMERICAN BARRICK	240	2,300
PEGASUS	260	370
HOMESTAKE	275	2,200

* After copper credit at US \$1.00 per pound

** Based on revenue received for copper and gold

- Copper cost \$0.38 per pound

- Gold cost \$140 per ounce

**CONTINENTAL GOLD CORP.
PROJECTED ANNUAL PRODUCTION
COMPARED TO LEADING NORTH AMERICAN GOLD PRODUCERS**

	ANNUAL GOLD PRODUCTION (000 OZ)	MARKET CAP. (MM \$C)
NEWMONT GOLD	1,200	6,000
PLACER DOME	1,100	5,000
HOMESTAKE	1,020	2,200
ECHO BAY	720	2,100
CORONA CORP.	630	1,400
BOND INTERNATIONAL	498	730
AMERICAN BARRICK	450	2,300
HEMLO	410	1,500
FMC GOLD	410	860
TECK CORP.	400	1,900
BATTLE MOUNTAIN	348	1,300
LAC MINERALS	320	1,700
AMAX GOLD	303	1,300
PEGASUS GOLD	330	370
CONTINENTAL GOLD CORP. *	280	70
FREEPORT GOLD	248	630
CAMBIOR	171	370

* Plus 58,000,000 pounds of copper

**CONTINENTAL GOLD CORP. RESERVES
 COMPARED TO
 LEADING NORTH AMERICAN GOLD PRODUCERS**

	RESERVES (000 OZ. AU)	MARKET CAP. (MM \$US)
NEWMONT GOLD	20,000	6,000
PLACER DOME	18,000	5,000
AMERICAN BARRICK	18,000	2,300
ECHO BAY	12,500	2,100
HOMESTAKE	10,200	2,200
HEMLO	6,600	1,500
LAC MINERALS	5,400	1,700
CORONA CORP.	4,900	1,400
BOND INTERNATIONAL	4,700	730
TECK CORP.	4,600	1,900
CONTINENTAL GOLD*	4,400	70
PEGASUS	3,500	370
FREEPORT	2,700	630
BATTLE MOUNTAIN	2,600	1,300
FMC GOLD	2,500	860
AMAX GOLD	2,200	1,300
CAMBIOR	1,800	370

* Plus 1,200,000,000 pounds of copper

PROJECTED MT. MILLIGAN PRODUCTION
COMPARED WITH MAJOR CANADIAN GOLD MINES

	OUNCES/YEAR
PAGE-WILLIAMS	490,000
MT. MILLIGAN *	400,000
GOLDEN GIANT	390,000
DAVID BELL	300,000
CAMPBELL	240,000
DOYON	230,000
LUPIN	200,000
DOME	120,000
DETOUR	120,000
BOUSQUET	110,000
PARMOUR	95,000

* Plus 83,000,000 pounds copper