

To BH
For background
data only
AS

92 H/8

800560

GEOLOGICAL REPORT
on
MINERAL CLAIMS
in the
HEDLEY DISTRICT
OSOYOOS MINING DIVISION

49° 21' North Latitude
120° 8' West Longitude

for

BANBURY GOLD MINES LTD.

to augment
report dated

April 9, 1979

September 28, 1979

TABLE OF CONTENTS

	<u>Page</u>
Introduction	1
Exploration 1979	1
Conclusions	3
Recommendations	4
Cost Estimate for Proposed Program	5

APPENDICES

Appendix "A"	Property Map
Appendix "B"	Topographic and Location Map
Appendix "C"	Map of Workings on Martin Vein
Appendix "D"	Vertical Projection through Martin Vein
Appendix "E"	Tabulation of Sample and Assay Data
Appendix "F"	Assay Certificates
Appendix "G"	Certificate W.G. Stevenson, P. Eng.

INTRODUCTION

On March 24, 1979 W.G. Stevenson & Associates Ltd. was commissioned by Banbury Gold Mines Ltd. to make an examination, appraise the mineral potential and recommend a program of exploration to test the potential of a gold prospect they hold in the Hedley District, Osoyoos Mining Division in southeastern B.C.

My report dated April 9, 1979, written in behalf of Banbury Gold Mines Ltd. proposed a program of geological mapping, sampling, diamond drilling, and the opening and rehabilitating of existing tunnels, at a cost estimated at \$45,000.

During the 1979 field season Banbury Gold Mines initiated a program of exploration.

In August 1979, W.G. Stevenson & Associates Ltd. was commissioned by Banbury Gold to visit the property, review the work which had been accomplished and to recommend a course of action. To accomplish this assignment, I spent the period August 31 to September 2, 1979 on the Banbury property in company with Mr. Douglas Dewar, President, and Mr. William Puckering, P. Eng., Director of Banbury Gold Mines Ltd.

EXPLORATION 1979

During the period March 24 - August 31, 1979 the existing wagon trail up the mountain was made passable to 4 wheel drive vehicles, dozer roads and trenches were put down

across part of the property and 4 diamond drill holes for a total of 605 feet of drilling was accomplished. Three of these holes had been completed, work was continuing on the fourth at the time of my examination.

One of these drill holes was put down near the portal of the lower Maple Leaf Tunnel, one drill hole put down approximately 1700 feet southerly and two drill holes put down to test the Martin vein approximately 900 feet east of the portal of the lower Maple Leaf Tunnel.

During the time I was on the property I logged the drill core, collected core and sludge samples from the drill holes and compiled a geological map and section. In addition I collected samples from the surface and the underground workings near the Maple Leaf Vein.

The attached maps marked appendix "B and C" shows the position of the diamond drill holes and dozer trenches. The attached cross section marked appendix "D" constructed through diamond drill hole number 4, shows the relative position of the old workings, the diamond drill hole and the samples of diamond drill core and sludge which I collected. The attachment marked appendix "E" is a tabulation of data pertinent to the samples I collected and their assay results. The attachments marked appendix "F" are photocopies of the assay certificates.

The sites where diamond drill holes could be positioned were restricted by topography and effective penetration of the Maple Leaf and Martin Veins were

impaired by the sites which were selected. A recommendation has been made that dozer trails be cut to gain access to better drill site positions.

The drilling which has been accomplished on the Martin Vein has penetrated the vein 65 feet beyond the lowest workings on this vein. Assays of samples collected over a core length of 18 feet from 115 to 133 feet average 0.86 oz. gold per ton. Sludge assays collected over 30 feet through the interval 113 - 143 feet, assayed 0.53 oz. gold per ton. One other mineralized intercept over a core length of 2 feet, from 70 - 72 feet, assayed 6.44 oz. gold per ton and 2.15 oz. silver per ton.

A composite sample of the mineralization in the core from drill hole number 4 from 115 to 133 feet and a sample of sludge from drill hole number 3 through the interval 160 - 230 feet have been analysed spectrographically. Photocopies of each of these spectrographic analyses marked appendix "F" are attached.

I have proposed that a dozer road be cut so that a drill can be moved to a site to be established at or near the location shown on the attached cross section. Drill holes from the site can be used to assess the downward extension of the Martin Vein.

CONCLUSIONS

1. A drill hole put down to test mineralization beyond workings on the Martin Vein penetrated 2 mineralized zones which assayed:

(1) 70 - 72' 2 feet 6.44 oz. gold per ton and 2.15 silver per ton and (2) 115 - 133' 18 feet 0.86 oz. gold per ton and 0.1 oz. silver per ton.

2. The 18 foot interval is 65 feet beyond the deepest workings on the Martin Vein.

3. As the drill hole was collared on and put down in the plane of the Martin Vein, the true width of the vein has not been determined.

4. It will be necessary to provide access to drill sites west of the old workings and the current drill site, to properly appriase the Martin Vein.

5. Some of the assays of samples which I collected from the surface, showed significant gold values.

6. It is imperative that geological mapping be accomplished over the property and in the accessible mine workings to properly guide future exploration.

RECOMMENDATIONS

1. Compile a Topographic map from existing air photographs.
2. Map and sample the underground workings.
3. Conduct a program of geological mapping and prospecting over the property.
4. Cut dozer roads to gain access for drill sites to properly test the Martin, Maple Leaf and other veins.
5. Put down drill holes from the sites which have been prepared.

6. Depending on the results obtained from this program, additional drilling, geological mapping and metallurgical testing may be warranted.

COST ESTIMATE FOR PROPOSED PROGRAM (phase two, revised)

1. Compilation of Topographic Map from existing air Photographs	\$1,000
2. Geological mapping, prospecting, sampling and assaying, surface and underground workings	5,000
3. Dozer road construction for drill site locations.	5,000
4. Program of diamond drilling Martin, Maple Leaf and other veins (3,000 feet at \$20.00/foot).....	60,000
5. Contingencies at 20%	<u>14,200</u>
Total	<u><u>\$85,200</u></u>

Depending on the results obtained during this phase of the program additional drilling, mapping, sampling assaying and metallurgical testing may be warranted.

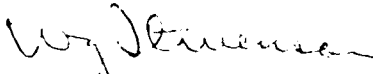
Respectfully submitted
W.G. STEVENSON & ASSOCIATES LTD.

W.G. Stevenson, P. Eng.

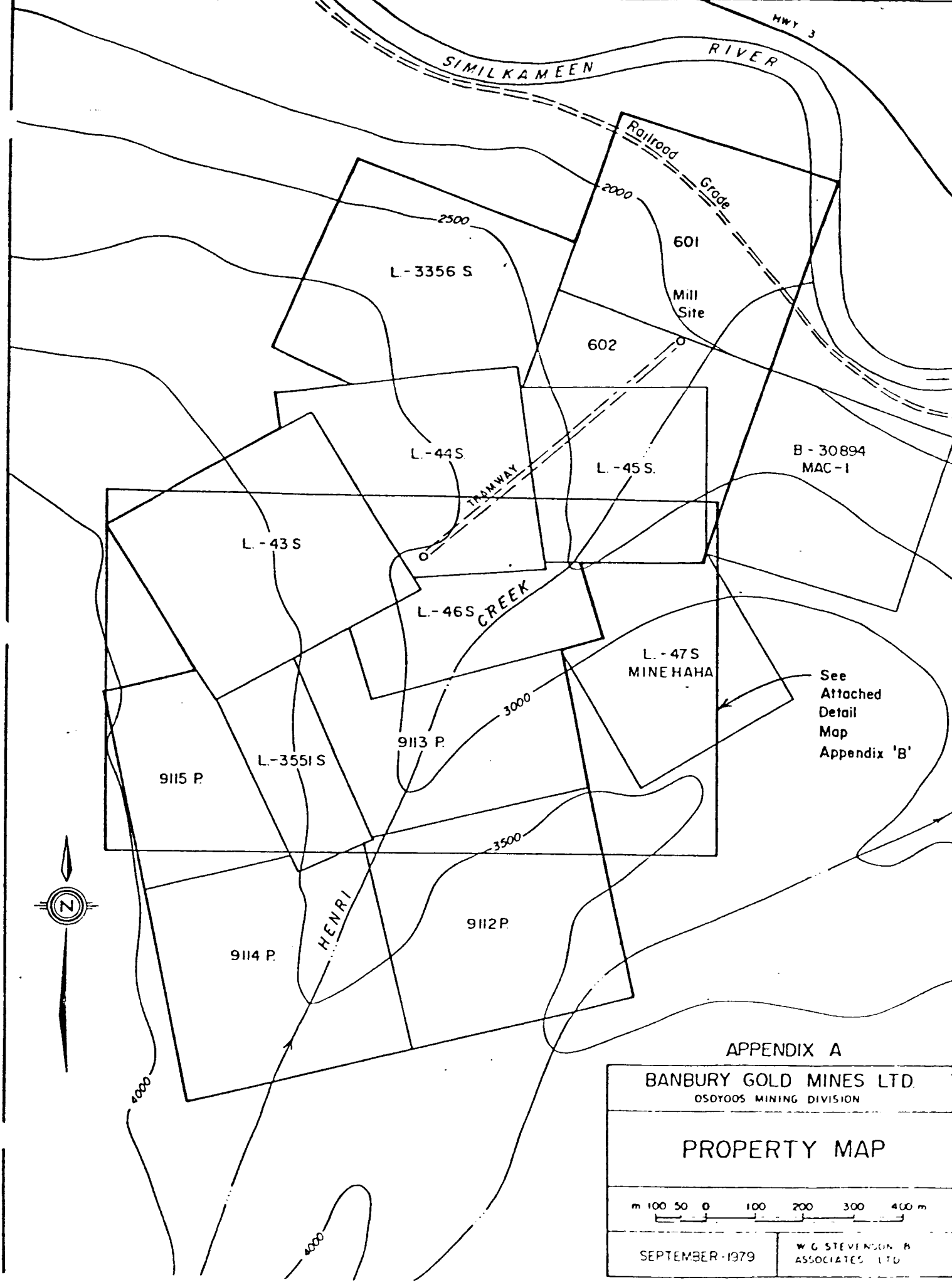
Vancouver, B.C.
September 28, 1979



HWY 3

SIMILKAMEEN RIVER

Railroad Grade

L-3356 S

601
Mill Site

602

L-44 S

L-45 S

B-30894
MAC-1

L-43 S

TRAYWAY

L-46 S
CREEK

L-47 S
MINEHAHA

See
Attached
Detail
Map
Appendix 'B'

9113 P

L-3551 S

9115 P

3000

3500



9114 P

HENRI

9112 P

4000

4000

APPENDIX A

BANBURY GOLD MINES LTD.
OSOYOOS MINING DIVISION

PROPERTY MAP

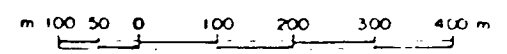

SEPTEMBER 1979

W G STEVENSON &
ASSOCIATES LTD

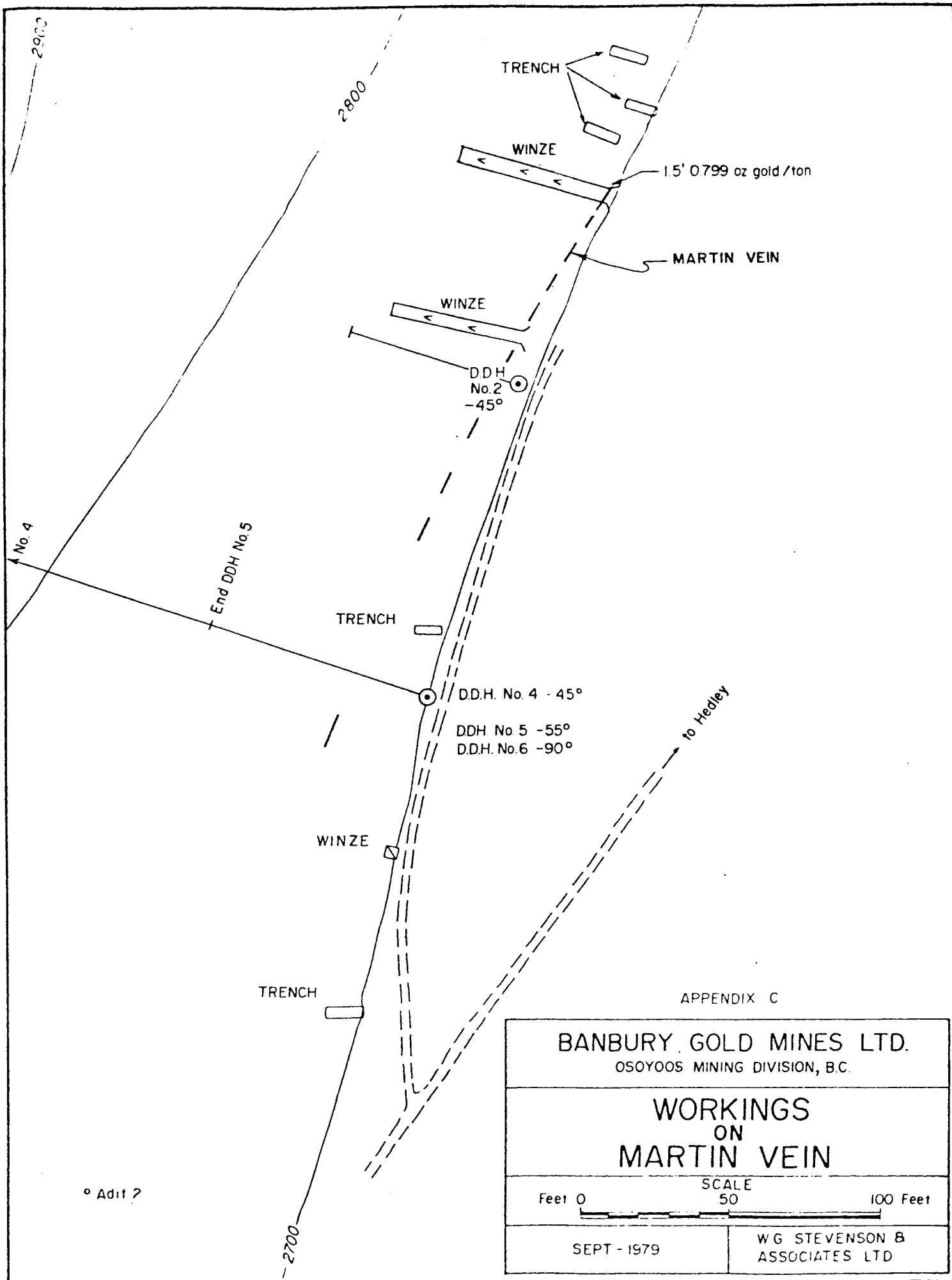

APPENDIX C

BANBURY GOLD MINES LTD. OSOYOOS MINING DIVISION, B.C.	
WORKINGS ON MARTIN VEIN	
SCALE Feet 0 0 100 Feet 	
SEPT - 1979	W.G. STEVENSON & ASSOCIATES LTD

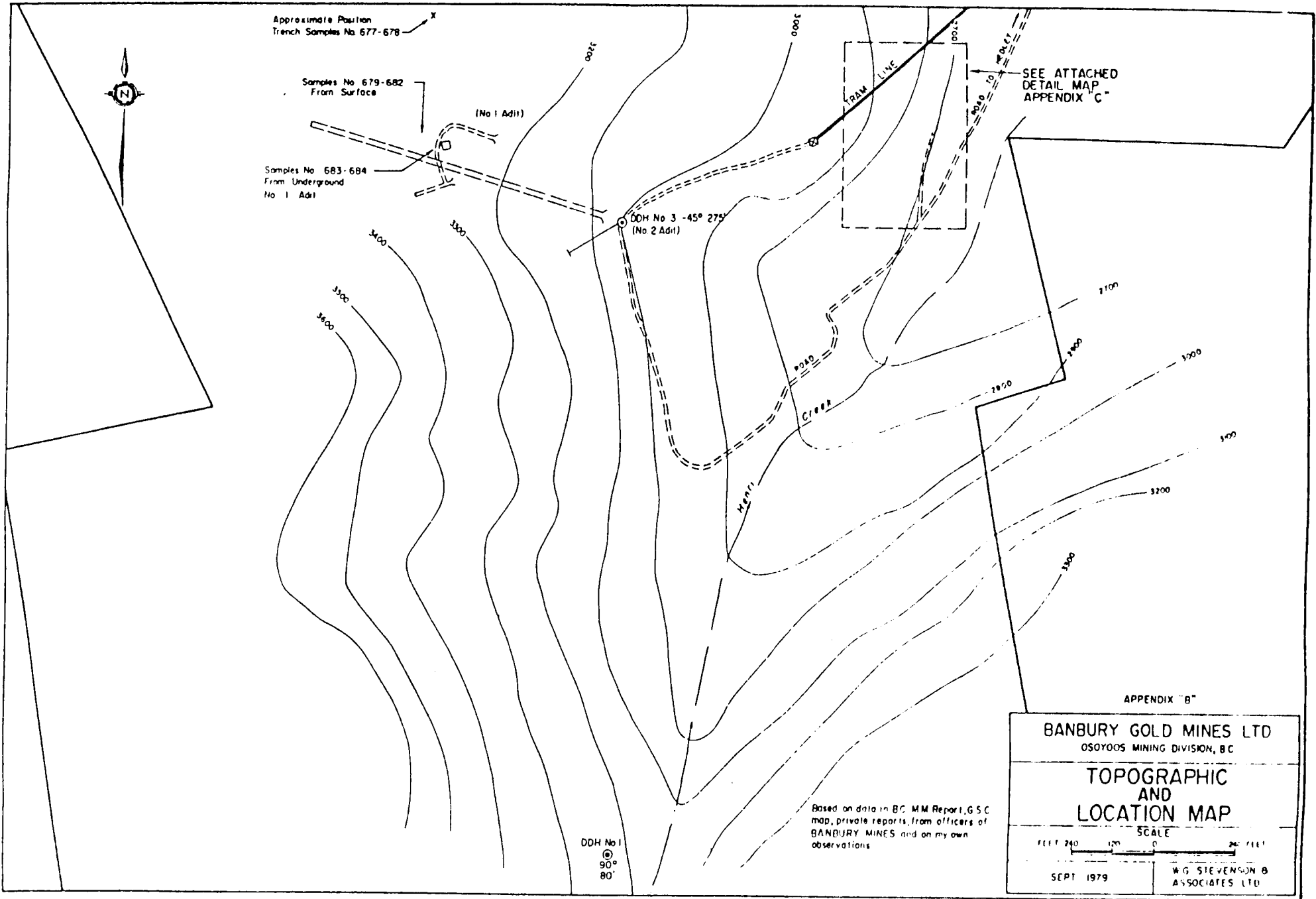

Approximate Position
Trench Samples No. 677-678

Samples No. 679-682
From Surface

(No 1 Adit)

Samples No. 683-684
From Underground
No. 1 Adit

DDH No. 3 - 45° 275'
(No. 2 Adit)

SEE ATTACHED
DETAIL MAP
APPENDIX "C"

APPENDIX "B"

BANBURY GOLD MINES LTD
OSOYOOS MINING DIVISION, B.C.

TOPOGRAPHIC
AND
LOCATION MAP

SCALE

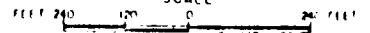

SEPT 1979

W.G. STEVENSON &
ASSOCIATES LTD

Based on data in B.C. M.M. Report, G.S.C.
map, private reports, from officers of
BANBURY MINES and on my own
observations

DDH No. 1
©
90°
80'

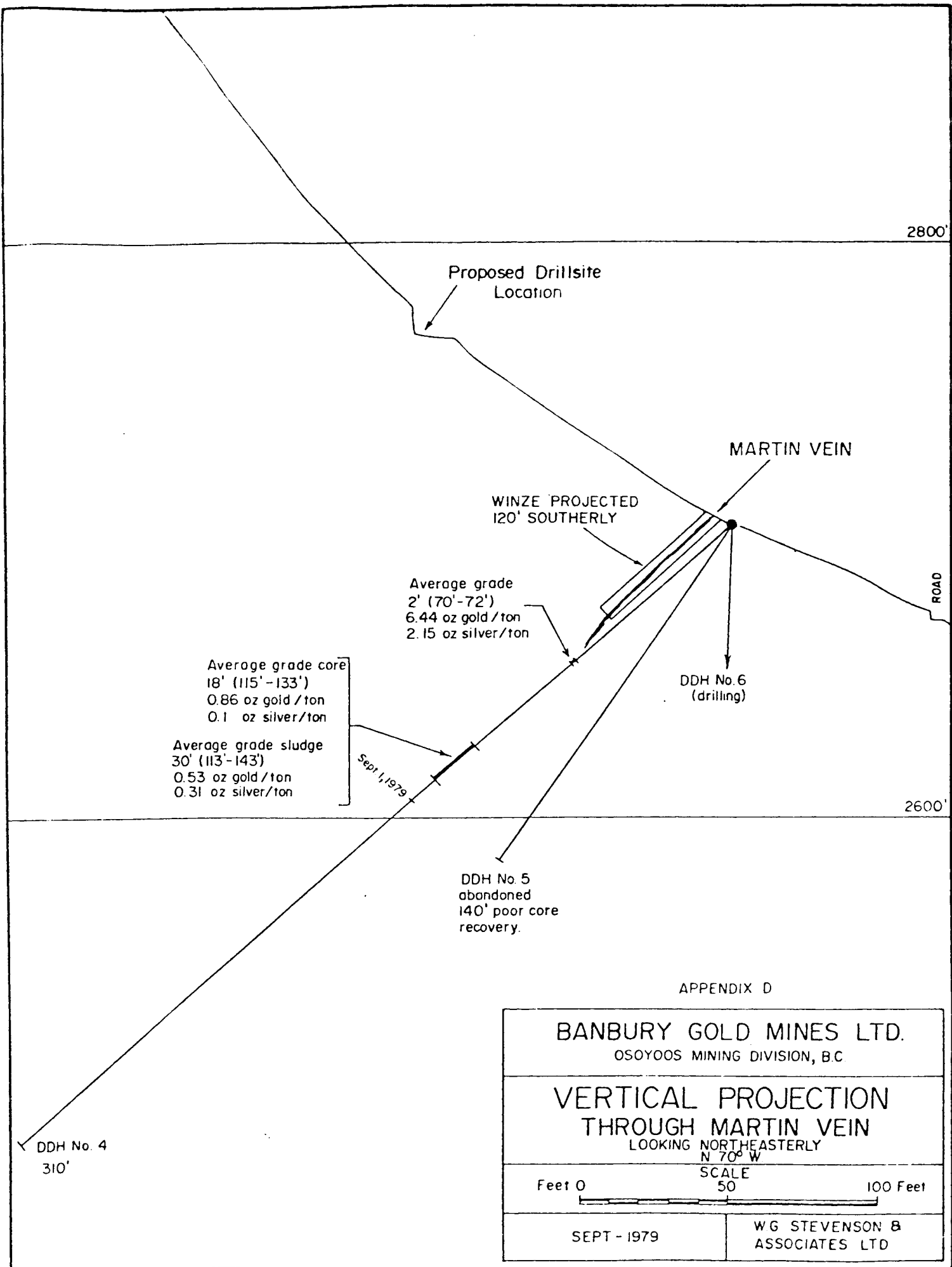

Tabulation of sample and assay data to accompany Geological Report dated September 21, 1979, by W.G. Stevenson & Associates Ltd. mineral claims Hedley District Osoyoos MD British Columbia for Banbury Gold Mines Ltd.

SAMPLE NUMBER	LOCATION	WIDTH	DESCRIPTION	OZ. PER TON	
				GOLD	SILVER
676	Approximately 850' NW of #692	specimen	White Clay	0.006	Tr
677	2000' SSE of #676	1 1/2'	vein	0.012	Tr
678	1000' SE of #677	1 1/2'	vein	0.696	0.10
679	3000' SSE of #678	3'	Quartz Breccia	0.126	Tr
680	3000' West of #679	4 1/2'	Quartz Breccia	0.040	Tr
681	1550' North of #679	5'	Quartz Breccia	0.014	Tr
682	3000' NE of #679	2'	Quartz Breccia	0.108	Tr
683	Maple Vein Under-ground	2'	Shear Zone	0.001	Tr
684	Maple Vein Under-ground	2'	Shear Zone	0.006	Tr
685	Martin Vein #4 hole drill core	2'	'70-72'	6.440	2.15
686	Martin Vein #4 hole drill core	5'	115-120'	1.756	0.33
687	Martin Vein #4 hole drill core	5'	120-125'	1.004	0.04
688	Martin Vein #4 hole drill core	8'	125-133'	0.216	Tr
689	Sludge #4 hole	10'	113-123	1.199	0.95
690	Sludge #4 hole	10'	123-133'	0.308	Tr
691	Sludge #4 hole	10'	133-143'	0.080	Tr
692	Maple Vein #3 hole Sludge	70'	160-230'	0.030	Tr
693	#1 Hole Core	specimen	@62'	0.016	Tr
694	Martin Vein #2 hole Sludge	35'	32-67'	0.022	Tr
695	Martin Vein #2 hole Core	5'	37-42'	0.080	0.20

Spectrographic analysis

686, 687, 688

692

Appendix "E"

GENERAL TESTING LABORATORIES

DIVISION SUPERINTENDENCE COMPANY (CANADA) LTD

1801 EAST PENDER ST. VANCOUVER, B.C., CANADA V6A 1W2
PHONE (604) 254-1847 TELEX 04-507314 CABLE SUPERVISE

TO:
W.G. STEVENSON & ASSOCIATES LTD.
 609 - 475 Howe Street
 Vancouver, B.C.
 V6C 2B3

CERTIFICATE OF ASSAY

No.: 7909-0458 DATE: Sept. 11/79

We hereby certify that the following are the results of assays on: Ore

MARKED	GOLD	SILVER	XXX	XXX	XXX	XX	XX	XX
	oz/st	oz/st						
E-18200								
676	0.006	trace						
677	0.012	trace						
678	0.696	0.10						
679	0.126	trace						
680	0.040	trace						
681	0.014	trace						
682	0.108	trace						
683	0.001	trace						
684	0.006	trace						
685	6.440	2.15						
686	1.756	0.33						
687	1.004	0.04						
688	0.216	trace						
689	1.199	0.95						
690	0.308	trace						
691	0.080	trace						
692	0.030	trace						
693	0.016	trace						
694	0.022	trace						
695	0.080	0.20						
* Spectrographic analyses to follow.								
						APPENDIX "F"		

NOTE: REJECTS RETAINED ONE MONTH PULPS RETAINED THREE MONTHS ON REQUEST
PULPS AND REJECTS WILL BE STORED FOR A MAXIMUM OF ONE YEAR.

ALL REPORTS ARE THE CONFIDENTIAL PROPERTY OF CLIENTS. PUBLICATION OF STATEMENTS CONCLUSION OR EXTRACTS FROM OR REGARDING OUR REPORTS IS NOT PERMITTED WITHOUT OUR WRITTEN APPROVAL. ANY LIABILITY ATTACHED THERETO IS LIMITED TO THE FEE CHARGED.

L. Wong

PROVINCIAL ASSAYER

Analytical and Consulting Chemists, Bulk Cargo Specialists, Surveyors, Inspectors, Samplers, Weighers

MEMBER American Society For Testing Materials - The American Oil Chemists Society - Canadian Testing Association
REFEREE AND OR OFFICIAL CHEMISTS FOR NATIONAL INSTITUTE OF CHEESE PRODUCTS - The American Oil Chemists Society
OFFICIAL WEIGHMASTERS FOR VANCOUVER BOARD OF TRADE

GENERAL TESTING LABORATORIES

DIVISION SUPERINTENDENCE COMPANY (CANADA) LTD

1001 EAST PENDER STREET VANCOUVER 6 B.C. CANADA
PHONE (604) 254-1647 TELETYPE 507514 CABLE SUPERVISE

SEMI QUANTITATIVE SPECTROGRAPHIC ANALYSES CERTIFICATE

TO:
V.G. STEVENSON & ASSOCIATES LTD.
609 - 475 Howe Street
Vancouver, B.C.
V6C 2B3

No.: 7909-0458

DATE: Sept. 25/79

We hereby certify that the following are the results of spectrographic analyses made on:

		1	2	3	4	5	SAMPLE No.	DESCRIPTION
Aluminum	Al	3.					1	COMP - 686 - 687 - 688
Antimony	Sb	ND					2	
Arsenic	As	*					3	
Barium	Ba	0.05					4	
Beryllium	Be	ND					5	
Bismuth	Bi	ND						
Boron	B	ND						
Cadmium	Cd	ND						
Calcium	Ca	1.						
Chromium	Cr	ND						
Cobalt	Co	ND						
Copper	Cu	0.1						
Gallium	Ga	ND						
Gold	Au	TRACE						
Iron	Fe	5.						
Lead	Pb	*						
Magnesium	Mg	0.1						
Manganese	Mn	0.03						
Molybdenum	Mo	ND						
Niobium	Nb	ND						
Nickel	Ni	0.03						
Potassium	K	ND						
Silicon	Si	MATRIX						
Silver	Ag	TRACE						
Sodium	Na	TRACE						
Strontium	Sr	0.01						
Tantalum	Ta	ND						
Thorium	Th	ND						
Tin	Sn	ND						
Titanium	Ti	0.1						
Tungsten	W	ND						
Uranium	U	ND						
Vanadium	V	TRACE						
Zinc	Zn	*						

All results expressed as percentages

MATRIX — Major constituent
 MAJOR — Above normal spectrographic range
 TRACE — Detected but minor amounts
 N.D. — Not detected
 * — Suggest assay

NOTES: Rejects retained one month.
 Pulps retained three months.
 On request pulps and rejects will be stored for a maximum of one year.

ALL REPORTS ARE THE CONFIDENTIAL PROPERTY OF CLIENTS. PUBLICATION OF STATEMENTS, CONCLUSIONS OR EXTRACTS FROM OR REGARDING OUR REPORTS IS NOT PERMITTED WITHOUT OUR WRITTEN APPROVAL. ANY LIABILITY ATTACHED THERE TO IS LIMITED TO THE FEE CHARGED.

APPENDIX "F"

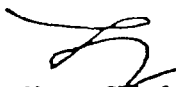
L. Wong, Chief Assayer

SIGNATURE AND TITLE

Analytical and Consulting Chemists, Bulk Cargo Specialists, Surveyors, Inspectors, Samplers, Weighers

MEMBER American Society For Testing Materials • The American Oil Chemists' Society • Canadian Testing Association
 REFEREE AND/OR OFFICIAL CHEMISTS FOR Vancouver Merchants Exchange • National Institute Of Ores And Minerals • The American Oil Chemists' Society
 OFFICIAL WEIGHMASTERS FOR Vancouver Board Of Trade • Vancouver Merchants Exchange

GENERAL TESTING LABORATORIES

DIVISION SUPERINTENDENCE COMPANY (CANADA) LTD

1001 EAST PENDER STREET VANCOUVER B.C. CANADA
PHONE (604) 254-1647 TELEX 04-507514 CABLE SUPERVISE

TO
W.G. STEVENSON & ASSOCIATES LTD.
609 - 475 Howe Street
Vancouver, B.C.
V6C 2B3

SEMI QUANTITATIVE SPECTROGRAPHIC ANALYSES CERTIFICATE

No.: 7907-0458 DATE: Sept. 25/79

We hereby certify that the following are the results of spectrographic analyses made on:

		1	2	3	4	5	SAMPLE No.	DESCRIPTION
Aluminum	Al	3.					1	692
Antimony	Sb	ND					2	
Arsenic	As	ND					3	
Barium	Ba	0.1					4	
Beryllium	Be	ND					5	
Bismuth	Bi	ND						
Boron	B	ND						
Cadmium	Cd	ND						
Calcium	Ca	1.						
Chromium	Cr	ND						
Cobalt	Co	ND						
Copper	Cu	0.01						
Gallium	Ga	ND						
Gold	Au	XXXXX (See assay)						
Iron	Fe	5.						
Lead	Pb	ND						
Magnesium	Mg	0.1						
Manganese	Mn	0.03						
Molybdenum	Mo	ND						
Niobium	Nb	ND						
Nickel	Ni	0.007						
Potassium	K	ND						
Silicon	Si	MATRIX						
Silver	Ag	TRACE						
Sodium	Na	ND						
Strontium	Sr	0.03						
Tantalum	Ta	ND						
Thorium	Th	ND						
Tin	Sn	ND						
Titanium	Ti	0.3						
Tungsten	W	ND						
Uranium	U	ND						
Vanadium	V	0.001						
Zinc	Zn	TRACE						

All results expressed as percentages

MATRIX — Major constituent
 MAJOR — Above normal spectrographic range
 TRACE — Detected but minor amounts
 N.D. — Not detected
 ★ — Suggest assay

NOTES: Rejects retained one month.
 Pulp retained three months
 On request pulps and rejects will be stored for a maximum of one year.

ALL REPORTS ARE THE CONFIDENTIAL PROPERTY OF CLIENTS. PUBLICATION OF STATEMENTS, CONCLUSION OR EXTRACTS FROM OR REGARDING OUR REPORTS IS NOT PERMITTED WITHOUT OUR WRITTEN APPROVAL. ANY LIABILITY ATTACHED THERETO IS LIMITED TO THE FEE CHARGED.

APPENDIX "F"

L. Wong, Chief Assayer
SIGNATURE AND TITLE

Analytical and Consulting Chemists, Bulk Cargo Specialists, Surveyors, Inspectors, Samplers, Weighers

MEMBER American Society For Testing Materials • The American Oil Chemists Society • Canadian Testing Association
 REFEREE AND/OR OFFICIAL CHEMISTS FOR Vancouver Merchants Exchange • National Institute Of Oiled Products • The American Oil Chemists Society
 OFFICIAL WEIGHMASTERS FOR Vancouver Board Of Trade • Vancouver Merchants Exchange

CERTIFICATE

I. William G. Stevenson, DO HEREBY CERTIFY:

1. That I am a Consulting Geological Engineer with offices at Suite 609, Crown Trust Building, 475 Howe Street, Vancouver, B.C.
2. That I am a graduate of the University of Utah, 1946, with a Bachelor of Science Degree.
3. That I am a registered Professional Engineer in the Association in British Columbia.
4. That I have practised my profession for more than 25 years.
5. That I have no direct, indirect or contingent interest in the mineral claims over the Henri Creek Gold Mine in Osoyoos Mining Division, British Columbia nor in the securities of Banbury Gold Mines Ltd. nor do I intend to receive any such interest.
6. That this report dated September 28, 1979 is based on examinations I conducted on March 24, August 31 and September 1, 1979, on a study of published and unpublished maps and reports and on discussions with officers of the company.

DATED at Vancouver, British Columbia, this
twenty eighth day of September, 1979.

W. G. STEVENSON & ASSOCIATES LTD.

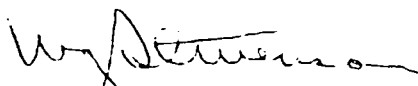

W.G. Stevenson, P. Eng.

Appendix "G"