

W. G. HAINSWORTH & ASSOCIATES LTD.

Mining Consultants

SUITE 905  
837 WEST HASTINGS STREET  
VANCOUVER, BRITISH COLUMBIA  
V6C 1B6 (604) 687-6930

800491

July 26, 1982

Amore Resources Inc.  
Mr. G.G. Grauer, President  
2000 - 609 Granville Street  
Vancouver, B.C.

Dear Mr. Grauer:

Re: Amoyette - Shunter Ag-Pb-Zn Showing  
Nelson Mining Division, Creston Area, B.C.

Referencing to the above showing examined by myself on July 12, 1982, the 36 claim group, broken into scattered groupings, lies 18 miles west of Creston along the Priest River within a mile of the International Boundary Line.

The first showing examined consisted of a blasted pit exposing quartz veinlets in a bluish-gray limestone. The general trend of the veinlets is slightly east of north (N12° E) which coincides with the regional trend of the sedimentaries in this particular area. Sulphides, mainly tetrahedrite with minor pyrite, were visible in the short gash-type veinlets but were not present in economic amounts. Copper staining was apparent throughout the showing. However, it should be recorded that copper oxidation (malachite and azurite) can spread over a large area from a small amount of the copper sulphide. In places the quartz is heavily combed and this peculiarity can at times harbour gold values. From a small stock pile nearby the writer collected typical specimens for analysis.

Sample #8282B (Midget 6204 claim) assayed 0.99 ounces per ton silver and 0.016 ounces per ton gold.

This zone, which is claimed to be over 200 feet wide, dips under overburden some 60 feet north of the showing and emerges on a hillside slope (YNS #7721) over a mile to the north. Here it presents itself as a light grey, banded dolomite striking N10° E and dipping vertically. There are occasional thin seams of light mineralization mainly of the tetrahedrite-pyrite variety, which are of a random nature lacking structural significances. Chalcopyrite was observed in several places.

On the Giant #4 claim, the so-called pyrite zone lies within an argillaceous sediment with characteristic north north-east strike and steep westerly dips. Gold and silver values were said to have come from this location. The writer chipped a 2.3 foot sample across the showing.

Sample #8283B assayed 0.17 ounces per ton silver and 0.008 ounces per ton gold.

Silver King 15031 claim further north and on the west slope of a ridge exposes in a blasted trench a highly sheared light coloured dolomite cut with quartz gash veins. The 8 foot wide zone trends almost north-south over a 75 - 85 foot length. Some of the quartz veins are associated with mineralization, primarily tetrahedrite.

In general, the showings examined are relatively weak in silver mineralization. There are no showings that could be termed to have economic values. The claims have not been well prospected nor has any great effort been made to open and extend the known areas of mineralization. There is nothing exciting about the claims either structurally or economically. It would appear that the vendors are trying to sell the ground on enthusiasm alone.

The writer is negative regarding the Amoyette-Shunter Creston area claims.

Yours truly,

W.G. HAINSWORTH & ASSOCIATES LTD.

W.G. Hainswerth

WGH/sb



TO WEST S

3

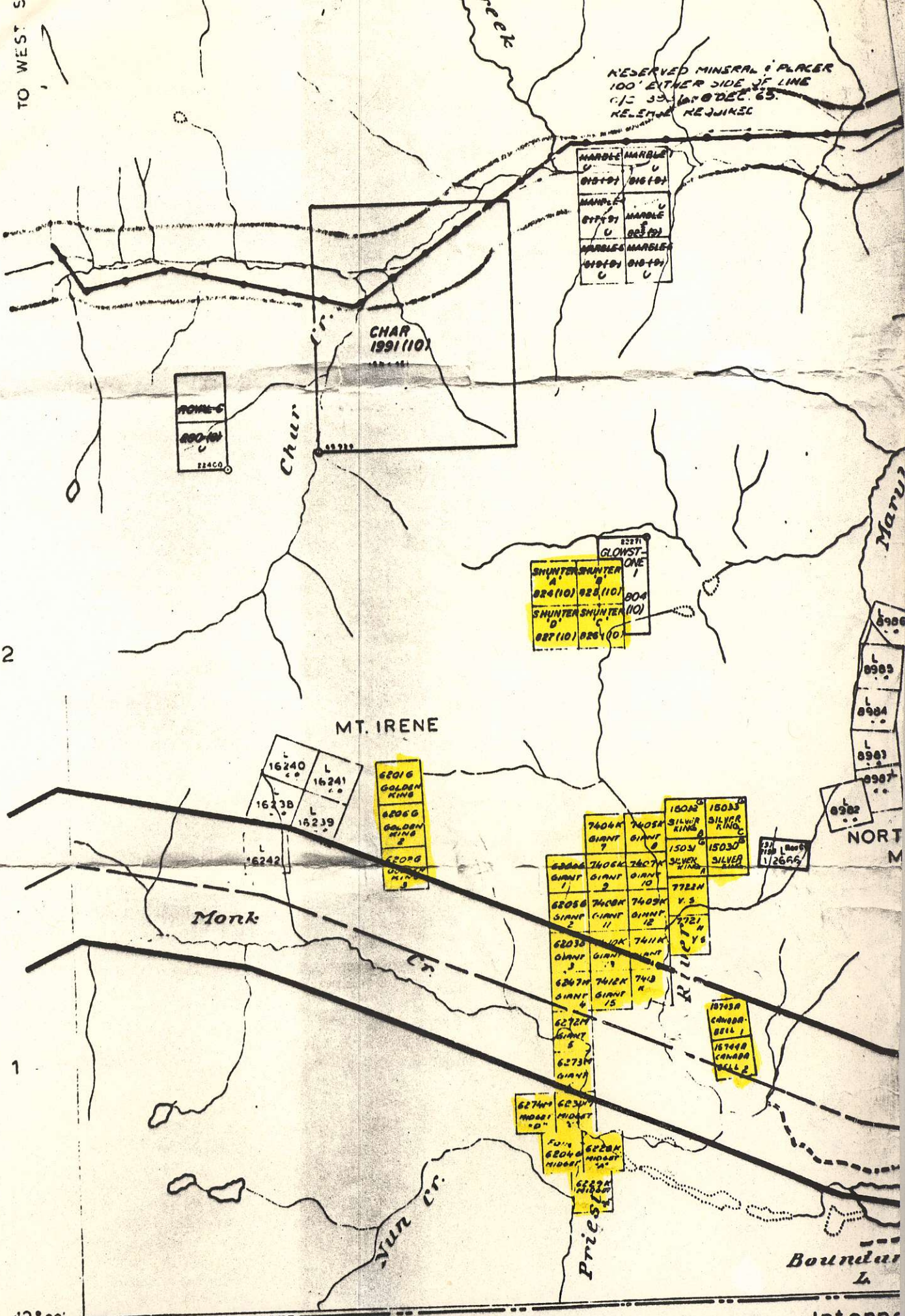

RESERVED MINERAL PLACER  
100' EITHER SIDE OF LINE  
C/L 33 100 DEC. 65.  
RELEASE REJUNE

CHAR  
1991 (10)

FORM-C  
020101  
22400

MARBLE	MARBLE
010101	016101
MARBLE	MARBLE
017101	023101
MARBLE	MARBLE
010101	016101

GLOWST-ONE	
SHUNTER A	SHUNTER B
024(10)	028(10)
004	
SHUNTER D	SHUNTER C
027(10)	0284(10)

MT. IRENE

L	16240	L	16241
L	16238	L	16239
L	16242		

02016	GOLDEN RING
02016	GOLDEN RING
02016	GOLDEN RING

7400A	7400K	SILVER RING	SILVER RING
GIANT 7	GIANT 8	1800A	1800B
6200A	7400K	7400M	7400N
GIANT 1	GIANT 2	GIANT 10	GIANT 11
6200B	7400K	7400M	7400N
GIANT 2	GIANT 11	GIANT 12	GIANT 13
6200C	7400K	7400M	7400N
GIANT 3	GIANT 14	GIANT 15	GIANT 16
6200D	7400K	7400M	7400N
GIANT 4	GIANT 15	GIANT 16	GIANT 17
6272M	GIANT 5		
6273M	GIANT 6		
6274M	GIANT 7		
6274N	GIANT 8		
6274O	GIANT 9		
6274P	GIANT 10		
6274Q	GIANT 11		
6274R	GIANT 12		
6274S	GIANT 13		
6274T	GIANT 14		
6274U	GIANT 15		
6274V	GIANT 16		
6274W	GIANT 17		
6274X	GIANT 18		
6274Y	GIANT 19		
6274Z	GIANT 20		

18703A	CANADA BELL 1
18703B	CANADA BELL 2

49° 00'

117° 00'

NELSON MINING DIVISION

Intern

For up-to-date information on

DEPARTMENT OF MINES  
VIC

