

800467

REPORT

on the

Phase 1A Operation

Concerning Claims:

L752 - Fontenoy
L753 - Last Chance
L3015 - Knight Rambler
4065 - Kettle

Greenwood Mining Division
British Columbia

CO-ORDINATES

North 49° 07' Latitude
West 119° 10' Longitude
N.T.S. 82 E/3 East

For

BRAVO RESOURCES INC.

930 - 470 GRANVILLE STREET,
VANCOUVER, B.C.

By

W.G. HAINSWORTH, P.ENG.

INTERNATIONAL FIELD SERVICES INC.

905 - 837 WEST HASTINGS STREET.
VANCOUVER , B.C. V6C 1B6

February 9, 1989

TABLE OF CONTENTS

	<u>Page</u>
Introduction	1
Location and Access.	2
Property	3
General Geology.	4
Local Geology.	5
Trench and Shaft Work.	6
Analysis	7
Recommendations.	9
Estimated Cost - Phase IB.	10
Cost Figures - Phase IA.	11
Certificate	
Assay Certificate	
Statement of Work	

MAPS.

Location map Fig. 1	following page 2
Claim map Fig. 2	following page 3
Shaft Sampling Fig. 4	following page 6
Recommended Drill Location Fig. 5.	following page 8
Trench Locations and Results.	end of report

IN BACK COVER

Fig. 3. Trench Locations

INTERNATIONAL FIELD SERVICES INC.

Consultation, Exploration & Management

SUITE 905
837 WEST HASTINGS STREET
VANCOUVER, BRITISH COLUMBIA
V6C 1B6 (604) 687-6930

INTRODUCTION

This report covers the results of work recently completed on the four (4) noted claims. This is a follow-up program report abiding by the recommendation of the July 10, 1987 report.

Work on the claims was carried out from August 23 to September 1, 1988. The work under the collective guidance of two graduate geologists consisted of pitting by back hoe at selected places and sampling the bedrock exposed by this means. In addition the old inclined shaft on the Fontenoy Crown Grant was de-watered and the vein structure in the shaft sampled at appointed locations. A total of 26 pits or trenches were attempted with 10 not reaching deep enough to bedrock. The shaft was de-watered to its 70 foot depth.

It should be noted that the identification of some of the older Crown - granted claims could not be specifically located due to absence of claim posts or land survey lines. The more recent staking, such as the Kettle claim of 20 units, was readily located.

The field operations carried out the Phase 1A recommendations as advanced in the writer's report of April 6, 1987. A sum in excess of \$21,138 was expended upon the operation. Recommendations as to the next phase are appended to this report.

BRAVO RESOURCES INC.

CAMP MCKINNEY CLAIMS

GREENWOOD M.D., B.C.

NTS: 82 E/3

LOCATION MAP

To accompany a report by
W.G.Hainsworth

FIGURE 1

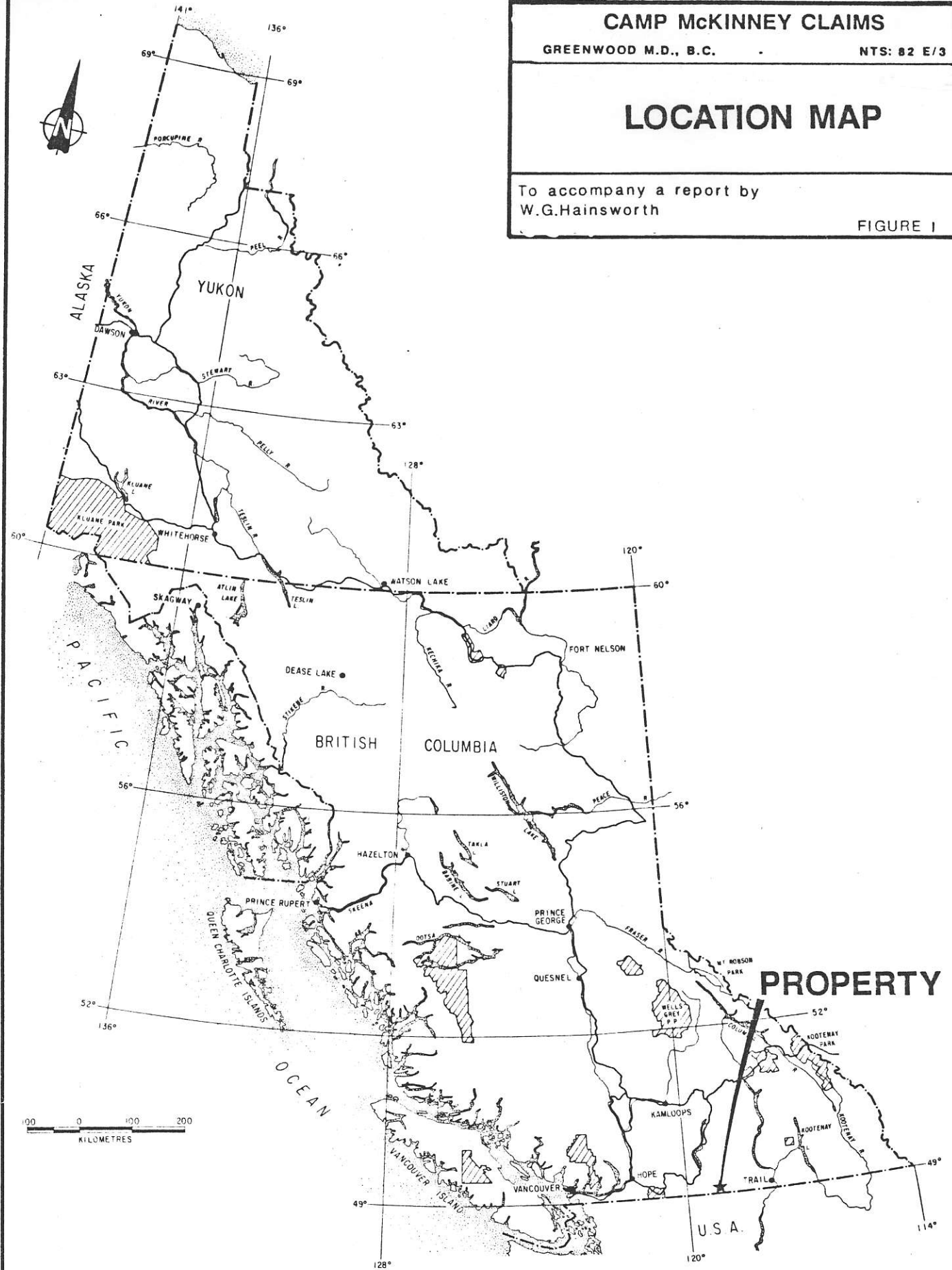

PROPERTY

The West Monashee Mountains property of Bravo is within the Greenwood Mining Division.

The holdings consist of two Crown - Granted claims kept in good standing, plus an optioned adjoining group consisting of a reverted crown grant and a claim of 20 units. Figure 2 shows the relationship of the block of claims to the adjoining old producer, the Cariboo- Amelia, and surrounding claims.

In total the property occupies approximately 557.8 hectares (1378.4 acres) with the claims being at an elevation of 1340 to 1370 meters (4400 to 4500 feet) in a fairly flat section of the mountain ridge.

The Claims

<u>Name</u>	<u>Record No.</u>	<u>Units</u>	<u>Expiry Date</u>	<u>Size</u>
Last Chance	L753	1	---	46.83
Fontenoy	L752	1	---	47.86
Knight Rambler	L3015	1	June 22, 1990	48.22
Kettle	4065	20	May 22, 1990	1235.5

Rock Creek (Jolly Creek) which runs through the northeastern corner of the Kettle claim, is some 1370 meters (4500 feet) north-northeast of the Fontenoy inclined shaft while Rice Creek is 1035 meters (3400 feet) west of the shaft. If necessary, water for drilling purposes could be drawn from the Waterloo shaft less than 300 meters (1000 feet) distant.

Assessment work up to the year 1990 has been entered against specific claims.

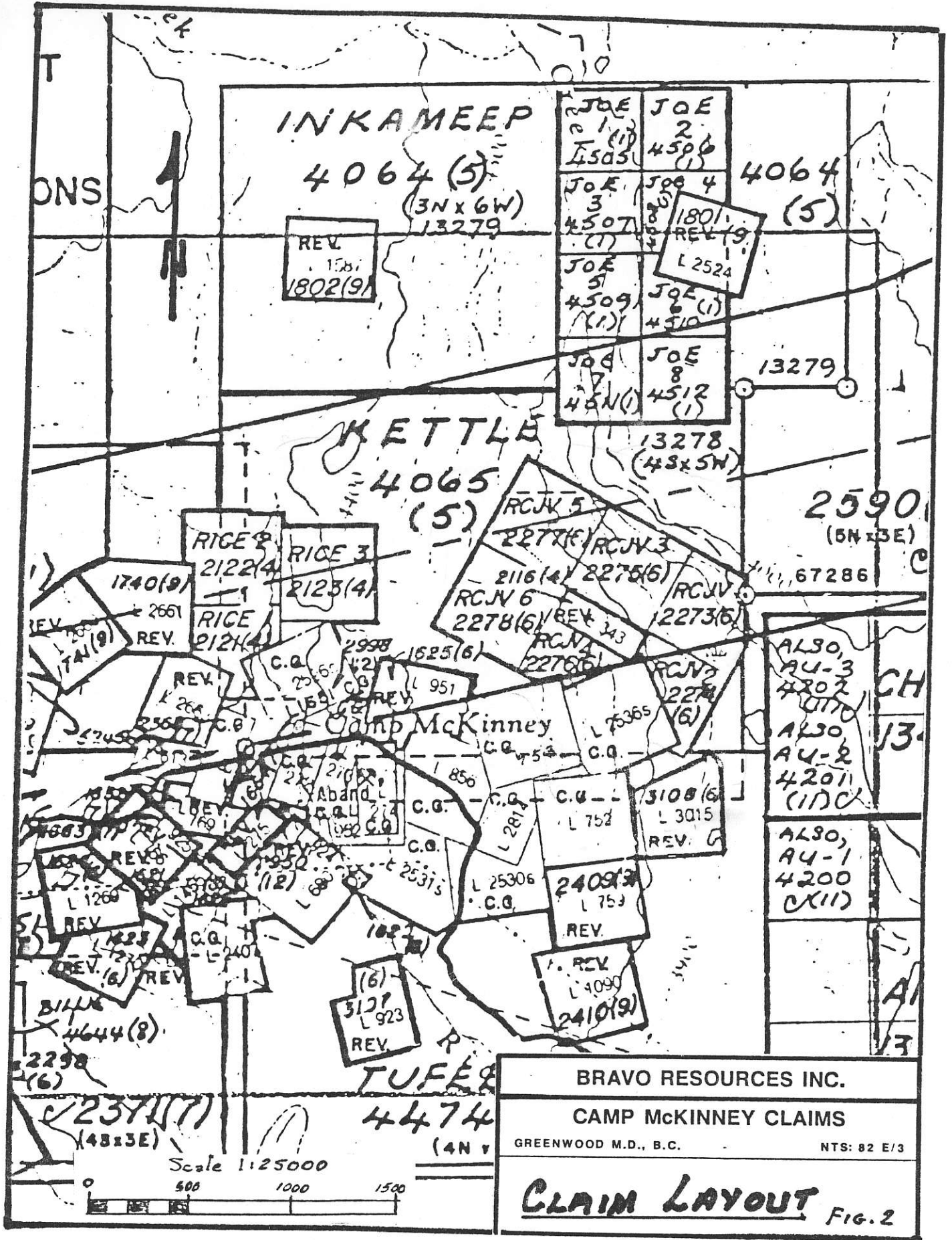

INKAMEEP
4064 (5)
(3N x 6W)
13279

JOE 1 (1) 4505	JOE 2 4506 (1)
JOE 3 4507 (1)	JOE 4 4508 (1)
JOE 5 4509 (1)	JOE 6 (1) 4510
JOE 7 4511 (1)	JOE 8 4512 (1)

REV.
1751
1802 (9)

1801
REV. (9)
L 2524

4064 (5)

13279

KETTLE
4065 (5)

13278
(4S x 5W)

2590
(5N x 3E)

67286

RICE 2
2122 (4)

RICE 3
2123 (4)

1740 (9)

REV. 2661
1741 (9)

RICE
2124 (4)

RCJV 5
2278 (6)

RCJV 3
2275 (6)

2116 (4)

RCJV 6
2278 (6)

RCJV 4
2273 (6)

C.O. 2998
2998 1625 (6)

Camp McKinney

ALSO,
AU-3
4202
4201
ALSO,
AU-2
4201
(1) C.

ALSO,
AU-1
4200
C (1)

Aband. R.L.
2100

RCJV 4
2278 (6)

RCJV 5
2278 (6)

C.O. 2409 (3)
L 753

C.O. 3108 (6)
L 3015
REV. G

C.O. 2409 (3)
L 753

C.O. 2409 (3)
L 753

C.O. 2409 (3)
L 753

C.O. 2409 (3)
L 753

C.O. 2409 (3)
L 753

C.O. 2409 (3)
L 753

C.O. 2409 (3)
L 753

C.O. 2409 (3)
L 753

C.O. 2409 (3)
L 753

C.O. 2409 (3)
L 753

TUFFER
4474 (4N)

Scale 1:25000

0 500 1000 1500

BRAVO RESOURCES INC.
CAMP MCKINNEY CLAIMS
GREENWOOD M.D., B.C. NTS: 82 E/3

CLAIM LAYOUT Fig. 2

LOCAL GEOLOGY

The brief examination of rock exposures in the vicinity of the inclined shaft showed the formations to be primarily siliceous argillites. The trend was northwest with the dip to the northeast. Several intercalated bands of highly silicified greenstones were observed in the general vicinity.

A deep gulley to the east of the main working and running north-south could be the surface indication of a fault structure.

The northwest corner of the Kettle Claim has been logged and presents a morass of wind falls and logging debris.

Numerous pits, trenches and shafts were encountered in the Crown - granted claims.

TRENCH & SHAFT WORK

In the author's July 10, 1987 report to Bravo Resources, recommendations were advanced for back hoe trench work in specific areas of the claims. In addition, the de-watering and sampling of the shafts in the Crown Grants should be undertaken.

The recommendations were carried out under the supervision and guidance of two graduate geologists - Geo. B. Hainsworth and Nigel Luckman - from August 23rd 1988 to September 1st 1988.

In total some 26 trenches were dug with 16 being completed through to bedrock. A total of 350 meters (1140 feet) of trench work was completed in the 16 trenches. Those trenches that did not reach bedrock were refilled. Sampling of the bedrock in each trench was done with a total of 34 samples being cut. In addition, mapping of outcroppings close by trenches was carried out with 4 samples being cut from 4 rock exposures.

The main Fontenoy shaft on the Fontenoy Crown Grant was de-watered by Sangold Resources Contractors Inc. of Vancouver. Sampling of the vein in the shaft was done by the previously named geologists. Some 17 samples were cut across the mineralized vein structure in the shaft.

In total 38 chip samples from the trenches and outcrops and 17 chip samples from the underground was sent to Min-En Laboratories in North Vancouver for fire assaying for gold and silver.

Location of trenches and samples therefor are shown in the adjoining individual trench plans and on figure 3 "Trench Locations".

ANALYSIS

The bulk of the trench sampling revealed weak precious metal values. In only one trench - 8-31-88 Trench B - did the sampling show results. Sample #130 cut across 3 feet of vein material carrying iron oxides and galena ran 33.83 ounces silver per ton with low 0.002 ounces gold per ton. A sample taken one foot further west (#127) produced weak results from the vein underlying (in the footwall) the main vein. This trench is 12 meters (40 feet) north northwest of the inclined shaft.

In July 1986 a grab sample taken by the writer from the dump of the shaft assayed 2.59 ounces silver per ton and 0.156 ounces gold per ton. This sample had galena and iron oxides associated with quartz-carbonates of the vein. The presence of galena in the Camp McKinney area is indicative of gold deposition.

The de-watering of the shaft to its 70 foot inclined depth exposed a surprising result. The shaft was collared on the original vein and followed it down for some 40 feet on its original 45° dip. At the 40 foot mark the shaft steepened to 49° and picked up the vein in the footwall. This vein which had assayed weak in 8-31-88 trench B (#127) showed similar weak results from 45 feet (# 245 to #270) to the bottom of the shaft at 70 feet. Sample results on the mineralized vein from collar to 40 feet (#200 to #240) had an overall value of 0.088 ounces gold per ton across a 3.8 foot width. The silver in this portion of the vein ran 4.42 ounces silver per ton across the same vein width. Two samples (#225W and #240W) taken in the hanging wall showed weak results. A portion of the vein structure was hidden under broken muck down the shaft from 5 to 35 feet thus not allowing full width of the vein to be sampled.

Two trenches to the south of the shaft (Trench B-8-25-88 and Trench C-8-31-88) apparently were off the extended strike of the main vein and did not catch it.

If the vein in the Fontenoy shaft is the same as that in the collapsed Wiarnton Shaft some 600 meters (1970 feet) west, then it was not recognized or picked up in the sampling (#122) of trench D-8-28-88.

It would appear from the sampling in the shaft and trenches done to date that the majority of vein structures exist on the two Crown Granted claims - the Fontenoy and the Last Chance. Continuity appears to exist between the shaft and a close by trench some 12 meters (40 feet) away. Unfortunately no trenching was done to the southeast of the shaft where extension could be expected. Therefore this area is still open.

Analysis cont.

Nothing of interest was generated in the trench work done on the optioned claims - the Kettle group and the Knight Rambler.

C.G
L752

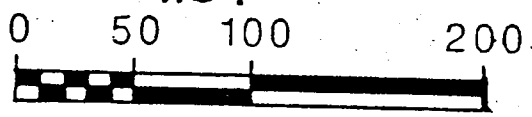
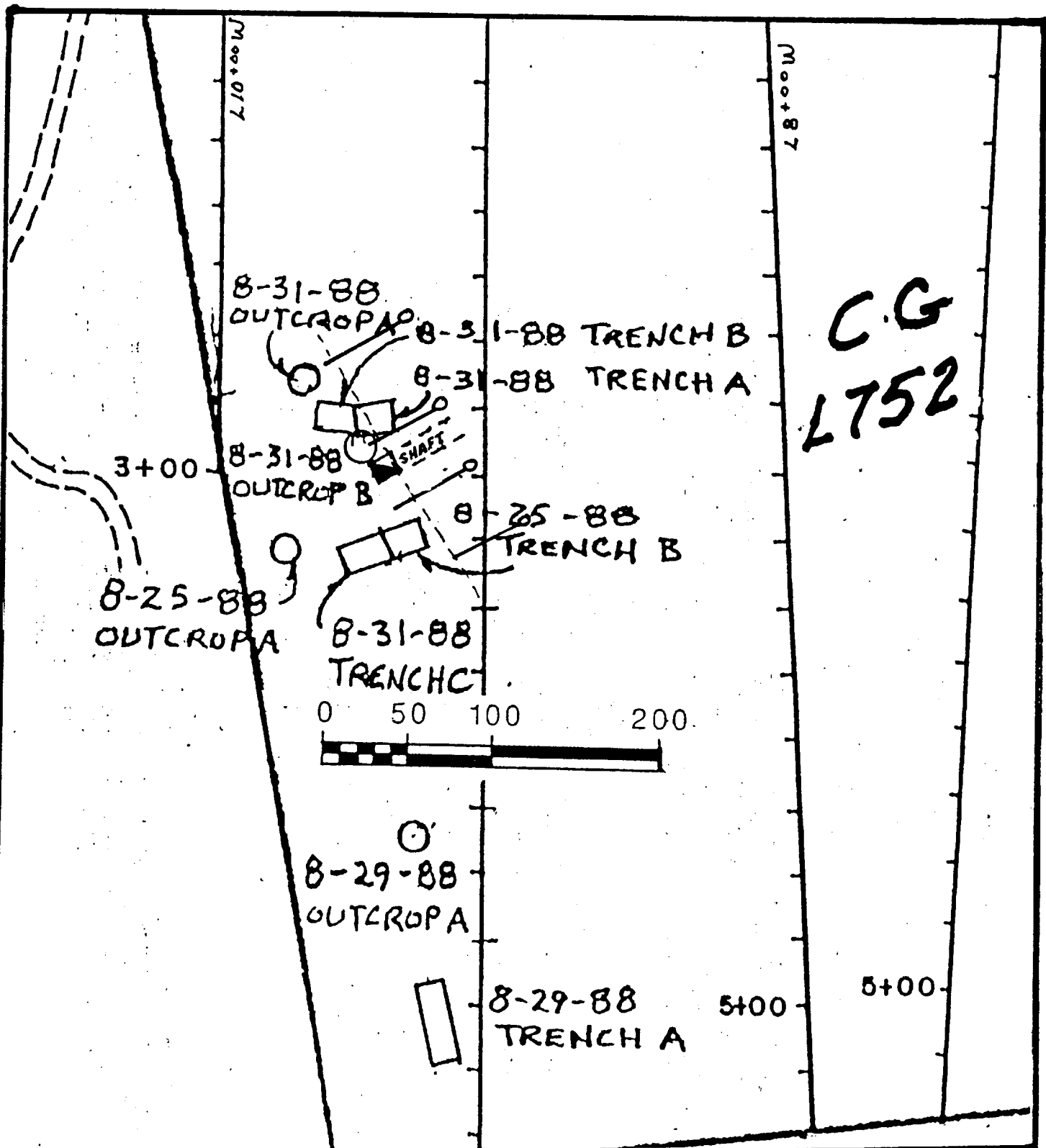

○
PROPOSED HOLE
LOCATIONS

POSSIBLE VEIN
TREND

BRAVO RESOURCES INC.	
CAMP MCKINNEY CLAIMS	
GREENWOOD M.D., B.C.	NTS: 82 E/3
PROPOSED DRILL HOLES	
FIG. 5	

RECOMMENDATIONS

It is recommended that Bravo Resources investigate the presence and extension of the vein structure outlined in the inclined shaft and the suspected extension of this vein in a close by trench. To this end it is recommended that consideration be given to an abbreviated diamond drill program structured to investigate the lateral extent of the above mentioned vein.

It is considered that six drill holes totalling 1,000 feet (300 meters) should be sufficient to prove or disprove the existence of the shaft vein to the northwest and southeast of the shaft. Drill holes should be spotted to cut the vein structure at 50 and 100 feet vertically.

Should the results of this short drill program prove encouraging a Phase II program involving further, more detailed drilling should be considered.

It is recommended that Bravo consider relinquishing the optioned claims - Kettle and Knight Rambler - as the past operation showed little results of merit from work done on the claims.

Respectfully submitted,

W.G. Hainsworth, P.Eng.

ESTIMATED COST OF PHASE IB (DIAMOND DRILLING)

1,000 feet of diamond drilling	
all found @ \$40/foot	\$40,000
Supervision, Consultation.....	4,000
Sampling of Core and Assaying.....	<u>2,500</u>
	\$46,500
Contingency 10%	<u>4,500</u>
	\$51,000

INTERNATIONAL FIELD SERVICES INC.

Consultation, Exploration & Management

SUITE 905
837 WEST HASTINGS STREET
VANCOUVER, BRITISH COLUMBIA
V6C 1B6 (604) 687-6930

FIELD EXPENDITURES - Aug. 23 to Sept 1, 1988

<u>Phone calls</u> (collect)	125.00
<u>Wages</u> 2100 + 2150 10 days	4,250.00
<u>Lodgings</u> 75.30 + 30.24 + 703.77	809.31
<u>Drafting</u> - 8 hours @ \$35/hour	280.00
<u>Supervision</u> - 3 days @ \$450	1,350.00
<u>Misc.</u> 37.52 + 43.62 + 18.00 + 33.46	132.60
<u>Back Hoe</u> \$170.00 + 1012.50	1,182.50
<u>Shaft Pumping</u>	5,613.30
<u>Vehicle Rental</u> 372.50 + 350.00	722.56
Report assessment production & filing of assessment work	818.40
<u>Travel Time</u> 590.60 + 566.00	1,156.60
Report of operation for Company purposes	3,000.00
<u>Taxi</u> 15.00 + 15.00 + 15.00	45.00
<u>Bus</u> (sample delivery)	23.55
<u>Gas</u> - 36.50 + 8.77 + 37.50 + 34.50 (on credit-card)	117.27
<u>Sampling</u> Min En Labs	1,050.00
<u>Food</u> 9.90 + 30.40 + 12.60 + 26.84 + 40.05 + 26.00 + 33.40 + 12.80 + 6.60 + 5.75 + 24.95 + 18.50 + 16.00 + 16.77 + 17.50 + 30.00 + 20.00 + 12.45 + 36.40 + 14.45 + 4.23 + 18.10 + 28.55.	<u>462.24</u>
	\$ 21,138.33

CERTIFICATE

I, W.G. Hainsworth, P.Eng., of Vancouver, B.C. do hereby certify:

- (1) That I am a Consulting Geologist residing at 836-13th Avenue, Vancouver, B.C.
- (2) That I am a graduate of the University of Western Ontario, London, Ontario, Bachelor of Science Degree, Honours Geology.
- (3) That I have practiced my profession for some 30 years.
- (4) That I have been a continuous member of the Association of Professional Engineers of British Columbia since 1965 and am a Professional Geologist registered with the Association of Professional Engineers, Geologists and Geophysicists of Alberta since 1979.
- (5) That I have no financial interest, direct or indirect, in Bravo Resources Inc. and do not expect to obtain any such interest.
- (6) That the information contained in this report is based on a visit to the Mt. McKinney property on August 23, 1988 and perusal of all pertinent information available.
- (7) That consent is herewith given to Bravo Resources Inc. to use any or all material from this report in information circulars, offerings or shareholders' brochures, provided no attempt is made to misrepresent the stated facts of the report.

W.G. HAINSWORTH, P.Eng. (B.C.)
P.Geol. (Alta)

To Accompany:

REPORT
on the
Phase 1A Operation
Concerning Claims:
L752 - Fontenay
L753 - Last Chance
L3015 - Knight Rambler
4065 - Kettle

February 9, 1989