

PROSPECTING
PROPERTY EXAMINATION

800365

ON THE
MARBLE ARCH MINERAL CLAIMS

SLOCAN MINING DIVISION

TWELVE MILE CREEK, KASLO AREA
BRITISH COLUMBIA

PREPARED FOR

STRYDER EXPLORATIONS LTD.

VANCOUVER, B.C.

April 8, 1986
Vancouver, B.C.

WRITTEN BY
LLOYD C. BREWER

TABLE OF CONTENTS

	PAGE
INTRODUCTION	1
PROPERTY, LOCATION & ACCESS	1
WATER & POWER	1
WORK PREFORMED	4
PERSONEL	4
STATEMENT OF COSTS	5
STATEMENT OF QUALIFICATIONS	6
APPENDIX # 1	7

LIST OF FIGURES

FIGURE 1	Location Map	2
FIGURE 2	Claim Map	3

INTRODUCTION

This report describes work done on the Marble Arch claim, record # 2820 (2), in late August, 1986. The property is part of the Marble Arch claim group which consists of 6 mineral claims totaling 52 units. There are 5 separate known mineral occurrences on the Marble Arch claim, all run good values in silver, lead, zinc and small amounts of gold. There is recorded production from the property,

PROPERTY, LOCATION & ACCESS

The Marble Arch claim consists of 12 units:

<u>Name :</u>	<u>Size</u>	<u>Record #</u>	<u>Anniversary Date</u>
Marble Arch	12 units	2820 (2)	February 9, 1987

The property is located in the watershed of Twelve Mile Creek approximately 20 kilometers west of Kaslo, B.C.. The claim is accessible by road by following hwy # 31A west from Kaslo for 20 km then turning left on to the Twelve Mile Creek road. The Legal Corner post is located on the Twelve Mile Creek road about 3000 meters up from the Kaslo River. The center of the claim lies @ 49°59' 30" N. Latitude by 117° 05' W. Longitude.

WATER & POWER

The only source of water on the property is Twelve Mile Creek which flows through the southeastern corner of the claim, it is a strong year round stream with ample water for all phases of exploration and development.

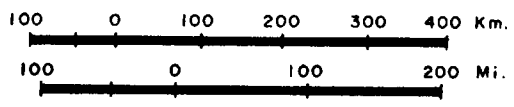
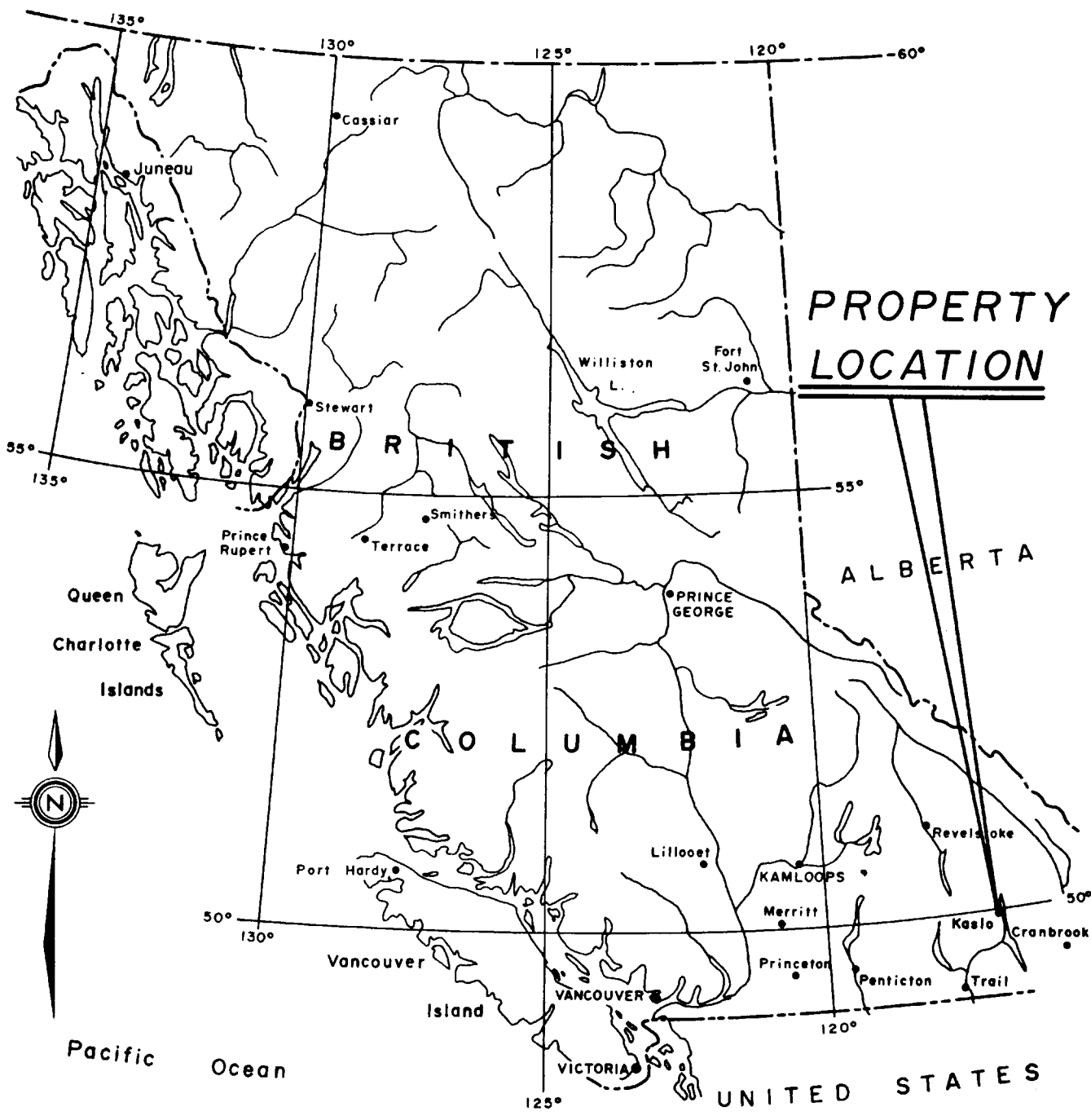
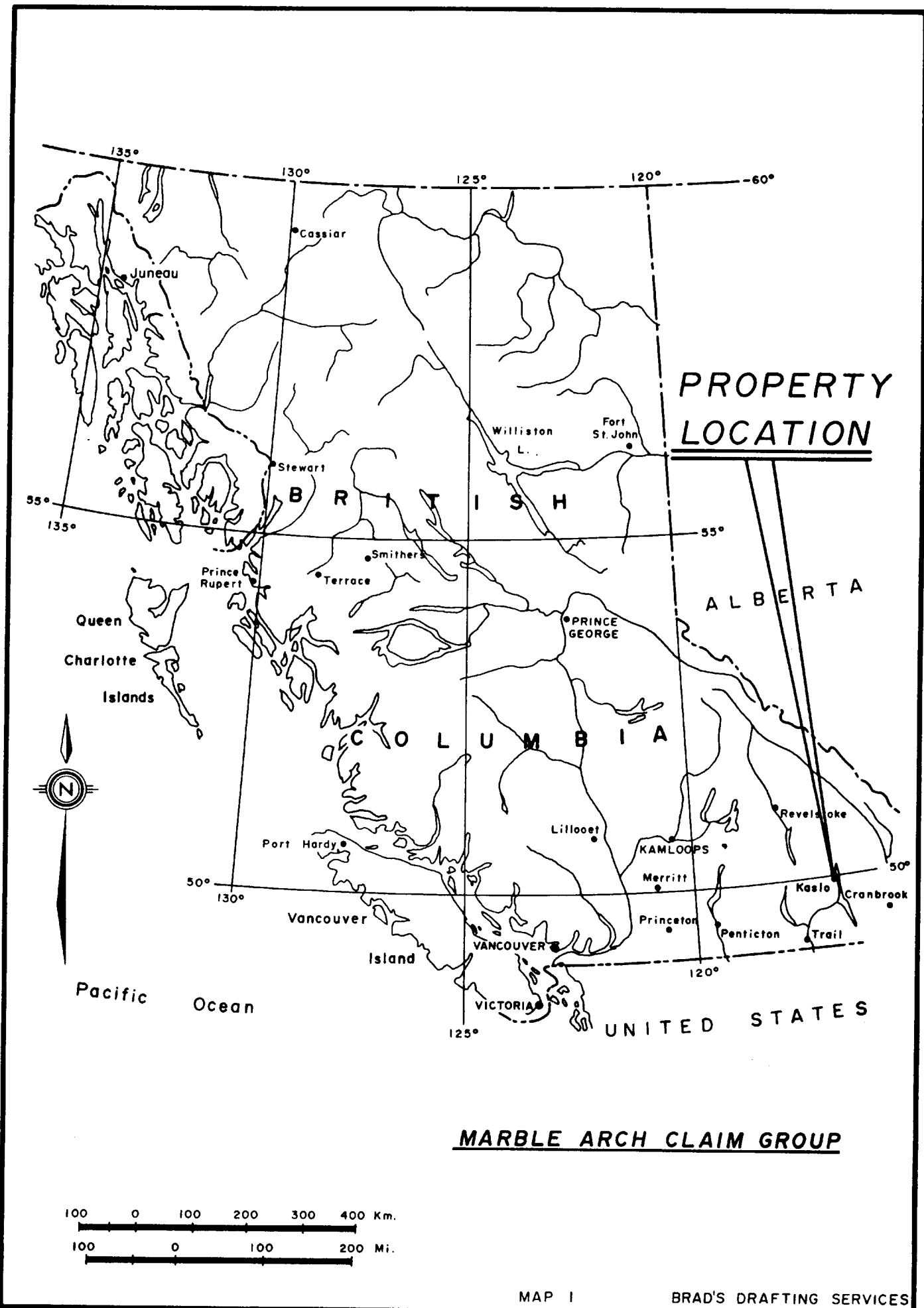

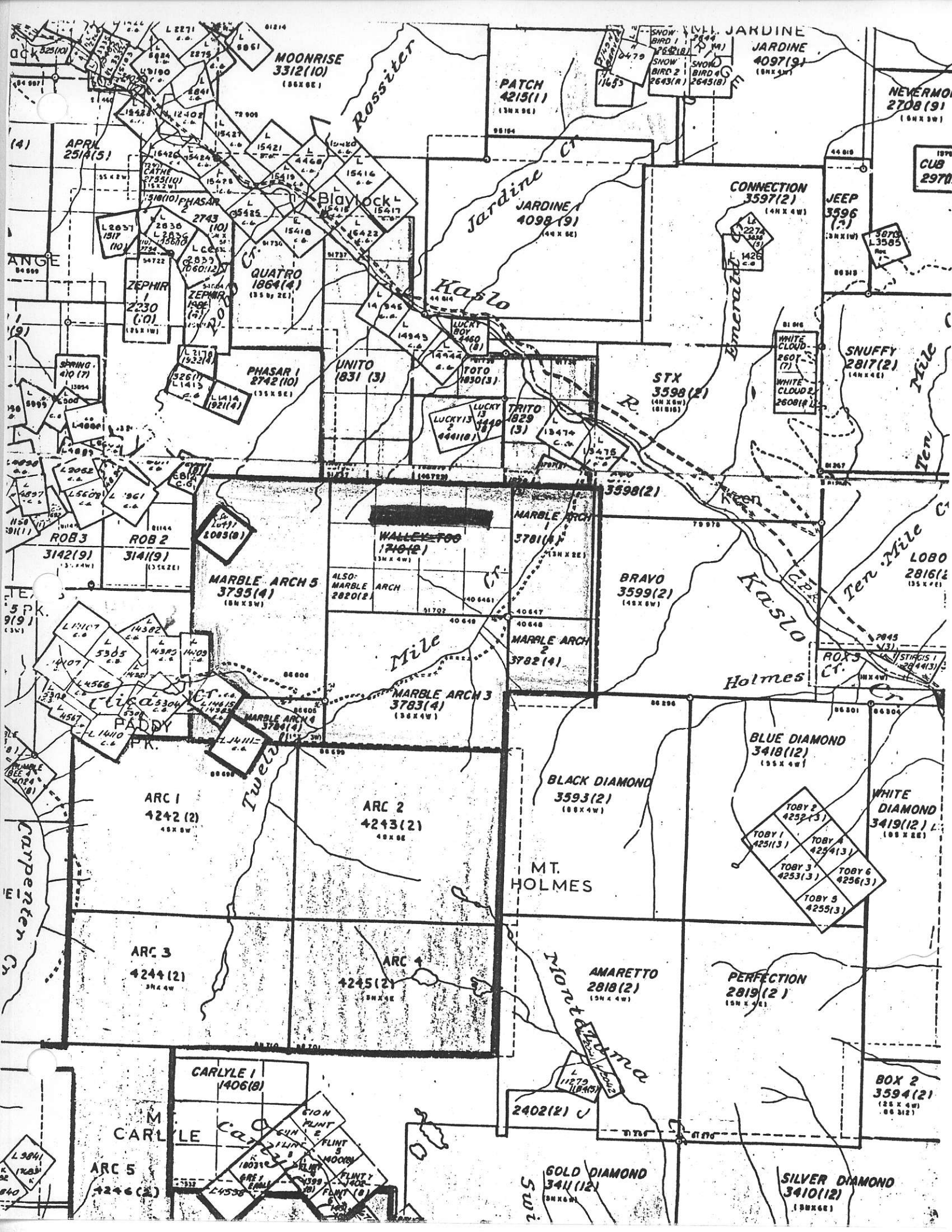

MOONRISE
3312(10)
(88X9E)

PATCH
4215(1)
(13X8E)

JARDINE
4097(9)
(88X8E)

NEVERMO
2708(9)
(88X8W)

APRIL
251A(5)

Blaylock

JARDINE
4098(9)
(44X8E)

CONNECTION
3597(2)
(48X4W)

JEEP
3596
(3)
(38X1W)

CUB
2970

QUATRO
1864(4)
(18.5X2E)

Kaslo

WHITE
CLOUD
2601
(7)

SNUFFY
2817(2)
(48X4E)

PHASAR 1
2742(10)
(135X5E)

UNITO
1831(3)

LUCKY
BOY
2460
(8)

TRITO
1829
(3)

STX
3598(2)
(48X8W)
(1018E)

WHITE
CLOUD 2
2608(12)

ROB 3
3142(9)
(3.84W)

ROB 2
3141(9)
(13.62E)

LOBBY
2083(8)

WALLEY POG
1740(2)

MARBLE ARCH
3781(4)

BRAVO
3599(2)
(48X6W)

MARBLE ARCH 5
3795(4)
(88X8W)

ALSO:
MARBLE ARCH
2820(2)

MARBLE ARCH
3782(4)

Kaslo
Holmes

ROX
3783(4)

LOBO
2816(2)
(135X8E)

LI 1107
LI 1407
LI 1456
LI 1457
LI 1458
LI 1459
LI 1460
LI 1461
LI 1462
LI 1463
LI 1464
LI 1465
LI 1466
LI 1467
LI 1468
LI 1469
LI 1470
LI 1471
LI 1472
LI 1473
LI 1474
LI 1475
LI 1476
LI 1477
LI 1478
LI 1479
LI 1480
LI 1481
LI 1482
LI 1483
LI 1484
LI 1485
LI 1486
LI 1487
LI 1488
LI 1489
LI 1490
LI 1491
LI 1492
LI 1493
LI 1494
LI 1495
LI 1496
LI 1497
LI 1498
LI 1499
LI 1500

MARBLE ARCH 4
3784(4)

MARBLE ARCH 3
3783(4)
(38X4W)

BLUE DIAMOND
3418(12)
(155X4W)

BLACK DIAMOND
3593(2)
(88X4W)

WHITE
DIAMOND
3419(12) L
(88X8E)

ARC 1
4242(2)
(48X8W)

ARC 2
4243(2)
(48X8E)

M.T.
HOLMES

TOBY 1
4251(3)
TOBY 2
4252(3)
TOBY 3
4253(3)
TOBY 4
4254(3)
TOBY 5
4255(3)
TOBY 6
4256(3)

ARC 3
4244(2)
(38X4W)

ARC 4
4245(2)
(88X8E)

AMARETTO
2818(2)
(138X4W)

PERFECTION
2819(2)
(138X4E)

CARLYLE 1
1406(8)

CARLYLE

2402(2) ✓

BOX 2
3594(2)
(28X4W)
(88X12)

ARC 5
4246(2)

GOLD DIAMOND
3411(12)
(88X8E)

SILVER DIAMOND
3410(12)
(88X8E)

WORK PERFORMED

A three man crew was sent to the Marble Arch property in late August to locate the five sets of workings that are reported to be on the claim. Two days were spent searching the property, two days were spent in traveling, and two half days were spent in gearing up and putting equipment back in storage. During the course of the property examination four of the five sets of workings were located by the field crew. The Marble Arch, Big Ben & California workings were located on the first day; they are on the north side of the Twelve Mile Creek drainage at an elevations of: Big Ben, 1600 meters a.s.l.; Marble Arch, 1400 meters a.s.l.; California, 1270 meters a.s.l.. The Helen set of workings was located on day two on the north western edge of the Marble Arch claim, about 1000 meters to the north-west of the Big Ben workings at an elevation of 1600 meters a.s.l.. The Keno workings were not located during the property visit but are believed to be located near the Helen workings in the north western area of the claim.

A grab sample from the Helen workings assayed, 60.20% Pb., 121.10 oz/t Ag.,
0,016 oz/t Au..

PERSONEL

Field Supervisor	Lloyd C. Brewer
Field Assistants	Stephen Bishop
	Kevin Swatez

STATEMENT OF COSTS

Lloyd C. Brewer	4 days @ \$150.00	\$ 600.00
Stephen Bishop	4 days @ \$100.00	\$ 400.00
Kevin Swatez	4 days @ \$100.00	\$ 400.00
Room, Board, Supplies		\$ 487.50
Vehicle Rental	5 days @ \$45.00	\$ 225.00
Gas		\$ 207.50
Report compilation & assay		<u>\$ 330.00</u>
Total cost of program		\$ 2,650.00

Costs are correct as stated,



Lloyd C. Brewer

STATEMENT OF QUALIFICATIONS

I, Lloyd C. Brewer, of #1016-470 Granville Street, Vancouver, B.C. do declare that;

- 1) I am president of Stryder Explorations Ltd., and have for the past 5 years been working full time in the mineral exploitation industry, both here in B.C. as well as western North America.
- 2) I am the owner of the Marble Arch claims located on the Twelve Mile Creek, in the Slocan Mining Division.
- 3) I have done the work as stated on the days stated, in good faith.

Dated this 8th day of April, 1986, at Vancouver, B.C.

Sincerely



Lloyd C. Brewer

ACME ANALYTICAL LABORATORIES LTD.
852 E. HASTINGS, VANCOUVER B.C.
PH: (604)253-3158 COMPUTER LINE:251-1011

DATE RECEIVED OCT 10 1985
DATE REPORTS MAILED Oct. 17/85

ASSAY CERTIFICATE

SAMPLE TYPE : PULP

ASSAYER D. Saundry DEAN TOYE OR TOM SAUNDRY, CERTIFIED B.C. ASSAYER

STRYDER EXPLORATION FILE# 85-2636 R

PAGE# 1

SAMPLE	Pb	Ag	Au
	%	oz/t	oz/t
1	60.20	121.10	.016