

GOLD CUP MINE.

NELSON MINING DIVISION.

Porto Rico. B.C.

PLAN OF WORKINGS: ADIT "B"

Scale: 1 Inch = 30 Feet.

GOLD CUP NO. 3 M.C.

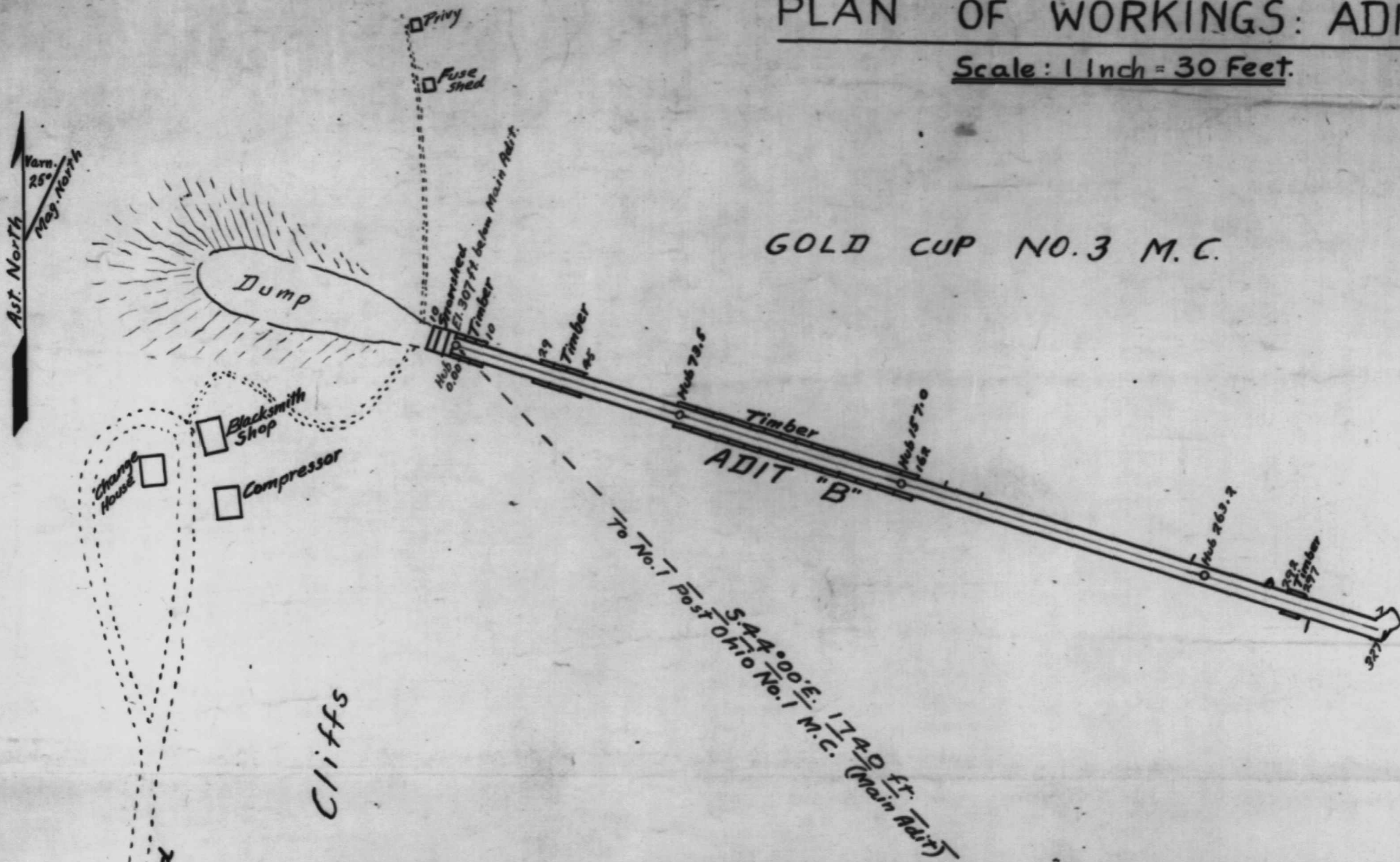

VERTICAL PLAN

Scale: 1 Inch = 30 Feet

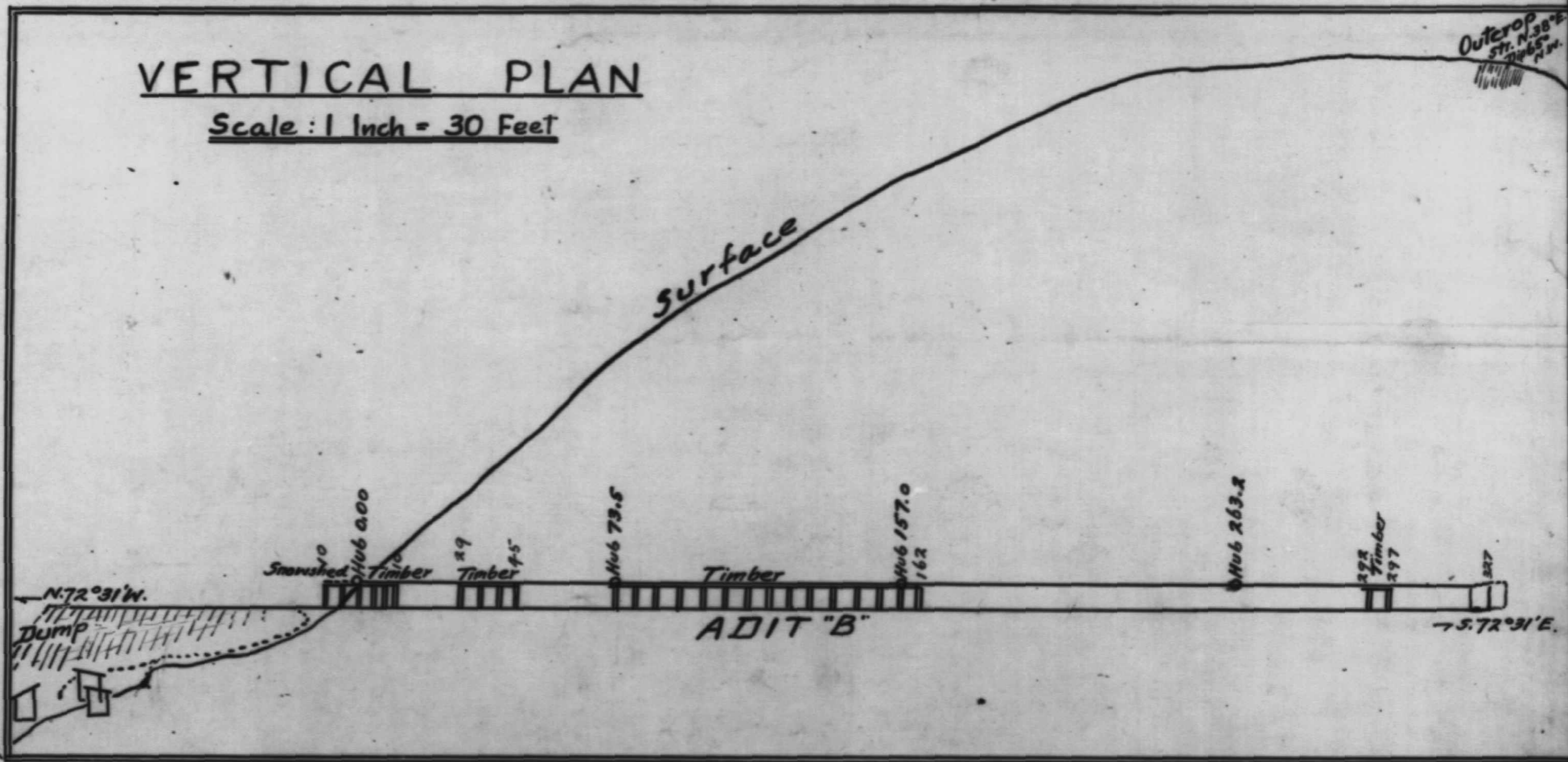

A. W. Haggan

Dominion and B.C. Land Surveyor
Registered Professional Engineer
Superintendent.

Nelson, B.C. Dec. 19th. 1935