

6000' ELEV

5950' ELEV

VERTICAL PROJECTION

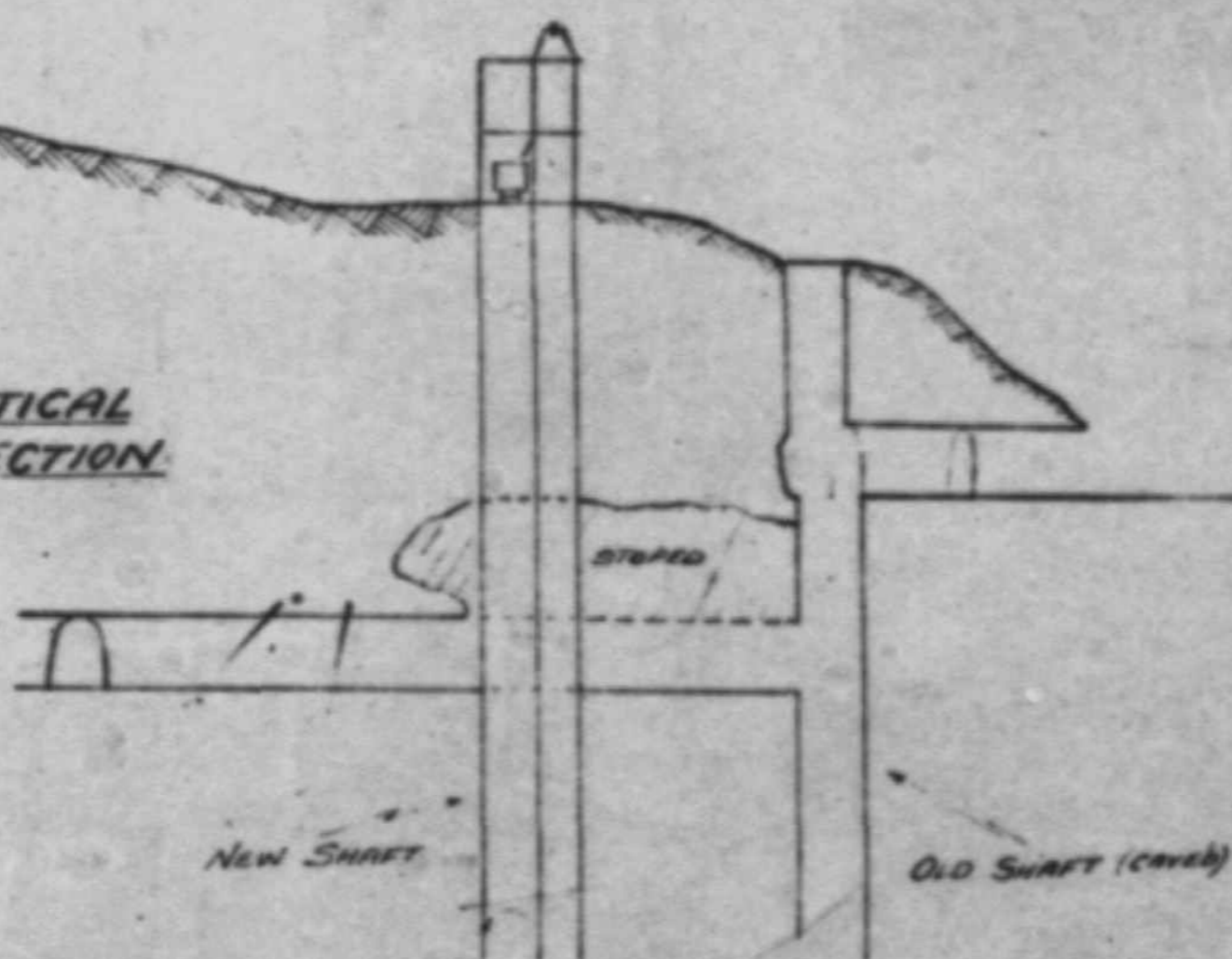

New Shaft

Old Shaft (cave)

5900' ELEV

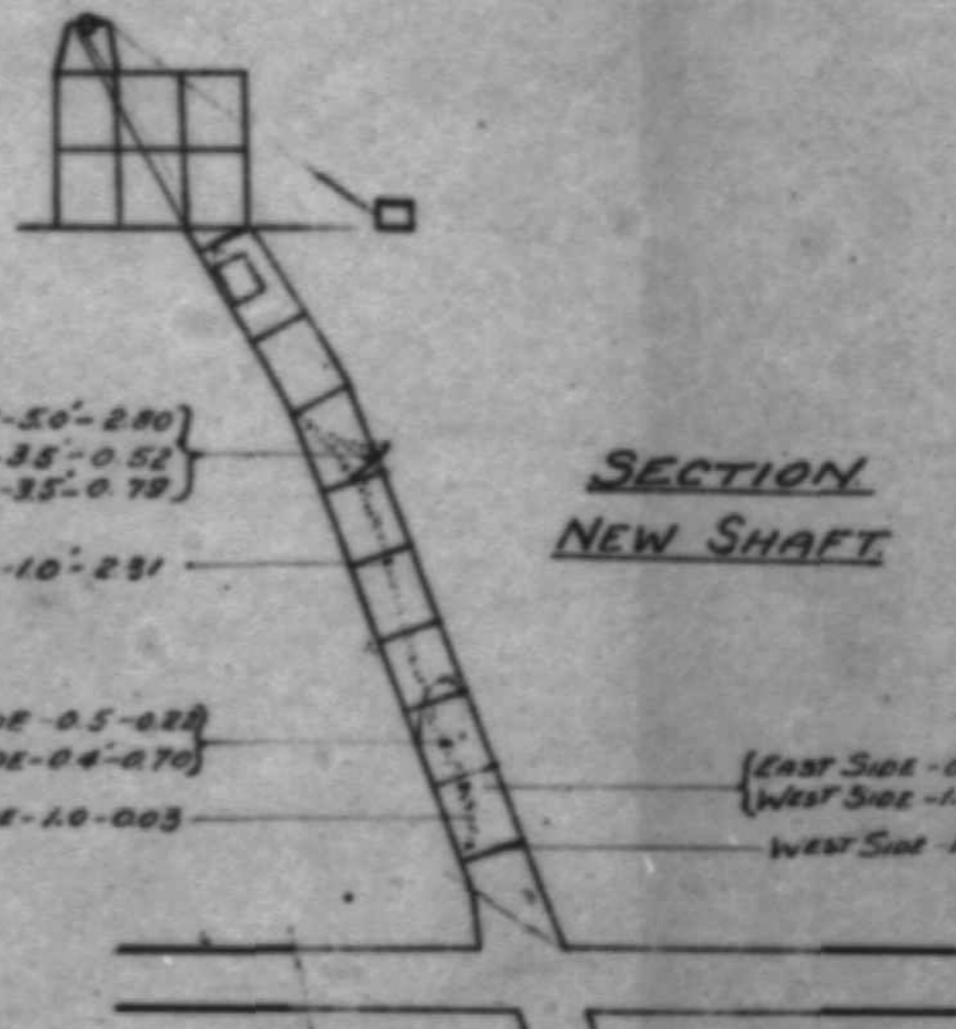

SECTION NEW SHAFT

EAST SIDE - 50' - 2.80  
MIDDLE - 35' - 0.52  
WEST SIDE - 35' - 0.79

EAST SIDE - 10' - 2.31

EAST SIDE - 0.5 - 0.22  
WEST SIDE - 0.4 - 0.70

WEST SIDE - 10' - 0.03

(EAST SIDE - 0.4 - 0.32  
WEST SIDE - 10' - 0.34  
WEST SIDE - 10' - 0.28



PLAN

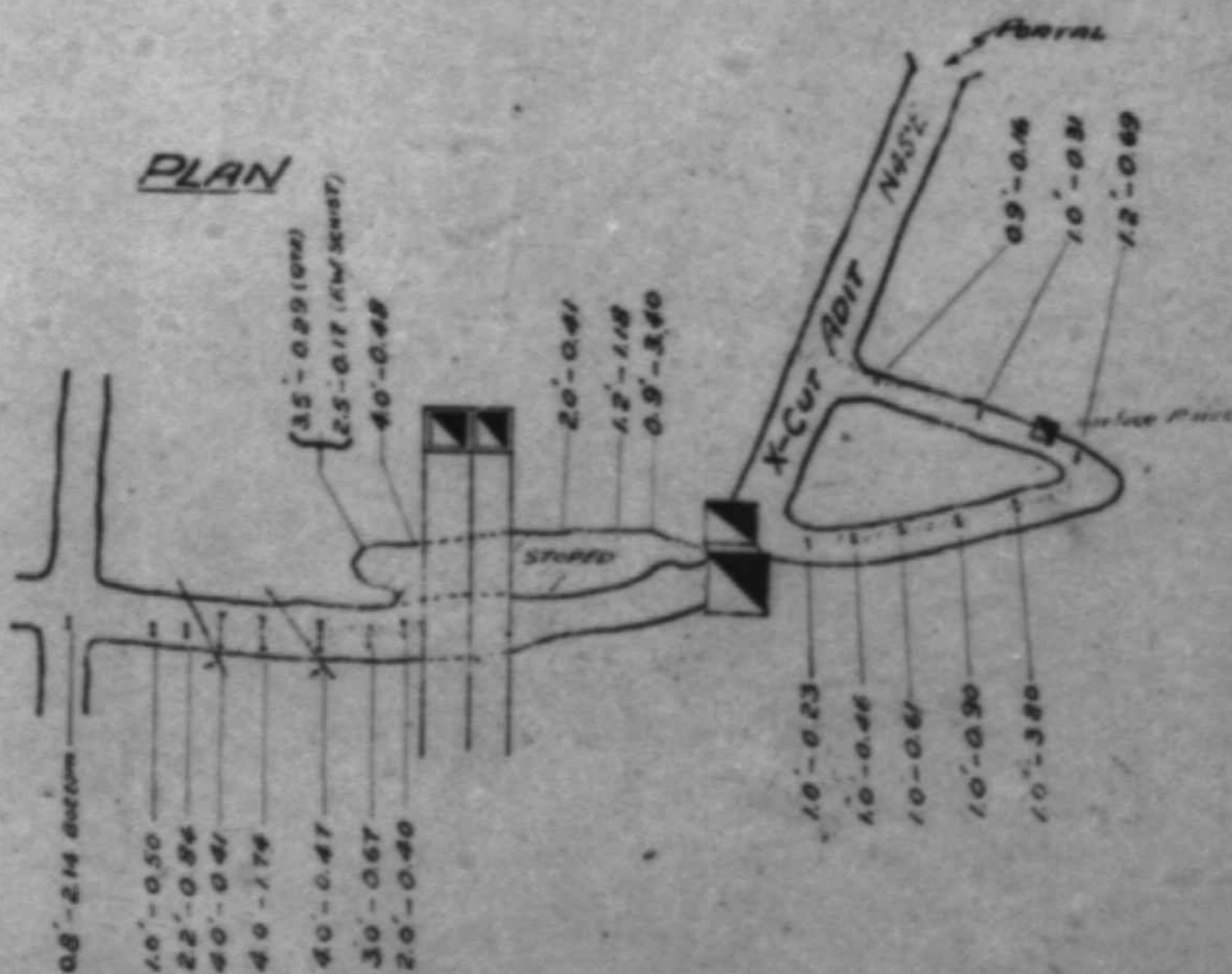

0.8' - 2.14

1.0' - 0.50

2.2' - 0.84

4.0' - 0.41

4.0' - 1.74

4.0' - 0.47

3.0' - 0.67

2.0' - 0.40

(3.5' - 0.29 (1000)  
2.5' - 0.17 (500/2000)

4.0' - 0.48

2.0' - 0.41

1.8' - 1.18  
0.9' - 3.40

1.0' - 0.23

1.0' - 0.46

1.0' - 0.61

1.0' - 0.90

1.0' - 3.80

Partial

X-Cut Adit N45°E

0.9' - 0.18

1.0' - 0.31

1.2' - 0.49

as per Plan

DAYLIGHT WORKINGS

DAYLIGHT GOLD MINES LTD.

SCALE 1 in = 20 ft.

AUG 1939

F. J. Hemsworth

Sample Sequence:- Width in feet - Ounces gold per ton

COMPLETED TO DATE OF  
SUSPENSION OF OPERATIONS  
SEPT 15, 1939

F. J. Hemsworth

Revised Sept 22, 1939  
James Dickson

120475-1  
DAYSIGHT 120475