

TOP SURVEY THIS  
1928  
D.A. COPPIN  
EAST WELLINGTON COAL

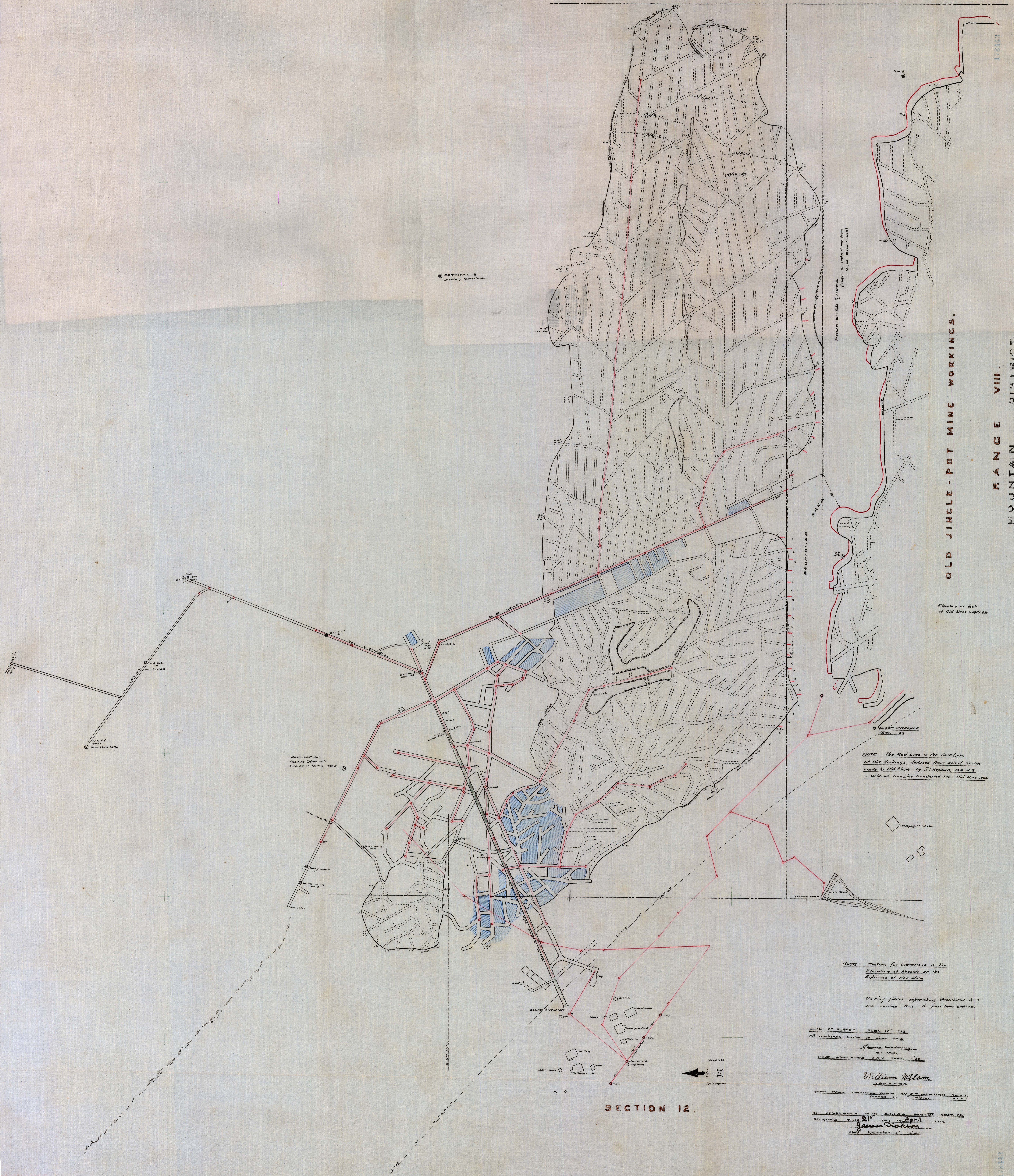

① BOREHOLE 13  
Leachery Apparatus

PROHIBITED AREA  
(From 1928 Survey)

OLD JINGLE-POT MINE WORKINGS.  
RANGE VIII.  
MOUNTAIN DISTRICT.

Elevation at foot  
of Old Slope - 413.20

NOTE: The Red Line is the Face Line  
of Old Workings, deduced from actual survey  
made to Old Slope by J.J. Hudson, M.E.M.S.  
- Original Face Line transferred from Old Mine plan.

NOTE - Datum for Elevations is the  
Elevation of Bench at the  
Entrance of New Slope

Working places approaching Prohibited Area  
and marked thus X have been stopped.

DATE OF SURVEY FEBY 10<sup>th</sup> 1928  
All workings located in above date  
- of same date  
S.E.M.S.  
MINE ABANDONED 31<sup>st</sup> FEBY 11/28

William Wilson  
INDICED

IN COMPLIANCE WITH S.M.A. PART 27 REG. 78  
RECEIVED THIS 21<sup>st</sup> DAY OF April 1928  
James Dickson  
Chief Inspector of Mines

SECTION 12.

PLAN  
of  
EAST WELLINGTON COAL COMPANY'S MINE.  
SCALE, 100 Feet = 1 inch

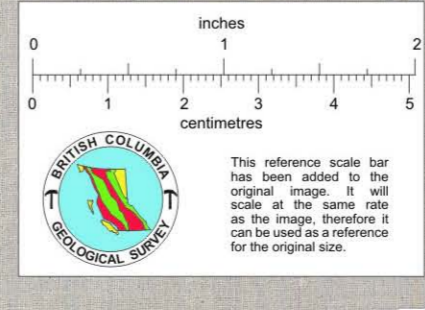

J.J. Hudson  
M.E.M.S.

will require original plan

17643