

PERRIER MINE

BRITISH AMERICAN EXPLORERS SYNDICATE

NELSON B.C.

F. J. S. SUB., E.M., M.O.R.
JAN. 22, 1932

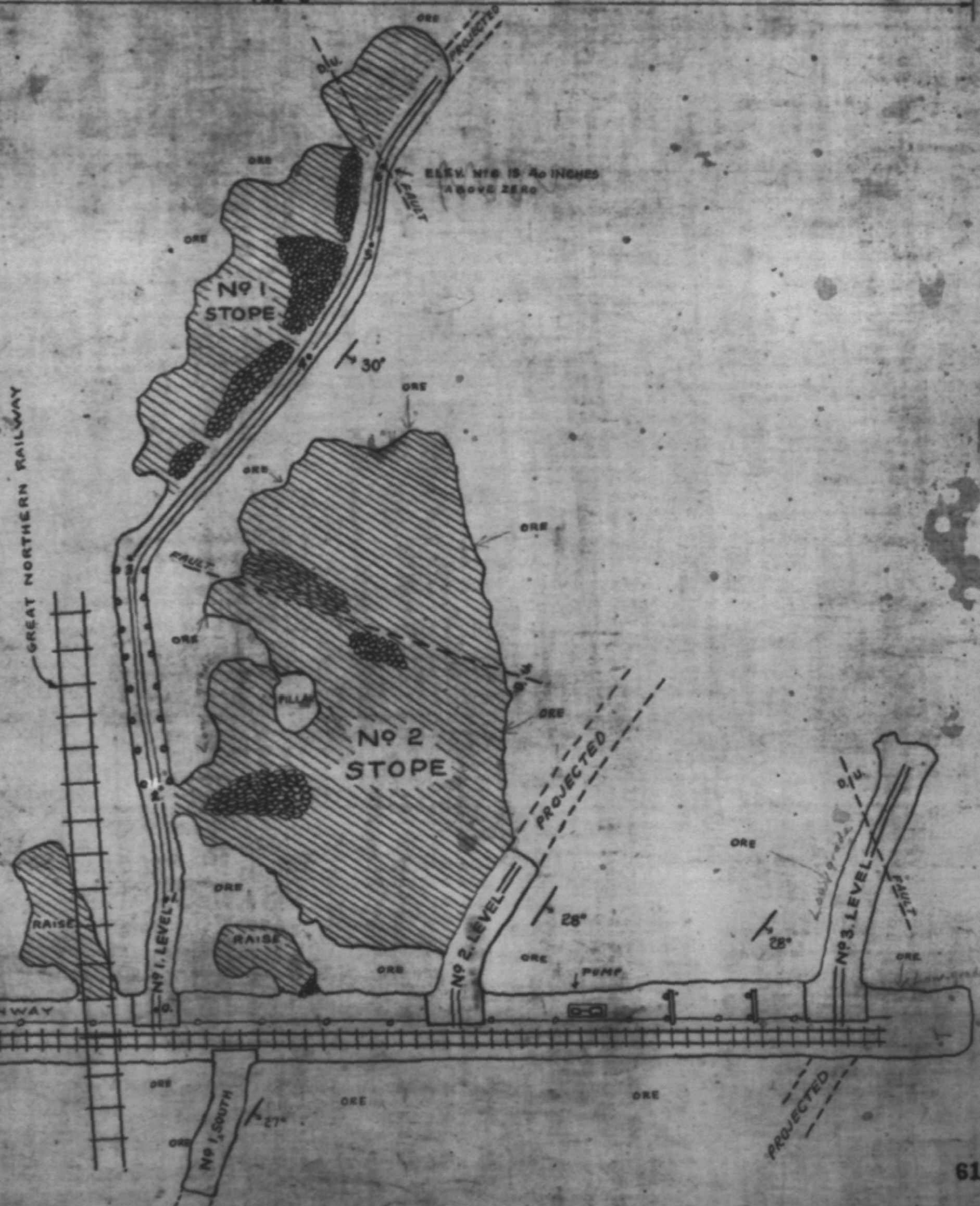
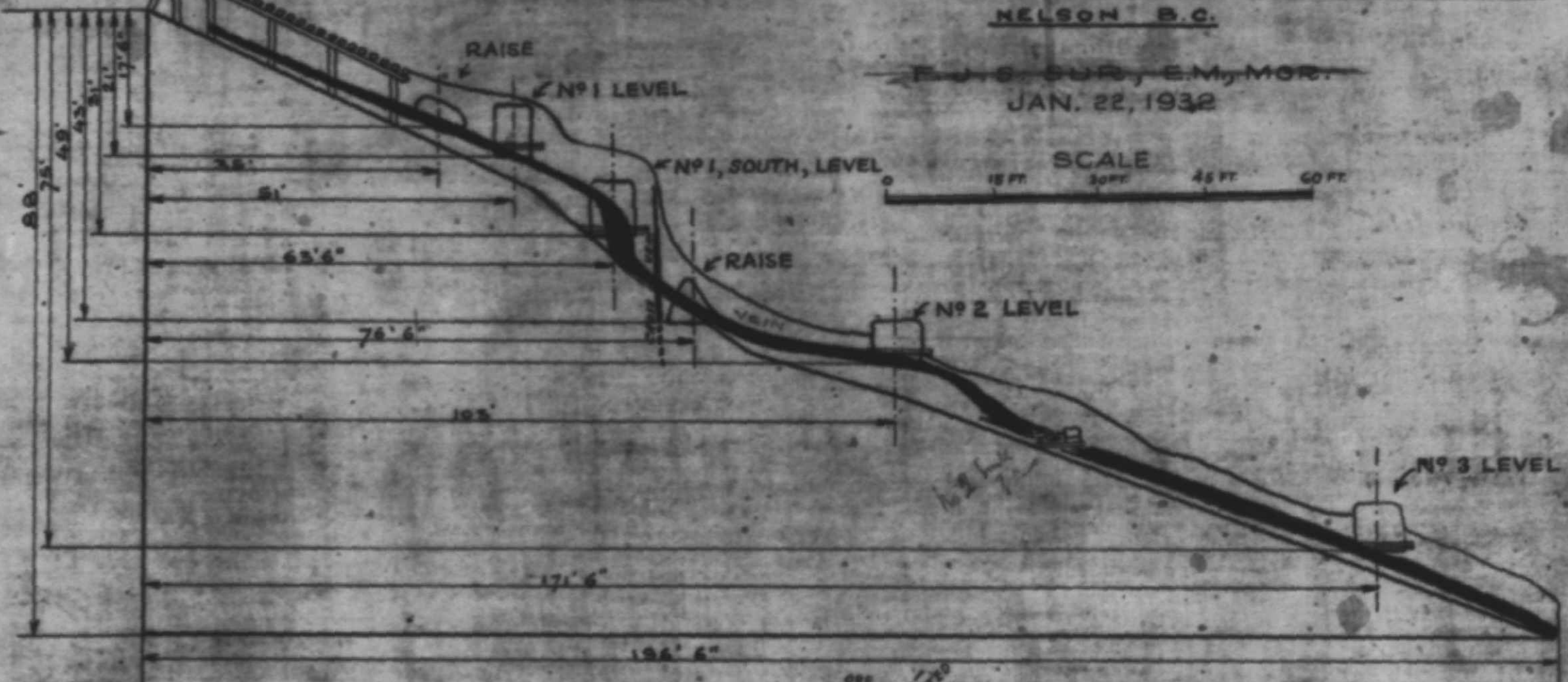

Upper portion of adit filled in 1958 or 1959 as this area was coming up to 500 feet

Handwritten notes and calculations:

30 - 2
15
2 1/2
30
15
42

Handwritten notes and calculations:

75
26
428
372