

APRIL 13
1996



PROVINCE OF
BRITISH COLUMBIA

MINISTRY OF
ENERGY, MINES AND
PETROLEUM RESOURCE

MINERAL TITLES REFERENCING
MAP 093104E
U.T.M. ZONE 10
LAST MAP UPDATE: 1995 JAN 04

ORIGINAL PRODUCED AT 1:31680

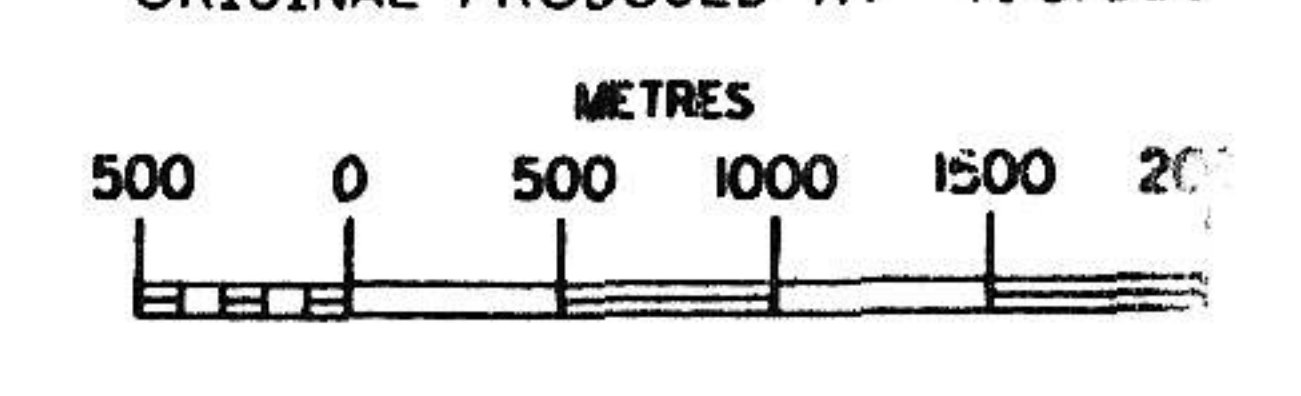

ADMINISTRATIVE AREAS
MINING DIVISIONS: CARIBOO

LAND DISTRICTS:

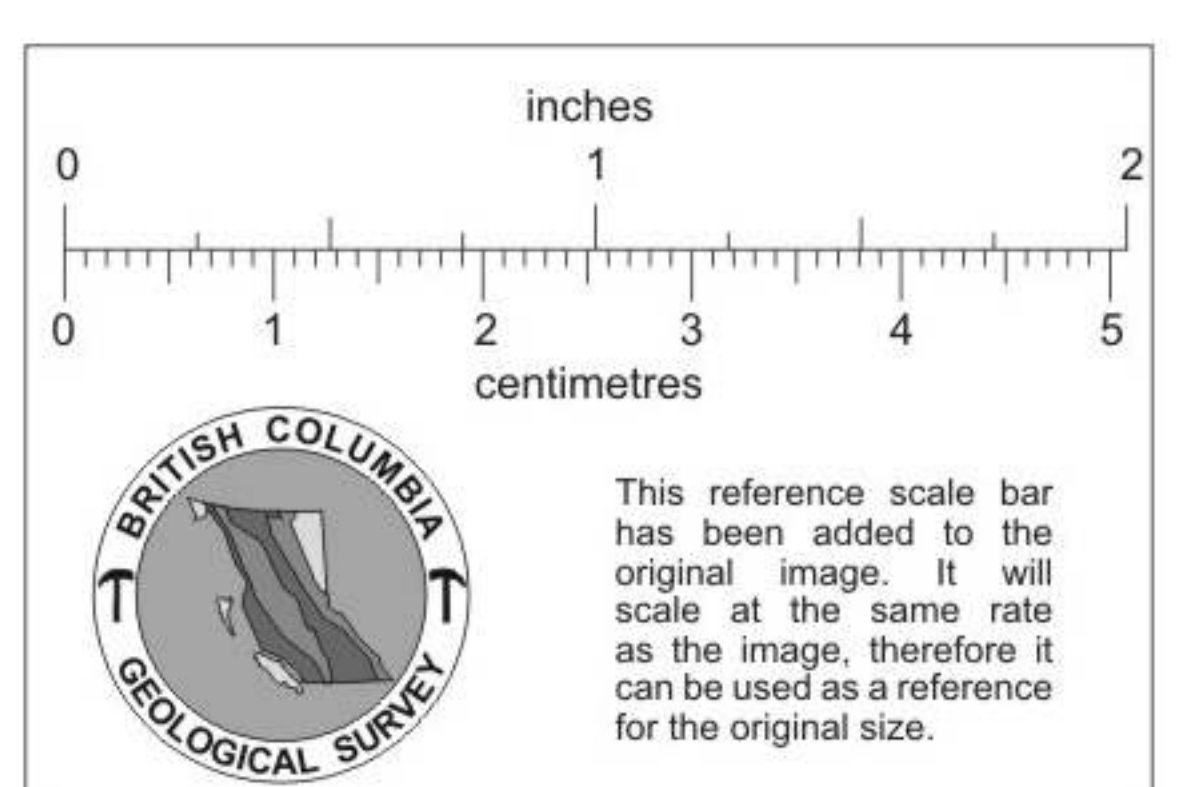

ALIENATIONS

- NO STAKING AREAS
- NO STAKING RESERVES
- PARKS
- ECOLOGICAL RESERVES
- RECREATION AREAS
- INDIAN RESERVES

CONDITIONAL AREAS

- SUBJECT TO CONDITIONS RESERVED
- SECTION 19 RECREATION AREAS
- POST CLAIM AREAS
- AREAS SUBJECT TO URANIUM / THORIUM REGULATIONS

MINERAL TENURE

- MINERAL CLAIM
 - MINERAL LEASE
 - INDUSTRIAL MINERAL CLAIM
- | | |
|-----------------------------|---------------|
| CLAIM NAME | EXAMPLE |
| TITLE NUMBER | 315675 |
| OLD TITLE NUMBER | 34567 |
| TAG NUMBER | 100000 |
| LEGAL POST | |
| WITNESS POST | |
| FORFEITED TENURE | |
| VERIFIED | VFR |
| SURVEYED | SUR |
| REVERTED C.G. MINERAL CLAIM | REV CG OR RCC |
| CROWN GRANTED | C G |
| OPEN FOR STAKING | O.F.S. |

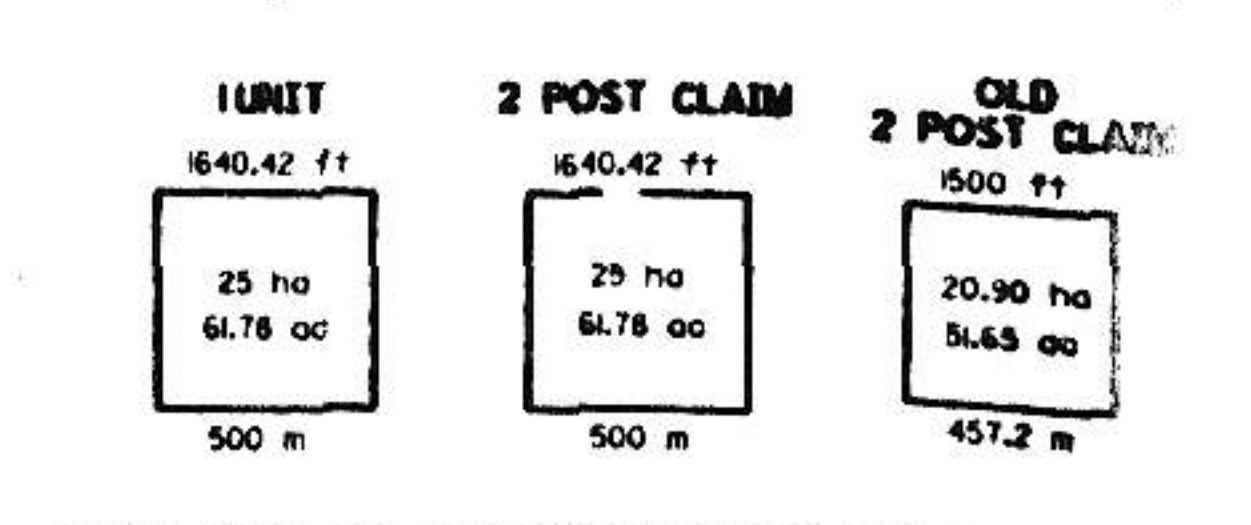

THIS MAP IS PREPARED ONLY AS A GUIDE TO THE LOCATION OF MINERAL TENURE AS SHOWN ON THE LOCATOR'S SKETCHES. FOR CURRENT OR MORE SPECIFIC INFORMATION, APPLICATION SHOULD BE MADE TO THE MINING DIVISION CONCERNED.

093105W	093105E	093106W
093104W	093104E	093103W
093103W	093103E	093104E

INDEX TO ADJOINING MAPS

093104E

681771



BT
EXP
OCT 25/91
DEC 22/96
DEV
26 BT RESOURCE CO. LTD
6620 CROSSCUTS SW
CALGARY
T3E-5R8
403-246
3190