

A

B

TO NORTH SEE MAP 27A

121° 30'

51° 30'

51° 30'



M92P/5E

0

5

4

3

2

1

6

5

4

3

2

1

TO WEST SEE MAP 92P/5W

TO EAST SEE MAP 92P/6W

TO SOUTH SEE MAP 92P/4E

681630

121° 30'

51° 15'

UNLESS VERIFIED OR SURVEYED, THE MAP POSITION OF A LEGAL CORNER POST IS BASED ON THE LOCATOR'S SKETCH FOR FURTHER INFORMATION, APPLY TO THE OFFICE OF THE MINING DIVISION CONCERNED.

DATE OF MICROFILM: MARCH 16, 1978

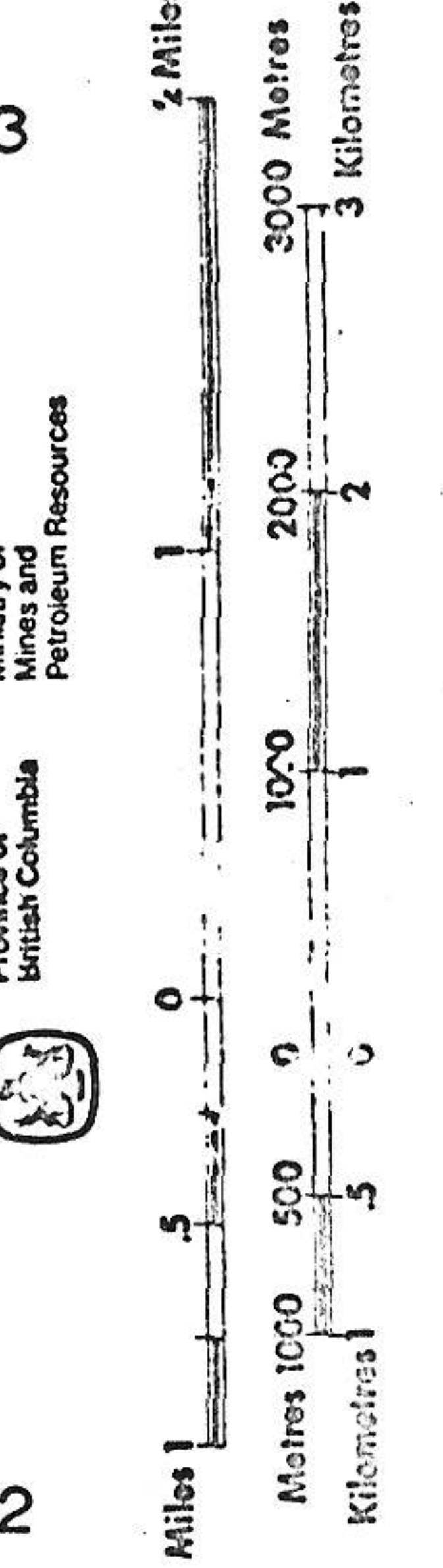

LEGEND

- CROWN-GRANTED MINERAL CLAIM
- REVERTED C.S. MINERAL CLAIM
- FORFEITED MINERAL CLAIM
- LEGAL SURVEY
- LEGAL CORNER POST
- LEGAL CORNER POST & TAG NUMBER 01-149

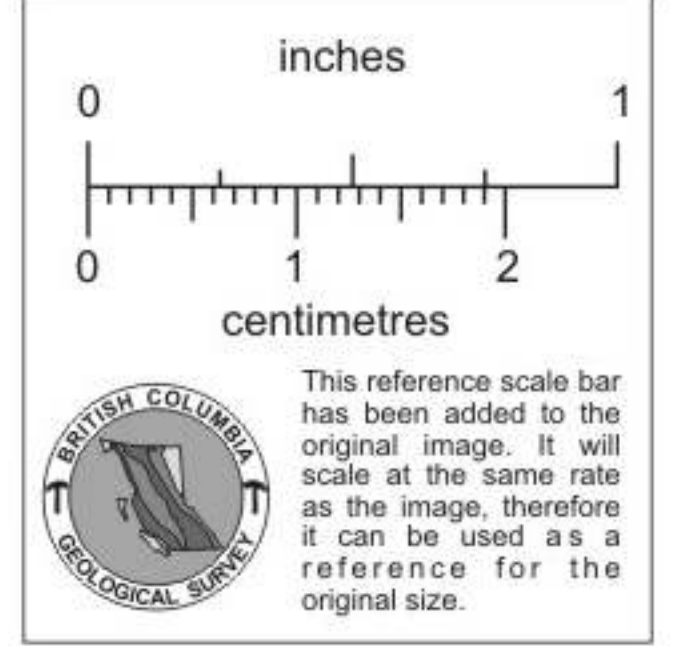

RES MIN 1-PLACER  
1/4 MILE EITHER SIDE  
SUBJ TO CONDITIONS  
PLEASE INQUIRE